

NOTES:

- 1) ALL SET IRON PINS ARE 1/2" DIAMETER REBAR WITH A YELLOW PLASTIC CAP STAMPED "BAKER SURVEYING".
- 2) BASIS OF BEARING IS THE TEXAS COORDINATE SYSTEM, TEXAS SOUTH CENTRAL ZONE 4204, NAD83.
- 3) NO CURRENT TITLE OPINION OF COMMITMENT FOR TITLE INSURANCE WAS FURNISHED AT THE TIME OF SURVEY; THEREFORE, NO CERTIFICATION IS MADE THAT ALL EASEMENTS AND DEDICATIONS OR OTHER ENCUMBRANCES ARE SHOWN ON THIS SURVEY.
- 4) CORRESPONDING METES AND BOUNDS DESCRIPTION ARE PREPARED.
- 5) IMPROVEMENTS ARE NOT SHOWN.
- 6) PROPERTY IS SUBJECT TO ALL CITY OF SAN ANTONIO AND BEXAR COUNTY ORDINANCES AND RESTRICTIONS.
- 7) THE PROPERTY SHOWN HEREON IS IN FLOOD ZONE AE, AS IDENTIFIED BY THE FLOOD INSURANCE RATE MAP 48029C0390G, DATED SEPTEMBER 29, 2010.

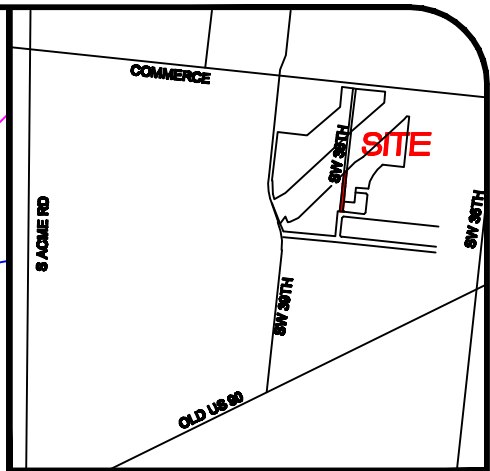

LOCATION MAP (N.T.S.)

SCALE:
1"=60'



LEGEND

- = FOUND 1/2" IRON PIN UNLESS NOTED OTHERWISE
- ⊗ = 1/2" IRON PIN SET

CITY OF SAN ANTONIO
6.6271 ACRES
VOL. 3973, PG 1509

TRACT "D"
5.07 AC
BOYD WATKINS
TRACT II
VOL. 6529, PG 110

TRACT "C"
4.33 AC
BOYD WATKINS
TRACT II
VOL. 6529, PG 110

TRACT "D"
5.07 AC
BOYD WATKINS
TRACT II
VOL. 6529, PG 110

PLAT SHOWING: A SURVEY OF A 0.29 OF AN ACRE, 30.0 FOOT WIDE STRIP OF LAND SITUATED IN THE CITY OF SAN ANTONIO, BEXAR COUNTY, TEXAS AND BEING A PORTION OF SOUTHWEST 38TH STREET.

N 06°01'50" E
0.29 ACRE
SW 38TH STREET (30' ROW)
S 06°01'50" W

LOT 1, BLK 7

LOT 2, BLK 7

LOT 4, BLK 7

LOT 3, BLK 7

I=90°10'50"
R=15.00'
A=23.61'
CHBRG=S39°03'35"E
CHDST=21.25'

WESTERN HILLS ADDITION
UNIT 2
VOL. 4600, PG. 163

N 84°09'00" W
20.60'

45.05'
N 83°46'6" W

PHARIS ST (50' ROW)

SW 38TH ST.
(30' ROW)

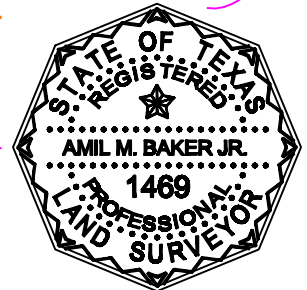

STATE OF TEXAS :
COUNTY OF BLANCO:

I, AMIL M. BAKER JR., DO HEREBY CERTIFY THAT THIS PLAT WAS PREPARED FROM AN ACTUAL SURVEY MADE ON THE GROUND BY PERSONS WORKING UNDER MY SUPERVISION.

Amil M. Baker Jr.

AMIL M. BAKER JR.

REGISTERED PROFESSIONAL LAND SURVEYOR NO. 1469
DRAWN: JUNE 18, 2013
SURVEYED: FEBRUARY 19, 2013
PROJECT NO.: 13-016 BRD-5900 COMMERCE
DWG No.: N:\Draw 2013\13-016 BRD-5900 COMMERCE

BAKER
SURVEYING, INC.

PH. (830) 833-2250
FAX. (830) 833-2257
2250 US 281 N.
BLANCO TX. 78606



THIS DRAWING IS THE PROPERTY OF BAKER SURVEYING AND SHALL NOT BE USED FOR ANY PURPOSE WITHOUT THE WRITTEN CONSENT OF AN AUTHORIZED AGENT OF BAKER SURVEYING. BAKER SURVEYING ACCEPTS NO RESPONSIBILITY FOR THE USE OF THIS DRAWING FOR ANY PURPOSE AFTER SIX MONTHS FROM THE DATE INDICATED ON THIS DRAWING. ALL RIGHTS RESERVED. COPYRIGHT 2013, BAKER SURVEYING, INC. ©