

A1 SPECIFIC USE AUTHORIZATION PLAN

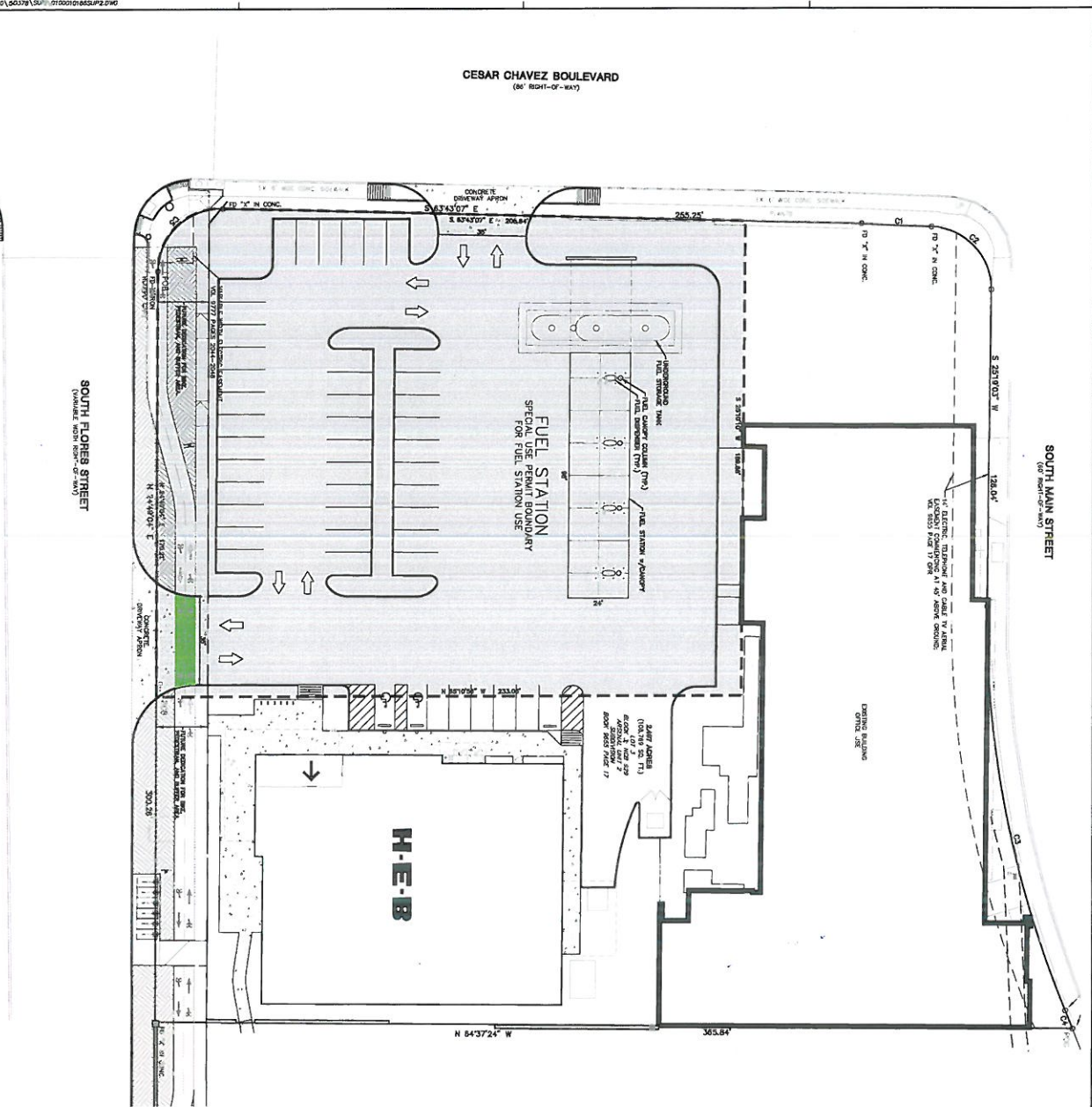

GRID #	LINE	PROPERTY BOUNDARY	GRID #	LINE	PROPERTY BOUNDARY
10	10	100' 0" 100' 0" 100' 0"	10	10	100' 0" 100' 0" 100' 0"
11	11	100' 0" 100' 0" 100' 0"	11	11	100' 0" 100' 0" 100' 0"
12	12	100' 0" 100' 0" 100' 0"	12	12	100' 0" 100' 0" 100' 0"
13	13	100' 0" 100' 0" 100' 0"	13	13	100' 0" 100' 0" 100' 0"
14	14	100' 0" 100' 0" 100' 0"	14	14	100' 0" 100' 0" 100' 0"
15	15	100' 0" 100' 0" 100' 0"	15	15	100' 0" 100' 0" 100' 0"
16	16	100' 0" 100' 0" 100' 0"	16	16	100' 0" 100' 0" 100' 0"
17	17	100' 0" 100' 0" 100' 0"	17	17	100' 0" 100' 0" 100' 0"
18	18	100' 0" 100' 0" 100' 0"	18	18	100' 0" 100' 0" 100' 0"
19	19	100' 0" 100' 0" 100' 0"	19	19	100' 0" 100' 0" 100' 0"
20	20	100' 0" 100' 0" 100' 0"	20	20	100' 0" 100' 0" 100' 0"

**ADDRESS**  
 822 WEST ROAD, SUITE 100  
 SAN ANTONIO, TEXAS 78205

**OWNER/DEVELOPER**  
 HEB STORES, INC.  
 SAN ANTONIO, TEXAS

**PREPARED BY**  
 BURY ENGINEERING & ARCHITECTURE, P.C.  
 822 WEST ROAD, SUITE 100  
 SAN ANTONIO, TEXAS 78205

**DATE**  
 7/18/12

**PLAT 150084**

**SPECIAL USE PERMIT REQUEST**  
 WE SUBMIT THIS SPECIAL USE PERMIT REQUEST TO ALLOW FOR DEVELOPMENT OF A FUEL STATION AND DRIVEWAY APPROX 8'x24'x12' E' ON THE SOUTH SIDE OF THE H-E-B STORE BUILDING. THE FUEL STATION WILL BE USED TO SERVE THE H-E-B STORE AND WILL BE OPERATED IN ACCORDANCE WITH ALL APPLICABLE REGULATIONS AND ORDINANCES. THE DRIVEWAY APPROX 8'x24'x12' E' WILL BE USED TO PROVIDE ACCESS TO THE FUEL STATION FROM THE H-E-B STORE. THE FUEL STATION AND DRIVEWAY APPROX 8'x24'x12' E' WILL BE OPERATED IN ACCORDANCE WITH ALL APPLICABLE REGULATIONS AND ORDINANCES.

**ADDRESS**  
 822 WEST ROAD, SUITE 100  
 SAN ANTONIO, TEXAS 78205

**OWNER/DEVELOPER**  
 HEB STORES, INC.  
 SAN ANTONIO, TEXAS

**PREPARED BY**  
 BURY ENGINEERING & ARCHITECTURE, P.C.  
 822 WEST ROAD, SUITE 100  
 SAN ANTONIO, TEXAS 78205

**DATE**  
 7/18/12

**PLAT 150084**

**SPECIAL USE PERMIT REQUEST**  
 WE SUBMIT THIS SPECIAL USE PERMIT REQUEST TO ALLOW FOR DEVELOPMENT OF A FUEL STATION AND DRIVEWAY APPROX 8'x24'x12' E' ON THE SOUTH SIDE OF THE H-E-B STORE BUILDING. THE FUEL STATION WILL BE USED TO SERVE THE H-E-B STORE AND WILL BE OPERATED IN ACCORDANCE WITH ALL APPLICABLE REGULATIONS AND ORDINANCES. THE DRIVEWAY APPROX 8'x24'x12' E' WILL BE USED TO PROVIDE ACCESS TO THE FUEL STATION FROM THE H-E-B STORE. THE FUEL STATION AND DRIVEWAY APPROX 8'x24'x12' E' WILL BE OPERATED IN ACCORDANCE WITH ALL APPLICABLE REGULATIONS AND ORDINANCES.

**ADDRESS**  
 822 WEST ROAD, SUITE 100  
 SAN ANTONIO, TEXAS 78205

**OWNER/DEVELOPER**  
 HEB STORES, INC.  
 SAN ANTONIO, TEXAS

**PREPARED BY**  
 BURY ENGINEERING & ARCHITECTURE, P.C.  
 822 WEST ROAD, SUITE 100  
 SAN ANTONIO, TEXAS 78205

**DATE**  
 7/18/12

**PLAT 150084**

**SPECIAL USE PERMIT REQUEST**  
 WE SUBMIT THIS SPECIAL USE PERMIT REQUEST TO ALLOW FOR DEVELOPMENT OF A FUEL STATION AND DRIVEWAY APPROX 8'x24'x12' E' ON THE SOUTH SIDE OF THE H-E-B STORE BUILDING. THE FUEL STATION WILL BE USED TO SERVE THE H-E-B STORE AND WILL BE OPERATED IN ACCORDANCE WITH ALL APPLICABLE REGULATIONS AND ORDINANCES. THE DRIVEWAY APPROX 8'x24'x12' E' WILL BE USED TO PROVIDE ACCESS TO THE FUEL STATION FROM THE H-E-B STORE. THE FUEL STATION AND DRIVEWAY APPROX 8'x24'x12' E' WILL BE OPERATED IN ACCORDANCE WITH ALL APPLICABLE REGULATIONS AND ORDINANCES.

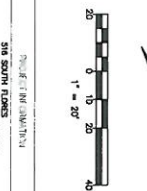

220150688 5