

LEGEND

	1/2" IRON PIN W/CAP SET
	CABLE BOX
	0.5' TELEPHONE PEDISTAL
	1/2" IRON PIN FOUND
	ELECTRICAL BOX
	1.0' TELEPHONE PEDISTAL
	WOODEN FENCE
	CHAIN LINK FENCE

MAP OF SURVEY
OF
BEING A 0.40 OF AN ACRE TRACT OF LAND OUT LOT THIRTEEN (13), BLOCK TWO (2), WICKS IOWA ADDITION AS RECORDED IN VOLUME 2575, PAGE 244, DEEDS AND PLATS RECORDS OF BEXAR COUNTY, TEXAS, BEING THE SAME TRACT OF LAND DESCRIBED AS THE WEST 100.0 FEET OF LOT 13, IN BLOCK 2, NEW CITY BLOCK 8067, OF SAN ANTONIO, IN BEXAR COUNTY, TEXAS, AS CONVEYED TO THE CITY OF SAN ANTONIO, TEXAS IN A DEED RECORDED IN VOLUME 3065, PAGE 522, DEEDS AND PLATS RECORDS OF BEXAR COUNTY, TEXAS

SURVEYED FOR: CAPITAL IMPROVEMENT MANAGEMENT SERVICES
ADDRESS: 815 EL MONTE BOULEVARD
DATE: 1-29-2014 SCALE: 1"=30'

- NOTES:**
1. BY GRAPHIC PLOTTING ONLY, THIS PROPERTY WAS SCALED TO BE IN ZONE "X" OF THE FLOOD INSURANCE RATE MAP COMMUNITY PANEL NO. 48029-C-0385-G WHICH BEARS A REVISED DATE OF SEPTEMBER 29, 2010. NO FIELD SURVEYING WAS PERFORMED TO DETERMINE THIS ZONE.
 2. BASIS OF BEARINGS ON THIS SURVEY ARE AS PER THE TEXAS STATE PLANE COORDINATE SYSTEM SOUTH CENTRAL ZONE (4204) NAD83 (03).
 3. THIS SURVEY WAS DONE WITHOUT THE BENEFIT OF A TITLE REPORT THEREFORE OTHER EASEMENTS MAY AFFECT THIS PROPERTY.
 4. EASEMENTS, RULES AND REGULATIONS BY LAW IN FAVOR OF RESPECTIVE IRRIGATION OR DRAINAGE DISTRICTS.

I, OSCAR HERNANDEZ, REGISTERED PROFESSIONAL LAND SURVEYOR NO. 5005, HEREBY CERTIFY THAT THE SURVEY DESCRIBED HEREIN WAS MADE ON THE GROUND ON THE 26TH DAY OF DECEMBER, 2013. THAT THE ONLY VISIBLE IMPROVEMENTS ON THE GROUND ARE AS SHOWN; THAT THERE ARE NO VISIBLE INTRUSIONS OR PROTRUSIONS, VISIBLE OVERLAPPIINGS, APPARENT CONFLICTS, OR VISIBLE EASEMENTS, EXCEPT AS SHOWN. THIS SURVEY SUBSTANTIALLY CONFORMS TO THE MINIMUM STANDARDS OF PRACTICE AS APPROVED BY THE TEXAS BOARD OF PROFESSIONAL LAND SURVEYORS.

OSCAR HERNANDEZ, R.P.L.S. # 5005

THIS SURVEY PLAT IS NOT VALID WITHOUT THE ORIGINAL SEAL AND SIGNATURE.

COPYRIGHT 2013

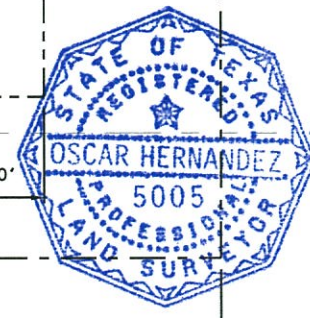

G D 115 E. TRAVIS ST. SUITE 1120
SAN ANTONIO, TX 78205
p:210.208.9400 f:210.208.9401
TBPE FIRM# 10015
TBPS FIRM# 10193922

GONZALEZ DE LA GARZA