

22018250

E EUCLID AVE

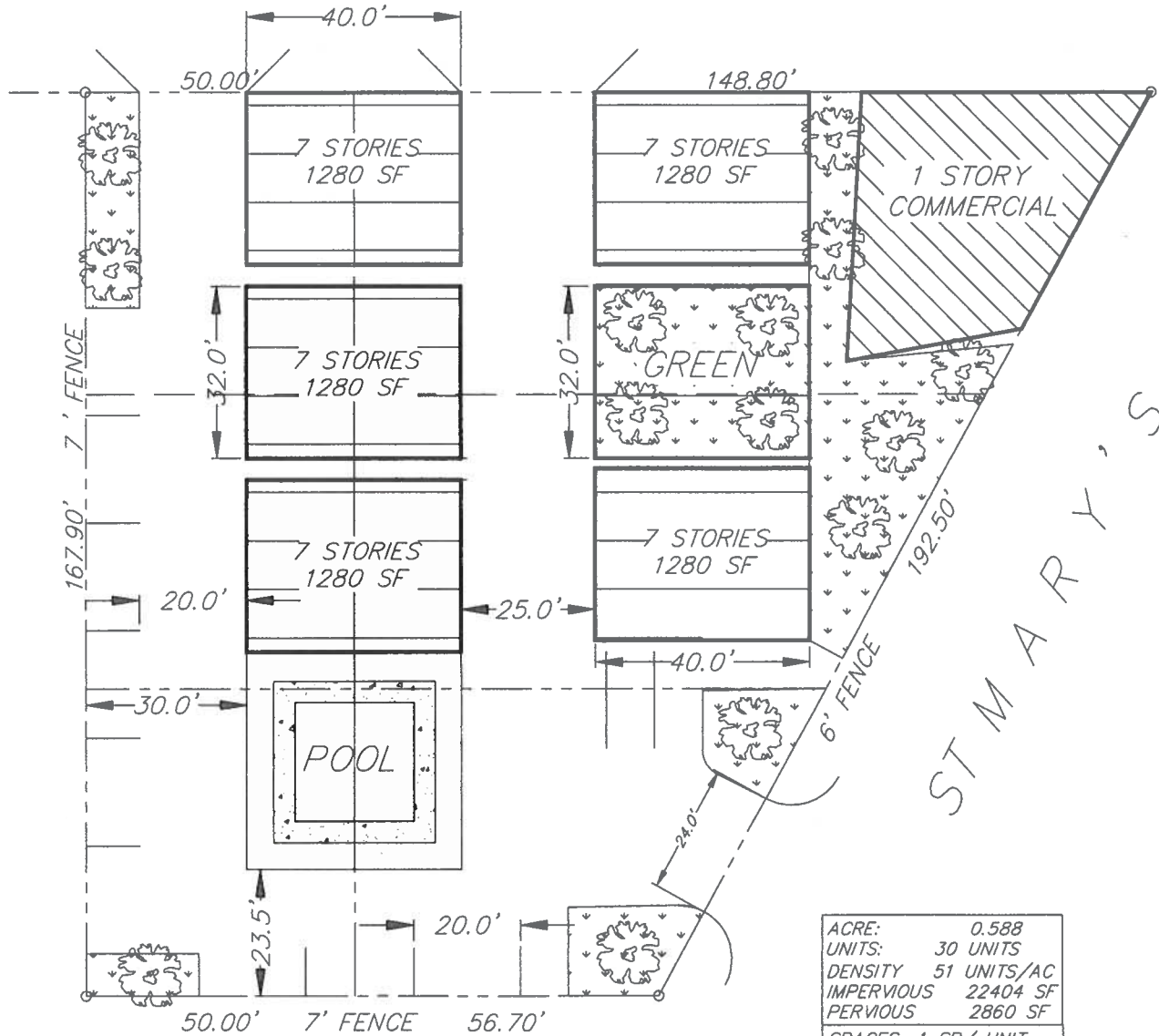

ACRE:	0.588
UNITS:	30 UNITS
DENSITY:	51 UNITS/AC
IMPERVIOUS:	22404 SF
PERVIOUS:	2860 SF
SPACES: 1 SP/ UNIT	
30 REQUIRED	
35 SPACES PROPOSED	
1ST LEVEL PARKING	

I Robert Melvin, the property owner, acknowledge that this site plan submitted for the purpose of rezoning this property in accordance with all applicable provisions of the United Development Code. Additionally, I understand that City Council approval of a site plan in conjunction with a rezoning case does not relieve me from adherence to any/all City adopted Codes at the time of plan submittal for building permits.

SCALE: 1:30
L7



GE Reaves Engineering
12508 Jones Maltsberger
San Antonio, Texas 78247
210-490-4506 F-4861
GRE-18-0490-1

ADDRESS: 1817 ST MARYS
Legal: NCB 829 BLK 3 LOT E IRR 148.3 OF
13,E IRR 118 OF 14,E IRR 88 FT OF 15
ADDRESS: 824 E EUCLID AVE
NCB 829 BLK 3 LOT W 50 FT OF 13, 14, & 15
INTENDED USE: MULTI-FAMILY CONDOMINIUMS