



**FIELD NOTES FOR A
0.032 ACRE TRACT**

OUT OF LOT 2, BLOCK 1, NCB 15828, CRASH PARTS OF TEXAS SUBDIVISION, SAN ANTONIO, BEXAR COUNTY, TEXAS, ACCORDING TO THE PLAT THEREOF RECORDED IN VOLUME 9533, PAGE 168 OF THE DEED AND PLAT RECORDS OF BEXAR COUNTY, TEXAS, AND BEING MORE PARTICULARLY DESCRIBED BY METES AND BOUNDS AS FOLLOWS:

- BEGINNING:** At a found ½" iron rod on the north right of way line of Rittiman Road (86' wide public right of way), having Texas State Plane South Central Zone grid coordinates of N=13,724,124.19 and E=2,165,665.40, the southeast corner of Lot 2 and of this tract;
- THENCE:** South 89°34'19" West (bearings are based on GPS observations, datum is NAD '88) 55.00' with the north right of way line of Rittiman Road to a found ½" iron rod, the southwest corner of Lot 2 and of this tract;
- THENCE:** North 00°25'41" West 25.00' to a set nail, the northwest corner hereof;
- THENCE:** South 89°34'19" East 55.00' to a set nail, the northeast corner of this tract;
- THENCE:** South 00°25'41" East 25.00' to the POINT OF BEGINNING of this 0.032 acre (1,375 square feet) tract in the City of San Antonio, Bexar County, Texas.

Gary A. Gibbons

Gary A. Gibbons, R.P.L.S. #4716
Date: January 1, 2021
Doc I.D.: fnRittimanA
GAG/fc

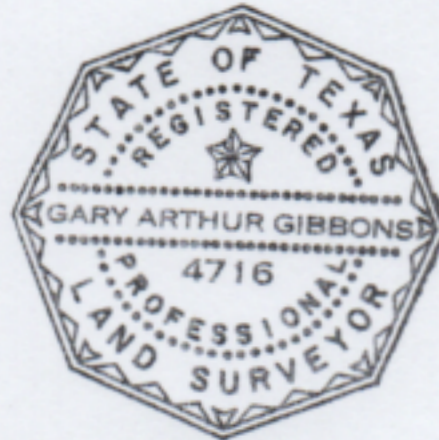

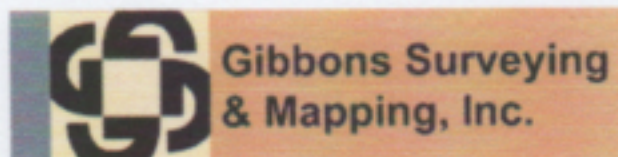

Z2020-10700297

**FIELD NOTES FOR A
0.861 ACRE TRACT**

OUT OF LOT 2, BLOCK 1, NCB 15828, CRASH PARTS OF TEXAS SUBDIVISION, SAN ANTONIO, BEXAR COUNTY, TEXAS, ACCORDING TO THE PLAT THEREOF RECORDED IN VOLUME 9533, PAGE 168 OF THE DEED AND PLAT RECORDS OF BEXAR COUNTY, TEXAS, AND BEING MORE PARTICULARLY DESCRIBED BY METES AND BOUNDS AS FOLLOWS:

- BEGINNING:** At a set nail having Texas State Plane South Central Zone grid coordinates of N=13,724,605.02 and E=2,165,606.80, the southwest corner of this tract, from which a found ½" iron rod on the north right of way line of Rittiman Road marking the southwest corner of Lot 2 bears South 00°25'41" East (bearings are based on GPS observations, datum is NAD '88) 481.26';
- THENCE:** North 00°25'41" West 100.00' to a found ½" iron rod, the northwest corner of Lot 2 and of this tract;
- THENCE:** North 89°34'19" East 375.00' to a found ½" iron rod, the northwest corner of Lot 2 and of this tract;
- THENCE:** South 00°25'41" East 100.00' to a set nail, the southeast corner of this tract;
- THENCE:** South 89°34'19" West 375.00' to the POINT OF BEGINNING of this 0.861 acre (37,500 square feet) tract in the City of San Antonio, Bexar County, Texas.

THESE FIELD NOTES TOGETHER WITH A SURVEY MAP WERE PREPARED FROM AN ACTUAL SURVEY MADE ON THE GROUND BY EMPLOYEES OF GIBBONS SURVEYING & MAPPING, INC. WHO WERE WORKING UNDER MY SUPERVISION AND DIRECTION.

Gary A. Gibbons

Gary A. Gibbons, R.P.L.S. #4716
Date: January 1, 2021
Doc I.D.: fnRittimanB
GAG/fc

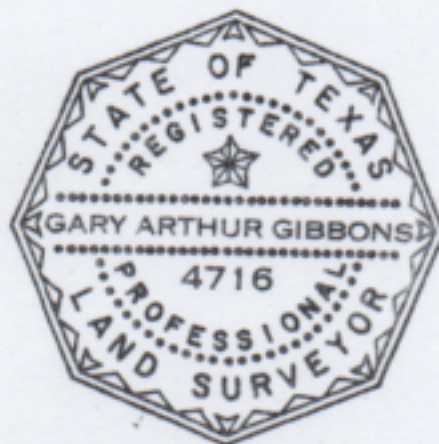

GIBBONS SURVEYING & MAPPING, INC.
PO Box 700576, San Antonio, TX 78216
(210) 861-5909 GaryGibbonsRPLS@gmail.com
TBPLS Firm No. 10119900



**FIELD NOTES FOR A
0.184 ACRE TRACT**

OUT OF LOT 1, BLOCK 1, NCB 15828, CRASH PARTS OF TEXAS SUBDIVISION, SAN ANTONIO, BEXAR COUNTY, TEXAS, ACCORDING TO THE PLAT THEREOF RECORDED IN VOLUME 9533, PAGE 168 OF THE DEED AND PLAT RECORDS OF BEXAR COUNTY, TEXAS, AND BEING MORE PARTICULARLY DESCRIBED BY METES AND BOUNDS AS FOLLOWS:

- BEGINNING: At a found 1/2" iron rod on the north right of way line of Rittiman Road (86' wide public right of way), having Texas State Plane South Central Zone grid coordinates of N=13,724,124.19 and E=2,165,665.40, the southwest corner of Lot 1 and of this tract;
- THENCE: North 00°25'41" West (bearings are based on GPS observations, datum is NAD '88) 25.00' to a set nail, the northwest corner hereof;
- THENCE: North 89°34'19" East 320.00' to a set nail, the northeast corner hereof;
- THENCE: South 00°25'41" East 25.00' to a set nail on the aforementioned north right of way line of Rittiman Road, the southeast corner of Lot 1 and of this tract;
- THENCE: With the north right of way line of Rittiman Road, South 89°34'19" West 320.00' to the POINT OF BEGINNING of this 0.184 acre (8,000 square feet) tract in the City of San Antonio, Bexar County, Texas.

THESE FIELD NOTES TOGETHER WITH A SURVEY MAP WERE PREPARED FROM AN ACTUAL SURVEY MADE ON THE GROUND BY EMPLOYEES OF GIBBONS SURVEYING & MAPPING, INC. WHO WERE WORKING UNDER MY SUPERVISION AND DIRECTION.

Gary A. Gibbons

Gary A. Gibbons, R.P.L.S. #4716
Date: January 2, 2021
Doc I.D.: fnRittiman
GAG/fc

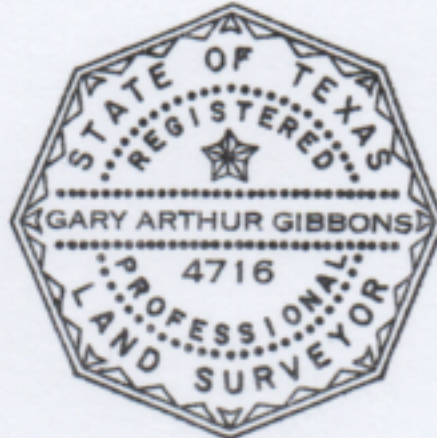

GIBBONS SURVEYING & MAPPING, INC.
PO Box 700576, San Antonio, TX 78216
(210) 861-5909 GaryGibbonsRPLS@gmail.com
TBPLS Firm No. 10119900