

22616043

SITE DATA

TOTAL LAND AREA 100%
 TOTAL BUILDING AREA 4.65%
 LANDSCAPE AREA 5.07%
 IMPERVIOUS AREA 28.54%
 YARD AREA (PERVIOUS) 61.74%

15.081 ACRES (656,923 SF)
 30,556 SF
 33,315 SF
 187,495 SF
 405,557 SF

PARKING

PARKING SPACE TYPE
 REQUIRED MINIMUM
 REQUIRED MAXIMUM
 ADA ASSESSABLE PARKING
 TOTAL

10'-0" (W) X 20'-0" (D)
 68
 131
 4
 124

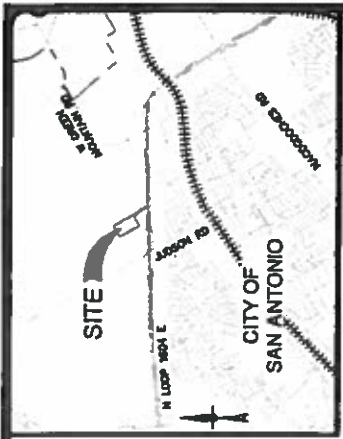

LOCATION MAP
NOT TO SCALE

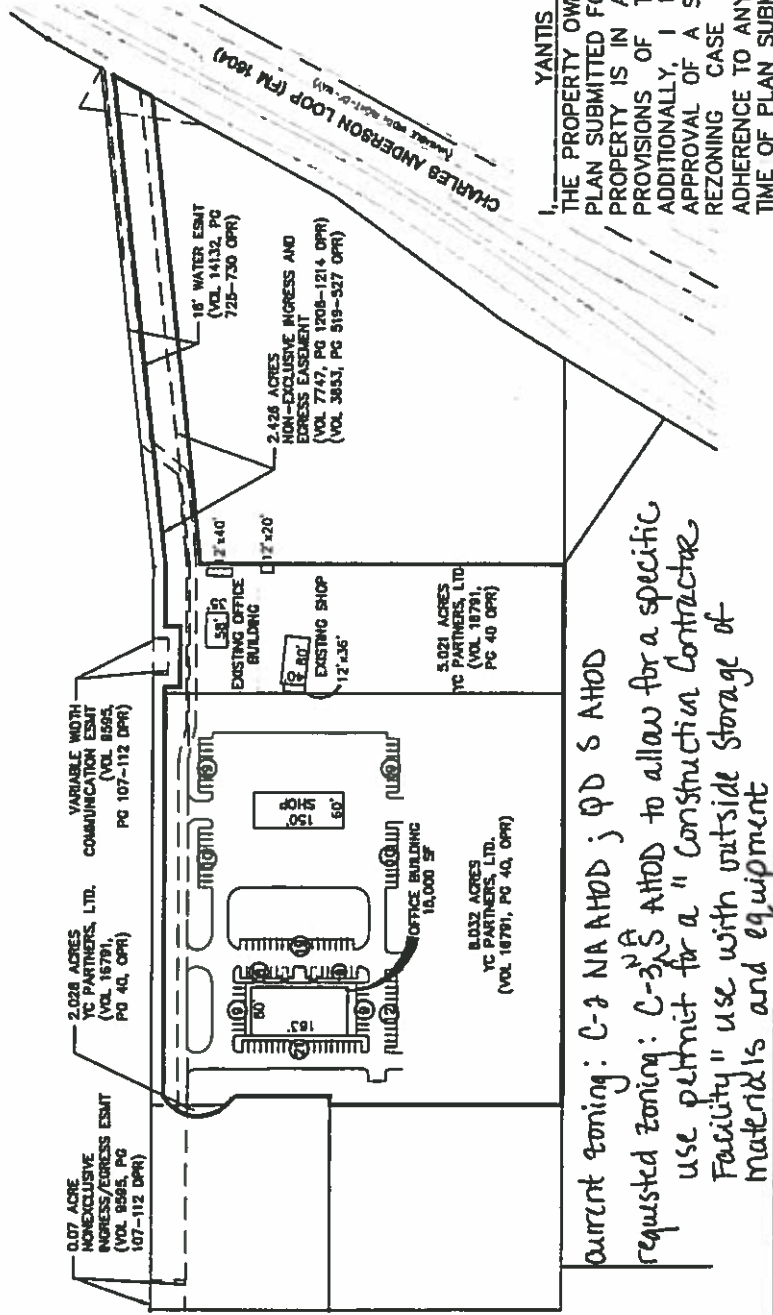

YANTIS COMPANY
 THE PROPERTY OWNER, ACKNOWLEDGE THAT THIS SITE PLAN SUBMITTED FOR THE PURPOSE OF REZONING THIS PROPERTY IS IN ACCORDANCE WITH ALL APPLICABLE PROVISIONS OF THE UNIFIED DEVELOPMENT CODE. ADDITIONALLY, I UNDERSTAND THAT CITY COUNCIL APPROVAL OF A SITE PLAN IN CONJUNCTION WITH A REZONING CASE DOES NOT RELIEVE ME FROM ADHERENCE TO ANY/ALL CITY-ADOPTED CODES AT THE TIME OF PLAN SUBMITTAL FOR BUILDING PERMITS.

Current zoning: C-2 NA AHOD ; QD S AHOD
 requested zoning: C-3A S AHOD to allow for a specific use permit for a "Construction Contractor Facility" use with outside storage of materials and equipment

YANTIS COMPANY SHOP
 SAN ANTONIO, TEXAS
 ZONING SITE PLAN

JOB NO. 5881-00
 DATE NOVEMBER 2015
 DESIGNER BL
 CHECKED *** DRAWN/KE
 SHEET 1 of 1

PAPE-DAWSON ENGINEERS
 2500 HWY LOOP 410 | SAN ANTONIO, TEXAS 78213 | PHONE: 210.775.0000
 TEXAS BOARD OF PROFESSIONAL ENGINEERS (PE) REGISTRATION # 478
 TEXAS BOARD OF PROFESSIONAL LAND SURVEYORS (PLS) REGISTRATION # 165024

THIS DOCUMENT HAS BEEN PROVIDED FROM MURAL. THAT HAS SAVED MONEY. UNWANTED ELECTRONICALLY AND MAY HAVE BEEN MODIFIED. PLEASE BE CAREFUL OF ORIGINALS. BLDG. AND S.A.