

1) BUILDING SET BACK ----- 8.5'L

"GENERAL NOTES"



LEGEND

- ASPHALT
- DRIVEWAY
- WALK
- TREE
- MANHOLE

1. TOTAL ACRES 0.78 AC.
2. TOTAL NUMBER OF LOTS 3
3. TOTAL OPEN SPACE 0.23 AC.
4. TOTAL IMPROVEDS COVER 0.25 AC.
5. TOTAL FLOOR AREA OF BUILDING 3,000 SF
6. SO. FOOTAGE OF PAVED AREA, CURBS, SIDEWALKS AND BUILDING 2,412.50 SF

NOTE:
 THE PROPERTY IS CURRENTLY UNIMPROVED AND THE PROPOSED USE IS FOR OFFICE USE. AT SOME TIME IN THE FUTURE THE PROPERTY MAY BE USED FOR OTHER PURPOSES. THE PROPOSED USE IS FOR OFFICE USE. AT SOME TIME IN THE FUTURE THE PROPERTY MAY BE USED FOR OTHER PURPOSES.

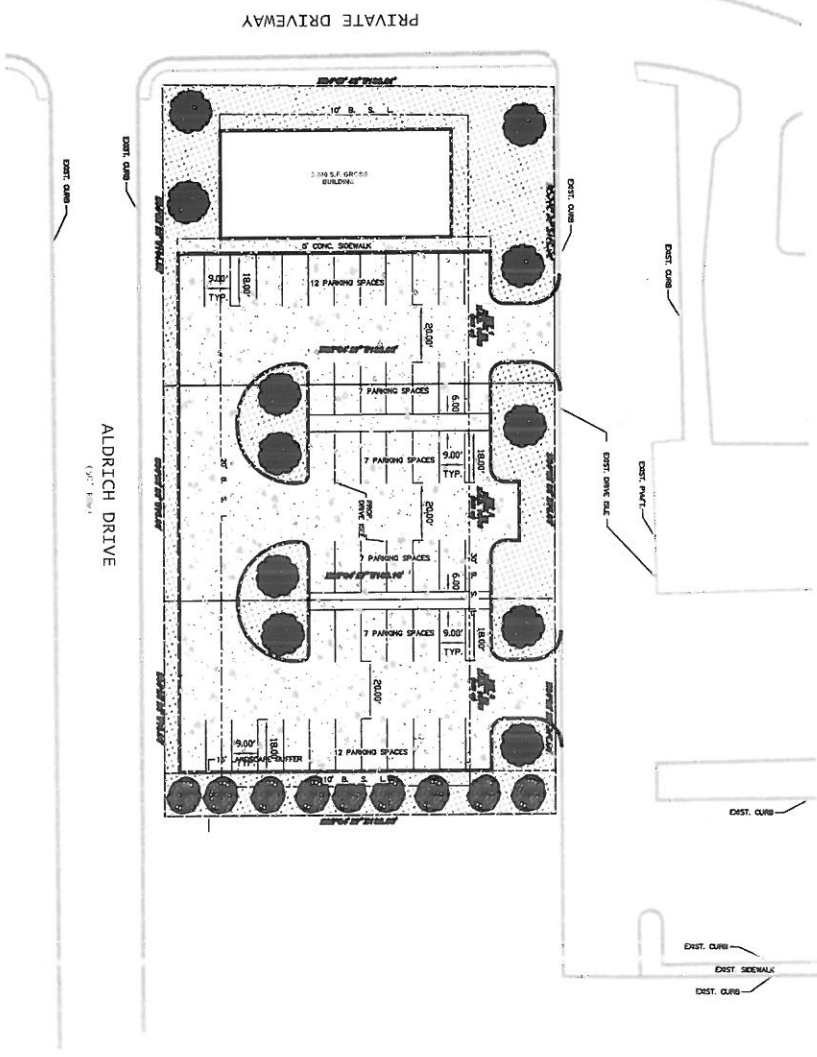

THE FOLLOWING STATEMENT IS MADE BY THE PROPERTY OWNER, XAVIER A. TORRES, IN CONNECTION WITH THE SUBMITTAL OF THIS ZONING EXHIBIT FOR THE JESCO DEVELOPMENT. THE PROPERTY OWNER HAS BEEN ADVISED OF THE APPLICABLE PROVISIONS OF THE LATEST DEVELOPMENT CODE, ADRICH TOWNSHIP, AND HAS AGREED TO COMPLY WITH THE SAME. THE PROPERTY OWNER HAS BEEN ADVISED OF THE APPLICABLE PROVISIONS OF THE LATEST DEVELOPMENT CODE, ADRICH TOWNSHIP, AND HAS AGREED TO COMPLY WITH THE SAME. THE PROPERTY OWNER HAS BEEN ADVISED OF THE APPLICABLE PROVISIONS OF THE LATEST DEVELOPMENT CODE, ADRICH TOWNSHIP, AND HAS AGREED TO COMPLY WITH THE SAME.

THE FOLLOWING STATEMENT IS MADE BY THE PROPERTY OWNER, XAVIER A. TORRES, IN CONNECTION WITH THE SUBMITTAL OF THIS ZONING EXHIBIT FOR THE JESCO DEVELOPMENT. THE PROPERTY OWNER HAS BEEN ADVISED OF THE APPLICABLE PROVISIONS OF THE LATEST DEVELOPMENT CODE, ADRICH TOWNSHIP, AND HAS AGREED TO COMPLY WITH THE SAME. THE PROPERTY OWNER HAS BEEN ADVISED OF THE APPLICABLE PROVISIONS OF THE LATEST DEVELOPMENT CODE, ADRICH TOWNSHIP, AND HAS AGREED TO COMPLY WITH THE SAME. THE PROPERTY OWNER HAS BEEN ADVISED OF THE APPLICABLE PROVISIONS OF THE LATEST DEVELOPMENT CODE, ADRICH TOWNSHIP, AND HAS AGREED TO COMPLY WITH THE SAME.

SHEET 1 OF 1
 ZONING

ZONING EXHIBIT FOR
 JESCO DEVELOPMENT
 183, 179, & 175 ALDRICH
 SAN ANTONIO, TEXAS

NO.	DATE	DESCRIPTION	BY



DATE: JAN. 07, 2016
 DESIGNED BY: X.A.T.
 DRAWN BY: J.D.C.
 CHECKED BY: X.A.T.
 V.E. 1" = 50'
 X. TORRES

TORRES ENGINEERING P.C.
 5005 CHISHOLM RD., STE. 101 (210) 680-0500
 SAN ANTONIO, TEXAS 78256