

Z-2019-10700290

Request for IDZ--3 Rio-2 DN GC-2 with uses permitted in C-3 and O-2

# EXHIBIT A1

I, OC Partners LLC, the property owner, acknowledge that this site plan submitted for the purpose of rezoning this property is in accordance with all applicable provisions of the Unified Development Code. Additionally, I understand that City Council approval of a site plan in conjunction with a rezoning case does not relieve me from adherence to any/all City-adopted Codes at the time of plan submittal for building permits.

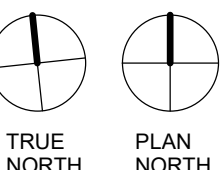

# EXHIBIT A2

Z. 2019-10700290  
Request for IDZ-3 Rio-2 DN GC-2 with uses permitted in C-3 and O-2  
I, OC Partners LLC, the property owner, acknowledge that this site plan submitted for the purpose of rezoning this property is in accordance with all applicable provisions of the United Development Code. Additionally, I understand that City Council approval of a site plan in conjunction with a rezoning case does not relieve me from adherence to any/all City-adopted Codes at the time of plan submittal for building permits.

Page 2 of 2

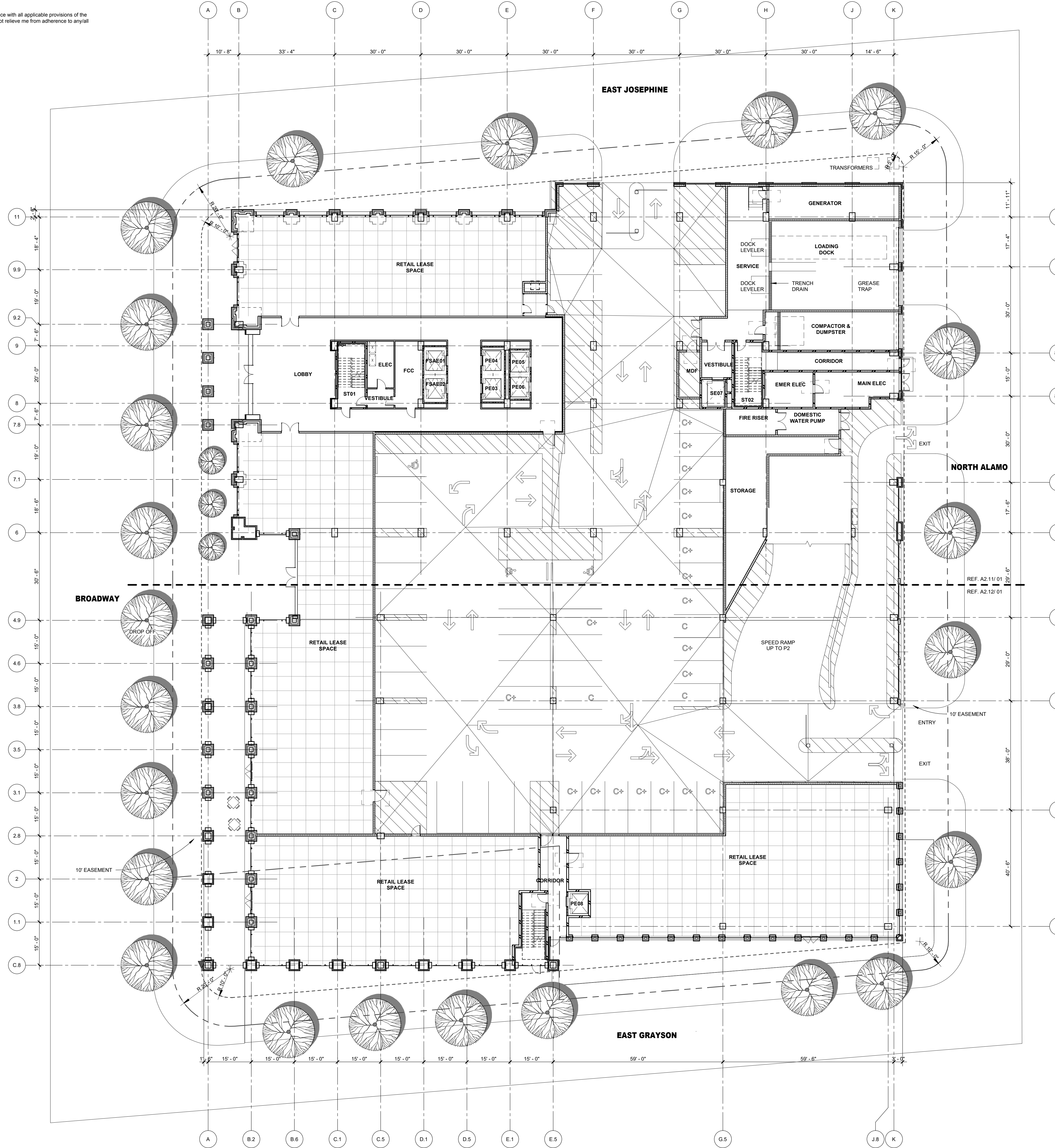

**01 ARCHITECTURAL SITE PLAN**  
1/16" = 1'-0"  
TRUE NORTH PLAN NORTH  
GRAPHIC SCALE 1/16" = 1'-0"  
0 4' 8' 16' 32'

# HKS

**ARCHITECT**  
HKS, INC.  
350 N SAINT PAUL ST, SUITE 1100  
DALLAS, TX 75201-4240

**STRUCTURAL**  
BROCKETTE DAVIS DRAKE, INC.  
4144 NORTH CENTRAL EXPRESSWAY, SUITE 1100  
DALLAS, TEXAS 75204

**MEP/FP CONSULTANT**  
PURDY+ACQUIRE, INC.  
BENT TREE GREEN  
17300 DALLAS PARKWAY, SUITE 3000  
DALLAS, TEXAS 75248

**LIGHTING CONSULTANT**  
SCOTT OLDNER LIGHTING DSIGN, LLC  
4645 GREENVILLE AVENUE, STUDIO B  
DALLAS, TEXAS 75246

**GRAPHICS CONSULTANT**  
XXX  
XXX  
DALLAS, TEXAS XXXXX

**ELEVATOR CONSULTANT**  
PERSONHORN ASSOCIATES, INC.  
8612 BROAD MEADOW LANE  
MCKINNEY, TEXAS 75071

**1990 BROADWAY**  
SAN ANTONIO, TX  
Jefferson Bank

**MILAM REAL ESTATE CAPITAL, LLC**

**OWNER**  
MILAM REAL ESTATE CAPITAL LLC  
250 W. NOTTINGHAM, SUITE 410  
SAN ANTONIO, TEXAS 78209

**OWNER'S CONSULTANTS**

**DESIGNER**  
DON B. McDONALD, ARCHITECT  
2121 NORTH MAIN AVENUE  
SAN ANTONIO, TEXAS 78212

**CIVIL CONSULTANT**  
KFW ENGINEERS  
3421 PAESANOSPARKWAY  
SAN ANTONIO, TEXAS 78231

**LANDSCAPE CONSULTANT**  
OPEN AIR STUDIO  
2722 W. BITTERS RD, SUITE 114  
SAN ANTONIO, TEXAS 78248

**PARKING CONSULTANT**  
KIMLEY - HORN  
601 NW LOOP 410, SUITE 350  
SAN ANTONIO, TEXAS 78216

**ENVELOPE CONSULTANT**  
TERRACON CONSULTANTS, INC.  
6911 BLANCO ROAD  
SAN ANTONIO, TEXAS 78216

**INTERIM REVIEW ONLY**  
These documents are incomplete, and are released for interim review only and are not intended for regulatory approval, permit, or construction purposes.  
Architect: XXXXXX  
Arch. Reg. No.: XXXXX  
Date: XXXXXXXX

KEY PLAN

REVISION NO.	DESCRIPTION	DATE

HKS PROJECT NUMBER  
**21565.002**  
DATE  
**10/24/19**  
ISSUE

SHEET TITLE  
**ARCHITECTURAL SITE PLAN**

SHEET NO.  
**A1.00**