

Pearl District Townhomes

Preliminary Site Plan
December 28, 2015

Current Zoning: C-1
Proposed Zoning: IDZ
with Single-Family Homes not to exceed 33 units per acre

Project Data	
Land Area:	0.47 Ac.
Total Units:	13
Units Per Ac:	27.7
On-site Parking	26
Guest Parking	5

Unit Mix & Square Footage			
Unit	SF	Qty	Total SF
A	1575	8	12,600
B	1575	5	7,875
Total		13	20,475

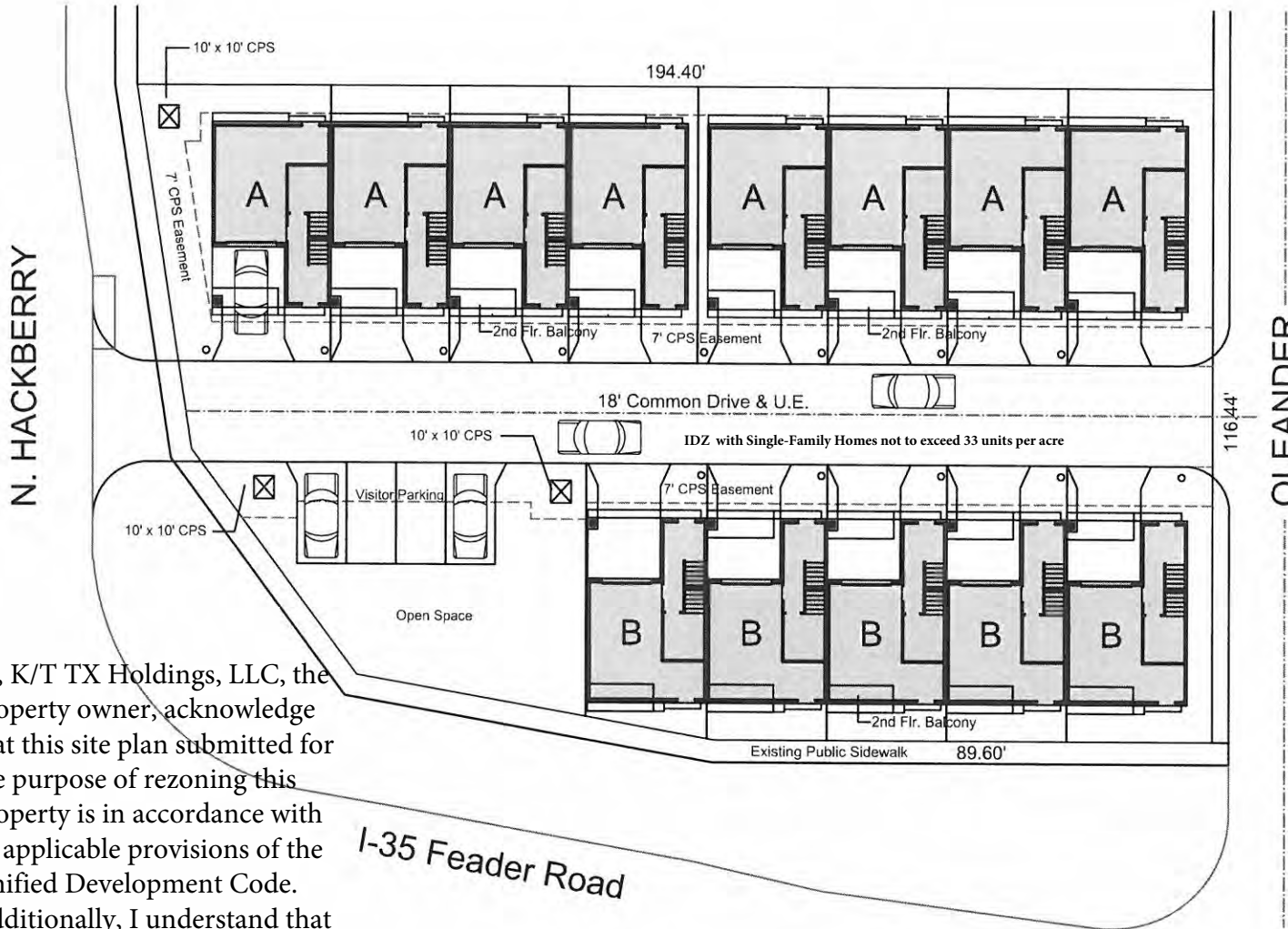

“I, K/T TX Holdings, LLC, the property owner, acknowledge that this site plan submitted for the purpose of rezoning this property is in accordance with all applicable provisions of the Unified Development Code. Additionally, I understand that City Council approval of a site plan in conjunction with a rezoning case does not relieve me from adherence to any/all City-adopted Codes at the time of plan submittal for building permits.”

Z2016187