

PLEASE RECYCLE

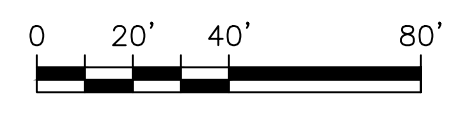

CAUTION:
CONTRACTOR TO VERIFY ALL EXISTING UTILITIES VERTICALLY AND HORIZONTALLY PRIOR TO CONSTRUCTION. CONTRACTOR TO NOTIFY THE ENGINEER IMMEDIATELY OF ANY DISCREPANCIES. THE ENGINEER ASSUMES NO RESPONSIBILITY FOR THE ACCURACY OF THE LOCATION OF UNDERGROUND UTILITIES. THE CONTRACTOR SHALL BE RESPONSIBLE FOR AVOIDING ALL EXISTING UTILITIES BY CALLING DIGTESS @ 1-800-DIG-TESS FOR LOCATION OF ALL UTILITIES, AT LEAST 2 WORKING DAYS PRIOR TO BEGINNING CONSTRUCTION.

NO.	DATE	REVISION

BIG RED DOG
ENGINEERING & CONSULTING
SAN ANTONIO, TEXAS 78249 • TEXAS REG. NO. F-13847

PRELIMINARY
NOT FOR CONSTRUCTION,
BIDDING, OR PERMIT
PURPOSES.

PREPARED UNDER THE
SUPERVISION OF
ROBERT R. DELGADO,
P.E. #95644 ON

PROJECT:
210 - ST. JOHN'S SEMINARY MIXED USE
222 E. MITCHELL STREET
SAN ANTONIO, BEXAR COUNTY, TX 78210

SHEET TITLE:
OVERALL CIVIL SITE PLAN

CLIENT: 210 DEVELOPMENT
DRAWN BY: MWT
DESIGNER: RRD
REVIEWER: RRD
B.R.D. PROJECT: 028.008

SHEET:
CS101
08 OF 25

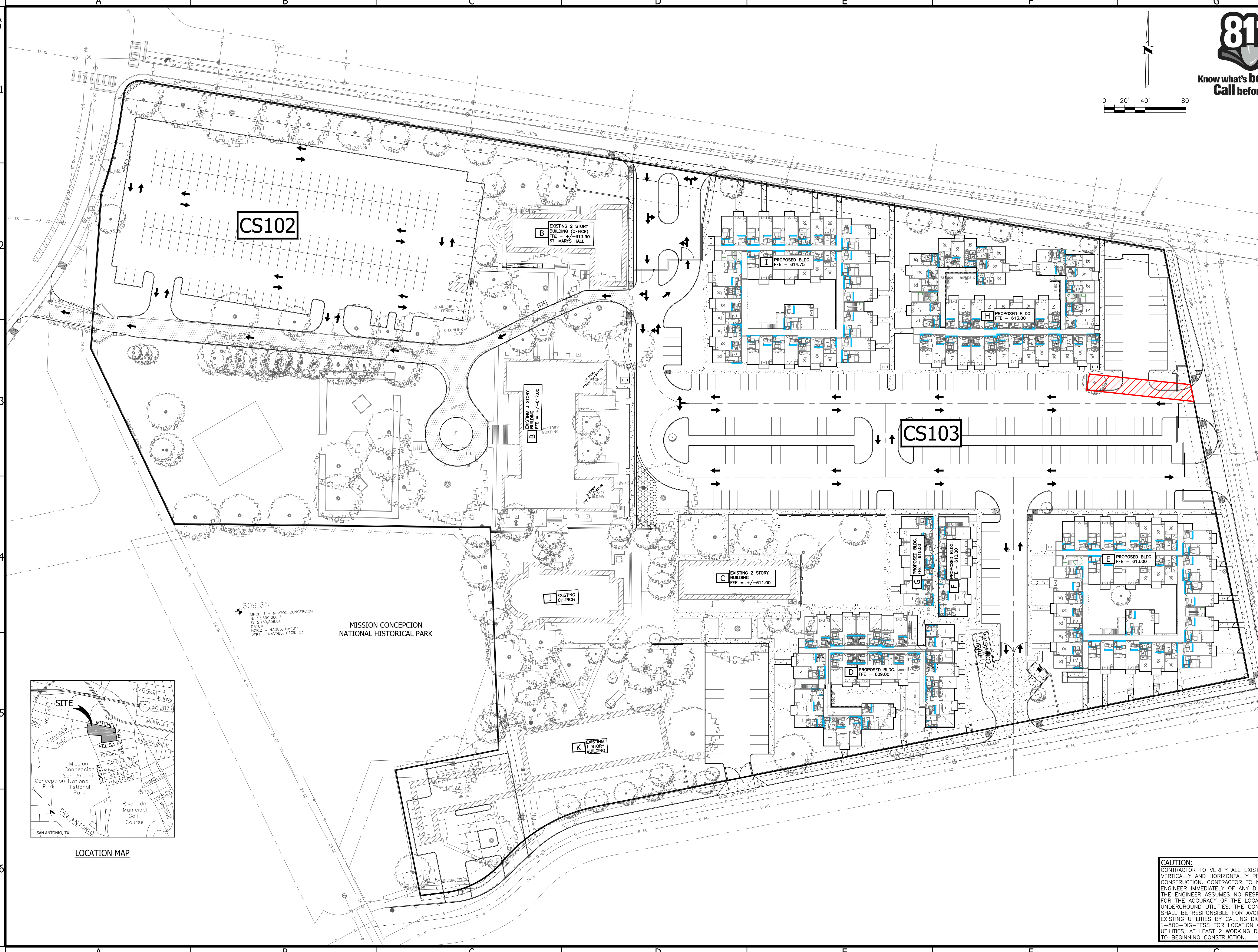

028.008 CS101 CIVIL SITE PLAN
Last Modified: Oct. 26, 16 10:59
C:\Users\john\Documents\028.008 CS101 CIVIL SITE PLAN.dwg

Xref: W:\Projects\210 Development\028 - St. John's Seminary\CS101 - Civil Site Plan.dwg
W:\Projects\210 Development\028 - St. John's Seminary\CS101 - Civil Site Plan.dwg
W:\Projects\210 Development\028 - St. John's Seminary\CS101 - Civil Site Plan.dwg
W:\Projects\210 Development\028 - St. John's Seminary\CS101 - Civil Site Plan.dwg

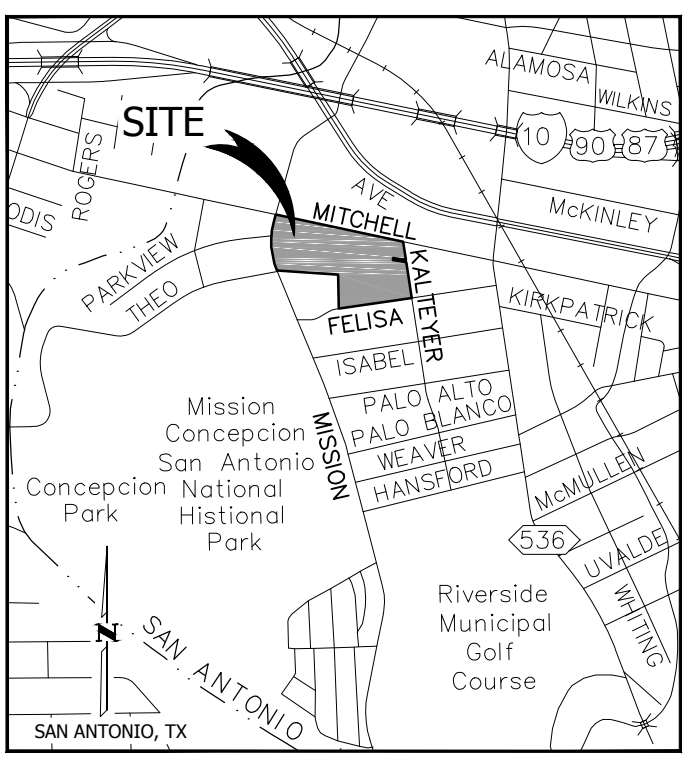

LOCATION MAP

609.65
MPOD-1 - MISSION CONCEPCION
N: 13,690,086.31
E: 2,353,359.41
DATUM: NAD83, NAD2011
NORTH: NAVD83, GEOD 03
EAST: NAVD83, GEOD 03

MISSION CONCEPCION NATIONAL HISTORICAL PARK