

Data Source: City of San Antonio Enterprise GIS, Bexar Metro 911, Bexar Appraisal District  
 The Geographic Information System Product received from The City of San Antonio is provided "as is" without warranty of any kind, and the City of San Antonio expressly disclaims all express and implied warranties, including but not limited to the implied warranties of merchantability and fitness for a particular purpose. The City of San Antonio does not warrant, guarantee, or make any representations regarding the use, or the results of the use, of the information provided to you by the City of San Antonio in terms of correctness, accuracy, reliability, timeliness or otherwise. The entire risk as to the results and performance of any information obtained from the City of San Antonio is entirely assumed by the recipient. Please contact the responsible City of San Antonio Department for specific system information.  
 City of San Antonio Planning Department (210) 207-1272

Map Created by: Gustavo Gutierrez  
 Map Creation Date: 8/14/2017  
 Map File Location: \\V:\rchived\Neighborhoods\Land\_Use\Amendments\Amend\_17073\_GovHill\_B&W.mxd  
 PDF Filename: Amend\_17073\_GovHill\_B&W.pdf

-  200' Notification Area
-  Subject Property
-  VIA Bus Stops
-  VIA Bus Routes

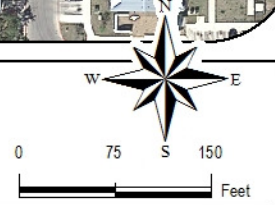

# Government Hill Neighborhood Plan

## 2016 Aerial

**City of San Antonio**  
 Planning and Community  
 Development Department  
 John M. Dugan, AICP  
 Director  
 Development Business  
 Service Center  
 PO BOX 539975  
 San Antonio, TX 78253

