

**McCauley Ranch – Division One
Legal Description**

Being 317.157 acres of land, known as Division No. One, lying and being situated on and east of graveled County Road No. 336, northwest of Sabinal, in Uvalde County, Texas; about 21.8 miles N 25° E of the City of Uvalde, the County Seat; and containing acreages in the various original Surveys, as follows:

Sur. No.	Original Grantee	Abst. No.	Acres
267	Saragossa Irr. & Mfg. Co.	591	0.776
271	G.B. & C.N.G. R.R. Co.	574	0.483
314	C.C.S.D. & R.G.N.G. R.R. Co.	1317	137.097
863	Mrs. Rebecca Tate	1062	1.740
1524	Luis Castanon	129	166.422
-----	Un-surveyed State Land	-----	<u>10.639</u>
	Total Acres.....		<u>317.157</u>

said 317.157 acres being more particularly described by metes and bounds attached hereto and made a part hereof for all purposes.

KOCH & KOCH LAND SURVEYORS, INC.
P.O. BOX 246 707 FM 1796 D'HANIS, TEXAS 78850
Office: 830-363-7331 Fax: 830-363-7441
E-Mail: kochkoch@swtexas.net

SHARON ANNE McCAULEY
"DIVISION NO. ONE"
317.157 ACRE TRACT

THE STATE OF TEXAS)
COUNTY OF UVALDE)

Field Notes of a perimeter/boundary survey of a 317.157 acre tract of land, made for Sharon Anne McCauley and The Nature Conservancy.

Said 317.157 acre tract of land, known as Division No. One, lying and being situated on and east of gravelled County Road No. 336, northwest of Sabinal, in Uvalde County, Texas; about 21.8 miles N 25° E of the City of Uvalde, the County Seat; and containing acreages in the various original Surveys, as follows:

Sur. No.	Original Grantee	Abst. No.	Acres
267	Saragossa Irr. & Mfg. Co.	591	0.776
271	G.B. & C.N.G. R.R. Co.	574	0.483
314	C.C.S.D. & R.G.N.G. R.R. Co.	1317	137.097
863	Mrs. Rebecca Tate	1062	1.740
1524	Luis Castanon	129	166.422
---	Un-surveyed State Land	----	<u>10.639</u>
Total Acres			317.157

Said 317.157 acre tract of land being all of a 50.000 acre tract (west portion of a 317.157 acre tract termed "Division No. One"), as conveyed to Sharon Anne McCauley, by Doris Esther Story and Kempner Davlin Story, Jr., by Gift Deeds (2) dated November 5, 2008, and recorded in Instrument Nos. 2008004315 and 2008004318, of the Official Public Records of said County, and all of a 267.157 acres (remainder of said 317.157 acre tract termed "Division No. One"), as conveyed to Sharon Anne McCauley, by Kempner Davlin Story, Jr. and Doris Esther Story, by Gift Deeds (2) dated July 8, 2011, and recorded in Instrument Nos. 2011002072 and 2011002078, of the Official Public Records of said Uvalde County, Texas. Said 317.157 acre tract being bounded on the south/southwest, from east to west, by the following: 1.) the Henry B. Martin, et al. Property, as recorded in Vol. 302, Pages 710-726 & Vol. 309, Pages 156-168, both of the Deed Records of said County, and Instrument No. 2012004426 of the Official Public Records of said County; 2.) the Leonard M. Bond 192.20 acre tract, as recorded in Vol. 237, Pages 190-194, of the

Cont. Page 2 of 6, Sharon Anne McCauley -- 317.157 Acre Tract.

Deed Records of said County; 3.) the Kempner Davlin "Bill" Story, Jr. 18.203 acre house tract [this date surveyed -- south middle portion of the Story "called" 1906.75 acres -- Vol. 262, Pages 414-417, Deed Records and Vol. 368, Pages 714-717, Official Public Records]; and 4.) the Elizabeth Jean Howard 317.157 acre tract [termed "Division No. Two" -- Instrument Nos. 2008004314, 2008004319, 2011002073, & 2011002079, Official Public Records]; on the west/northwest by the said Elizabeth Jean Howard 317.157 acre tract, and a 2.933 acre "Spring Area" tract (this date surveyed -- middle portion of said Story "called" 1906.75 acres); on the north by the John McNair Family 2012 Irrevocable Trust (McNair) 782.710 acre tract, as recorded in Instrument No. 2012004443, of the Official Public Records of said Uvalde County; and on the east/southeast, from north to south, by the said John McNair Family 2012 Irrevocable Trust 782.710 acre tract, and the said Henry B. Martin, et al. Property. Said 317.157 acre tract fully encompassing the Kenneth and Sharon McCauley log house and improvements, with no overlapping thereof, and being more fully described by metes and bounds, as follows:

BEGINNING (in said Sur. No. 271) at a 5/8" Steel Pin found at a 2-way fence corner post, at a northwest re-entrant corner of said Martin Property; for the S.S.E. corner of said McCauley 317.157 acre tract, and the S.S.E. corner of this tract; said 5/8" Steel Pin being distant 652.13 ft. S 85° 41' 50" E of the common corner of the following three original Surveys, viz.: the N.E. corner of said Sur. No. 267, the S.S.W. corner of said Sur. No. 314, and the N.W. corner of said Sur. No. 271;

THENCE with fence (unless noted); with the north/northeast sides of said Martin Property and said Bond 192.20 acre tract, the southeast and north sides of said 18.203 acre house tract, and a northeast side of said Howard 317.157 acre tract, respectively; with the south/southwest sides of said McCauley 317.157 acre tract, and the south/southwest sides of this tract; with 5/8" Steel Pins (unless otherwise noted) set at fence corner posts, at corners, as follows:

N 86° 47' 19" W 649.47 ft. to a 5/8" Steel Pin found at a cut-off 2-way fence corner post, for corner; said 5/8" Steel Pin being distant 12.68 ft. S 08° 20' 41" E of the above-mentioned original Survey corner;

N 62° 18' 52" W, at 6.62 ft. cross the upper west line of said Sur. No. 271, the east line of said Sur. No. 267; total 621.83 ft. to a 5/8" Steel Pin found at a fence corner post, for corner;

N 62° 00' 10" W 153.05 ft. to an "X" found chiseled in rock, 1.3 ft. N 61° W of a 2-7/8" Steel Pipe 3-way fence corner post,

at a N.W. corner of said Martin Property, the N.E. corner of said Bond 192.20 acre tract, for corner;

N 56° 42' 17" W 491.03 ft. to the center of a 7" cedar 3-way fence corner post found in concrete, at the southeast corner of a field, for corner;

N 56° 32' 07" W, at 201.54 ft. cross the north line of said Sur. No. 267, the south line of said Sur. No. 1524, and thence diverging slightly northerly of said survey line; total 344.96 ft. to the center of a 4" Steel Pipe 2-way fence corner post, for corner;

N 61° 52' 46" W, converging southerly toward said survey line, 275.32 ft. to the center of a 4" Steel Pipe 2-way fence corner post, in said survey line, for corner;

N 50° 33' 41" W, leaving said survey line, 350.95 ft. to a Steel Pipe 3-way fence corner post, at the easternmost south corner of said 18.203 acre house tract, for corner;

N 45° 10' 10" E, with the southeast side of said house tract, crossing said field, 743.78 ft. to the center of a 16" Live Oak tree fence corner, at a corner of said 18.203 acre house tract;

N 05° 12' 39" E 28.00 ft. to the center of a 15" Live Oak tree 2-way fence corner, at the easternmost corner of said 18.203 acre house tract;

N 12° 20' 47" W 17.61 ft. to the center of a 14" Live Oak tree 2-way fence corner;

N 46° 59' 34" W, now and continuing with the north side of said house tract, 292.26 ft. to the center of a 20" Live Oak tree 2-way fence corner;

N 70° 47' 12" W, unfenced, 343.12 ft. to 5/8" Steel Pin set in fence, at the base of a multi-trunked Live Oak tree 2-way fence corner;

N 86° 21' 44" W, unfenced, passing under electric transmission lines bearing N 29° 34' 13" E into this described tract, 588.34 ft.;

S 55° 03' 17" W, unfenced, at 99.46 ft. pass the southeast terminal of the centerline of a 40.00 ft. wide waterline easement (this date surveyed -- crossing this described tract -- waterline access from said Spring Area tract to said house tract); crossing Blanco Creek; total 368.72 ft. to a 5/8" Steel Pin set on line, on the northeast side of said County Road No. 336;

S 55° 03' 17" W, unfenced, entering said County Road, 6.64 ft. to an 8" Nail Spike set flush in the center of said County Road, at the W.N.W. corner of said 18.203 acre house tract, for corner;

N 41° 35' 03" W, unfenced, with the centerline of said County Road No. 336 (until noted), now along the lower northeast side of said Howard 317.157 acre tract, 245.93 ft. to an angle point (no pin set), for corner;

Cont. Page 4 of 6, Sharon Anne McCauley -- 317.157 Acre Tract.

N 30° 41' 48" W 726.94 ft. to an angle point (no pin set),
for corner; and

THENCE N 22° 07' 09" W 183.88 ft. to an 8" Nail Spike set flush
in the center of said County Road, at an east re-entrant corner of
said Howard 317.157 acre tract, for the Westernmost corner of said
McCauley 317.157 acre tract, and the Westernmost corner of this
tract;

THENCE leaving the centerline of said County Road No. 336; and
with a southeast side of said Howard 317.157 acre tract, the west and
and southeast sides of said 2.933 acre Spring Area tract, and the
upper east side of said Howard 317.157 acre tract, respectively;
along the northwest side of said McCauley 317.157 acre tract, and the
northwest side of this tract, unfenced, as follows:

N 40° 15' 56" E 23.63 ft. to a 5/8" Steel Pin set on line,
on the northeast side of said County Road No. 336;

N 40° 15' 56" E, re-crossing said Blanco Creek, 474.35 ft.
to a 5/8" Steel Pin set on the northeast bank of said Blanco Creek,
at the N.W. corner of said 2.933 acre Spring Area Tract, for corner;

S 15° 17' 21" E, with the west side of said Spring Area
tract, 666.85 ft. to a 5/8" Steel Pin set at the South corner of said
Spring Area tract, for corner;

N 42° 35' 49" E, with the southeast side of said Spring
Area tract; at 33.83 ft. pass the north terminal of the centerline of
said 40.00 ft. wide waterline easement; total 320.58 ft. to a 5/8"
Steel Pin set at the East corner of said Spring Area tract, for
corner; and

THENCE N 28° 18' 28" E, leaving said Spring Area tract,
ascending and crossing over a mountain, 1504.93 ft. to a 5/8" Steel
Pin set in fence, in a south side of said McNair 782.710 acre tract;
at the E.N.E. corner of said Howard 317.157 acre tract, for the
N.N.W. corner of said McCauley 317.157 acre tract, and the N.N.W.
corner of this tract;

THENCE with fence, a south side of said McNair 782.710 acre
tract; along the north side of said McCauley 317.157 acre tract, and
the north side of this tract, as follows:

S 64° 25' 58" E, re-passing under said electric
transmission lines bearing N 02° 52' 00" E out of this described
tract, 825.24 ft. to the center of a 7" cedar fence post, for corner;

S 62° 01' 56" E 158.03 ft. to the center of a 7" cedar
fence post, for corner;

S 61° 48' 14" E 596.87 ft. to the center of a 7" cedar fence post, for corner;

S 86° 21' 04" E, at 256.14 ft. cross the north line of said Sur. No. 1524, the south line of said un-surveyed State Land; total 319.01 ft. to the center of an 8" cedar fence post, for corner;

S 52° 48' 14" E 221.97 ft. to the center of a 9" cedar fence post in the south line of said un-surveyed State Land, the north line of said Sur. No. 1524, for corner;

S 84° 28' 03" E, leaving said survey line and entering said un-surveyed State Land; at 712.72 ft. cross the north line of said un-surveyed State Land, the south line of said Sur. No. 863; at 1346.80 ft. cross the east line of said Sur. No. 863, a west line of said un-surveyed State Land; total 1896.02 ft. to the center of an

8" cedar east gate post in fence, in a mountain saddle, for corner; N 89° 18' 40" E 876.52 ft. to the center of a 7" cedar fence post, for corner; and

THENCE S 68° 07' 01" E 94.57 ft. to the center of a 6" cedar 2-way fence corner post, at a 24" cedar tree, at a southwest re-entrant corner of said McNair 782.710 acre tract; for the N.E. corner of said McCauley 317.157 acre tract, and the N.E corner of this tract;

THENCE with fence, with a lower west/northwest side of said McNair 782.710 acre tract and an upper northwest side of said Martin Property, respectively; along the east/southeast side of said McCauley 317.157 acre tract, and the east/southeast side of this tract, as follows:

S 08° 38' 47" W 142.03 ft. to the center of a 12" cedar tree 2-way fence corner, for corner;

S 04° 32' 47" E, at 9.38 ft. cross a south line of said un-surveyed State Land, the north line of said Sur. No. 314, and thence crossing said Sur. No. 314 (until noted); total 485.20 ft. to the center of a 12" Mountain Laurel tree 2-way fence corner, for corner;

S 19° 13' 36" W 153.01 ft. to the center of a 10" cedar tree 2-way fence corner, for corner;

S 41° 56' 32" W 44.66 ft. to the center of a 22" Live Oak tree 2-way fence corner, for corner;

S 32° 13' 50" W 357.63 ft. to the center of a 12" dead cedar tree 2-way fence corner, for corner;

S 36° 13' 34" W 606.64 ft. to the center of a 7" cedar 2-way fence corner post, for corner;

S 46° 13' 39" W 1146.16 ft. to the center of a 5" cedar fence post, for corner;

Cont. Page 6 of 6, Sharon Anne McCauley -- 317.157 Acre Tract.

S 43° 45' 10" W 448.11 ft. to a 5/8" Steel Pin found at an old 3-way fence corner post, at a west corner of said McNair 782.710 acre tract, a north corner of said Martin Property, for corner;
S 45° 22' 07" W 214.98 ft. to the center of a 5" cedar fence post, for corner; and

THENCE S 41° 31' 18" W, at 275.44 ft. cross the south line of said Sur. No. 314, the north line of said Sur. No. 271; total 340.79 ft. to the place of BEGINNING:

NOTE: This described 317.157 acre tract is subject to the east/northeast one-half of a portion of gravelled County Road No. 336, lying within and along its westernmost southwest side, and is subject to a 40.00 ft. wide waterline easement, crossing its west portion, in a north/south direction, as mentioned herein.

NOTE: Bearings noted herein are true geodetic bearings based on Global Positioning System (GPS) and Global Navigation Satellite System (GNSS) observations (WGS '84 Datum).

Surveyed: November 12, 2007 - April 29, 2008 and April 25 - 29, 2013.

Field Crew Personnel: Spencer J. Burrell
Michael J. Koch
Ferd John Rock

THE STATE OF TEXAS)
COUNTY OF MEDINA)

I, Hilmar A. Koch, a Registered Professional Land Surveyor of the State of Texas, do hereby state that the foregoing Field Notes description and accompanying plat correctly represent an actual survey made under my supervision, on the ground, on the dates given.

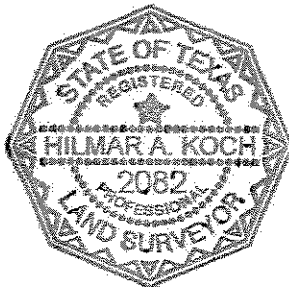

Hilmar A. Koch
Registered Professional
Land Surveyor No. 2082

Howard Ranch – Division Two Legal Description

Being 317.157 acres of land, known as Division No. Two, lying and being situated on and on both sides of graveled County Road No. 336, northwest of Sabinal, in Uvalde County, Texas; about 21.8 miles N 25° E of the City of Uvalde, the County Seat; and containing acreages in the various original Surveys, as follows:

Sur. No.	Original Grantee	Abst. No.	Acres
48	Mariano Carbajal	117	0.488
267	Saragossa Irr. & Mfg. Co.	591	3.029
285	Saragossa Irr. & Mfg. Co.	589	3.615
864	Mrs. Rebecca Tate	1900	8.447
961	T. C. R.R. Co.	1055	257.229
1524	Luis Castanon	129	41.735
-----	Un-surveyed State Land	-----	<u>2.614</u>
	Total Acres.....		317.157

said 317.157 acres being more particularly described by metes and bounds attached hereto and made a part hereof for all purposes.

KOCH & KOCH LAND SURVEYORS, INC.
 P.O. BOX 246 707 FM 1796 D'HANIS, TEXAS 79850
 Office: 830-363-7331 Fax: 830-363-7441
 E-Mail: kochkoch@swtexas.net

ELIZABETH JEAN HOWARD
"DIVISION NO. TWO"
317.157 ACRE TRACT

THE STATE OF TEXAS)
 COUNTY OF UVALDE)

Field Notes of a perimeter/boundary survey of a 317.157 acre tract of land, made for Elizabeth Jean Howard and The Nature Conservancy.

Said 317.157 acre tract of land, known as Division No. Two, lying and being situated on and on both sides of gravelled County Road No. 336, northwest of Sabinal, in Uvalde County, Texas; about 21.8 miles N 25° E of the City of Uvalde, the County Seat; and containing acreages in the various original Surveys, as follows:

Sur. No.	Original Grantee	Abst. No.	Acres
48	Mariano Carbajal	117	0.488
267	Saragossa Irr. & Mfg. Co.	591	3.029
285	Saragossa Irr. & Mfg. Co.	589	3.615
864	Mrs. Rebecca Tate	1900	8.447
961	T. C. R.R. Co.	1055	257.229
1524	Luis Castanon	129	41.735
----	Un-surveyed State Land	----	2.614
Total Acres			317.157

Said 317.157 acre tract of land being all of a 50.000 acre tract (middle portion of a 317.157 acre tract termed "Division No. Two"), as conveyed to Elizabeth Jean Howard, by Doris Esther Story and Kempner Davlin Story, Jr., by Gift Deeds (2) dated November 5, 2008, and recorded in Instrument Nos. 2008004314 and 2008004319, of the Official Public Records of said County, and all of 267.157 acres (remainder of said 317.157 acre tract termed "Division No. Two"), as conveyed to Elizabeth Jean Howard, by Kempner Davlin Story, Jr. and Doris Esther Story, by Gift Deeds (2) dated July 8, 2011, and recorded in Instrument Nos. 2011002073 and 2011002079, of the Official Public Records of said Uvalde County, Texas. Said 317.157 acre tract being bounded on the south, from east to west, by the

Cont. Page 2 of 7, Elizabeth Jean Howard -- 317.157 Acre Tract.

Leonard M. Bond 192.20 acre tract, as recorded in Vol. 237, Pages 190-194, of the Deed Records of said County, and the Blanco Ranch, LLC (Blanco Ranch) 2656.547 acre tract, as recorded in Instrument No. 2012001272, of the Official Public Records of said County; on the lower west and lower north, by the Charles Davlin Story 317.157 acre tract (termed "Division No. Three" -- Instrument Nos. 2008004313, 2008004320, 2011002074, & 2011002080, Official Public Records); on the upper west, from south to north, by the said Charles Story 317.157 acre tract, and the Jack Douglas Story 317.157 acre tract (termed "Division No. Four" -- Instrument Nos. 2008004312, 2008004321, 2011002075, & 2011002081, Official Public Records); on the upper north by the William Davis Story 317.157 acre tract (termed "Division No. Six" -- Instrument Nos. 2008004317, 2008004322, 2011002077, & 2011002083, Official Public Records); on the northeast by the John McNair Family 2012 Irrevocable Trust (McNair) 782.710 acre tract, as recorded in Instrument No. 2012004443, of the Official Public Records of said County; and on the east, from north to south, by the following: 1.) the Sharon Anne McCauley 317.157 acre tract [termed "Division No. One" -- Instrument Nos. 2008004315, 2008004318, 2011002072, & 2011002078, Official Public Records], 2.) a 2.933 acre "Spring Area" tract [this date surveyed -- middle portion of the Kempner Davlin "Bill" Story, Jr. "called" 1906.75 acres -- Vol. 262, Pages 414-417, Deed Records and Vol. 368, Pages 714-717, Official Public Records], and 3.) the Kempner Davlin "Bill" Story, Jr. 18.203 acre house tract [this date surveyed -- south middle portion of said Story "called" 1906.75 acres]. Said 317.157 acre tract being more fully described by metes and bounds, as follows:

BEGINNING at a 5/8" Steel Pin set on top of a mountain ridge, approximately 20 ft. north of an existing east/west fence, in the north line of Sur. No. 266, R. J. Hanson, the lower south line of said Sur. No. 961; in the north line of said Blanco Ranch 2656.547 acre tract, for the S.S.E. corner of said Charles Story 317.157 acre tract, the S.W. corner of said Howard 317.157 acre tract, and the S.W. corner of this tract; said 5/8" Steel Pin being distant 1969.47 ft. N 64° 15' 50" W (generally with said survey line and said property line) of another 5/8" Steel Pin found at a 3-way fence corner post, at the N.E. corner of said Sur. No. 266, the N.W. corner of Sur. No. 265, San Antonio Alazan Ditch Co., in the lower south

Cont. Page 3 of 7, Elizabeth Jean Howard -- 317.157 Acre Tract.

line of said Sur. No. 961, same being the N.N.E. corner of said Blanco Ranch 2656.547 acre tract, the W.N.W. corner of said Bond 192.20 acre tract;

THENCE leaving said survey/property line; and with the lower east and upper south lines of said Charles Story 317.157 acre tract; along the lower west and lower north sides of said Howard 317.157 acre tract, and the lower west and lower north sides of this tract, unfenced, with 5/8" Steel Pins set at corners, as follows:

N 16° 23' 00" E, along and over the top of said mountain, 1180.00 ft.;

N 28° 13' 05" E, descending said mountain ridge, 1337.39 ft.; and

THENCE EAST, at 918.92 ft. cross a lower north line of said Sur. No. 961, the south line of said Sur. No. 285; crossing Blanco Creek; at 1820.00 ft. cross the east line of said Sur. No. 285, the upper west line of said Sur. No. 961; at 2423.45 ft. pass a 5/8" Steel Pin set on line, on the west side of said County Road No. 336, and thence entering said road, an additional 19.51 ft.; for a total of 2442.96 ft. to an 8" Nail Spike set flush in the center of said County Road No. 336, at the E.S.E. corner of said Charles Story 317.157 acre tract; for the northwest re-entrant corner of said Howard 317.157 acre tract, and the northwest re-entrant corner of this tract;

THENCE with the centerline of said County Road No. 336; with the upper east side of said Charles Story 317.157 acre tract and the east side of said Jack Story 317.157 acre tract, respectively; along the upper west side of said Howard 317.157 acre tract, and the upper west side of this tract, unfenced, with angle points in the center of said road, at corners (no pins set), as follows:

N 09° 14' 32" W 141.63 ft.;

N 23° 29' 10" W 128.73 ft.;

N 39° 13' 56" W 354.56 ft.;

N 32° 54' 23" W 233.50 ft.;

N 28° 04' 49" W, at 110.74 ft. re-cross the upper west line of said Sur. No. 961, the east line of said Sur. No. 285; total 244.74 ft.;

N 31° 52' 26" W, at 146.65 ft. pass an 8" Nail Spike set flush in the center of said County Road No. 336, at the N.E. corner

Cont. Page 4 of 7, Elizabeth Jean Howard -- 317.157 Acre Tract.

of said Charles Story 317.157 acre tract, the S.E. corner of said Jack Story 317.157 acre tract; total 218.67 ft. to a point in the center of said road, 25 ft. north of a "Y" in said road, for corner;
N 18° 58' 39" W 98.65 ft.;
N 04° 20' 50" W, at 128.97 ft. cross the north line of said Sur. No. 285, the south line of said Sur. No. 864; total 230.42 ft.; and

THENCE N 04° 17' 31" E 244.81 ft. to an 8" Nail Spike set flush in the center of said County Road No. 336, at the N.E. corner of said Jack Story 317.157 acre tract, the S.S.E. corner of the Peggy Lynn Brink 317.157 acre tract (termed "Division No. Five" -- Instrument Nos. 2008004316, 2008004323, 2011002076, & 2011002082, Official Public Records); for the S.S.W. corner of said William Story 317.157 acre tract, the N.N.W. corner of said Howard 317.157 acre tract, and the N.N.W. corner of this tract; said 8" Nail Spike being distant 17.07 ft. N 89° 08' 28" E (with the north line of said Jack Story 317.157 acre tract, the south line of said Brink 317.157 acre tract) of a 5/8" Steel Pin set in said line on the west side of said County Road;

THENCE leaving the center of said County Road No. 336; and with the lower south line of said William Story 317.157 acre tract; along the upper north side of said Howard 317.157 acre tract, and the upper north side of this tract, N 89° 12' 46" E, unfenced, at 895.65 ft. cross the east line of said Sur. No. 864, the west line of said un-surveyed State Land; total 908.60 ft. to the center of a 10" cedar fence corner post, in the southwest side of said McNair 782.710 acre tract; for the S.S.E. corner of said William Story 317.157 acre tract, the N.N.E. corner of said Howard 317.157 acre tract, and the N.N.E. corner of this tract;

THENCE with fence and the southwest side of said McNair 782.710 acre tract; along the northeast side of said Howard 317.157 acre tract, and the northeast side of this tract, as follows:

S 22° 13' 40" E 280.66 ft. to the center of a 12" cedar tree fence corner;

S 40° 49' 45" E 243.26 ft. to the center of a 12" cedar tree fence corner;

S 46° 56' 07" E, at 221.54 ft. cross the south line of said

Cont. Page 5 of 7, Elizabeth Jean Howard -- 317.157 Acre Tract.

un-surveyed State Land, the upper north line of said Sur. No. 961; at 703.95 ft. cross the upper east line of said Sur. No. 961, the west line of said Sur. No. 1524; total 705.11 ft. to the center of an 8" cedar fence corner post, for corner;

S 63° 15' 35" E 311.57 ft. to the center of a 5" cedar post in fence, for corner; and

THENCE S 64° 25' 58" E 458.44 ft. to a 5/8" Steel Pin set in fence, in the southwest side of said McNair 782.710 acre tract; for the N.N.W. corner of said McCauley 317.157 acre tract, the E.N.E. corner of said Howard 317.157 acre tract, and the E.N.E. corner of this tract;

THENCE leaving fence and said property line; and with the west side of said McCauley 317.157 acre tract (unless noted), the northeast and north sides of said Spring Area 2.933 acre tract, and the west/southwest side of said Bill Story 18.203 acre house tract, respectively; along the east side of said Howard 317.157 acre tract, and the east side of this tract, unfenced, as follows:

S 28° 18' 28" W, crossing over a mountain, 1504.93 ft. to a 5/8" Steel Pin set on the southwest slope of said mountain, at the East/S.E. corner of said 2.933 acre Spring Area tract, for corner;

N 29° 02' 43" W, leaving the upper west side of said McCauley 317.157 acre tract, and with the northeast side of said 2.933 acre Spring Area tract, 511.09 ft. to a point (no pin set) on said southwest steep slope, at the N.E. corner of said 2.933 acre Spring Area tract, for corner;

S 74° 42' 40" W, descending said steep slope, 150.00 ft. to a 5/8" Steel Pin set at the N.W. corner of said 2.933 acre Spring Area tract, a North corner of said McCauley 317.157 acre tract, for corner;

S 40° 15' 56" W, with a northwest side of said McCauley 317.157 acre tract; re-crossing said Blanco Creek; at 474.35 ft. pass a 5/8" Steel Pin set on line on the east side of said County Road No. 336, and thence re-entering said County Road, an additional 23.63 ft.; for a total of 497.98 ft. to an 8" Nail Spike set flush in the center of said County Road, at the Westernmost corner of said McCauley 317.157 acre tract, an east re-entrant corner of said Howard 317.157 acre tract, and an east re-entrant corner of this tract, for corner;

Cont. Page 6 of 7, Elizabeth Jean Howard -- 317.157 Acre Tract.

S 22° 07' 09" E, now again with the centerline of said County Road No. 336 (and continuing with angle points at corners -- no pins set), with the westernmost southwest side of said McCauley 317.157 acre tract (until noted), 183.88 ft.;

S 30° 41' 48" E 726.94 ft.;

S 41° 35' 03" E, at 245.93 ft. pass an 8" Nail Spike set flush in the center of said County Road, at the upper S.W. corner of said McCauley 317.157 acre tract, the N.W. corner of said Bill Story 18.203 acre house tract, and thence continuing with the west side of said 18.203 acre house tract; total 411.93 ft.;

S 40° 38' 51" E 270.16 ft.;

S 34° 52' 17" E, passing under an electric transmission line bearing S 29° 30' 48" W across the southeast corner of this described tract, 102.32 ft.;

S 24° 57' 04" E, at 49.35 ft. cross the south line of said Sur. No. 1524, the north line of said Sur. No. 267; total 85.01 ft.;

and

THENCE S 07° 57' 28" E 79.30 ft. to a point in the center of a cattleguard, in the centerline of said County Road No. 336; in the north side of said Bond 192.20 acre tract; for the S.W. corner of said Bill Story 18.203 acre house tract, the E.S.E. corner of said Howard 317.157 acre tract, and the E.S.E. corner of this tract;

THENCE leaving said County Road No. 336; and with fence (unless noted), with the north/northwest side of said Bond 192.20 acre tract and the upper north side of said Blanco Ranch 2656.547 acre tract, respectively; along the south side of said Howard 317.157 acre tract, and the south side of this tract, with 5/8" Steel Pins set at fence corner posts (except where otherwise noted), at corners, as follows:

S 89° 28' 04" W, in most part with fence, 129.09 ft.;

S 55° 29' 05" W, re-passing under said electric transmission line; at 556.97 ft. cross the upper west line of said Sur. No. 267, the middle east line of said Sur. No. 961; total 883.27 ft.;

N 71° 06' 42" W 566.48 ft. to a 5/8" Steel Pin set at an 18" cedar tree fence corner;

S 80° 33' 02" W 90.74 ft. to a 5/8" Steel Pin set at a dead 12" cedar tree fence corner;

S 45° 25' 08" W, at 16.56 ft. cross the upper south line of

Cont. Page 7 of 7, Elizabeth Jean Howard -- 317.157 Acre Tract.

said Sur. No. 961, the north line of said Sur. No. 48; at 363.71 ft. cross the west line of said Sur. No. 48, the lower east line of said Sur. No. 961; total 1054.29 ft. to a 5/8" Steel Pin set at a fence corner post, in the lower south line of said Sur. No. 961, the upper north line of said Sur. No. 265, for corner;

N 65° 06' 14" W, with said survey line, 728.83 ft. to a 5/8" Steel Pin found at a 3-way fence corner post, at the above-mentioned N.W. corner of said Sur. No. 265, the N.E. corner of said Sur. No. 266; same being the W.N.W. corner of said Bond 192.20 acre tract, the N.N.E. corner of said Blanco Ranch 2656.547 acre tract, for corner;

N 64° 12' 40" W, now with the lower south line of said Sur. No. 961, the north line of said Sur. No. 266, 1099.47 ft.; and

THENCE N 64° 19' 49" W, continuing with said survey/property line, diverging northerly from said fence, 870.00 ft. to the place of BEGINNING;

NOTE: This described 317.157 acre tract is subject to portions of gravelled County Road No. 336, passing through and lying within and along its upper west and lower east sides.

NOTE: Bearings noted herein are true geodetic bearings based on Global Positioning System (GPS) and Global Navigation Satellite System (GNSS) observations (WGS '84 Datum).

Surveyed: November 12, 2007 - April 29, 2008 and April 25 - 29, 2013.

Field Crew Personnel: Spencer J. Burrell, Michael J. Koch, & Ferd John Rock

THE STATE OF TEXAS)
COUNTY OF MEDINA)

I, Hilmar A. Koch, a Registered Professional Land Surveyor of the State of Texas, do hereby state that the foregoing Field Notes description and accompanying plat correctly represent an actual survey made under my supervision, on the ground, on the dates given.

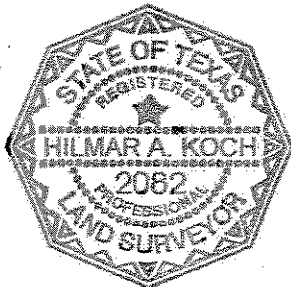

Hilmar A. Koch

Registered Professional
Land Surveyor No. 2082

Charles Story Ranch – Division Three Legal Description

Being 317.157 acres of land, known as Division No. Three, lying and being situated on and west of graveled County Road No. 336, northwest of Sabinal, in Uvalde County, Texas; about 21.8 miles N 25° E of the City of Uvalde, the County Seat; and containing acreages in the various original Surveys, as follows:

Sur. No.	Original Grantee	Abst. No.	Acres
284	City of San Antonio (C. James Richarz)	1494	0.046
285	Saragossa Irr. & Mfg. Co.	589	30.920
961	T. C. R.R. Co.	1055	102.358
962	T. C. R.R. Co. (Charles Peters)	1491	183.833
Total Acres.....			317.157

said 317.157 acres being more particularly described by metes and bounds attached hereto and made a part hereof for all purposes.

KOCH & KOCH LAND SURVEYORS, INC.
P.O. BOX 246 707 FM 1796 D'HANIS, TEXAS 78850
Office: 830-363-7331 Fax: 830-363-7441
E-Mail: kochkoch@swtexas.net

CHARLES DAVLIN STORY
"DIVISION NO. THREE"
317.157 ACRE TRACT

THE STATE OF TEXAS)
COUNTY OF UVALDE)

Field Notes of a perimeter/boundary survey of a 317.157 acre tract of land, made for Charles Davlin Story and The Nature Conservancy.

Said 317.157 acre tract of land, known as Division No. Three, lying and being situated on and west of gravelled County Road No. 336, northwest of Sabinas, in Uvalde County, Texas; about 21.8 miles N 25° E of the City of Uvalde, the County Seat; and containing acreages in the various original surveys, as follows:

Sur. No.	Original Grantee	Abst. No.	Acres
284	City of San Antonio (C. James Richarz)	1494	0.046
285	Saragossa Irr. & Mfg. Co.	589	30.920
961	T. C. R.R. Co.	1055	102.358
962	T. C. R.R. Co. (Charles Peters)	1491	183.833
Total Acres			317.157

Said 317.157 acre tract of land being all of a 50.000 acre tract (east portion of a 317.157 acre tract termed "Division No. Three"), as conveyed to Charles Davlin Story, by Doris Esther Story and Kempner Davlin Story, Jr., by Gift Deeds (2) dated November 5, 2008, and recorded in Instrument Nos. 2008004313 and 2008004320, of the Official Public Records of said County, and all of 267.157 acres (remainder of said 317.157 acre tract termed "Division No. Three"), as conveyed to Charles Davlin Story, by Kempner Davlin Story, Jr. and Doris Esther Story, by Gift Deeds (2) dated July 8, 2011, and recorded in Instrument Nos. 2011002074 and 2011002080, of the Official Public Records of said Uvalde County, Texas. Said 317.157 acre tract being bounded on the lower south/southwest, from east to west, by the Blanco Ranch, LLC (Blanco Ranch) 2656.547 acre tract, as recorded in Instrument No. 2012001272, of the Official Public Records of said County, and the Concan Ranch, LP 2013.001 acre tract,

Cont. Page 2 of 5, Charles Davlin Story -- 317.157 Acre Tract.

designated as "Tract I", as recorded in Instrument No. 2009000751, of the Official Public Records of said County; on the west by the said Concan Ranch 2013.001 acre tract; on the north by the Jack Douglas Story 317.157 acre tract (termed "Division No. Four" -- Instrument Nos. 2008004312, 2008004321, 2011002075, & 2011002081, Official Public Records); and on the upper east, upper south, and lower east by the Elizabeth Jean Howard 317.157 acre tract (termed "Division No. Two" -- Instrument Nos. 2008004314, 2008004319, 2011002073, & 2011002079, Official Public Records). Said 317.157 acre tract being more fully described by metes and bounds, as follows:

BEGINNING at a 5/8" Steel Pin set on top of a mountain ridge, approximately 20 ft. north of an existing east/west fence, in the north line of Sur. No. 266, R. J. Hanson, the lower south line of said Sur. No. 961; in the north line of said Blanco Ranch 2656.547 acre tract; for the S.W. corner of said Howard 317.157 acre tract, the S.S.E. corner of said Charles Story 317.157 acre tract, and the S.S.E. corner of this tract; said 5/8" Steel Pin being distant 1969.47 ft. N 64° 15' 50" W (generally with said survey line and said property line) of another 5/8" Steel Pin found at a 3-way fence corner post, at the N.E. corner of said Sur. No. 266, the N.W. corner of Sur. No. 265, San Antonio Alazan Ditch Co., in the lower south line of said Sur. No. 961, same being the N.N.E. corner of said Blanco Ranch 2656.547 acre tract, and the W.N.W. corner of the Leonard M. Bond 192.20 acre tract (Vol. 237, Pgs. 190-194, Deed Records);

THENCE with the north side of said Blanco Ranch 2656.547 acre tract and a fenced and occupied middle north side of said Concan Ranch 2013.001 acre tract, respectively; along the lower south/southwest side of said Charles Story 317.157 acre tract, and the lower south/southwest side of this tract, unfenced (until noted), as follows:

N 64° 19' 49" W, with the lower south lines of said Sur. Nos. 961 and 962, respectively; the north line of said Sur. No. 266; at 1617.14 ft. pass the S.W. corner of said Sur. No. 961, the S.S.E. corner of said Sur. No. 962; total 2389.83 ft. to an old rock mound (found 7.47 ft. north of a 5/8" Steel Pin set at a 3-way fence corner post), in the lower south line of said Sur. No. 962, at the N.W. corner of said Sur. No. 266, the N.E. corner of said Sur. No. 284; at the N.W. corner of said Blanco Ranch 2656.547 acre tract, a middle N.E. corner of said Concan Ranch 2013.001 acre tract, for corner;

Cont. Page 3 of 5, Charles Davlin Story -- 317.157 Acre Tract.

N 57° 15' 23" W, diverging northerly from said survey line; and converging with fence, 137.10 ft. to the center of a 5" cedar fence post, for corner;

N 67° 05' 18" W, now and continuing with fence, converging with said survey line, at 506.93 ft. cross the lower south line of said Sur. No. 962, the north line of said Sur. No. 284; total 832.39 ft. to the center of a 7" cedar 2-way fence corner post, found at a lower northeast re-entrant corner of said Concan Ranch 2013.001 acre tract (as fenced and occupied), the S.S.W. corner of said Charles Story 317.157 acre tract, and the S.S.W. corner of this tract; and

THENCE N 27° 56' 24" W, at 19.68 ft. re-cross the north line of said Sur. No. 284, the lower south line of said Sur. No. 962; total 641.01 ft. to the center of a 5" cedar 2-way fence corner post, found in the east/southeast line of Sur. No. 762, C. James Richarz, the lower west line of said Sur. No. 962; in an east/southeast side of said Concan Ranch 2013.001 acre tract; for an east re-entrant corner of said Concan Ranch 2013.001 acre tract (as fenced and occupied), the W.S.W. corner of said Charles Story 317.157 acre tract, and the W.S.W. corner of this tract;

THENCE with fence and said last-mentioned survey/property line, along the west side of said Charles Story 317.157 acre tract, and the west side of this tract, N 25° 05' 24" E 2224.02 ft. to a 5/8" Steel Pin set in fence, in said survey line, on the northwest side of a mountain, in a middle east side of said Concan Ranch 2013.001 acre tract; for a S.W. corner of said Jack Story 317.157 acre tract, the W.N.W. corner of said Charles Story 317.157 acre tract, and the W.N.W. corner of this tract;

THENCE leaving fence, said survey line, and said property line; and with the south side of said Jack Story 317.157 acre tract, along the north side of said Charles Story 317.157 acre tract, and the north side of this tract, unfenced, with 5/8" Steel Pins set at corners, as follows:

S 64° 54' 36" E, ascending said mountain, 260.00 ft. to a 5/8" Steel Pin set on the northwest side of the top of a mountain ridge;

N 65° 32' 15" E, along the northwest side of the top of said mountain ridge, 973.19 ft.;

S 64° 04' 19" E, descending along the north side of the top of said mountain ridge, 2642.95 ft.;

Cont. Page 4 of 5, Charles Davlin Story -- 317.157 Acre Tract.

N 87° 18' 19" E, descending said mountain, at 333.83 ft. cross the middle east line of said Sur. No. 962, the west line of said Sur. No. 285; passing under electric transmission lines bearing S 35° 37' 12" E into this described tract; total 1170.65 ft. to a 5/8" Steel Pin set on the west bank of Blanco Creek, for corner;

N 71° 25' 19" E, crossing said Blanco Creek, 523.05 ft. to a 5/8" Steel Pin set on line, on the west side of said County Road No. 336; and

THENCE N 71° 25' 19" E, entering said County Road, 21.37 ft. to an 8" Nail Spike set flush in the center of said County Road, in the upper west side of said Howard 317.157 acre tract, at the S.E. corner of said Jack Story 317.157 acre tract; for the N.E. corner of said Charles Story 317.157 acre tract, and the N.E. corner of this tract;

THENCE with the centerline of said County Road No. 336, the upper west side of said Howard 317.157 acre tract, the upper east side of said Charles Story 317.157 acre tract, and the upper east side of this tract, with angle points at corners (no pins set), as follows:

S 31° 52' 26" E 146.65 ft.;

S 28° 04' 49" E, at 134.00 ft. cross the east line of said Sur. No. 285, the upper west line of said Sur. No. 961; total 244.74 ft.;

S 32° 54' 23" E 233.50 ft.;

S 39° 13' 56" E 354.56 ft.;

S 23° 29' 10" E 128.73 ft.; and

THENCE S 09° 14' 32" E 141.63 ft. to an 8" Nail Spike set flush in the center of said County Road, at the northwest re-entrant corner of said Howard 317.157 acre tract; for the E.S.E. corner of said Charles Story 317.157 acre tract, and the E.S.E. corner of this tract;

THENCE leaving the center of said County Road No. 336; and with the lower north and lower west sides of said Howard 317.157 acre tract; along the upper south and lower east sides of said Charles Story 317.157 acre tract, and the upper south and lower east sides of this tract, unfenced, with 5/8" Steel Pins set at corners, as follows:

WEST 19.51 ft. to a 5/8" Steel Pin set on line, on the

west side of said County Road;

NEST, leaving said road, at 603.45 ft. re-cross the upper west line of said Sur. No. 961, the east line of said Sur. No. 285; re-crossing said Blanco Creek; at 1504.53 ft. cross the south line of said Sur. No. 285, a lower north line of said Sur. No. 961; total 2423.45 ft. to a 5/8" Steel Pin set at the lower N.W. corner of said Howard 317.157 acre tract, the southeast re-entrant corner of said Charles Story 317.157 acre tract, and the southeast re-entrant corner of this tract;

S 28° 13' 05" W, ascending a mountain ridge, 1337.38 ft. to a 5/8" Steel Pin set on top of said ridge; and

THENCE S 16° 23' 00" W, along and over the top of said mountain, 1180.00 ft. to the place of BEGINNING:

NOTE: This described 317.157 acre tract is subject to the west one-half of a portion of gravelled County Road No. 336, lying within and along its entire upper east side.

NOTE: Bearings noted herein are true geodetic bearings based on Global Positioning System (GPS) and Global Navigation Satellite System (GNSS) observations (WGS '84 Datum).

Surveyed: November 12, 2007 - April 29, 2008 and April 25 - 29, 2013.

Field Crew Personnel: Spencer J. Burrell
Michael J. Koch
Ferd John Rock

THE STATE OF TEXAS)
COUNTY OF MEDINA)

I, Hilmar A. Koch, a Registered Professional Land Surveyor of the State of Texas, do hereby state that the foregoing Field Notes description and accompanying plat correctly represent an actual survey made under my supervision, on the ground, on the dates given.

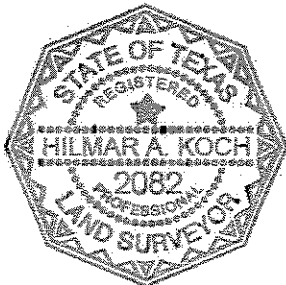

Hilmar A. Koch
Registered Professional
Land Surveyor No. 2082

**Jack Story Ranch – Division Four
Legal Description**

Being 317.157 acres of land, known as Division No. Four, lying and being situated on and west of graveled County Road No. 336, northwest of Sabinal, in Uvalde County, Texas; about 21.8 miles N 25° E of the City of Uvalde, the County Seat; and containing acreages in the various original Surveys, as follows:

Sur. No.	Original Grantee	Abst. No.	Acres
285	Saragossa Irr. & Mfg. Co.	589	15.411
864	Mrs. Rebecca Tate	1900	111.400
962	T. C. R.R. Co. (Charles Peters)	1491	160.295
1035	C.T. & M.C. R.R. Co.	1395	<u>30.051</u>
Total Acres.....			317.157

said 317.157 acres being more particularly described by metes and bounds attached hereto and made a part hereof for all purposes.

KOCH & KOCH LAND SURVEYORS, INC.
P.O. BOX 246 707 FM 1796 D'HANIS, TEXAS 79850
Office: 830-363-7331 Fax: 830-363-7441
E-Mail: kochkoch@swtexas.net

JACK DOUGLAS STORY
"DIVISION NO. FOUR"
317.157 ACRE TRACT

THE STATE OF TEXAS)
COUNTY OF UVALDE)

Field Notes of a perimeter/boundary survey of a 317.157 acre tract of land, made for Jack Douglas Story and The Nature Conservancy.

Said 317.157 acre tract of land, known as Division No. Four, lying and being situated on and west of gravelled County Road No. 336, northwest of Sabinal, in Uvalde County, Texas; about 21.8 miles N 25° E of the City of Uvalde, the County Seat; and containing acreages in the various original Surveys, as follows:

Sur. No.	Original Grantee	Abst. No.	Acres
285	Saragossa Irr. & Mfg. Co.	589	15.411
864	Mrs. Rebecca Tate	1900	111.400
962	T. C. R.R. Co. (Charles Peters)	1491	160.295
1035	C.T. & M.C. R.R. Co.	1395	<u>30.051</u>
Total Acres			317.157

Said 317.157 acre tract of land being all of a 50.000 acre tract (east portion of a 317.157 acre tract termed "Division No. Four"), as conveyed to Jack Douglas Story, by Doris Esther Story and Kempner Davlin Story, Jr., by Gift Deeds (2) dated November 5, 2008, and recorded in Instrument Nos. 2008004312 and 2008004321, of the Official Public Records of said County, and all of 267.157 acres (remainder of said 317.157 acre tract termed "Division No. Four"), as conveyed to Jack Douglas Story, by Kempner Davlin Story, Jr. and Doris Esther Story, by Gift Deeds (2) dated July 8, 2011, and recorded in Instrument Nos. 2011002075 and 2011002081, of the Official Public Records of said Uvalde County, Texas. Said 317.157 acre tract being bounded on the south by the Charles Davlin Story 317.157 acre tract (termed "Division No. Three" -- Instrument Nos. 2008004313, 2008004320, 2011002074, & 2011002080, Official Public Records); on the southwest and west by the Concan Ranch, LP 2013.001

Cont. Page 2 of 5, Jack Douglas Story -- 317.157 Acre Tract.

acre tract, designated as "Tract I", as recorded in Instrument No. 2009000751, of the Official Public Records of said County; on the north by the Peggy Lynn Brink 317.157 acre tract (termed "Division No. Five" -- Instrument Nos. 2008004316, 2008004323, 2011002076, & 2011002082, Official Public Records); and on the east by the Elizabeth Jean Howard 317.157 acre tract (termed "Division No. Two" -- Instrument Nos. 2008004314, 2008004319, 2011002073, & 2011002079, Official Public Records). Said 317.157 acre tract being more fully described by metes and bounds, as follows:

BEGINNING at the center of an 8" cedar 2-way fence corner post, found in the easternmost east line of Sur. No. 766, C. James Richarz, the upper west line of said Sur. No. 962; at the upper northeast re-entrant corner of said Concan Ranch 2013.001 acre tract (as fenced and occupied); for the W.S.W. corner of said Jack Story 317.157 acre tract, and the W.S.W. corner of this tract; said 8" cedar 2-way fence corner post being distant 3.65 ft. NORTH of the E.S.E. corner of said Sur. No. 766, the upper S.W. corner of said Sur. No. 962, in the north line of Sur. No. 762, C. James Richarz;

THENCE with fence, with the easternmost east line of said Sur. No. 766, the upper west line of said Sur. No. 962; along the upper east side of said Concan Ranch 2013.001 acre tract, the west side of said Jack Story 317.157 acre tract, and the west side of this tract, N 00° 00' 21" E 1210.02 ft. to a 5/8" Steel Pin set at a Steel "T" Post in fence, in said survey/property line, on top of a mountain ridge, at the S.W. corner of said Brink 317.157 acre tract; for the W.N.W. corner of said Jack Story 317.157 acre tract, and the W.N.W. corner of this tract;

THENCE leaving fence, said survey line, and said property line; and with the south side of said Brink 317.157 acre tract, along the north side of said Jack Story 317.157 acre tract, and the north side of this tract, unfenced, with 5/8" Steel Pins set at corners, as follows:

N 56° 21' 18" E, along and just north of the top of a mountain ridge, at 477.92 ft. cross the upper north line of said Sur. No. 962, the lower south line of said Sur. No. 1035; total 1900.00 ft.;

Cont. Page 3 of 5, Jack Douglas Story -- 317.157 Acre Tract.

S 76° 02' 23" E, descending said mountain, 1328.05 ft.;
S 60° 35' 26" E, at 126.53 ft. cross the lower east line of
said Sur. No. 1035, the west line of said Sur. No. 864; total 1293.13
ft. to a 5/8" Steel Pin set on the west side of a pasture road, for
corner;

S 35° 51' 56" E 694.65 ft.;
S 19° 13' 33" E 1081.75 ft.;
S 54° 34' 16" E, crossing said pasture road and Blanco
Creek, 1306.89 ft. to a 5/8" Steel Pin set on the north side of said
pasture road, for corner;

N 89° 08' 28" E, passing under electric transmission lines
bearing S 00° 31' 23" W into this described tract, 1095.75 ft. to a
5/8" Steel Pin set on line, on the west side of said County Road No.
336; and

THENCE N 89° 08' 28" E, entering said County Road, 17.07 ft. to
an 8" Nail Spike set flush in the center of said County Road No. 336,
at the S.S.E. corner of said Brink 317.157 acre tract, the S.S.W.
corner of the William Davis Story 317.157 acre tract (termed
"Division No. Six" -- Instrument Nos. 2008004317, 2008004322,
2011002077, & 2011002083, Official Public Records), for the N.N.W.
corner of said Howard 317.157 acre tract, the E.N.E. corner of said
Jack Story 317.157 acre tract, and the E.N.E. corner of this tract;

THENCE with the center of said County Road No. 336, the upper
west side of said Howard 317.157 acre tract, the east side of said
Jack Story 317.157 acre tract, and the east side of this tract, with
angle points at corners (no pins set), as follows:

S 04° 17' 31" W 244.81 ft.;
S 04° 20' 50" E, at 101.45 ft. cross the south line of said
Sur. No. 864, the north line of said Sur. No. 285; total 230.42 ft.;
S 18° 58' 39" E 98.65 ft. to a point in the center of said
County Road, 25 ft. north of a "Y" in said road; and

THENCE S 31° 52' 26" E 72.02 ft. to an 8" Nail Spike set flush
in the center of said County Road, in the upper west side of said
Howard 317.157 acre tract, at the N.E. corner of said Charles Story
317.157 acre tract; for the S.E. corner of said Jack Story 317.157
acre tract, and the S.E. corner of this tract;

THENCE leaving the center of said County Road No. 336 and the upper west side of said Howard 317.157 acre tract; and with the north side of said Charles Story 317.157 acre tract, and a middle east and middle north sides of said Concan Ranch 2013.001 acre tract, respectively; along the south and southwest sides of said Jack Story 317.157 acre tract, and the south and southwest sides of this tract, unfenced (until noted), with 5/8" Steel Pins set at corners (unless otherwise noted), as follows:

S 71° 25' 19" W, 21.37 ft. to a 5/8" Steel Pin set on line, on the west side of said County Road No. 336;

S 71° 25' 19" W, leaving said County Road, and re-crossing said Blanco Creek, 523.05 ft. to a 5/8" Steel Pin set on the west bank of said Blanco Creek, for corner;

S 87° 18' 19" W, ascending a mountain; re-passing under said electric transmission lines bearing S 35° 37' 12" E out of this described tract; at 836.82 ft. cross the west line of said Sur. No. 285, the middle east line of said Sur. No. 962; total 1170.65 ft. to a 5/8" Steel Pin set on the north side of the top of a mountain ridge, for corner;

N 64° 04' 19" W, ascending along the north side of the top of said ridge, 2642.95 ft. to a 5/8" Steel Pin set on the north side of the top of said ridge, for corner;

S 65° 32' 15" W, along the northwest side of the top of said mountain ridge, 973.19 ft.;

N 64° 54' 36" W 260.00 ft. to a 5/8" Steel Pin set in fence, on the northwest side of said mountain, in a middle east side of said Concan Ranch 2013.001 acre tract; in the lower west line of said Sur. No. 962, the east line of said Sur. No. 762; at the W.N.W. corner of said Charles Story 317.157 acre tract, for corner;

N 25° 05' 24" E, now with fence, said survey line (until noted), and an east side of said Concan Ranch 2013.001 acre tract, 95.00 ft. to a 5/8" Steel Pin set at a cedar stump 2-way fence corner post, for corner;

N 33° 57' 39" E, with fence, diverging easterly from said survey line, 44.08 ft. to a 5/8" Steel Pin set in fence, at a N.E. corner of said Concan Ranch 2013.001 acre tract, for corner;

N 64° 52' 30" W, unfenced, with a north side of said Concan Ranch 2013.001 acre tract (until noted); at 6.80 ft. pass the N.E. corner of said Sur. No. 762, the southwest re-entrant corner of said

Cont. Page 5 of 5, Jack Douglas Story -- 317.157 Acre Tract.

Sur. No. 962; and thence with the north line of said Sur. No. 762, the westernmost south line of said Sur. No. 962 (until noted); at 15 ft. pass a 2-way fence corner post, and thence again and continuing with fence; total 1887.68 ft. to a Steel "T" fence post, for corner; N 62° 44' 40" W, diverging northerly from said survey line, 64.52 ft. to the center of a 10" Spanish Oak tree 2-way fence corner; N 29° 07' 46" W, leaving a north side of said Concan Ranch 2013.001 acre tract, and crossing a mountain drain, 69.15 ft. to the center of an 8" cedar tree 2-way fence corner; N 86° 28' 45" W 68.41 ft. to the center of a 6" Live Oak tree 2-way fence corner; and

THENCE S 72° 26' 03" W 21.10 ft. to the place of BEGINNING;

NOTE: This described 317.157 acre tract is subject to the west one-half of a portion of gravelled County Road No. 336, lying within and along its entire east side.

NOTE: Bearings noted herein are true geodetic bearings based on Global Positioning System (GPS) and Global Navigation Satellite System (GNSS) observations (WGS '84 Datum).

Surveyed: November 12, 2007 - April 29, 2008 and April 25 - 29, 2013.

Field Crew Personnel: Spencer J. Burrell
Michael J. Koch
Ferd John Rock

THE STATE OF TEXAS)
COUNTY OF MEDINA)

I, Hilmar A. Koch, a Registered Professional Land Surveyor of the State of Texas, do hereby state that the foregoing Field Notes description and accompanying plat correctly represent an actual survey made under my supervision, on the ground, on the dates given.



Hilmar A. Koch
Registered Professional
Land Surveyor No. 2082

**Brink Ranch – Division Five
Legal Description**

Being 317.157 acres of land, known as Division No. Five, lying and being situated on and west of graveled County Road No. 336, northwest of Sabinal, in Uvalde County, Texas; about 21.8 miles N 25° E of the City of Uvalde, the County Seat; and containing acreages in the various original Surveys, as follows:

Sur. No.	Original Grantee	Abst. No.	Acres
864	Mrs. Rebecca Tate	1900	151.809
962	T. C. R.R. Co. (Charles Peters)	1491	1.209
1035	C.T. & M.C. R.R. Co.	1395	<u>164.139</u>
	Total Acres.....		317.157

said 317.157 acres being more particularly described by metes and bounds attached hereto and made a part hereof for all purposes.

KOCH & KOCH LAND SURVEYORS, INC.
P.O. BOX 246 707 FM 1796 D'HANIS, TEXAS 78850
Office: 830-363-7331 Fax: 830-363-7441
E-Mail: kochkoch@swtexas.net

PEGGY LYNN BRINK
"DIVISION NO. FIVE"
317.157 ACRE TRACT

THE STATE OF TEXAS)
COUNTY OF UVALDE)

Field Notes of a perimeter/boundary survey of a 317.157 acre tract of land, made for Peggy Lynn Brink and The Nature Conservancy.

Said 317.157 acre tract of land, known as Division No. Five, lying and being situated on and west of gravelled County Road No. 336, northwest of Sabinal, in Uvalde County, Texas; about 21.8 miles N 25° E of the City of Uvalde, the County Seat; and containing acreages in the various original surveys, as follows:

Sur. No.	Original Grantee	Abst. No.	Acres
864	Mrs. Rebecca Tate	1900	151.809
962	T. C. R.R. Co. (Charles Peters)	1491	1.209
1035	C.T. & M.C. R.R. Co.	1395	<u>164.139</u>
Total Acres			317.157

Said 317.157 acre tract of land being all of a 50.000 acre tract (middle portion of a 317.157 acre tract termed "Division No. Five"), as conveyed to Peggy Lynn Brink, by Doris Esther Story and Kempner Davlin Story, Jr., by Gift Deeds (2) dated November 5, 2008, and recorded in Instrument Nos. 2008004316 and 2008004323, of the Official Public Records of said County, and all of 267.157 acres (remainder of said 317.157 acre tract termed "Division No. Five"), as conveyed to Peggy Lynn Brink, by Kempner Davlin Story, Jr. and Doris Esther Story, by Gift Deeds (2) dated July 8, 2011, and recorded in Instrument Nos. 2011002076 and 2011002082, of the Official Public Records of said Uvalde County, Texas. Said 317.157 acre tract being bounded on the south by the Jack Douglas Story 317.157 acre tract (termed "Division No. Four" -- Instrument Nos. 2008004312, 2008004321, 2011002075, & 2011002081, Official Public Records); on the lower west by the Concan Ranch, LP 2013.001 acre tract, designated as "Tract I", as recorded in Instrument No. 2009000751, of the Official Public Records of said County; on the westernmost north

and upper west by the Betty J. Bludworth 169.55 acres, designated as "Third Tract", as recorded in Instrument No. 2012000254, of the Official Public Records of said County; and on the upper north, northeast, and east, from north to south, by the following: 1.) the said Betty J. Bludworth 169.55 acres, 2.) the Jack D. Story, et ux. 413.876 acre tract, as recorded in Instrument No. 2009004251, of the Official Public Records of said County; 3.) the William Davis Story 317.157 acre tract [termed "Division No. Six" -- Instrument Nos. 2008004317, 2008004322, 2011002077, & 2011002083, Official Public Records]; 4.) a 1.265 acre "Water Well" tract [this date surveyed -- middle portion of the Kempner Davlin Story, Jr. "called" 1906.75 acres -- Vol. 262, Pages 414-417, Deed Records and Vol. 368, Pages 714-717, Official Public Records], and 5.) the said William Davis Story 317.157 acre tract. Said 317.157 acre tract fully encompassing a wood-frame camp house and other improvements, with no overlapping thereof, and being more fully described by metes and bounds, as follows:

BEGINNING at an old 6" concrete-filled tile set upright, found at an angle point in the south line of Sur. No. 969, G.C. & S.F. R.R. Co., at the W.N.W. corner of said Sur. No. 1035, the N.E. corner of Sur. No. 766, C. James Richard; in the south side of said Bludworth 169.55 acres, at the N.N.E. corner of said Concan Ranch 2013.001 acre tract; for the W.N.W. corner of said Brink 317.157 acre tract, and the W.N.W. corner of this tract; said old 6" tile being distant 16.58 ft. N 32° 03' 23" W of a fallen dead cedar tree 3-way fence corner, found at the "fenced" N.W. corner of said Bill Story 1906.75 acre ranch;

THENCE with the easternmost south line of said Sur. No. 969, the lower north line of said Sur. No. 1035; along a south line of said Bludworth 169.55 acres, the westernmost north line of said Brink 317.157 acre tract, and the westernmost north side of this tract, S 89° 34' 29" E, generally along but not with existing fence, passing and re-passing through said fence, 1937.22 ft. to an old 6" concrete-filled tile set upright, found in a rock mound, on the northeast side of said existing fence; at the S.E. corner of said Sur. No. 969, the northwest re-entrant corner of said Sur. No. 1035; at a S.E. corner of said Bludworth 169.55 acres; for a northwest re-entrant corner of said Brink 317.157 acre tract, and a northwest re-entrant corner of

Cont. Page 3 of 6, Peggy Lynn Brink -- 317.157 Acre Tract.

this tract; said 6" concrete-filled tile being distant 37.34 ft.
S 42° 48' 39" E of a 5/8" Steel Pin set at a 3-way fence corner post;

THENCE with the east line of said Sur. No. 969, the upper west line of said Sur. No. 1035; along an east side of said Bludworth 169.55 acres, the upper west side of said Brink 317.157 acre tract, and the upper west side of this tract, N 00° 36' 27" E, unfenced, east of and generally parallel to existing fence, 252.10 ft. to an old 6" concrete-filled tile set upright, found in said survey line, at a southeast re-entrant corner of said Bludworth 169.55 acres; for the N.N.W. corner of said Brink 317.157 acre tract, and the N.N.W. corner of this tract;

THENCE leaving said survey line; and with the upper north, northeast, and east sides of said Brink 317.157 acre tract; along the upper north, northeast, and east sides of this tract, unfenced (unless noted), with 5/8" Steel Pins set at property corners (unless otherwise noted), as follows:

S 89° 34' 29" E, entering said Sur. No. 1035, with an upper south side of said Bludworth 169.55 acres (until noted), 550.00 ft.;

S 40° 19' 03" E 526.10 ft. to an old 6" concrete-filled tile set upright, found 4.4 ft. north of existing fence, for corner;

N 67° 02' 41" E, along and converging toward said fence, 174.08 ft. to the center of a 12" cedar tree fence corner, for corner;

N 65° 40' 17" E, with fence, 143.42 ft. to the center of a 2-7/8" Steel Pipe 3-way fence corner post, at a S.E. corner of said Bludworth 169.55 acres, the S.W. corner of said Jack Story 413.876 acre tract, for corner;

N 62° 16' 45" E, with fence and now with the south and southwest sides of said Jack Story 413.876 acre tract (until noted), 39.44 ft. to the center of a 2-7/8" Steel Pipe fence corner post, for corner;

S 36° 15' 28" E, with fence, 24.93 ft. to the center of a 2-7/8" Steel Pipe 3-way fence corner post, for corner;

S 29° 00' 32" E, with fence, 147.21 ft. to a 5/8" Steel Pin set at a fence corner post, for corner;

S 20° 05' 23" E, with fence, at 214.61 ft. cross the lower east line of said Sur. No. 1035, the west line of said Sur.

No. 864; total 242.81 ft. to a 5/8" Steel Pin set at a fence corner post, for corner;

S 47° 44' 07" E, with fence, passing under electric transmission lines bearing S 05° 41' 51" E into this described tract, 588.23 ft. to a 5/8" Steel Pin set at a 3-way fence corner post, at a S.W. corner of said Jack Story 413.876 acre tract, the W.N.W. corner of said William Story 317.157 acre tract, for corner;

S 11° 32' 43" E, leaving fence and the south side of said Jack Story 413.876 acre tract; now with the west side of said William Story 317.157 acre tract (until noted); crossing and re-crossing Bailey Creek, 1356.01 ft.;

S 60° 09' 32" E 1274.04 ft.;

N 84° 20' 07" E, crossing a draw and ascending the west side of a mountain, 1350.00 ft.;

S 18° 14' 36" W, along the top of a ridge, partially descending said mountain, 1102.12 ft.;

S 31° 48' 34" E, descending said mountain, passing under electric transmission lines bearing S 68° 20' 38" W into this described tract, 678.49 ft. to a 5/8" Steel Pin set at a 2-way fence corner post, in the north side of a field, for corner;

N 70° 39' 54" E, with field fence, 219.32 ft.;

S 77° 05' 22" E, with field fence, 210.34 ft.;

S 89° 49' 39" E, with field fence, passing under electric transmission lines bearing S 23° 28' 55" E across a N.E. corner of this described tract, 125.13 ft.;

S 18° 52' 54" E, with field fence, re-passing under said electric transmission lines, and thence passing under another electric transmission line bearing S 67° 54' 56" W across a southeast corner of this described tract, 461.56 ft. to a 5/8" Steel Pin set in the north line of said 1.265 acre water well tract; at a S.W. corner of said William Story 317.157 acre tract, for corner;

S 87° 54' 55" W, with the north side of said 1.265 acre water well tract, re-passing under said last-mentioned electric transmission line, 295.01 ft.;

S 44° 14' 55" E, with the southwest side of said water well tract (until noted), 140.64 ft.;

S 55° 13' 59" E 130.27 ft. to a 5/8" Steel Pin set on the north side of County Road No. 336;

S 55° 13' 59" E, entering said County Road, 32.08 ft. to an 8" Nail Spike set flush in the center of said County Road, at the

Cont. Page 5 of 6, Peggy Lynn Brink -- 317.157 Acre Tract.

S.W. corner of said 1.265 acre water well tract, in a northwest side of said William Story 317.157 acre tract, for an East corner of said Brink 317.157 acre tract, and an East corner of this tract;

S 72° 59' 15" W, now and continuing with the center of said County Road No. 336 (until noted), 39.33 ft. to a point in the center of said road, for corner;

S 41° 46' 32" W, crossing the Blanco Creek, 53.78 ft. to a point in the center of said road, for corner;

S 35° 17' 57" W 91.62 ft. to a point in the center of said road, for corner;

S 21° 24' 30" W 129.00 ft. to a point in the center of said road, for corner; and

THENCE S 04° 17' 31" W 55.56 ft. to an 8" Nail Spike set flush in the center of said road; at the S.S.W. corner of said William Story 317.157 acre tract, the E.N.E. corner of said Jack Story 317.157 acre tract, and the N.N.W. corner of the Elizabeth Jean Howard 317.157 acre tract (termed "Division No. Two" -- Instrument Nos. 2008004314, 2008004319, 2011002073, & 2011002079, Official Public Records); for the S.S.E. corner of said Brink 317.157 acre tract, and the S.S.E. corner of this tract;

THENCE leaving the center of said County Road No. 336; and with the north side of said Jack Story 317.157 acre tract; along the south side of said Brink 317.157 acre tract, and the south side of this tract, unfenced, with 5/8" Steel Pins set at corners, as follows:

S 89° 08' 28" W 17.07 ft. to a 5/8" Steel Pin set on line, on the west side of said County Road;

S 89° 08' 28" W, passing under electric transmission lines bearing N 00° 31' 23" E into this described tract, 1095.75 ft.;

N 54° 34' 16" W, re-crossing said Blanco Creek, 1306.89 ft.;

N 19° 13' 33" W 1081.75 ft.;

N 35° 51' 56" W 694.65 ft.;

N 60° 35' 26" W, at 1166.59 ft. re-cross the west line of said Sur. No. 864, the lower east line of said Sur. No. 1035; total 1293.13 ft.;

N 76° 02' 23" W, ascending a mountain, 1328.05 ft.; and

THENCE $S 56^{\circ} 21' 18'' W$, generally along the top of said mountain, at 1422.08 ft. cross the lower south line of said Sur. No. 1035, the upper north line of said Sur. No. 962; total 1900.00 ft. to a 5/8" Steel Pin set in fence, at a Steel "T" post, on top of said mountain; in the upper west line of said Sur. No. 962, the east line of said Sur. No. 766; in the upper east side of said Concan Ranch 2013.001 acre tract; for the W.N.W. corner of said Jack Story 317.157 acre tract, the S.W. corner of said Brink 317.157 acre tract, and the S.W. corner of this tract;

THENCE with the east line of said Sur. No. 766, with the upper west line of said Sur. No. 962 and the lower west line of said Sur. No. 1035, respectively; along the upper east line of said Concan Ranch 2013.001 acre tract, the lower west side of said Brink 317.157 acre tract, and the lower west side of this tract, $N 00^{\circ} 00' 36'' W$, with fence, at 264.79 ft. pass the N.W. corner of said Sur. No. 962, the S.W. corner of said Sur. No. 1035; total 2900.17 ft. to an angle point in fence (fence fallen), for corner; and $N 01^{\circ} 08' 15'' W$, leaving said fence, 36.57 ft. to the place of BEGINNING:

NOTE: This described 317.157 acre tract is subject to the west one-half of a portion of gravelled County Road No. 336, lying within and along its lower east side.

NOTE: Bearings noted herein are true geodetic bearings based on Global Positioning System (GPS) and Global Navigation Satellite System (GNSS) observations (WGS '84 Datum).

Surveyed: November 12, 2007 - April 29, 2008 and April 25 - 29, 2013.

Field Crew Personnel: Spencer J. Burrell
Michael J. Koch
Ferd John Rock

THE STATE OF TEXAS)
COUNTY OF MEDINA)

I, Hilmar A. Koch, a Registered Professional Land Surveyor of the State of Texas, do hereby state that the foregoing Field Notes description and accompanying plat correctly represent an actual survey made under my supervision, on the ground, on the dates given.

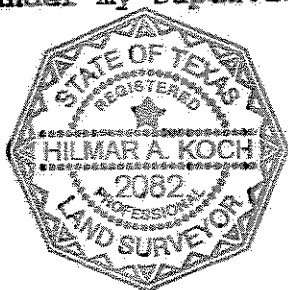

Hilmar A. Koch

Registered Professional
Land Surveyor No. 2082

William Story Ranch – Division Six Legal Description

Being 317.157 acres of land, known as Division No. Six, lying and being situated on and on both sides of graveled County Road No. 336, northwest of Sabinal, in Uvalde County, Texas; about 21.8 miles N 25° E of the City of Uvalde, the County Seat; and containing acreages in the various original Surveys, as follows:

Sur. No.	Original Grantee	Abst. No.	Acres
864	Mrs. Rebecca Tate	190	316.109
975	G.C. & S.F. R.R. Co.	968	1.043
---	Un-surveyed State Land	---	<u>0.005</u>
	Total Acres.....		317.157

said 317.157 acres being more particularly described by metes and bounds attached hereto and made a part hereof for all purposes.

KOCH & KOCH LAND SURVEYORS, INC.
P.O. BOX 246 707 FM 1796 D'HANIS, TEXAS 78850
Office: 830-363-7331 Fax: 830-363-7441
E-Mail: kochkoch@swtexas.net

WILLIAM DAVIS STORY
"DIVISION NO. SIX"
317.157 ACRE TRACT

THE STATE OF TEXAS)
COUNTY OF UVALDE)

Field Notes of a perimeter/boundary survey of a 317.157 acre tract of land, made for William Davis Story and The Nature Conservancy.

Said 317.157 acre tract of land, known as Division No. Six, lying and being situated on and on both sides of gravelled County Road No. 336, northwest of Sabinal, in Uvalde County, Texas; about 21.8 miles N 25° E of the City of Uvalde, the County Seat; and containing acreages in the various original surveys, as follows:

Sur. No.	Original Grantee	Abst. No.	Acres
864	Mrs. Rebecca Tate	190	316.109
975	G.C. & S.F. R.R. Co.	968	1.043
---	Un-surveyed State Land	----	0.005
Total Acres			317.157

Said 317.157 acre tract of land being all of a 50.000 acre tract (south portion of a 317.157 acre tract termed "Division No. Six"), as conveyed to William Davis Story, by Doris Esther Story and Kempner Davlin Story, Jr., by Gift Deeds (2) dated November 5, 2008, and recorded in Instrument Nos. 2008004317 and 2008004322, of the Official Public Records of said County, and all of 267.157 acres (remainder of said 317.157 acre tract termed "Division No. Six"), as conveyed to William Davis Story, by Kempner Davlin Story, Jr. and Doris Esther Story, by Gift Deeds (2) dated July 8, 2011, and recorded in Instrument Nos. 2011002077 and 2011002083, of the Official Public Records of said Uvalde County, Texas. Said 317.157 acre tract being bounded on the south by the Elizabeth Jean Howard 317.157 acre tract (termed "Division No. Two" -- Instrument Nos. 2008004314, 2008004319, 2011002073, & 2011002079, Official Public Records); on the west/southwest, from south to north, by the following: 1.) the Peggy Lynn Brink 317.157 acre tract [termed "Division No. Five" -- Instrument Nos. 2008004316, 2008004323, 2011002076, & 2011002082, Official Public Records], 2.) a 1.265 acre

Cont. Page 2 of 6, William Davis Story -- 317.157 Acre Tract.

"Water Well" tract [this date surveyed -- middle portion of the Kempner Davlin Story, Jr. "called" 1906.75 acres -- Vol. 262, Pages 414-417, Deed Records and Vol. 368, Pages 714-717, Official Public Records], and 3.) the said Peggy Lynn Brink 317.157 acre tract; on the north by the Jack D. Story, et ux. 413.876 acre tract, as recorded in Instrument No. 2009004251, of the Official Public Records of said County; and on the east by the John McNair Family 2012 Irrevocable Trust (McNair) 782.710 acre tract, as recorded in Instrument No. 2012004443, of the Official Public Records of said Uvalde County. Said 317.157 acre tract being more fully described by metes and bounds, as follows:

BEGINNING at a 5/8" Steel Pin set at a 3-way fence corner post, at a S.E. corner of said Jack Story 413.876 acre tract, the upper N.W. corner of said McNair 782.710 acre tract; for the N.N.E. corner of said William Story 317.157 acre tract, and the N.N.E. corner of this tract; said 5/8" Steel Pin being distant 105.17 ft. N 86° 20' 35" W of the N.E. corner of said Sur. No. 864, a southwest re-entrant corner of said Sur. No. 975;

THENCE leaving the south side of said Jack Story 413.876 acre tract; and with fence (unless noted) and the upper west side of said McNair 782.710 acre tract; along the east side of said William Story 317.157 acre tract, and the east side of this tract, with the center of cedar fence corner posts, found at corners (unless noted), as follows:

S 04° 48' 45" W, at 1156.09 ft. cross the east line of said Sur. No. 864, a middle west line of said Sur. No. 975; total 1374.53 ft. to a 5/8" Steel Pin set at a fence corner post, for corner;

S 11° 04' 51" W 898.62 ft. to a 5/8" Steel Pin set at a fence corner post, for corner;

S 08° 30' 52" W 151.55 ft.;

S 08° 03' 10" W 326.75 ft.;

S 09° 11' 45" W 1017.43 ft. to a 5/8" Steel Pin set at a 3-way fence corner post, for corner;

S 19° 46' 16" W, passing under electric transmission lines bearing N 82° 45' 41" W into this described tract, 137.50 ft. to a 5/8" Steel Pin set at a fence corner post, for corner;

Cont. Page 3 of 6, William Davis Story -- 317.157 Acre Tract.

S 19° 17' 56" W, at 54.32 ft. re-cross the east line of said Sur. No. 864, a middle west line of said Sur. No. 975; total 231.49 ft.;

S 34° 53' 20" W 35.90 ft. to a 3-way fence corner post, for corner;

S 68° 53' 37" W 304.16 ft. to a fence corner post, found on the north side of said County Road No. 336, at the W.N.W. corner of said McNair 782.710 acre tract, for corner;

S 06° 37' 25" E, crossing said County Road, 46.27 ft. to a cedar fence corner post, found on the south side of said County Road No. 336, for corner;

S 07° 42' 36" E, crossing Blanco Creek, 207.90 ft. to a fence post found at the south terminal of existing fence, at the base of a bluff, for corner;

N 78° 10' 05" E, unfenced, with line of old fence and the base of said bluff, 177.68 ft. to an old 2-way fence corner post at the base of said bluff, for corner;

S 20° 22' 25" E 92.01 ft. to a dead 8" cedar tree 3-way fence corner; and

THENCE S 10° 31' 00" E, at 46.29 ft. cross the east line of said Sur. No. 864, the west line of said un-surveyed State Land; total 92.59 ft. to a 2-way cedar fence corner post found in the southwest side of said McNair 782.710 acre tract; for the N.N.E. corner of said Howard 317.157 acre tract, the S.S.E. corner of said William Story 317.157 acre tract, and the S.S.E. corner of this tract;

THENCE leaving fence and said McNair property line; and with the upper north side of said Howard 317.157 acre tract; along the lower south side of said William Story 317.157 acre tract, and the lower south side of this tract, S 89° 12' 46" W, unfenced, at 12.95 ft. re-cross said last-mentioned survey line; total 908.60 ft. to an 8" Nail Spike set flush in the center of said County Road No. 336; at the S.S.E. corner of said Brink 317.157 acre tract, the E.N.E. corner of the Jack Douglas Story 317.157 acre tract (termed "Division No. Four" -- Instrument Nos. 2008004312, 2008004321, 2011002075, & 2011002081, Official Public Records); for the N.N.W. corner of said Howard 317.157 acre tract, the S.S.W. corner of said William Story 317.157 acre tract, and the S.S.W. corner of this tract; said 8" Nail Spike being distant 17.07 ft. N 89° 08' 28" E (with the north line of said

Jack Story 317.157 acre tract, the south line of said Brink 317.157 acre tract) of a 5/8" Steel Pin set on the west side of said County Road;

THENCE with the centerline of said County Road No. 336 and the lower east side of said Brink 317.157 acre tract (until noted); the south, east, and north sides of said 1.265 acre "Water Well" tract; and the northeast side of said Brink 317.157 acre tract, respectively; along the west side of said William Story 317.157 acre tract, and the west side of this tract, unfenced (unless noted), with angle points in the center of said County Road, at corners (no pins set until noted), as follows:

N 04° 17' 31" E 55.56 ft.;

N 21° 24' 30" E 129.00 ft.;

N 35° 17' 57" E 91.62 ft.;

N 41° 46' 32" E, re-crossing said Blanco Creek, 53.78 ft.;

N 72° 59' 15" E, at 39.33 ft. pass an 8" Nail Spike set flush in the center of said County Road, at an east corner of said Brink 317.157 acre tract, the S.S.W. corner of said 1.265 acre "Water Well" tract, and thence with the south side of said "Water Well" tract (until noted); total 64.00 ft.;

N 88° 20' 54" E 124.75 ft. to an 8" Nail Spike set flush in the center of said County Road, at the S.E. corner of said 1.265 acre "Water Well" tract, a northwest re-entrant corner of this tract;

N 01° 22' 27" E, leaving the center of said County Road, and with the east side of said "Water Well" tract; at 17.08 ft. pass a 5/8" Steel Pin set on line, on the north side of said County Road No. 336; total 196.57 ft. to a 5/8" Steel Pin set at the N.E. corner of said "Water Well" tract, for corner;

S 87° 54' 57" W, now with the north side of said "Water Well" tract, 89.75 ft. to a 5/8" Steel Pin set in a north/south fence, in the north side of said "Water Well" tract, at a S.E. corner of said Brink 317.157 acre tract, for a S.W. corner of said William Story 317.157 acre tract, and a S.W. corner of this tract;

N 18° 52' 54" W, with field fence, leaving the north side of said 1.265 acre "Water Well" tract, and continuing with the northeast side of said Brink 317.157 acre tract (until noted), passing under electric transmission lines bearing N 67° 54' 56" E into this described tract, and thence passing under another electric

Cont. Page 5 of 6, William Davis Story -- 317.157 Acre Tract.

transmission line bearing S 23° 28' 55" E into this described tract, 461.56 ft. to a 5/8" Steel Pin set at a 3-way fence corner post, for corner;

N 89° 49' 39" W, with field fence, re-passing under last-mentioned electric transmission line, 125.13 ft. to a 5/8" Steel Pin set at a fence corner post, for corner;

N 77° 05' 22" W, with field fence, 210.34 ft. to a 5/8" Steel Pin set at a double 20" Live Oak tree fence corner, for corner;

S 70° 39' 54" W, with field fence, 219.32 ft. to a 5/8" Steel Pin set at a 32" Elm tree fence corner, for corner;

N 31° 48' 34" W, leaving said field fence, now and continuing unfenced; passing under electric transmission lines bearing N 68° 20' 38" E into this described tract; and thence ascending a mountain ridge, 678.49 ft. to a 5/8" Steel Pin set on said mountain ridge, for corner;

N 18° 14' 36" E, ascending and along the top of said ridge, 1102.12 ft. to a 5/8" Steel Pin set on the west side of the top of said mountain, for corner;

S 84° 20' 07" W, descending said mountain, and crossing a draw, 1350.00 ft. to a 5/8" Steel Pin set in a flat, for corner;

N 60° 09' 32" W 1274.04 ft. to a 5/8" Steel Pin set for corner; and

THENCE N 11° 32' 43" W, crossing and re-crossing Bailey Creek, 1356.01 ft. to a 5/8" Steel Pin set at a 3-way fence corner post; at an angle point in the south side of said Jack Story 413.876 acre tract; for a N.E. corner of said Brink 317.157 acre tract, the W.N.W. corner of said William Story 317.157 acre tract, and the W.N.W. corner of this tract;

THENCE leaving the northeast side of said Brink 317.157 acre tract; and with fence and the south side of said Jack Story 413.876 acre tract; along the north side of said William Story 317.157 acre tract, and the north side of this tract, as follows:

N 85° 44' 30" E 454.65 ft. to a 5/8" Steel Pin set at a fence corner post, for corner;

N 40° 39' 59" E 511.04 ft. to a 5/8" Steel Pin set at a fence corner post, for corner;

S 66° 59' 25" E 331.12 ft. to the center of a 10" cedar fence corner post, for corner;

Cont. Page 6 of 6, William Davis Story -- 317.157 Acre Tract.

N 41° 52' 10" E 709.07 ft. to the center of an 8" cedar fence corner post, for corner;

S 41° 00' 48" E 51.06 ft. to the center of a 10" Spanish Oak tree fence corner;

S 78° 26' 28" E 688.29 ft. to the center of a 7" Cedar tree fence corner;

S 81° 45' 39" E 1079.32 ft. to the center of a 4" Live Oak tree fence corner;

S 78° 56' 42" E 745.63 ft. to the center of a 16" Blue Oak tree fence corner;

S 85° 15' 19" E 224.57 ft. to the center of a 12" Blue Oak tree fence corner;

S 75° 59' 01" E 50.10 ft. to the center of a 12" Cedar tree fence corner;

S 81° 46' 30" E 352.17 ft. to the center of a dead 8" Cedar tree fence corner; and

THENCE S 74° 48' 11" E 88.36 ft. to the place of BEGINNING:

NOTE: This described 317.157 acre tract is subject to portions of gravelled County Road No. 336, passing through its south portion and lying within and along its lower west side.

NOTE: Bearings noted herein are true geodetic bearings based on Global Positioning System (GPS) and Global Navigation Satellite System (GNSS) observations (WGS '84 Datum).

Surveyed: November 12, 2007 - April 29, 2008 and April 25 - 29, 2013.

Field Crew Personnel: Spencer J. Burrell
Michael J. Koch
Ferd John Rock

THE STATE OF TEXAS)
COUNTY OF MEDINA)

I, Hilmar A. Koch, a Registered Professional Land Surveyor of the State of Texas, do hereby state that the foregoing Field Notes description and accompanying plat correctly represent an actual survey made under my supervision, on the ground, on the dates given.

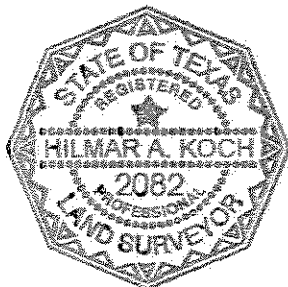

Hilmar A. Koch

Registered Professional
Land Surveyor No. 2082

Kempner Story Ranch Legal Description

Tract One: Being a 18.203 acre tract of land, known as the "House" tract, lying and being situated on and northeast of graveled County Road No. 336, northwest of Sabinal, in Uvalde County, Texas; about 21.8 miles N 25° E of the City of Uvalde, the County Seat; and containing 0.157 acre lying within Survey No. 267, Saragossa Irr. & Mfg. Co., Original Grantee, Abstract No. 591, and 18.046 acres lying within Survey No. 1524, Luis Castanon, Original Grantee, Abstract No. 129. Said 18.203 acre tract being more particularly described by metes and bounds in Exhibit "A" attached hereto and made a part hereof for all purposes.

Tract Two: Being a 2.933 acre tract of land, known as the "Spring Area" tract, lying and being situated east of County Road No. 336, northwest of Sabinal, in Uvalde County, Texas; about 21.8 miles N 25° E of the City of Uvalde, the County Seat; all within Survey No. 1524, Luis Castanon, Original Grantee, Abstract No. 129. Said 2.933 acre tract being more particularly described by metes and bounds in Exhibit "B" attached hereto and made a part hereof for all purposes.

Tract Three: Being a 1.265 acre tract of land, known as the "Water Well" tract, lying and being situated on and north of graveled County Road No. 336, northwest of Sabinal, in Uvalde County, Texas; about 21.8 miles N 25° E of the City of Uvalde, the County Seat; all within Survey No. 864, Mrs. Rebecca Tate, Original Grantee, Abstract No. 1900. Said 1.265 acre tract being more particularly described by metes and bounds in Exhibit "C" attached hereto and made a part hereof for all purposes.

KOCH & KOCH LAND SURVEYORS, INC.
P.O. BOX 246 707 FM 1796 D'HANIS, TEXAS 78850
Office: 830-363-7331 Fax: 830-363-7441
E-Mail: kochkoch@swtexas.net

KEMPNER DAVLIN "BILL" STORY, JR.
18.203 ACRE HOUSE TRACT

Exhibit "A"

THE STATE OF TEXAS)
COUNTY OF UVALDE)

Field Notes of a perimeter/boundary survey of an 18.203 acre tract of
land, made for Kempner Davlin "Bill" Story, Jr. and
The Nature Conservancy.

Said 18.203 acre tract of land, known as the "House" tract, lying and being situated on and northeast of gravelled County Road No. 336, northwest of Sabinal, in Uvalde County, Texas; about 21.8 miles N 25° E of the City of Uvalde, the County Seat; and containing 0.157 acre lying within Sur. No. 267, Saragossa Irr. & Mfg. Co., Original Grantee, Abst. No. 591, and 18.046 acres lying within Sur. No. 1524, Luis Castanon, Original Grantee, Abst. No. 129. Said 18.203 acre tract of land being a south middle portion of the same land referred to as 1906.75 acres, designated as No. "2", as conveyed to Kempner Davlin Story, Jr., by Jack D. Story, et. al., by Judgment (Cause No. 14,684) dated February 25, 1985, and recorded in Vol. 262, Pages 414-417, of the Deed Records of said Uvalde County, Texas (partially described in Vol. 116, Pages 182-184, Deed Records), and as conveyed to Doris Esther Story (1/2 interest), by Kempner Davlin Story, Jr., by Gift Deed dated August 13, 1996, and recorded in Vol. 368, Pages 714-717, of the Official Public Records of said Uvalde County. Said 18.203 acre house tract being bounded on the north and southeast by the Sharon Anne McCauley 317.157 acre tract (termed "Division No. One" -- Instrument Nos. 2008004315, 2008004318, 2011002072, & 2011002078, Official Public Records); on the south by the Leonard M. Bond 192.20 acre tract, as recorded in Vol. 237, Pages 190-194, of the Deed Records of said County; and on the southwest by the centerline of said County Road No. 336, same being the lower northeast side of the Elizabeth Jean Howard 317.157 acre tract (termed "Division No. Two" -- Instrument Nos. 2008004314, 2008004319, 2011002073, & 2011002079, Official Public Records). Said 18.203 acre tract fully encompassing the Bill Story home and improvements, with

Cont. Page 2 of 4, Bill Story -- 18.203 Acre House Tract.

no overlapping thereof, and being more fully described by metes and bounds, as follows:

BEGINNING at a point (in said Sur. No. 267) in the center of a cattleguard, in the centerline of said County Road No. 336, in the north side of said Bond 192.20 acre tract, the south side of said Story "called" 1906.75 acres (both as fenced and occupied); for the E.S.E. corner of said Howard 317.157 acre tract, and the S.W. corner of this tract; said point being distant 9.04 ft. S 89° 28' 04" W (with said property line) of the center of a 4" Steel Pipe fence post, found on the east side of said cattleguard and said County Road; with said beginning point also being distant 438.74 ft. S 49° 05' 40" E of the N.W. corner of said Sur. No. 267, the lower N.E. corner of Sur. No. 961, T. C. R.R. Co., in the south line of said Sur. No. 1524;

THENCE leaving said cattleguard, the north side of said Bond 192.20 acre tract, and the south side of said Story "called" 1906.75 acres; and with the centerline of said County Road No. 336, along the lower northeast side of said Howard 317.157 acre tract, and the westernmost southwest side of this tract, unfenced, with angle points at corners (no pins set), as follows:

N 07° 57' 28" W 79.30 ft.;
N 24° 57' 04" W, at 35.67 ft. cross the north line of said
Sur. No. 267, the south line of said Sur. No. 1524; total 85.01 ft.;
N 34° 52' 17" W, passing under electric transmission lines
bearing N 29° 30' 48" E across this described tract, 102.32 ft.;
N 40° 38' 51" W 270.16 ft.; and

THENCE N 41° 35' 03" W 166.00 ft. to an 8" Nail Spike set flush
in the center of said County Road, in the lower northeast side of
said Howard 317.157 acre tract, at the westernmost South corner of
said McCauley 317.157 acre tract; for the West/W.N.W. corner of this
tract;

THENCE leaving the centerline of said County Road No. 336 and the lower northeast side of said Howard 317.157 acre tract; and with

Cont. Page 3 of 4, Bill Story -- 18.203 Acre House Tract.

a south side of said McCauley 317.157 acre tract, along the north side of this tract, unfenced (unless noted), as follows:

N 55° 03' 17" E, at 6.64 ft. pass a 5/8" Steel Pin set on line on the northeast side of said County Road; crossing Blanco Creek; at 275.91 ft. pass the centerline of the south terminal of a 40.00 ft. wide waterline easement (this date surveyed -- crossing said McCauley 317.157 acre tract -- waterline access from 2.933 acre "Spring Area" tract [this date surveyed] to this described tract); total 375.36 ft. to a 5/8" Steel Pin set for corner;

S 86° 21' 44" E, re-passing under said electric transmission lines, 588.34 ft. to a 5/8" Steel Pin set at the base of a multi-trunked Live Oak tree fence corner;

S 70° 47' 12" E 343.12 ft. to the center of a 20" Live Oak tree 2-way fence corner; and

THENCE S 46° 59' 34" E, with fence, 292.26 ft. to the center of a 14" Live Oak tree 2-way fence corner, at a west re-entrant corner of said McCauley 317.157 acre tract; for the N.E. corner of this tract;

THENCE with fence; and with west and northwest sides of said McCauley 317.157 acre tract; along the east and southeast sides of this tract, as follows:

S 12° 20' 47" E 17.61 ft. to the center of a 15" Live Oak tree 2-way fence corner, at the easternmost corner of this described tract;

S 05° 12' 39" W 28.00 ft. to the center of a 16" Live Oak tree 3-way fence corner; and

THENCE S 45° 10' 10" W, crossing a field, 743.78 ft. to a Steel Pipe 3-way fence corner post, in the north side of said Bond 192.20 acre tract, the south side of said Story "called" 1906.75 acres (as fenced and occupied); for a West corner of said McCauley 317.157 acre tract, and the easternmost South/S.E. corner of this tract;

THENCE with fence and the north side of said Bond 192.20 acre

Cont. Page 4 of 4, Bill Story -- 18.203 Acre House Tract.

tract; along the south side of said Story "called" 1906.75 acres (as fenced and occupied), and the south side of this tract, as follows:

N 50° 33' 42" W 364.31 ft. to the center of a 4" Steel Pipe 3-way fence corner post, for corner;
S 62° 44' 10" W 208.32 ft. to the center of a 16" Pecan tree 2-way fence corner;
S 89° 09' 43" W 39.24 ft. to said 4" Steel Pipe fence post, found on the east side of said County Road No. 336, for corner;
and

THENCE S 89° 28' 04" W, entering said County Road, 9.04 ft. to the place of BEGINNING:

NOTE: This described 18.203 acre tract is subject to the east/northeast one-half of a portion of gravelled County Road No. 336, lying within and along its entire westernmost southwest side.

NOTE: Bearings noted herein are true geodetic bearings based on Global Positioning System (GPS) and Global Navigation Satellite System (GNSS) observations (WGS '84 Datum).

Surveyed: November 12, 2007 - April 29, 2008 and April 25 - 29, 2013.

Field Crew Personnel: Spencer J. Burrell
Michael J. Koch
Ferd John Rock

THE STATE OF TEXAS)
COUNTY OF MEDINA)

I, Hilmar A. Koch, a Registered Professional Land Surveyor of the State of Texas, do hereby state that the foregoing Field Notes description and accompanying plat correctly represent an actual survey made under my supervision, on the ground, on the dates given.

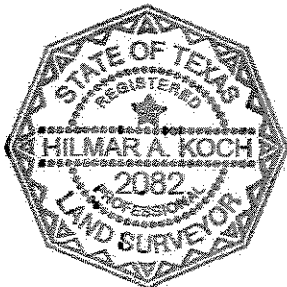

Hilmar A. Koch
Registered Professional
Land Surveyor No. 2082

KOCH & KOCH LAND SURVEYORS, INC.
P.O. BOX 246 707 FM 1796 D'HANIS, TEXAS 78850
Office: 830-363-7331 Fax: 830-363-7441
E-Mail: kochkoch@swtexas.net

KEMPNER DAVLIN "BILL" STORY, JR.
2.933 ACRE SPRING AREA TRACT

EXHIBIT "B"

THE STATE OF TEXAS)
COUNTY OF UVALDE)

Field Notes of a perimeter/boundary survey of a 2.933 acre tract of
land, made for Kempner Davlin "Bill" Story, Jr. and
The Nature Conservancy.

Said 2.933 acre tract of land, known as the "Spring Area" tract,
lying and being situated east of County Road No. 336, northwest of
Sabinal, in Uvalde County, Texas; about 21.8 miles N 25° E of the
City of Uvalde, the County Seat; all within Sur. No. 1524, Luis
Castanon, Original Grantee, Abst. No. 129. Said 2.933 acre spring
area tract of land being a middle portion of the same land referred
to as 1906.75 acres, designated as No. "2", as conveyed to Kempner
Davlin Story, Jr., by Jack D. Story, et.al., by Judgment (Cause No.
14,684) dated February 25, 1985, and recorded in Vol. 262, Pages 414-
417, of the Deed Records of said Uvalde County, Texas (partially
described in Vol. 116, Pages 182-184, Deed Records), and as conveyed
to Doris Esther Story (1/2 interest), by Kempner Davlin Story, Jr.,
by Gift Deed dated August 13, 1996, and recorded in Vol. 368, Pages
714-717, of the Official Public Records of said Uvalde County. Said
2.933 acre spring area tract being bounded on the north and east by
the Elizabeth Jean Howard 317.157 acre tract (termed "Division No.
Two" -- Instrument Nos. 2008004314, 2008004319, 2011002073, &
2011002079, Official Public Records); and on the southeast and west
by the Sharon Anne McCauley 317.157 acre tract (termed "Division No.
One" -- Instrument Nos. 2008004315, 2008004318, 2011002072, &
2011002078, Official Public Records). Said 2.933 acre spring area
tract fully encompassing a natural spring, located on the southwest
slope of a mountain, and being more fully described by metes and
bounds, as follows:

BEGINNING at a 5/8" Steel Pin set on the east side of Blanco
Creek, near the bottom of the southwest side of a mountain, at a

Cont. Page 2 of 3, Bill Story -- 2.933 Acre Spring Area Tract.

north re-entrant corner of said McCauley 317.157 acre tract; for the South/S.W. corner of this tract; said 5/8" Steel Pin being distant 563.04 ft. S 62° 07' 22" E of an 8" Nail Spike set flush in the center of said County Road No. 336, at the East re-entrant corner of said Howard 317.157 acre tract, the Westernmost West corner of said McCauley 317.157 acre tract; and being distant 4424.76 ft. N 53° 32' 05" W of another 5/8" Steel Pin found at a 2-way fence corner post, at the S.S.E. corner of said Story "called" 1906.75 acres (as fenced and occupied); with said beginning 5/8" Steel Pin also being distant 1078.50 ft. N 73° 36' 07" E of the West/S.W. corner of said Sur. No. 1524, the East re-entrant corner of Sur. No. 961, T. C. R.R. Co.;

THENCE with an east line of said McCauley 317.157 acre tract; along the west side of this tract, N 15° 17' 21" W, unfenced, along the east side of said Blanco Creek, 666.85 ft. to a 5/8" Steel Pin set on the northeast side of said Creek, at a southeast re-entrant corner of said Howard 317.157 acre tract, the westernmost N.E. corner of said McCauley 317.157 acre tract; for the N.W. corner of this tract;

THENCE with an upper south line of said Howard 317.157 acre tract; along the north side of this tract, N 74° 42' 40" E, unfenced, ascending a bluff of said mountain, 150.00 ft. to a point (no pin set) on the west steep slope of said mountain, at a southwest re-entrant corner of said Howard 317.157 acre tract; for the N.E. corner of this tract;

THENCE with a west/southwest line of said Howard 317.157 acre tract; along the east/northeast side of this tract, S 29° 02' 43" E, unfenced, 511.09 ft. to a 5/8" Steel Pin set on the southwest slope of said mountain, at an angle point in the upper northwest side of said McCauley 317.157 acre tract, a South corner of said Howard 317.157 acre tract; for the S.E./East corner of this tract;

THENCE with an upper northwest side of said McCauley 317.157 acre tract; along the southeast side of this tract, S 42° 35' 49" W, unfenced, descending said southwest slope, at 286.75 ft. pass the centerline of the north terminal of a 40.00 ft. wide waterline

Cont. Page 3 of 3, Bill Story -- 2.933 Acre Spring Area Tract.

easement (this date surveyed -- crossing said McCauley 317.157 acre tract -- waterline access from this described tract to an 18.203 acre "House" tract [this date surveyed]); total 320.58 ft. to the place of BEGINNING:

NOTE: Bearings noted herein are true geodetic bearings based on Global Positioning System (GPS) and Global Navigation Satellite System (GNSS) observations (WGS '84 Datum).

Surveyed: November 12, 2007 - April 29, 2008 and April 25 - 29, 2013.

Field Crew Personnel: Spencer J. Burrell
Michael J. Koch
Ferd John Rock

THE STATE OF TEXAS)
COUNTY OF MEDINA)

I, Hilmar A. Koch, a Registered Professional Land Surveyor of the State of Texas, do hereby state that the foregoing Field Notes description and accompanying plat correctly represent an actual survey made under my supervision, on the ground, on the dates given.

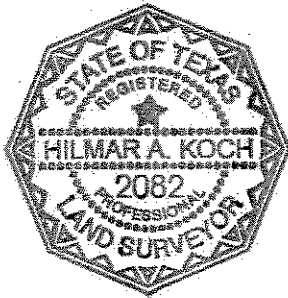

Hilmar A. Koch
Registered Professional
Land Surveyor No. 2082

KOCH & KOCH LAND SURVEYORS, INC.
P.O. BOX 246 707 FM 1796 D'HANIS, TEXAS 78850
Office: 830-363-7331 Fax: 830-363-7441
E-Mail: kochkoch@swtexas.net

KEMPNER DAVLIN "BILL" STORY, JR.
1.265 ACRE WATER WELL TRACT

Exhibit "C"

THE STATE OF TEXAS)
COUNTY OF UVALDE)

Field Notes of a perimeter/boundary survey of a 1.265 acre tract of
land, made for Kempner Davlin "Bill" Story, Jr. and
The Nature Conservancy.

Said 1.265 acre tract of land, known as the "Water Well" tract, lying
and being situated on and north of gravelled County Road No. 336,
northwest of Sabinal, in Uvalde County, Texas; about 21.8 miles
N 25° E of the City of Uvalde, the County Seat; all within Sur. No.
864, Mrs. Rebecca Tate, Original Grantee, Abst. No. 1900. Said 1.265
acre water well tract being a middle portion of the same land
referred to as 1906.75 acres, designated as No. "2", as conveyed to
Kempner Davlin Story, Jr., by Jack D. Story, et al., by Judgment
(Cause No. 14,684) dated February 25, 1985, and recorded in Vol. 262,
Pages 414-417, of the Deed Records of said Uvalde County, Texas
(partially described in Vol. 116, Pages 182-184, Deed Records), and
as conveyed to Doris Esther Story (1/2 interest), by Kempner Davlin
Story, Jr., by Gift Deed dated August 13, 1996, and recorded in Vol.
368, Pages 714-717, of the Official Public Records of said Uvalde
County. Said 1.265 acre water well tract being bounded on the east
and south by the William Davis Story 317.157 acre tract (termed
"Division No. Six" -- Instrument Nos. 2008004317, 2008004322,
2011002077, & 2011002083, Official Public Records); on the southwest
by the Peggy Lynn Brink 317.157 acre tract (termed "Division No.
Five" -- Instrument Nos. 2008004316, 2008004323, 2011002076, &
2011002082, Official Public Records); and on the north, from west to
east, by the said Brink 317.157 acre tract and the said William Story
317.157 acre tract. Said 1.265 acre tract fully encompassing a
domestic water well, an old camp house, and a mobile home, with no
overlapping of improvements, and being more fully described by metes
and bounds, as follows:

BEGINNING at an 8" Nail Spike set flush in the center of said County
Road No. 336, at the lower northwest re-entrant corner of said
William Story 317.157 acre tract; for the S.E. corner of this tract;
said 8" Nail Spike being distant 158.46 ft. S 09° 28' 54" E of the
center of said domestic water well, and being distant 4483.90 ft.
S 16° 30' 49" W of a 5/8" Steel Pin set at a 3-way fence corner post,

at the upper N.E. corner of said Story "called" 1906.75 acres; with said 8" Nail Spike also being distant 935.42 ft. N 30° 57' 27" W of the S.E. corner of said Sur. No. 864, the W.S.W. corner of an un-surveyed State Land tract, in the upper north line of Sur. No. 961, T. C. R.R. Co.;

THENCE with the centerline of said County Road No. 336; along a lower north line of said William Story 317.157 acre tract, and the south side of this tract, unfenced, S 88° 20' 54" W 124.75 ft. to a point in the centerline of said road, for corner, and S 72° 59' 15" W 24.67 ft. to an 8" Nail Spike set flush in the center of said County Road, at a lower east corner of said Brink 317.157 acre tract; for the S.S.W. corner of this tract;

THENCE leaving the centerline of said County Road No. 336 and the lower north/northwest side of said William Story 317.157 acre tract; and with a lower northeast side of said Brink 317.157 acre tract; along the southwest side of this tract, unfenced (until noted), as follows:

N 55° 13' 59" W 32.08 ft. to a 5/8" Steel Pin set on line, on the northwest side of said County Road;

N 55° 13' 59" W, leaving said Road, 130.27 ft. to a 5/8" Steel Pin set at a 10" Live Oak tree 2-way fence corner; and

THENCE N 44° 14' 55" W, now with fence, 140.64 ft. to a 5/8" Steel Pin set at a 2-way fence corner post, at a southeast re-entrant corner of said Brink 317.157 acre tract; for the N.W. corner of this tract;

THENCE with south lines of said Brink 317.157 acre tract and said William Story 317.157 acre tract, respectively; along the north side of this tract, N 87° 54' 55" E, with fence, passing under electric transmission lines bearing S 67° 54' 56" W into this described tract, 295.01 ft. to a 5/8" Steel Pin set in a north/south fence, at the E.S.E. corner of said Brink 317.157 acre tract, a S.W. corner of said William Story 317.157 acre tract, and N 87° 54' 57" E, unfenced, 89.75 ft. to a 5/8" Steel Pin set at the lower southwest re-entrant corner of said William Story 317.157 acre tract; for the N.E. corner of this tract;

THENCE with a west line of said William Story 317.157 acre tract; along the east side of this tract, S 01° 22' 27" W, unfenced, at 40.94 ft. pass a point on line 29.84 ft. east of the center of said domestic water well; at 179.49 ft. pass a 5/8" Steel Pin set on

Cont. Page 3 of 3, Bill Story -- 1.265 Acre Water Well Tract.

line, on the north side of said County Road No. 336, and thence entering said County Road, an additional 17.08 ft.; for a total of 196.57 ft. to the place of BEGINNING:

NOTE: This described 1.265 acre tract is subject to the north one-half of a portion of gravelled County Road No. 336, lying within and along its entire south side.

NOTE: Bearings noted herein are true geodetic bearings based on Global Positioning System (GPS) and Global Navigation Satellite System (GNSS) observations (WGS '84 Datum).

Surveyed: November 12, 2007 - April 29, 2008 and April 25 - 29, 2013.

Field Crew Personnel: Spencer J. Burrell
Michael J. Koch
Ferd John Rock

THE STATE OF TEXAS)
COUNTY OF MEDINA)

I, Hilmar A. Koch, a Registered Professional Land Surveyor of the State of Texas, do hereby state that the foregoing Field Notes description and accompanying plat correctly represent an actual survey made under my supervision, on the ground, on the dates given.

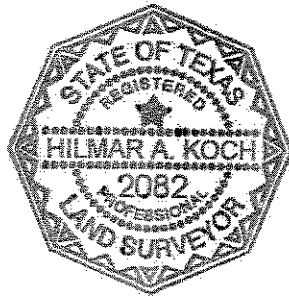

Hilmar A. Koch

Registered Professional
Land Surveyor No. 2082