

15+50 - 18+25  
SCALE: 1" = 20'

**PRELIMINARY**  
THIS DRAWING AND ANY PARTS THEREOF ARE NOT TO BE USED FOR CONSTRUCTION. THE GENERAL SCOPE OF THE PROJECT IS NOT A COMPLETED CONTRACT DOCUMENT.  
ROGER C. LAHMEID, P.E. LICENSE NO. 48411

**LOOP 1604 EAST BOUND ACCESS ROAD BRIDGE**

18+25 - MATCH LINE

<p><b>SLAY ENGINEERING CO., INC.</b> SURVEYING - CONSULTING CIVIL 123 ALTBELT AVENUE SAN ANTONIO, TEXAS 78201-1802 TYPE PRM REGISTRATION NO. F1901 FAX (210) 734-4401 SLAYENGINEERING.COM</p>	
<p><b>CITY OF SAN ANTONIO</b> PARKS AND RECREATION DEPARTMENT LEON CREEK LINEAR TRAIL EXTENSION C.O.S.A. PROJECT NO. 28-00813</p>	
<p><b>GRADING</b> SHEET 4 OF 14</p>	
<p>DATE: 11-07-14 SHEET NO.: C39</p>	<p>DRWN. BY: JVA SUBMITTAL: SLAY PROJECT NO.: 13-042 DSGN. BY: R.C.L. CHKD. BY: R.C.L.</p>

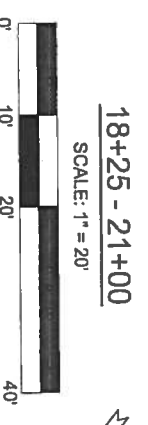
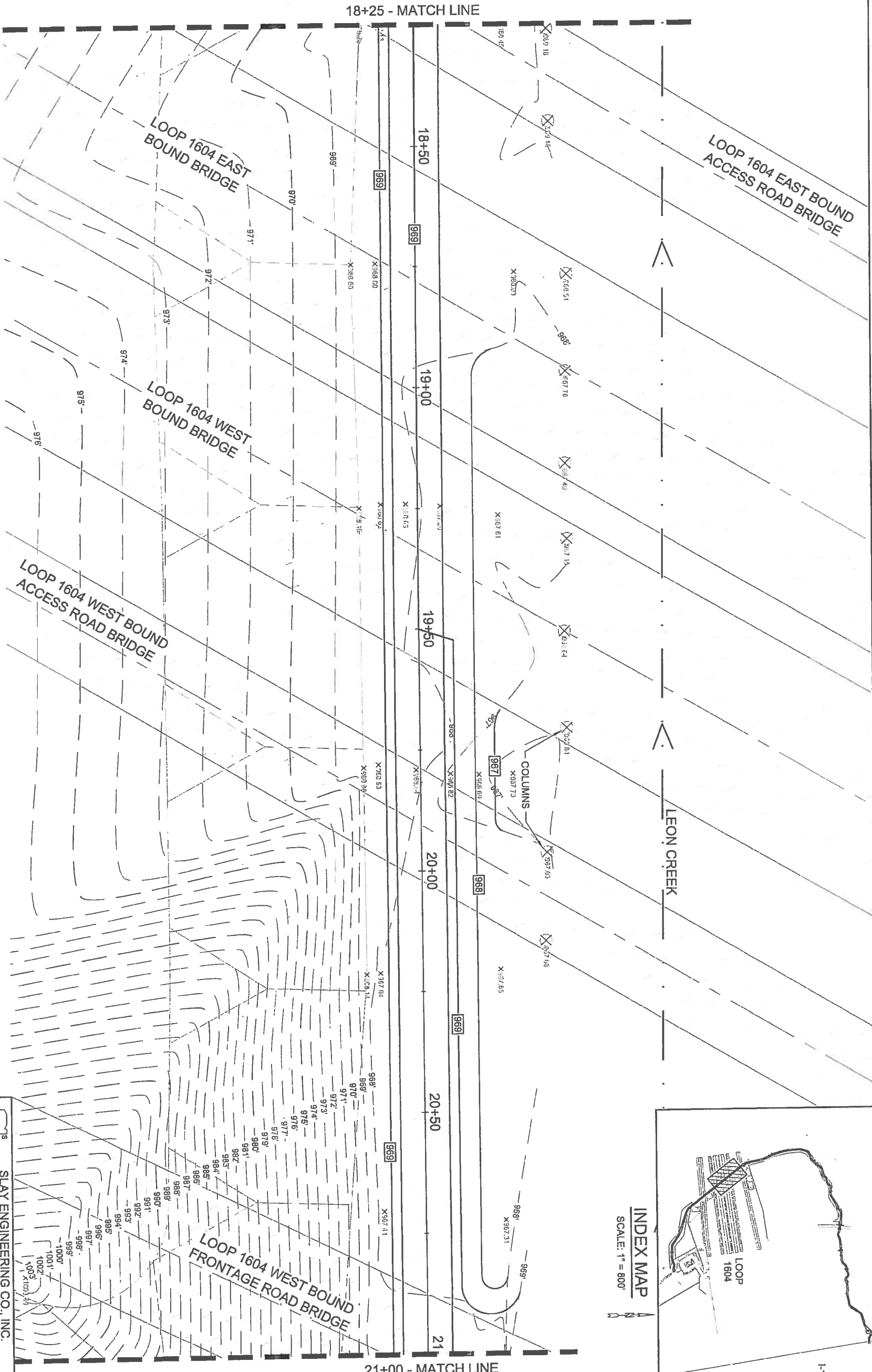

**PRELIMINARY**  
 NOT FOR CONSTRUCTION  
 THIS DRAWING INDICATES THE GENERAL SCOPE OF THE PROJECT. IT IS NOT A COMPLETED CONTRACT DOCUMENT.  
 ROBERT C. LAWRENCE,  
 P.E. LICENSE NO. 48411

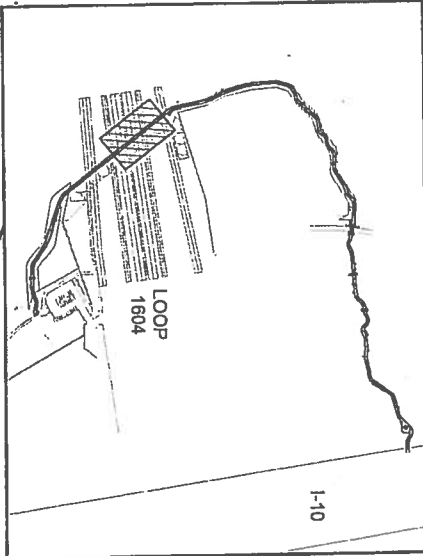

<p><b>SLAY ENGINEERING CO., INC.</b>                  CIVIL - SUPERVISING - CONSULTING                  123 ALTBELT AVENUE                  SAN ANTONIO, TEXAS 78201-1802                  TEL: (210) 734-4388                  FAX: (210) 734-4401                  SLAYENGINEERING.COM</p>	<p><b>CITY OF SAN ANTONIO</b>                  PARKS AND RECREATION DEPARTMENT                  LEON CREEK LINEAR TRAIL EXTENSION                  C.O.S.A. PROJECT NO.: 2500815</p>
<p>DATE: 11-07-14                  SHEET NO.: C40</p>	<p>DATE: 11-07-14                  SHEET NO.: C40</p>

LOOP 1604 WEST BOUND FRONTAGE ROAD BRIDGE

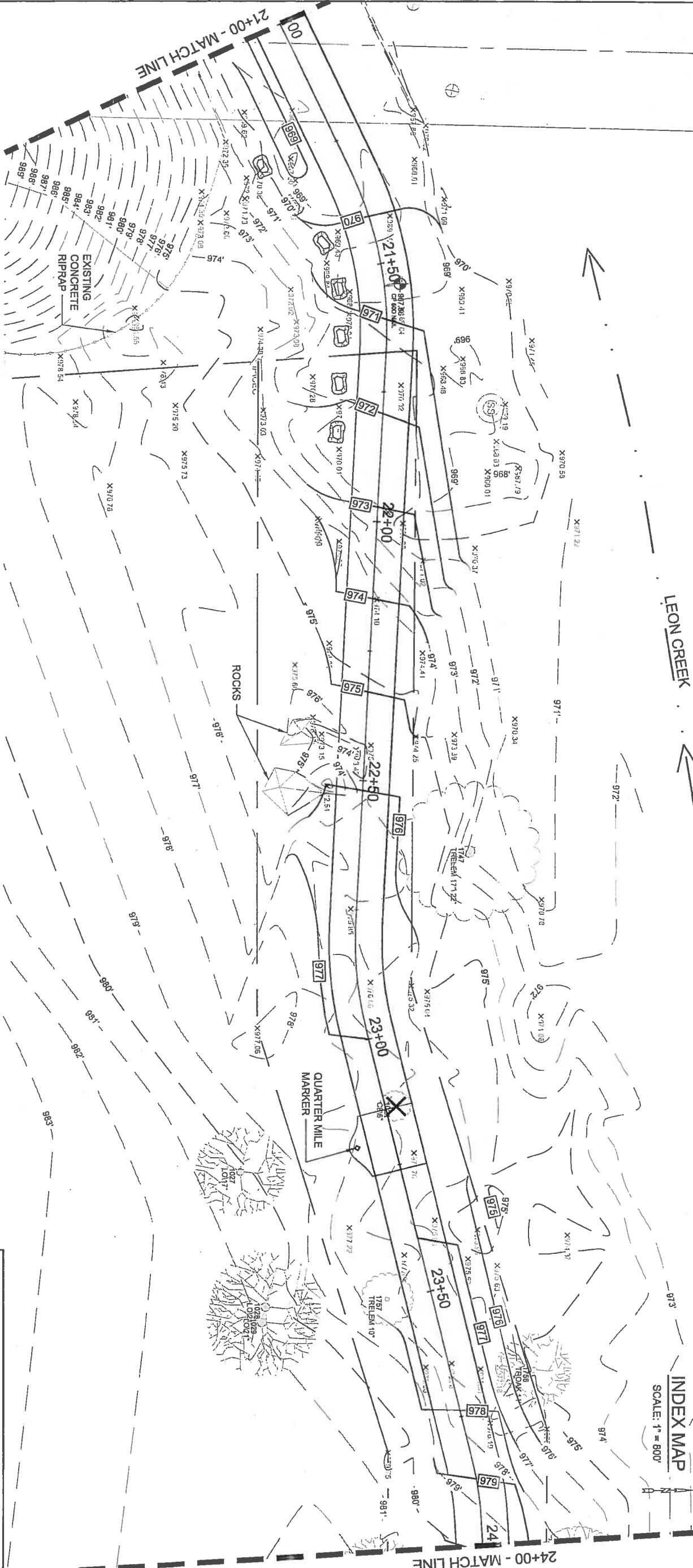

LEON CREEK

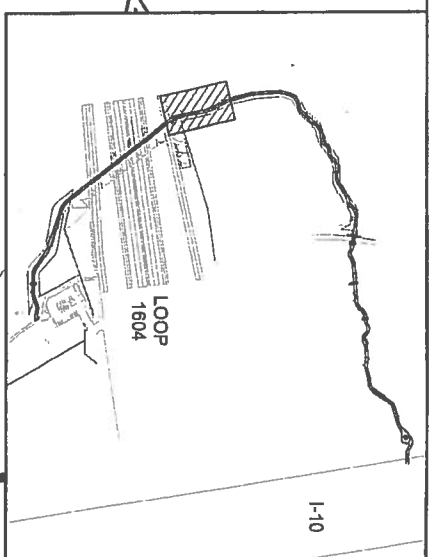
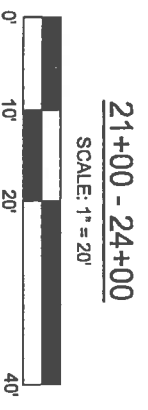

**PRELIMINARY**  
 THIS DRAWING INDICATES  
 THE DESIGN CONCEPT AND  
 THE PROJECT. IT IS NOT A  
 COMPLETED CONTRACT  
 DOCUMENT.  
 ROGER C. LAWHEAD,  
 P.E. LICENSE NO. 44411

 <b>SLAY ENGINEERING CO., INC.</b> CIVIL SURVEYING & CONSULTING 123 ALBERT AVENUE SAN ANTONIO, TEXAS 78201-8822 TEL: (512) 734-4388 FAX: (512) 734-8801 SLAYENGINEERING.COM	
CITY OF SAN ANTONIO PARKS AND RECREATION DEPARTMENT LEON CREEK LINEAR TRAIL EXTENSION C.O.S.A. PROJECT NO.: 28-00613	
<b>GRADING</b> SHEET 8 OF 14	
SUBMITTAL DRAWN BY: JVA DSGN BY: R.C.L. CHKD BY: R.C.L.	SLAY PROJECT NO.: 13442 DATE: 11-07-14 SHEET NO.: C41

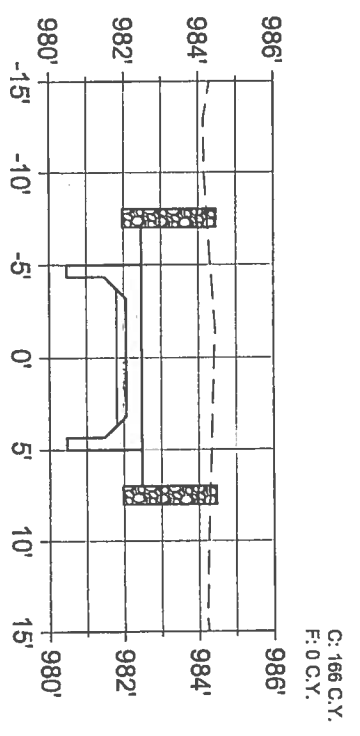

**13+00**  
C: 38.58 S.F.  
F: 0.00 S.F.

C: 85 C.Y.  
F: 2 C.Y.

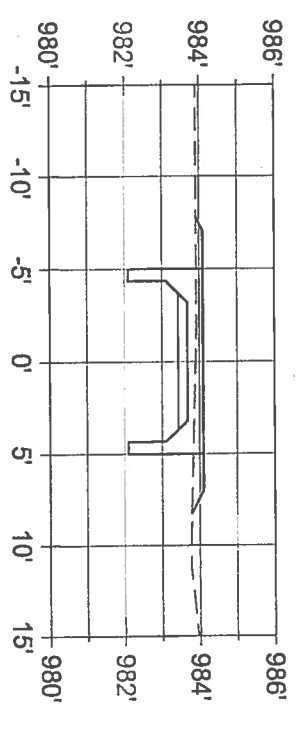

**12+00**  
C: 6.56 S.F.  
F: 1.20 S.F.

C: 26 C.Y.  
F: 3 C.Y.

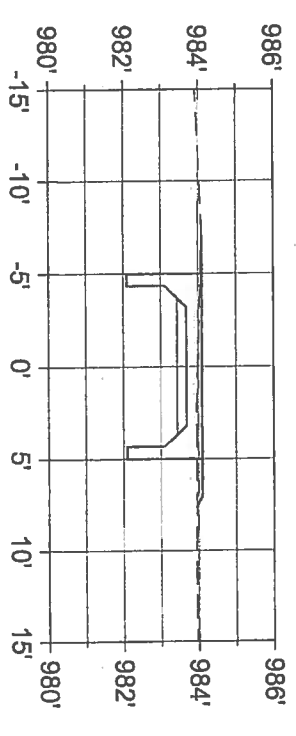

**11+00**  
C: 7.59 S.F.  
F: 0.40 S.F.

C: 31 C.Y.  
F: 1 C.Y.

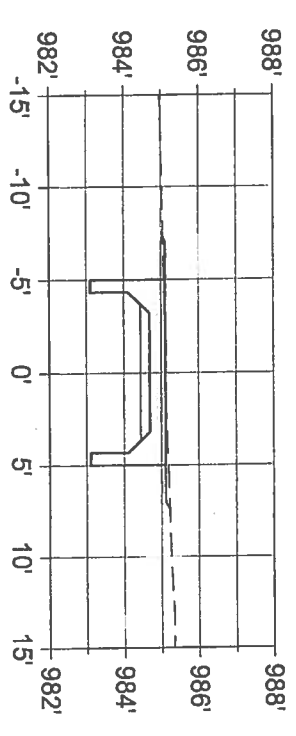

**10+00**  
C: 8.95 S.F.  
F: 0.11 S.F.

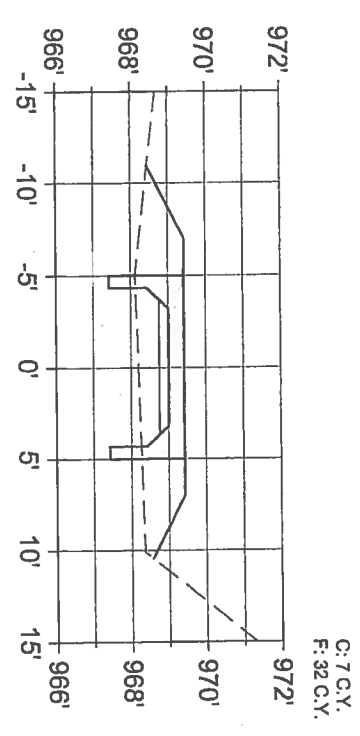

**17+00**  
C: 1.03 S.F.  
F: 14.02 S.F.

C: 20 C.Y.  
F: 28 C.Y.

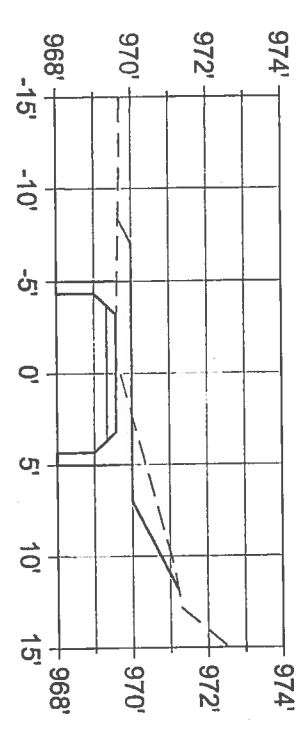

**16+00**  
C: 9.51 S.F.  
F: 0.98 S.F.

C: 28 C.Y.  
F: 4 C.Y.

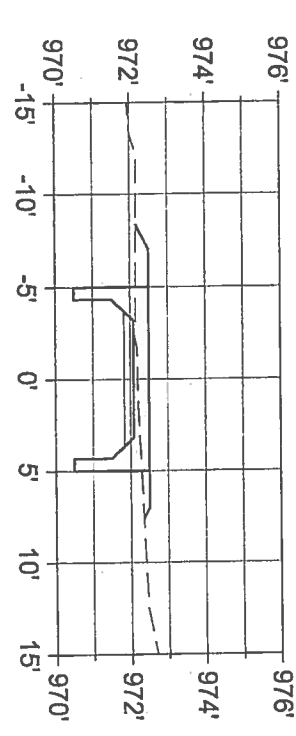

**15+00**  
C: 5.65 S.F.  
F: 1.37 S.F.

C: 103 C.Y.  
F: 3 C.Y.

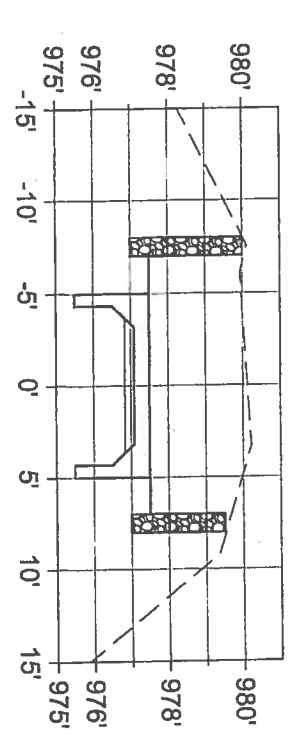

**14+00**  
C: 49.85 S.F.  
F: 0.00 S.F.

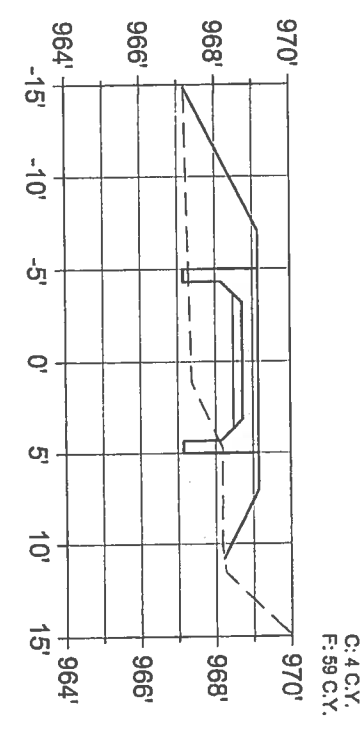

**20+00**  
C: 0.78 S.F.  
F: 23.36 S.F.

C: 5 C.Y.  
F: 80 C.Y.

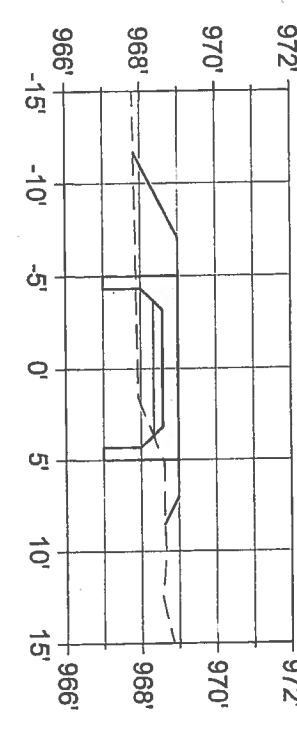

**19+00**  
C: 1.76 S.F.  
F: 8.79 S.F.

C: 8 C.Y.  
F: 23 C.Y.

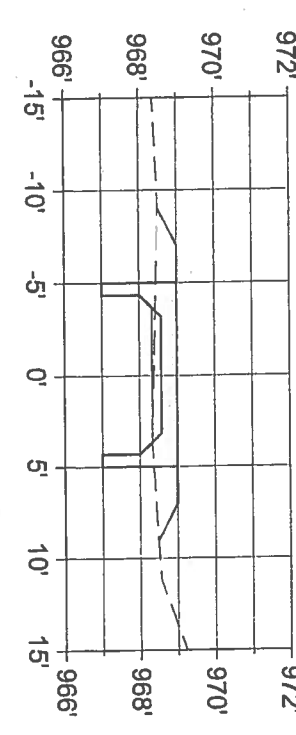

**18+00**  
C: 2.53 S.F.  
F: 3.43 S.F.

**SCALES**  
HORIZONTAL SCALE: 1" = 10'  
VERTICAL SCALE: 1" = 5'

**PRELIMINARY**  
THIS DRAWING INDICATES THE GENERAL SCOPE OF THE PROJECT. IT IS NOT A COMPLETED CONTRACT DOCUMENT.  
ROGER C. LAWRENCE  
P.E. LICENSE NO. 46411



**SLAY ENGINEERING CO., INC.**  
CIVIL - SURVEYING CONSULTING  
153 ALTHEA T. AVENUE  
SAN ANTONIO, TEXAS 78201-1602  
TELEPHONE: (210) 734-4386  
FAX: (210) 734-4401  
SLAYENGINEERING.COM

**CITY OF SAN ANTONIO**  
PARKS AND RECREATION DEPARTMENT  
LEON CREEK LINEAR TRAIL EXTENSION  
C.O.S.A. PROJECT NO.: 28-00613

**CROSS SECTIONS**  
SHEET 1 OF 4

DRWN. BY: JVA	DESIGN. BY: R.C.L.	CHECK. BY: R.C.L.	DATE: 11-07-14
SUBMITTAL	SLAY PROJECT NO.: 13-042		SHEET NO.: C50

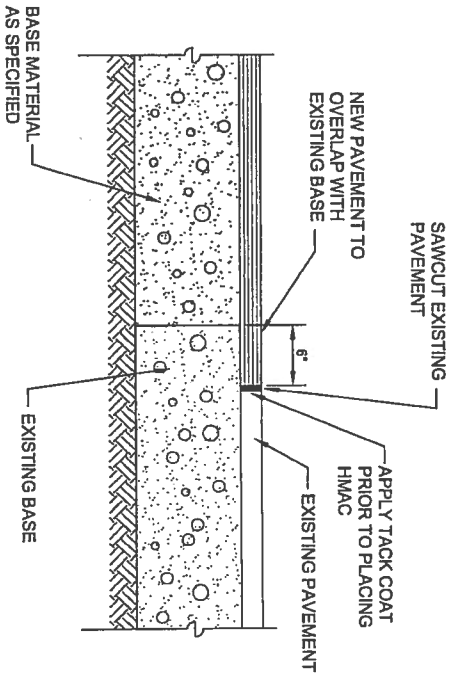

**1** NEW ASPHALT TO EXISTING ASPHALT PAVEMENT  
D1  
NTS

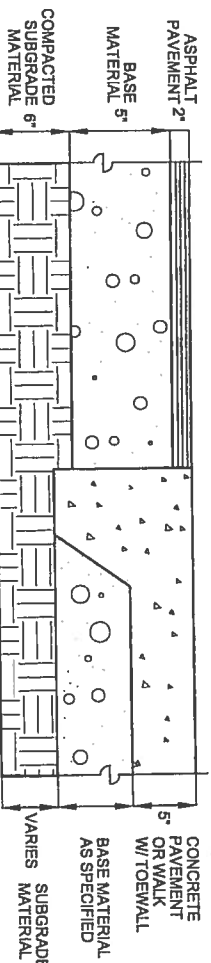

**2** CONCRETE TO ASPHALT PAVEMENT  
D1  
NTS

NOTES:  
1. WHERE CURB ABUTS SIDEWALKS AND OR CONCRETE PAVEMENT JOINTS SHALL MATCH, UNLESS OTHERWISE SHOWN ON PLANS.  
2. SUBGRADE COMPACTED TO 90% PER TEX 114-E.

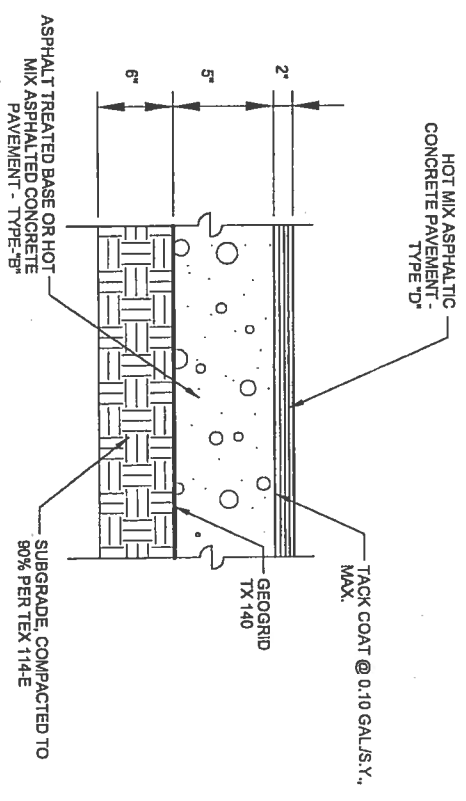

**4** ASPHALT PAVEMENT  
D1  
NTS

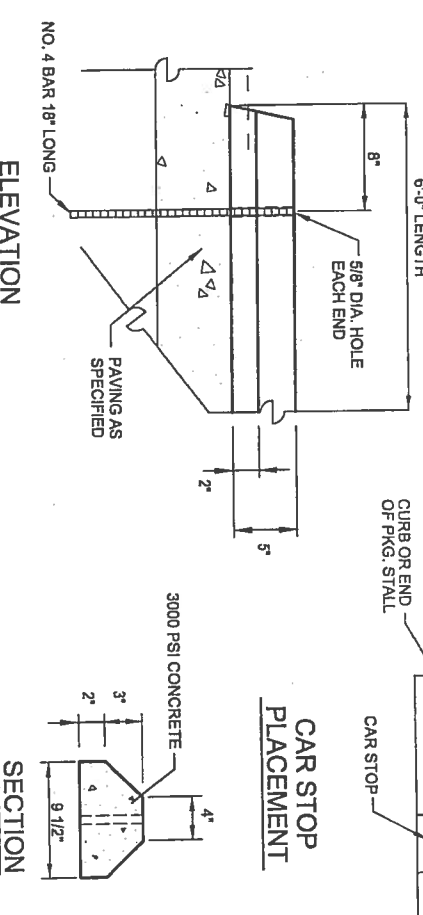

**5** CAR STOP  
D1  
NTS

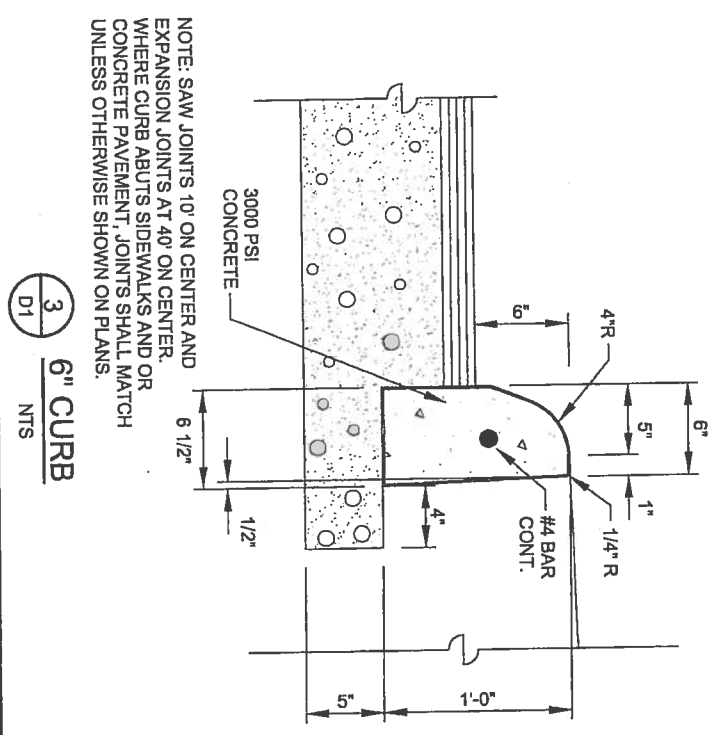

**3** 6" CURB  
D1  
NTS

NOTE: SAW JOINTS 10' ON CENTER AND EXPANSION JOINTS AT 40' ON CENTER. WHERE CURB ABUTS SIDEWALKS AND OR CONCRETE PAVEMENT, JOINTS SHALL MATCH UNLESS OTHERWISE SHOWN ON PLANS.

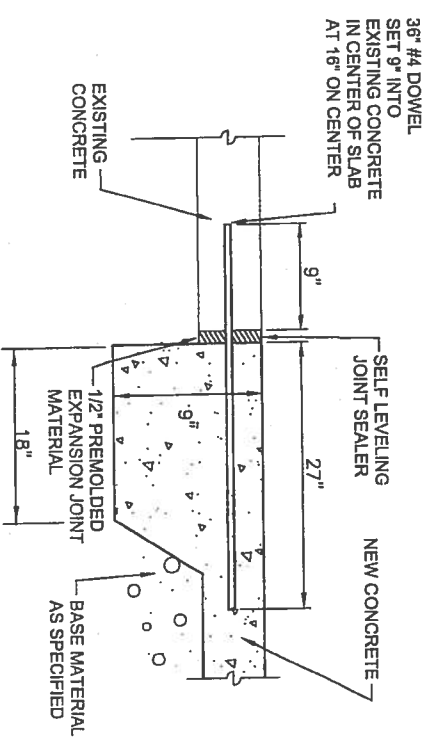

**6** NEW CONCRETE TO EXISTING CONCRETE  
D1  
NTS

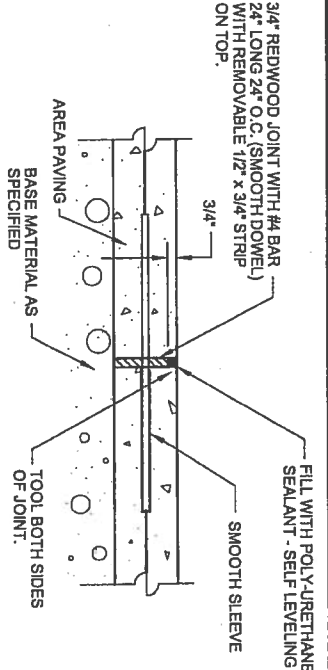

**7** CONCRETE JOINTS  
D1  
NTS

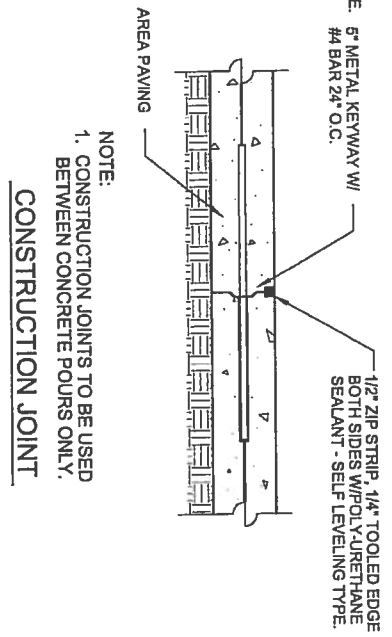

**CONSTRUCTION JOINT**

NOTE: SAW CUT JOINTS BETWEEN 18 AND 30 HOURS AFTER CONCRETE POUR.

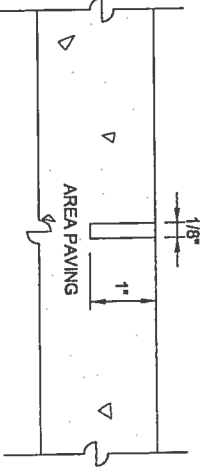

**SAW JOINT**

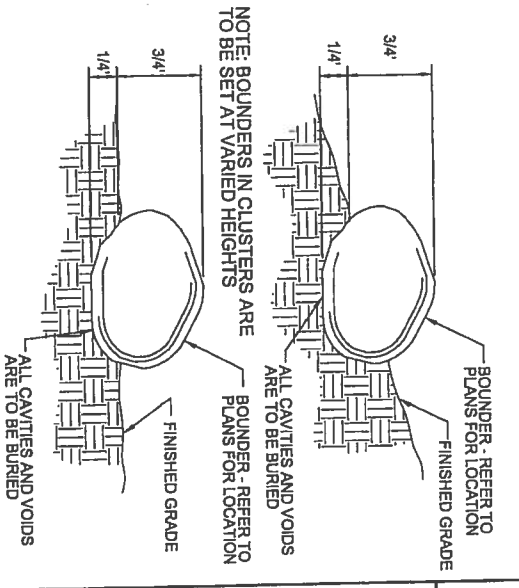

**8** BOULDER BARRIER  
D1  
NTS

PRELIMINARY  
NOT FOR CONSTRUCTION  
THESE PLANS AND SPECIFICATIONS  
ARE THE PROPERTY OF SLAY ENGINEERING  
THE DESIGN CONCEPT AND  
THE GENERAL SCOPE OF  
THE PROJECT IS NOT A  
CONTRACT DOCUMENT.  
PROB. C. L. J. 4/14/10  
P.E. LICENSE NO. 44111



SLAY ENGINEERING CO., INC.  
CIVIL - SURVEYING - CONSULTING  
123 ALBERT AVENUE  
SAN ANTONIO, TEXAS 78201-1802  
TYPE FROM REGISTRATION NO. F1901  
TELEPHONE (210) 734-4388  
FAX (210) 734-4301  
SLAYENGINEERING.COM

CITY OF SAN ANTONIO  
PARKS AND RECREATION DEPARTMENT  
LEON CREEK LINEAR TRAIL EXTENSION  
C.O.S.A. PROJECT NO. 26-00613

SPECIAL DETAILS - D1  
SHEET 1 OF 4

DATE:	10-31-14
SUBMITTAL:	SLAY/PROJECT NO. 13002
DRWN. BY:	J.V.A.
DSGN. BY:	R.C.L.
CHKD. BY:	R.C.L.
SHEET NO.:	C54

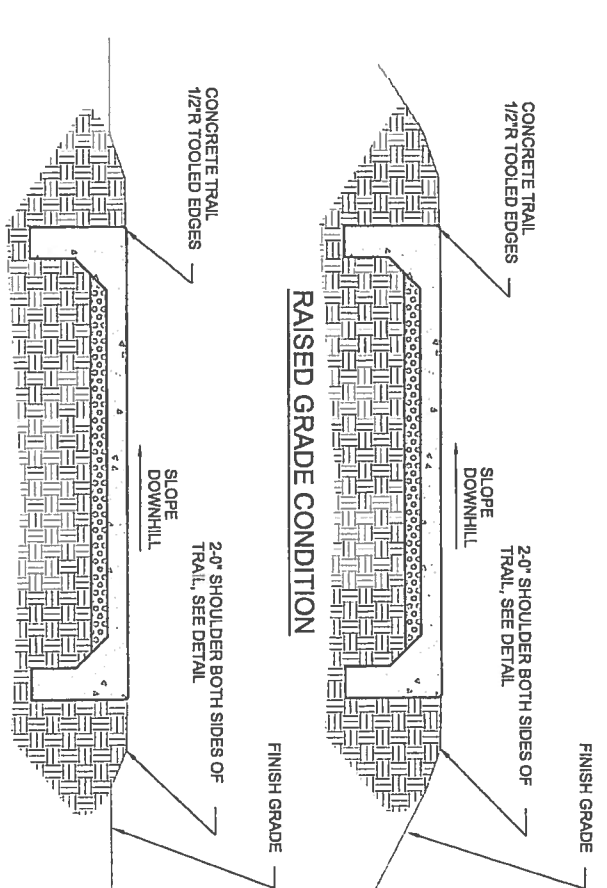

AT GRADE CONDITION

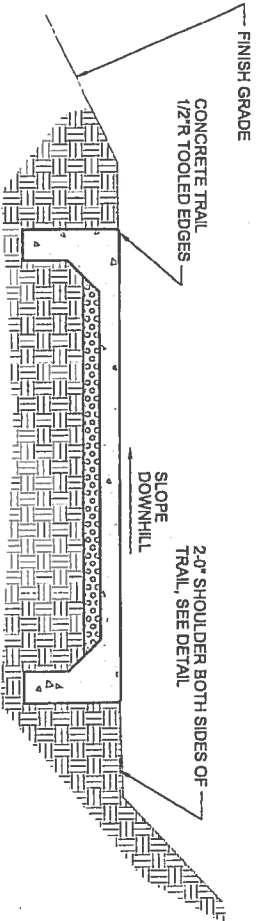

1 CONCRETE PAVED TRAIL SECTIONS  
NTS

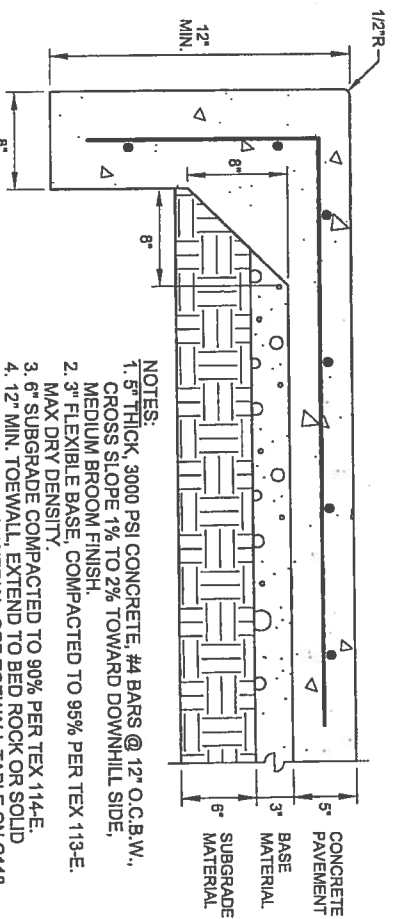

1 CONCRETE TRAIL & TOEWALL  
NTS

- NOTES:
1. 5" THICK, 3000 PSI CONCRETE, #4 BARS @ 12" O.C.B.W., CROSS SLOPE 1% TO 2% TOWARD DOWNHILL SIDE, MEDIUM BROOM FINISH.
  2. 3" FLEXIBLE BASE, COMPACTED TO 95% PER TEX 113-E.
  3. MAX DRY DENSITY.
  4. 6" SUBGRADE COMPACTED TO 90% PER TEX 114-E.
  5. 12" MIN. TOEWALL, EXTEND TO BED ROCK OR SOLID UNDISTURBED MATERIAL. SEE TOEWALL TABLE ON C118.

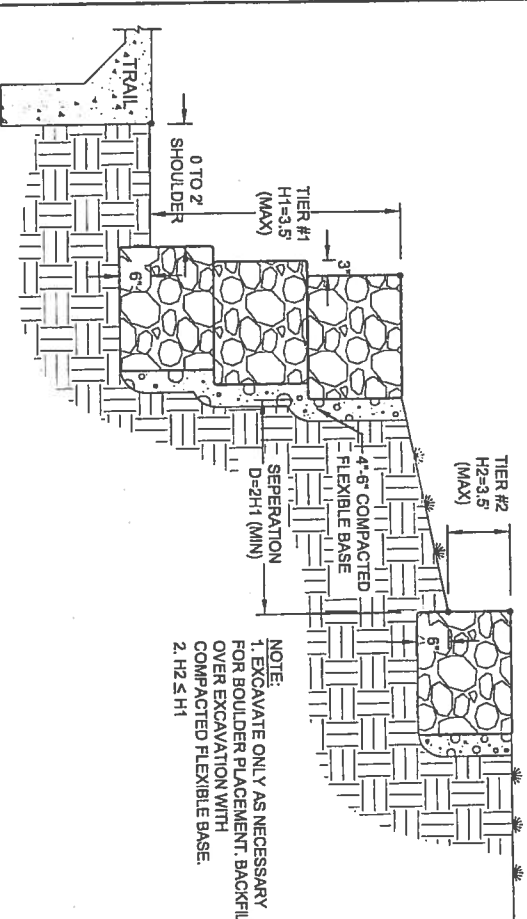

3 BOULDER RETAINING WALL  
NTS

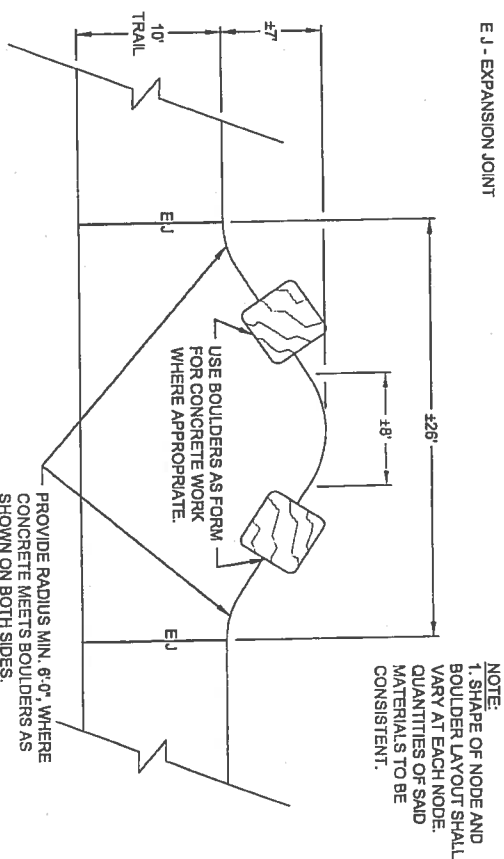

4 TRAIL REST AREA  
NTS

2 CROSSWALK STRIPING DETAIL  
NTS

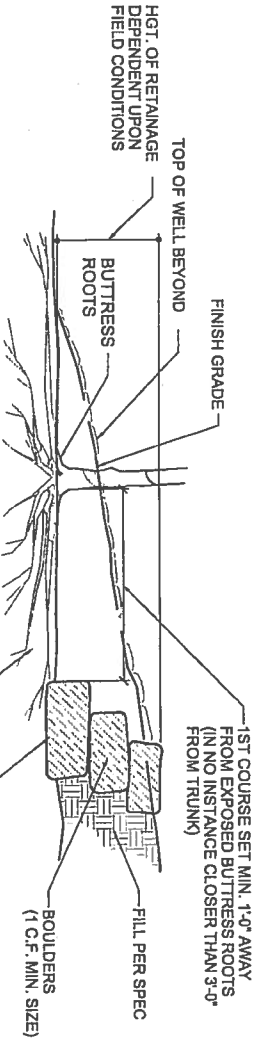
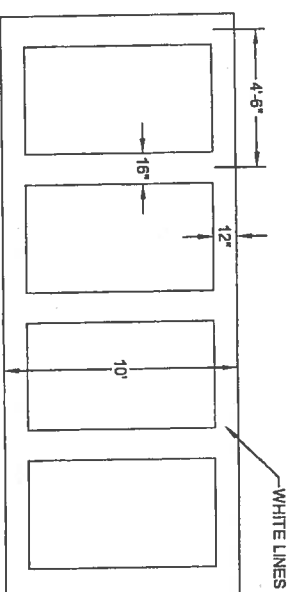

NOTE:  
PROVIDE TREE WELL WHERE GRADING REQUIRES FILL AT EXISTING TREE WHEN TOE OF FILL CANNOT BE BENCHED BACK @ 3:1; LAYOUT TO BE CONFIRMED W/ OWNER REP.

FILL CONDITION

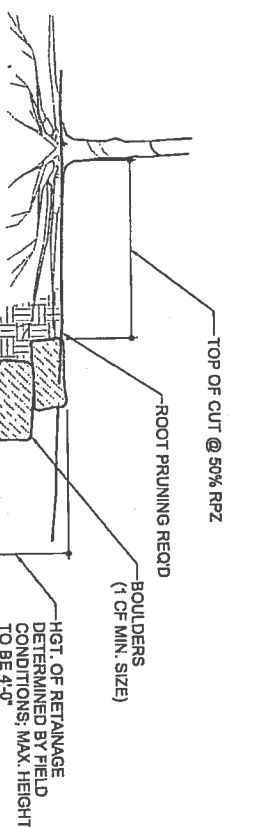

NOTE:  
PROVIDE RETAINAGE WHERE GRADING REQUIRES CUT AT EXISTG. TREE AND CUT CANNOT BE SLOPED @ 3:1. LAYOUT TO BE CONFIRMED W/ OWNER REPRESENTATIVE

CUT CONDITION

PRELIMINARY  
THIS DRAWING INDICATES THE GENERAL CONCEPT AND THE GENERAL SCOPE OF A CONCEPT CONTRACT DOCUMENT.  
P.E. LICENSE NO. 46411



SLAY ENGINEERING CO., INC.  
CIVIL SURVEYING CONSULTING  
123 ALTHELT AVENUE  
SAN ANTONIO, TEXAS 78201-1892  
PHONE FROM REGISTRATION NO. F1801  
FAX (210) 734-4801  
SLAYENGINEERING.COM

CITY OF SAN ANTONIO  
PARKS AND RECREATION DEPARTMENT  
LEON CREEK GREENWAY NORTH (VALERO TRAIL HEAD) to I-10  
C.O.S.A. PROJECT NO.: 26-00813

SPECIAL DETAILS - D2  
SHEET 2 OF 4

DATE:	11-20-14
SHEET NO.:	C55
CHKD. BY:	R.C.L.
DSGN. BY:	R.C.L.
DRWN. BY:	J.V.A.
SUBMITTAL:	SLAY PROJECT NO.: 13442

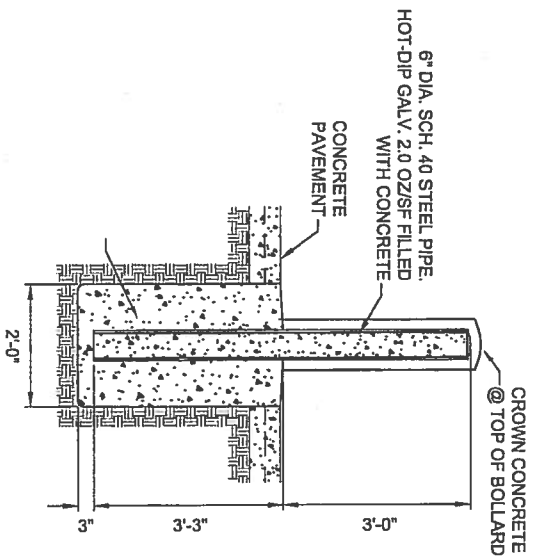

1 PIPE BOLLARD  
D3  
NTS

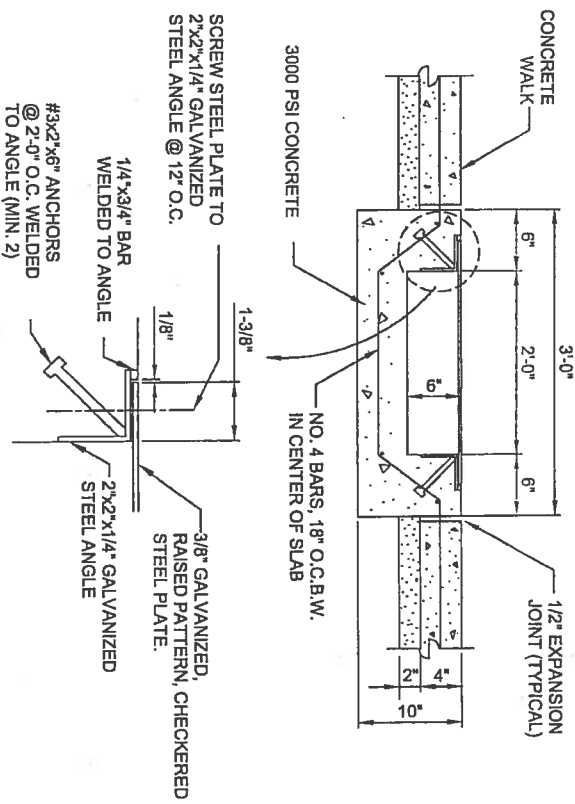

2 SIDEWALK TRENCH DRAIN  
D3  
NTS

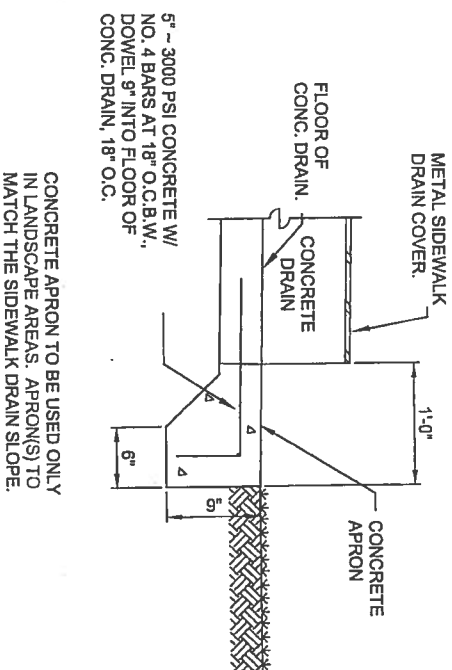

PRELIMINARY  
NOT FOR CONSTRUCTION  
THIS DRAWING IS FOR INFORMATION ONLY AND THE GENERAL SCOPE OF THE PROJECT IT IS NOT A CONTRACT DOCUMENT  
ROBERT C. LAWRENCE  
P.E. LICENSE NO. 48411



SLAY ENGINEERING CO., INC.  
CIVIL - SURVEYING - CONSULTING  
123 ALTHEA AVENUE  
SAN ANTONIO, TEXAS 78201-1822  
TELEPHONE: (210) 734-4388  
FAX: (210) 734-6601  
SLAYENGINEERING.COM

CITY OF SAN ANTONIO  
PARKS AND RECREATION DEPARTMENT

LEON CREEK GREENWAY NORTH (VALERO TRAILHEAD) 10-1-10  
C.O.S.A. PROJECT NO.: 26-00813

SPECIAL DETAILS - D3

SHEET 3 OF 4

DATE:	11-20-14
SUBMITTAL	SLAY PROJECT NO.: 13442
DRWN. BY:	J.V.A.
DSGN. BY:	R.C.L.
CHKD. BY:	R.C.L.
SHEET NO.:	C56

**BOULDER WALL TABLE**

E OFFSET	LEFT					RIGHT					TOTAL	TOTAL	TOTAL
	BEGIN STATION	HEIGHT	END STATION	HEIGHT	LENGTH (FEET)	BEGIN STATION	HEIGHT	END STATION	HEIGHT	LENGTH (FEET)			
5 TO 7	12+80	1.0'	13+00	1.5'	10	12+50	1.0'	13+00	1.5'	10	1.25	12.50	
5 TO 7	13+00	1.5'	13+25	2.0'	25	13+00	1.5'	13+25	2.0'	25	1.75	43.75	
5 TO 7	13+25	2.0'	13+50	3.0'	25	13+25	2.0'	13+50	3.0'	25	2.50	62.50	
5 TO 7	13+50	3.0'	13+75	3.5'	25	13+50	3.0'	13+75	3.5'	25	3.25	81.25	
5 TO 7	13+75	3.5'	14+00	2.0'	25	13+75	3.5'	14+00	2.0'	25	2.75	68.75	
5 TO 7	14+00	2.0'	14+10	1.0'	10	14+00	2.0'	14+10	1.0'	10	1.50	15.00	
5 TO 20'	13+50	1.5'	13+75	2.5'	25	13+50	1.5'	13+75	2.5'	25	2.00	50.00	
5 TO 20'	13+75	2.5'	13+90	1.0'	15	13+75	2.5'	13+90	1.0'	15	1.75	26.25	
5 TO 7	14+30	1.0'	14+50	1.5'	20	14+30	1.0'	14+50	1.5'	20	1.25	25.00	
5 TO 7	14+50	1.5'	14+55	1.0'	5	14+50	1.5'	14+55	1.0'	5	1.75	43.75	
5 TO 7	29+80	1.5'	30+00	1.5'	20	29+80	1.5'	30+00	1.5'	20	1.50	43.75	
5 TO 7	37+50	1.5'	37+59	2.0'	9	37+50	1.5'	37+59	2.0'	9	1.75	15.75	
5 TO 7	37+57	2.0'	37+75	2.0'	8	37+57	2.0'	37+75	1.5'	25	2.00	16.00	
5 TO 7	37+75	2.0'	38+00	2.5'	25	37+75	2.0'	38+00	2.5'	25	2.25	56.25	
5 TO 7	38+00	2.5'	38+25	2.5'	25	38+00	2.5'	38+25	2.5'	25	2.50	62.50	
5 TO 7	38+25	2.5'	38+30	1.5'	5	38+25	2.5'	38+30	1.5'	5	2.00	10.00	
					TOTAL					TOTAL		TOTAL	
					277					320		613.75	

**BOULDER WALLS - SUMMARY**  
 WALL FACE = 1,222 S.F.  
 LENGTH = 592 L.F.  
 AVG. HEIGHT = 2.1 V.F.

**DRAINAGE CULVERT TABLE**

#	INV.	TRAIL			HEADWALLS (HW) AND BOULDER WALLS (BW)		APRON SIZE	PIPE # SIZE, LENGTH
		STATION	ELEVATION	SLOPE	LEFT SIDE	RIGHT SIDE		
1	982.10	11+85	984.10	2.00'	3.00'	HW 11+81 TO 11+89 = 8'	4X6'	12 LF = 2-12"
2	981.10	33+79	983.31	2.21'	3.21'	HW 33+75 TO 33+83 = 8'	4X6'	12 LF = 1-18"
3	981.10	34+14	983.31	2.21'	3.21'	HW 34+10 TO 34+18 = 8'	4X6'	12 LF = 1-18"
4	983.04	35+95	985.54	2.50'	3.50'	HW 35+91 TO 35+99 = 8'	4X7' D.S. IRREGULAR TRAPEZODIAL 5.5X8.5 U.S.	12 LF = 2 BARREL 3X2' IMBC
5	982.00	37+83	984.54	2.54'	3.54'	BW 37+50 TO 37+59 HW 37+49 TO 37+67 = 8' BW 37+87 TO 38+30	4X6'	12 LF = 2-12"
6	979.00	41+20	983.00	4.00'	5.00'	HW 40+87 TO 41+46 = 58'	4X50'	12 LF = 6 BARREL 6X3' IMBC

**PRELIMINARY**  
 NOT FOR CONSTRUCTION  
 THESE DRAWINGS AND NOTES  
 ARE THE PROPERTY OF SLAY ENGINEERING CO., INC.  
 AND ARE NOT TO BE REPRODUCED OR  
 COPIED IN ANY MANNER WITHOUT  
 THE WRITTEN CONSENT OF SLAY  
 ENGINEERING CO., INC.  
 ROGER C. LAUREN,  
 P.E. LICENSE NO. 48411



**SLAY ENGINEERING CO., INC.**  
 CIVIL SURVEYING & CONSULTING  
 1321 BELLEVILLE AVE., SUITE 1100  
 SAN ANTONIO, TEXAS 78204  
 TEL: (210) 734-4388 FAX: (210) 734-6601  
 SLAYENGINEERING.COM

**CITY OF SAN ANTONIO**  
 PARKS AND RECREATION DEPARTMENT  
 LEON CREEK LINEAR TRAIL EXTENSION  
 C.O.S.A. PROJECT NO.: 28-00913

**SPECIAL DETAILS - TABLES**

SHEET 4 OF 4  
 SUBMITTAL  
 DESIGN BY: JVA  
 R.C.L.  
 CHECK BY: R.C.L.  
 DATE: 10-31-14  
 SHEET NO.: 057



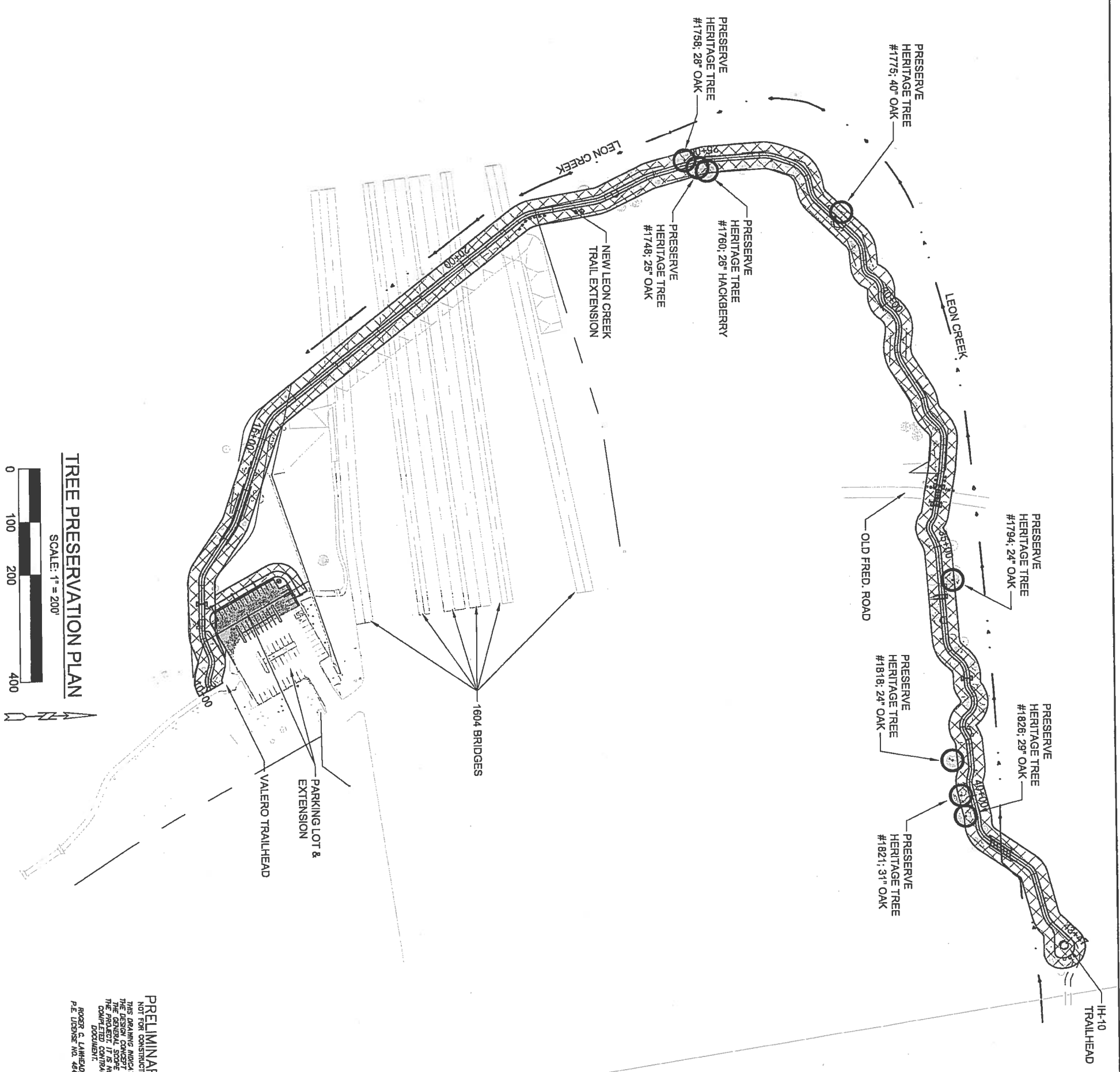

**LEGEND**

- HERITAGE TREE TO BE PRESERVED
- TRAIL CORRIDOR

**TREE PRESERVATION PLAN**

SCALE: 1" = 200'

**PRELIMINARY**  
 THIS DRAWING INDICATES  
 THE DESIGN CONCEPT AND  
 THE PARKER IT IS NOT A  
 COMPLETED CONTRACT  
 DOCUMENT.  
 ROGER C. LAHREDA,  
 P.E. LICENSE NO. 48411

**SLAY ENGINEERING CO., INC.**  
 CIVIL - SURVEYING AND CONSULTING  
 1708 RYAN REGISTRATION NO. F1901  
 SAN ANTONIO, TEXAS 78201-1802  
 TEL: (210) 734-4388 FAX: (210) 734-6601  
 SLAYENGINEERING.COM

**CITY OF SAN ANTONIO**  
 PARKS AND RECREATION DEPARTMENT

LEON CREEK GREENWAY NORTH (VALERO TRAILHEAD TO I-10)  
 C.O.S.A. PROJECT NO.: 28-00613

**TREE PRESERVATION PLAN**  
 SHEET 1 OF 5

SUBMITTAL	SLAY PROJECT NO.: 13-942	DATE:	11-20-14
DESIGN BY: JVA	DESIGN BY: R.C.L.	CHANGED BY: R.C.L.	SHEET NO.: C83

TREE PRESERVATION TABLE

STATION	E OFFSET	TREE TAG #	SIZE DBH (INCHES)	TREE SPECIES	REMOVE (R)	PRESERVE (P)	CANOPY AREA (SF)	REMOVED AREA (SF)	SIGNIFICANT 5' TO 23'		HERITAGE 12' AND 24' +						
									REMOVE (IN)	PRESERVE (IN)	REMOVE (IN)	PRESERVE (IN)					
10+04	11' RT	423	3"	TXP	-	P	7 SF	-	-	-	-	-					
10+35	11' LT	606	9"	MESQ	-	P	64 SF	-	-	-	-	-					
10+43	20' RT	434	3"	TXP	-	P	7 SF	-	-	-	-	-					
10+50	18' RT	439	3"	TXP	-	P	7 SF	-	-	-	-	-					
10+88	14' RT	605	11"	MESQ	-	P	95 SF	-	-	11'	-	-					
10+90	11' RT	8	11"	MESQ	-	P	88 SF	-	-	11'	-	-					
11+28	12' LT	27	9"	MESQ	-	P	64 SF	-	-	-	-	-					
11+30	19' RT	24	5"	TXP	-	P	20 SF	-	-	5'	-	-					
11+37	27' RT	23	7"	HACK	-	P	38 SF	-	-	-	-	-					
11+49	24' RT	30	5"	TXP	-	P	20 SF	-	-	5'	-	-					
11+63	10' RT	39	7"	HUI	-	P	38 SF	-	-	-	-	-					
11+84	4' LT	37	5"	TXP	R	-	20 SF	20 SF	-	5'	-	-					
11+94	26' RT	53	13"	HACK	-	P	133 SF	-	-	13'	-	-					
12+04	10' RT	51	11"	HUI	-	P	95 SF	-	-	11'	-	-					
12+05	21' RT	52	9"	HACK	-	P	64 SF	-	-	-	-	-					
12+38	13' RT	92	7"	HUI	-	P	38 SF	-	-	-	-	-					
12+66	11' RT	93	5"	HUI	-	P	20 SF	-	-	-	-	-					
12+96	12' LT	91	7"	MESQ	-	P	38 SF	-	-	-	-	-					
13+13	15' LT	84	5"	HACK	-	P	20 SF	-	-	-	-	-					
13+30	6' RT	103	5"	HACK	R	-	20 SF	20 SF	-	-	-	-					
13+34	10' RT	104	5"	MESQ	-	P	20 SF	-	-	-	-	-					
13+39	16' RT	107	9"	MESQ	-	P	64 SF	-	-	-	-	-					
13+46	7' RT	109	5"	TXP	R	-	20 SF	20 SF	-	5'	-	-					
13+46	1' LT	114	7"	MESQ	R	-	38 SF	38 SF	-	-	-	-					
13+49	17' RT	108	11"	JUN	-	P	95 SF	-	-	11'	-	-					
13+51	3' RT	113	5"	HACK	R	-	20 SF	20 SF	-	-	-	-					
13+83	11' RT	124	7"	HACK	R	-	38 SF	38 SF	-	-	-	-					
13+86	16' RT	128	7"	HACK	-	P	38 SF	-	-	-	-	-					
13+89	10' RT	125	7"	HACK	R	-	38 SF	38 SF	-	-	-	-					
13+92	28' RT	130	19"	MESQ	-	P	283 SF	-	-	19'	-	-					
14+01	17' RT	131	7"	CE	-	P	38 SF	-	-	7'	-	-					
14+32	15' LT	145	5"	CE	-	P	20 SF	-	-	-	-	-					
14+35	20' LT	147	5"	CE	-	P	20 SF	-	-	-	-	-					
SECTION TOTALS:									299'	7 - 41'	26 - 198'	1634 SF	194 SF	0'	103'	0'	0'

TREE PRESERVATION TABLE

STATION	E OFFSET	TREE TAG #	SIZE DBH (INCHES)	TREE SPECIES	REMOVE (R)	PRESERVE (P)	CANOPY AREA (SF)	REMOVED AREA (SF)	SIGNIFICANT 5' TO 23'		HERITAGE 12' AND 24' +						
									REMOVE (IN)	PRESERVE (IN)	REMOVE (IN)	PRESERVE (IN)					
14+37	12' LT	144	5"	CE	-	P	20 SF	-	-	-	-	-					
14+40	11' LT	143	5"	CE	-	P	20 SF	-	-	-	-	-					
14+40	10' RT	139	7"	CE	-	P	38 SF	-	-	7'	-	-					
14+43	3' RT	140	7"	CE	R	-	38 SF	38 SF	-	-	-	-					
14+46	8' LT	142	5"	CE	-	P	20 SF	-	-	-	-	-					
14+63	1' RT	151	5"	HUI	R	-	20 SF	20 SF	-	-	-	-					
14+76	23' LT	156	18"	CE	-	P	254 SF	-	-	18'	-	-					
14+77	18' LT	155	16"	CE	-	P	201 SF	-	-	16'	-	-					
14+81	2' LT	152	5"	HUI	R	-	20 SF	20 SF	-	-	-	-					
15+40	3' RT	170	7"	HUI	-	P	38 SF	-	-	-	-	-					
22+63	20' LT	1747	22"	ELM	-	P	380 SF	-	-	22'	-	-					
23+14	2' LT	1024	6"	CE	R	-	28 SF	28 SF	-	6'	-	-					
23+19	29' RT	1027	17"	LO	-	P	227 SF	-	-	17'	-	-					
23+45	3' RT	1028	21"	LO	-	P	346 SF	-	-	21'	-	-					
23+48	33' RT	1029	21"	LO	-	P	346 SF	-	-	21'	-	-					
23+50	8' RT	1757	10"	ELM	-	P	79 SF	-	-	10'	-	-					
23+70	15' LT	1756	14"	OAK	-	P	154 SF	-	-	14'	-	-					
24+05	20' RT	1753	15"	OAK	-	P	177 SF	-	-	15'	-	-					
24+06	18' RT	1754	7"	PER	-	P	38 SF	-	-	7'	-	-					
24+06	18' LT	1752	17"	HACK	-	P	227 SF	-	-	17'	-	-					
24+43	16' LT	1759	17"	HACK	-	P	227 SF	-	-	17'	-	-					
24+52	9' LT	1758	28"	OAK	-	P	615 SF	-	-	-	-	28'					
24+65	6' RT	1751	16"	OAK-STUMP	R	-	-	-	-	-	-	-					
24+68	9' RT	1750	17"	OAK	-	P	227 SF	-	-	17'	-	-					
24+77	13' RT	1749	20"	OAK	-	P	314 SF	-	-	20'	-	-					
24+81	11' RT	1748	25"	OAK	-	P	491 SF	-	-	-	-	25'					
25+00	21' RT	1760	26"	HACK	-	P	631 SF	-	-	-	-	26'					
25+15	10' RT	1761	13"	HACK	-	P	133 SF	-	-	13'	-	-					
25+21	15' RT	1762	10"	HACK	-	P	79 SF	-	-	10'	-	-					
25+67	24' RT	1764	19"	OAK	-	P	283 SF	-	-	19'	-	-					
25+70	10' RT	1763	12"	HACK	-	P	113 SF	-	-	12'	-	-					
26+03	15' RT	1765	17"	OAK	-	P	227 SF	-	-	17'	-	-					
26+34	16' RT	1766	10"	OAK	-	P	79 SF	-	-	10'	-	-					
SECTION TOTALS:									428'	4 - 23'	28 - 405'	5988 SF	106 SF	13'	320'	0'	79'

\* STUMP NOT ADDED IN TREE TOTALS. CEDAR TREES NOT INCLUDED IN TOTALS.

**PRELIMINARY**  
 THIS DRAWING INDICATES  
 HOT FOR CONSTRUCTION!  
 THE GENERAL CONCEPT AND  
 THE GENERAL SCOPE OF  
 THE ANTICIPATED CONTRACT  
 DOCUMENT.  
 ROGER C. LAMWEDD  
 P.E. LICENSE NO. 44411

**SLAY ENGINEERING CO., INC.**  
 CIVIL SURVEYING CONSULTING  
 123 ALBERT AVENUE  
 SAN ANTONIO, TEXAS 78201-1882  
 TEL: (210) 724-4388 FAX: (210) 724-4380  
 SLAYENGINEERING.COM

**CITY OF SAN ANTONIO**  
 PARKS AND RECREATION DEPARTMENT  
 LEON CREEK LINEAR TRAIL EXTENSION  
 C.O.S.A. PROJECT NO.: 28-00619

**TREE PRESERVATION TABLE**  
 SHEET 2 OF 5

DATE: 11-07-14  
 SUBMITTAL: SLAY PROJECT NO.: 13-002  
 DRWN. BY: JVA DSGN. BY: R.C.L. CHKD. BY: R.C.L. SHEET NO.: 084

TREE PRESERVATION TABLE

STATION	ℓ OFFSET	TREE TAG #	SIZE DBH (INCHES)	TREE SPECIES	REMOVE (R)	PRESERVE (P)	CANOPY AREA (SF)	REMOVED AREA (SF)	SIGNIFICANT 5' TO 23'	REMOVE (IN)	PRESERVE (IN)	HERITAGE 12' AND 24'+	REMOVE (IN)	PRESERVE (IN)
28+56	5' RT	1767	14"	OAK	R	-	154 SF	154 SF	14"	-	-	-	-	-
28+56	3' RT	1768	14"	OAK	R	-	154 SF	154 SF	14"	-	-	-	-	-
28+72	7' LT	1771	18"	OAK	-	P	254 SF	-	-	18"	-	-	-	-
28+86	14' RT	877	15"	OAK	-	P	177 SF	-	-	15"	-	-	-	-
28+88	13' RT	876	15"	OAK	-	P	177 SF	-	-	15"	-	-	-	-
28+94	18' RT	878	16"	OAK	-	P	201 SF	-	-	16"	-	-	-	-
27+23	12' RT	1769	12"	OAK	-	P	113 SF	-	-	12"	-	-	-	-
27+26	11' LT	883	11"	OAK	-	P	95 SF	-	-	11"	-	-	-	-
27+28	15' RT	1770	13"	OAK	-	P	133 SF	-	-	13"	-	-	-	-
27+37	23' LT	882	9"	JUN	-	P	64 SF	-	-	-	-	-	-	-
27+80	25' RT	851	11"	OAK	-	P	95 SF	-	-	11"	-	-	-	-
27+90	10' RT	1772	7"	OAK	-	P	38 SF	-	-	7"	-	-	-	-
27+93	4' RT	845	7"	JUN	R	-	38 SF	38 SF	-	-	-	-	-	-
27+94	10' LT	843	13"	OAK	-	P	133 SF	-	-	13"	-	-	-	-
27+96	5' LT	1774	11"	CDR	-	-	-	-	-	-	-	-	-	-
27+97	6' RT	1773	9"	OAK	R	-	64 SF	64 SF	-	9"	-	-	-	-
28+00	4' RT	844	7"	JUN	R	-	38 SF	38 SF	-	-	-	-	-	-
28+01	15' LT	1775	40"	OAK	-	P	1256 SF	-	-	-	-	-	-	40"
28+22	2' LT	1776	5"	OAK	R	-	20 SF	20 SF	-	-	-	-	-	-
28+22	15' LT	835	9"	JUN	-	P	64 SF	-	-	-	-	-	-	-
28+29	10' LT	833	7"	JUN	-	P	38 SF	-	-	-	-	-	-	-
28+29	13' LT	834	7"	JUN	-	P	38 SF	38 SF	-	-	-	-	-	-
28+36	6' LT	1777	9"	OAK	R	-	64 SF	64 SF	9"	-	-	-	-	-
28+42	18' RT	826	7"	OAK	-	P	38 SF	-	-	7"	-	-	-	-
28+55	20' RT	824	17"	JUN	-	P	227 SF	-	-	17"	-	-	-	-
28+67	17' RT	1778	24"	CDR	-	-	-	-	-	-	-	-	-	-
28+85	2' RT	820	7"	JUN	R	-	38 SF	38 SF	-	-	-	-	-	-
29+16	12' LT	812	13"	SO	-	P	133 SF	-	-	13"	-	-	-	-
29+50	10' RT	1780	15"	OAK	-	P	177 SF	-	-	15"	-	-	-	-
29+88	13' LT	792	13"	JUN	-	P	133 SF	-	-	13"	-	-	-	-
30+23	8' RT	1781	7"	OAK	-	P	38 SF	-	-	7"	-	-	-	-
30+23	10' RT	779	9"	LO	-	P	64 SF	-	-	9"	-	-	-	-
30+70	12' RT	769	11"	JUN	-	P	95 SF	-	-	11"	-	-	-	-
SECTION TOTALS:			367"	-	8 - 72"	23 - 295"	4380 SF	570 SF	37"	222"	0"	40"		

TREE PRESERVATION TABLE

STATION	ℓ OFFSET	TREE TAG #	SIZE DBH (INCHES)	TREE SPECIES	REMOVE (R)	PRESERVE (P)	CANOPY AREA (SF)	REMOVED AREA (SF)	SIGNIFICANT 5' TO 23'	REMOVE (IN)	PRESERVE (IN)	HERITAGE 12' AND 24'+	REMOVE (IN)	PRESERVE (IN)
30+79	6' LT	767	5"	SO	-	P	20 SF	-	-	-	-	-	-	-
30+79	11' LT	766	5"	SO	-	P	20 SF	-	-	-	-	-	-	-
31+17	20' RT	754	5"	LO	-	P	20 SF	-	-	-	-	-	-	-
31+78	10' RT	729	9"	JUN	-	P	64 SF	-	-	-	-	-	-	-
32+01	20' RT	718	11"	JUN	-	P	95 SF	-	-	-	-	-	-	-
32+15	11' LT	713	7"	JUN	-	P	38 SF	-	-	-	-	-	-	-
32+30	48' RT	690	19"	LO	-	P	293 SF	-	-	19"	-	-	-	-
32+35	31' RT	691	19"	LO	-	P	283 SF	-	-	19"	-	-	-	-
32+40	7' LT	703	5"	CE	-	P	20 SF	-	-	-	-	-	-	-
32+45	12' LT	704	5"	CE	-	P	20 SF	-	-	-	-	-	-	-
32+46	43' RT	689	19"	LO	-	P	283 SF	-	-	19"	-	-	-	-
32+59	10' RT	696	7"	CE	-	P	38 SF	-	-	7"	-	-	-	-
32+88	7' RT	672	5"	CE	-	P	20 SF	-	-	-	-	-	-	-
32+85	4' RT	670	9"	HUI	R	-	64 SF	64 SF	-	-	-	-	-	-
32+96	14' RT	675	6"	CE	-	P	20 SF	-	-	-	-	-	-	-
32+99	19' RT	677	7"	CE	-	P	38 SF	-	-	7"	-	-	-	-
33+00	13' RT	676	7"	CE	-	P	38 SF	-	-	7"	-	-	-	-
33+46	10' RT	651	7"	CE	-	P	38 SF	-	-	7"	-	-	-	-
34+81	14' LT	1784	18"	ELM	-	P	284 SF	-	-	18"	-	-	-	-
34+79	21' LT	1783	17"	HACK	-	P	227 SF	-	-	17"	-	-	-	-
34+86	10' RT	1787	14"	ELM	-	P	154 SF	-	-	14"	-	-	-	-
34+95	20' RT	1789	14"	ELM	-	P	154 SF	-	-	14"	-	-	-	-
35+04	2' RT	1788	3"	PER	R	-	7 SF	7 SF	-	-	-	-	-	-
35+04	23' LT	1785	20"	ELM	-	P	314 SF	-	-	20"	-	-	-	-
35+09	11' LT	1786	13"	ELM	-	P	133 SF	-	-	13"	-	-	-	-
35+47	26' LT	1786	10"	ELM	-	P	79 SF	-	-	10"	-	-	-	-
35+50	28' LT	1795	23"	OAK	-	P	415 SF	-	-	23"	-	-	-	-
35+63	15' RT	1790	20"	CDR	-	-	-	-	-	-	-	-	-	-
35+65	22' LT	1794	24"	OAK	-	P	452 SF	-	-	-	-	-	-	24"
35+84	24' LT	1793	11"	CDR	-	-	-	-	-	-	-	-	-	-
35+86	15' LT	1782	15"	CDR	-	-	-	-	-	-	-	-	-	-
36+09	14' RT	1791	13"	CDR	-	-	-	-	-	-	-	-	-	-
36+25	15' RT	1803	15"	ELM	-	P	177 SF	-	-	15"	-	-	-	-
SECTION TOTALS:			327"	-	2 - 12"	27 - 315"	3787 SF	71 SF	0"	240"	0"	24"		

**PRELIMINARY**  
 THIS DRAWING INDICATES  
 NOT FOR CONSTRUCTION  
 THE DESIGN CONCEPT AND  
 THE GENERAL SCOPE OF  
 THE PROJECT. IT IS NOT A  
 CONTRACT DOCUMENT.  
 ROGER C. LAMBEAU,  
 P.E. LICENSE NO. 46411

**SLAY ENGINEERING CO., INC.**  
 CIVIL - SURVEYING - CONSULTING  
 123 ALBERT AVENUE  
 SAN ANTONIO, TEXAS 78201-1602  
 TYPE FIRM REGISTRATION NO. F1901  
 FAX (210) 734-4401  
 SLAYENGINEERING.COM

**CITY OF SAN ANTONIO**  
 LEON CREEK LINEAR TRAIL EXTENSION  
 PARKS AND RECREATION DEPARTMENT  
 C.O.S.A. PROJECT NO.: 29-08613

**TREE PRESERVATION TABLE**  
 SHEET 3 OF 5

DATE:	11/07/14
SUBMITTAL:	JVA
DESIGN BY:	RCL
CHECK BY:	RCL
SHEET NO.:	085

TREE PRESERVATION TABLE

STATION	ℓ OFFSET	TREE TAG #	SIZE DBH (INCHES)	TREE SPECIES	REMOVE (R)	PRESERVE (P)	CANOPY AREA (SF)	REMOVED AREA (SF)	SIGNIFICANT 5' TO 23' (IN)	PRESERVE (IN)	HERITAGE 12' AND 24'+ (IN)	PRESERVE (IN)
36+33	11' LT	1804	3"	PER	-	P	7 SF	-	-	-	-	-
36+42	11' RT	1802	16"	ELM	-	P	201 SF	-	-	16"	-	-
36+50	3' RT	1801	12"	ELM	-	P	113 SF	-	-	12"	-	-
36+76	12' LT	1797	17"	ELM	-	P	227 SF	-	-	17"	-	-
37+00	30' LT	1788	18"	ELM	-	P	254 SF	-	-	18"	-	-
37+10	10' LT	1799	17"	OAK	-	P	227 SF	-	-	17"	-	-
37+23	11' RT	1800	19"	ELM	-	P	283 SF	-	-	19"	-	-
37+43	18' LT	1807	13"	ELM	-	P	133 SF	-	-	13"	-	-
37+46	19' LT	1808	13"	ELM	-	P	133 SF	-	-	13"	-	-
37+51	17' LT	1805	13"	ELM	-	P	133 SF	-	-	13"	-	-
37+87	10' LT	1811	13"	ELM	-	P	133 SF	-	-	13"	-	-
37+92	20' LT	1810	13"	ELM	-	P	133 SF	-	-	13"	-	-
37+95	11' RT	1812	12"	ELM	-	P	113 SF	-	-	12"	-	-
38+07	18' LT	1809	22"	ELM	-	P	380 SF	-	-	22"	-	-
38+08	20' RT	1813	18"	ELM	-	P	254 SF	-	-	18"	-	-
38+18	18' LT	1808	16"	ELM	-	P	201 SF	-	-	16"	-	-
38+22	11' RT	1814	15"	ELM	-	P	177 SF	-	-	15"	-	-
38+50	13' LT	1851	21"	OAK	-	P	346 SF	-	-	21"	-	-
38+50	19' LT	1816	23"	OAK	-	P	415 SF	-	-	23"	-	-
39+06	16' RT	1817	20"	ELM	-	P	314 SF	-	-	20"	-	-
39+29	34' RT	1818	24"	OAK	-	P	452 SF	-	-	-	-	24
39+40	16' RT	1819	19"	ELM	-	P	283 SF	-	-	19"	-	-
39+82	9' RT	1820	4"	PER	-	P	13 SF	-	-	-	-	-
39+90	12' LT	1822	13"	ELM	-	P	133 SF	-	-	13"	-	-
39+92	10' LT	1823	10"	ELM	-	P	79 SF	-	-	10"	-	-
39+95	20' RT	1821	31"	OAK	-	P	754 SF	-	-	-	-	31"
40+25	8' LT	1824	10"	ELM	-	P	79 SF	-	-	10"	-	-
40+26	10' RT	1825	13"	ELM	-	P	133 SF	-	-	13"	-	-
40+34	21' RT	1826	29"	OAK	-	P	660 SF	-	-	-	-	29"
40+68	10' LT	1829	11"	ELM	-	P	95 SF	-	-	11"	-	-
40+77	13' RT	1828	7"	PER	-	P	38 SF	-	-	7"	-	-
40+85	20' RT	1827	23"	OAK	-	P	415 SF	-	-	23"	-	-
43+47	13' RT	1831	13"	ELM	-	P	133 SF	-	-	13"	-	-
SECTION TOTALS:			521"	-	0	33 - 521"	7443 SF	0 SF	0"	430"	0"	84"

TREE PRESERVATION TABLE

STATION	ℓ OFFSET	TREE TAG #	SIZE DBH (INCHES)	TREE SPECIES	REMOVE (R)	PRESERVE (P)	CANOPY AREA (SF)	REMOVED AREA (SF)	SIGNIFICANT 5' TO 23' (IN)	PRESERVE (IN)	HERITAGE 12' AND 24'+ (IN)	PRESERVE (IN)
43+47	14' RT	1830	14"	ELM	-	P	154	-	-	14"	-	-
43+47	3' RT	1832	13"	ELM	-	P	133	-	-	13"	-	-
43+47	11' RT	1333	12"	ELM	-	P	113	-	-	12"	-	-
43+47	14' RT	1834	16"	ELM	-	P	201	-	-	16"	-	-
43+47	11' RT	1836	19"	ELM	-	P	283	-	-	19"	-	-
SECTION TOTALS:			74"	-	0	5 - 74"	884	0 SF	0"	74"	0"	0"
GRAND TOTALS:			1855"	-	23 - 148"	147 - 1808"	28,331 SF	1,036 SF	50"	1,399"	0"	227"

**TREE SPECIES ABBREVIATIONS**

LO	-	LIVE OAK
HACK	-	HACKBERRY
MESQ	-	MESQUITE
HUI	-	HUISACHE
JUN	-	JUNIPER
TXP	-	TEXAS PERSIMMON
CE	-	CEDAR OAK
ELM	-	ELM
PER	-	PERSIMMON
CDR	-	CEDAR
SO	-	SPANISH OAK

**PRELIMINARY**  
 NOT FOR CONSTRUCTION  
 THE DESIGN, CONSTRUCTION AND THE GENERAL SCOPES OF THE PROJECT IT IS NOT A CONTRACT DOCUMENT.  
 ROGER C. LAWRENCE  
 P.E. LICENSE NO. 48111

**SLAY ENGINEERING CO., INC.**  
 CIVIL - SURVEYING - CONSULTING  
 123 ATGELT AVENUE  
 SAN ANTONIO, TEXAS 78201-1802  
 TELEPHONE: (210) 794-4388  
 FAX: (210) 794-4601  
 SLAYENGINEERING.COM

**CITY OF SAN ANTONIO**  
 PARKS AND RECREATION DEPARTMENT  
 LEON CREEK LINEAR TRAIL EXTENSION  
 C.O.S.A. PROJECT NO.: 2600813

**TREE PRESERVATION TABLE**  
 SHEET 4 OF 5

SUBMITTAL	DATE
DRWN. BY: JVA	11-07-14
DSGN. BY: RCL	
CHKD. BY: RCL	
SHEET NO.: C96	

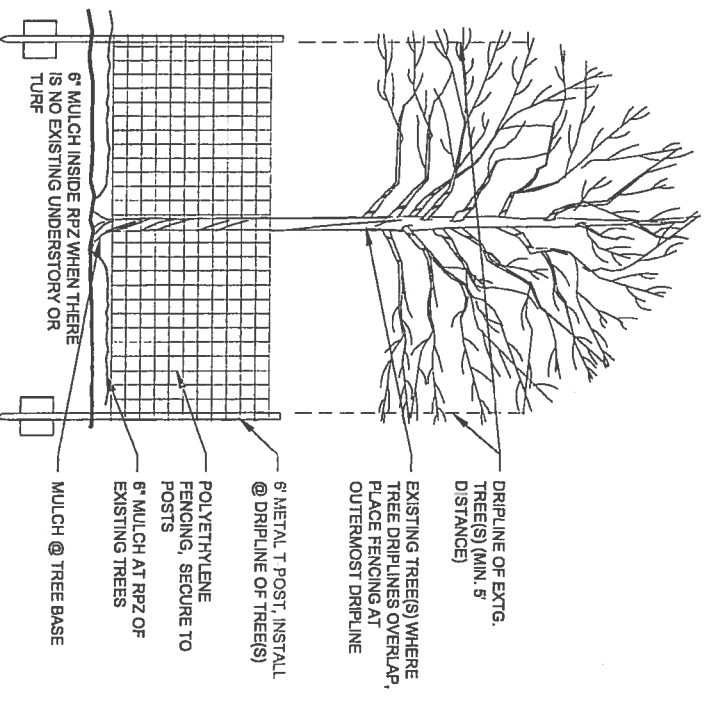
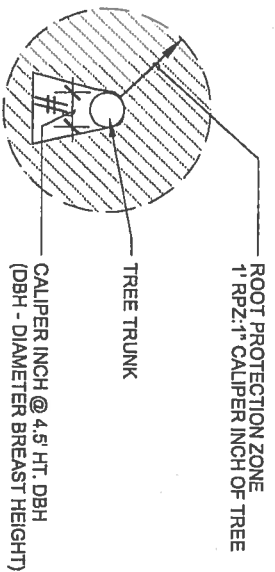

**TREE BARRICADE FENCING**  
NOT TO SCALE

**TREE PROTECTION AND PRESERVATION GENERAL NOTES**

1. ALL THE TREES WITH A DIAMETER GREATER THAN 3 INCHES AFFECTED BY CONSTRUCTION SHALL HAVE THE LIMBS AND ROOTS TRIMMED AND PRUNED ACCORDING TO ITEM NO. 802. TREE PRUNING, SOIL AMENDING AND FERTILIZATION, UNLESS SPECIFIED TREES SHALL RECEIVE LEVEL 2 PROTECTION AS PER ITEM NO. 802. TREES TO RECEIVE LEVEL 1 PROTECTION AS PER ITEM NO. 802 ARE SHOWN ON TREE PROTECTION TABLE ON THIS SHEET.
2. ALL TREES SHALL REMAIN UNLESS NOTED ON THE PLANS.
3. NO SITE PREPARATION WORK SHALL BEGIN IN AREAS WHERE TREE PRESERVATION AND TREATMENT MEASURES HAVE NOT BEEN COMPLETED AND APPROVED.
4. TREE PROTECTION FENCING SHALL BE REQUIRED. TREE PROTECTION FENCING SHALL BE INSTALLED, MAINTAINED AND REPAIRED BY THE CONTRACTOR DURING SITE CONSTRUCTION.
5. THE CONTRACTOR SHALL AVOID CUTTING ROOTS LARGER THAN THREE INCHES IN DIAMETER WHEN EXCAVATING NEAR EXISTING TREES. EXCAVATION IN THE VICINITY OF TREES SHALL PROCEED WITH CAUTION. THE CONTRACTOR SHALL CONTACT THE CITY INSPECTOR.
6. THE ROOT PROTECTION ZONE IS THAT AREA SURROUNDING A TREE, AS MEASURED BY A RADIUS FROM THE TREE TRUNK, IN WHICH NO EQUIPMENT, VEHICLES OR MATERIALS MAY OPERATE OR BE STORED. THE REQUIRED RADIUS LENGTH IS 1 FOOT PER DIAMETER INCH OF THE TREE. FOR EXAMPLE, A 10-INCH DIAMETER TREE WOULD HAVE A 5-FOOT RADIUS ROOT PROTECTION ZONE AROUND THE TREE. ROOTS OR BRANCHES THAT ARE IN CONTACT WITH THE CONSTRUCTION SHALL BE CUT CLEANLY ACCORDING TO PROPER PRUNING METHODS. OAK WOUNDS SHALL BE PAINTED OVER, WITHIN 20 MINUTES TO PREVENT OAK WILT.
7. ACCESS TO FENCED AREAS WILL BE PERMITTED ONLY WITH THE APPROVAL OF THE ENGINEER OR CITY INSPECTOR.
8. GRADING, IF REQUIRED, SHALL BE LIMITED TO A 3 INCH CUT OR FILL WITHIN THE FENCED ROOT ZONE AREAS.
9. TREES, SHRUBS OR BUSHES TO BE CLEARED FROM PROTECTED ROOT ZONE AREAS SHALL BE REMOVED BY HAND AS DIRECTED BY THE PROJECT MANAGER OR CITY INSPECTOR.
10. TREES DAMAGED OR LOST DUE TO CONTRACTOR'S NEGLIGENCE DURING CONSTRUCTION SHALL BE MITIGATED TO THE ENGINEER'S SATISFACTION.
11. EXPOSED ROOTS SHALL BE COVERED AT THE END OF EACH DAY USING TECHNIQUES SUCH AS COVERING WITH SOIL, MULCH OR WET BURLAP.
12. ANY TREE REMOVAL SHALL BE APPROVED BY THE CITY ARBORIST PRIOR TO ITS REMOVAL.

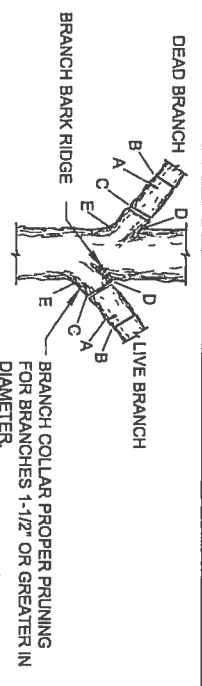

- NOTE: DO NOT CUT FROM D TO E.
- A. FIRST CUT - TO PREVENT THE BARK FROM BEING PEELED WHEN THE BRANCH FALLS.
  - B. SECOND CUT - TO REDUCE THE WEIGHT OF BRANCH.
  - C. FINAL CUT - ALLOW FOR HEALING COLLAR BUT NO STUBS
  - D. BRANCH RIDGES - INDENT PROPERLY BRANCH RIDGES WHICH ARE SITE FOR DECAY.
  - E. A MINIMUM BRANCH CLEARANCE OF 14 FEET ABOVE STREET ELEVATION AND 8 FEET MINIMUM ABOVE WALK MUST BE MAINTAINED. PRUNE TREES AS NECESSARY TO OBTAIN CLEARANCES. FOR OAKS ONLY: PAINT ALL WOUNDS OR CUTS WITH PRUNING PAINT WITHIN 20 MIN TO PREVENT THE SPREAD OF OAK WILT.

**BRANCH PRUNING**  
NOT TO SCALE

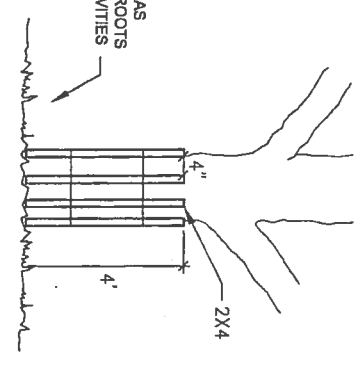

**LEVEL II B FENCE PROTECTION**  
NOT TO SCALE

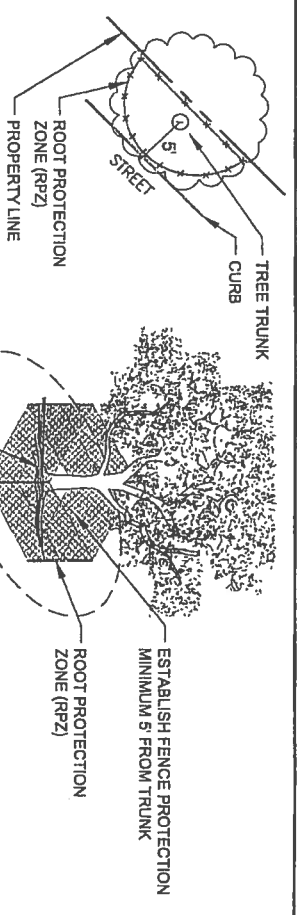

**LEVEL II A FENCE PROTECTION**  
NOT TO SCALE

**TREE PRESERVATION NOTES**

1. TREE PRESERVATION: TREE PRESERVATION REQUIREMENTS SHALL BE ACCOMPLISHED IN ACCORDANCE WITH SECTION 35-523 OF THE CURRENT UNIFIED DEVELOPMENT CODE OF THE CITY OF SAN ANTONIO, TEXAS.
2. TOPOGRAPHIC AND TREE SURVEY DETAIL INFORMATION ALONG TRAIL LOCATION PROVIDED BY SLAY ENGINEERING, 123 ALT BELT AVE., SAN ANTONIO, TX, 78201,(210)734-4388.
3. ALL CONDITIONS NECESSITATING THE REMOVAL OR PRUNING OF A TREE SHALL BE REVIEWED BY LANDSCAPE ARCHITECT. LOCATIONS OF ANY IMPROVEMENTS WITH THE POTENTIAL OF IMPACTING TREES SHALL BE STAKE/DELIMITED PRIOR TO THE FIELD REVIEW. CONTRACTOR WILL BE REQUIRED TO MAKE REASONABLE ADJUSTMENTS IN LAYOUT OF ELEMENTS (INCLUDING CURBS, PAVING AND WALKS) PER APPROVAL OF OWNER.
4. ALL WOODY MATERIAL TO BE REMOVED SHALL BE CHIPPED INTO MULCH. SUBSEQUENT CORRIDORS, AND ON SITE WITHIN RPZS AT TREES ADJACENT TO CONSTRUCTION & NATURAL AREAS. MATERIAL NOT USED ON SITE IS TO BE REMOVED AND PROPERLY DISPOSED OF BY CONTRACTOR.
5. ALL TREES TO BE REMOVED SHALL BE REMOVED ONLY UNDER THE FOLLOWING SITUATIONS ONLY WITH PRIOR APPROVAL OF LANDSCAPE ARCHITECT & OWNER.
  - A. CUT/FILL GREATER THAN THREE (3") INCHES TO TAKE PLACE BENEATH THE DRIPLINE OF A TREE EXCEEDS 50% OF THE ROOT PROTECTION ZONE (RPZ).
  - B. CONSTRUCTION OF A BUILDING OR OTHER IMPROVEMENTS REQUIRE THE REMOVAL OF MORE THAN 50% OF THE PORTION OF A TREE CROWN.
  - C. POOR CONDITION OF TREE.
6. BARRICADE FENCING SHALL BE PLACED TO PROTECT RPZ OF ALL TREES TO REMAIN UNLESS OTHERWISE APPROVED BY LANDSCAPE ARCHITECT TO PROVIDE ACCESS TO WORK. IN THESE INSTANCES THE MINIMUM DISTANCE FOR BARRICADE FENCING FROM TRUNK SHALL BE EQUAL TO 50% MINIMUM OF RPZ. MINIMUM DISTANCE BARRICADE TO BE ERCTED IS 5'-0" FROM TRUNK OF TREE OR CLUMP OF TREES 10" CALIPER OR LESS. REFER TO TREE PRESERVATION RELATED DETAILS FOR TREE BARRICADE FENCING AND ROOT PROTECTION ZONE WORK RESTRICTIONS.
7. CONSTRUCTION ENVELOPE AT SITE IMPROVEMENTS SHALL BE LIMIT OF AREA WITHIN SELECTIVE CLEARED AREA WHICH CAN BE COMPLETELY DISTURBED BY CONSTRUCTION. ANY SIGNIFICANT OR HERITAGE TREES ENCOUNTERED ARE TO BE REVIEWED ON AN INDIVIDUAL BASIS TO DETERMINE MODIFICATION TO LOCATION OF PATHWAY/TRAIL/IMPROVEMENTS. ROUTING OF UTILITIES TO BE CONFIRMED WITH LANDSCAPE ARCHITECT AND OWNER; MAKE ADJUSTMENTS AS DIRECTED AT NO ADDITIONAL COST TO CONTRACT.
8. CONTRACTOR SHALL PROVIDE A CITY CERTIFIED PROFESSIONAL ARBORIST FOR PROPER TREE PRUNING AND ALL TREE CARE AND MAINTENANCE PRACTICES.

**TREE INVENTORY SUMMARY**  
(6" DIAMETER AND LARGER)

(6" DIAMETER AND LARGER)	
TOTAL DIAMETER INCHES, R.O.W	1956"
TOTAL DIAMETER INCHES REMOVED	148"
TOTAL DIAMETER INCHES PRESERVED	1829"
TOTAL PERCENTAGE INCHES PRESERVED	94%
TOTAL INCHES TO BE MITIGATED	0

**PRELIMINARY**  
NOT FOR CONSTRUCTION  
THIS DRAWING INDICATES THE DESIGN CONCEPT AND THE GENERAL SITE PLAN. A COMPLETED CONTRACT DOCUMENT.  
ROGER C. LAMKEDA,  
P.E. LICENSE NO. 48411

**SLAY ENGINEERING CO., INC.**  
SURVEYING & CONSULTING  
123 ALT BELT AVENUE  
SAN ANTONIO, TEXAS 78201-1822  
TYPE FIRM REGISTRATION NO. F1901  
FAX (210) 734-4301  
SLAYENGINEERING.COM  
CITY OF SAN ANTONIO  
PARKS AND RECREATION DEPARTMENT  
LEON CREEK GREENWAY NORTH (VALERO TRAILHEAD) p.1-10  
C.O.S.A. PROJECT NO.: 26-00613

**TREE PRESERVATION DETAILS**  
SHEET 5 OF 5

SUBMITTAL	SLAY PROJECT NO.: 13042	DATE	11-20-14
DESIGN BY: JVA	R.C.L.	CHECKED BY: R.C.L.	SHEET NO.: C87