

22018043

PLOT PLAN FOR BUILDING PERMITS

Carport 20' x 125'

Address: 1121 Ashby Place

Lot: 39

Block: 2

NCB: 3031

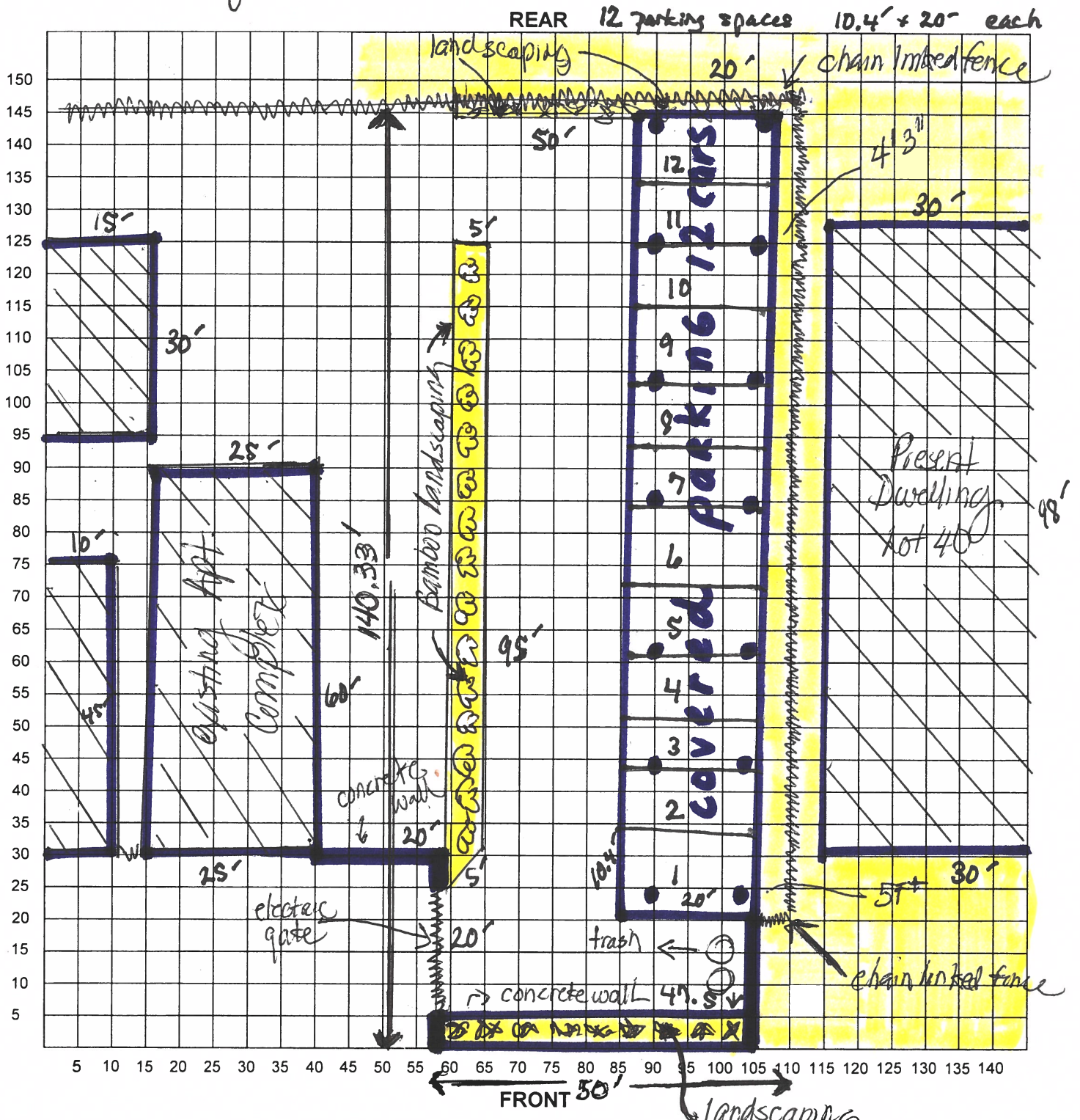

I certify that the above plot plan shows all improvements on this property and that there will be no construction over easements. I also certify that I will build in compliance with the UDC and the 2015 IRC.

Date: 6/6/17

Signature of Applicant: [Handwritten Signature]

Z2018055

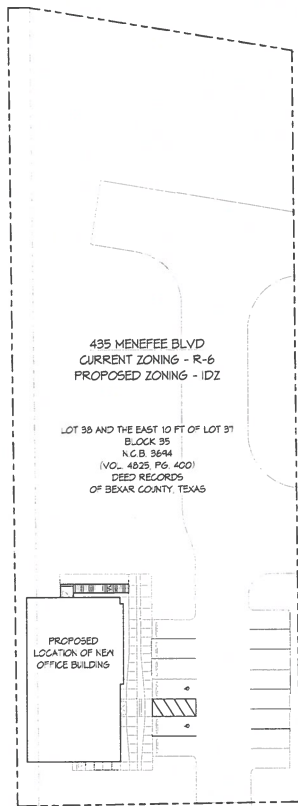

MENEFFEE BLVD.

SCALE: 1" = 20'-0"

GNA

GNA ARCHITECTURE
300 CORNHILL STREET, SUITE 1800
SAN ANTONIO, TEXAS 78205
P. 210.548.1800

ARCHITECT'S SEAL

ARCHITECT: GERARDO S. KOREAN,
AIA REGISTRATION NUMBER 15816
NOT FOR REGULATORY APPROVAL,
PERMITTING OR CONSTRUCTION

CONSULTANTS LOGO

CONSULTANTS SEAL

ISSUANCE	NO.	DESCRIPTION	DATE

REVISIONS	NO.	DESCRIPTION	DATE

NEW OFFICE BUILDING FOR
CG CONSTRUCTION

411 MENEFFEE BLVD
SAN ANTONIO, TX 78201

PROJECT NO.	5-018
SHEET SCALE DATE	1/20/11
DRAWN BY	RB
CHECKED BY	SA
DESCRIPTION	

ZONING SITE PLAN
SHEET NO.

ZO.1



ZIGA ARCHITECTURE STUDIO
Architecture | Interiors | Historic Preservation

Donna Marie Romo

DCF Legacy Partners LLC

schematic design: preliminary site plan

1/16" = 1'-0"

11-09-17

1824 + 1826 HAYS, .21 ACRES

22018047

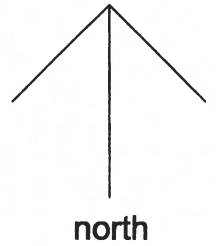

HAYS ST.

