

IDZ SITE PLAN FOR 1222 SHERMAN
 (LOTS 9 & 10, N.C.B. 6056)

ZONING-Z-2020-10700269

CURRENT ZONING: "1-2 MLOD-3 MLR-2 AHOD"
PROPOSED ZONING: "IDZ-1 MLOD-3 MLR-2 AHOD"

ACREAGE: 0.0876

USES: TWO (2) SINGLE FAMILY ATTACHED RESIDENTIAL UNITS
 EACH UNIT 1720 S.F. (21.5 x 40 FT FOOTPRINT)
 TWO STORIES

NOTES: NO EXISTING SIDEWALKS, FENCES, WALLS AND/OR LANDSCAPING
 NO PROPOSED SIDEWALKS, WALLS (SEE PLAN FOR PROPOSED FENCING)
 PROPOSED LANDSCAPING IN ALL REMAINING AREAS

LEGEND:



IMPERVIOUS AREA FOR DRIVEWAY, CARPORT, AND/OR COVERED FRONT PORCH

—□— PROPOSED WOOD FENCE

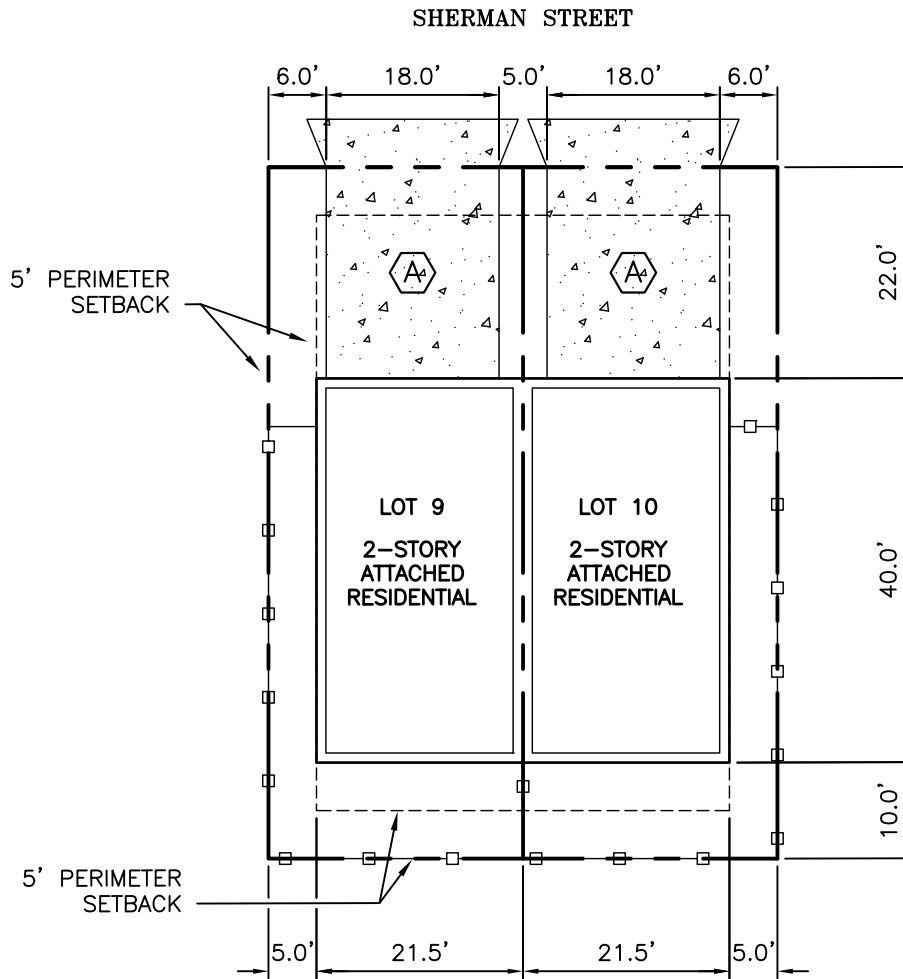

"I, Maria Mercedes Carpio Perez, the property owner, acknowledges that this site plan submitted for the purpose of rezoning this property is in accordance with all applicable provisions of the Unified Development Code. Additionally, I understand that City Council approval of a site plan in conjunction with a rezoning case does not relieve me from adherence to any/all City-adopted Codes at the time of plan submittal for building permits."

DATE: 2020-11-18