

AN ORDINANCE 2014 - 08 - 21 - 0623

AMENDING THE OFFICIAL ZONING MAP OF THE CITY OF SAN ANTONIO BY AMENDING CHAPTER 35, UNIFIED DEVELOPMENT CODE, SECTION 35-304, OF THE CITY CODE OF SAN ANTONIO, TEXAS BY CHANGING THE ZONING DISTRICT BOUNDARY OF CERTAIN PROPERTY.

* * * * *

WHEREAS, a public hearing was held after notice and publication regarding this amendment to the Official Zoning Map at which time parties in interest and citizens were given an opportunity to be heard; and

WHEREAS, the Zoning Commission has submitted a final report to the City Council regarding this amendment to the Official Zoning Map of the City of San Antonio; **NOW THEREFORE**,

BE IT ORDAINED BY THE CITY COUNCIL OF THE CITY OF SAN ANTONIO:

SECTION 1. Chapter 35, Unified Development Code, Section 35-304, Official Zoning Map, of the City Code of San Antonio, Texas is amended by changing the zoning district boundary of 0.5736 of an acre out of NCB 16549 from "C-3 AHOD" General Commercial Airport Hazard Overlay District and "I-1 AHOD" General Industrial Airport Hazard Overlay District to "I-1 AHOD" General Industrial Airport Hazard Overlay District.

SECTION 2. A description of the property is attached as **Attachment "A"** and made a part hereof and incorporated herein for all purposes.

SECTION 3. All other provisions of Chapter 35 except those expressly amended by this ordinance shall remain in full force and effect including the penalties for violations as made and provided for in Section 35 -491.

SECTION 4. The Director of Development Services shall change the zoning records and maps in accordance with this ordinance and the same shall be available and open to the public for inspection.

SECTION 5. This ordinance shall become effective August 31, 2014.

PASSED AND APPROVED this 21st day of August 2014.

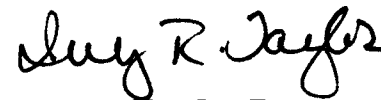
M A Y O R
Ivy R. Taylor

ATTEST:

Leticia M. Vacek, City Clerk

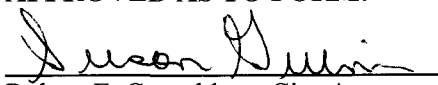
APPROVED AS TO FORM:

Robert F. Greenblum, City Attorney
FR

Agenda Item:	Z-3 (in consent vote: P-2, Z-3)
Date:	08/21/2014
Time:	02:20:35 PM
Vote Type:	Motion to Approve
Description:	ZONING CASE # Z2014173 (District 2): An Ordinance amending the Zoning District Boundary from "C-3 AHOD" General Commercial Airport Hazard Overlay District and "I-1 AHOD" General Industrial Airport Hazard Overlay District to "I-1 AHOD" General Industrial Airport Hazard Overlay District on 0.5736 of an acre out of NCB 16549 located on a portion of 9003 Interstate Highway 10 East. Staff and Zoning Commission recommend approval pending the plan amendment. (Associated Plan Amendment 14052)
Result:	Passed

Voter	Group	Not Present	Yea	Nay	Abstain	Motion	Second
Ivy Taylor	Mayor		x				
Diego Bernal	District 1		x				x
Keith Toney	District 2		x			x	
Rebecca Viagran	District 3		x				
Rey Saldaña	District 4		x				
Shirley Gonzales	District 5		x				
Ray Lopez	District 6		x				
Mari Aguirre-Rodriguez	District 7		x				
Ron Nirenberg	District 8		x				
Joe Krier	District 9		x				
Michael Gallagher	District 10		x				

**METES AND BOUNDS DESCRIPTION
0.5736 OF AN ACRE, BEXAR COUNTY, TEXAS**

Being 0.5736 of an acre out of Lot 1, Block 1, NCB 16549, Moody at Escondido Subdivision, according to plat thereof recorded in Volume 9541, Page 79 of the Deed and Plat Records of Bexar County, Texas. The herein described property contains 0.5736 of an acre, and is more particularly described by metes and bounds as follows:

Beginning at a 1/2" iron rod found in the north right-of-way line of Interstate Highway No. 10 at the southwest corner of said Lot 1, Moody at Escondido Subdivision, also the southwest corner of the herein described tract;

THENCE with the east line of said Lot 1 and the west line of this tract, North 17° 14' 46" West, 100.00 feet to a point;

THENCE across said Lot 1, North 72° 54' 06" East, 249.83 feet to a point in the east line of Lot 1;

THENCE with the east line of Lot 1, South 17° 15' 29" East, 100.00 feet to a 1/2" iron rod found in the north right-of-way line of Interstate Highway No. 10, the southeast corner of said Lot 1, and the southeast corner of this tract;

THENCE with said north right-of-way line, South 72° 54' 06" West, 249.85 feet to the Point of Beginning, containing 0.5736 of an acre of land. This description is based on a survey made by me, on the ground.

Kerry J. Brown

Kerry J. Brown, RPLS No. 4916
May 7, 2014
Job # 14005-A

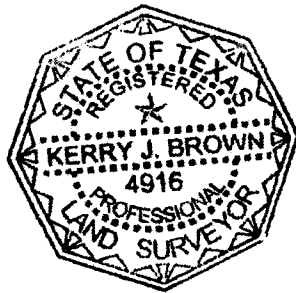

Attachment A