

FIELD NOTES

August 21, 2018

BEING 13.530 acres of land, more or less, out of the Wm. Lindsey Survey No. 75, Abstract 425, N.C.B. 11212, City of San Antonio, Bexar County, Texas and being comprised of a 1.0 acre tract described in Volume 3529, Page 547 of the Real Property Records of Bexar County, Texas, a 1.914 acre tract and 10.589 acres out of a 37.046 acre tract both described on a survey by Barrera-Wilkie Surveying dated March 1, 2010 and being more particularly described as follows:

BEGINNING at a point in the existing east R.O.W. line of Somerset Road for the southwest corner of this tract and the southwest corner of the above referenced 37.046 acre tract, said point also being the northwest corner of the Bexar Housing Subdivision as recorded in Volume 9200, Page 129 of the Deed and Plat Records of Bexar County, Texas;

THENCE, N 37°20'29" E, 380.78 feet along said east R.O.W. line to a point in same for the common corner of a said 1.914 acre tract and said 1.0 acre tract and an angle point of this tract;

THENCE, N 37°20'21" E, 114.93 feet along said east R.O.W. line to a point in same for the northwest corner of this tract and the northwest corner of a said 1.0 acre tract;

THENCE, S 77°26'07" E, 417.31 feet along the common line with a 43.308 acre tract described in Volume 12077, Page 864 of the Real Property Records of Bexar County, Texas to a point in same for the northeast corner of a said 1.0 acre tract and a corner of a said 37.046 acre tract;

THENCE, S 77°26'07" E, 342.40 feet, continuing along the common line with a said 43.308 acre tract, to a point in same for the northeast corner of this tract;

THENCE, S 15°42'07" E, 785.57 feet crossing said 37.046 acre tract along the approximate limits of the "Aircraft Landing Path" to a point in the common line with said Bexar Housing Subdivision for the southeast corner of this tract;

THENCE, N 67°12'07" W, 1361.13 feet along said subdivision to the POINT OF BEGINNING and containing 13.530 acres of land, more or less.

This document was prepared under 22 TAC 663.21, does not reflect the results of an on the ground survey, and is not to be used to convey or establish interests in real property except those rights and interests implied or established by the creation or reconfiguration of the boundary of the political subdivision for which it was prepared.

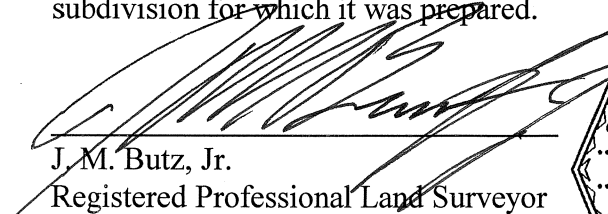
J. M. Butz, Jr.
Registered Professional Land Surveyor
No. 2024

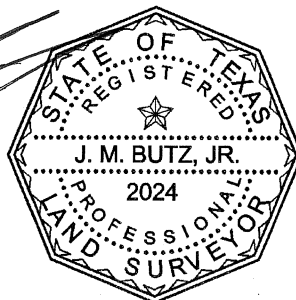

FN18-128.A

FIELD NOTES

August 21, 2018

BEING 26.456 acres of land, more or less, out of the Wm. Lindsey Survey No. 75, Abstract 425, N.C.B. 11212, City of San Antonio, Bexar County, Texas and being out of a 37.046 acre tract described on a survey by Barrera-Wilkie Surveying dated March 1, 2010 and being more particularly described as follows:

BEGINNING at a point in the common line with a 2.18 acre tract described in Volume 5280, Page 1546 of the Real Property Records of Bexar County, Texas for the southeast corner of this tract and the southeast corner of the above referenced 37.046 acre tract, said point also being the southwest corner of a 2.7388 acre tract described in Volume 2745, Page 102 of the Real Property Records of Bexar County, Texas;

THENCE, N 67°12'07" W, 1046.16 feet along the common line with a said 2.18 acre tract and the common line with the Bexar Housing Subdivision, recorded in Volume 9200, Page 129 of the Deed and Plat Records of Bexar County, Texas to a point in same for the southwest corner of this tract;

THENCE, N 15°42'07" W, 785.57 feet crossing said 37.046 acre tract along the approximate limits of the "Aircraft Landing Path" to a point in the common line a 43.308 acre tract described in Volume 12077, Page 864 of the Real Property Records of Bexar County, Texas for the northwest corner of this tract;

THENCE, S 77°26'07" E, 1893.14 feet, along the common line with a said 43.308 acre tract, to a point in same for the northeast corner of this tract and the northeast corner of a said 37.046 acre tract;

THENCE, S 41°48'58" W, 1006.04 feet along the common line with a said 2.7388 acre tract to the POINT OF BEGINNING and containing 26.456 acres of land, more or less.

This document was prepared under 22 TAC 663.21, does not reflect the results of an on the ground survey, and is not to be used to convey or establish interests in real property except those rights and interests implied or established by the creation or reconfiguration of the boundary of the political subdivision for which it was prepared.

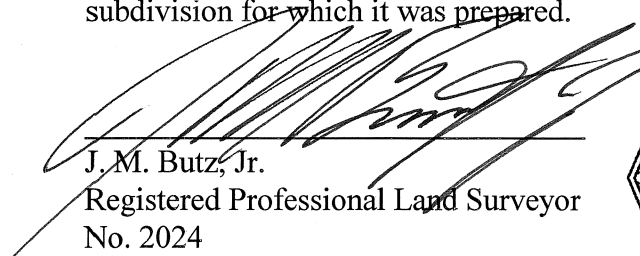

J. M. Butz, Jr.
Registered Professional Land Surveyor
No. 2024

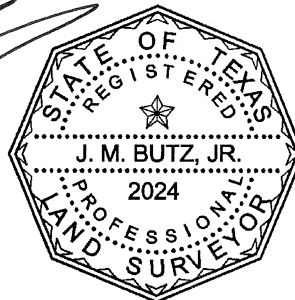

FN18-128.B