

FIELD NOTES
FOR ZONING EXHIBIT

TRACT 6

3.45 ACRES

Being 3.45 acres of land, more or less, out of the J. Hefferman Survey No. 101, Abstract No. 338, County Block 5028, New City Block 14945, and the M.A. De Los Santos Coy Survey No. 306, Abstract No. 135, County Block 5034, New City Block 14945 in the City of San Antonio, Bexar County, Texas. Said 3.45 acres being more particularly described as follows with bearings based on the Texas Coordinate System, South Central Zone, N.A.D. 83:

BEGINNING At the North end of a 25 foot radius curve at the Southernmost corner of the intersection of Thousand Oaks with Schertz Road;

THENCE: Departing said curve and along the West right-of-way line of Thousand Oaks, S 48°56'41" E, 180.20 feet to a point;

THENCE: Continuing along said right-of-way line and along the arc of a curve to the right, said curve having a radial bearing of S 45°38'30" W, a radius of 1550.00 feet, a central angle of 16°48'52", a chord bearing and distance of S 35°57'04" E, 453.24 feet, and an arc length of 454.87 feet to a point;

THENCE: Departing said right-of-way line, S 83°32'26" W, 151.71 feet to a point;

THENCE: N 54°48'21" W, 204.78 feet to a point;

THENCE: S 73°45'42" W, 130.51 feet to a point;

THENCE: N 41°08'28" W, 267.93 feet to a point on the Southeast right-of-way line of Schertz Road;

THENCE: Along said right-of-way line and along the arc of a curve to the left, said curve having a radial bearing of N 41°08'28" W, a radius of 430.00 feet, a central angle of 07°47'44", a chord bearing and distance of N 44°57'40" E, 58.46 feet, and an arc length of 58.50 feet to a point;

THENCE: Continuing along said right-of-way line, N 41°03'48" E, 217.60 feet to the South end of a curve at the intersection of the Southeast right-of-way line of Schertz Road with the West right-of-way line of Thousand Oaks;

Page 1 of 2

Z2018335

Tract 6
3.45 Acres

Z2007319

THENCE: Along said curve, the arc of a curve to the right having a radial bearing of S 48°56'12" E, a radius of 40.00 feet, a central angle of 53°39'14", a chord bearing and distance of N 67°53'25" E, 36.10 feet, and an arc length of 37.46 feet to the POINT OF BEGINNING and containing 3.45 acres in the City of San Antonio, Bexar County, Texas.

This document was prepared under 22 TAC 663.21, does not reflect the results of an on the ground survey, and is not to be used to convey or establish interests in real property except those rights and interests implied or established by the creation or reconfiguration of the boundary of the political subdivision for which it was prepared.

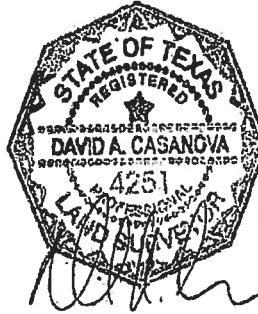

I:\3633\10\Design\Zoning\zn06rev.doc

Z2018235



Z2007319

LAND DEVELOPMENT ENVIRONMENTAL TRANSPORTATION WATER RESOURCES SURVEYING

FIELD NOTES
FOR ZONING EXHIBIT

TRACT 13
3.38 ACRES

Being 3.38 acres of land, more or less, out of the J. Hefferman Survey No. 101, Abstract No. 338, County Block 5028, New City Block 14945, and the M.A. De Los Santos Coy Survey No. 306, Abstract No. 135, County Block 5034, New City Block 14945 in the City of San Antonio, Bexar County, Texas. Said 3.38 acres being more particularly described as follows with bearings based on the Texas Coordinate System, South Central Zone, N.A.D. 83:

COMMENCING at the South end of a curve at the intersection of the Southeast right-of-way line of Schertz Road with the West right-of-way line of Thousand Oaks;

THENCE: Along said Schertz Road right-of-way line, S 41°03'48" W, 217.60 feet to a point of curvature;

THENCE: Continuing along said Schertz Road right-of-way line and along the arc of a curve to the right, said curve having a radius of 430.00 feet, a central angle of 07°47'44", a chord bearing and distance of S 44°57'40" W, 58.46 feet, and an arc length of 58.50 feet to the POINT OF BEGINNING;

THENCE: Departing said right-of-way line, S 41°08'28" E, 267.93 feet to a point;

THENCE: S 29°20'47" W, 118.33 feet to a point;

THENCE: S 88°34'55" W, 593.05 feet to a point;

THENCE: S 81°36'30" W, 29.10 feet to a point;

THENCE: N 00°57'39" W, 213.89 feet to a point on the Southeast right-of-way line of Schertz Road;

THENCE: Along said right-of-way line, N 89°02'21" E, 231.10 feet to a point;

Tract 13
3.38 Acres

Z2007318

Z2018335

THENCE: Continuing along said right-of-way line and along the arc of a curve to the left, said curve having a radial bearing of N 00°56'04" W, a radius of 430.00 feet, a central angle of 40°12'24", a chord bearing and distance of N 68°57'44" E, 295.60 feet, and an arc length of 301.75 feet to the POINT OF BEGINNING and containing 3.38 acres in the City of San Antonio, Bexar County, Texas.

This document was prepared under 22 TAC 663.21, does not reflect the results of an on the ground survey, and is not to be used to convey or establish interests in real property except those rights and interests implied or established by the creation or reconfiguration of the boundary of the political subdivision for which it was prepared.

I:\3633\10\Design\Zoning\zn13.doc

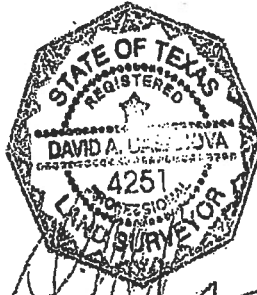

FIELD NOTES
FOR ZONING EXHIBIT
TRACT 5
10.85 ACRES

Being 10.85 acres of land, more or less, out of the J. Hefferman Survey No. 101, Abstract No. 338, County Block 5028, New City Block 14945, and the M.A. De Los Santos Coy Survey No. 306, Abstract No. 135, County Block 5034, New City Block 14945 in the City of San Antonio, Bexar County, Texas. Said 10.85 acres being more particularly described as follows with bearings based on the Texas Coordinate System, South Central Zone, N.A.D. 83:

COMMENCING At a point at the intersection of the southeast right-of-way line of Schertz Road and the north right-of-way line of Wurzbach Parkway;

THENCE: Along the southeast right-of-way line of said Schertz Road, N 49°04'34"E, 2072.01 feet to a point;

THENCE: Continuing along said right-of-way, N 49°49'51"E, 280.57 feet to the POINT OF BEGINNING and the Westernmost corner of herein described 10.85 acre tract of land;

THENCE: Along said Southeast right-of-way line of Schertz Road, N 49°49'51" E, 552.28 feet to a point;

THENCE: Continuing along said right-of-way line and along the arc of a curve to the right, having a radial bearing of S 40°10'09" E, a radius of 542.63 feet, a central angle of 39°14'06", a chord bearing and distance of N 69°26'54" E, 364.36 feet, and an arc length of 371.58 feet to a point;

THENCE: Continuing along said right-of-way line, N 89°03'57" E, 560.97 feet to a point;

THENCE: Continuing along said right-of-way line, N 89°02'21" E, 256.89 feet to a point;

THENCE: Departing said right-of-way line of Schertz Road, S 00°57'39" E, 213.89 feet to a point;

Tract 5
10.85 Acres

THENCE: S 81°36'30" W, 829.00 feet to a point;

THENCE: S 64°33'39" W, 353.07 feet to a point;

THENCE: S 40°56'47" W, 344.96 feet to a point;

THENCE: N 41°20'49" W, 332.27 feet to the POINT OF BEGINNING and containing 10.85 acres in the City of San Antonio, Bexar County, Texas.

This document was prepared under 22 TAC 663.21, does not reflect the results of an on the ground survey, and is not to be used to convey or establish interests in real property except those rights and interests implied or established by the creation or reconfiguration of the boundary of the political subdivision for which it was prepared.

I:\3633\10\Design\Zoning\zn05.doc

