





**Board of Adjustment  
Notification Plan for  
Case No A-18-064**



- San Antonio City Limits 
- Subject Property 
- 200' Notification Boundary 
- Council District: 2



"NOT TO SCALE,  
FOR ILLUSTRATIVE PURPOSES ONLY"

Development Services Department  
City of San Antonio

**S WW WHITE RD**

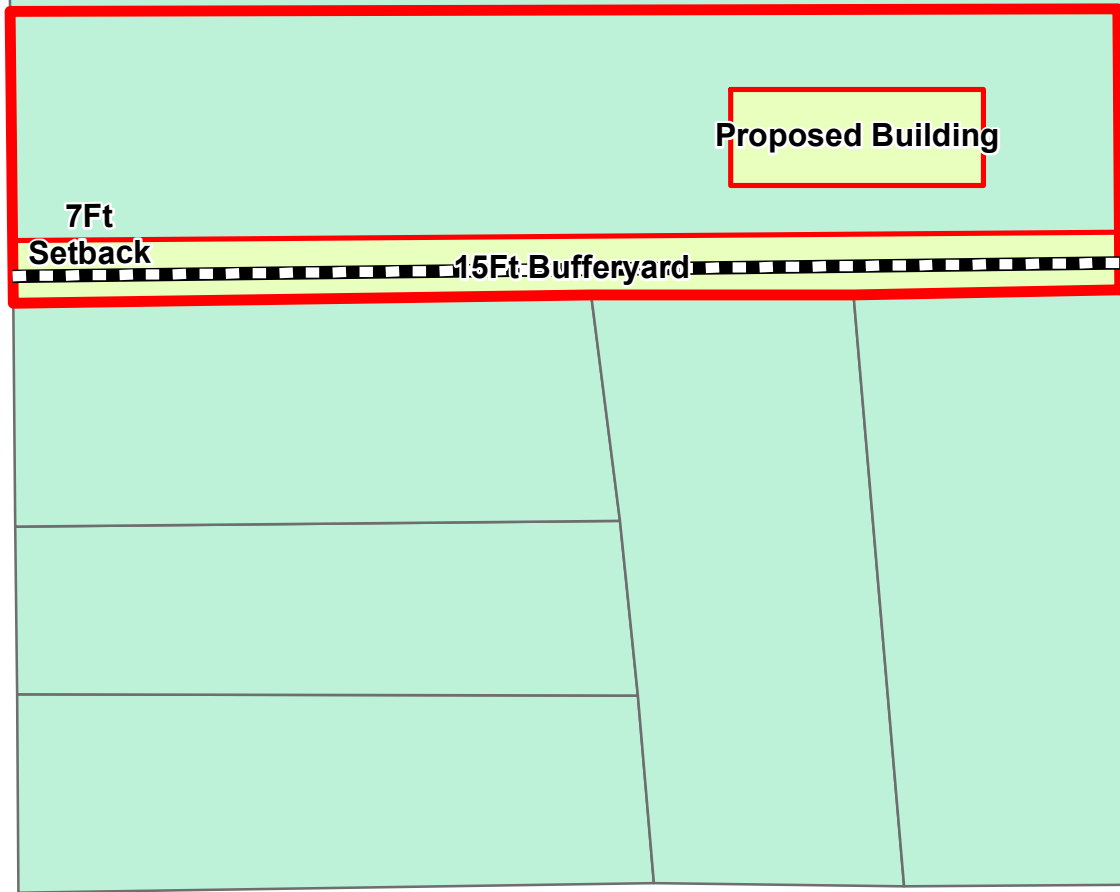

**HOLMGREEN RD**

**Board of Adjustment**  
Plot Plan for  
**Case No A-18-064**



"NOT TO SCALE,  
FOR ILLUSTRATIVE PURPOSES ONLY"  
Council District: 2

**1452 S WW White Rd**

Development Services Department  
City of San Antonio

CHURCH BUILDING R-5 NON RESIDENTIAL USE

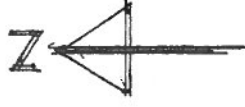
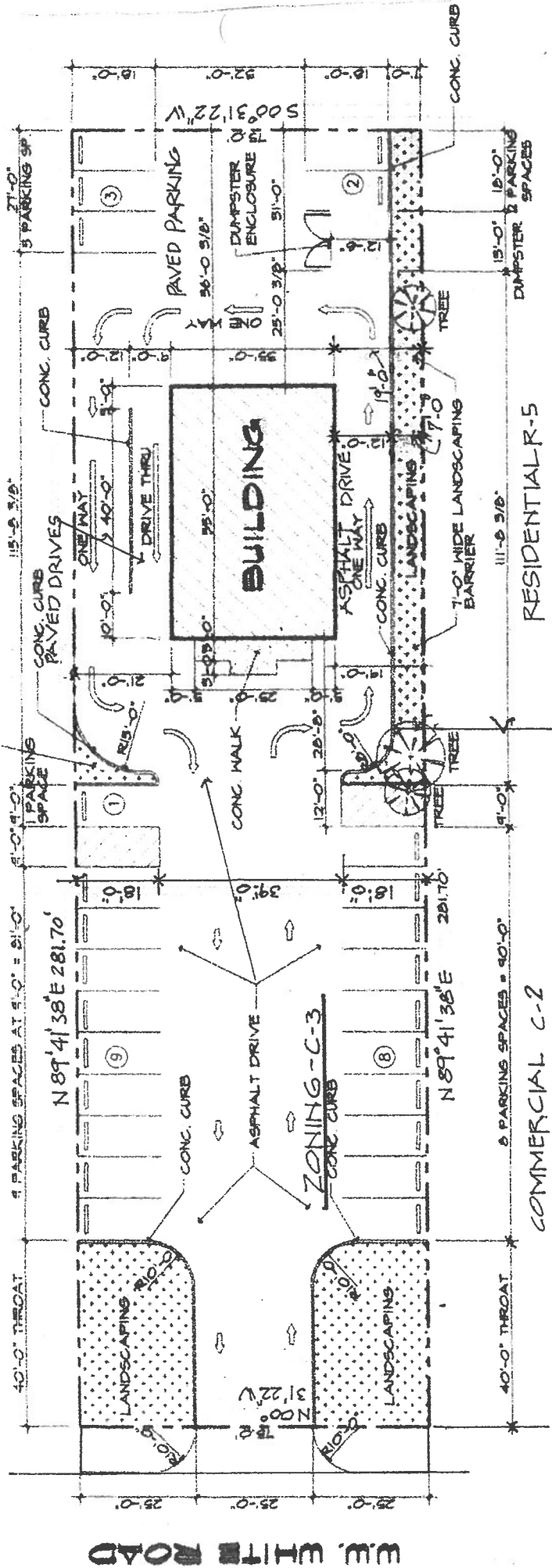

SITE PLAN SCALE: 1" = 20'-0"

- SETBACKS
- FRONT - 30'
- SIDE & COMMERCIAL - 0'
- SIDE & RESIDENTIAL - 30'
- REAR - 30'

REQUEST FOR MODIFIED "C" BUFFER VARIANCE

PROPERTY LEGAL DESCRIPTION

THE WEST 281.7' OF LOT 52  
 N.C.B. 10755  
 R.W. ALBERT SUBDIVISION  
 VOLUME 18353, PAGE 2465  
 D.R.B.C.T.  
 VOLUME 6400, PAGE 54  
 D.P.R.B.C.T.

LOT AREA = 21,127.50 SQ-FT

DATE: FEB. 15, 2018



JOE F. RODRIGUEZ  
 ARCHITECT  
 4726 HOLLYHEDGE  
 SAN ANTONIO, TEXAS 78228  
 210-432-7176

PROPOSED NEW RESTAURANT  
 EL SABROSITO RESTAURANT  
 14-52 S.W.V. WHITE RD SAN ANTONIO 78220

2-15-18

**A-18-064**  
**Subject Property – 1452 S. WW White Road**



**Subject Property Side View**



Streetscape



Streetscape

