

**All zoning in this region
Effective November 27, 2017
as per Zoning Case Z2017-206
Ordinance: 2017-08-31-0624**

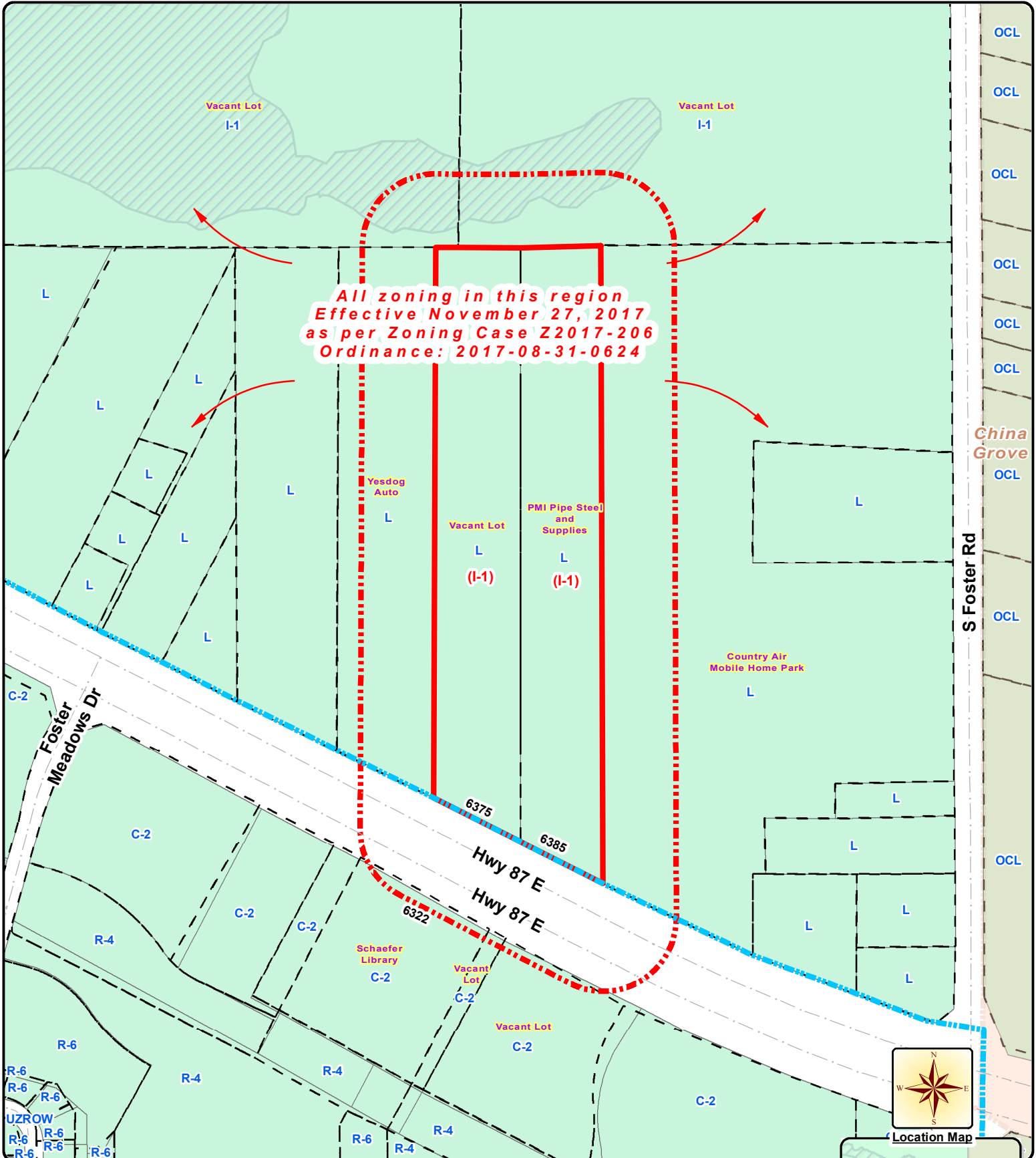

Location Map



Zoning Case Notification Plan

Case Z-2017-302

Council District: 2
 School District: East Central I.S.D.
 Scale: 1" approx. = 350 Feet
 Subject Property Legal Description(s): CB 5132 - LOT TR-7, EXC S IRRG 31.09 ft of 469, & TR-8 EXC S IRR 35.49 ft.

Legend

- Subject Property(ies) (17.28 Acres) ———
- 200 Ft. Buffer - - - - -
- Current Zoning TEXT
- Requested Zoning Change (TEXT) TEXT
- MLOD Region ▨
- AHOD Region ▨
- Single Family Residential 1R ▨
- Current Land Use Description TEXT
- 100-Year DFIRM Floodplain ▨
- City Limits ▨
- Corridor Overlay ▨
- ERZD Region ▨

Note: All Current and Requested Zoning includes Airport Hazard Overlay District (AHOD).