

SAN ANTONIO WATER SYSTEM DEVELOPMENT SERVICES
Interdepartmental Correspondence Sheet RECEIVED

2019 SEP 26 PM 1:25

To: Zoning Commission Members

From: Scott R. Halty, Director, Resource Protection & Compliance Department,
San Antonio Water System

Copies To: Andrew Wiatrek, Manager, Edwards Aquifer and Watershed Protection Division,
Michael Barr, Supervisor, Aquifer Protection and Evaluation Section, Michael A.
Escalante, Environmental Protection Specialist III

Subject: Zoning Case Z2019-10700181 (Hope Center Church Access Easement)

Date: September 18, 2019

SUMMARY

A request for a change in zoning has been made for an approximate 0.496-acre lot located on the city's northwest side. A change in zoning from "R-6 ERZD MLOD-1 MLR-1 AHOD" to "C-2 ERZD MLOD-1 MLR-1 AHOD" is being requested by the applicants, Aaron Staas, P.E. The change in zoning has been requested to allow for an access easement.

Currently, the site is a developed paved driveway located near the Ridge retail strip and the Hope Center Church. The subject property is located at 4545 North Loop 1604 West, the 431 foot driveway leading to the Hope Center Church was paved in 2000. Additionally, the proposed zoning change will not increase the existing impervious cover as the subject site is requesting the zoning change to allow for an access easement.

Based on the information submitted by the applicant, SAWS staff recommends **approval** for an assisted living facility, located at 4545 North Loop 1604 West. Should the San Antonio City Council rezone the property that is the subject of this report, the San Antonio Water System recommends that any proposed development on that property after the zoning classification has been changed should be reviewed by all applicable agencies.

APPROVED:

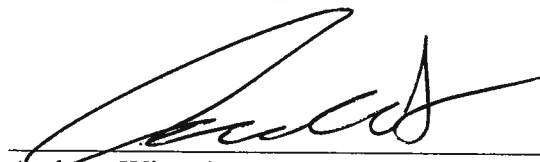

Andrew Wiatrek
Manager
Edwards Aquifer and Watershed Protection Division



Scott R. Halty
Director
Resource Protection & Compliance Department

MJB:MAE

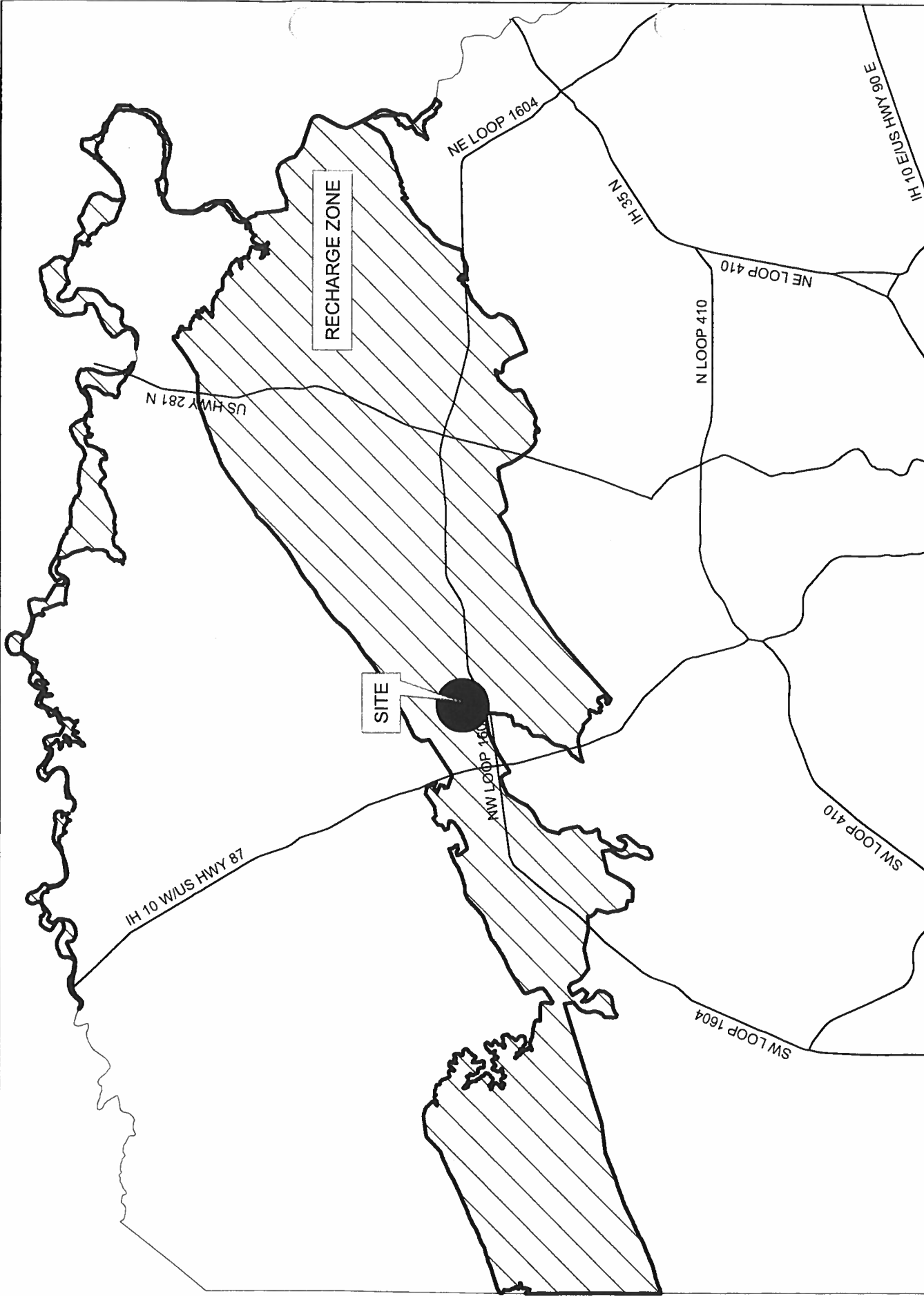

ZONING FILE: HOPE CENTER CHURCH ACCESS DRIVEWAY (FIGURE 1)
 ZONING CASE: Z2019-10700181
 MAP PAGE: 149, B6

1 in = 16,667 ft

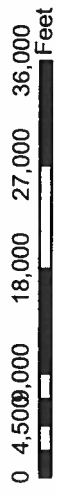

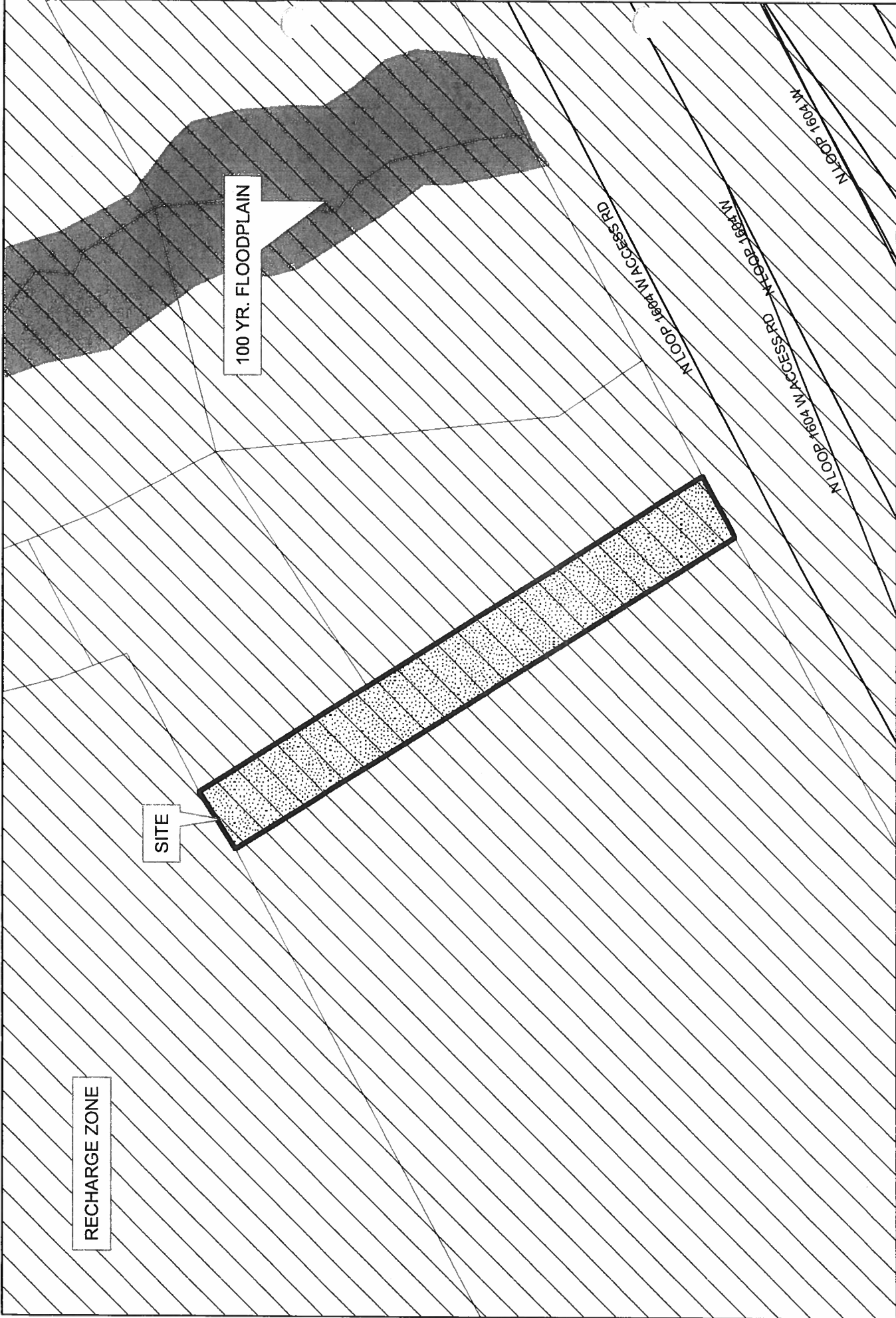

ZONING FILE: HOPE CENTER CHURCH ACCESS DRIVEWAY (FIGURE 2)
 ZONING CASE: Z2019-10700181
 MAP PAGE: 149, B6

