

LEGAL DESCRIPTION

BEING 1327.82 grid acres of land lying in Uvalde County, Texas, and being out of and in part of H.S. Johnson Survey 758, Abstract No. 1260, Geo. B. Johnson Survey 326, Abstract No. 982, G.C. & S.F. Ry. Co. Survey 757, Abstract No. 905, G.C. & S.F. Ry. Co. Survey 749, Abstract No. 915 and B.S. & F. Survey 171, Abstract No. 84 and being a composite of the parts of that same certain tract called 1342.25 acres with the individual tracts being termed "First, Second, Third, Fourth, and Fifth Tracts" as described in conveyance documents to Steve P. Urso et ux, and recorded in Volume 408, Page 458-473 of the Official Public Records of Uvalde County, Texas; and being more particularly described in Exhibit "A" attached hereto and made a part hereof; SAVE AND EXCEPT 5.00 grid acres of land lying in Uvalde County, Texas, and being out of and a part of H.S. Johnson Survey 758, Abstract No. 1260 and also being out of and a part of that same certain 1260.000 acre tract called "First Tract" and Exhibit "A" as described in conveyance documents to Steve P. Urso et ux and recorded in Volume 408, Page 458-473 of the Official Public Records of Uvalde County, Texas; and being more particularly described in Exhibit "B" attached hereto and made a part hereof.

TOGETHER WITH: A 60 foot wide road access easement through various Surveys in Uvalde County, Texas; Survey No. 972, H.M. Robinson, Original Grantee, Abst. 1533, Survey No. 971, G.C. & S.F. R.R. Co., Original Grantee, Abst. 1094, Survey No. 759, George B. Johnston, Original Grantee, Abst. 1035, and Survey No. 758, H.S. Johnston, Original Grantee, Abst. 1260, Uvalde County, Texas and being more particularly described in Exhibit "C" attached hereto and made a part hereof for all purposes.

D. G. Smyth & Company, Inc.

"A Statewide Professional Land Surveying Service Company"
1022 Garner Field Road, Suite B
Uvalde, Texas 78801

Office Tel. (830) 591-0858

Fax (830) 591-0863

FIELD NOTES FOR A BOUNDARY SURVEY COMPLETED SEPTEMBER 23, 2013 TRACT I - 1327.82 ACRES

Being a boundary survey of 1327.82 grid acres of land lying in Uvalde County, Texas, and being out of and a part of H. S. Johnson Survey 758, Abstract No. 1260, Geo. B. Johnson Survey 326, Abstract No. 982, G.C. & S.F. RY. Co. Survey 757, Abstract No. 905, G.C. & S.F. RY. Co. Survey 749, Abstract No. 915 and B.S. & F. Survey 171, Abstract No. 84 and being a composite of the parts of that same certain tract called 1342.25 acres with the individual tracts being termed "First, Second, Third, Fourth, and Fifth Tracts" as described in conveyance documents to Steve P. Urso et ux. and recorded in Volume 408, Pages 458-473 of the Official Public Records of Uvalde County, Texas, there is however a 5.00 acres tract retained by the current owner of record of said 1327.82 acres tract designated as Tract II surveyed concurrently and the more particular description for which is attach hereto and the 1327.82 acres total tract being more particularly described by metes and bounds as follows: (The courses, distances, areas and any coordinates cited herein or shown on the corresponding survey plat conform to the Texas Coordinate System, North American Datum 1927, Texas South Central Zone. (All corners called for as being set, are marked on the ground with 1/2" diameter steel stakes with identification markers stamped "SMYTH/2046" attached unless otherwise noted or shown.):

BEGINNING at a 1/2 inch diameter steel stake with cap marked "Smyth 2046" found as previously set for the southwest corner of the herein described tract, on the west line of H.S. Johnson Survey 758, Abstract No. 1260, the east line of B.S. & F. Survey 171, Abstract No. 84, the southwest corner of that same certain 73.27 acre tract called "Fourth Tract" and Exhibit "D" as described in conveyance documents to Steve P. Urso et ux. and recorded in Volume 408, Pages 458-473 of the Official Public Records of Uvalde County, Texas, and located on the common boundary of that same certain 2804.67 acre tract described in conveyance documents to Frances E. Livingston and recorded in Volume 140, Pages 553-559 of the Deed Records of Uvalde County, Texas, and said point being located at S.P.C. N= 585237.83', E= 1765956.34' from which corner a rock mound found for the southwest corner of said Survey 758 and the southeast corner of said Survey 171 bears S 00° 24' 16" E at 274.51 feet;

THENCE: N 00° 26' 57" W, along the west boundary of the herein described tract, the west boundary of said 73.27 acre tract, the east boundary of said 2804.67 acre tract, the east line of said Survey 171 and the west line of said Survey 758, for a distance of 4178.43 feet to a 1/2 steel stake with cap marked "Smyth 2046" found as previously set along the occupied fence for the north corner of said 73.27 acre tract at an angle point of the herein described tract located on the east line of said Survey 171, the west line of said Survey 758 and being the south corner of that same certain included tract called 5.61 acres and designated as "Second Tract" and Exhibit "B" as described in conveyance documents to Steve P. Urso et ux. and recorded in Volume 408, Pages 458-473 of the Official Public Records of Uvalde County, Texas and also located on a west boundary of that same certain tract called 1260.00 acres and designated as "First Tract" and Exhibit "A" as described in conveyance documents to Steve P. Urso et ux. and recorded in Volume 408, Pages 458-473 of the Official Public Records of Uvalde County, Texas;

THENCE: N 19° 26' 13" W, generally with the occupied fence along a west boundary line of herein described tract, the west boundary of said 5.61 acre tract and the eastern fenced of said 2804.67 acres tract for a distance of 1519.66 feet to a 6 inch diameter cedar 3-way fence corner post found for an exterior corner of the herein described tract, the northwest corner of said included 5.61 acre tract, the northeast fence corner of said 2804.67 acre tract located on the ostensible north line of said Survey 171 and the south line of G.C. & S.F. RY. Co. Survey 749, Abstract No. 915, and on the south boundary of that same certain 1941.86 acre tract conveyed to Briscoe Ranch Inc;

THENCE: N 89° 45' 28" E, generally with the occupied fence along the boundary of the herein described tract being the north boundary of said 5.61 acre included tract, the south boundary of said 1941.86 acre tract, the north line of said Survey 171 and the south line of Survey 749 for a distance of 317.56 feet to a 6 inch diameter cedar fence corner post found on the north boundary of said 5.61 acre tract and the southwest corner of that same certain 0.67 acre included tract called "Fifth Tract" and Exhibit "E" as described in conveyance documents to Steve P. Urso et ux and recorded in Volume 408, Pages 458-473 of the Official Public Records of Uvalde County, Texas;

THENCE: N 10° 24' 39" E, generally with the occupied fence along a west boundary of the herein described tract, the west boundary of said 0.67 acre tract and the east fenced boundary of said 1941.86 acre tract for a distance of 221.02 feet to an angle point in the fence;

THENCE: N 08° 46' 09" E, continuing generally with the occupied fence along a west boundary of the herein described tract, the west boundary of said 0.67 acres included tract and an east fenced boundary of said 1941.86 acre tract, at 395.49 feet passing the north corner of said 0.67 acres included tract and the south corner of that same certain included tract called 2.70 acres designated as "Third Tract" and Exhibit "C" as described in conveyance documents to Steve P. Urso et ux and recorded in Volume 408, Pages 458-473 of the Official Public Records of Uvalde County, Texas, and continuing along the same course now with the east boundary of said 2.70 acres tract for a total distance of 844.98 feet to an angle point in the enclosure fence and said point being on the east line of said Survey 749, the west line of said Survey 758, on a west boundary of said 1260.00 acre tract and on the southerly east boundary of said included 2.70 acre tract;

THENCE: N 00° 26' 48" W departing westerly from the occupied fence and along a west boundary of the herein described tract, the west boundary of said included 2.70 acre tract, the east record boundary of said 1941.86 acre tract, the east line of said Survey 749 and the west line of said Survey 758, crossing the occupied fence and continuing along the same course for a total distance of 1543.50 feet to a point along the occupied east-west fence for the northwest corner of the herein described tract, the north corner of said included 2.70 acre tract, an exterior corner of said 1260.00 acre tract, and the southwest corner of that same certain 373.77 acre tract called "First Tract" and Exhibit "A" as described in conveyance documents to Howard Pouncey et al and recorded in Volume 410, Pages 890-908 (Document No. 9900475) of the Official Public Records of Uvalde County, Texas, and from which point the occupied 2.5 inch diameter fence corner post bears S 85° 15' 12" W at 43.91 feet;

THENCE: N 84° 59' 26" E, generally with the occupied fence along a north boundary of the herein described tract, a north boundary of said 1260.00 acre tract and the south boundary of said 373.77 acre tract for a distance of 2189.89 feet to a ½ inch diameter steel stake found for a re-entrant corner of the herein tract, the southeast corner of said 373.77 acre tract and the re-entrant corner of said 1260.00 acre tract and from which point a 2.5 inch diameter pipe fence corner post bears N 33° 17' 04" W at 0.47 feet;

THENCE: N 12° 18' 02" E, generally with the occupied fence along the upper western boundary of the herein described tract, the east boundary of said 373.77 acre tract, and the upper west boundary of said 1260.00 acre tract for a distance of 1788.10 feet to a 2.5 inch diameter pipe fence corner post for an exterior corner of the herein described tract, a re-entrant corner of said 373.77 acre tract and an exterior corner of said 1260.00 acre tract;

THENCE: N 81° 55' 44" E, generally with the occupied fence along the most northerly north boundary of the herein described tract, the south boundary of said 373.77 acre tract and the most northerly north boundary of said 1260.00 acre tract, at 370.87 feet passing a ½ inch diameter steel stake set for the northwest corner of a 5.00 acres retained acreage tract designated as Tract H surveyed concurrently with the herein described tract, and continuing along the same course at 389.84 feet passing an exterior corner of said 373.77 acre tract, the southwest corner of that same certain 376.09 acre tract termed Tract I as described in conveyance documents to Frin Property, Ltd. and recorded in Volume 514, Pages 254-260 (Document No. 2003003373) of the Official Public Records of Uvalde County, Texas, and said point also being the center of a 60 foot wide road access easement designated as Exhibit "F" as described in conveyance documents to Stove P. Urso et ux and recorded in Volume 408, Pages 458-473 of the Official Public Records of Uvalde County, Texas and continuing along the same course now with the south boundary of said 376.09 acre tract and the most northerly north boundary of the herein described tract, at 813.08 feet passing a ½ inch diameter steel stake set for the northeast corner of said 5.00 acres retained acreage tract surveyed concurrently, and continuing along the same course for a total distance of 2138.42 feet to 3-way fence corner post found marking the southeast corner of said 376.09 acre tract, the upper northeast corner of the herein described tract located on a west boundary of that same certain tract known as the Amundale Ranch and recorded in Volume 29, Pages 250-251 of the Deed Records of Uvalde County, Texas and said point being the upper northeast corner of said 1260.00 acre tract;

THENCE: Generally in a southeasterly direction with the fence along as eastern boundary of the herein described tract, a west boundary of said Amundale Ranch, and an east boundary of said 1260.00 acre tract for the following seven (7) calls:

1. S 05° 18' 21" E, for a distance of 783.79 feet to a ½ steel stake found for a deflection point;
2. S 18° 58' 06" E, for a distance of 1223.77 feet to a 2.5 inch diameter pipe fence corner post found for a corner;
3. S 83° 16' 35" E, for a distance of 668.13 feet to a 2.5 inch diameter pipe fence corner post found for a corner;
4. S 06° 03' 24" E, crossing the common line between said Survey 758 and Geo. B. Johnson Survey 326, Abstract No. 982, and continuing along the same course into said Survey 326 for a total distance of 2004.67 feet to a ½ inch diameter steel stake found for a re-entrant corner of the herein described tract;
5. N 86° 35' 34" E, for a distance of 1057.50 feet to a ½ inch diameter steel stake found for an angle point;
6. S 53° 55' 44" E, for a distance of 662.43 feet to a ½ inch diameter steel stake found for an angle point;
7. S 08° 57' 57" E, for a distance of 1818.84 feet 2.5 inch diameter pipe 3-way fence corner post for an exterior corner of the herein described tract;

THENCE: Progressing in a southwesterly direction generally with the occupied fence along a southeasterly boundary of the herein described tract, a northwesterly boundary of said Amundale Ranch, and a southeasterly boundary of said 1260.00 acre tract for the following seven (7) calls:

1. S 44° 24' 33" W, for a distance of 1111.83 feet to a deflection point;

2. S 42° 16' 50" W, leaving the fence for a distance of 1826.80 feet to a 2.5 inch diameter pipe fence corner post found for a deflection point;
3. S 31° 43' 08" W, at 276.82 feet a ½ inch diameter steel stake found as previously set marking the common line between said Survey 326 and G.C. & S.P. RY. Co. Survey 757, Abstract No. 905, and continuing along the same course into said Survey 757 for a total distance of 921.37 feet to a deflection point;
4. S 31° 24' 46" W, for a distance of 495.32 feet to fence corner post found for a deflection point;
5. S 68° 31' 42" W, for a distance of 2085.06 feet to a 3-way cedar fence corner post;
6. S 83° 55' 55" W, for a distance of 1519.18 feet to a fence corner post for a deflection point;
7. S 84° 13' 37" W, for a distance of 452.24 feet to a point for the southeast corner of the aforesaid 73.27 acres included tract, on the south boundary of the herein described tract and the southwest corner of said 1260.00 acres included tract;

THENCE: N 89° 37' 40" W, along the south boundary of said 73.27 acre tract, the south boundary of the herein described tract and a record boundary of said Annendale Ranch, at 612.84 feet passing the common line between said Survey 757 and said Survey 758 and continuing along the same course for a total distance of 1184.78 feet to the **PLACE OF BEGINNING** and containing 1327.82 grid acres of land within the herein described boundary according to an actual survey made on the ground by D.G. Smyth & Co., Inc. and completed September 23, 2013, **SAVE AND EXCEPT** that same certain retained 5.00 acre tract designated as Tract II the more particular description for which is hereto attached.

THE STATE OF TEXAS:
COUNTY OF UVALDE:

It is hereby certified that the foregoing field note description and attached plat were prepared from an actual on the ground survey made by personnel working under my direct supervision and that same are true and correct according to same said survey.

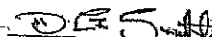
D. G. Smyth-Registered Professional Land Surveyor
Licensed State Land Surveyor No. 2046

PROJECT NO. 13-4898 Tr I



D. G. Smyth & Company, Inc.

"A Statewide Professional Land Surveying Service Company"

1022 Garner Field Road, Suite D

Uvalde, Texas 78801

Office Tel. (830) 591-0858

Fax (830) 591-0863

FIELD NOTES FOR A RETAINED ACREAGE SURVEY COMPLETED SEPTEMBER 23, 2013 TRACT II -- 5.00 ACRES

Being a retained acreage survey of 5.00 grid acres of land lying in Uvalde County, Texas, and being out of and a part of H. S. Johnson Survey 758, Abstract No. 1260 and also being out of and a part of that same certain 1260.00 acre tract called "First Tract" and Exhibit "A" as described in conveyance documents to Steve P. Urso et ux. and recorded in Volume 408, Pages 458-473 of the Official Public Records of Uvalde County, Texas, and being more particularly described by metes and bounds as follows: (The courses, distances, areas and any coordinates cited herein or shown on the corresponding survey plat conform to the Texas Coordinate System, North American Datum 1927, Texas South Central Zone. (All corners called for as being set are marked on the ground with ½" diameter steel stakes with identification markers stamped "SMYTH/2046" attached unless otherwise noted or shown.))

BEGINNING at a ½ inch diameter steel stake set for the northwest corner of the herein described tract being located at S.P.C. N= 595436.81', E= 1768821.79', and being on the most northerly north boundary of that same certain 1260.00 acre tract called "First Tract" and Exhibit "A" as described in conveyance documents to Steve P. Urso et ux. and recorded in Volume 408, Pages 458-473 of the Official Public Records of Uvalde County, Texas, from which point the center line terminus of a 60 foot wide road access easement designated as Exhibit "P" as described in conveyance documents to Steve P. Urso et ux. and recorded in Volume 408, Pages 458-473 of the Official Public Records of Uvalde County, Texas, bears N 81° 55' 44" E at 18.97 feet and a fence post marking the northeast corner of said 1290.00 acres tract bears N 81° 55' 44" E at a distance of 1325.34 feet;

TRENCHE: N 81° 55' 44" E, along the most northerly north boundary of said 1260.00 acre tract and the north boundary of the herein described tract, at 18.97 feet passing the center line terminus of said 60 foot road easement and the southwest corner of that same certain 376.09 acre tract called Tract I as described in conveyance documents to Frio Property, Ltd. and recorded in Volume 514, Pages 254-260 (Document No. 2003003373) of the Official Public Records of Uvalde County, Texas, and continuing along the same course with the south boundary of said 376.09 acre tract for a total distance of 442.21 feet to a ½ inch diameter steel stake set for the northeast corner of the herein described tract, on the south boundary of said 376.09 acre tract and on the most northerly north boundary of said 1260.00 acre tract;

TRENCHE: S 11° 04' 51" E, leaving the boundary of said 376.09 acre tract and across and into said 1260.00 acre tract for a distance of 272.65 feet to a ½ inch diameter steel stake set for an exterior corner of the herein described tract;

TRENCHE: S 75° 33' 52" W, for a distance of 110.07 feet to a ½ inch diameter steel stake set for a deflection point of the herein described tract;

THENCE: S 57° 44' 52" W, for a distance of 250.33 feet to a ½ inch diameter steel stake set for a re-entrant corner of the herein described tract;

THENCE: S 16° 37' 58" E, for a distance of 322.27 feet to a ½ inch diameter steel stake set for a re-entrant corner of the herein described tract;

THENCE: N 76° 25' 03" E, for a distance of 181.56 feet to a ½ inch diameter steel stake set for an exterior corner of the herein described tract;

THENCE: S 50° 04' 11" E, for a distance of 159.39 feet to a ½ inch diameter steel stake set for the most southerly east corner of the herein described tract an exterior corner;

THENCE: S 32° 07' 28" W, for a distance of 199.15 feet to a ½ inch diameter steel stake set for an exterior corner of the herein described tract;

THENCE: S 81° 53' 26" W, for a distance of 179.93 feet to a ½ inch diameter steel stake set for the most southerly corner of the herein described tract;

THENCE: N 50° 56' 00" W, for a distance of 120.93 feet to a ½ inch diameter steel stake set for an exterior corner of the herein described tract;

THENCE: N 09° 09' 49" E, for a distance of 166.91 feet to a ½ inch diameter steel stake set for an exterior corner of the herein described tract;

THENCE: N 76° 25' 03" E, for a distance of 24.11 feet to a ½ inch diameter steel stake set for a re-entrant corner of the herein described tract;

THENCE: N 16° 37' 58" W, for a distance of 608.55 feet to a ½ inch diameter steel stake set for a deflection point of the herein described tract;

THENCE: N 31° 29' 04" W, for a distance of 116.39 feet to the PLACE OF BEGINNING and containing 5.60 grid acres of land within the herein described boundary according to an actual survey made on the ground by D.G. Smyth & Co., Inc. and completed September 23, 2013.

THE STATE OF TEXAS:
COUNTY OF UVALDE

It is hereby certified that the foregoing field note description and attached plat were prepared from an actual per the ground survey made by personnel working under my direct supervision and that same are true and correct according to same said survey.

D. G. Smyth-Registered Professional Land Surveyor
Licensed State Land Surveyor No. 2046

PROJECT NO. 13-4828 Tr II

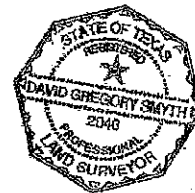

Edward Garrett & Associates

CIVIL ENGINEERING LAND SURVEYING
P.O. Drawer 263 County Road 387
Sabinal, Texas 78881
Telephone (830) 963-2034 Fax (830) 968-2033

DESCRIPTION OF A 60-FOOT WIDE ROAD ACCESS EASEMENT IN
UVALDE COUNTY, TEXAS

BEING a 60-foot wide road access easement through various Surveys in Uvalde County,
Texas, according to the following schedule:

Survey No.	Original Grantee	Abstract
972	H. M. Robinson	1533
971	G.C. & S.F. R.R. CO.	1094
759	T.C. R.R. CO.	1035
750	H. S. Johnston	1260

said 60-foot wide road access easement lying 30-feet on each side of its centerline
described as follows:

BEGINNING at a 5/8-inch iron pin set at the intersection of the centerline of this
described 60-foot wide road access easement with the SE right-of-way line of U. S.
Highway 83, from which a 5/8-inch iron pin found set by a fence corner post in said SE
right-of-way line of U.S. Hwy. 83, being the NW corner of that certain 510.144 acre tract
as described in a Deed dated April 10, 1997, from Oma Bell Ferry to R. B. Wilkoughby,
Jr., as recorded in Vol. 377 on Page 531 of the Deed Records of Uvalde County, Texas,
bears N 67°56'22" E, 514.06 feet, a 5/8-inch iron pin in old rock mound found marking
the NW corner of Survey No. 971 bears N 83°57'16" E, 2668.74 feet, a 5/8-inch iron pin
found by a fence corner post at the NW re-entrant corner of said Survey No. 971, bears
S 84°39'00" E, 2183.31 feet, and a 5/8-inch iron pin found in old rock mound at the West
NW corner of said Survey No. 971, being the SW corner of Survey No. 972, bears
S 81°01'55" W, 1942.72 feet;

THENCE with the centerline of this described 60-foot-wide road access easement as
follows:

S 25°01'01" E, 66.82 feet;
S 66°34'46" E, 209.26 feet;
S 79°02'11" E, 113.12 feet;
S 33°50'51" E, 162.67 feet;
S 76°17'13" E, 113.54 feet;
S 59°08'01" E, 171.81 feet;
S 77°65'16" E, 82.63 feet;
N 73°34'53" E, 140.09 feet;
S 56°21'55" E, 98.04 feet;
S 79°08'10" E, 199.55 feet;
N 66°25'20" E, 259.45 feet;
S 63°22'26" E, 176.24 feet;
N 86°06'00" E, 131.99 feet;
S 79°52'08" E, 133.12 feet;
S 74°13'26" E, 141.02 feet;
S 63°20'22" E, 144.45 feet;
S 50°12'39" E, 365.70 feet;
S 34°54'36" E, 88.64 feet;

Exhibit F

Page 1 of 2 pages

Vol 0408 PAGE 471

EXHIBIT "C" 99

S 08°09'28" W, 174.12 feet;
 S 29°16'03" E, 235.86 feet;
 S 14°31'21" W, 138.59 feet;
 S 42°24'32" E, 629.26 feet;
 S 12°49'54" W, 291.73 feet;
 S 53°28'56" W, 372.18 feet;
 S 65°46'33" W, 76.74 feet;
 N 41°46'33" W, 127.34 feet;
 S 88°28'30" W, 94.72 feet;
 S 36°01'22" W, 286.68 feet;
 S 35°16'24" E, 341.57 feet;
 S 03°45'50" E, 69.73 feet;
 S 24°14'21" W, 157.87 feet;
 S 13°30'50" W, 19.02 feet;
 S 53°25'51" W, 747.72 feet;
 S 24°08'43" W, 1020.44 feet;
 S 53°49'52" E, 421.47 feet;
 S 53°49'52" E, 421.47 feet;
 S 46°06'02" E, 90.14 feet;
 S 55°58'34" E, 147.86 feet;
 S 24°41'49" E, 110.84 feet;
 S 73°19'54" E, 159.77 feet;
 S 42°48'21" E, 150.58 feet;
 S 57°18'08" E, 139.27 feet;
 S 29°52'14" E, 125.24 feet;
 S 19°51'30" W, 59.71 feet;
 S 13°46'03" E, 88.87 feet;
 S 25°02'52" E, 77.17 feet;
 S 38°34'51" E, 290.34 feet;
 S 66°02'46" E, 63.15 feet;
 S 30°03'22" E, 53.61 feet;
 S 54°19'27" E, 98.47 feet;
 S 77°03'08" E, 88.16 feet;
 S 39°10'34" E, 232.91 feet;
 S 16°23'59" E, 211.67 feet;
 S 43°00'28" E, 39.38 feet;
 S 26°57'19" E, 245.57 feet;
 S 48°30'26" E, 66.68 feet;
 S 05°32'20" E, 117.22 feet;
 S 32°04'58" W, 82.74 feet;
 S 27°50'36" E, 175.34 feet;

and S 34°47'39" E, 840.08 feet to the intersection of the centerline of this
 described 60-foot wide road access easement with the North line of a 1260.00 acre tract
 this date surveyed, from which a 5/8-inch iron pin set for the upper NW corner of said
 1260.00 acre tract bears S 81°36'58" W, 384.69 feet.

(Note: Bearings recited herein are true bearings obtained using G.P.S.)

Surveyed by: *Edward R. Garrett*
 Edward R. Garrett 12/4/98
 R.P.L.S. No. 2242



Exhibit F
 Page 2 of 2 pages

vol 0408 PAGE 472

EXHIBIT " C "

FILED AND RECORDED
OFFICIAL PUBLIC RECORDS

Lucille C. Hutcherson

12-30-98 04:34 PM 9804030
GARCIA \$39.00
Lucille C. Hutcherson, County Clerk
UVALDE COUNTY, TEXAS

VOL 0408 PAGE 473

11/11

EXHIBIT " C "