

22015115

LOOP 410  
(320' R.O.W.)

LOISPECIFIC USE FOR  
MANUFACTURED HOME / OVERSIZED  
VEHICLE SALES, SERVICE OR STORAGE

THE PROPERTY OWNER, ACKNOWLEDGE THAT THIS SITE  
PURPOSE OF REZONING THIS PROPERTY IS IN ACCORDANCE  
WITH THE ZONING ORDINANCE OF THE CITY OF DALLAS.  
THE CITY OF DALLAS HAS REVIEWED THE SITE PLAN IN CONJUNCTION WITH A  
REVIEW OF THE SITE PLAN AND HAS DETERMINED THAT THE SITE PLAN  
IS SUBSTANTIAL FOR BUILDING PERMITS.

324.64 TO E. OF  
UECKER ROAD

14' ELECT., GAS, TELE,  
& CATV EASEMENT

N 00°02'18" W 324.31'

25' BLDG. SETBACK LINE

LOT 1  
BLOCK 1  
N.C.B. 17295  
(VOL. 9502 PG. 110)

PROPERTY LINE  
N 89°58'20" W

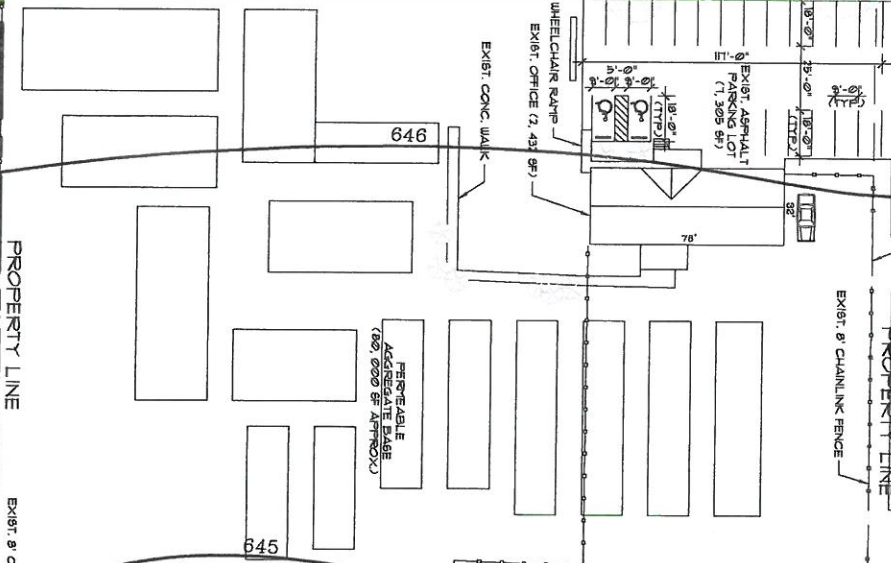

14' ELECT., GAS, TELE,  
& CATV EASEMENT

TEX-CON RD.

60' SANITARY SEWER EASEMENT  
(UNRECORDED)

LOT 43  
N.C.B. 12888  
(UNRECORDED)

LOT 2  
N.C.B. 17295  
(VOL. 9502 PG. 110)  
4,000 acres

499.71'

UNPLATTED  
(VOL. 3843 PG. 1018)

PROPERTY LINE  
S 00°02'18" E

346.52'

REMAINING PORTION OF P-3  
N.C.B. 12888  
(VOL. 4361 PG. 259)

