

## HISTORIC AND DESIGN REVIEW COMMISSION

April 15, 2015

### Agenda Item No: 16

<b>HDRC CASE NO:</b>	<b>2015-133</b>
<b>COMMON NAME:</b>	New Territories Park
<b>ADDRESS:</b>	9023 BOWEN
<b>LEGAL DESCRIPTION:</b>	NCB 19005 BLK 4 LOT 1 (NEW TERRITORIES UT-1A) "GUILBEAU/FM 1604" ANNXATN
<b>ZONING:</b>	R6
<b>CITY COUNCIL DIST.:</b>	6
<b>APPLICANT:</b>	Lance Permenter
<b>OWNER:</b>	City of San Antonio
<b>TYPE OF WORK:</b>	Park Improvements

### REQUEST:

The applicant is requesting a Certificate of Appropriateness for approval to:

1. Install two sets of trash receptacles, two pet waste stations and trash cans.
2. Repair a section of an existing pathway by extending the concrete beyond a washout point.
3. Benches will be installed and an existing water fountain will be replaced.

Possible design alternatives include:

4. Install a loop trail composed of decomposed granite with flush concrete edge.
5. Add additional non-surfaced cleared trails within the natural interior areas of the Park.
6. Install a 50' diameter shade fabric canopy structure over the existing playground.
7. Install a 40' diameter picnic pad complete with 4 picnic tables and a hexagon shade fabric canopy structure, or metal standing seem canopy.

### APPLICABLE CITATIONS:

*UDC Section 35-642 – New Construction of Buildings and Facilities:*

#### a. Site and Setting

2. Special consideration should be given to maintain existing urban design characteristics, such as setbacks, building heights, streetscapes, pedestrian movement, and traffic flow. Building placement should enhance or create focal points and views. Continuity of scale and orientation shall be emphasized.
3. Accessibility from streets should be designed to accommodate safe pedestrian movement as well as vehicular traffic. Where possible, parking areas should be screened from view from the public right-of-way by attractive fences, berms, plantings or other means.
4. Historically significant aspects of the site shall be identified and if possible incorporated into the site design. Historic relationships between buildings, such as plazas or open spaces, boulevards or axial relationships should be maintained.

#### b. Building Design

1. Buildings for the public should maintain the highest quality standards of design integrity. They should elicit a pride of ownership for all citizens. Public buildings should reflect the unique and diverse character of San Antonio and should be responsive to the time and place in which they were constructed.
2. Buildings shall be in scale with their adjoining surroundings and shall be in harmonious conformance to the identifying quality and characteristics of the neighborhood. They shall be compatible in design, style and materials. Reproductions of styles and designs from a different time period are not encouraged, consistent with the secretary of the interior's standards. Major horizontal and vertical elements in adjoining sites should be respected.
3. Materials shall be suitable to the type of building and design in which they are used. They shall be durable and easily maintained. Materials and designs at pedestrian level shall be at human scale, that is they shall be designed to be understood and appreciated by someone on foot. Materials should be selected that respect the historic character of the surrounding area in texture, size and color.
5. Colors shall be harmonious with the surrounding environment, but should not be dull. Choice of color should reflect the local and regional character. Nearby historic colors shall be respected.
8. Auxiliary design. The site should take into account the compatibility of landscaping, parking facilities, utility

and service areas, walkways and appurtenances. These should be designed with the overall environment in mind and should be in visual keeping with related buildings, structures and places.

**FINDINGS:**

- a. The proposed improvements are appropriate to help make the park more accessible and inviting to users. The improvements are consistent with the UDC Section 35-642.b.1 in terms of maintaining high design quality standards for public facilities.
- b. The proposed new sidewalk is appropriate for its location and will improve accessibility to the park, consistent with the UDC Section 35-642.a.3.
- c. The proposed installation of public amenities including trash cans, seating and shade structures appear to be compatible with the landscape. This is consistent with the UDC section 35-642.b. 8.
- d. The project has been reviewed by the City Archaeologist.

**RECOMMENDATION:**

Staff recommends approval of items 1-7 based on findings a through d.

**CASE MANAGER:**

Alyson Smith





## 9023 Bowen St.

### New Territories Park

Printed: Apr 08, 2015

The City of San Antonio does not guarantee the accuracy, adequacy, completeness or usefulness of any information. The City does not warrant the completeness, timeliness, or positional, thematic, and attribute accuracy of the GIS data. The GIS data, cartographic products, and associated applications are not legal representations of the depicted data. Information shown on these maps is derived from public records that are constantly undergoing revision. Under no circumstances should GIS-derived products be used for final design purposes. The City provides this information on an "as is" basis without warranty of any kind, express or implied, including but not limited to warranties of merchantability or fitness for a particular purpose, and assumes no responsibility for anyone's use of the information.

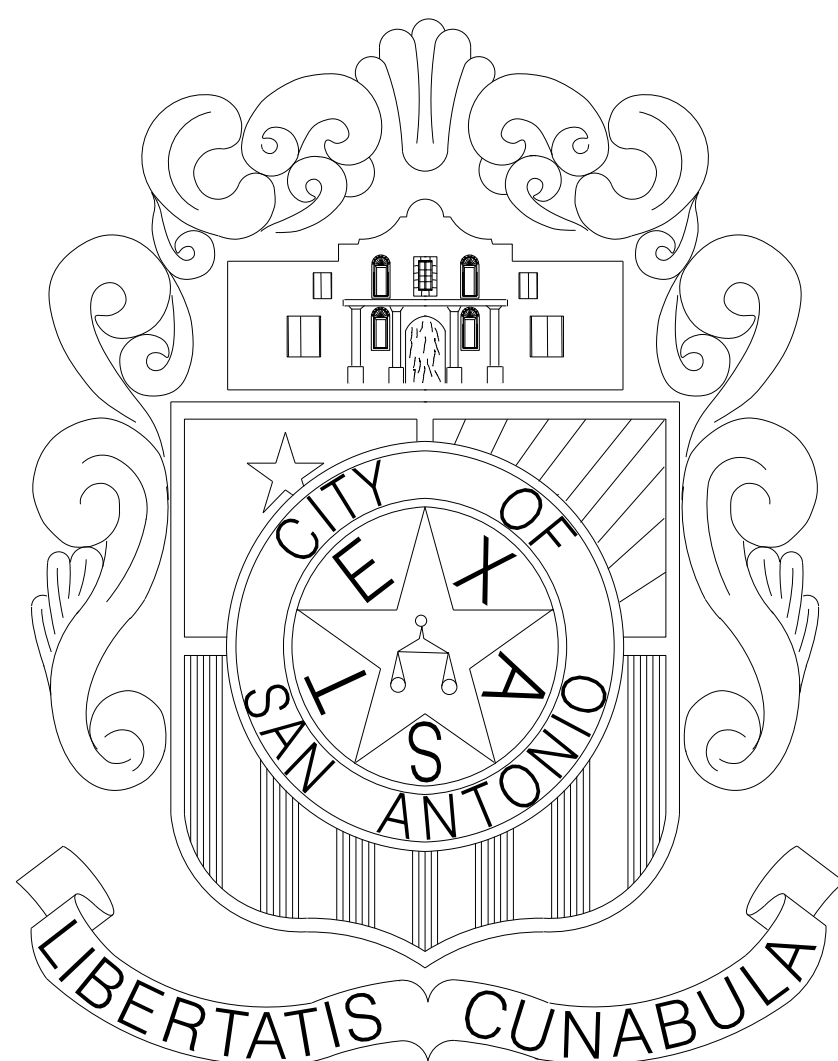

**CITY OF SAN ANTONIO**  
**DISTRICT 6 PARK IMPROVEMENTS**  
**NEW TERRITORIES PARK**

**9023 BOWEN STREET**  
**SAN ANTONIO, TEXAS**

**CITY MANAGER**

SHERYL SCULLEY

**TCI DIRECTOR**

MIKE FRISBIE

**TCI PROJECT MANAGER**

CARLOS MENDEZ  
LANDSCAPE ARCHITECT  
PH. # 210-207-2878  
FAX # 210-207-2197

**PRIME CONSULTANT**

KUDELA & WEINHEIMER, INC.  
LANDSCAPE ARCHITECT  
PH. # 210-349-3500  
FAX # 210-349-3508

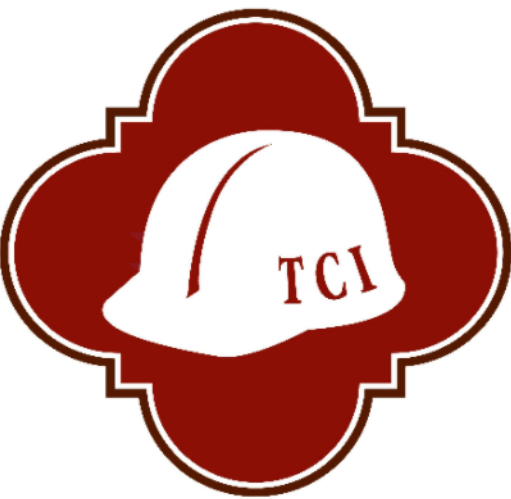

**SHEET INDEX**

LANDSCAPE ARCHITECTURE	
L0.01 OVERALL SITE PLAN	03/16/2015
L1.01 MATERIALS PLAN	03/16/2015
L1.02 MATERIALS PLAN	03/16/2015
L1.03 MATERIALS PLAN	03/16/2015
L1.04 MATERIALS PLAN	03/16/2015
L1.05 MATERIALS PLAN	03/16/2015
L1.06 MATERIALS PLAN	03/16/2015
L2.01 DETAILS	03/16/2015
L2.02 DETAILS	03/16/2015

**DATE OF ISSUE: 03/16/2015**

**PROJECT NUMBER**

40-00377

**FUNDING**

2012-17 GENERAL OBLIGATION BOND PROGRAM

**CITY COUNCIL**

**MAYOR**

IVY R. TAYLOR

**COUNCIL**

ROBERTO C. TREVIÑO .....	DISTRICT 1
ALAN E. WARRICK, II .....	DISTRICT 2
REBECCA J. VIAGRAN .....	DISTRICT 3
REY SALDANA .....	DISTRICT 4
SHIRLEY GONZALES .....	DISTRICT 5
RAY LOPEZ .....	DISTRICT 6
CHRIS MEDINA .....	DISTRICT 7
RON NIRENBERG .....	DISTRICT 8
JOE KRIER .....	DISTRICT 9
MIKE GALLAGHER .....	DISTRICT 10

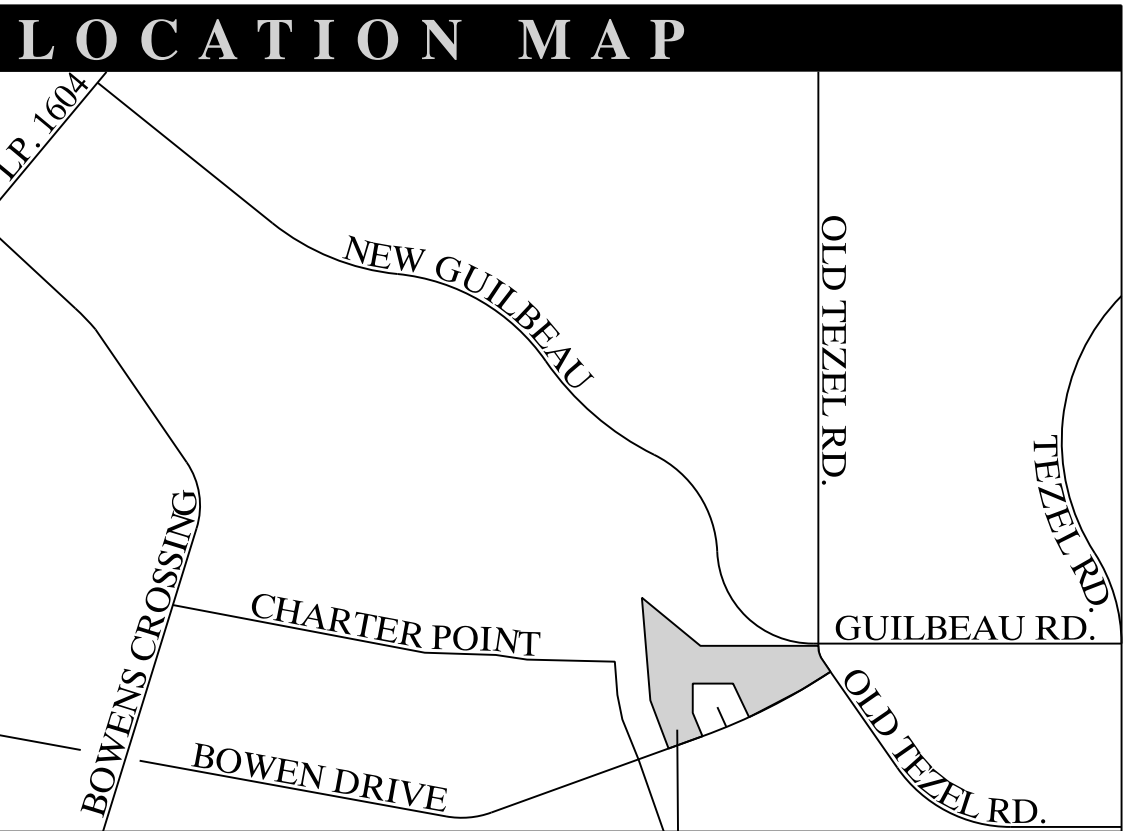

PROJECT LOCATION

OUR MISSION: THROUGH INNOVATION AND DEDICATION, WE BUILD AND  
MAINTAIN SAN ANTONIO'S INFRASTRUCTURE

**TRANSPORTATION AND CAPITAL IMPROVEMENTS DEPARTMENT**

MUNICIPAL PLAZA BUILDING 114 W. COMMERCE SAN ANTONIO, TX 78238 PH # 210-207-2879 FAX # 210-207-2197



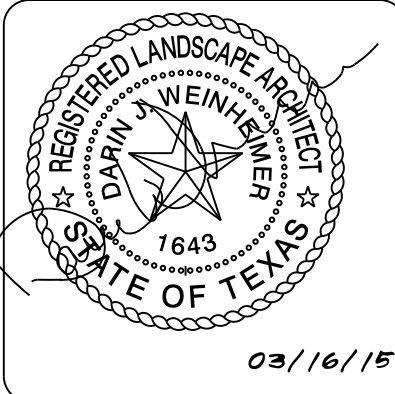

Date:	Revisions/Submissions
06/11/14	30% Construction Documents
10/17/14	50% Construction Documents
01/15/15	100% Construction Document
03/16/15	100% Construction Documents-Revisions

**CITY OF SAN ANTONIO**  
**TRANSPORTATION AND CAPITAL**  
**IMPROVEMENTS**  
VERTICAL PROJECT MANAGEMENT DIVISION  
MUNICIPAL PLAZA BUILDING 114 W. COMMERCE  
SAN ANTONIO, TX 78203-3966  
P.O. BOX 839966  
TEL. (210) 207-2879  
FAX (210) 207-2197

**NEW TERRITORIES PARK**  
9023 BOWEN STREET  
SAN ANTONIO, TEXAS

**OVERALL SITE PLAN**

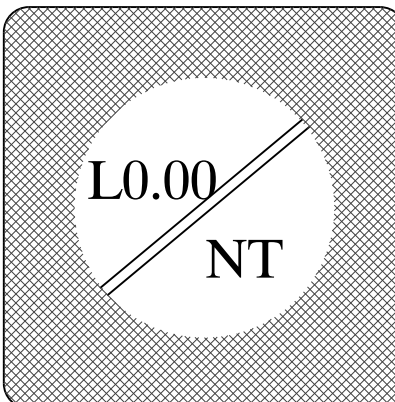

Designed By:
Designer Name
Drawn By:
DT
Date:
03/16/2015
Project No. :
CSA-351
Filename:
L-Overall.dgn

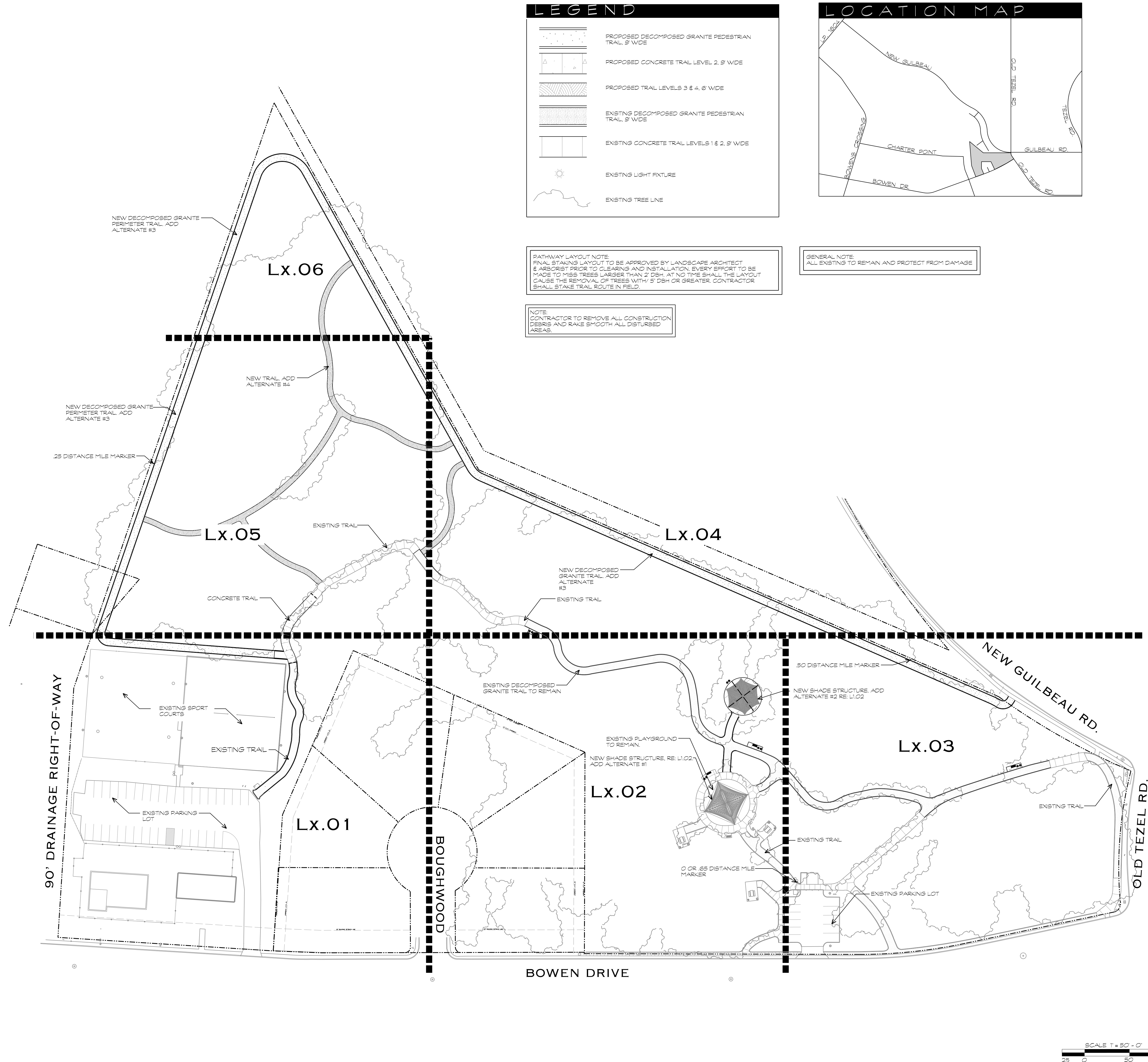

NOTE:  
CONTRACTOR TO REMOVE ALL CONSTRUCTION  
DEBRIS AND RAKE SMOOTH ALL DISTURBED  
AREAS.

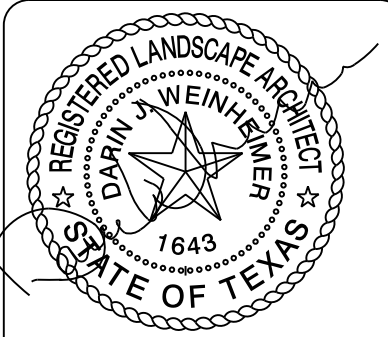
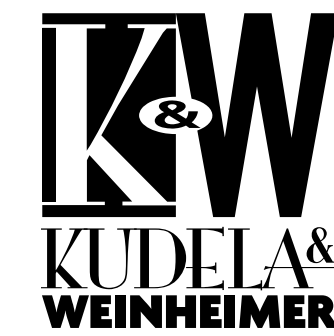
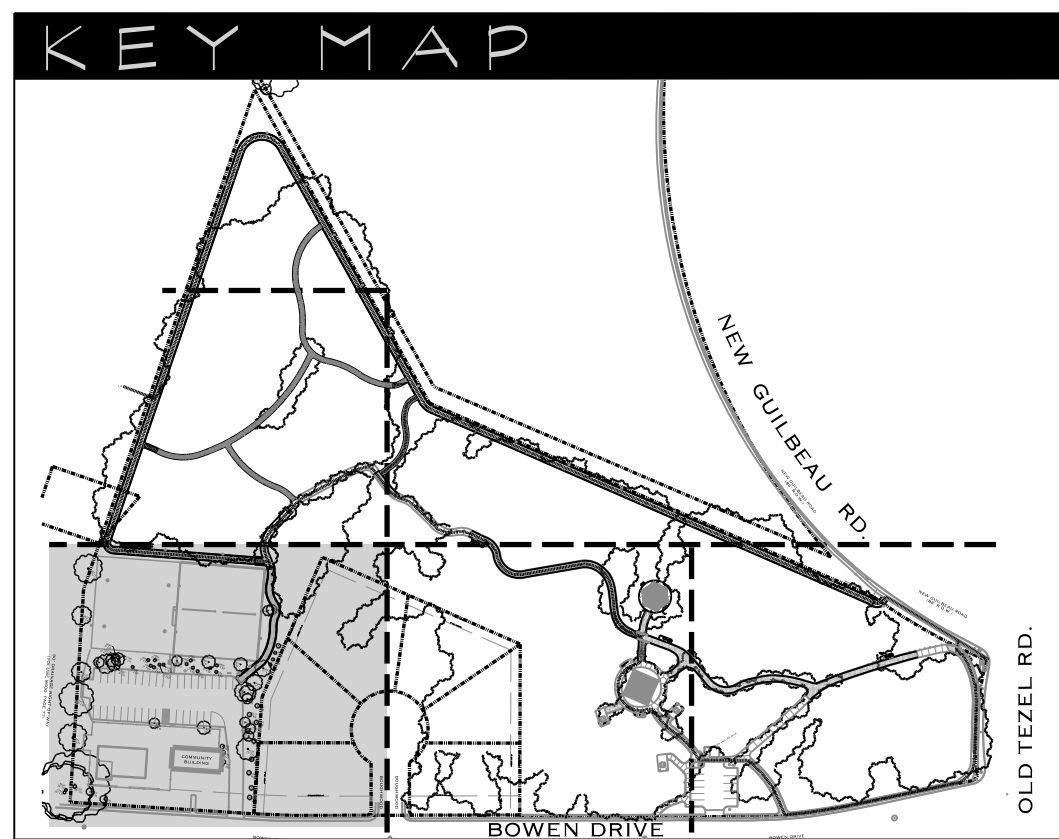

03/16/15

Date:	Revisions/Submission
06/11/14	30% Construction Document
10/17/14	50% Construction Document
01/15/15	100% Construction Document
03/16/15	100% Construction Documents-Revisions

**CITY OF SAN ANTONIO**  
**TRANSPORTATION AND CAPITAL**  
**IMPROVEMENTS**  
**VERTICAL PROJECT MANAGEMENT DIVISION**  
MUNICIPAL PLAZA BUILDING 114 W. COMMERCE  
SAN ANTONIO, TX 78203-3966  
P.O. BOX 839966  
TEL. (210) 207-2879  
FAX (210) 207-2197

**NEW TERRITORIES PARK**  
9023 BOWEN STREET  
SAN ANTONIO, TEXAS

**MATERIALS PLAN**

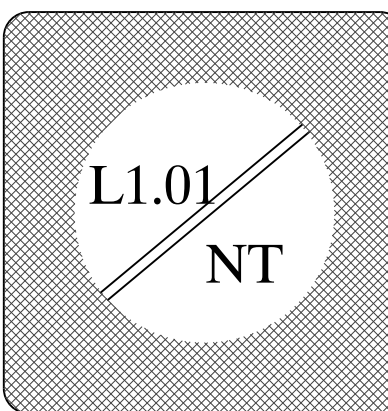

Designed By:	Designer Name
Drawn By:	DT
Date:	03/16/2015
Project No. :	CSA-351
Filename:	L-Materials.dgn

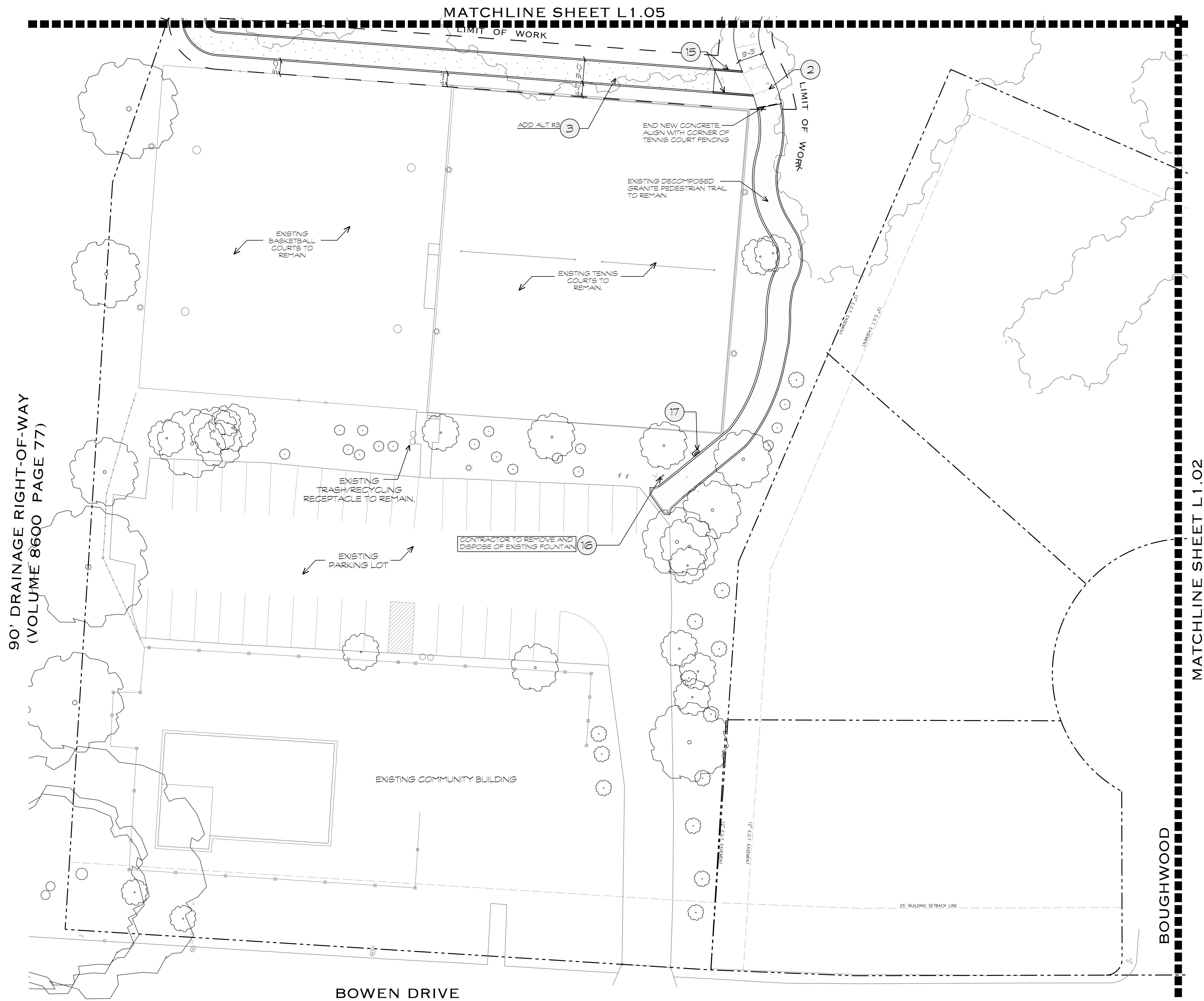

## LEGEND

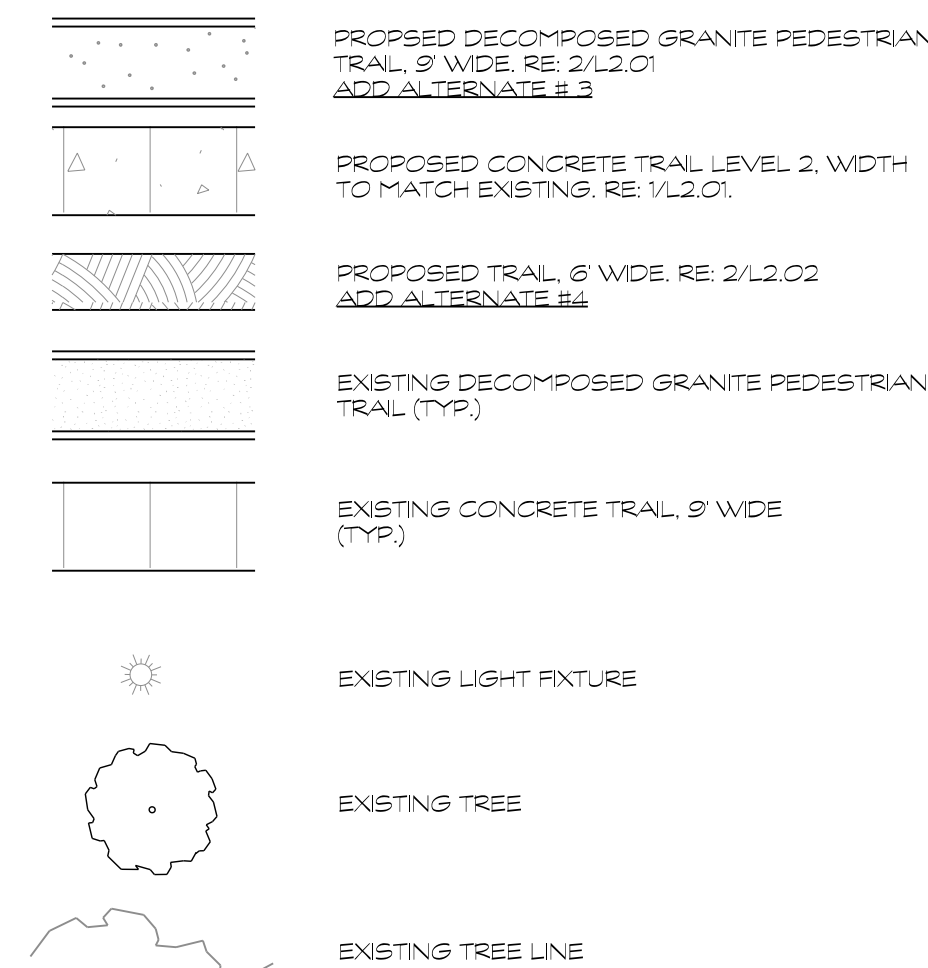

## MATERIALS LEGEND

1. EXISTING 9" CONCRETE TRAIL
2. CONCRETE TRAIL, 4'-2" THICK, 3' WIDE (TYP). RE: DETAIL 1/2 L2.01. SEE NOTE ON L2.00 FOR TREE CLEARING.
3. DECOMPOSED GRANITE PEDESTRIAN TRAIL, 3' WIDE. RE: DETAIL 2/1 L2.01. SEE NOTE ON L2.00 FOR TREE CLEARING. ADD ALTERNATE #3
4. NOT USED
5. RECYCLE RECEPTACLE TO BE FABRICATED WITH 1/4" STEEL AND PAINTED BLACK. RE: 6/1 L2.01
6. RECYCLE RECEPTACLE TO BE FABRICATED WITH 1/4" STEEL AND PAINTED BLUE. RE: 6/1 L2.01
7. PLANT COLOR, 92 SERIES BY DUMOR SITE FURNISHINGS, 92 SERIES WITH 5-2 SURFACE PLANT, 20% TO BE BLUE. SET ON CONCRETE PAD AND MOUNTED PER MANUFACTURERS INSTRUCTIONS. CONTACT CATHY COMEAU-WRIGHT @ 502-636-8266. RE: DETAIL 2/1 L2.02
8. PROPOSED TRAIL, 3' WIDE. RE: DETAIL 2/1 L2.02. SEE NOTE ON L2.00 FOR TREE CLEARING. ADD ALTERNATE #4
9. EXISTING PICNIC AREA
10. EXISTING DECOMPOSED GRANITE PEDESTRIAN TRAIL
11. EXISTING TRASH/RECYCLING RECEPTACLE
12. EXISTING BENCH
13. EXISTING CHILDREN'S PLAY AREA
14. EXISTING PARK SIGNAGE
15. TURN DOWN EDGE SIDEWALK. RE: DETAIL 8/1 L2.01. SEE NOTE ON L2.00 FOR TREE CLEARING.
16. PET FOUNTAIN WITH ADA FOUNTAIN BY MOST DEPENDABLE FOUNTAINS, INC. MODEL # 20085M1. COLOR TO BE EMERALD GREEN. INSTALL PER MANUFACTURERS RECOMMENDATION. CONTACT @ 1-800-552-6331
17. LITTER BASKS AND COMPLETE DOG WASTE STATION BY DOG-ON! PARKS. ITEM #74038. INSTALL PER MANUFACTURERS RECOMMENDATION. CONTACT @ 577-344-3647.
18. MARNERS SHADE STRUCTURE AT PLAYGROUND BY USA SHADE AND FABRIC DESIGN, BENCH, MODEL # H-25392. CONTACT DION SOTMA @ (612)-270-2252. SHADE STRUCTURES ARE TO BE PERMITTED SEPARATELY. CONTRACTOR SHALL BE RESPONSIBLE FOR OBTAINING ALL PERMITS REGARDING THIS STRUCTURE. ADD ALTERNATE #1
19. GROUP PICNIC UNIT - MULTI-PANEL, MULTILEVEL, HEXAGON SHADE STRUCTURE, BY USA SHADE AND FABRIC STRUCTURES, MODEL # MHPM40, 40' HEXAGON. CONTACT DION SOTMA @ (612)-270-2252. SHADE STRUCTURES ARE TO BE PERMITTED SEPARATELY. CONTRACTOR SHALL BE RESPONSIBLE FOR OBTAINING ALL PERMITS REGARDING THIS STRUCTURE. ADD ALTERNATE #2
20. GROUP PICNIC UNIT - CONCRETE PAD. RE: DETAIL 8/1 L2.02. SEE NOTE ON L2.00 FOR TREE CLEARING.
21. GROUP PICNIC UNIT - 4X4 CONCRETE TABLES AND BENCHES WITH EXPOSED AGGREGATE. LESS BY YACON PRECAST TABLES AND BENCHES. ADA ACCESSIBLE. MODEL # RPK-78. CONTACT @ 200-732-6581
22. MILE MARKER SIGN. RE: DETAIL 7/1 L3.01
23. BONDED RUBBER PLAYGROUND SAFETY SURFACING BY RUBBER DESIGNS LLC, POWERED BY RAINBOW TUFF PRODUCTS. PRODUCT AND SAFETY FALD DEPTH TO COMPLY WITH ASTM F1292. CONTACT MIKE GEHL, @ FUN ABOUNDS @ 502-636-8266. RE: DETAIL 2/1 L2.01



ALL EXISTING TO REMAIN AND PROTECT  
FROM CONSTRUCTION OPERATIONS

NOTE:  
CONTRACTOR TO REMOVE ALL CONSTRUCTION  
DEBRIS AND RAKE SMOOTH ALL DISTURBED  
AREAS.

## KEY MAP

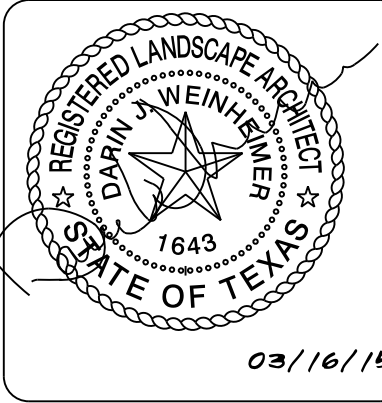
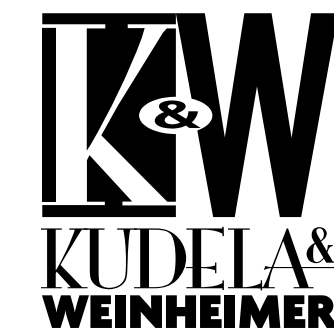
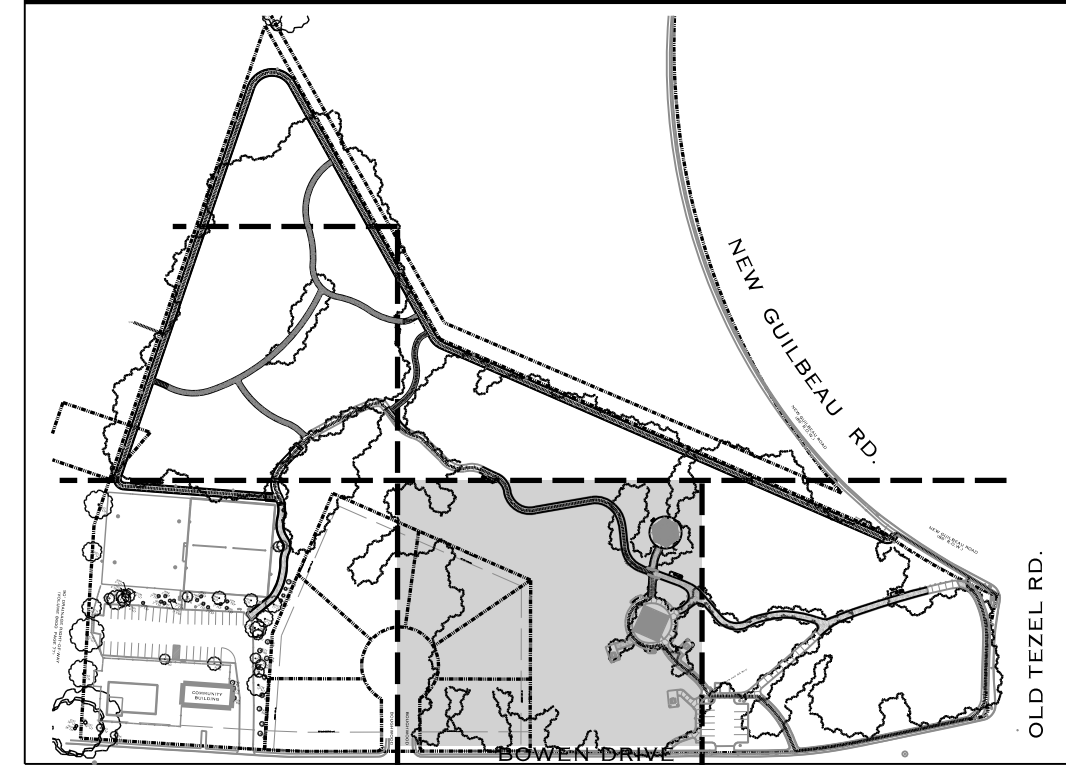

Date:	Revisions/Submissions
06/11/14	30% Construction Documents
10/17/14	50% Construction Documents
01/15/15	100% Construction Documents
03/16/15	100% Construction Documents-Revisions

**CITY OF SAN ANTONIO**  
**TRANSPORTATION AND CAPITAL**  
**IMPROVEMENTS**

VERTICAL PROJECT MANAGEMENT DIVISION  
MUNICIPAL PLAZA BUILDING 114 W. COMMERCE  
SAN ANTONIO, TX 78203-3966  
P.O. BOX 539966 TEL (210) 207-2879 FAX (210) 207-2197

**NEW TERRITORIES PARK**  
9023 BOWEN STREET  
SAN ANTONIO, TEXAS

**MATERIALS PLAN**

L1.02

M

Designed By:	Designer Name
Drawn By:	DT
Date:	03/16/2015
Project No. :	CSA-351
Filename:	L-Materials.dgn

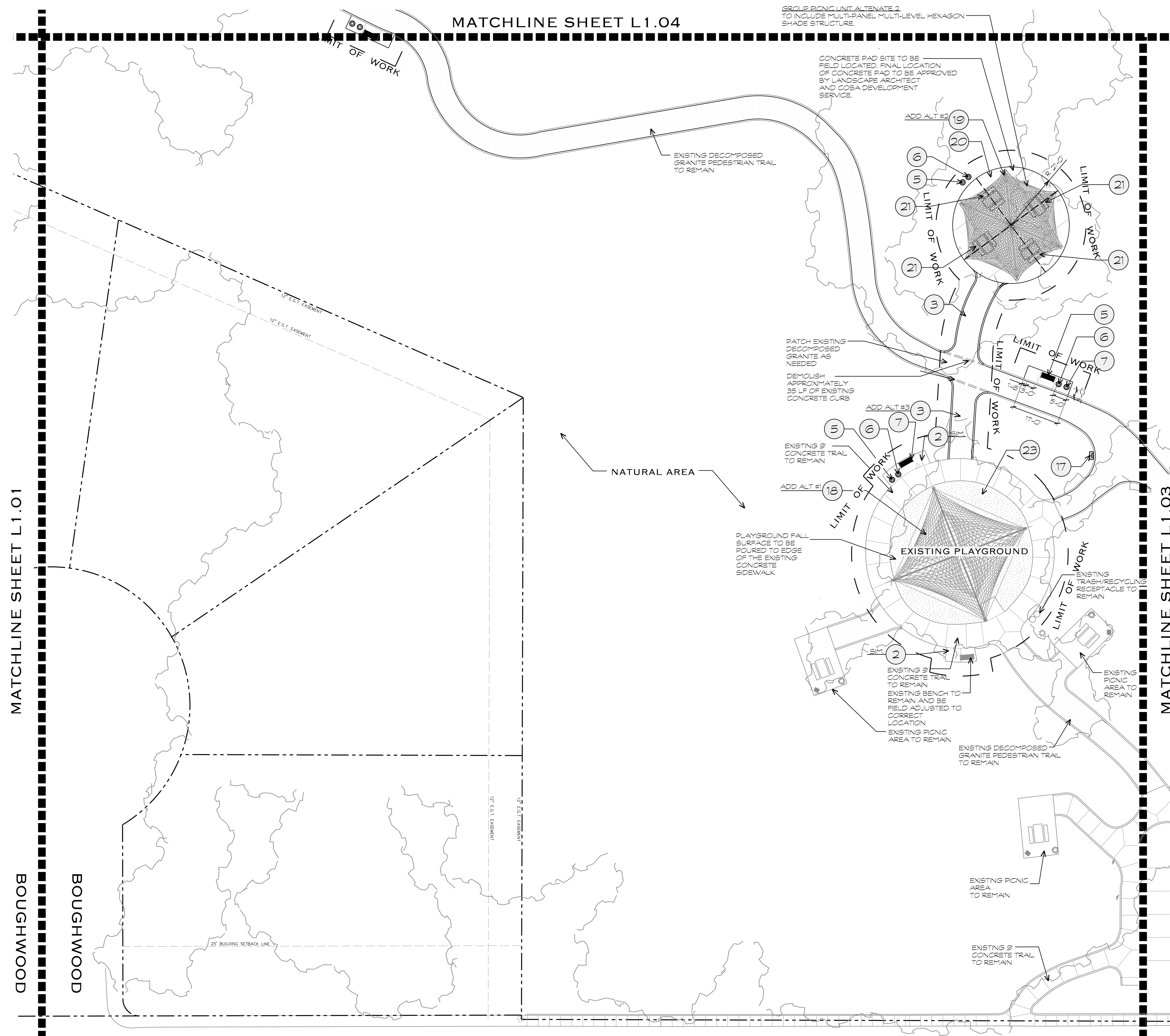

## LEGEND

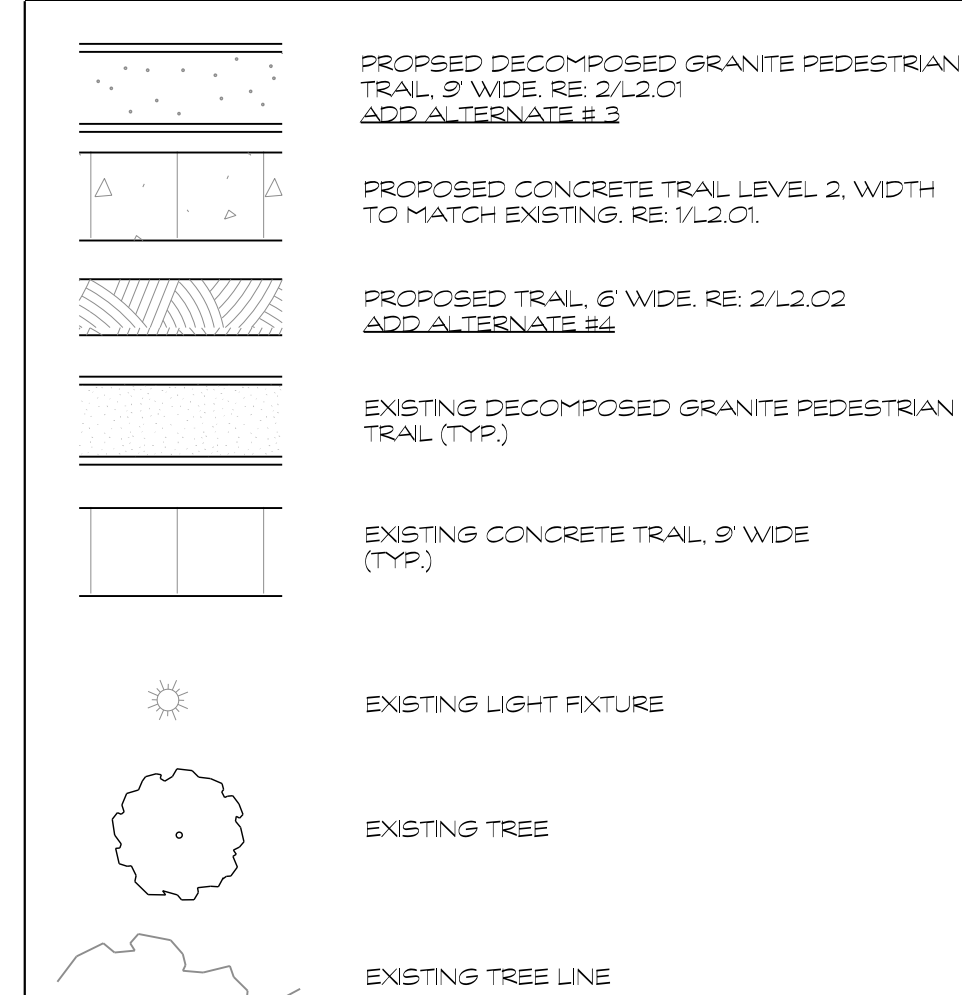

## MATERIALS LEGEND

- |     |  |
|-----|--|
| 1.  | EXISTING 9' CONCRETE TRAIL   |
| 2.  | CONCRETE TRAIL, 4'-2" THICK, 9' WIDE (TYP.) RE DETAIL V.1/2.01. SEE NOTE ON L.O.O.F FOR TREE CLEARING.   |
| 3.  | DECOMPOSED GRANITE PEDESTRIAN TRAIL, 9' WIDE RE DETAIL 2/1/2.01. SEE NOTE ON L.O.O.F FOR TREE CLEARING. ADD ALTERNATE #3   |
| 4.  | OF CURBS   |
| 5.  | TRASH RECEPTACLE TO BE FABRICATED WITH 1/4" STEEL AND PAINTED BLACK. RE 6/1/2.01   |
| 6.  | RECYCLE RECEPTACLE TO BE FABRICATED WITH 1/4" STEEL AND PAINTED BLUE. RE 6/1/2.01  |
| 7.  | BENCH, 32 SERIES BY DUMOR SITE FURNISHINGS, 32 SERIES WITH 5-2 SURFACE PLATE. COLOR TO BE BLUE SET ON CONCRETE PAD AND MOUNTED PER MANUFACTURERS INSTRUCTIONS. CONTACT CATHY CONE/EAUX-WRIGHT @ 813-238-1878. RE DETAIL 2/1/2.02   |
| 8.  | PROPOSED TRAIL, 6' WIDE RE DETAIL 2/1/2.02. SEE NOTE ON L.O.O.F FOR TREE CLEARING. ADD ALTERNATE #4  |
| 9.  | EXISTING POND AREA   |
| 10. | EXISTING DECOMPOSED GRANITE PEDESTRIAN TRAIL   |
| 11. | EXISTING TRASH/RECYCLING RECEPTACLE  |
| 12. | EXISTING BENCH   |
| 13. | EXISTING CHILDRENS PLAY AREA   |
| 14. | EXISTING PARK SIGNAGE  |
| 15. | TURN DOWN EDGE SIDEWALK. RE DETAIL 6/1/2.01. SEE NOTE ON L.O.O.F FOR TREE CLEARING   |
| 16. | PET FOUNTAIN WITH ADA FOUNTAIN BY MOST DEPENDABLE FOUNTAINS, INC. MODEL # 2002691. COLOR TO BE EMERALD GREEN. INSTALL PER MANUFACTURERS SIGNING INSTRUCTIONS. CONTACT @ 1-800-853-6631   |
| 17. | LITTER BAGS AND COMPLETE DOG WASTE STATION BY DOG-ONIT PARKS. ITEM #740698. INSTALL PER MANUFACTURERS RECOMMENDATION. CONTACT @ 877-349-3647   |
| 18. | MARINERS SHADE STRUCTURE AT PLAYGROUND BY USA SHADE AND FABRIC STRUCTURES, 36X36X6. MODEL # YH538369. CONTACT DION BOTHA @ 202-725-0292. SHADE STRUCTURE, MODEL # M14M40. 40' HEXAGON. CONTACT DION BOTHA @ (512)-720-2252. SHADE STRUCTURE ARE TO BE PROVIDED BY CONTRACTOR. CONTRACTOR SHALL BE RESPONSIBLE FOR OBTAINING ALL PERMITS REGARDING THIS STRUCTURE. ADD ALTERNATE #1 |
| 19. | GROUP PICNIC UNIT - MULTI-PANEL MULTI-LEVEL, HEXAGON SHADE STRUCTURE, BY USA SHADE AND FABRIC STRUCTURES, MODEL # M14M40. 40' HEXAGON. CONTACT DION BOTHA @ (512)-720-2252. SHADE STRUCTURE ARE TO BE PROVIDED BY CONTRACTOR. CONTRACTOR SHALL BE RESPONSIBLE FOR OBTAINING ALL PERMITS REGARDING THIS STRUCTURE. ADD ALTERNATE #2   |
| 20. | GROUP PICNIC UNIT - CONCRETE PAD. RE DETAIL 6/1/2.02. SEE NOTE ON L.O.O.F FOR TREE CLEARING  |
| 21. | GROUP PICNIC UNIT - H2O CONCRETE TABLES AND BENCHES WITH EXPOSED AGGREGATE LEGS BY HICON PRECAST TABLES AND BENCHES. ADA COMESSED. MODEL # GR-170. CONTACT @ 210-732-8591  |
| 22. | MILE MARKER SIGN. RE DETAIL 7/1/3.01   |
| 23. | BONDED RUBBER PLAYGROUND SURFACE SURFACING BY RUBBER DESIGNS LLC, POWERED BY AEROM TURF PRODUCTS. PRODUCT AND SAFETY FALL DEPTH TO COMPLY WITH ASTM F1292 CONTACT MIKE GEHL @ FLUN AROUNDS @ 419-314-2233  |

SCALE 1" = 20' - 0"

A horizontal scale bar with alternating black and white segments. It is marked with '10' at the left end, '0' at the first segment boundary, '20' at the second segment boundary, and '40' at the right end.



ALL EXISTING TO REMAIN AND PROTECT FROM CONSTRUCTION OPERATIONS

NOTE: CONTRACTOR TO REMOVE ALL CONSTRUCTION DEBRIS AND RAKE SMOOTH ALL DISTURBED AREAS.

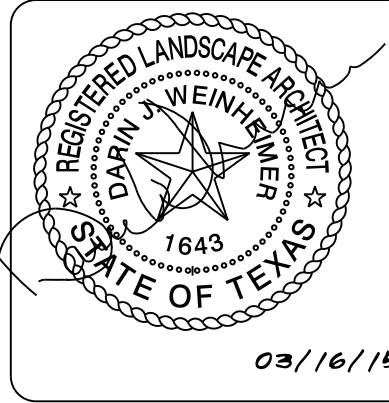
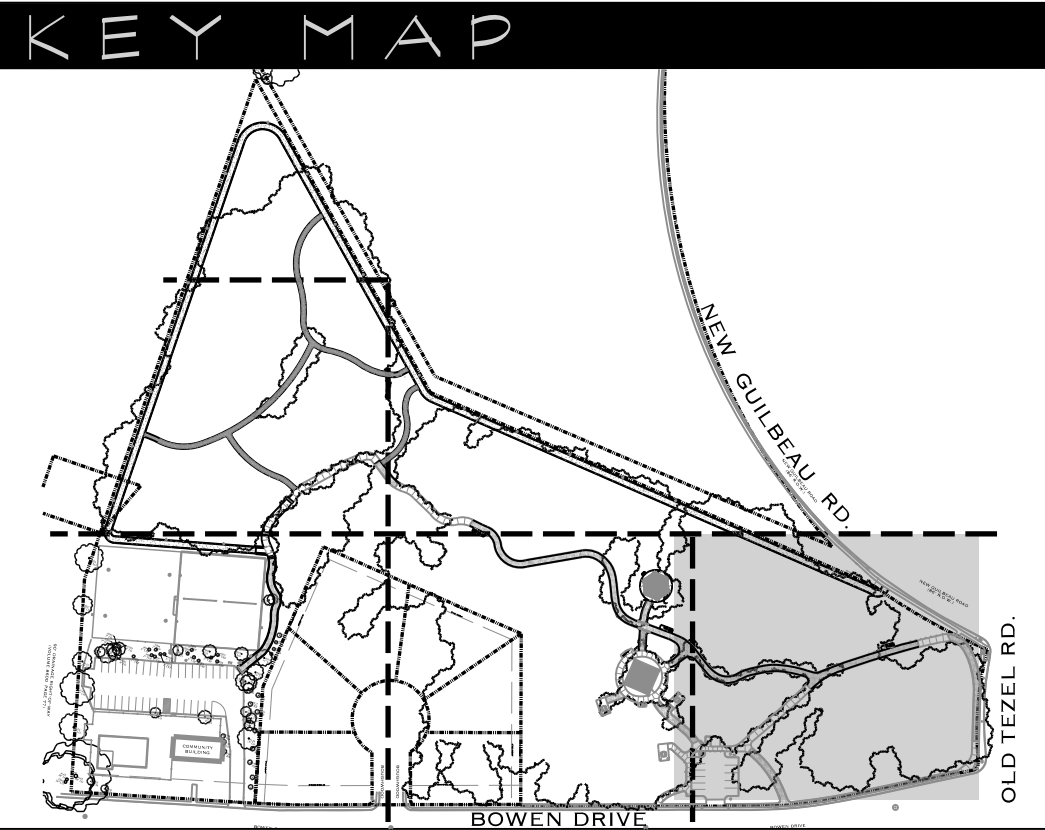

Date:	Revisions/Submissions
06/11/14	30% Construction Documents
10/17/14	50% Construction Documents
01/15/15	100% Construction Documents
03/16/15	100% Construction Documents/Revisions

**CITY OF SAN ANTONIO**  
**TRANSPORTATION AND CAPITAL IMPROVEMENTS**  
**VERTICAL PROJECT MANAGEMENT DIVISION**  
MUNICIPAL PLAZA BUILDING 114 W. COMMERCE  
SAN ANTONIO, TX 78283-3966  
P.O. BOX 839966  
TEL. (210) 207-2879 FAX (210) 207-2197

**NEW TERRITORIES PARK**  
9023 BOWEN STREET  
SAN ANTONIO, TEXAS  
**MATERIALS PLAN**

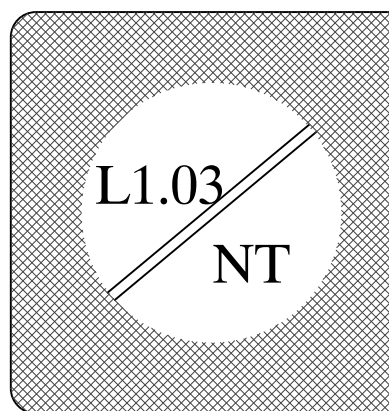

Designed By:  
**Designer Name**  
Drawn By:  
**DT**  
Date:  
**03/16/2015**  
Project No.:  
**CSA-351**  
Filename:  
**L-Materials.dgn**

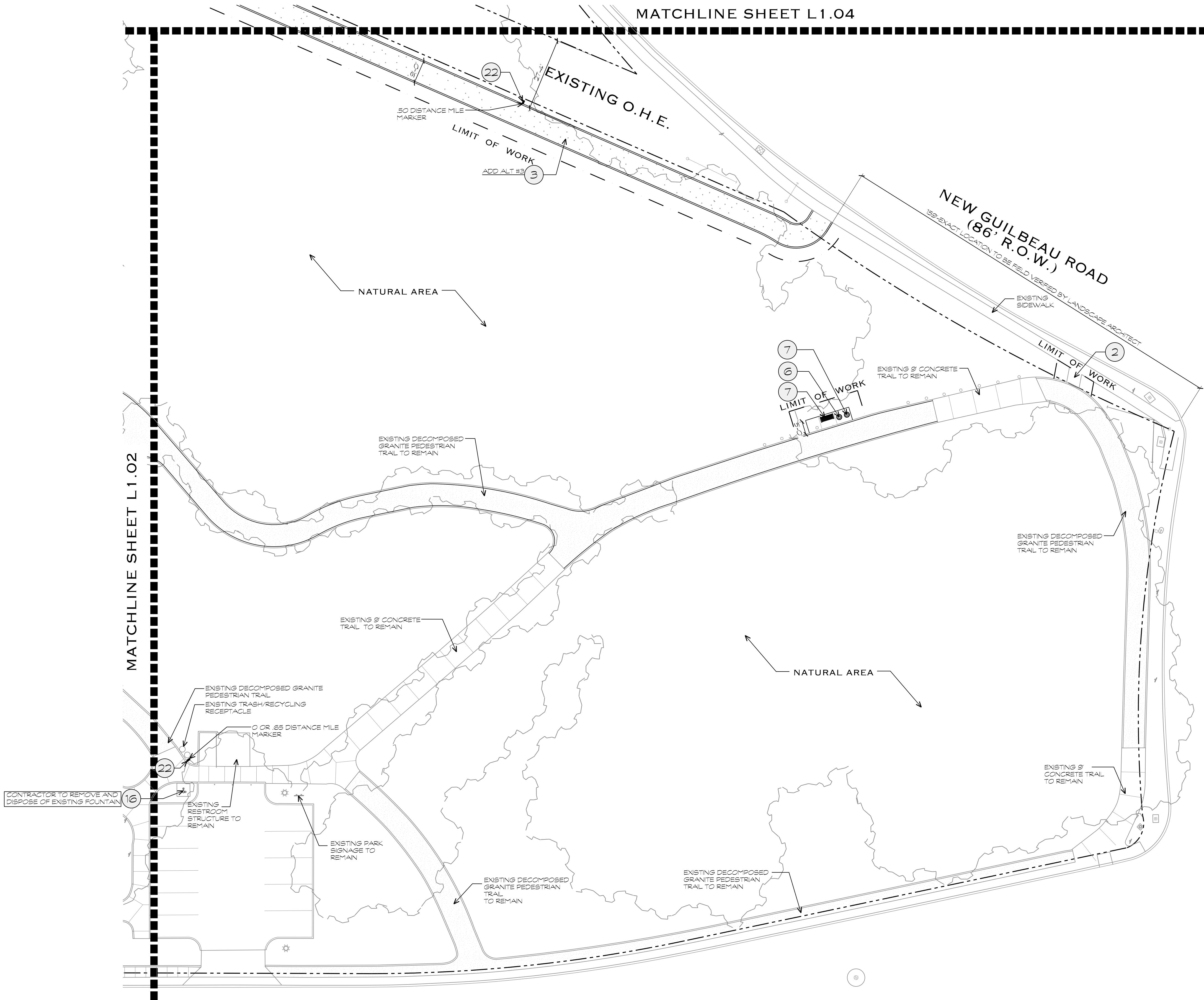

LEGEND	
	PROPOSED DECOMPOSED GRANITE PEDESTRIAN TRAIL, 8' WIDE, RE: 2/L2.01 ADD ALTERNATE #3
	PROPOSED CONCRETE TRAIL LEVEL 2, WIDTH TO MATCH EXISTING, RE: 1/L2.01
	PROPOSED TRAIL, 6' WIDE, RE: 2/L2.02 ADD ALTERNATE #4
	EXISTING DECOMPOSED GRANITE PEDESTRIAN TRAIL (TYP.)
	EXISTING CONCRETE TRAIL, 8' WIDE (TYP.)
	EXISTING LIGHT FIXTURE
	EXISTING TREE
	EXISTING TREE LINE

MATERIALS LEGEND	
1.	EXISTING CONCRETE TRAIL
2.	CONCRETE TRAIL, 4-1/2" THICK, 8' WIDE (TYP.) RE: DETAIL 1/L2.01, SEE NOTE ON L.O.O.O FOR TREE CLEARING
3.	DECOMPOSED GRANITE PEDESTRIAN TRAIL, 8' WIDE RE: DETAIL 2/L2.01, SEE NOTE ON L.O.O.O FOR TREE CLEARING, ADD ALTERNATE #3
4.	NOT USED
5.	TRASH RECEPTACLE TO BE FABRICATED WITH 1/4" STEEL AND PAINTED BLACK, RE: 6/L2.01
6.	RECYCLE RECEPTACLE TO BE FABRICATED WITH 1/4" STEEL AND PAINTED BLUE, RE: 6/L2.01
7.	6' BENCH, 82 SERIES BY DUMOR SITE FURNISHINGS, 82 SERIES WITH 5-2 SURFACE PLATE, COLOR TO BE BLUE SET ON CONCRETE PAD AND MOUNTED PER MANUFACTURER'S INSTRUCTIONS, CONTACT CATHY COMEAUX-WRIGHT @ 800-430-6226 X 1316, RE: DETAIL 2/L2.02
8.	PROPOSED TRAIL, 6' WIDE, RE: DETAIL 2/L2.02, SEE NOTE ON L.O.O.O FOR TREE CLEARING, ADD ALTERNATE #4
9.	EXISTING PICNIC AREA
10.	EXISTING DECOMPOSED GRANITE PEDESTRIAN TRAIL
11.	EXISTING TRASH/RECYCLING RECEPTACLE
12.	EXISTING BENCH
13.	EXISTING CHILDREN'S PLAY AREA
14.	EXISTING PARK SIGNAGE
15.	TURN DOWN EDGE SIDEWALK, RE: DETAIL 8/L2.01, SEE NOTE ON L.O.O.O FOR TREE CLEARING
16.	PET FOUNTAIN WITH ADA FOUNTAIN BY MOST DEPENDABLE FOUNTAINS, INC. MODEL # 20089M, COLOR TO BE EMERALD GREEN, INSTALL PER MANUFACTURER'S RECOMMENDATION, CONTACT @ 1-800-552-8331
17.	LITTER BAGS AND COMPLETE DOG WASTE STATION BY DOG-ON-IT PARKS, ITEM #74085, INSTALL PER MANUFACTURER'S RECOMMENDATION, CONTACT @ 877-348-3647
18.	MARINERS SHADE STRUCTURE AT PLAYGROUND BY USA SHADE AND FABRIC STRUCTURES, 36X36, MODEL # M833636, CONTACT DION BOTHA @ (512) 270-2252, SHADE STRUCTURES ARE TO BE PERMITTED SEPARATELY, CONTRACTOR SHALL BE RESPONSIBLE FOR OBTAINING ALL PERMITS REGARDING THIS STRUCTURE, ADD ALTERNATE #1
19.	GROUP PICNIC UNIT - MULTI-PANEL, MULTI-LEVEL, HEXAGON SHADE STRUCTURE, BY USA SHADE AND FABRIC STRUCTURES, MODEL # MLMPH40, 40' HEXAGON, CONTACT DION BOTHA @ (512) 270-2252, SHADE STRUCTURES ARE TO BE PERMITTED SEPARATELY, CONTRACTOR SHALL BE RESPONSIBLE FOR OBTAINING ALL PERMITS REGARDING THIS STRUCTURE, ADD ALTERNATE #2
20.	GROUP PICNIC UNIT - CONCRETE PAD, RE: DETAIL 6/L2.02, SEE NOTE ON L.O.O.O FOR TREE CLEARING
21.	GROUP PICNIC UNIT - #10 CONCRETE TABLES AND BENCHES WITH EXPOSED AGGREGATE LEGS BY MACON PRECAST TABLES AND BENCHES, ADA ACCESSIBLE, MODEL # GP-12, CONTACT @ 210-732-8591
22.	MILE MARKER SIGN, SEE DETAIL 7/L3.01
23.	BONDED RUBBER PLAYGROUND SAFETY SURFACING BY RUBBER DESIGNS LLC, POWERED BY RAINBOW TURF PRODUCTS, PRODUCT AND SAFETY FALL DEPTH TO COMPLY WITH ASTM F1292, CONTACT MIKE GEHL @ FUN ABOUNDS @ 512-535-8260, RE: DETAIL 2/L2.01



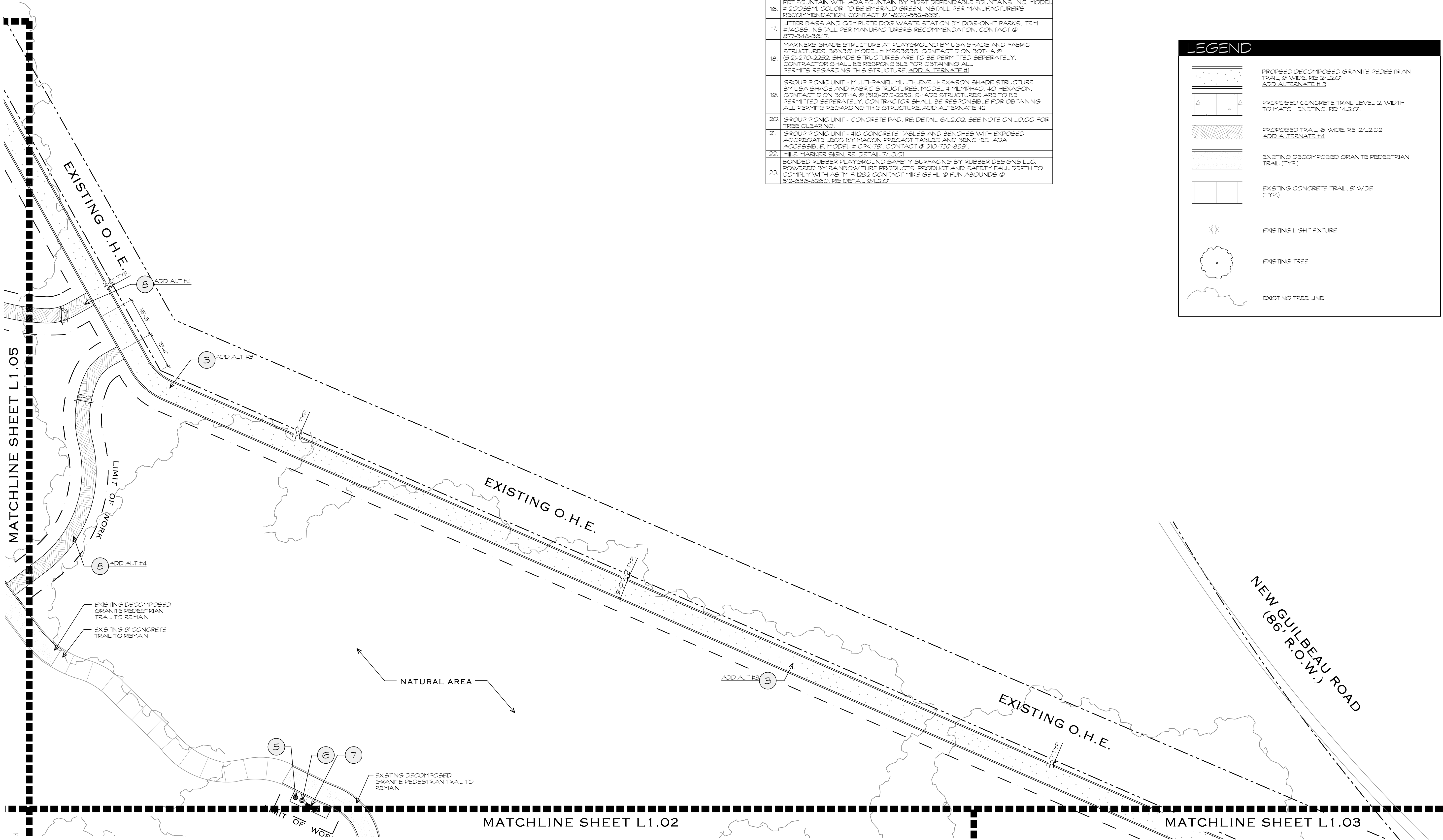

MATERIALS LEGEND

1. EXISTING 9' CONCRETE TRAIL
2. CONCRETE TRAIL, 4 1/2" THICK, 9' WIDE (TYP.) RE: DETAIL 1/ L2.01. SEE NOTE ON L0.00 FOR TREE CLEARING.
3. DECOMPOSED GRANITE PEDESTRIAN TRAIL, 9' WIDE, RE: DETAIL 2/ L2.01. SEE NOTE ON L0.00 FOR TREE CLEARING. ADD ALTERNATE #3
4. NOT USED
5. TRASH RECEPTACLE TO BE FABRICATED WITH 1/4" STEEL AND PAINTED BLACK. RE: 6/ L2.01
6. RECYCLE RECEPTACLE TO BE FABRICATED WITH 1/4" STEEL AND PAINTED BLUE. RE: 6/ L2.01
7. 8' BENCH, 92 SERIES BY DUMOR SITE FURNISHINGS, 92 SERIES WITH S-2 SURFACE PLATE. COLOR TO BE BLUE. SET ON CONCRETE PAD AND MOUNTED PER MANUFACTURERS INSTRUCTIONS. CONTACT CATHY COMEAUX-WRIGHT @ 800-492-6228 X 1316. RE: DETAIL 9/ L2.02
8. PROPOSED TRAIL, 6' WIDE, RE: DETAIL 2/ L2.02. SEE NOTE ON L0.00 FOR TREE CLEARING. ADD ALTERNATE #4
9. EXISTING PICNIC AREA
10. EXISTING DECOMPOSED GRANITE PEDESTRIAN TRAIL
11. EXISTING TRASH/RECYCLING RECEPTACLE
12. EXISTING BENCH
13. EXISTING CHILDREN'S PLAY AREA
14. EXISTING PARK SIGNAGE
15. TURN DOWN EDGE SIDEWALK. RE: DETAIL 8/ L2.01. SEE NOTE ON L0.00 FOR TREE CLEARING.
16. PET FOUNTAIN WITH ADA FOUNTAIN BY MOST DEPENDABLE FOUNTAINS, INC. MODEL # 2008SM. COLOR TO BE EMERALD GREEN. INSTALL PER MANUFACTURERS RECOMMENDATION. CONTACT @ 14900-852-6331
17. LITTER BAGS AND COMPLETE DOG WASTE STATION BY DOGS-ON-IT PARKS, ITEM #74086. INSTALL PER MANUFACTURERS RECOMMENDATION. CONTACT @ 877-348-2647.
18. MARINERS SHADE STRUCTURE AT PLAYGROUND BY USA SHADE AND FABRIC STRUCTURES, 36'X36', MODEL # 11893636. CONTACT DION BOTHA @ (512)-210-2252. SHADE STRUCTURES ARE TO BE PERMITTED SEPARATELY. CONTRACTOR SHALL BE RESPONSIBLE FOR OBTAINING ALL PERMITS REGARDING THIS STRUCTURE. ADD ALTERNATE #1
19. GROUP PICNIC UNIT - MULTI-PANEL MULTI-LEVEL HEXAGON SHADE STRUCTURE. BY USA SHADE AND FABRIC STRUCTURES, MODEL # MLYPH40, 40' HEXAGON. CONTACT DION BOTHA @ (512)-210-2252. SHADE STRUCTURES ARE TO BE PERMITTED SEPARATELY. CONTRACTOR SHALL BE RESPONSIBLE FOR OBTAINING ALL PERMITS REGARDING THIS STRUCTURE. ADD ALTERNATE #2
20. GROUP PICNIC UNIT - CONCRETE PAD. RE: DETAIL 6/ L2.02. SEE NOTE ON L0.00 FOR TREE CLEARING.
21. GROUP PICNIC UNIT - 4'X10' CONCRETE TABLES AND BENCHES WITH EXPOSED AGGREGATE LEGS BY MACON PRECAST TABLES AND BENCHES, ADA ACCESSIBLE. MODEL # CPK-79'. CONTACT @ 210-732-8559.
22. MILE MARKER SIGN. RE: DETAIL 7/ L3.01
23. BONDED RUBBER PLAYGROUND SAFETY SURFACING BY RUBBER DESIGNS LLC, POWERED BY RAINBOW TURF PRODUCTS, PRODUCT AND SAFETY FALL DEPTH TO COMPLY WITH ASTM F-1992. CONTACT MIKE GSHL @ FUN ASOUNDS @ 512-636-8260. RE: DETAIL 9/ L2.01

KEY MAP

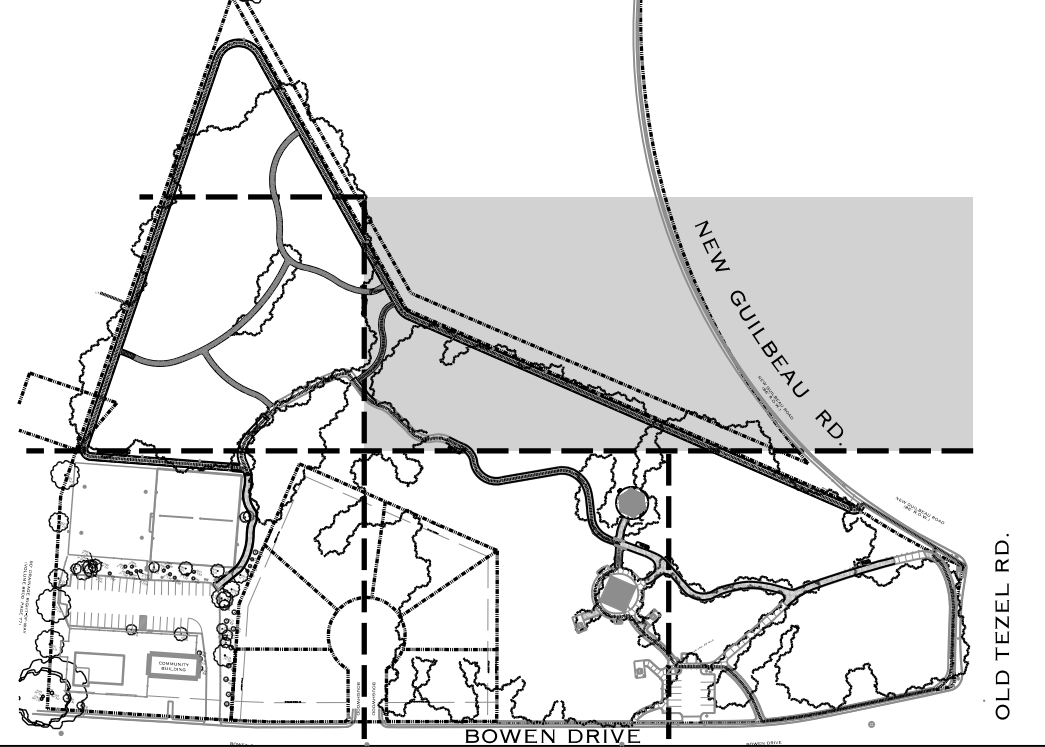

ALL EXISTING TO REMAIN AND PROTECT FROM CONSTRUCTION OPERATIONS

NOTE: CONTRACTOR TO REMOVE ALL CONSTRUCTION DEBRIS AND RAKE SMOOTH ALL DISTURBED AREAS.

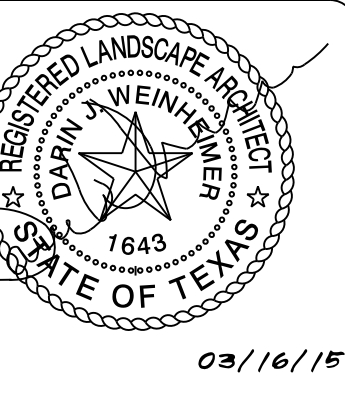

Date:	Revisions/Submissions
06/11/14	30% Construction Documents
10/17/14	50% Construction Documents
01/15/15	100% Construction Documents
03/16/15	100% Construction Documents/Revisions

**CITY OF SAN ANTONIO**  
**TRANSPORTATION AND CAPITAL IMPROVEMENTS**  
**VERTICAL PROJECT MANAGEMENT DIVISION**  
MUNICIPAL PLAZA BUILDING 114 W. COMMERCE  
SAN ANTONIO, TX 78203-3966  
TEL. (210) 207-2879 FAX (210) 207-2197

**NEW TERRITORIES PARK**  
9023 BOWEN STREET  
SAN ANTONIO, TEXAS  
**MATERIALS PLAN**

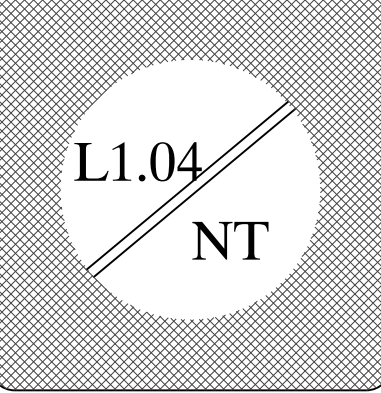

Designed By:  
Designer Name  
Drawn By:  
DT  
Date:  
03/16/2015  
Project No.:  
CSA-351  
Filename:  
L-Materials.dgn

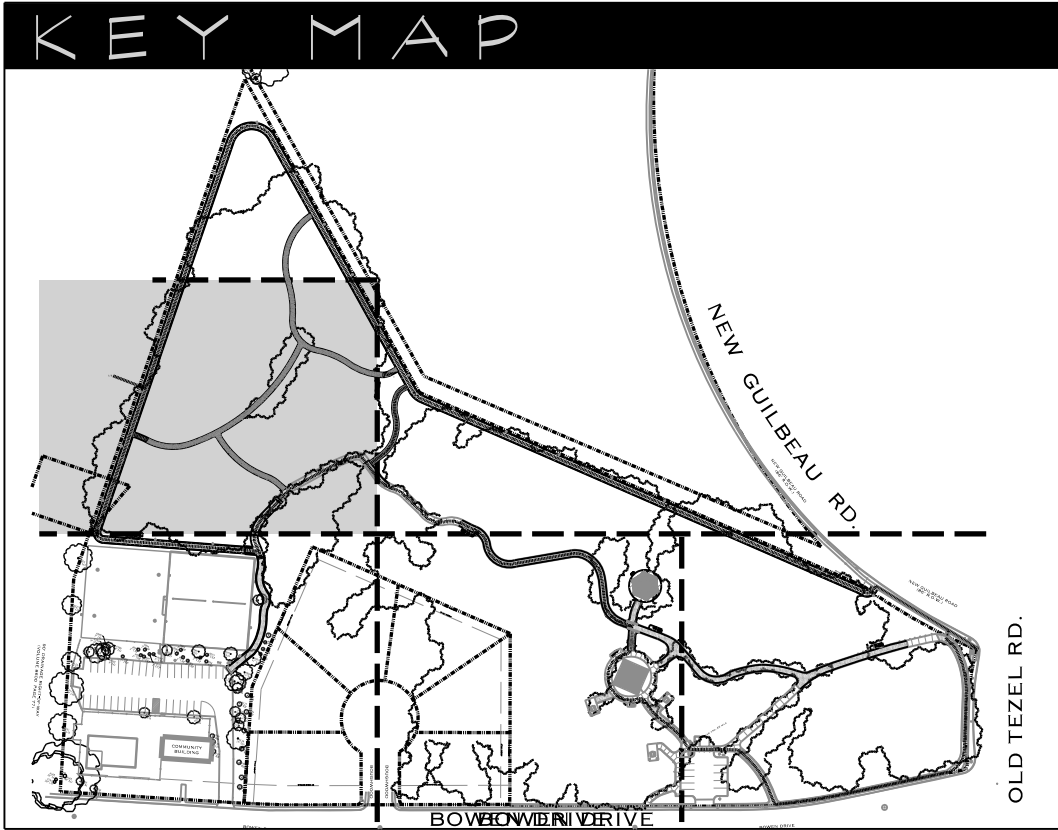

ALL EXISTING TO REMAIN AND PROTECT FROM CONSTRUCTION OPERATIONS

NOTE:  
CONTRACTOR TO REMOVE ALL CONSTRUCTION DEBRIS AND RAKE SMOOTH ALL DISTURBED AREAS.

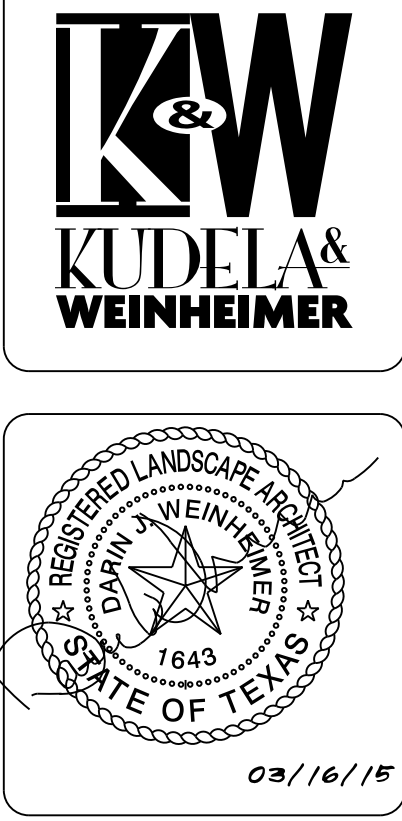

Date:	Revisions/Submissions
06/11/14	30% Construction Documents
10/17/14	50% Construction Documents
01/15/15	100% Construction Documents
03/16/15	100% Construction Documents/Revisions

**CITY OF SAN ANTONIO**  
**TRANSPORTATION AND CAPITAL IMPROVEMENTS**  
**VERTICAL PROJECT MANAGEMENT DIVISION**  
MUNICIPAL PLAZA BUILDING 114 W. COMMERCE  
SAN ANTONIO, TX 78203-3966  
P.O. BOX 839966  
TEL. (210) 207-2879 FAX (210) 207-2197

**NEW TERRITORIES PARK**  
9023 BOWEN STREET  
SAN ANTONIO, TEXAS  
**MATERIALS PLAN**

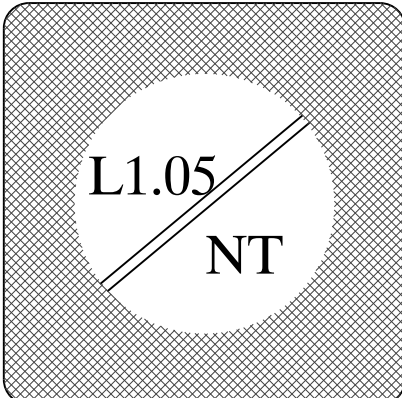

Designed By:  
**Designer Name**  
Drawn By:  
**DT**  
Date:  
**03/16/2015**  
Project No.:  
**CSA-351**  
Filename:  
**L-Materials.dgn**

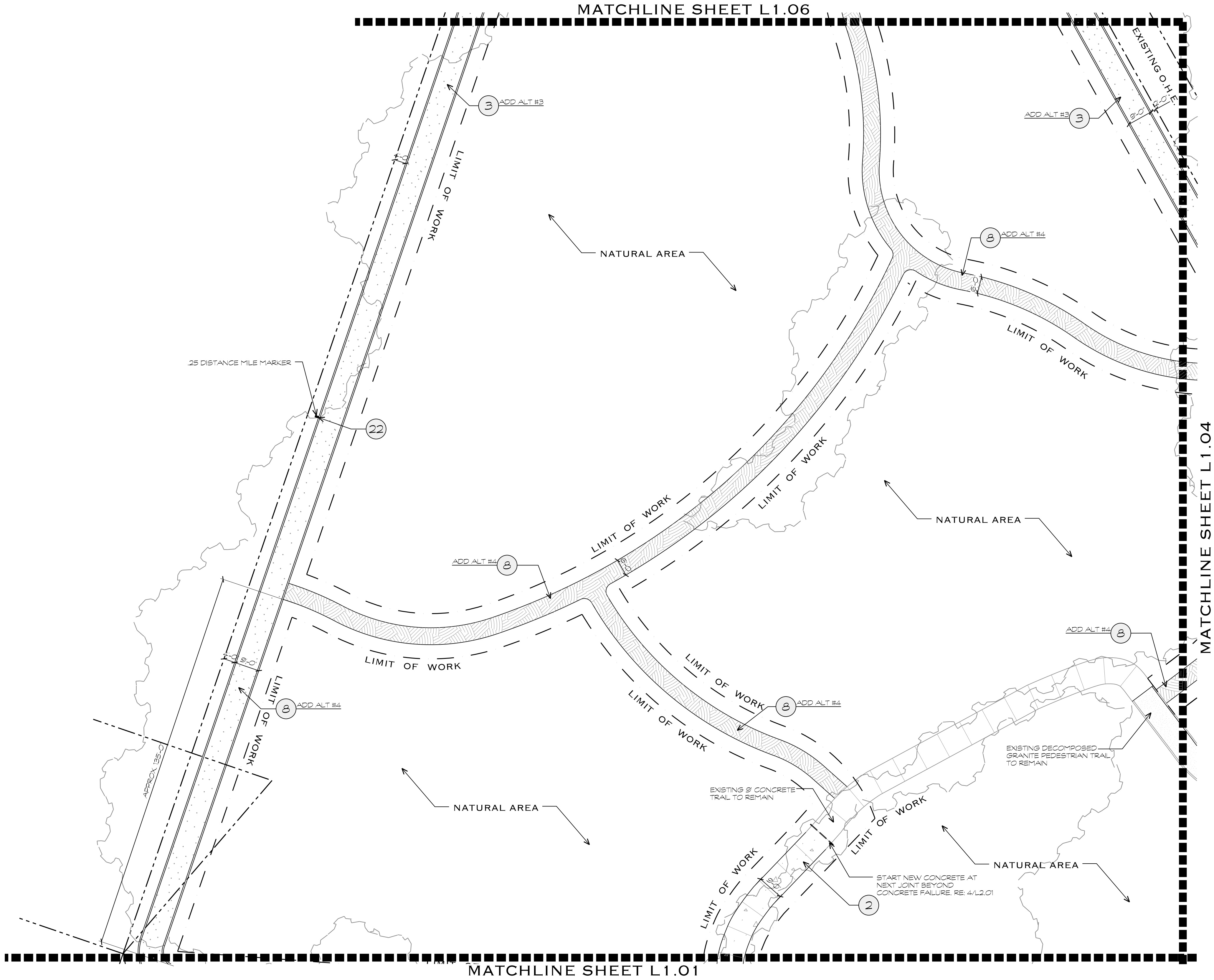

LEGEND

	PROPOSED DECOMPOSED GRANITE PEDESTRIAN TRAIL, 9' WIDE, RE: 2/L2.01 ADD ALTERNATE #3
	PROPOSED CONCRETE TRAIL LEVEL 2, WIDTH TO MATCH EXISTING, RE: 1/L2.01
	PROPOSED TRAIL, 6' WIDE, RE: 2/L2.02 ADD ALTERNATE #4
	EXISTING DECOMPOSED GRANITE PEDESTRIAN TRAIL (TYP.)
	EXISTING CONCRETE TRAIL, 9' WIDE (TYP.)
	EXISTING LIGHT FIXTURE
	EXISTING TREE
	EXISTING TREE LINE

MATERIALS LEGEND

1.	EXISTING 9' CONCRETE TRAIL
2.	CONCRETE TRAIL, 4-1/2" THICK, 9' WIDE (TYP.) RE: DETAIL 1/L2.01. SEE NOTE ON L0.00 FOR TREE CLEARING
3.	DECOMPOSED GRANITE PEDESTRIAN TRAIL, 9' WIDE, RE: DETAIL 2/L2.01. SEE NOTE ON L0.00 FOR TREE CLEARING. ADD ALTERNATE #3
4.	NOT USED
5.	TRASH RECEPTACLE TO BE FABRICATED WITH 1/4" STEEL AND PAINTED BLACK, RE: 6/L2.01
6.	RECYCLE RECEPTACLE TO BE FABRICATED WITH 1/4" STEEL AND PAINTED BLUE, RE: 6/L2.01
7.	6' BENCH, 82' SERIES BY DUMOR SITE FURNISHINGS, 82' SERIES WITH S-2 SURFACE PLATE, COLOR TO BE BLUE. SET ON CONCRETE PAD AND MOUNTED PER MANUFACTURER'S INSTRUCTIONS. CONTACT CATHY COMEAUX-WRIGHT @ 800-430-6226 X1216. RE: DETAIL 9/L2.02
8.	PROPOSED TRAIL, 6' WIDE, RE: DETAIL 2/L2.02. SEE NOTE ON L0.00 FOR TREE CLEARING. ADD ALTERNATE #4
9.	EXISTING PICNIC AREA
10.	EXISTING DECOMPOSED GRANITE PEDESTRIAN TRAIL
11.	EXISTING TRASH/RECYCLING RECEPTACLE
12.	EXISTING BENCH
13.	EXISTING CHILDREN'S PLAY AREA
14.	EXISTING PARK SIGNAGE
15.	TURN DOWN EDGE SIDEWALK, RE: DETAIL 8/L2.01. SEE NOTE ON L0.00 FOR TREE CLEARING
16.	PET FOUNTAIN WITH ADA FOUNTAIN BY MOST DEPENDABLE FOUNTAINS, INC. MODEL # 20089M. COLOR TO BE EMERALD GREEN. INSTALL PER MANUFACTURER'S RECOMMENDATION. CONTACT @ 1-800-552-8331
17.	LITTER BAGS AND COMPLETE DOG WASTE STATION BY DOG-ON-IT PARKS, ITEM #14085. INSTALL PER MANUFACTURER'S RECOMMENDATION. CONTACT @ 877-348-3647
18.	MARINERS SHADE STRUCTURE AT PLAYGROUND BY USA SHADE AND FABRIC STRUCTURES, 36X36, MODEL # M883636, CONTACT DION BOTHA @ (912) 270-2282. SHADE STRUCTURES ARE TO BE PERMITTED SEPARATELY. CONTRACTOR SHALL BE RESPONSIBLE FOR OBTAINING ALL PERMITS REGARDING THIS STRUCTURE. ADD ALTERNATE #1
19.	GROUP PICNIC UNIT - MULTIPANEL, MULTILEVEL, HEXAGON SHADE STRUCTURE, BY USA SHADE AND FABRIC STRUCTURES, MODEL # MUMPH40, 40' HEXAGON, CONTACT DION BOTHA @ (912) 270-2282. SHADE STRUCTURES ARE TO BE PERMITTED SEPARATELY. CONTRACTOR SHALL BE RESPONSIBLE FOR OBTAINING ALL PERMITS REGARDING THIS STRUCTURE. ADD ALTERNATE #2
20.	GROUP PICNIC UNIT - CONCRETE PAD, RE: DETAIL 6/L2.02. SEE NOTE ON L0.00 FOR TREE CLEARING
21.	GROUP PICNIC UNIT - #10 CONCRETE TABLES AND BENCHES WITH EXPOSED AGGREGATE LEGS BY MACON PRECAST TABLES AND BENCHES, ADA ACCESSIBLE, MODEL # GP-79, CONTACT @ 210-732-8591
22.	MILE MARKER SIGN, RE: DETAIL 7/L3.01
23.	BONDED RUBBER PLAYGROUND SAFETY SURFACING BY RUBBER DESIGNS LLC, POWERED BY RAINBOW TURF PRODUCTS. PRODUCT AND SAFETY FALL DEPTH TO COMPLY WITH ASTM F1292. CONTACT MIKE GEHL @ FUN ABOUNDS @ 512-636-6260, RE: DETAIL 9/L2.01



GENERAL NOTES

- 1) Planting soil mixture shall be composed the following:  
40% Topsoil  
30% Double Shredded Bark Mulch  
30% Sand
- 2) Bidding contractors be advised that all new tree material is to be container-grown corresponding to stated root ball sizes as recognized by industry standards. This shall exclude all B&B, machine moved, or trans-planted trees from the bidding process unless otherwise indicated on the plan. The installation contractor shall be prepared to provide photographs of intended plant material along with signed clarification that plant material meets these requirements and that no variations or substitutions have been made.
- 3) The Landscape Contractor doing the installation of this work shall submit to Kudela & Weinheimer information regarding sourcing of plant material. All plant material must be container grown and approved at the source of growth by Kudela & Weinheimer. Tree material meeting the specifications will be tagged with a serialized locking tag at the nursery by Kudela & Weinheimer. Plants arriving at the job site without these tags will be categorically rejected at contractor's expense.
- 4) If the planting plan does not agree with the plant list the quantities indicated graphically on the planting plan shall govern.
- 5) Contractor is responsible for the grading of parking lot islands and setbacks. Grade changes shall range from 8" to 15" above the curb depending on the size of the island. Select topsoil shall be used for these berms. See Parking Island Tree Detail.
- 6) All unsurfaced areas are to receive four inches of topsoil, seed, mulch or sod, and watered until a healthy stand of grass is established.

MATERIALS LEGEND

1. EXISTING 9" CONCRETE TRAIL
2. CONCRETE TRAIL, 4-1/2" THICK, 9" WIDE (TYP.) RE: DETAIL V/L2.01. SEE NOTE ON L0.00 FOR TREE CLEARING
3. DECOMPOSED GRANITE PEDESTRIAN TRAIL, 9" WIDE, RE: DETAIL 2/L2.01. SEE NOTE ON L0.00 FOR TREE CLEARING. ADD ALTERNATE #3
4. NOT USED
5. TRASH RECEPTACLE TO BE FABRICATED WITH 1/4" STEEL AND PAINTED BLACK. RE: 6/L2.01
6. RECYCLE RECEPTACLE TO BE FABRICATED WITH 1/4" STEEL AND PAINTED BLUE. RE: 6/L2.01
7. BENCH, 92 SERIES BY DUMOR SITE FURNISHINGS, 92 SERIES WITH 9-2 SURFACE PLATE. COLOR TO BE BLUE. SET ON CONCRETE PAD AND MOUNTED PER MANUFACTURERS INSTRUCTIONS. CONTACT CATHY COMEAUX-WRIGHT @ 800-527-6408 X 138. RE: DETAIL 9/L2.02
8. PROPOSED TRAIL, 6" WIDE, RE: DETAIL 2/L2.02. SEE NOTE ON L0.00 FOR TREE CLEARING. ADD ALTERNATE #4
9. EXISTING PICNIC AREA
10. EXISTING DECOMPOSED GRANITE PEDESTRIAN TRAIL
11. EXISTING TRASH/RECYCLING RECEPTACLE
12. EXISTING BENCH
13. EXISTING CHILDRENS PLAY AREA
14. EXISTING PARK SIGNAGE
15. TURN DOWN EDGE SIDEWALK. RE: DETAIL 8/L2.01. SEE NOTE ON L0.00 FOR TREE CLEARING
16. PET FOUNTAIN WITH ADA FOUNTAIN BY MOST DEPENDABLE FOUNTAINS, INC. MODEL # 20085M. COLOR TO BE SHERALD GREEN. INSTALL PER MANUFACTURERS RECOMMENDATION. CONTACT @ 1800-892-6391
17. LITTER BAGS AND COMPLETE DOG WASTE STATION BY DOGS-ON-IT PARKS, ITEM #74086. INSTALL PER MANUFACTURERS RECOMMENDATION. CONTACT @ 877-348-3647
18. MARINERS SHADE STRUCTURE AT PLAYGROUND BY USA SHADE AND FABRIC STRUCTURES, 38138, MODEL # H563636. CONTACT DION BOTHA @ (512)-270-2252. SHADE STRUCTURES ARE TO BE PERMITTED SEPERATELY. CONTRACTOR SHALL BE RESPONSIBLE FOR OBTAINING ALL PERMITS REGARDING THIS STRUCTURE. ADD ALTERNATE #1
19. GROUP PICNIC UNIT - MULTI-PANEL MULTI-LEVEL HEXAGON SHADE STRUCTURE. BY USA SHADE AND FABRIC STRUCTURES, MODEL # MLYPH40, 40" HEXAGON. CONTACT DION BOTHA @ (512)-270-2252. SHADE STRUCTURES ARE TO BE PERMITTED SEPERATELY. CONTRACTOR SHALL BE RESPONSIBLE FOR OBTAINING ALL PERMITS REGARDING THIS STRUCTURE. ADD ALTERNATE #2
20. GROUP PICNIC UNIT - CONCRETE PAD. RE: DETAIL 6/L2.02. SEE NOTE ON L0.00 FOR TREE CLEARING
21. GROUP PICNIC UNIT - #10 CONCRETE TABLES AND BENCHES WITH EXPOSED AGGREGATE LEGS BY MACON PRECAST TABLES AND BENCHES, ADA ACCESSIBLE. MODEL # CPK-79. CONTACT @ 210-732-8591
22. MILE MARKER SIGN. RE: DETAIL 7/L3.01
23. BONDED RUBBER PLAYGROUND SAFETY SURFACING BY RUBBER DESIGNS LLC, POWERED BY RAINBOW TURF PRODUCTS. PRODUCT AND SAFETY FALL DEPTH TO COMPLY WITH ASTM F-1292 CONTACT MIKE GEHL @ FUN ABOUNDS @ 812-836-8260. RE: DETAIL 9/L2.01

KEY MAP

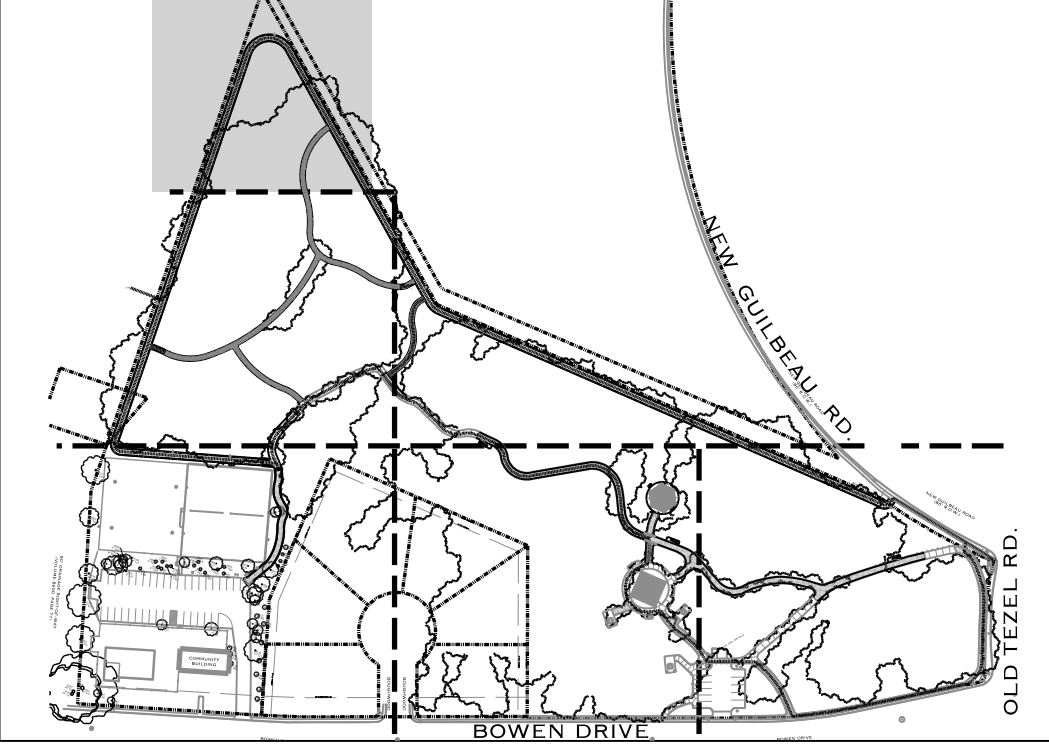

LEGEND

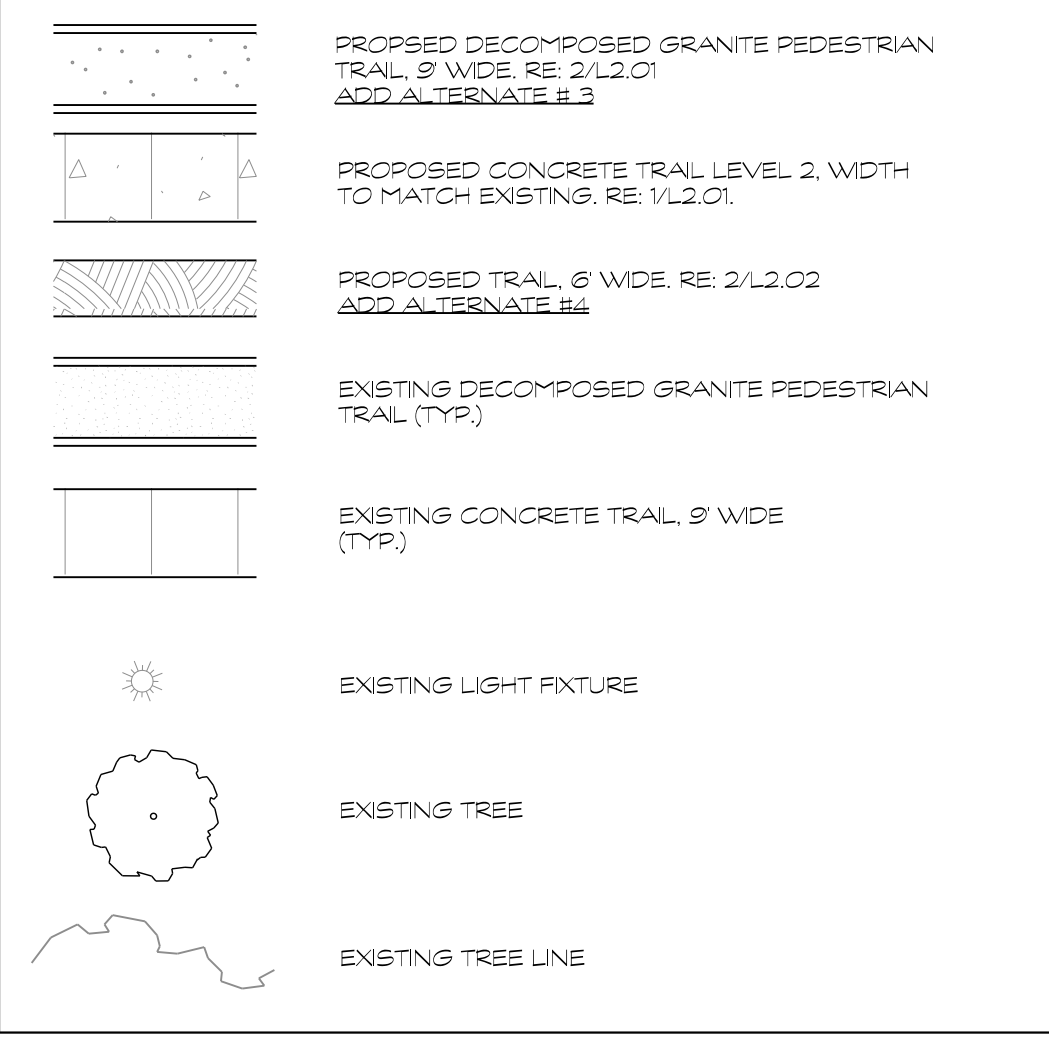

ALL EXISTING TO REMAIN AND PROTECT FROM CONSTRUCTION OPERATIONS

NOTE: CONTRACTOR TO REMOVE ALL CONSTRUCTION DEBRIS AND RAKE SMOOTH ALL DISTURBED AREAS.

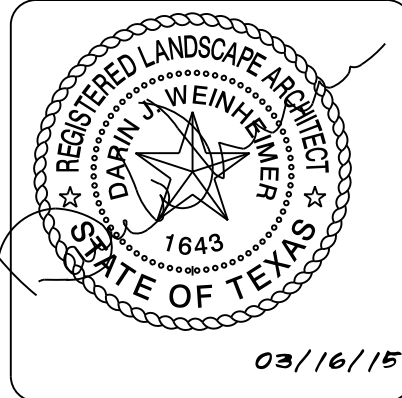
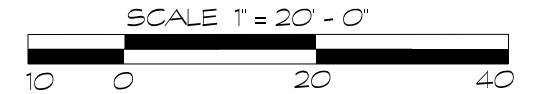
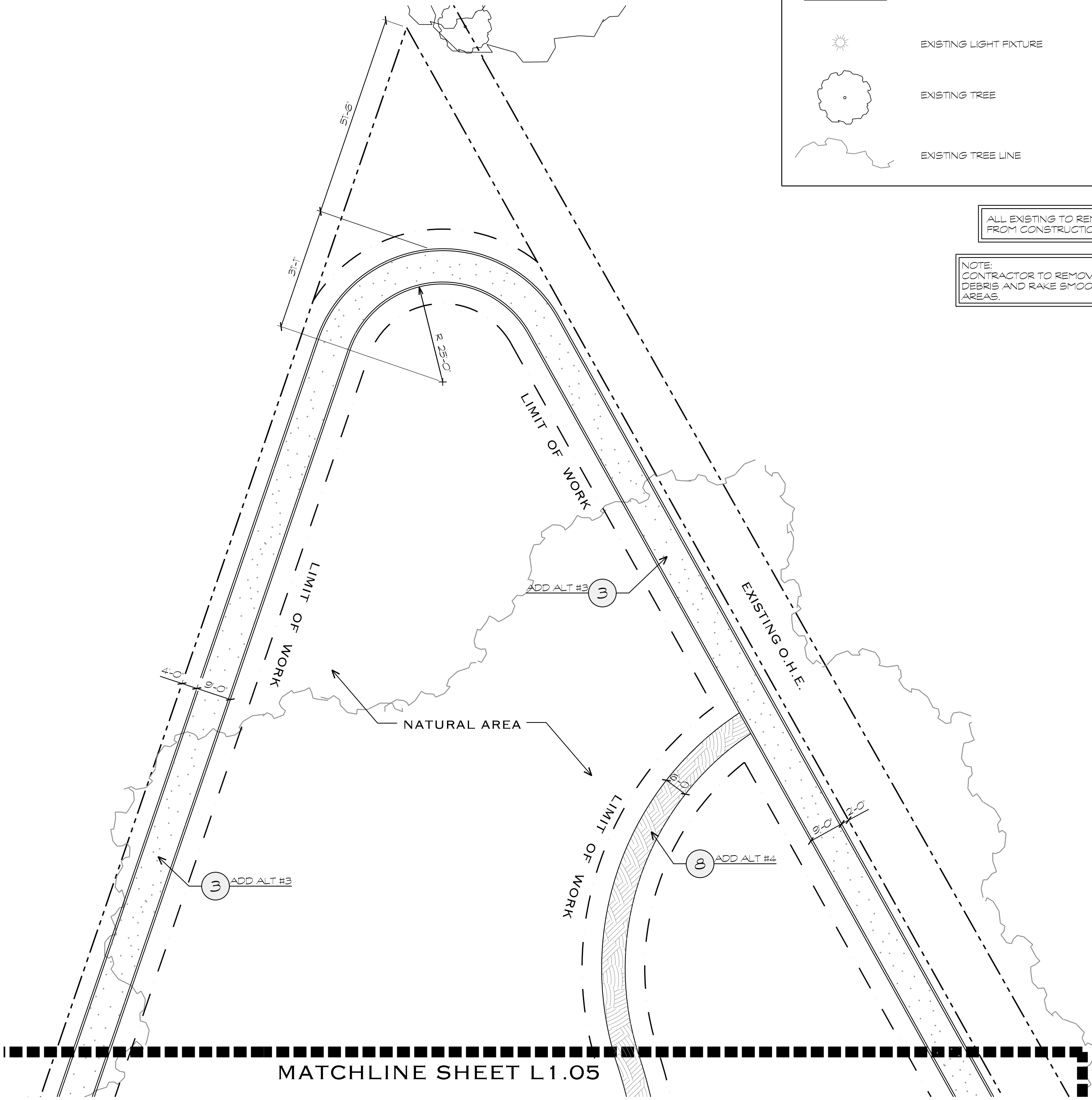

Date:	Revisions/Submissions
06/11/14	30% Construction Documents
10/17/14	50% Construction Documents
01/15/15	100% Construction Documents
03/16/15	100% Construction Documents/Revisions

**CITY OF SAN ANTONIO**  
**TRANSPORTATION AND CAPITAL IMPROVEMENTS**  
**VERTICAL PROJECT MANAGEMENT DIVISION**  
MUNICIPAL PLAZA BUILDING 114 W. COMMERCE  
SAN ANTONIO, TX 78283-3966  
TEL. (210) 207-2879 FAX (210) 207-2197

**NEW TERRITORIES PARK**  
9023 BOWEN STREET  
SAN ANTONIO, TEXAS  
**MATERIALS PLAN**

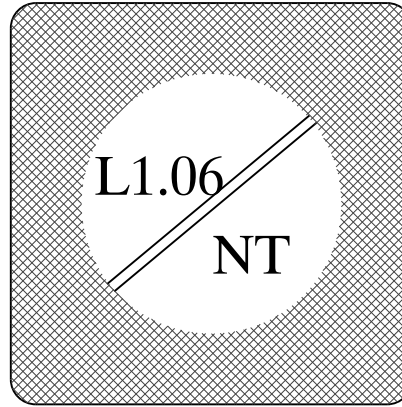

Designed By:	Designer Name
Drawn By:	DT
Date:	03/16/2015
Project No.:	CSA-351
Filename:	L-Materials.dgn



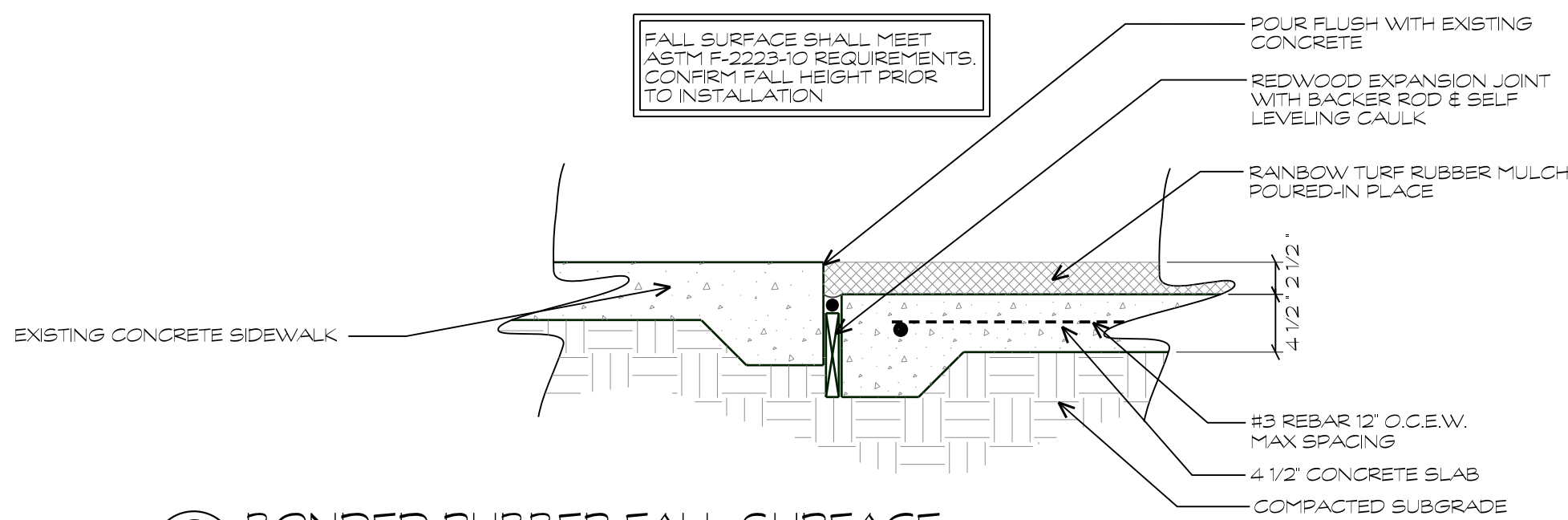

9 BONDED RUBBER FALL SURFACE  
L2.01 1"=1'-0"

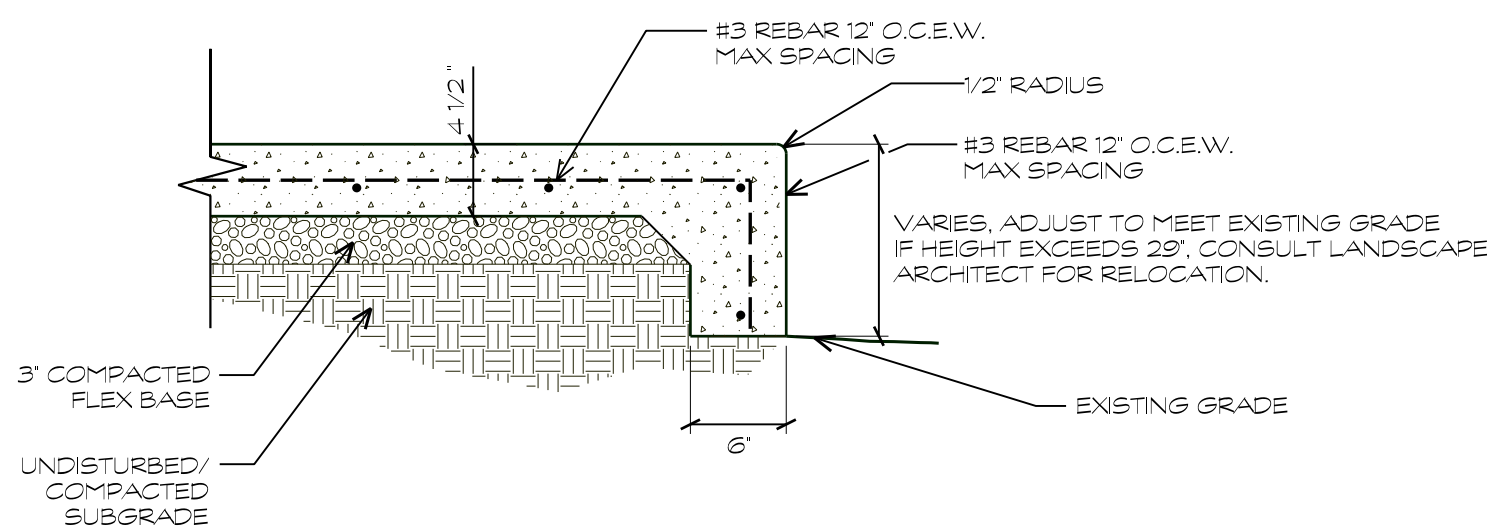

8 CONCRETE SIDEWALK WITH TURNED DOWN EDGE  
L2.01 1"=1'-0"

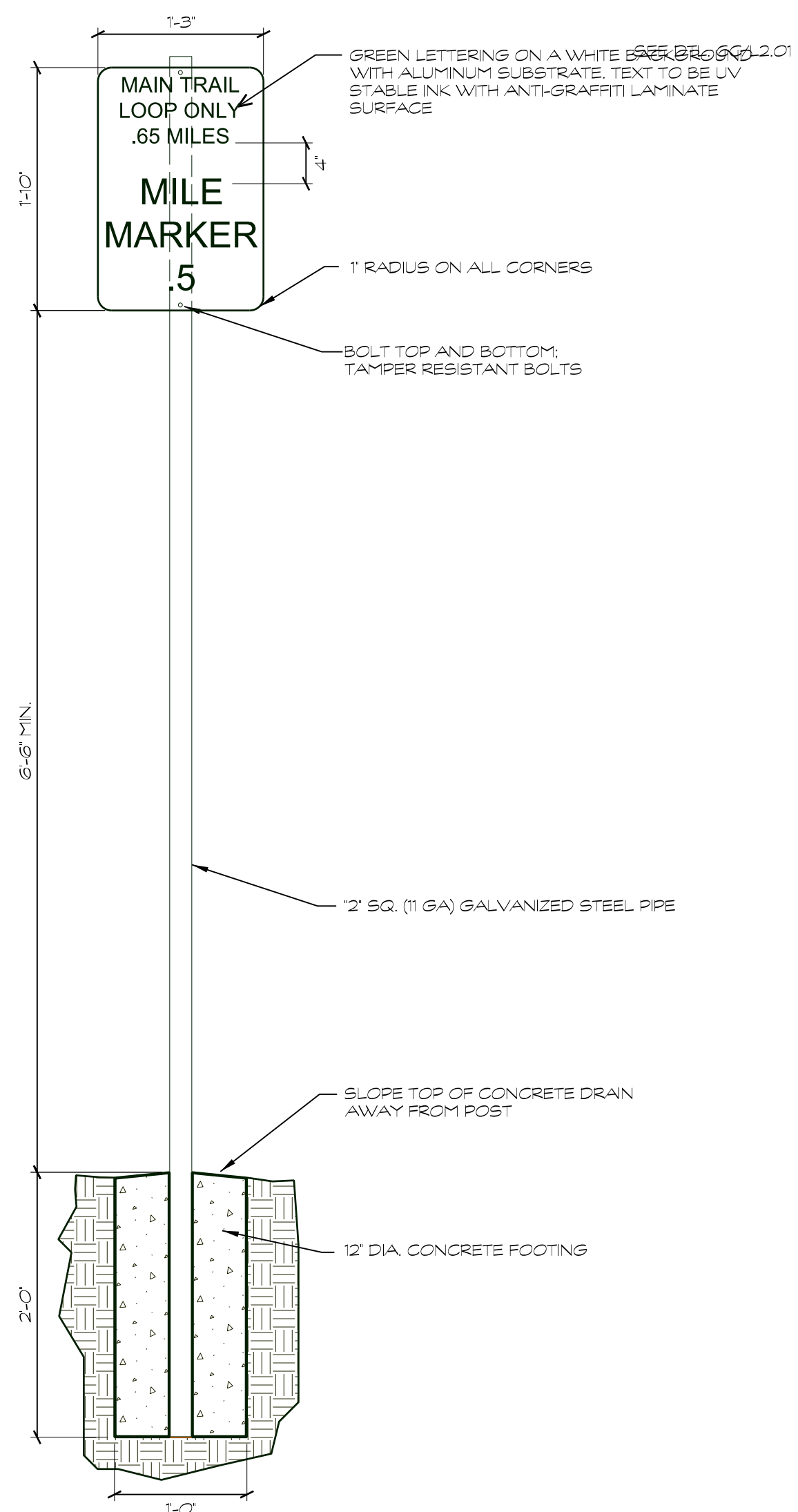

7 MILE MARKER SIGN  
L2.01 NOT TO SCALE

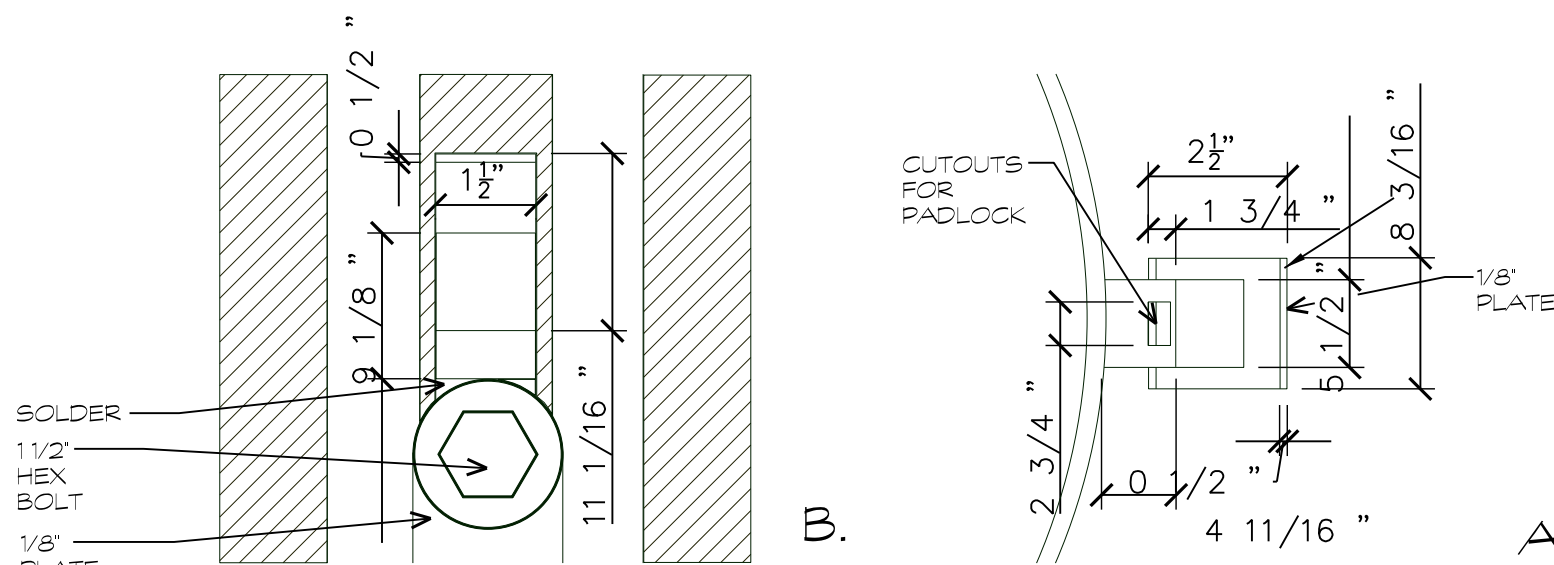
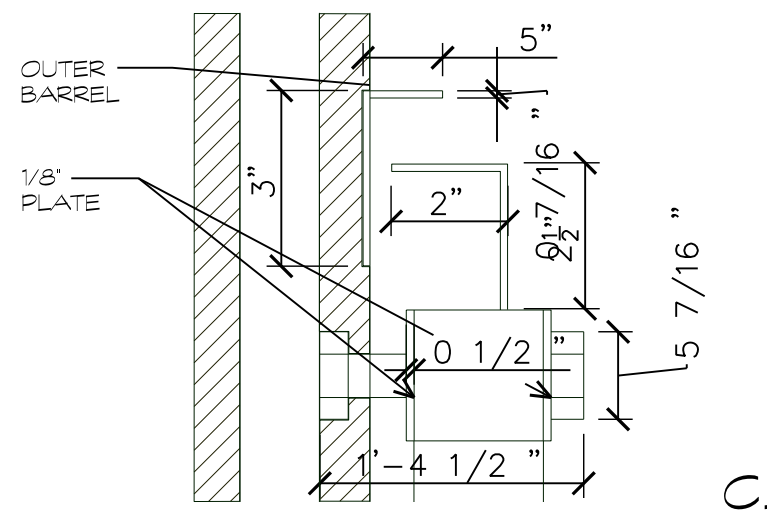

B.

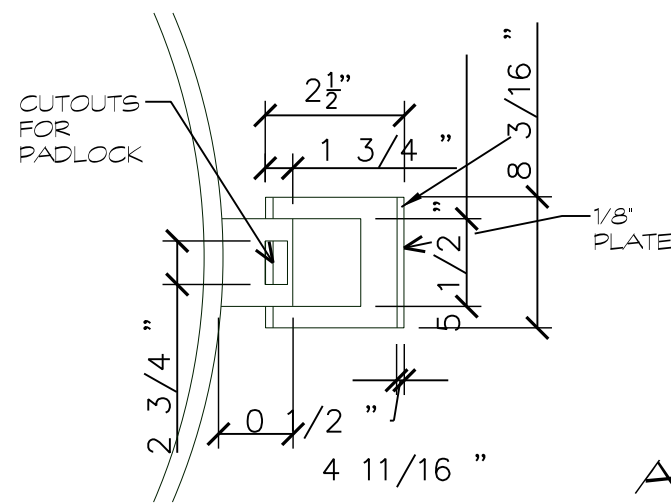

A.

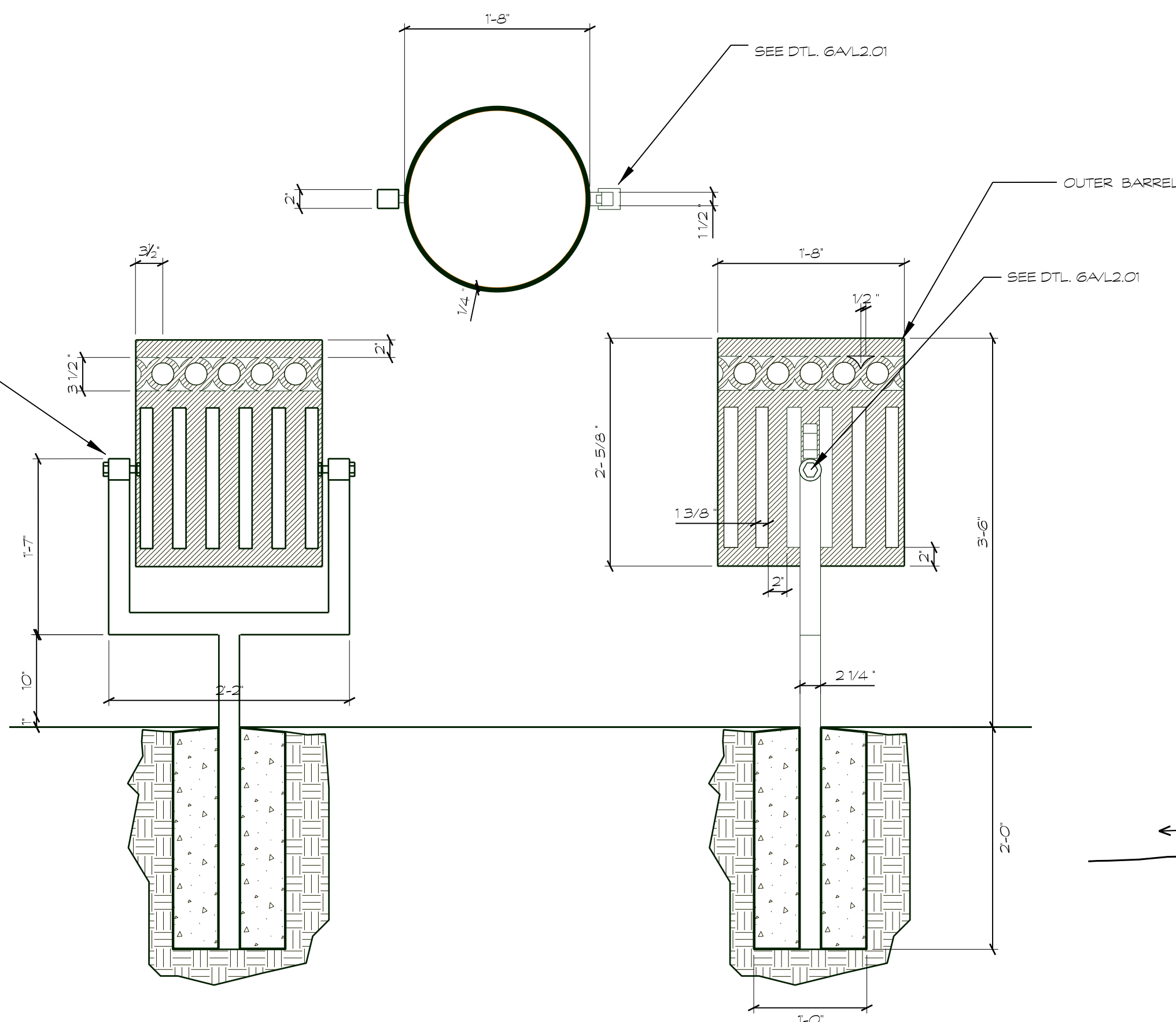

6 TRASH/RECYCLE RECEPTACLE  
L2.01 1"=1'-0"

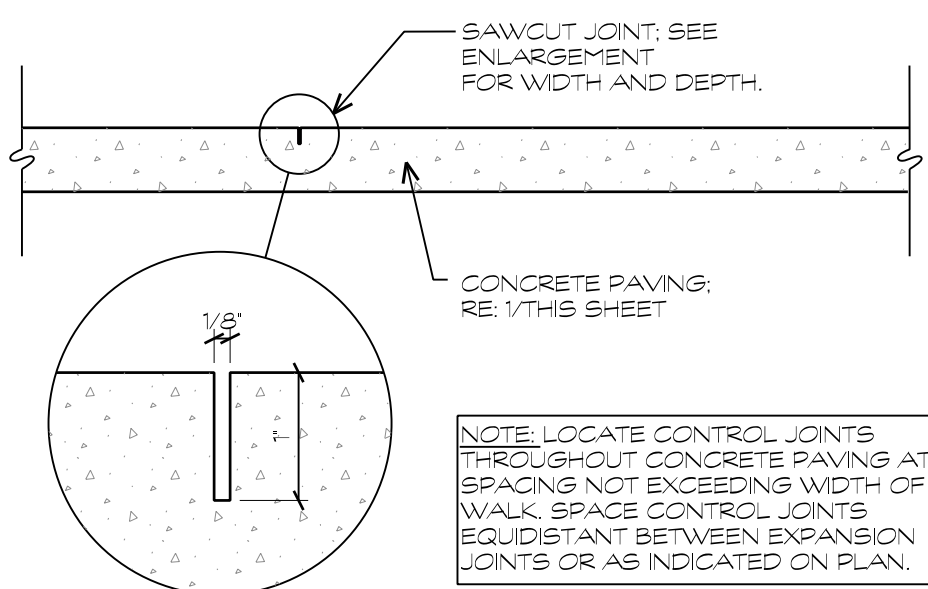

5 TYPICAL CONCRETE CONTROL JOINT  
L2.01 NOT TO SCALE

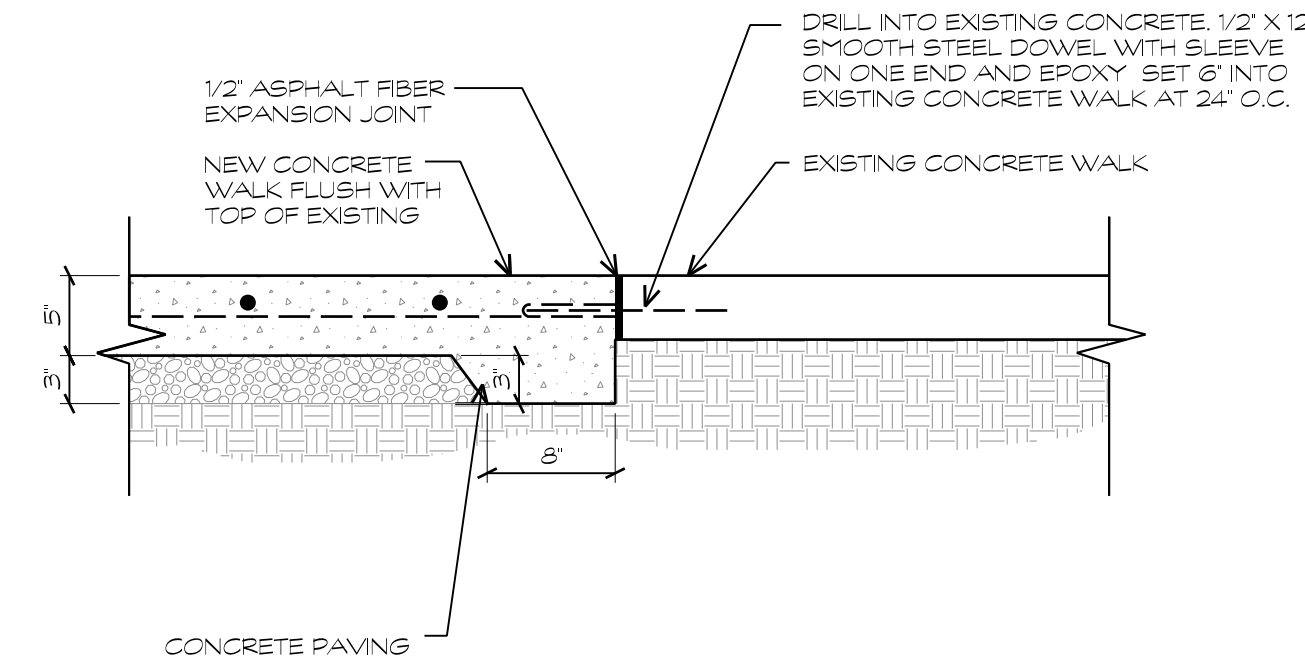

4 NEW SIDEWALK TIED TO EXISTING SIDEWALK  
L2.01 1"=1'-0"

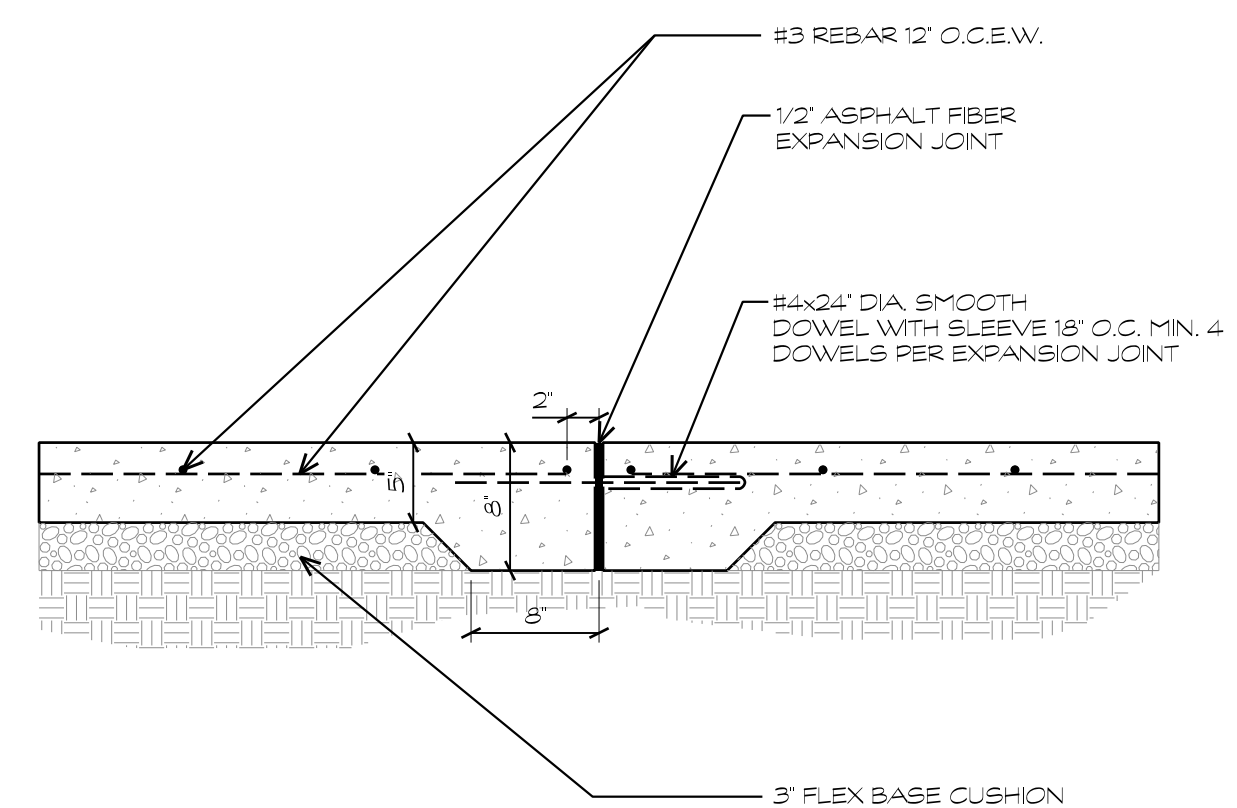

3 TYPICAL CONCRETE EXPANSION JOINT  
L2.01 1"=1'-0"

- DECOMPOSED GRANITE TRAIL NOTES:
1. ALL CURVES INDICATED ON THE PLANS TO BE CONSTRUCTED WITH TRUE RADIUS AND TANGENTS AS DRAWN AND LABELED.
  2. ALL CURBS TO HAVE MEDIUM BROOM FINISH ON EXPOSED SURFACES.
  3. PROVIDE 1/2" EXPANSION JOINTS @ 50' O.C. AND AT ALL POINTS WHERE NEW TRAIL AND CONCRETE WALKS INTERSECT.
  4. ALL CURBS TO BE FORMED TO FULL 12" DEPTH ON BOTH SIDES.
  5. CROSS SLOPES SHALL BE LESS THAN 2%; RUNNING SLOPE SHALL BE LESS THAN 5%. MARK LOCATION OF UTILITIES PASSING BELOW TRAIL.
  6. OF UTILITIES PASSING BELOW TRAIL.

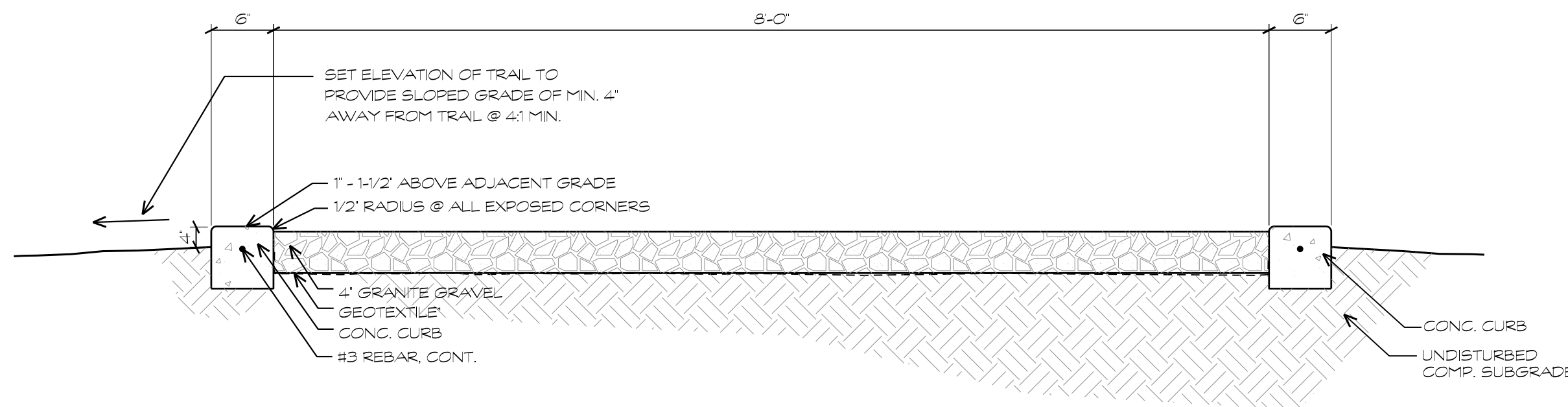

2 DECOMPOSED GRANITE TRAIL (PEDESTRIAN ONLY)  
L2.01 1"=1'-0"

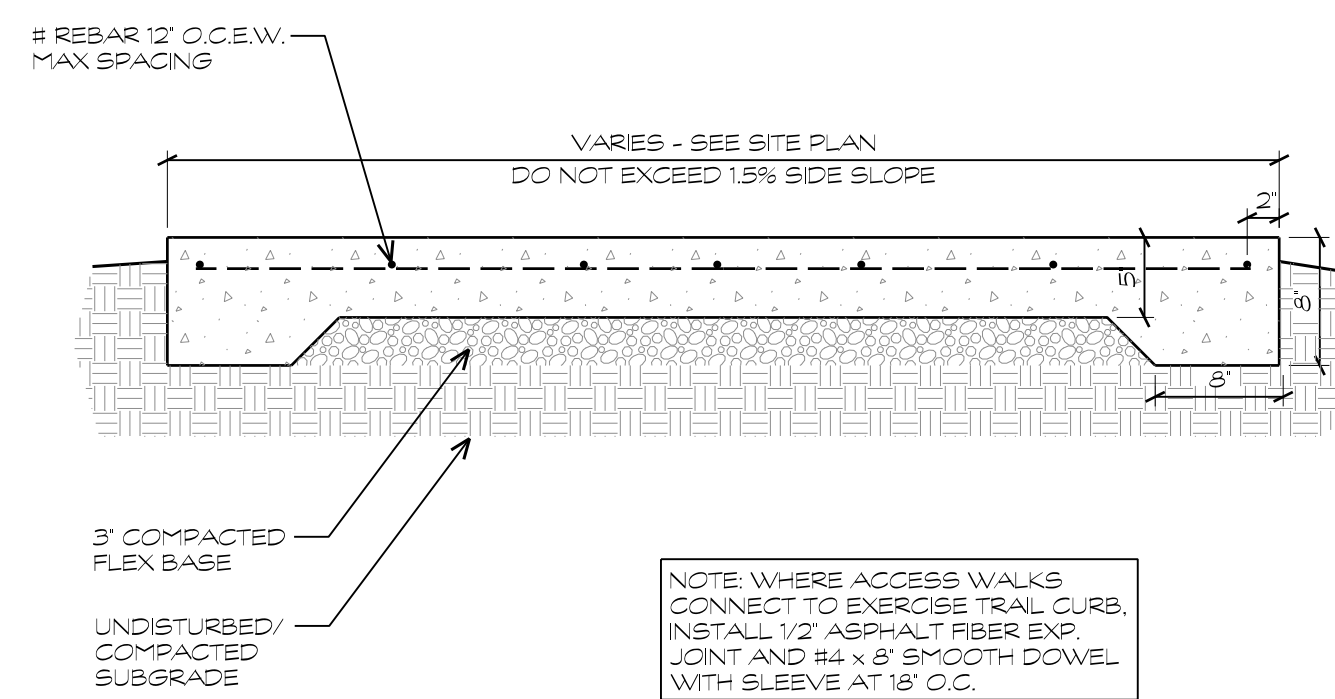

1 TYPICAL CONCRETE SIDEWALK  
L2.01 1"=1'-0"

Date:	Revisions/Submissions
06/11/14	30% Construction Documents
10/11/14	50% Construction Documents
01/15/15	100% Construction Documents
03/16/15	100% Construction Documents Revisions



