

**Board of Adjustment  
Notification Plan for  
Case No A-15-120**

San Antonio City Limits  
Subject Property  
200' Notification Boundary  
Council District: 7

NOT TO SCALE,  
FOR ILLUSTRATIVE PURPOSES ONLY

Development Services Department  
City of San Antonio



**Board of Adjustment  
Notification Plan for  
Case No A-15-120**

San Antonio City Limits  
Subject Property  
200' Notification Boundary  
Council District 7

"NOT TO SCALE,  
FOR ILLUSTRATIVE PURPOSES ONLY"

Development Services Department  
City of San Antonio

Attachment 2  
Plot Plan



**Board of Adjustment**  
Plot Plan for  
**Case No A-15-120**



"NOT TO SCALE,  
FOR ILLUSTRATIVE PURPOSES ONLY"  
Council District: 7

2431 W Mistletoe  
1/250

Development Services Department  
City of San Antonio



Attachment 2  
Plot Plan (continued)



**Board of Adjustment**  
Plot Plan for  
Case No A-15-120



"NOT TO SCALE,  
FOR ILLUSTRATIVE PURPOSES ONLY"  
Council District: 7

2431 W Mistletoe

Development Services Department  
City of San Antonio

**Attachment 3  
Applicant's Site Plan**

**PLOT PLAN**

FOR  
BLDG PERMITS

Address 2431 W Mistletoe Lot 11 Block 9 NCB 9108

REAR

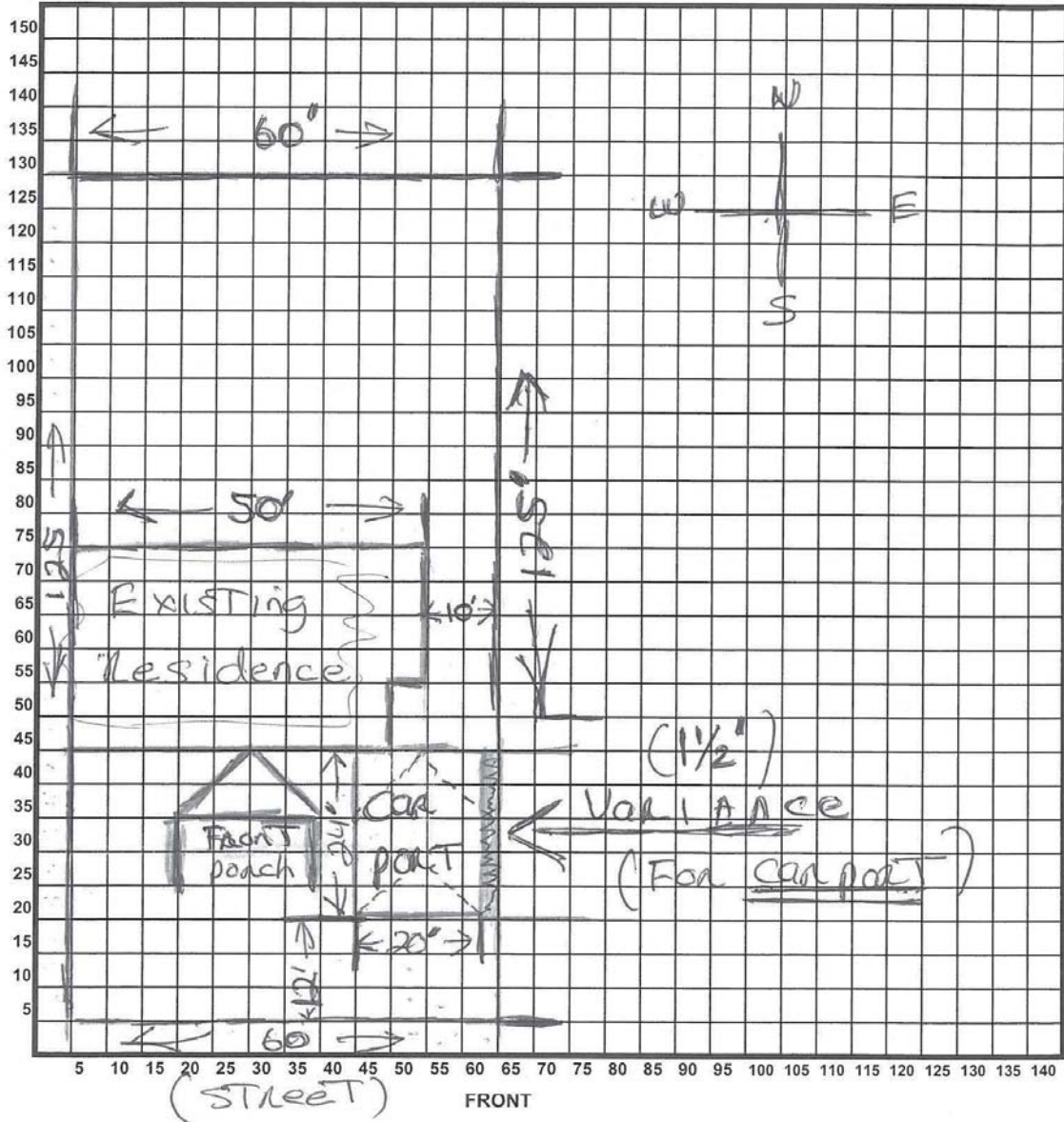

Date

Signature of Applicant



**Attachment 4 – Photos  
Subject Property**

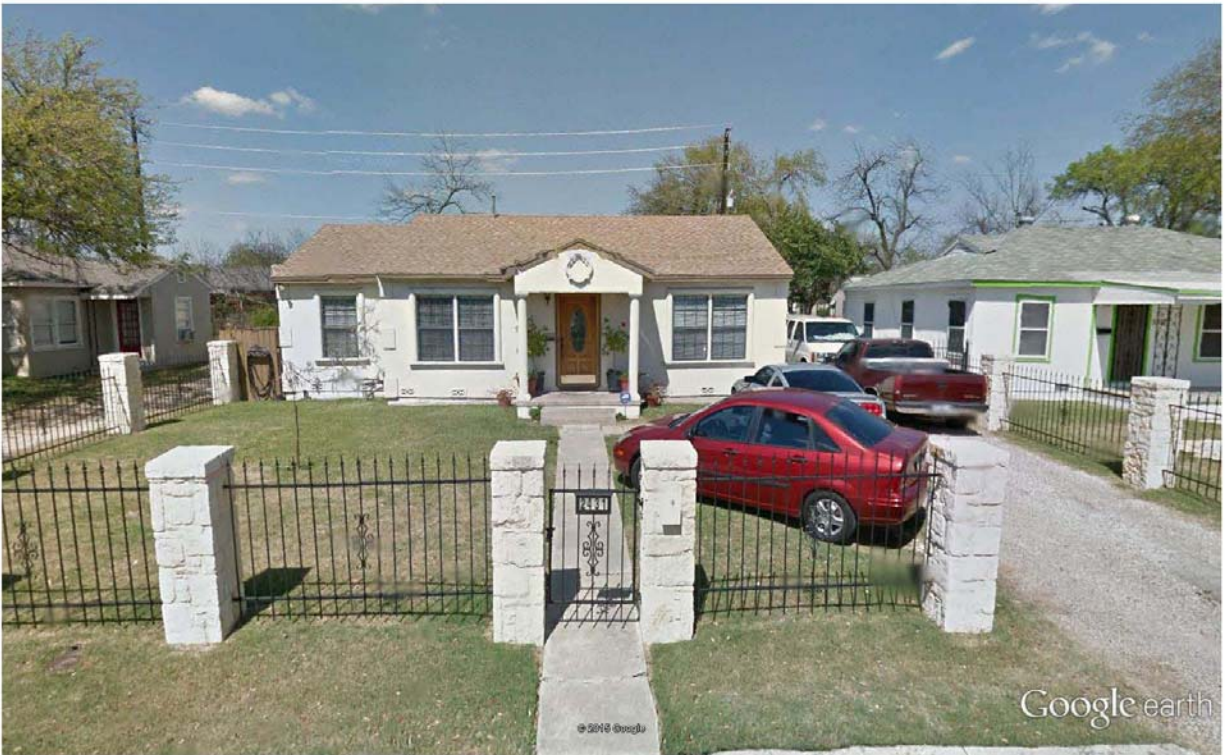

**Subject Property**

