

I, Enrique Sotabia (Director of Sotabia Brothers International, Inc.), the property owner, acknowledge that this site plan submitted for the purpose of rezoning this property is in accordance with all applicable provisions of the Unified Development Code. Additionally, I understand that City Council approval of a site plan in conjunction with a rezoning case does not relieve me from adherence to any/all City-adopted Codes at the time of plan submittal for building permits.

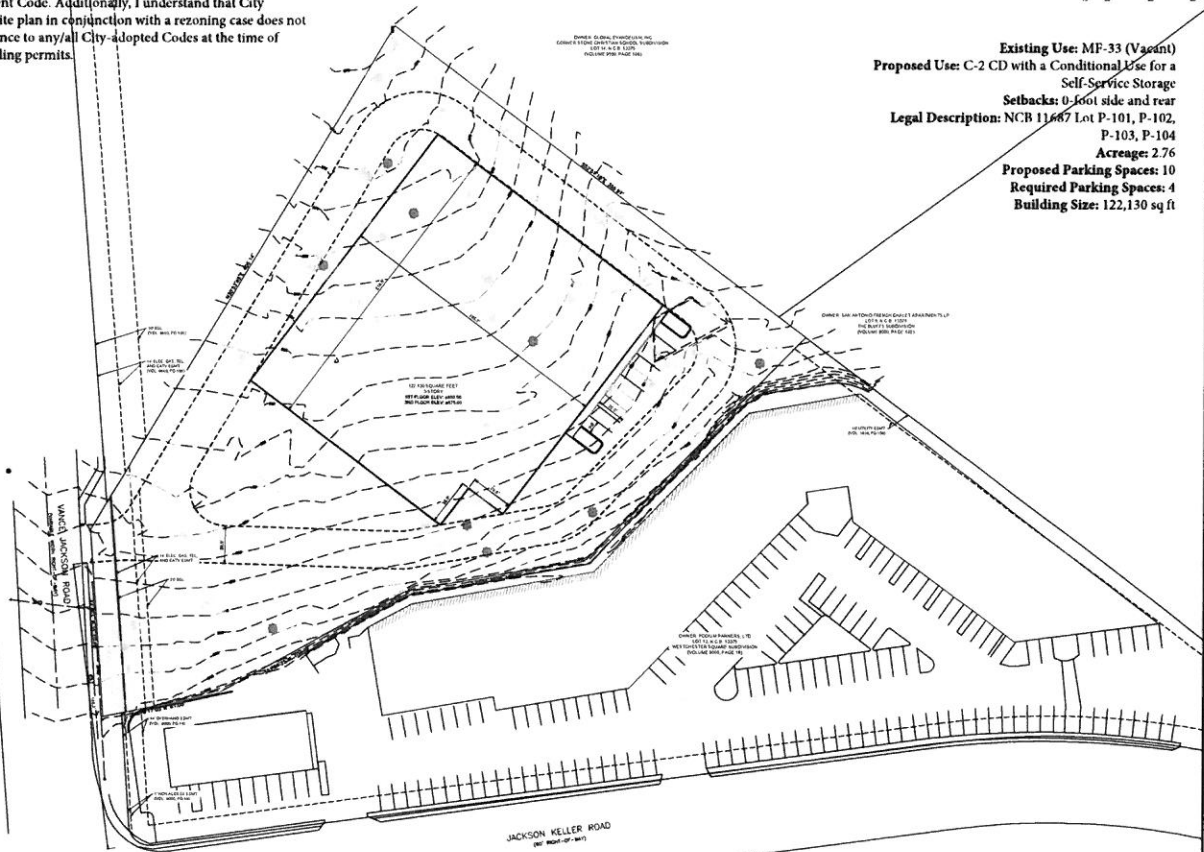

**Existing Use:** MF-33 (Vacant)  
**Proposed Use:** C-2 CD with a Conditional Use for a Self-Service Storage  
**Setbacks:** 0-foot side and rear  
**Legal Description:** NCB 11667 Lot P-101, P-102, P-103, P-104  
**Acres:** 2.76  
**Proposed Parking Spaces:** 10  
**Required Parking Spaces:** 4  
**Building Size:** 122,130 sq ft



MACHINA • BOSE • CORLEANO & ASSOC., INC.  
 CONSULTING ENGINEERS AND LAND SURVEYORS  
 1205 Central Expressway, Suite 200, Austin, Texas 78702  
 (512) 345-1121 • Fax: (512) 345-8800 • www.machinabose.com  
 Date: September 15, 2011 • Project No.: 11-001-000



VANCE JACKSON STORAGE  
 SAN ANTONIO, TX  
 CONCEPTUAL SITE EXHIBIT

DATE	11/15/11
BY	ES
CHECKED BY	ES
SCALE	AS SHOWN
PROJECT NO.	11-001-000
SHEET NO.	1 OF 1