

Attachment 1 Notification Plan

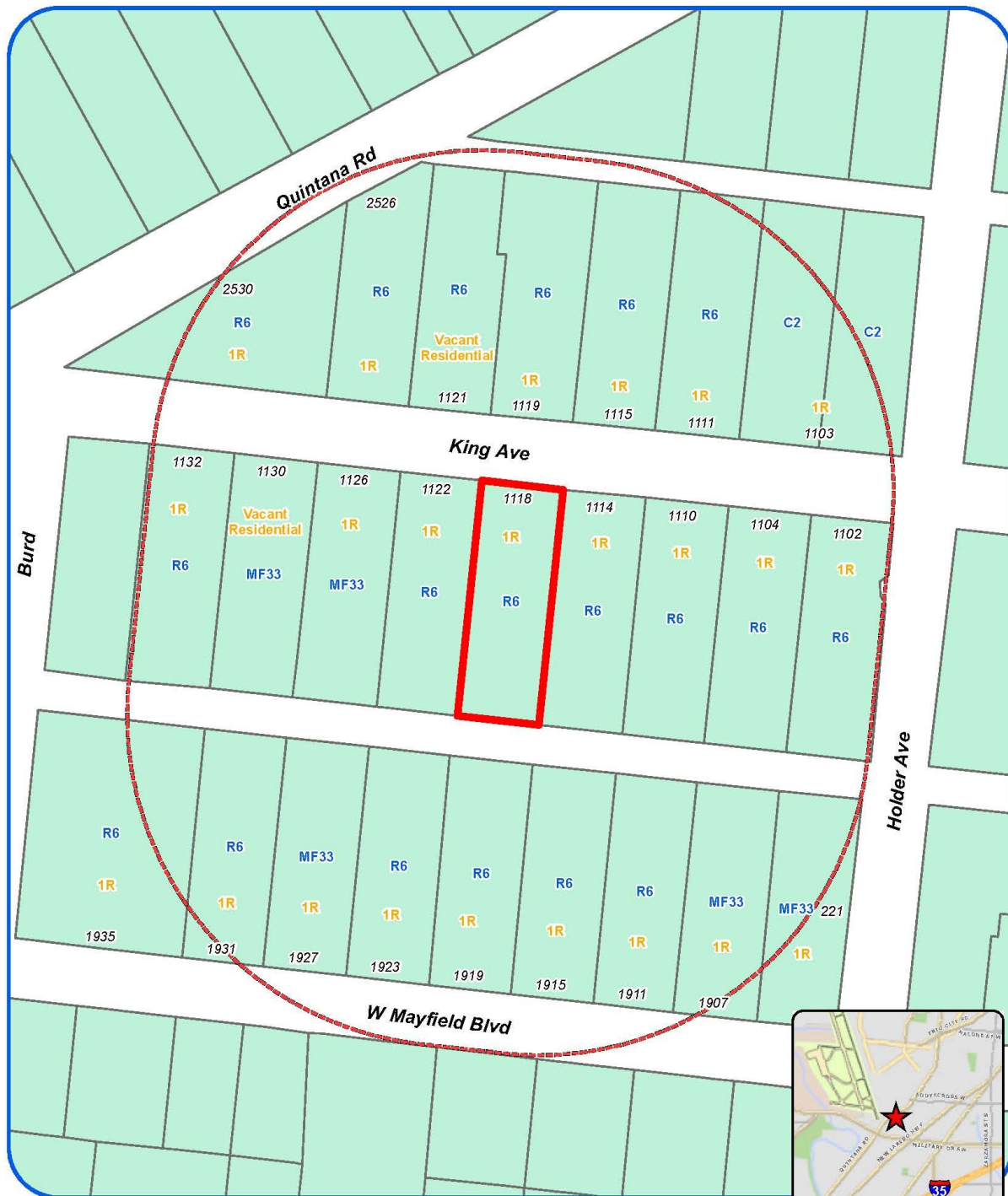

Board of Adjustment Notification Plan for Case No A-15-140



San Antonio City Limits
Subject Property
200' Notification Boundary
Council District: 4



"NOT TO SCALE,
FOR ILLUSTRATIVE PURPOSES ONLY"

Development Services Department
City of San Antonio

**Board of Adjustment
Notification Plan for
Case No A-15-140**

San Antonio City Limits
Subject Property
200' Notification Boundary
Council District 4

**NOT TO SCALE,
FOR ILLUSTRATIVE PURPOSES ONLY**

Department of Planning
City of San Antonio

**Attachment 2
Plot Plan**



Board of Adjustment
Plot Plan for
Case No A-15-140



"NOT TO SCALE,
FOR ILLUSTRATIVE PURPOSES ONLY"
Council District: 4

1118 King Ave

Development Services Department
City of San Antonio

Attachment 2
Plot Plan (continued)



Variance Request: 1) a four foot variance from the four foot maximum predominately open front yard fence height to allow an eight foot tall wrought iron fence in the front yard of the property and 2) a four foot variance from the minimum five foot side yard setback to allow an attached carport to be located one foot from the side property line and 3) a one foot variance from the three foot side setback to allow an accessory structure to be located one foot from the side property line.

Board of Adjustment
Plot Plan for
Case No A-15-140



"NOT TO SCALE,
FOR ILLUSTRATIVE PURPOSES ONLY"
Council District: 4

1118 King Ave

Development Services Department
City of San Antonio

Attachment 3
Applicant's Site Plan

PLOT PLAN

FOR
BLDG PERMITS

Address 1118 KING AVE.
S. A. TX 78211

Lot _____

Block _____

NCB _____

REAR

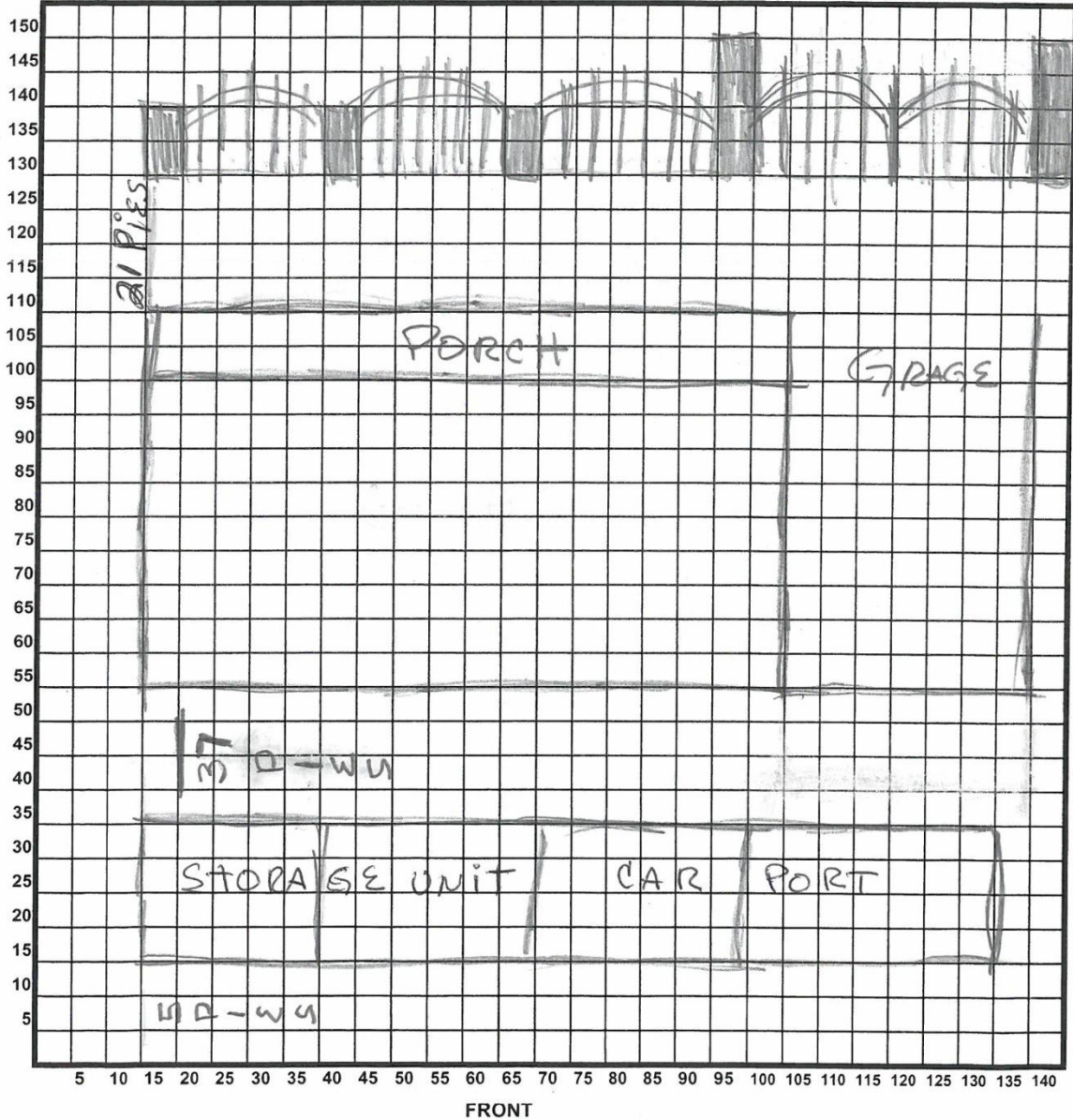

8-17-15

Date

James M. Melfo

Signature of Applicant

**Attachment 4 – Photos
Subject Property**



Eight foot tall fence



Carport



Carport



Carport one foot from side property line



Accessory structure two feet from side property line

