

Z2016223

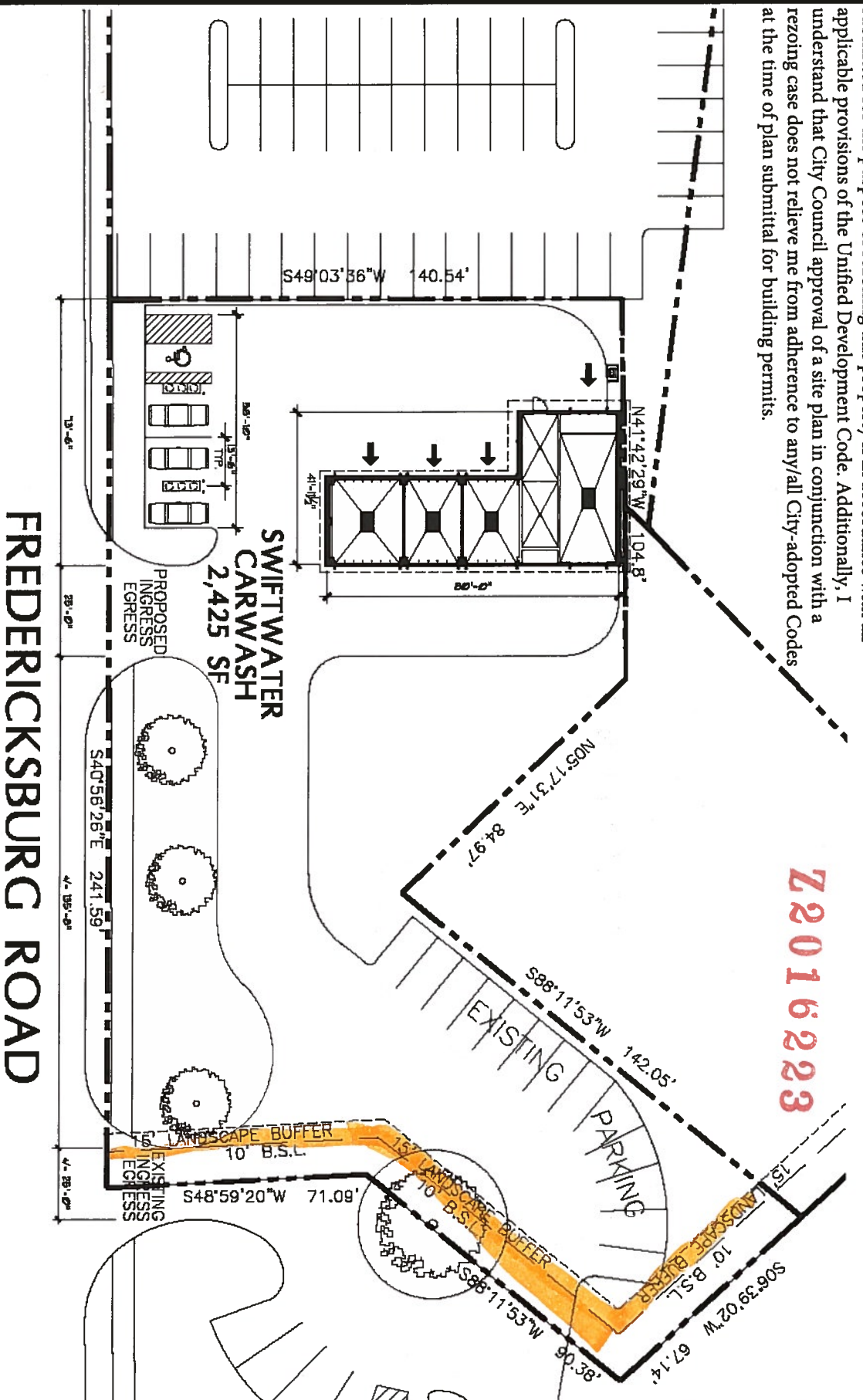

CONCEPTUAL SITE DEVELOPMENT PLAN



NORTH

SCALE: GRAPHIC



0,

100'

NOTE:

THIS CONCEPTUAL SITE PLAN IS FOR MARKETING PURPOSES ONLY, AND HAS BEEN PREPARED FOR CLIENT BASED UPON PRELIMINARY AVAILABLE SITE INFORMATION DEEMED RELIABLE. ALL DIMENSIONS, GRADES AND AREA CALCULATIONS ARE SUBJECT TO VERIFICATION AND MODIFICATION BY A PROFESSIONAL CIVIL ENGINEER FOR COMPLIANCE WITH ALL NATIONAL, STATE, AND LOCAL REGULATIONS, NOT FOR REGULATORY APPROVAL, PERMITTING, OR CONSTRUCTION.

Acreage: 0.803

Current Zoning: R-6 CD AHOD

Proposed Zoning: C-2S AHOD

Parking Spaces: 4 and 13 share parking spaces

Legal Description: Lot 35, Block 2, NCB 8416

Current Use: Vacant

Proposed Use: Car Wash

Council District: 7