



Board of Adjustment **Notification Plan for** **Case No A-16-162**



San Antonio City Limits



Subject Property



200' Notification Boundary



Council District: 1

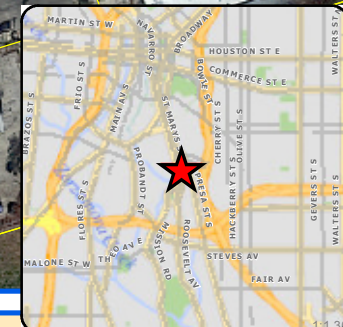

"NOT TO SCALE,
 FOR ILLUSTRATIVE PURPOSES ONLY"

Development Services Department
 City of San Antonio



Variance Request: 1) A request for variances from the S. Presa/S. St. Marys Neighborhood Conservation District to include: 1) the prohibition of attached garages; 2) the requirement that a porch comprise at least one-third the width of the front façade; 3) a variance to allow a window in the principal elevation which does not satisfy the 2:1 vertical ratio; 4) a variance from the requirement to connect the entrance to the public sidewalk; 5) a variance from the requirement to maintain a 4:12 roof pitch; 6) a variance from the 2.5 story limitation to allow 3 stories; 7) a variance from the requirement that homes be within 20% of the block median setback to allow new homes which are no closer than 7 feet and 8) the limitation that fencing above 2 ft. be transparent.

Board of Adjustment
Plot Plan for
Case No A-16-162



"NOT TO SCALE,
 FOR ILLUSTRATIVE PURPOSES ONLY"
 Council District: 1

1511-1519 S Presa St



LOTUS AVE.

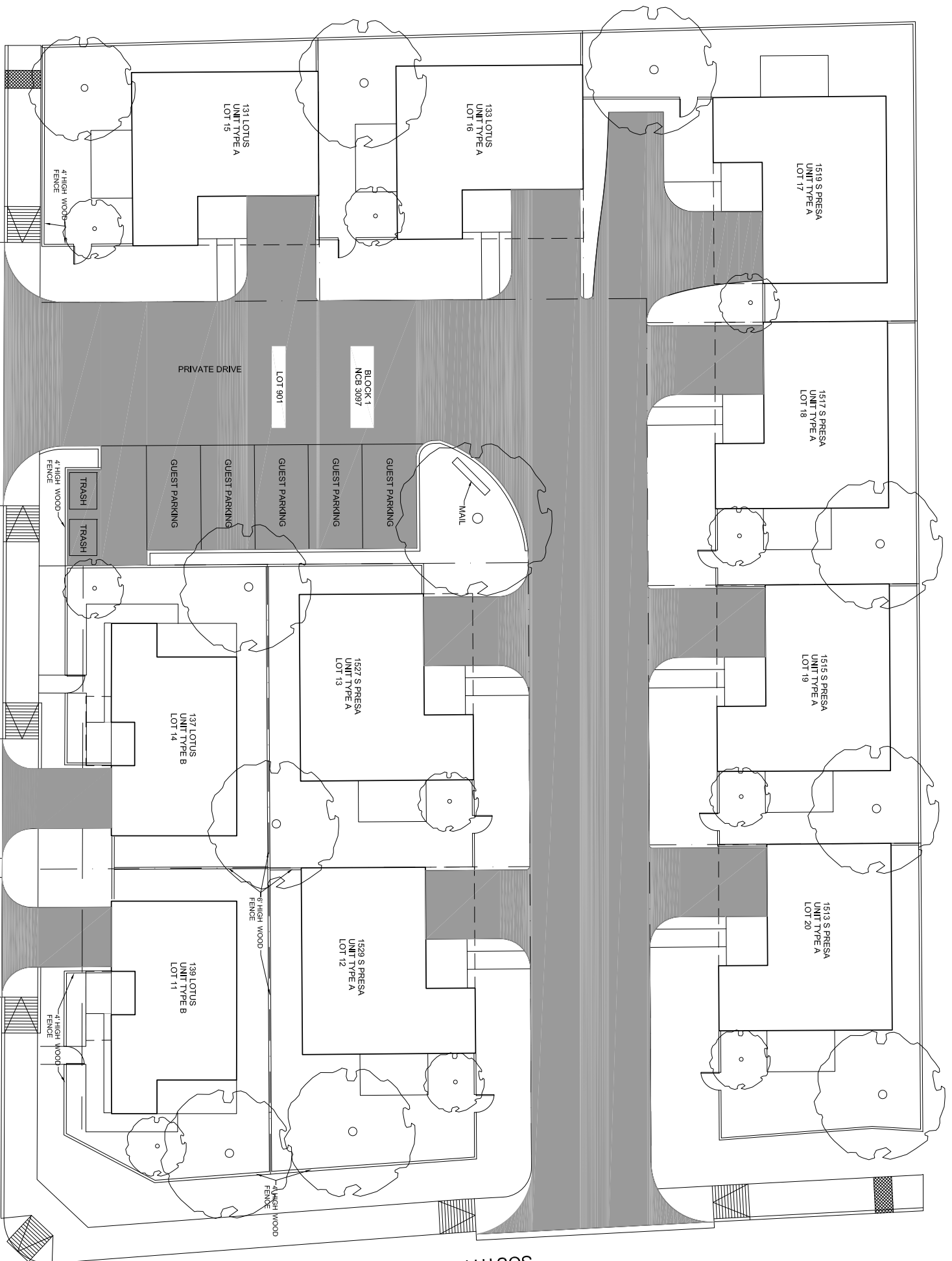

The subject property looking west



The subject property looking north



Across S. Presa Street



Across Locust Street down S. Presa Street

