

Board of Adjustment **Notification Plan for** **Case No A-16-164**



San Antonio City Limits

Subject Property

200' Notification Boundary

Council District: 2



"NOT TO SCALE,
 FOR ILLUSTRATIVE PURPOSES ONLY"

Development Services Department
 City of San Antonio

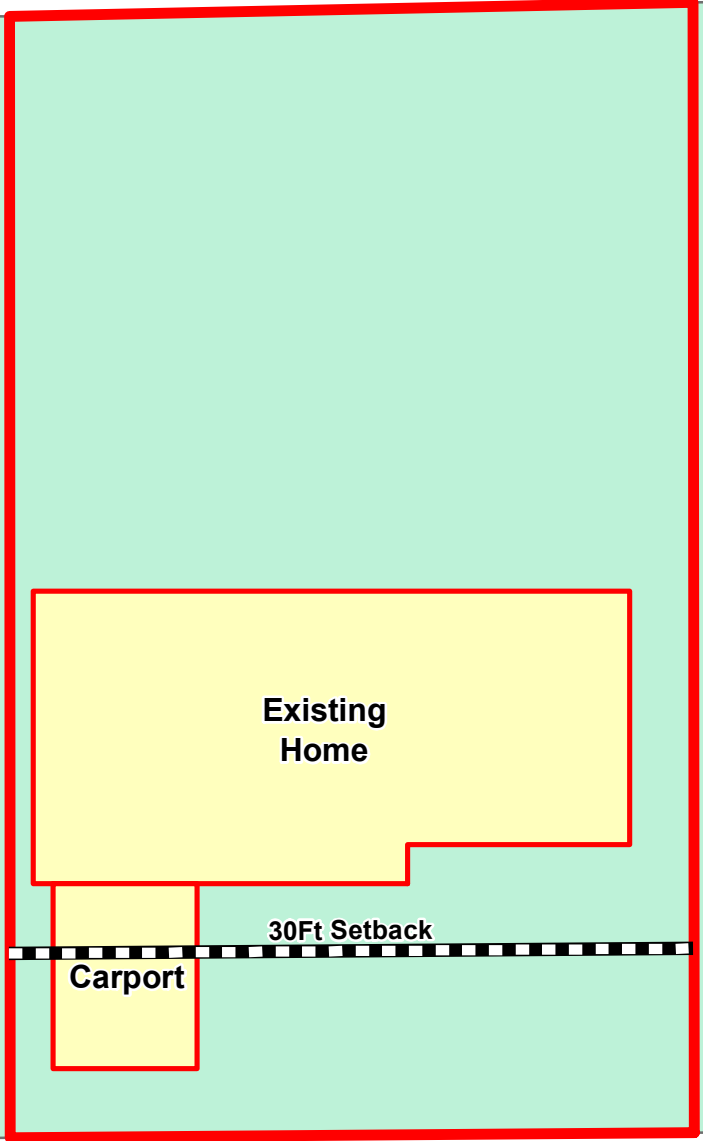

Variance Request: 1) a 20 foot variance from the 30 foot platted front setback to allow a carport to be 10 feet from the front property line.

CRUSADE DR

Board of Adjustment
Plot Plan for
Case No A-16-164



"NOT TO SCALE,
FOR ILLUSTRATIVE PURPOSES ONLY"
Council District: 2

5011 Crusade Dr

Development Services Department
City of San Antonio

1:250

Site Plan

PLOT PLAN FOR BUILDING PERMITS

Address: 5011 Crusade Dr

Lot: 22

Block: 4

NCB: 13686

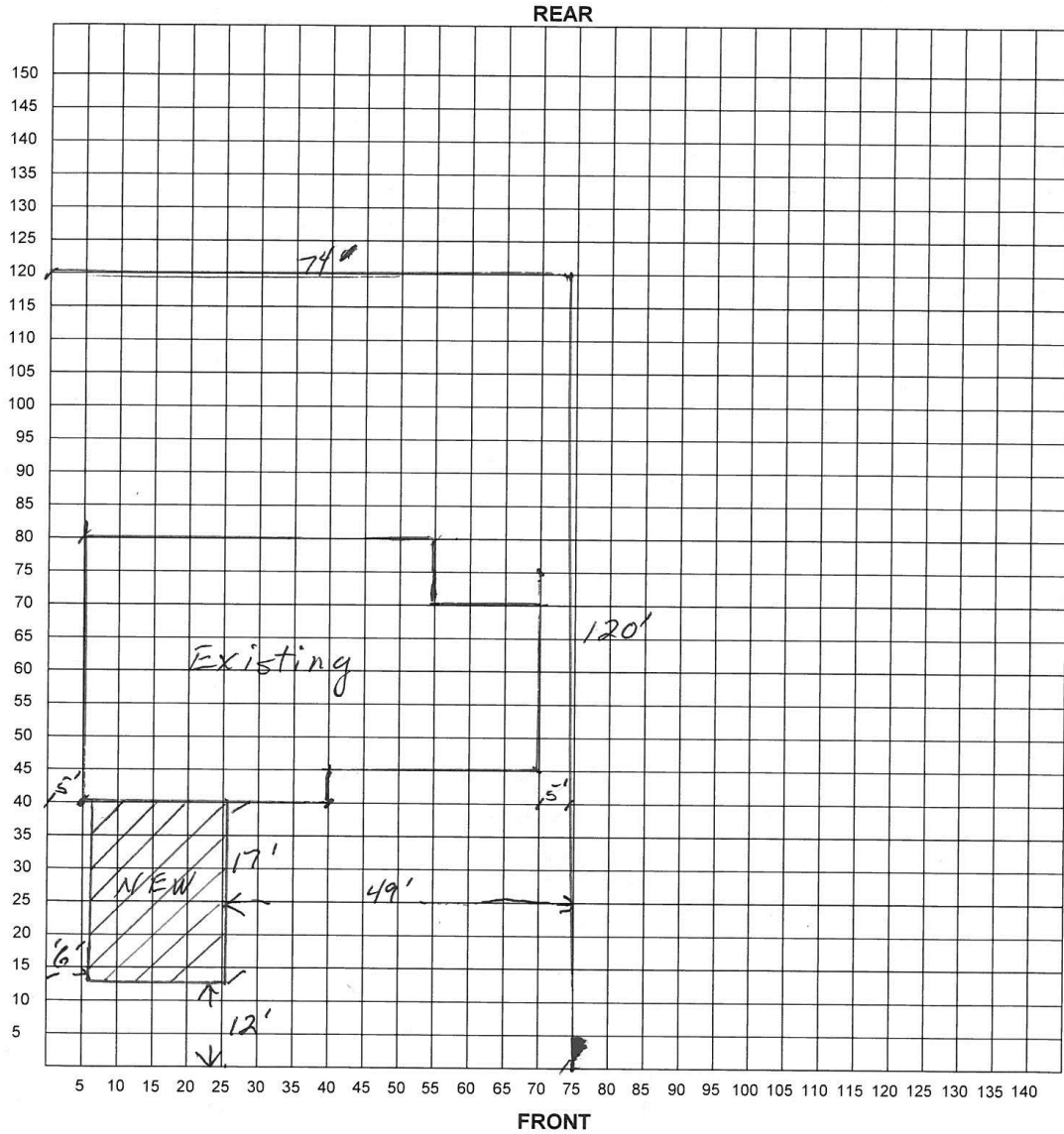

I certify that the above plot plan shows all improvements on this property and that there will be no construction over easements. I also certify that I will build in compliance with the UDC and the 2015 IRC.

Date: _____

Signature of Applicant: Michael G. Gutierrez

Subject Property – 5011 Crusade Drive



Carport meets side setback



Other carport in community



Other carport in community

