

SUBDIVISION PLAT  
OF  
**VALLEY RANCH**  
UNIT 4B

BEING A TOTAL OF 7.578 ACRE TRACT OF LAND ESTABLISHING VALLEY RANCH UNIT 4B OUT OF A 318.3 ACRE TRACT "3" RECORDED IN VOL. 12157, PGS. 1916-1932, AND OUT OF A 6,315 ACRE TRACT RECORDED IN VOL. 17799, PG. 1287, BOTH OF THE REAL PROPERTY RECORDS OF BEXAR COUNTY, TEXAS AND LYING IN THE J.J. SANCHEZ SURVEY NO. 83, ABSTRACT NO. 666, COUNTY BLOCK 4451 & THE M.M.Y. MUSQUIZ SURVEY NO. 80, ABSTRACT NO. 467 COUNTY BLOCK 4450, BEXAR COUNTY, TEXAS.

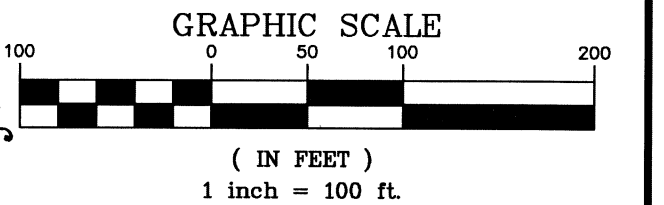

**Denham-Ramones Engineering**  
and Associates, Inc.

415 Arch Bluff  
SAN ANTONIO, TX. 78216  
FIRM REGISTRATION NUMBER: T.B.P.E. F-5161 & T.B.P.L.S. 10027.00

STATE OF TEXAS  
COUNTY OF BEXAR

THE OWNER OF LAND SHOWN ON THIS PLAT, IN PERSON OR THROUGH A DULY AUTHORIZED AGENT, DEDICATES TO THE USE OF THE PUBLIC, EXCEPT AREAS IDENTIFIED AS PRIVATE OR PART OF AN ENCLAVE OR PLANNED UNIT DEVELOPED, FOREVER ALL STREETS, ALLEYS, PARKS, WATERCOURSES, DRAINS, EASEMENTS AND PUBLIC PLACES THEREON SHOWN FOR THE PURPOSE AND CONSIDERATION THEREIN EXPRESSED.

OWNER: CONTINENTAL HOMES OF TEXAS, L.P.  
BY: A TEXAS LIMITED PARTNERSHIP  
CITE OF TEXAS, INC.  
A DELAWARE CORPORATION, ITS SOLE GENERAL PARTNER  
LESLIE OSTRANDER, ASSISTANT SECRETARY

DULY AUTHORIZED AGENT:  
STATE OF TEXAS  
COUNTY OF BEXAR

BEFORE ME, THE UNDERSIGNED AUTHORITY ON THIS DAY PERSONALLY APPEARED  
LESLIE OSTRANDER  
KNOWN TO ME TO BE THE PERSON  
WHOSE NAME IS SUBSCRIBED TO THE FOREGOING INSTRUMENT, AND ACKNOWLEDGED TO ME THAT  
HE EXECUTED THE SAME FOR THE PURPOSES AND CONSIDERATIONS THEREIN EXPRESSED AND IN THE  
CAPACITY THEREIN STATED.

GIVEN UNDER MY HAND & SEAL OF OFFICE THIS 3 DAY OF MARCH A.D., 2017.

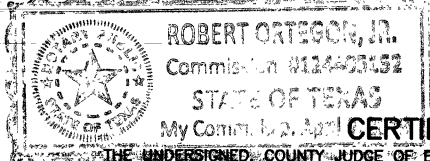

**NOTARY PUBLIC, BEXAR COUNTY, TEXAS**

**CERTIFICATE OF APPROVAL**  
THE UNDERSIGNED, COUNTY JUDGE OF BEXAR COUNTY, TEXAS AND PRESIDING OFFICER OF THE COMMISSIONERS COURT OF BEXAR COUNTY, DOES HEREBY CERTIFY THAT THE ATTACHED PLAT WAS DULY FILED WITH THE COMMISSIONERS COURT OF BEXAR COUNTY, TEXAS AND THAT AFTER EXAMINATION IT APPEARED THAT SAID PLAT IS IN CONFORMITY WITH THE STATUTES, RULES AND REGULATIONS GOVERNING SAME, AND THIS PLAT WAS APPROVED BY THE SAID COMMISSIONERS COURT.

DATED THIS \_\_\_\_\_ DAY OF \_\_\_\_\_ A.D. 20\_\_\_\_

COUNTY JUDGE, BEXAR COUNTY, TEXAS

COUNTY CLERK, BEXAR COUNTY, TEXAS

THIS PLAT OF VALLEY RANCH UNIT 4B HAS BEEN SUBMITTED TO AND CONSIDERED BY THE PLANNING COMMISSION OF THE CITY OF SAN ANTONIO, TEXAS; IS HEREBY APPROVED BY SUCH COMMISSION IN ACCORDANCE WITH STATE OR LOCAL LAWS AND REGULATIONS; AND/OR WHERE ADMINISTRATIVE EXCEPTION(S) AND/OR VARIANCE(S) HAVE BEEN GRANTED,

DATED THIS \_\_\_\_\_ DAY OF \_\_\_\_\_ A.D., 2017.

BY: \_\_\_\_\_ CHAIRMAN

BY: \_\_\_\_\_ SECRETARY

STATE OF TEXAS  
COUNTY OF BEXAR

I, \_\_\_\_\_ COUNTY CLERK OF SAID COUNTY DO HEREBY CERTIFY THAT THIS PLAT WAS FILED FOR RECORD IN MY OFFICE, ON THE

\_\_\_\_\_ DAY OF \_\_\_\_\_, A.D. \_\_\_\_\_ AT \_\_\_\_\_ M., AND DULY RECORDED THE

\_\_\_\_\_ DAY OF \_\_\_\_\_, A.D. \_\_\_\_\_ AT \_\_\_\_\_ M., IN THE RECORDS OF

\_\_\_\_\_ OF SAID COUNTY, IN BOOK VOLUME \_\_\_\_\_

ON PAGE \_\_\_\_\_ IN TESTIMONY WHEREOF, WITNESS MY HAND AND OFFICIAL SEAL OF OFFICE THIS

\_\_\_\_\_ DAY OF \_\_\_\_\_, A.D. \_\_\_\_\_ COUNTY CLERK, BEXAR COUNTY, TEXAS

BY: \_\_\_\_\_, DEPUTY

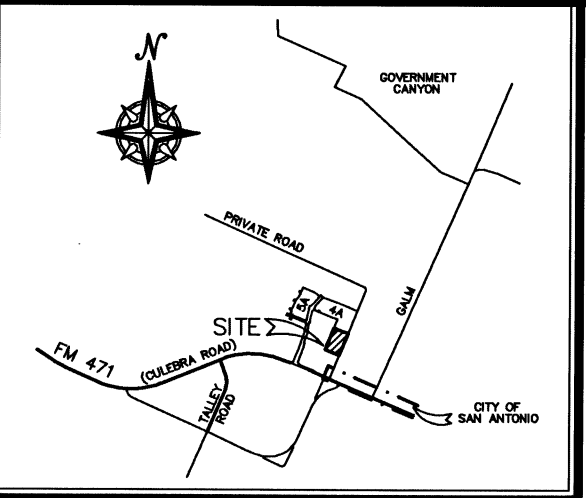

**LOCATION MAP**  
NOT TO SCALE

LINE	BEARING	LENGTH
L1	S89°53'30"E	50.00
L2	S89°53'30"E	50.00
L3	N24°06'30"E	17.14
L4	S89°08'30"W	15.00
L5	N20°53'30"W	15.00
L6	S24°06'30"W	35.00
L7	S24°06'30"W	35.00

CURVE	DELTA	RADIUS	TANGENT	LENGTH	CHORD
C1	81°51'01"	51.00'	44.22'	72.88'	68.82'
C2	36°08'11"	28.00'	9.46'	18.29'	17.99'
C3	90°00'00"	10.00'	10.00'	15.71'	14.14'
C4	90°00'00"	25.00'	25.00'	39.27'	35.36'
C5	90°00'00"	25.00'	25.00'	39.27'	35.36'
C6	90°00'00"	25.00'	25.00'	39.27'	35.36'
C7	36°08'11"	28.00'	9.46'	18.29'	17.99'
C8	182°18'45"	51.00'	327.18'	144.45'	100.78'
C9	36°08'11"	28.00'	9.46'	18.29'	17.99'
C10	36°08'11"	28.00'	9.46'	18.29'	17.99'
C11	80°23'21"	51.00'	43.12'	71.99'	65.85'

**"C.P.S. NOTES"**

- THE CITY OF SAN ANTONIO AS A PART OF ITS ELECTRIC AND GAS SYSTEM (CITY PUBLIC SERVICE BOARD) IS HEREBY DEDICATED THE EASEMENTS AND RIGHTS-OF-WAY FOR ELECTRIC AND GAS DISTRIBUTION AND SERVICE FACILITIES IN THE AREAS DESIGNATED ON THIS PLAT AS "ELECTRIC EASEMENT", "GAS EASEMENT", "ANCHOR EASEMENT", "SERVICE EASEMENT", "OVERHANG EASEMENT", "UTILITY EASEMENT", AND "TRANSFORMER EASEMENT" FOR THE PURPOSE OF INSTALLING, CONSTRUCTING, RECONSTRUCTING, MAINTAINING, REMOVING, INSPECTING, PATROLLING, AND ERECTING POLES, HANGING OR BURYING WIRES, CABLES, CONDUITS, PIPELINES OR TRANSFORMERS, EACH WITH ITS NECESSARY APPURTENANCES, TOGETHER WITH THE RIGHT OF INGRESS AND EGRESS OVER GRANTOR'S ADJACENT LAND, THE RIGHT TO RELOCATE SAID FACILITIES WITHIN SAID EASEMENT AND RIGHT-OF-WAY AREAS, AND THE RIGHT TO REMOVE FROM SAID LANDS ALL TREES OR PARTS THEREOF, OR OTHER OBSTRUCTIONS WHICH ENDANGER OR MAY INTERFERE WITH THE EFFICIENCY OF SAID LINES OR APPURTENANCES THERETO, IT IS AGREED AND UNDERSTOOD THAT NO BUILDINGS, CONCRETE SLABS, OR WALLS WILL BE PLACED WITHIN SAID EASEMENT AREAS.
- ANY OPS MONETARY LOSS RESULTING FROM MODIFICATIONS REQUIRED OF CPS EQUIPMENT, LOCATED WITHIN SAID EASEMENT, DUE TO GRADE CHANGES OR GROUND ELEVATION ALTERATIONS SHALL BE CHARGED TO THE PERSON OR PERSONS DEEMED RESPONSIBLE FOR SAID GRADE CHANGES OR GROUND ELEVATION ALTERATION.
- THIS PLAT DOES NOT AMEND, ALTER, RELEASE OR OTHERWISE AFFECT ANY EXISTING ELECTRIC, GAS, WATER, SEWER, DRAINAGE, TELEPHONE, CABLE EASEMENTS OR ANY OTHER EASEMENTS FOR UTILITIES UNLESS THE CHANGES TO SUCH EASEMENTS ARE DESCRIBED BELOW.
- CONCRETE DRIVEWAY APPROACHES ARE ALLOWED WITHIN THE FIVE (5) FOOT WIDE ELECTRIC AND GAS EASEMENTS WHEN LOTS ARE SERVED ONLY BY REAR LOT UNDERGROUND ELECTRIC AND GAS FACILITIES.
- ROOF OVERHANGS ARE ALLOWED WITHIN FIVE (5) FOOT WIDE ELECTRIC, GAS, TELEPHONE, AND CABLE T.V. EASEMENTS WHEN ONLY UNDERGROUND ELECTRIC, GAS, TELEPHONE AND CABLE T.V. FACILITIES ARE PROPOSED OR EXISTING WITHIN THOSE FIVE (5) FOOT WIDE EASEMENTS.

**LEGEND**

- BUILDING SETBACK LINE
- CLEAR VISION EASEMENT
- ELECTRIC & CABLE TELEVISION EASEMENT
- TELEPHONE & CABLE TELEVISION EASEMENT
- GAS, ELECTRIC, TELEPHONE & CABLE TELEVISION EASEMENT
- ESMT
- VEHICULAR NON-ACCESS EASEMENT
- OFFICIAL PUBLIC RECORDS OF REAL PROPERTY, BEXAR COUNTY, TEXAS.
- DEED AND PLAT RECORDS, BEXAR COUNTY, TEXAS.
- VARIABLE
- VOLUME
- PAGE
- EASEMENT
- RIGHT OF WAY
- STREET CENTERLINE
- MINIMUM FINISHED FLOOR ELEVATION
- EXISTING CONTOUR
- PROPOSED FINISHED CONTOUR
- THE VALUES OF THE SETS OF COORDINATES SHOWN HEREON WERE OBTAINED WITH GLOBAL POSITIONING RECEIVERS DATUM IS NAD 83 (2011), TEXAS STATE PLANE COORDINATE SYSTEM, SOUTH CENTRAL ZONE, COMBINED SCALE FACTOR IS 1.00017, ROTATION GRID TO PLAT IS 0°00'00".
- MONUMENTATION AS SHOWN, IT IS THE PRACTICE OF DENHAM-RAMONES ENGINEERING AND ASSOCIATES, INC. TO MONUMENT ALL CORNERS (IF PRACTICAL) IN THE SUBDIVISION WITH 1/2" REBAR AND D-R E PLASTIC CAP UPON COMPLETION OF CONSTRUCTION.
- RECEIVERS DATUM IS NAD 83 (2011), TEXAS STATE PLANE COORDINATE SYSTEM, SOUTH CENTRAL ZONE, COMBINED SCALE FACTOR IS 1.00017, ROTATION GRID TO PLAT IS 0°00'00".
- MONUMENTATION AS SHOWN, IT IS THE PRACTICE OF DENHAM-RAMONES ENGINEERING AND ASSOCIATES, INC. TO MONUMENT ALL CORNERS (IF PRACTICAL) IN THE SUBDIVISION WITH 1/2" REBAR AND D-R E PLASTIC CAP UPON COMPLETION OF CONSTRUCTION.
- RECEIVERS DATUM IS NAD 83 (2011), TEXAS STATE PLANE COORDINATE SYSTEM, SOUTH CENTRAL ZONE, COMBINED SCALE FACTOR IS 1.00017, ROTATION GRID TO PLAT IS 0°00'00".
- MONUMENTATION AS SHOWN, IT IS THE PRACTICE OF DENHAM-RAMONES ENGINEERING AND ASSOCIATES, INC. TO MONUMENT ALL CORNERS (IF PRACTICAL) IN THE SUBDIVISION WITH 1/2" REBAR AND D-R E PLASTIC CAP UPON COMPLETION OF CONSTRUCTION.
- RECEIVERS DATUM IS NAD 83 (2011), TEXAS STATE PLANE COORDINATE SYSTEM, SOUTH CENTRAL ZONE, COMBINED SCALE FACTOR IS 1.00017, ROTATION GRID TO PLAT IS 0°00'00".
- MONUMENTATION AS SHOWN, IT IS THE PRACTICE OF DENHAM-RAMONES ENGINEERING AND ASSOCIATES, INC. TO MONUMENT ALL CORNERS (IF PRACTICAL) IN THE SUBDIVISION WITH 1/2" REBAR AND D-R E PLASTIC CAP UPON COMPLETION OF CONSTRUCTION.
- RECEIVERS DATUM IS NAD 83 (2011), TEXAS STATE PLANE COORDINATE SYSTEM, SOUTH CENTRAL ZONE, COMBINED SCALE FACTOR IS 1.00017, ROTATION GRID TO PLAT IS 0°00'00".
- MONUMENTATION AS SHOWN, IT IS THE PRACTICE OF DENHAM-RAMONES ENGINEERING AND ASSOCIATES, INC. TO MONUMENT ALL CORNERS (IF PRACTICAL) IN THE SUBDIVISION WITH 1/2" REBAR AND D-R E PLASTIC CAP UPON COMPLETION OF CONSTRUCTION.
- RECEIVERS DATUM IS NAD 83 (2011), TEXAS STATE PLANE COORDINATE SYSTEM, SOUTH CENTRAL ZONE, COMBINED SCALE FACTOR IS 1.00017, ROTATION GRID TO PLAT IS 0°00'00".
- MONUMENTATION AS SHOWN, IT IS THE PRACTICE OF DENHAM-RAMONES ENGINEERING AND ASSOCIATES, INC. TO MONUMENT ALL CORNERS (IF PRACTICAL) IN THE SUBDIVISION WITH 1/2" REBAR AND D-R E PLASTIC CAP UPON COMPLETION OF CONSTRUCTION.
- RECEIVERS DATUM IS NAD 83 (2011), TEXAS STATE PLANE COORDINATE SYSTEM, SOUTH CENTRAL ZONE, COMBINED SCALE FACTOR IS 1.00017, ROTATION GRID TO PLAT IS 0°00'00".
- MONUMENTATION AS SHOWN, IT IS THE PRACTICE OF DENHAM-RAMONES ENGINEERING AND ASSOCIATES, INC. TO MONUMENT ALL CORNERS (IF PRACTICAL) IN THE SUBDIVISION WITH 1/2" REBAR AND D-R E PLASTIC CAP UPON COMPLETION OF CONSTRUCTION.
- RECEIVERS DATUM IS NAD 83 (2011), TEXAS STATE PLANE COORDINATE SYSTEM, SOUTH CENTRAL ZONE, COMBINED SCALE FACTOR IS 1.00017, ROTATION GRID TO PLAT IS 0°00'00".
- MONUMENTATION AS SHOWN, IT IS THE PRACTICE OF DENHAM-RAMONES ENGINEERING AND ASSOCIATES, INC. TO MONUMENT ALL CORNERS (IF PRACTICAL) IN THE SUBDIVISION WITH 1/2" REBAR AND D-R E PLASTIC CAP UPON COMPLETION OF CONSTRUCTION.
- RECEIVERS DATUM IS NAD 83 (2011), TEXAS STATE PLANE COORDINATE SYSTEM, SOUTH CENTRAL ZONE, COMBINED SCALE FACTOR IS 1.00017, ROTATION GRID TO PLAT IS 0°00'00".
- MONUMENTATION AS SHOWN, IT IS THE PRACTICE OF DENHAM-RAMONES ENGINEERING AND ASSOCIATES, INC. TO MONUMENT ALL CORNERS (IF PRACTICAL) IN THE SUBDIVISION WITH 1/2" REBAR AND D-R E PLASTIC CAP UPON COMPLETION OF CONSTRUCTION.
- RECEIVERS DATUM IS NAD 83 (2011), TEXAS STATE PLANE COORDINATE SYSTEM, SOUTH CENTRAL ZONE, COMBINED SCALE FACTOR IS 1.00017, ROTATION GRID TO PLAT IS 0°00'00".
- MONUMENTATION AS SHOWN, IT IS THE PRACTICE OF DENHAM-RAMONES ENGINEERING AND ASSOCIATES, INC. TO MONUMENT ALL CORNERS (IF PRACTICAL) IN THE SUBDIVISION WITH 1/2" REBAR AND D-R E PLASTIC CAP UPON COMPLETION OF CONSTRUCTION.
- RECEIVERS DATUM IS NAD 83 (2011), TEXAS STATE PLANE COORDINATE SYSTEM, SOUTH CENTRAL ZONE, COMBINED SCALE FACTOR IS 1.00017, ROTATION GRID TO PLAT IS 0°00'00".
- MONUMENTATION AS SHOWN, IT IS THE PRACTICE OF DENHAM-RAMONES ENGINEERING AND ASSOCIATES, INC. TO MONUMENT ALL CORNERS (IF PRACTICAL) IN THE SUBDIVISION WITH 1/2" REBAR AND D-R E PLASTIC CAP UPON COMPLETION OF CONSTRUCTION.
- RECEIVERS DATUM IS NAD 83 (2011), TEXAS STATE PLANE COORDINATE SYSTEM, SOUTH CENTRAL ZONE, COMBINED SCALE FACTOR IS 1.00017, ROTATION GRID TO PLAT IS 0°00'00".
- MONUMENTATION AS SHOWN, IT IS THE PRACTICE OF DENHAM-RAMONES ENGINEERING AND ASSOCIATES, INC. TO MONUMENT ALL CORNERS (IF PRACTICAL) IN THE SUBDIVISION WITH 1/2" REBAR AND D-R E PLASTIC CAP UPON COMPLETION OF CONSTRUCTION.
- RECEIVERS DATUM IS NAD 83 (2011), TEXAS STATE PLANE COORDINATE SYSTEM, SOUTH CENTRAL ZONE, COMBINED SCALE FACTOR IS 1.00017, ROTATION GRID TO PLAT IS 0°00'00".
- MONUMENTATION AS SHOWN, IT IS THE PRACTICE OF DENHAM-RAMONES ENGINEERING AND ASSOCIATES, INC. TO MONUMENT ALL CORNERS (IF PRACTICAL) IN THE SUBDIVISION WITH 1/2" REBAR AND D-R E PLASTIC CAP UPON COMPLETION OF CONSTRUCTION.
- RECEIVERS DATUM IS NAD 83 (2011), TEXAS STATE PLANE COORDINATE SYSTEM, SOUTH CENTRAL ZONE, COMBINED SCALE FACTOR IS 1.00017, ROTATION GRID TO PLAT IS 0°00'00".
- MONUMENTATION AS SHOWN, IT IS THE PRACTICE OF DENHAM-RAMONES ENGINEERING AND ASSOCIATES, INC. TO MONUMENT ALL CORNERS (IF PRACTICAL) IN THE SUBDIVISION WITH 1/2" REBAR AND D-R E PLASTIC CAP UPON COMPLETION OF CONSTRUCTION.
- RECEIVERS DATUM IS NAD 83 (2011), TEXAS STATE PLANE COORDINATE SYSTEM, SOUTH CENTRAL ZONE, COMBINED SCALE FACTOR IS 1.00017, ROTATION GRID TO PLAT IS 0°00'00".
- MONUMENTATION AS SHOWN, IT IS THE PRACTICE OF DENHAM-RAMONES ENGINEERING AND ASSOCIATES, INC. TO MONUMENT ALL CORNERS (IF PRACTICAL) IN THE SUBDIVISION WITH 1/2" REBAR AND D-R E PLASTIC CAP UPON COMPLETION OF CONSTRUCTION.
- RECEIVERS DATUM IS NAD 83 (2011), TEXAS STATE PLANE COORDINATE SYSTEM, SOUTH CENTRAL ZONE, COMBINED SCALE FACTOR IS 1.00017, ROTATION GRID TO PLAT IS 0°00'00".
- MONUMENTATION AS SHOWN, IT IS THE PRACTICE OF DENHAM-RAMONES ENGINEERING AND ASSOCIATES, INC. TO MONUMENT ALL CORNERS (IF PRACTICAL) IN THE SUBDIVISION WITH 1/2" REBAR AND D-R E PLASTIC CAP UPON COMPLETION OF CONSTRUCTION.
- RECEIVERS DATUM IS NAD 83 (2011), TEXAS STATE PLANE COORDINATE SYSTEM, SOUTH CENTRAL ZONE, COMBINED SCALE FACTOR IS 1.00017, ROTATION GRID TO PLAT IS 0°00'00".
- MONUMENTATION AS SHOWN, IT IS THE PRACTICE OF DENHAM-RAMONES ENGINEERING AND ASSOCIATES, INC. TO MONUMENT ALL CORNERS (IF PRACTICAL) IN THE SUBDIVISION WITH 1/2" REBAR AND D-R E PLASTIC CAP UPON COMPLETION OF CONSTRUCTION.
- RECEIVERS DATUM IS NAD 83 (2011), TEXAS STATE PLANE COORDINATE SYSTEM, SOUTH CENTRAL ZONE, COMBINED SCALE FACTOR IS 1.00017, ROTATION GRID TO PLAT IS 0°00'00".
- MONUMENTATION AS SHOWN, IT IS THE PRACTICE OF DENHAM-RAMONES ENGINEERING AND ASSOCIATES, INC. TO MONUMENT ALL CORNERS (IF PRACTICAL) IN THE SUBDIVISION WITH 1/2" REBAR AND D-R E PLASTIC CAP UPON COMPLETION OF CONSTRUCTION.
- RECEIVERS DATUM IS NAD 83 (2011), TEXAS STATE PLANE COORDINATE SYSTEM, SOUTH CENTRAL ZONE, COMBINED SCALE FACTOR IS 1.00017, ROTATION GRID TO PLAT IS 0°00'00".
- MONUMENTATION AS SHOWN, IT IS THE PRACTICE OF DENHAM-RAMONES ENGINEERING AND ASSOCIATES, INC. TO MONUMENT ALL CORNERS (IF PRACTICAL) IN THE SUBDIVISION WITH 1/2" REBAR AND D-R E PLASTIC CAP UPON COMPLETION OF CONSTRUCTION.
- RECEIVERS DATUM IS NAD 83 (2011), TEXAS STATE PLANE COORDINATE SYSTEM, SOUTH CENTRAL ZONE, COMBINED SCALE FACTOR IS 1.00017, ROTATION GRID TO PLAT IS 0°00'00".
- MONUMENTATION AS SHOWN, IT IS THE PRACTICE OF DENHAM-RAMONES ENGINEERING AND ASSOCIATES, INC. TO MONUMENT ALL CORNERS (IF PRACTICAL) IN THE SUBDIVISION WITH 1/2" REBAR AND D-R E PLASTIC CAP UPON COMPLETION OF CONSTRUCTION.
- RECEIVERS DATUM IS NAD 83 (2011), TEXAS STATE PLANE COORDINATE SYSTEM, SOUTH CENTRAL ZONE, COMBINED SCALE FACTOR IS 1.00017, ROTATION GRID TO PLAT IS 0°00'00".
- MONUMENTATION AS SHOWN, IT IS THE PRACTICE OF DENHAM-RAMONES ENGINEERING AND ASSOCIATES, INC. TO MONUMENT ALL CORNERS (IF PRACTICAL) IN THE SUBDIVISION WITH 1/2" REBAR AND D-R E PLASTIC CAP UPON COMPLETION OF CONSTRUCTION.
- RECEIVERS DATUM IS NAD 83 (2011), TEXAS STATE PLANE COORDINATE SYSTEM, SOUTH CENTRAL ZONE, COMBINED SCALE FACTOR IS 1.00017, ROTATION GRID TO PLAT IS 0°00'00".
- MONUMENTATION AS SHOWN, IT IS THE PRACTICE OF DENHAM-RAMONES ENGINEERING AND ASSOCIATES, INC. TO MONUMENT ALL CORNERS (IF PRACTICAL) IN THE SUBDIVISION WITH 1/2" REBAR AND D-R E PLASTIC CAP UPON COMPLETION OF CONSTRUCTION.
- RECEIVERS DATUM IS NAD 83 (2011), TEXAS STATE PLANE COORDINATE SYSTEM, SOUTH CENTRAL ZONE, COMBINED SCALE FACTOR IS 1.00017, ROTATION GRID TO PLAT IS 0°00'00".
- MONUMENTATION AS SHOWN, IT IS THE PRACTICE OF DENHAM-RAMONES ENGINEERING AND ASSOCIATES, INC. TO MONUMENT ALL CORNERS (IF PRACTICAL) IN THE SUBDIVISION WITH 1/2" REBAR AND D-R E PLASTIC CAP UPON COMPLETION OF CONSTRUCTION.
- RECEIVERS DATUM IS NAD 83 (2011), TEXAS STATE PLANE COORDINATE SYSTEM, SOUTH CENTRAL ZONE, COMBINED SCALE FACTOR IS 1.00017, ROTATION GRID TO PLAT IS 0°00'00".
- MONUMENTATION AS SHOWN, IT IS THE PRACTICE OF DENHAM-RAMONES ENGINEERING AND ASSOCIATES, INC. TO MONUMENT ALL CORNERS (IF PRACTICAL) IN THE SUBDIVISION WITH 1/2" REBAR AND D-R E PLASTIC CAP UPON COMPLETION OF CONSTRUCTION.
- RECEIVERS DATUM IS NAD 83 (2011), TEXAS STATE PLANE COORDINATE SYSTEM, SOUTH CENTRAL ZONE, COMBINED SCALE FACTOR IS 1.00017, ROTATION GRID TO PLAT IS 0°00'00".
- MONUMENTATION AS SHOWN, IT IS THE PRACTICE OF DENHAM-RAMONES ENGINEERING AND ASSOCIATES, INC. TO MONUMENT ALL CORNERS (IF PRACTICAL) IN THE SUBDIVISION WITH 1/2" REBAR AND D-R E PLASTIC CAP UPON COMPLETION OF CONSTRUCTION.
- RECEIVERS DATUM IS NAD 83 (2011), TEXAS STATE PLANE COORDINATE SYSTEM, SOUTH CENTRAL ZONE, COMBINED SCALE FACTOR IS 1.00017, ROTATION GRID TO PLAT IS 0°00'00".
- MONUMENTATION AS SHOWN, IT IS THE PRACTICE OF DENHAM-RAMONES ENGINEERING AND ASSOCIATES, INC. TO MONUMENT ALL CORNERS (IF PRACTICAL) IN THE SUBDIVISION WITH 1/2" REBAR AND D-R E PLASTIC CAP UPON COMPLETION OF CONSTRUCTION.
- RECEIVERS DATUM IS NAD 83 (2011), TEXAS STATE PLANE COORDINATE SYSTEM, SOUTH CENTRAL ZONE, COMBINED SCALE FACTOR IS 1.00017, ROTATION GRID TO PLAT IS 0°00'00".
- MONUMENTATION AS SHOWN, IT IS THE PRACTICE OF DENHAM-RAMONES ENGINEERING AND ASSOCIATES, INC. TO MONUMENT ALL CORNERS (IF PRACTICAL) IN THE SUBDIVISION WITH 1/2" REBAR AND D-R E PLASTIC CAP UPON COMPLETION OF CONSTRUCTION.
- RECEIVERS DATUM IS NAD 83 (2011), TEXAS STATE PLANE COORDINATE SYSTEM, SOUTH CENTRAL ZONE, COMBINED SCALE FACTOR IS 1.00017, ROTATION GRID TO PLAT IS 0°00'00".
- MONUMENTATION AS SHOWN, IT IS THE PRACTICE OF DENHAM-RAMONES ENGINEERING AND ASSOCIATES, INC. TO MONUMENT ALL CORNERS (IF PRACTICAL) IN THE SUBDIVISION WITH 1/2" REBAR AND D-R E PLASTIC CAP UPON COMPLETION OF CONSTRUCTION.
- RECEIVERS DATUM IS NAD 83 (2011), TEXAS STATE PLANE COORDINATE SYSTEM, SOUTH CENTRAL ZONE, COMBINED SCALE FACTOR IS 1.00017, ROTATION GRID TO PLAT IS 0°00'00".
- MONUMENTATION AS SHOWN, IT IS THE PRACTICE OF DENHAM-RAMONES ENGINEERING AND ASSOCIATES, INC. TO MONUMENT ALL CORNERS (IF PRACTICAL) IN THE SUBDIVISION WITH 1/2" REBAR AND D-R E PLASTIC CAP UPON COMPLETION OF CONSTRUCTION.
- RECEIVERS DATUM IS NAD 83 (2011), TEXAS STATE PLANE COORDINATE SYSTEM, SOUTH CENTRAL ZONE, COMBINED SCALE FACTOR IS 1.00017, ROTATION GRID TO PLAT IS 0°00'00".
- MONUMENTATION AS SHOWN, IT IS THE PRACTICE OF DENHAM-RAMONES ENGINEERING AND ASSOCIATES, INC. TO MONUMENT ALL CORNERS (IF PRACTICAL) IN THE SUBDIVISION WITH 1/2" REBAR AND D-R E PLASTIC CAP UPON COMPLETION OF CONSTRUCTION.
- RECEIVERS DATUM IS NAD 83 (2011), TEXAS STATE PLANE COORDINATE SYSTEM, SOUTH CENTRAL ZONE, COMBINED SCALE FACTOR IS 1.00017, ROTATION GRID TO PLAT IS 0°00'00".
- MONUMENTATION AS SHOWN, IT IS THE PRACTICE OF DENHAM-RAMONES ENGINEERING AND ASSOCIATES, INC. TO MONUMENT ALL CORNERS (IF PRACTICAL) IN THE SUBDIVISION WITH 1/2" REBAR AND D-R E PLASTIC CAP UPON COMPLETION OF CONSTRUCTION.
- RECEIVERS DATUM IS NAD 83 (2011), TEXAS STATE PLANE COORDINATE SYSTEM, SOUTH CENTRAL ZONE, COMBINED SCALE FACTOR IS 1.00017, ROTATION GRID TO PLAT IS 0°00'00".
- MONUMENTATION AS SHOWN, IT IS THE PRACTICE OF DENHAM-RAMONES ENGINEERING AND ASSOCIATES, INC. TO MONUMENT ALL CORNERS (IF PRACTICAL) IN THE SUBDIVISION WITH 1/2" REBAR AND D-R E PLASTIC CAP UPON COMPLETION OF CONSTRUCTION.
- RECEIVERS DATUM IS NAD 83 (2011), TEXAS STATE PLANE COORDINATE SYSTEM, SOUTH CENTRAL ZONE, COMBINED SCALE FACTOR IS 1.00017, ROTATION GRID TO PLAT IS 0°00'00".
- MONUMENTATION AS SHOWN, IT IS THE PRACTICE OF DENHAM-RAMONES ENGINEERING AND ASSOCIATES, INC. TO MONUMENT ALL CORNERS (IF PRACTICAL) IN THE SUBDIVISION WITH 1/2" REBAR AND D-R E PLASTIC CAP UPON COMPLETION OF CONSTRUCTION.
- RECEIVERS DATUM IS NAD 83 (2011), TEXAS STATE PLANE COORDINATE SYSTEM, SOUTH CENTRAL ZONE, COMBINED SCALE FACTOR IS 1.00017, ROTATION GRID TO PLAT IS 0°00'00".
- MONUMENTATION AS SHOWN, IT IS THE PRACTICE OF DENHAM-RAMONES ENGINEERING AND ASSOCIATES, INC. TO MONUMENT ALL CORNERS (IF PRACTICAL) IN THE SUBDIVISION WITH 1/2" REBAR AND D-R E PLASTIC CAP UPON COMPLETION OF CONSTRUCTION.
- RECEIVERS DATUM IS NAD 83 (2011), TEXAS STATE PLANE COORDINATE SYSTEM, SOUTH CENTRAL ZONE, COMBINED SCALE FACTOR IS 1.00017, ROTATION GRID TO PLAT IS 0°00'00".
- MONUMENTATION AS SHOWN, IT IS THE PRACTICE OF DENHAM-RAMONES ENGINEERING AND ASSOCIATES, INC. TO MONUMENT ALL CORNERS (IF PRACTICAL) IN THE SUBDIVISION WITH 1/2" REBAR AND D-R E PLASTIC CAP UPON COMPLETION OF CONSTRUCTION.
- RECEIVERS DATUM IS NAD 83 (2011), TEXAS STATE PLANE COORDINATE SYSTEM, SOUTH CENTRAL ZONE, COMBINED SCALE FACTOR IS 1.00017, ROTATION GRID TO PLAT IS 0°00'00".
- MONUMENTATION AS SHOWN, IT IS THE PRACTICE OF DENHAM-RAMONES ENGINEERING AND ASSOCIATES, INC. TO MONUMENT ALL CORNERS (IF PRACTICAL) IN THE SUBDIVISION WITH 1/2" REBAR AND D-R E PLASTIC CAP UPON COMPLETION OF CONSTRUCTION.
- RECEIVERS DATUM IS NAD 83 (2011), TEXAS STATE PLANE COORDINATE SYSTEM, SOUTH CENTRAL ZONE, COMBINED SCALE FACTOR IS 1.00017, ROTATION GRID TO PLAT IS 0°00'00".
- MONUMENTATION AS SHOWN, IT IS THE PRACTICE OF DENHAM-RAMONES ENGINEERING AND ASSOCIATES, INC. TO MONUMENT ALL CORNERS (IF PRACTICAL) IN THE SUBDIVISION WITH 1/2" REBAR AND D-R E PLASTIC CAP UPON COMPLETION OF CONSTRUCTION.
- RECEIVERS DATUM IS NAD 83 (2011), TEXAS STATE PLANE COORDINATE SYSTEM, SOUTH CENTRAL ZONE, COMBINED SCALE FACTOR IS 1.00017, ROTATION GRID TO PLAT IS 0°00'00".
- MONUMENTATION AS SHOWN, IT IS THE PRACTICE OF DENHAM-RAMONES ENGINEERING AND ASSOCIATES, INC. TO MONUMENT ALL CORNERS (IF PRACTICAL) IN THE SUBDIVISION WITH 1/2" REBAR AND D-R E PLASTIC CAP UPON COMPLETION OF CONSTRUCTION.
- RECEIVERS DATUM IS NAD 83 (2011), TEXAS STATE PLANE COORDINATE SYSTEM, SOUTH CENTRAL ZONE, COMBINED SCALE FACTOR IS 1.00017, ROTATION GRID TO PLAT IS 0°00'00".
- MONUMENTATION AS SHOWN, IT IS THE PRACTICE OF DENHAM-RAMONES ENGINEERING AND ASSOCIATES, INC. TO MONUMENT ALL CORNERS (IF PRACTICAL) IN THE SUBDIVISION WITH 1/2" REBAR AND D-R E PLASTIC CAP UPON COMPLETION OF CONSTRUCTION.
- RECEIVERS DATUM IS NAD 83 (2011), TEXAS STATE PLANE COORDINATE SYSTEM, SOUTH CENTRAL ZONE, COMBINED SCALE FACTOR IS 1.00017, ROTATION GRID TO PLAT IS 0°00'00".
- MONUMENTATION AS SHOWN, IT IS THE PRACTICE OF DENHAM-RAMONES ENGINEERING AND ASSOCIATES, INC. TO MONUMENT ALL CORNERS (IF PRACTICAL) IN THE SUBDIVISION WITH 1/2" REBAR AND D-R E PLASTIC CAP UPON COMPLETION OF CONSTRUCTION.
- RECEIVERS DATUM IS NAD 83 (2011), TEXAS STATE PLANE COORDINATE SYSTEM, SOUTH CENTRAL ZONE, COMBINED SCALE FACTOR IS 1.00017, ROTATION GRID TO PLAT IS 0°00'00".
- MONUMENTATION AS SHOWN, IT IS THE PRACTICE OF DENHAM-RAMONES ENGINEERING AND ASSOCIATES, INC. TO MONUMENT ALL CORNERS (IF PRACTICAL) IN THE SUBDIVISION WITH 1/2" REBAR AND D-R E PLASTIC CAP UPON COMPLETION OF CONSTRUCTION.
- RECEIVERS DATUM IS NAD 83 (2011), TEXAS STATE PLANE COORDINATE SYSTEM, SOUTH CENTRAL ZONE, COMBINED SCALE FACTOR IS 1.00017, ROTATION GRID TO PLAT IS 0°00'00".
- MONUMENTATION AS SHOWN, IT IS THE PRACTICE OF DENHAM-RAMONES ENGINEERING AND ASSOCIATES, INC. TO MONUMENT ALL CORNERS (IF PRACTICAL) IN THE SUBDIVISION WITH 1/2" REBAR AND D-R E PLASTIC CAP UPON COMPLETION OF CONSTRUCTION.
- RECEIVERS DATUM IS NAD 83 (2011), TEXAS STATE PLANE COORDINATE SYSTEM, SOUTH CENTRAL ZONE, COMBINED SCALE FACTOR IS 1.00017, ROTATION GRID TO PLAT IS 0°00'00".
- MONUMENTATION AS SHOWN, IT IS THE PRACTICE OF DENHAM-RAMONES ENGINEERING AND ASSOCIATES, INC. TO MONUMENT ALL CORNERS (IF PRACTICAL) IN THE SUBDIVISION WITH 1/2" REBAR AND D-R E PLASTIC CAP UPON COMPLETION OF CONSTRUCTION.
- RECEIVERS DATUM IS NAD 83 (2011), TEXAS STATE PLANE COORDINATE SYSTEM, SOUTH CENTRAL ZONE, COMBINED SCALE FACTOR IS 1.00017, ROTATION GRID TO PLAT IS 0°00'00".
- MONUMENTATION AS SHOWN, IT IS THE PRACTICE OF DENHAM-RAMONES ENGINEERING AND ASSOCIATES, INC. TO MONUMENT ALL CORNERS (IF PRACTICAL) IN THE SUBDIVISION WITH 1/2" REBAR AND D-R E PLASTIC CAP UPON COMPLETION OF CONSTRUCTION.
- RECEIVERS DATUM IS NAD 83 (2011), TEXAS STATE PLANE COORDINATE SYSTEM, SOUTH CENTRAL ZONE, COMBINED SCALE FACTOR IS 1.00017, ROTATION GRID TO PLAT IS 0°00'00".
- MONUMENTATION AS SHOWN, IT IS THE PRACTICE OF DENHAM-RAMONES ENGINEERING AND ASSOCIATES, INC. TO MONUMENT ALL CORNERS (IF PRACTICAL) IN THE SUBDIVISION WITH 1/2" REBAR AND D-R E PLASTIC CAP UPON COMPLETION OF CONSTRUCTION.
- RECEIVERS DATUM IS NAD 83 (2011), TEXAS STATE PLANE COORDINATE SYSTEM, SOUTH CENTRAL ZONE, COMBINED SCALE FACTOR IS 1.00017, ROTATION GRID TO PLAT IS 0°00'00".
- MONUMENTATION AS SHOWN, IT IS THE PRACTICE OF DENHAM-RAMONES ENGINEERING AND ASSOCIATES, INC. TO MONUMENT ALL CORNERS (IF PRACTICAL) IN THE SUBDIVISION WITH 1/2" REBAR AND D-R E PLASTIC CAP UPON COMPLETION OF CONSTRUCTION.
- RECEIVERS DATUM IS NAD 83 (2011), TEXAS STATE PLANE COORDINATE SYSTEM, SOUTH CENTRAL ZONE, COMBINED SCALE FACTOR IS 1.00017, ROTATION GRID TO PLAT IS 0°00'00".
- MONUMENTATION AS SHOWN, IT IS THE PRACTICE OF DENHAM-RAMONES ENGINEERING AND ASSOCIATES, INC. TO MONUMENT ALL CORNERS (IF PRACTICAL) IN THE SUBDIVISION WITH 1/2" REBAR AND D-R E PLASTIC CAP UPON COMPLETION OF CONSTRUCTION.
- RECEIVERS DATUM IS NAD 83 (2011), TEXAS STATE PLANE COORDINATE SYSTEM, SOUTH CENTRAL ZONE, COMBINED SCALE FACTOR IS 1.00017, ROTATION GRID TO PLAT IS 0°00'00".
- MONUMENTATION AS SHOWN, IT IS THE PRACTICE OF DENHAM-RAMONES ENGINEERING AND ASSOCIATES, INC. TO MONUMENT ALL CORNERS (IF PRACTICAL) IN THE SUBDIVISION WITH 1/2" REBAR AND D-R E PLASTIC CAP UPON COMPLETION OF CONSTRUCTION.
- RECEIVERS DATUM IS NAD 83 (2011), TEXAS STATE PLANE COORDINATE SYSTEM, SOUTH CENTRAL ZONE, COMBINED SCALE FACTOR IS 1.00017, ROTATION GRID TO PLAT IS 0°00'00".
- MONUMENTATION AS SHOWN, IT IS THE PRACTICE OF DENHAM-RAMONES ENGINEERING AND ASSOCIATES, INC. TO MONUMENT ALL CORNERS (IF PRACTICAL) IN THE SUBDIVISION WITH 1/2" REBAR AND D-R E PLASTIC CAP UPON COMPLETION OF CONSTRUCTION.
- RECEIVERS DATUM IS NAD 83 (2011), TEXAS STATE PLANE COORDINATE SYSTEM, SOUTH CENTRAL ZONE, COMBINED SCALE FACTOR IS 1.00017, ROTATION GRID TO PLAT IS 0°00'00".
- MONUMENTATION AS SHOWN, IT IS THE PRACTICE OF DENHAM-RAMONES ENGINEERING AND ASSOCIATES, INC. TO MONUMENT ALL CORNERS (IF PRACTICAL) IN THE SUBDIVISION WITH 1/2" REBAR AND D-R E PLASTIC CAP UPON COMPLETION OF CONSTRUCTION.
- RECEIVERS DATUM IS NAD 83 (2011), TEXAS STATE PLANE COORDINATE SYSTEM, SOUTH CENTRAL ZONE, COMBINED SCALE FACTOR IS 1.00017, ROTATION GRID TO PLAT IS 0°00'00".
- MONUMENTATION AS SHOWN, IT IS THE PRACTICE OF DENHAM-RAMONES ENGINEERING AND ASSOCIATES, INC. TO MONUMENT ALL CORNERS (IF PRACTICAL) IN THE SUBDIVISION WITH 1/2" REBAR AND D-R E PLASTIC CAP UPON COMPLETION OF CONSTRUCTION.
- RECEIVERS DATUM IS NAD 83 (2011), TEXAS STATE PLANE COORDINATE SYSTEM, SOUTH CENTRAL ZONE, COMBINED SCALE FACTOR IS 1.00017, ROTATION GRID TO PLAT IS 0°00'00".
- MONUMENTATION AS SHOWN, IT IS THE PRACTICE OF DENHAM-RAMONES ENGINEERING AND ASSOCIATES, INC. TO MONUMENT ALL CORNERS (IF PRACTICAL) IN THE SUBDIVISION WITH 1/2" REBAR AND D-R E PLASTIC CAP UPON COMPLETION OF CONSTRUCTION.
- RECEIVERS DATUM IS NAD 83 (2011), TEXAS STATE PLANE COORDINATE SYSTEM, SOUTH CENTRAL ZONE, COMBINED SCALE FACTOR IS 1.00017, ROTATION GRID TO PLAT IS 0°00'00".
- MONUMENTATION AS SHOWN, IT IS THE PRACTICE OF DENHAM-RAMONES ENGINEERING AND ASSOCIATES, INC. TO MONUMENT ALL CORNERS (IF PRACTICAL) IN THE SUBDIVISION WITH 1/2" REBAR AND D-R E PLAST