

San Antonio Missions National Historical Park

Mission San José Area: City property to be transferred to NPS

National Park Service
U.S. Department of the Interior

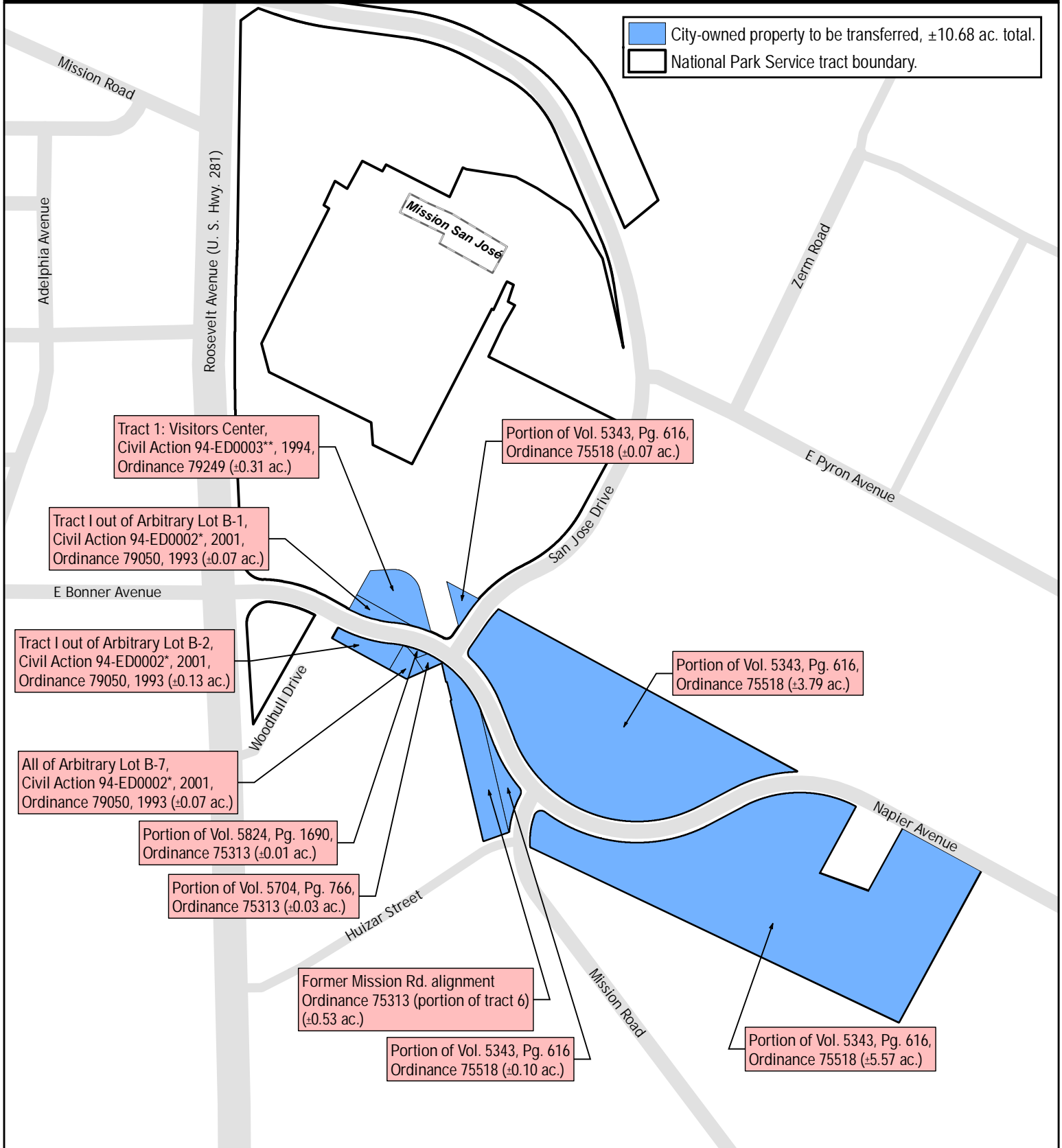

National Park Service
Lands Resources Program Center
Intermountain Region
September 2014



SCALE: 1" = 300'

0 75 150 300
Feet

* Civil Action 94-ED0002 was adjudicated in Bexar County Probate Court No. 2, recorded in Court records Vol. 20, Pg. 2748.

** Civil Action 94-ED0003 was adjudicated in Bexar County Probate Court No. 1, recorded in Bexar County Clerk records Vol. 5949, Pg. 837.

This is not a surveying quality drawing and should be used for general scaling purposes only.

Texas State Plane Coordinate System, South Central Zone, NAD83, US Foot.

Exhibit "A"