

POINTS							
POINT #	NORTHING	EASTING	ALIGNMENT	STATION	OFFSET	ELEVATION	DESCRIPTION
53	13712079.39	2135271.20	US281 RAMP	—	—	660.19	SET MAG NAIL & WASHER (TRAV)
100	13710947.42	2134933.75	AVENUE B	15+29.41	9.09' RT	661.97	SET MAG NAIL & WASHER (TRAV)
102	13711374.09	2135136.11	AVENUE B	19+97.39	77.81' RT	658.12	SET MAG NAIL & WASHER (TRAV)
200	13710421.15	2134933.98	NEWELL AVE	—	—	663.15	SET MAG NAIL & WASHER (TRAV)
201	13710718.92	2134869.73	AVENUE B	12+94.61	16.63' LT	664.00	SET MAG NAIL & WASHER (TRAV)
202	13711604.32	2135132.48	AVENUE B	22+16.28	6.36' RT	657.83	SET MAG NAIL & WASHER (TRAV)
203	13711937.68	2135274.99	AVENUE B	25+76.85	44.09' RT	660.91	SET MAG NAIL & WASHER (TRAV)

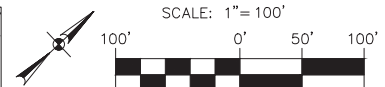

This document is released
for INTERIM REVIEW
purposes ONLY under
the authorization of
Thomas Matthew Carter,
P.E. #79272 on
3/3/2017
This document is not
to be used for
CONSTRUCTION.

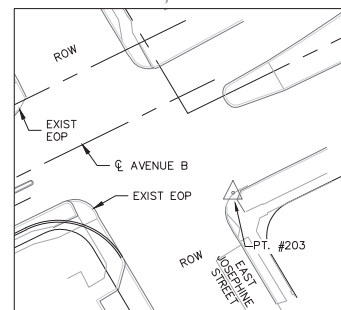
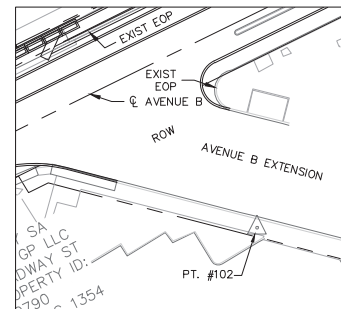
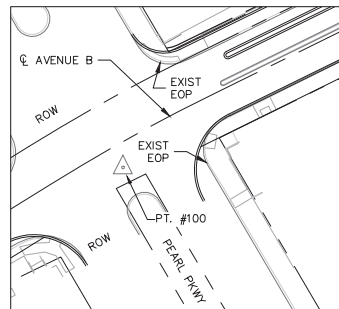
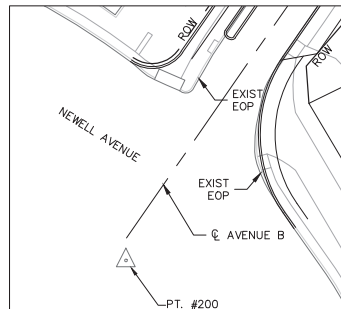
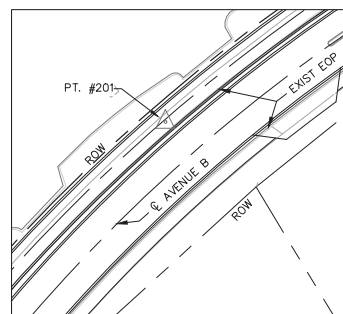

**PAPE-DAWSON
ENGINEERS**

SAN ANTONIO | AUSTIN | HOUSTON | FORT WORTH | DALLAS
2000 NW LOOP 410 | SAN ANTONIO, TX 78213 | 210.375.9000
TYPE FIRM REGISTRATION #470 | TBPLS FIRM REGISTRATION #10028800



CITY OF SAN ANTONIO
TRANSPORTATION & CAPITAL IMPROVEMENTS

AVENUE B IMPROVEMENTS PROJECT LAYOUT

30 % SUBMITTAL	PROJECT NO.: 5576-05	DATE: 03/03/2017
DRWN BY: JS	DRGN BY: DLS	CHKD BY:
		SHEET NO.: 3