



PARKS & RECREATION
SAN ANTONIO

LEON VISTA TRAILHEAD PARKING EXPANSION PROJECT

City Council
September 7, 2017
Parks and Recreation Department

ACTION

- **Contract with Industrial Construction Company to construct the Leon Vista Trailhead Parking Expansion Project**
- **Construction Contract Amount – \$179,942.10**
- **Low Qualified Bid process**
- **Lowest bidder was deemed non-responsive**



LEON VISTA TRAILHEAD PARKING EXPANSION PROJECT

- Leon Vista Trailhead (8561 Rochelle St.)
- Connects to Leon Creek between Mainland Trailhead and OP Schnabel Park
- Adds 28 Parking Spaces
- Includes Low-Impact Development features
- Council District 7

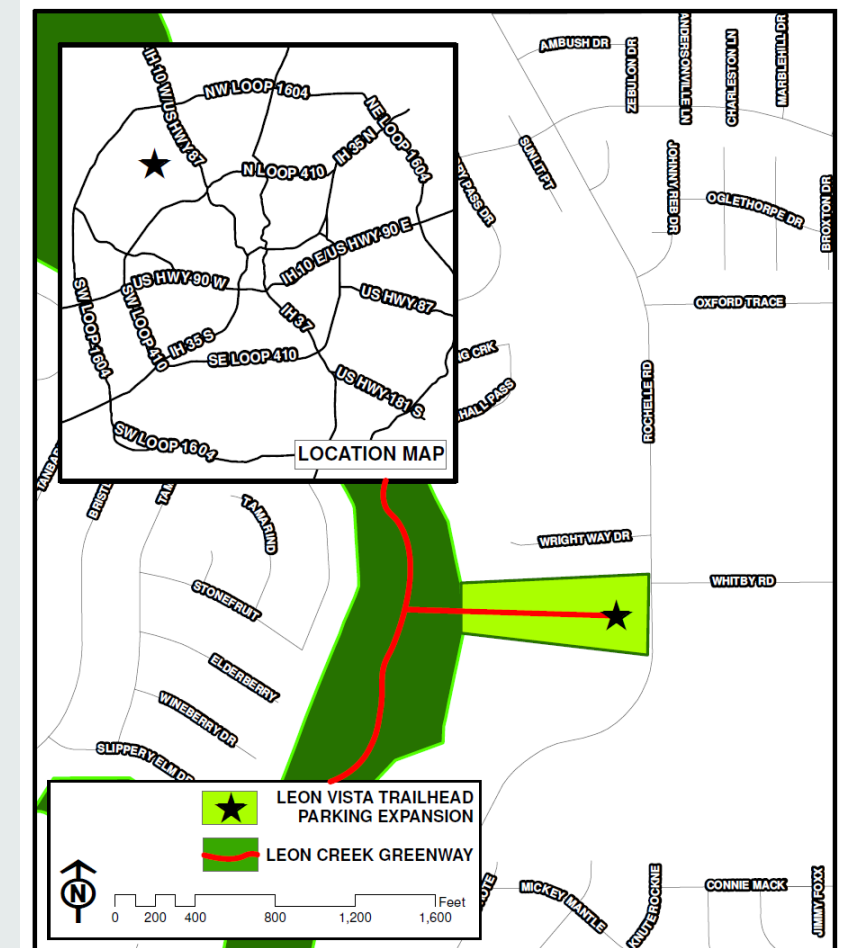

EXISTING TRAILHEAD



PARKING EXPANSION LAYOUT

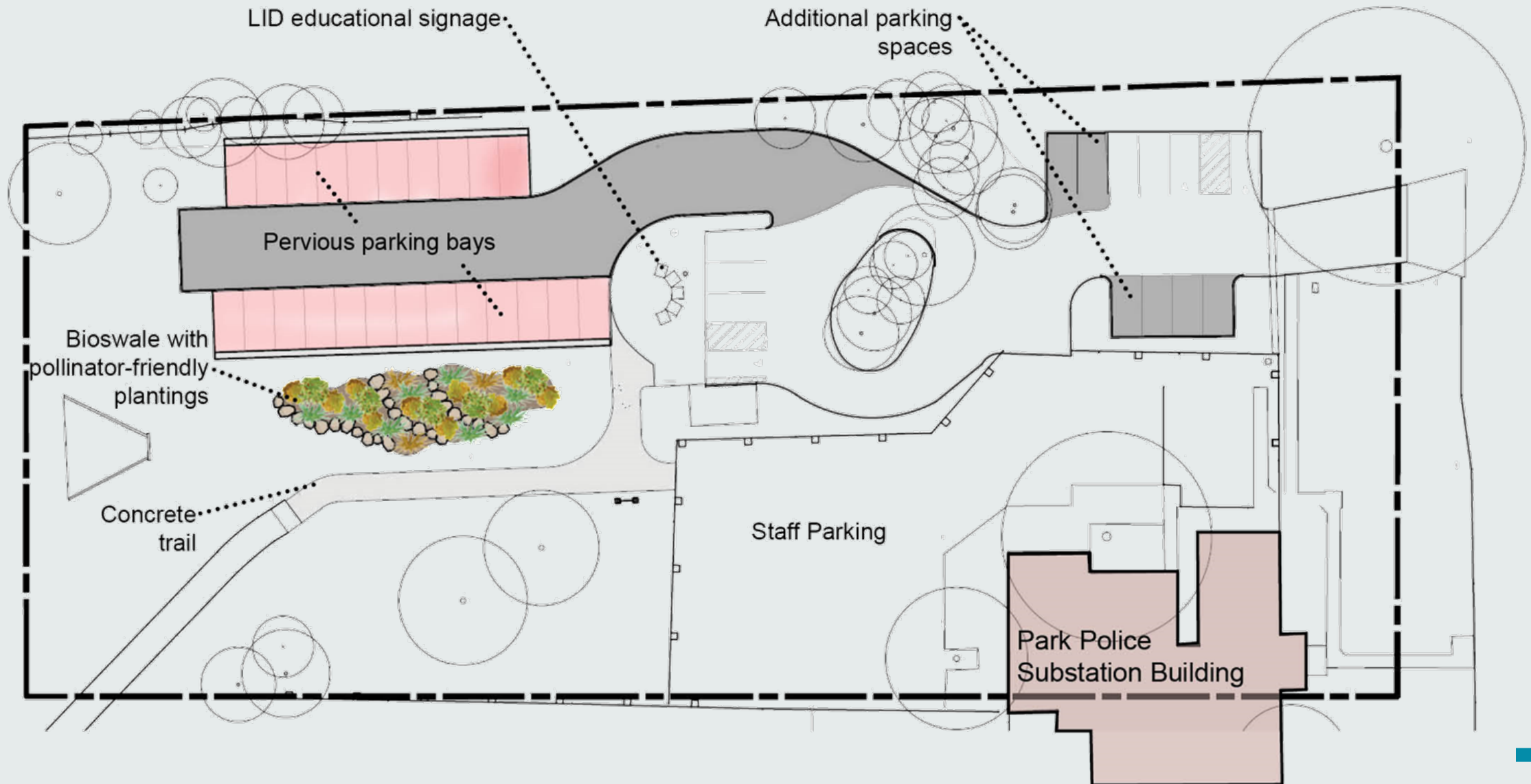

PROPOSED LOW IMPACT DEVELOPMENT FEATURES

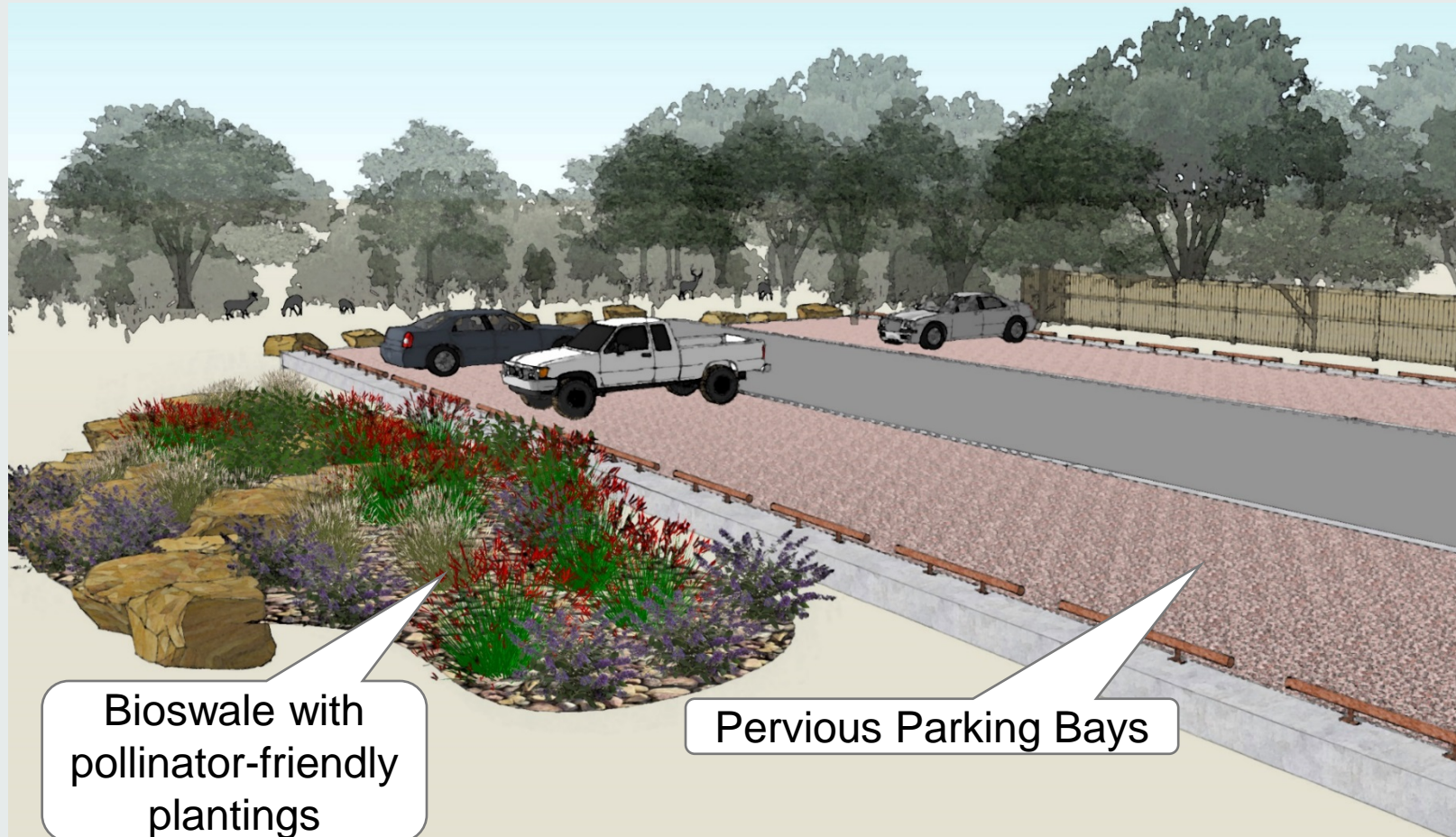

RECOMMENDATION

- Staff recommends approval

