



**Board of Adjustment**  
**Notification Plan for**  
**Case No A-18-113**



- San Antonio City Limits
- Subject Property
- 200' Notification Boundary
- Council District: 9



"NOT TO SCALE,  
 FOR ILLUSTRATIVE PURPOSES ONLY"  
 Development Services Department  
 City of San Antonio



6/30/2017 9:31 AM

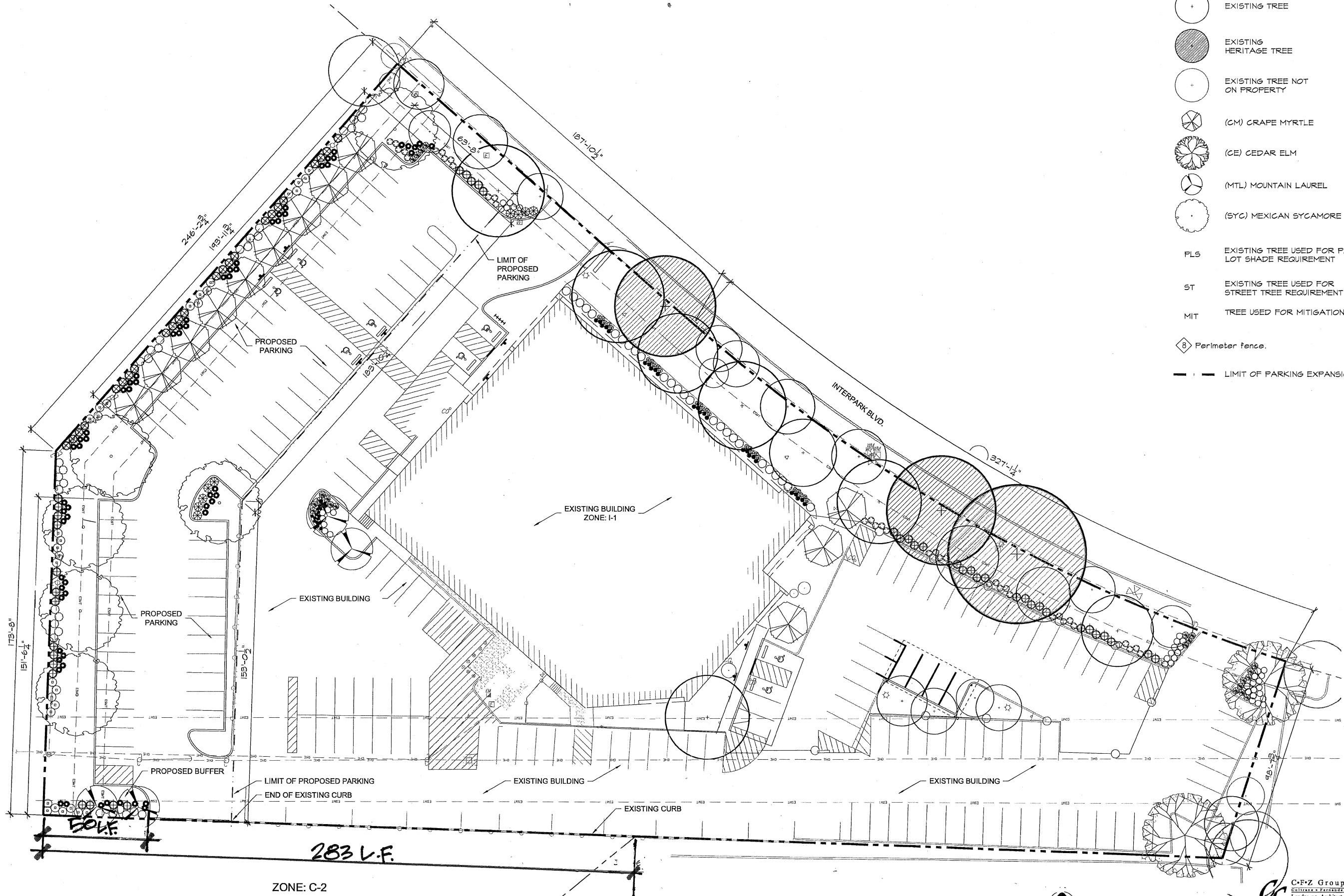

#### LEGEND

- EXISTING TREE
- EXISTING HERITAGE TREE
- EXISTING TREE NOT ON PROPERTY
- (CM) GRAPE MYRTLE
- (CE) CEDAR ELM
- (MTL) MOUNTAIN LAUREL
- (SYC) MEXICAN SYCAMORE
- PLS EXISTING TREE USED FOR PARKING LOT SHADE REQUIREMENT
- ST EXISTING TREE USED FOR STREET TREE REQUIREMENT
- MIT TREE USED FOR MITIGATION
- Perimeter fence.
- LIMIT OF PARKING EXPANSION



237 W. Travis Ste. 201  
San Antonio, TX 78205  
1.210.734.4448  
1.210.734.4909  
www.lopezsalas.com

Project No. 17-1097  
Date: 10/11/2017



The above seal indicates only that I have reviewed the consultants work and have coordinated it with the overall project.

REVISION DATE

BEXAR COUNTY  
**JUSTICE COURT, PRECINCT 3**  
320 Interpark Blvd, San Antonio, TX 78231

#### TREE PLAN

The record copy of this drawing is on file at the offices of Lopez Salas Architects, Inc., 237 W. Travis Ste. 201, San Antonio, Texas 78205. This document is released for the purpose of reference, coordination, and/or facility management under the authority of the named professional, registration number and date on the seal affixed above.

L4.0

C-F-Z Group LLC  
7410 John Smith Drive, Suite 208  
San Antonio, Texas 78229  
210-366-1911/210-366-0044 fax  
5317-1097DWGSL2-PLANTING.DWG  
© 2014 Lopez Salas Architects, Inc.

**A-18-113**  
**Subject Property – 320 Interpark Boulevard**



**Subject Property (south)**





**Bufferyard Request (southwest corner)**



**Bufferyard Request Along South Property Line (east)**





**Bufferyard Request Along South Property Line (west)**



**Streetscape Interpark Boulevard (west)**



**Streetscape Interpark Boulevard (east)**

