

BLANK

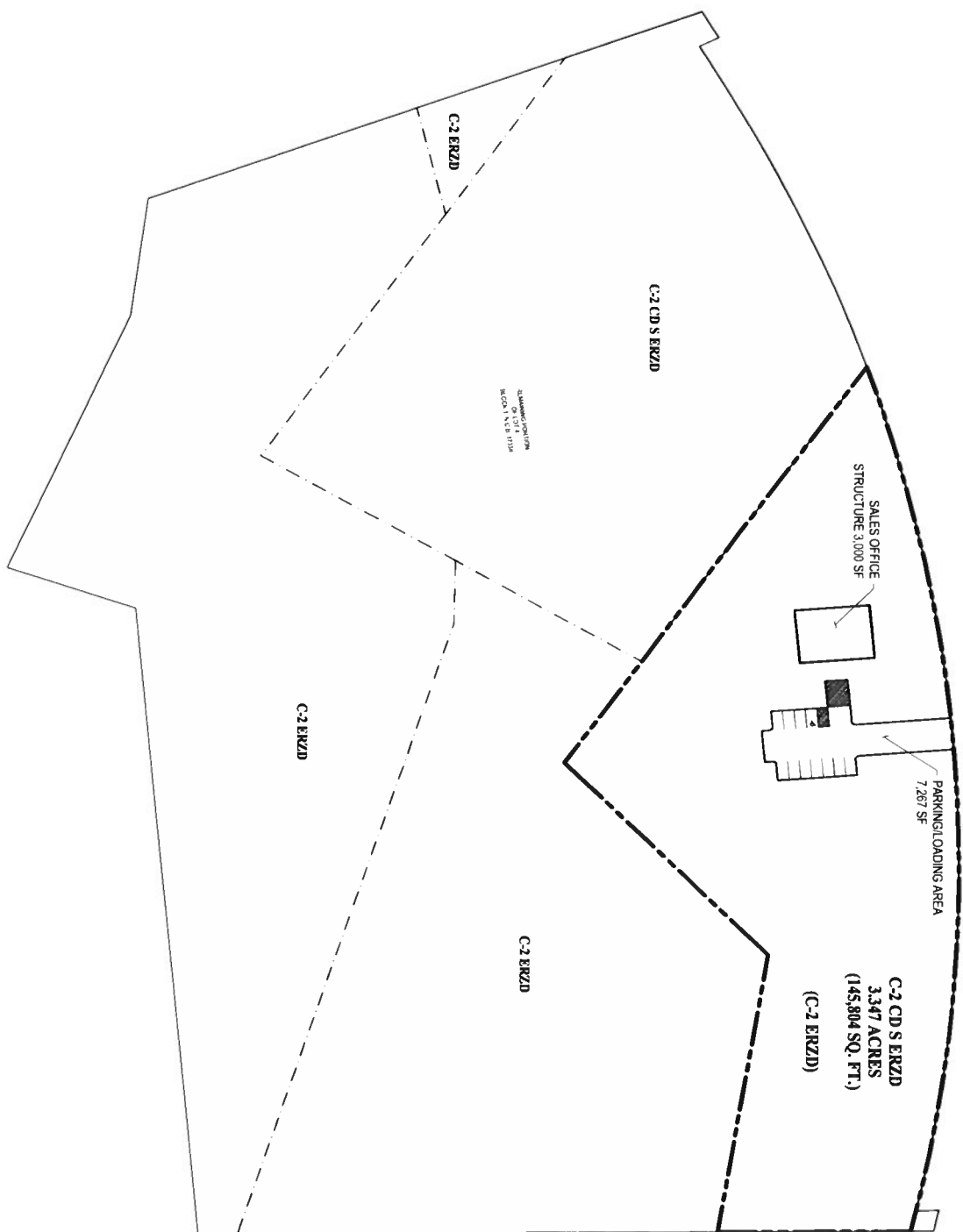

- PROPERTY: 3.347 ACRES (145,804 SF)
- LEGAL DESCRIPTION: REMAINING PORTION OF LOT 4 BLOCK 1 NCB 17338
- CURRENT ZONING: C-2 ERZD
- PROPOSED ZONING: C-2 CD S ERZD
- ON 3.347 ACRES (145,804 SF)
- IMPERVIOUS COVER: UP TO 94.77%
- SETBACKS/BUFFERVARDS: PER CONDITIONS
- REQUIRED PARKING: 1/300 GFA

I, JABLAB, LLC, c/o John Bellinger, the property owner, acknowledge that this site plan submitted for the purpose of rezoning this property is in accordance with all applicable provisions of the Unified Development Code. Additionally, I understand that City Council approval of a site plan in conjunction with a rezoning case does not relieve me from adherence to any/all City adopted Codes at the time of plan submittal for zoning permits.

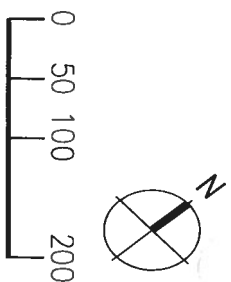

LPA



**ZONING EXHIBIT OF**

A 3.347 ACRE (145,804 SQUARE FEET) TRACT, OUT OF THE REMAINDER LOT 4, BLOCK 1, NEW CITY BLOCK 17338, BETHESDA TEMPLE SUBDIVISION, VOLUME 9351, PAGE 202, DEED AND PLAT RECORDS BECHAR COUNTY, TEXAS

Job No. 1806511  
Date 10/12/2018  
Created By  
Scale 1" = 100'

**ZONING EXHIBIT**