

DISCLAIMER:
I, HUMZA CHOWDHRY, CEO, DREAM ESTATES LLC., THE PROPERTY OWNER, ACKNOWLEDGE THAT THIS SITE PLAN SUBMITTED FOR THE PURPOSE OF REZONING IS IN ACCORDANCE WITH ALL APPLICABLE PROVISIONS OF THE UNIFIED DEVELOPMENT CODE. ADDITIONALLY, I UNDERSTAND THAT CITY COUNCIL APPROVAL OF A SITE PLAN IN CONJUNCTION WITH A REZONING CASE DOES NOT RELIEVE ME FROM ADHERENCE TO ANY/ALL CITY ADOPTED CODES AT THE TIME OF PLAN SUBMITTAL FOR BUILDING PERMITS.

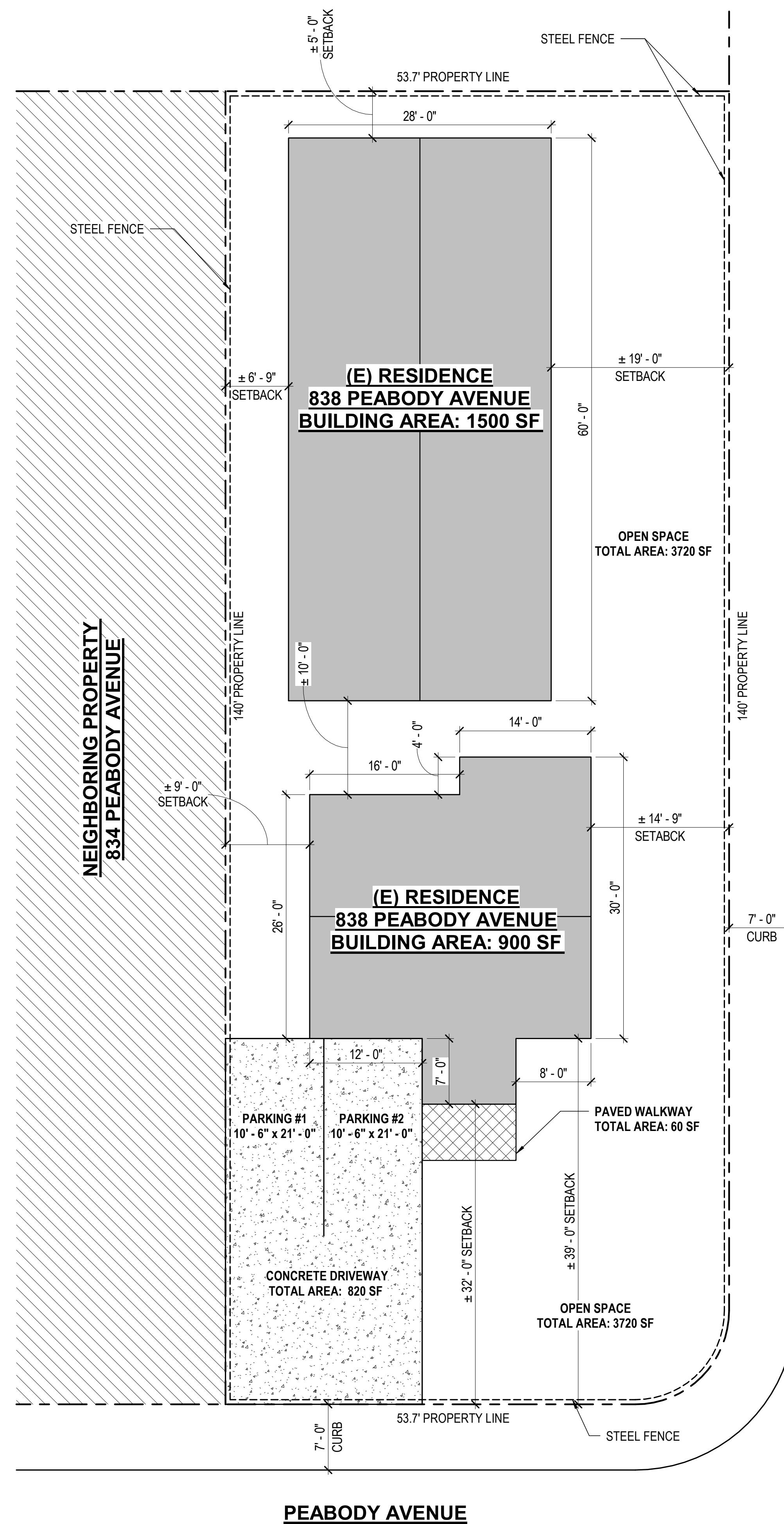

Z2019-10700018 CD



OWNER INFORMATION:
OWNER NAME: DREAM ESTATES LLC.
OWNER ID: 3102949
LOT SIZE: 7000 SF

PROPERTY INFORMATION:
PROPERTY ID: 426043
GEOGRAPHIC ID: 08926-037-0100
LOT SIZE: 7000 SF
ZONING: R-6

SPINDLE AVE

NOTE:
ALL SITE DIMENSIONS ARE APPROXIMATE AND
BASED ON CITY OF SAN ANTONIO ASSESSOR MAP



THESE PLANS ARE THE PROPERTY OF HC STRUCTURAL
ENGINEERING, INC. FOR THE EXPRESS USE ON THIS
PROJECT. ANY REPRODUCTION OR USE OF THIS
DRAWINGS OR ANY OF ITS DETAILS WITHOUT WRITTEN
CONSENT OF HC STRUCTURAL ENGINEERING, INC. IS A
VIOLATION OF COPYRIGHT LAW AND THE VIOLATOR MAY
BE SUBJECT TO PROSECUTION IN A COURT OF LAW.

Consultant
Address
Address
Phone
Fax
e-mail

Consultant
Address
Address
Phone
Fax
e-mail

Consultant
Address
Address
Phone
Fax
e-mail

APPROVAL STAMP

[illegible]

DREAM ESTATES, LLC.

838 PEABODY AVENUE, SAN ANTONIO, TX 78211

SITE PLAN

| | |
|----------------|------------|
| Project number | 2019-07 |
| Date | 01-14-2019 |
| Drawn by | HV |
| Checked by | HSC |

A0.0

Scale $1/8" = 1'-0"$

11/16/2019 12:49:15 PM