

**METES AND BOUNDS DESCRIPTION
FOR A 0.532 ACRE SEGMENT OF BURNET STREET**

Being a 0.532 of an acre segment of Burnet Street located in the City of San Antonio, Bexar County, Texas, said 0.532 of an acre road segment being more particularly described as follows:

BEGINNING at a 1/2" iron pin (with cap stamped "HMT") set at the intersection of the North right-of-way line of Burnet Street and the West right-of-way line of North Olive Street for the Northeast corner of the herein described road segment, same being the Southeast corner of Lockwood Park, New City Block 562;

THENCE with the West right-of-way line of North Olive Street, S 00°18'47" E a distance of 55.60 feet to a mag nail set in a sidewalk for the Northeast corner of Dignowity Park, New City Block 562;

THENCE departing the West right-of-way line of North Olive Street, with the South line of Burnet Street and the North line of said Dignowity Park, S 89°42'41" W a distance of 416.98 feet to a mag nail set in a sidewalk in the East right-of-way line of North Hackberry Street for the Northwest corner of said Dignowity Park;

THENCE with the East right-of-way line of North Hackberry Street, N 00°00'56" W a distance of 55.60 feet to a 1/2" iron pin (with cap stamped "HMT") set for the Southwest corner of said Lockwood Park;

THENCE departing the East right-of-way line of North Hackberry Street, with the North line of Burnet Street and the South line of said Lockwood Park, N 89°42'41" E a distance of 416.69 feet to the POINT OF BEGINNING and containing a 0.532 of an acre segment of Burnet Street in Bexar County, Texas.

Bearings shown hereon are based on the Texas Coordinate System, South Central Zone (4204), NAD 83.

Field Work dated April 2, 2018, Written this the 20th day of December, 2018.

Reference survey of said 0.532 of an acre road segment prepared this same date.



Dorothy J. Taylor

Registered Professional Land Surveyor No. 6295

S:\Projects\141 - TBG Partners\002 - Dignowity-Lockwood Park\road closure m&b.docx

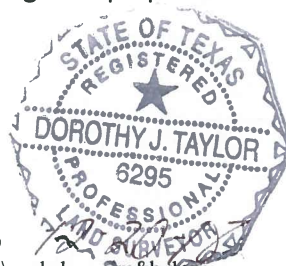

12-20-18