

# HISTORIC AND DESIGN REVIEW COMMISSION

August 07, 2019

**HDRC CASE NO:** 2019-426  
**ADDRESS:** 229 W HOLLYWOOD AVE  
**LEGAL DESCRIPTION:** NCB 6459 BLK 10 LOT 7, 8 & W 12.5 FT OF 9  
**ZONING:** R-5,H  
**CITY COUNCIL DIST.:** 1  
**DISTRICT:** Monte Vista Historic District  
**APPLICANT:** Matt Murray/Pella Windows  
**OWNER:** MURRAY KATHRYN A  
**TYPE OF WORK:** Window replacement  
**APPLICATION RECEIVED:** July 19, 2019  
**60-DAY REVIEW:** September 17, 2019  
**CASE MANAGER:** Stephanie Phillips  
**REQUEST:**

The applicant is requesting a Certificate of Appropriateness for approval to:

1. Replace five multi-lite wood casement windows on the front façade with new Pella Architect series aluminum clad wood windows to match size and configuration.
2. Replace all remaining wood casement windows on the side and rear facades with new Pella Architect series one over one, double hung aluminum clad wood windows.

## APPLICABLE CITATIONS:

*Historic Design Guidelines, Chapter 2, Exterior Maintenance and Alterations*

### 6. Architectural Features: Doors, Windows, and Screens

#### A. MAINTENANCE (PRESERVATION)

- i. *Openings*—Preserve existing window and door openings. Avoid enlarging or diminishing to fit stock sizes or air conditioning units. Avoid filling in historic door or window openings. Avoid creating new primary entrances or window openings on the primary façade or where visible from the public right-of-way.
- ii. *Doors*—Preserve historic doors including hardware, fanlights, sidelights, pilasters, and entablatures.
- iii. *Windows*—Preserve historic windows. When glass is broken, the color and clarity of replacement glass should match the original historic glass.
- iv. *Screens and shutters*—Preserve historic window screens and shutters.
- v. *Storm windows*—Install full-view storm windows on the interior of windows for improved energy efficiency. Storm window may be installed on the exterior so long as the visual impact is minimal and original architectural details are not obscured.

#### B. ALTERATIONS (REHABILITATION, RESTORATION, AND RECONSTRUCTION)

- i. *Doors*—Replace doors, hardware, fanlight, sidelights, pilasters, and entablatures in-kind when possible and when deteriorated beyond repair. When in-kind replacement is not feasible, ensure features match the size, material, and profile of the historic element.
- ii. *New entrances*—Ensure that new entrances, when necessary to comply with other regulations, are compatible in size, scale, shape, proportion, material, and massing with historic entrances.
- iii. *Glazed area*—Avoid installing interior floors or suspended ceilings that block the glazed area of historic windows.
- iv. *Window design*—Install new windows to match the historic or existing windows in terms of size, type, configuration, material, form, appearance, and detail when original windows are deteriorated beyond repair.
- v. *Muntins*—Use the exterior muntin pattern, profile, and size appropriate for the historic building when replacement windows are necessary. Do not use internal muntins sandwiched between layers of glass.
- vi. *Replacement glass*—Use clear glass when replacement glass is necessary. Do not use tinted glass, reflective glass, opaque glass, and other non-traditional glass types unless it was used historically. When established by the architectural style of the building, patterned, leaded, or colored glass can be used.
- vii. *Non-historic windows*—Replace non-historic incompatible windows with windows that are typical of the architectural

style of the building.

viii. *Security bars*—Install security bars only on the interior of windows and doors.

ix. *Screens*—Utilize wood screen window frames matching in profile, size, and design of those historically found when the existing screens are deteriorated beyond repair. Ensure that the tint of replacement screens closely matches the original screens or those used historically.

x. *Shutters*—Incorporate shutters only where they existed historically and where appropriate to the architectural style of the house. Shutters should match the height and width of the opening and be mounted to be operational or appear to be operational. Do not mount shutters directly onto any historic wall material.

## **FINDINGS:**

- a. The primary structure located 229 W Hollywood is a 1-story single family home constructed circa 1925 in the Spanish Eclectic style. The home features a cross gable configuration, barrel tile roof, stucco facade, asymmetrical porch with wooden columns, and a prominent side chimney clad in stucco. The structure is contributing to the Monte Vista Historic District.
- b. EXISTING WINDOWS: CONDITION – The applicant provided several photographs of the existing windows taken from outside the structure. All of the windows feature exterior wood casement windows and interior casement screens. Four out of the five windows on the front façade are covered by the front porch, and several windows on the west elevation are covered by non-original awnings. Based on the photographic evidence provided, staff finds that the windows are in good condition and are fully repairable.
- c. EXISTING WINDOWS: FUNCTIONALITY AND EFFICIENCY – Regarding efficiency, in most cases, windows only account for a fraction of heat gain/loss in a house. Improving the energy efficiency of historic windows should be considered only after other options have been explored such as improving attic and wall insulation. The original windows feature single-pane glass which is subject to radiant heat transfer. Products are available to reduce heat transfer such as window films, interior storm windows, and thermal shades. Additionally, air infiltration can be mitigated through weatherstripping or readjusting the window assembly within the frame, as assemblies can settle or shift over time. In most cases, windows may also be retrofitted with new glass. Additionally, windows that have been painted shut over time can be cut and freed for functionality. The applicant has also noted that the windows on the west façade are unable to swing open due to the non-original awnings. The removal of these awnings is eligible for administrative approval. In general, staff encourages the repair of historic wood windows. A wood window that is maintained over time can last for decades. Replacement window products have a much shorter lifespan and cannot be repaired once they fail.
- d. WINDOW REPLACEMENT: CASEMENTS – The applicant has requested to replace five multi-lite casement windows on the front façade with new multi-lite aluminum clad wood casements to match the existing in size, proportion, and configuration. According to the Guidelines for Exterior Maintenance and Alterations 6.A.iii., and 6.B.iv., in kind replacement of windows is only appropriate when the original windows are beyond repair. As noted in finding b, staff does not find the windows to be beyond repair. Replacement of any kind is not consistent with the Guidelines.
- e. WINDOW REPLACEMENT: CASEMENT TO ONE OVER ONE – According to the Guidelines for Exterior Maintenance and Alterations 6.A.iii., and 6.B.iv., in kind replacement of windows is only appropriate when the original windows are beyond repair, and replacement windows should match existing in style, configuration, proportion, and detail. As noted in finding b, staff does not find the windows to be beyond repair based on the evidence provided. Replacement of any kind is not consistent with the Guidelines, especially the removal of character defining window configurations, such as casement windows.

## **RECOMMENDATION:**

Items 1 and 2, Staff does not recommend approval of the window replacement based on findings a through d. Staff recommends that the applicant repair the remaining existing wood windows in place. If there are assemblies that are deteriorated beyond repair, the applicant must submit evidence to that effect to staff in the form of an updated window schedule and photographs.

If an assembly is deemed deteriorated beyond repair by HDRC based on the evidence provided, staff recommends that new windows meet the following stipulation:

- i. That the applicant installs fully wood windows with no cladding to match the existing configuration as closely as possible. One over one windows are not appropriate for this structure and the current proposed replacement product is not appropriate. Meeting rails must be no taller than 1.25" and stiles no wider than 2.25". The final window specification, along with a completed window replacement worksheet provided by OHP staff, must be submitted to staff for review and approval prior to the issuance of a Certificate of Appropriateness.



# City of San Antonio One Stop

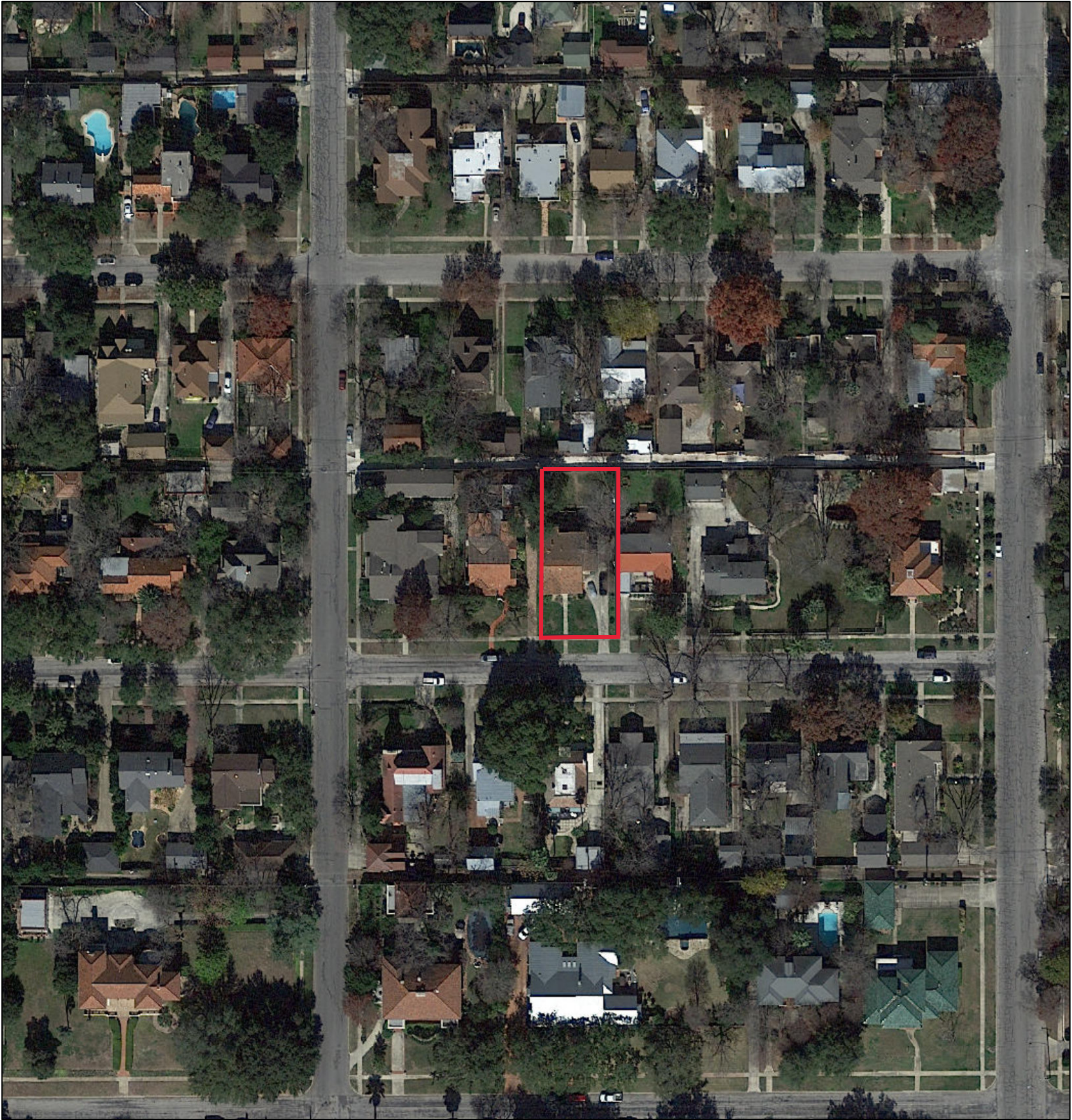

August 1, 2019

—— User drawn lines

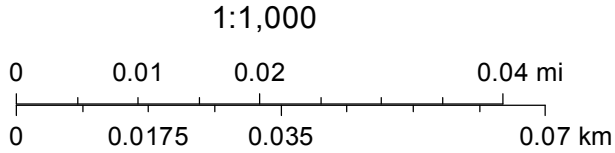





2251A























# Customer Approval Form:

Signature: \_\_\_\_\_ Date: \_\_\_\_\_

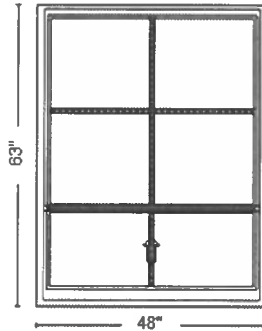

Viewed from the Exterior

**Quote Number:** 11591789

**Line Number:** 35

**Quote Qty:** 1

**Scaling:** 1/2" = 1'

**Description:** Architect Reserve, Single Hung, 48 X 63, Poplar White

**Rough Opening:** 48.75" X 63.75"

These drawings are based on our interpretation of the information provided to us. They are submitted for final approval of the individual\*\* responsible for the project and are not intended to create any warranty or other liability. The user\*\* is responsible for compliance with applicable building codes or other regulations and determining the suitability of the suggestions for the particular application, including the final design of reinforcement, flashing, and sealant systems for all window and door installations.

\*\* building owner, architect, contractor, installer and/or consumer



**Quote Name:** Clad Wood wondows

**Project Name:** Murray, Kathy

**Jobsite Location:** ,

**Room Location:** Front w Shutters

**Sales Branch Location:** 37000 Pella South Texas





## Proposal - Detailed

Pella Window and Door Showroom of San Antonio  
6510 Blanco Road  
San Antonio, TX 78216

**Sales Rep Name:** Murray, Matt  
**Sales Rep Phone:** 210-483-3319  
**Sales Rep E-Mail:** mmurray@pellasouthtexas.com  
**Sales Rep Fax:**

Customer Information	Project/Delivery Address	Order Information
<b>Kathy Murray</b> 229 W Hollywood Ave  San Antonio, TX 78212-2314 <b>Primary Phone:</b> (813) 407-9060 <b>Mobile Phone:</b> <b>Fax Number:</b> <b>E-Mail:</b> kathyemurray65@gmail.com <b>Contact Name:</b>  <b>Great Plains #:</b> 1005320295 <b>Customer Number:</b> 1009238504 <b>Customer Account:</b> 1005320295	<b>Murray, Kathy</b>  <b>Lot #</b> , <b>County:</b> <b>Owner Name:</b>  <b>Owner Phone:</b>	<b>Quote Name:</b> Clad Wood wondows  <b>Order Number:</b> 370 <b>Quote Number:</b> <b>11591789</b> <b>Order Type:</b> Non-Installed Sales <b>Wall Depth:</b> <b>Payment Terms:</b> <b>Tax Code:</b> SATGROUPTX <b>Cust Delivery Date:</b> None <b>Quoted Date:</b> 7/15/2019 <b>Contracted Date:</b> <b>Booked Date:</b> <b>Customer PO #:</b>
Line #	Location:	Attributes

10

Front side of house From Left to Right

Item Price	Qty	Ext'd Price
\$0.00	1	\$0.00



Line #	Location:	Attributes		
15	Front w Shutters	<div><div><div><div><div><div></div><div></div><div></div><div></div><div></div><div></div></div><div><div></div><div></div><div></div><div></div><div></div><div></div></div><div><div></div><div></div><div></div><div></div><div></div><div></div></div><div><div></div><div></div><div></div><div></div><div></div><div></div></div><div><div></div><div></div><div></div><div></div><div></div><div></div></div><div><div></div><div></div><div></div><div></div><div></div><div></div></div></div></div><div><div>63"</div><div>25"50"25"</div></div><div>Viewed From Exterior</div><div>Rough Opening: 50 - 3/4" X 63 - 3/4"</div></div><div><div>PK #</div><div>2040</div></div><div><div><div><div><div><div></div><div></div><div></div><div></div><div></div><div></div></div><div><div></div><div></div><div></div><div></div><div></div><div></div></div><div><div></div><div></div><div></div><div></div><div></div><div></div></div><div><div></div><div></div><div></div><div></div><div></div><div></div></div><div><div></div><div></div><div></div><div></div><div></div><div></div></div></div></div><div><div>63"</div><div>25"50"25"</div></div><div>Viewed From Exterior</div><div>Rough Opening: 50 - 3/4" X 63 - 3/4"</div></div><div><div>PK #</div><div>2040</div></div><div><div><div><div><div><div></div><div></div><div></div><div></div><div></div><div></div></div><div><div></div><div></div><div></div><div></div><div></div><div></div></div><div><div></div><div></div><div></div><div></div><div></div><div></div></div><div><div></div><div></div><div></div><div></div><div></div><div></div></div><div><div></div><div></div><div></div><div></div><div></div><div></div></div></div></div><div><div>63"</div><div>25"50"25"</div></div><div>Viewed From Exterior</div><div>Rough Opening: 50 - 3/4" X 63 - 3/4"</div></div><div><div>PK #</div><div>2040</div></div><div><div><div><div><div><div></div><div></div><div></div><div></div><div></div><div></div></div><div><div></div><div></div><div></div><div></div><div></div><div></div></div><div><div></div><div></div><div></div><div></div><div></div><div></div></div><div><div></div><div></div><div></div><div></div><div></div><div></div></div><div><div></div><div></div><div></div><div></div><div></div><div></div></div></div></div><div><div>63"</div><div>25"50"25"</div></div><div>Viewed From Exterior</div><div>Rough Opening: 50 - 3/4" X 63 - 3/4"</div></div><div><div>PK #</div><div>2040</div></div><div><div><div><div><div><div></div><div></div><div></div><div></div><div></div><div></div></div><div><div></div><div></div><div></div><div></div><div></div><div></div></div><div><div></div><div></div><div></div><div></div><div></div><div></div></div><div><div></div><div></div><div></div><div></div><div></div><div></div></div><div><div></div><div></div><div></div><div></div><div></div><div></div></div></div></div><div><div>63"</div><div>25"50"25"</div></div><div>Viewed From Exterior</div><div>Rough Opening: 50 - 3/4" X 63 - 3/4"</div></div><div><div>PK #</div><div>2040</div></div><div><div><div><div><div><div></div><div></div><div></div><div></div><div></div><div></div></div><div><div></div><div></div><div></div><div></div><div></div><div></div></div><div><div></div><div></div><div></div><div></div><div></div><div></div></div><div><div></div><div></div><div></div><div></div><div></div><div></div></div><div><div></div><div></div><div></div><div></div><div></div><div></div></div></div></div><div><div>63"</div><div>25"50"25"</div></div><div>Viewed From Exterior</div><div>Rough Opening: 50 - 3/4" X 63 - 3/4"</div></div><div><div>PK #</div><div>2040</div></div><div><div><div><div><div><div></div><div></div><div></div><div></div><div></div><div></div></div><div><div></div><div></div><div></div><div></div><div></div><div></div></div><div><div></div><div></div><div></div><div></div><div></div><div></div></div><div><div></div><div></div><div></div><div></div><div></div><div></div></div><div><div></div><div></div><div></div><div></div><div></div><div></div></div></div></div><div><div>63"</div><div>25"50"25"</div></div><div>Viewed From Exterior</div><div>Rough Opening: 50 - 3/4" X 63 - 3/4"</div></div><div><div>PK #</div><div>2040</div></div><div><div><div><div><div><div></div><div></div><div></div><div></div><div></div><div></div></div><div><div></div><div></div><div></div><div></div><div></div><div></div></div><div><div></div><div></div><div></div><div></div><div></div><div></div></div><div><div></div><div></div><div></div><div></div><div></div><div></div></div><div><div></div><div></div><div></div><div></div><div></div><div></div></div></div></div><div><div>63"</div><div>25"50"25"</div></div><div>Viewed From Exterior</div><div>Rough Opening: 50 - 3/4" X 63 - 3/4"</div></div><div><div>PK #</div><div>2040</div></div><div><div><div><div><div><div></div><div></div><div></div><div></div><div></div><div></div></div><div><div></div><div></div><div></div><div></div><div></div><div></div></div><div><div></div><div></div><div></div><div></div><div></div><div></div></div><div><div></div><div></div><div></div><div></div><div></div><div></div></div><div><div></div><div></div><div></div><div></div><div></div><div></div></div></div></div><div><div>63"</div><div>25"50"25"</div></div><div>Viewed From Exterior</div><div>Rough Opening: 50 - 3/4" X 63 - 3/4"</div></div><div><div>PK #</div><div>2040</div></div><div><div><div><div><div><div></div><div></div><div></div><div></div><div></div><div></div></div><div><div></div><div></div><div></div><div></div><div></div><div></div></div><div><div></div><div></div><div></div><div></div><div></div><div></div></div><div><div></div><div></div><div></div><div></div><div></div><div></div></div><div><div></div><div></div><div></div><div></div><div></div><div></div></div></div></div><div><div>63"</div><div>25"50"25"</div></div><div>Viewed From Exterior</div><div>Rough Opening: 50 - 3/4" X 63 - 3/4"</div></div><div><div>PK #</div><div>2040</div></div><div><div><div><div><div><div></div><div></div><div></div><div></div><div></div><div></div></div><div><div></div><div></div><div></div><div></div><div></div><div></div></div><div><div></div><div></div><div></div><div></div><div></div><div></div></div><div><div></div><div></div><div></div><div></div><div></div><div></div></div><div><div></div><div></div><div></div><div></div><div></div><div></div></div></div></div><div><div>63"</div><div>25"50"25"</div></div><div>Viewed From Exterior</div><div>Rough Opening: 50 - 3/4" X 63 - 3/4"</div></div><div><div>PK #</div><div>2040</div></div><div><div><div><div><div><div></div><div></div><div></div><div></div><div></div><div></div></div><div><div></div><div></div><div></div><div></div><div></div><div></div></div><div><div></div><div></div><div></div><div></div><div></div><div></div></div><div><div></div><div></div><div></div><div></div><div></div><div></div></div><div><div></div><div></div><div></div><div></div><div></div><div></div></div></div></div><div><div>63"</div><div>25"50"25"</div></div><div>Viewed From Exterior</div><div>Rough Opening: 50 - 3/4" X 63 - 3/4"</div></div><div><div>PK #</div><div>2040</div></div><div><div><div><div><div><div></div><div></div><div></div><div></div><div></div><div></div></div><div><div></div><div></div><div></div><div></div><div></div><div></div></div><div><div></div><div></div><div></div><div></div><div></div><div></div></div><div><div></div><div></div><div></div><div></div><div></div><div></div></div><div><div></div><div></div><div></div><div></div><div></div><div></div></div></div></div><div><div>63"</div><div>25"50"25"</div></div><div>Viewed From Exterior</div><div>Rough Opening: 50 - 3/4" X 63 - 3/4"</div></div><div><div>PK #</div><div>2040</div></div><div><div><div><div><div><div></div><div></div><div></div><div></div><div></div><div></div></div><div><div></div><div></div><div></div><div></div><div></div><div></div></div><div><div></div><div></div><div></div><div></div><div></div><div></div></div><div><div></div><div></div><div></div><div></div><div></div><div></div></div><div><div></div><div></div><div></div><div></div><div></div><div></div></div></div></div><div><div>63"</div><div>25"50"25"</div></div><div>Viewed From Exterior</div><div>Rough Opening: 50 - 3/4" X 63 - 3/4"</div></div><div><div>PK #</div><div>2040</div></div><div><div><div><div><div><div></div><div></div><div></div><div></div><div></div><div></div></div><div><div></div><div></div><div></div><div></div><div></div><div></div></div><div><div></div><div></div><div></div><div></div><div></div><div></div></div><div><div></div><div></div><div></div><div></div><div></div><div></div></div><div><div></div><div></div><div></div><div></div><div></div><div></div></div></div></div><div><div>63"</div><div>25"50"25"</div></div><div>Viewed From Exterior</div><div>Rough Opening: 50 - 3/4" X 63 - 3/4"</div></div><div><div>PK #</div><div>2040</div></div><div><div><div><div><div><div></div><div></div><div></div><div></div><div></div><div></div></div><div><div></div><div></div><div></div><div></div><div></div><div></div></div><div><div></div><div></div><div></div><div></div><div></div><div></div></div><div><div></div><div></div><div></div><div></div><div></div><div></div></div><div><div></div><div></div><div></div><div></div><div></div><div></div></div></div></div><div><div>63"</div><div>25"50"25"</div></div><div>Viewed From Exterior</div><div>Rough Opening: 50 - 3/4" X 63 - 3/4"</div></div><div><div>PK #</div><div>2040</div></div><div><div><div><div><div><div></div><div></div><div></div><div></div><div></div><div></div></div><div><div></div><div></div><div></div><div></div><div></div><div></div></div><div><div></div><div></div><div></div><div></div><div></div><div></div></div><div><div></div><div></div><div></div><div></div><div></div><div></div></div><div><div></div><div></div><div></div><div></div><div></div><div></div></div></div></div><div><div>63"</div><div>25"50"25"</div></div><div>Viewed From Exterior</div><div>Rough Opening: 50 - 3/4" X 63 - 3/4"</div></div><div><div>PK #</div><div>2040</div></div><div><div><div><div><div><div></div><div></div><div></div><div></div><div></div><div></div></div><div><div></div><div></div><div></div><div></div><div></div><div></div></div><div><div></div><div></div><div></div><div></div><div></div><div></div></div><div><div></div><div></div><div></div><div></div><div></div><div></div></div><div><div></div><div></div><div></div><div></div><div></div><div></div></div></div></div><div><div>63"</div><div>25"50"25"</div></div><div>Viewed From Exterior</div><div>Rough Opening: 50 - 3/4" X 63 - 3/4"</div></div><div><div>PK #</div><div>2040</div></div><div><div><div><div><div><div></div><div></div><div></div><div></div><div></div><div></div></div><div><div></div><div></div><div></div><div></div><div></div><div></div></div><div><div></div><div></div><div></div><div></div><div></div><div></div></div><div><div></div><div></div><div></div><div></div><div></div><div></div></div><div><div></div><div></div><div></div><div></div><div></div><div></div></div></div></div><div><div>63"</div><div>25"50"25"</div></div><div>Viewed From Exterior</div><div>Rough Opening: 50 - 3/4" X 63 - 3/4"</div></div><div><div>PK #</div><div>2040</div></div><div><div><div><div><div><div></div><div></div><div></div><div></div><div></div><div></div></div><div><div></div><div></div><div></div><div></div><div></div><div></div></div><div><div></div><div></div><div></div><div></div><div></div><div></div></div><div><div></div><div></div><div></div><div></div><div></div><div></div></div><div><div></div><div></div><div></div><div></div><div></div><div></div></div></div></div><div><div>63"</div><div>25"50"25"</div></div><div>Viewed From Exterior</div><div>Rough Opening: 50 - 3/4" X 63 - 3/4"</div></div><div><div>PK #</div><div>2040</div></div><div><div><div><div><div><div></div><div></div><div></div><div></div><div></div><div></div></div><div><div></div><div></div><div></div><div></div><div></div><div></div></div><div><div></div><div></div><div></div><div></div><div></div><div></div></div><div><div></div><div></div><div></div><div></div><div></div><div></div></div><div><div></div><div></div><div></div><div></div><div></div><div></div></div></div></div><div><div>63"</div><div>25"50"25"</div></div><div>Viewed From Exterior</div><div>Rough Opening: 50 - 3/4" X 63 - 3/4"</div></div><div><div>PK #</div><div>2040</div></div><div><div><div><div><div><div></div><div></div><div></div><div></div><div></div><div></div></div><div><div></div><div></div><div></div><div></div><div></div><div></div></div><div><div></div><div></div><div></div><div></div><div></div><div></div></div><div><div></div><div></div><div></div><div></div><div></div><div></div></div><div><div></div><div></div><div></div><div></div><div></div><div></div></div></div></div><div><div>63"</div><div>25"50"25"</div></div><div>Viewed From Exterior</div><div>Rough Opening: 50 - 3/4" X 63 - 3/4"</div></div><div><div>PK #</div><div>2040</div></div><div><div><div><div><div><div></div><div></div><div></div><div></div><div></div><div></div></div><div><div></div><div></div><div></div><div></div><div></div><div></div></div><div><div></div><div></div><div></div><div></div><div></div><div></div></div><div><div></div><div></div><div></div><div></div><div></div><div></div></div><div><div></div><div></div><div></div><div></div><div></div><div></div></div></div></div><div><div>63"</div><div>25"50"25"</div></div><div>Viewed From Exterior</div><div>Rough Opening: 50 - 3/4" X 63 - 3/4"</div></div><div><div>PK #</div><div>2040</div></div><div><div><div><div><div><div></div><div></div><div></div><div></div><div></div><div></div></div><div><div></div><div></div><div></div><div></div><div></div><div></div></div><div><div></div><div></div><div></div><div></div><div></div><div></div></div><div><div></div><div></div><div></div><div></div><div></div><div></div></div><div><div></div><div></div><div></div><div></div><div></div><div></div></div></div></div><div><div>63"</div><div>25"50"25"</div></div><div>Viewed From Exterior</div><div>Rough Opening: 50 - 3/4" X 63 - 3/4"</div></div><div><div>PK #</div><div>2040</div></div><div><div><div><div><div><div></div><div></div><div></div><div></div><div></div><div></div></div><div><div></div><div></div><div></div><div></div><div></div><div></div></div><div><div></div><div></div><div></div><div></div><div></div><div></div></div><div><div></div><div></div><div></div><div></div><div></div><div></div></div><div><div></div><div></div><div></div><div></div><div></div><div></div></div></div></div><div><div>63"</div><div>25"50"25"</div></div><div>Viewed From Exterior</div><div>Rough Opening: 50 - 3/4" X 63 - 3/4"</div></div><div><div>PK #</div><div>2040</div></div><div><div><div><div><div><div></div><div></div><div></div><div></div><div></div><div></div></div><div><div></div><div></div><div></div><div></div><div></div><div></div></div><div><div></div><div></div><div></div><div></div><div></div><div></div></div><div><div></div><div></div><div></div><div></div><div></div><div></div></div><div><div></div><div></div><div></div><div></div><div></div><div></div></div></div></div><div><div>63"</div><div>25"50"25"</div></div><div>Viewed From Exterior</div><div>Rough Opening: 50 - 3/4" X 63 - 3/4"</div></div><div><div>PK #</div><div>2040</div></div><div><div><div><div><div><div></div><div></div><div></div><div></div><div></div><div></div></div><div><div></div><div></div><div></div><div></div><div></div><div></div></div><div><div></div><div></div><div></div><div></div><div></div><div></div></div><div><div></div><div></div><div></div><div></div><div></div><div></div></div><div><div></div><div></div><div></div><div></div><div></div><div></div></div></div></div><div><div>63"</div><div>25"50"25"</div></div><div>Viewed From Exterior</div><div>Rough Opening: 50 - 3/4" X 63 - 3/4"</div></div><div><div>PK #</div><div>2040</div></div><div><div><div><div><div><div></div><div></div><div></div><div></div><div></div><div></div></div><div><div></div><div></div><div></div><div></div><div></div><div></div></div><div><div></div><div></div><div></div><div></div><div></div><div></div></div><div><div></div><div></div><div></div><div></div><div></div><div></div></div><div><div></div><div></div><div></div><div></div><div></div><div></div></div></div></div><div><div>63"</div><div>25"50"25"</div></div><div>Viewed From Exterior</div><div>Rough Opening: 50 - 3/4" X 63 - 3/4"</div></div><div><div>PK #</div><div>2040</div></div><div><div><div><div><div><div></div><div></div><div></div><div></div><div></div><div></div></div><div><div></div><div></div><div></div><div></div><div></div><div></div></div><div><div></div><div></div><div></div><div></div><div></div><div></div></div><div><div></div><div></div><div></div><div></div><div></div><div></div></div><div><div></div><div></div><div></div><div></div><div></div><div></div></div></div></div><div><div>63"</div><div>25"50"25"</div></div><div>Viewed From Exterior</div><div>Rough Opening: 50 - 3/4" X 63 - 3/4"</div></div><div><div>PK #</div><div>2040</div></div><div><div><div><div><div><div></div><div></div><div></div><div></div><div></div><div></div></div><div><div></div><div></div><div></div><div></div><div></div><div></div></div><div><div></div><div></div><div></div><div></div><div></div><div></div></div><div><div></div><div></div><div></div><div></div><div></div><div></div></div><div><div></div><div></div><div></div><div></div><div></div><div></div></div></div></div><div><div>63"</div><div>25"50"25"</div></div><div>Viewed From Exterior</div><div>Rough Opening: 50 - 3/4" X 63 - 3/4"</div></div><div><div>PK #</div><div>2040</div></div><div><div><div><div><div><div></div><div></div><div></div><div></div><div></div><div></div></div><div><div></div><div></div><div></div><div></div><div></div><div></div></div><div><div></div><div></div><div></div><div></div><div></div><div></div></div><div><div></div><div></div><div></div><div></div><div></div><div></div></div><div><div></div><div></div><div></div><div></div><div></div><div></div></div></div></div><div><div>63"</div><div>25"50"25"</div></div><div>Viewed From Exterior</div><div>Rough Opening: 50 - 3/4" X 63 - 3/4"</div></div><div><div>PK #</div><div>2040</div></div><div><div><div><div><div><div></div><div></div><div></div><div></div><div></div><div></div></div><div><div></div><div></div><div></div><div></div><div></div><div></div></div><div><div></div><div></div><div></div><div></div><div></div><div></div></div><div><div></div><div></div><div></div><div></div><div></div><div></div></div><div><div></div><div></div><div></div><div></div><div></div><div></div></div></div></div><div><div>63"</div><div>25"50"25"</div></div><div>Viewed From Exterior</div><div>Rough Opening: 50 - 3/4" X 63 - 3/4"</div></div><div><div>PK #</div><div>2040</div></div><div><div><div><div><div><div></div><div></div><div></div><div></div><div></div><div></div></div><div><div></div><div></div><div></div><div></div><div></div><div></div></div><div><div></div><div></div><div></div><div></div><div></div><div></div></div><div><div></div><div></div><div></div><div></div><div></div><div></div></div><div><div></div><div></div><div></div><div></div><div></div><div></div></div></div></div><div><div>63"</div><div>25"50"25"</div></div><div>Viewed From Exterior</div><div>Rough Opening: 50 - 3/4" X 63 - 3/4"</div></div><div><div>PK #</div><div>2040</div></div><div><div><div><div><div><div></div><div></div><div></div><div></div><div></div><div></div></div><div><div></div><div></div><div></div><div></div><div></div><div></div></div><div><div></div><div></div><div></div><div></div><div></div><div></div></div><div><div></div><div></div><div></div><div></div><div></div><div></div></div><div><div></div><div></div><div></div><div></div><div></div><div></div></div></div></div><div><div>63"</div><div>25"50"25"</div></div><div>Viewed From Exterior</div><div>Rough Opening: 50 - 3/4" X 63 - 3/4"</div></div><div><div>PK #</div><div>2040</div></div><div><div><div><div><div><div></div><div></div><div></div><div></div><div></div><div></div></div><div><div></div><div></div><div></div><div></div><div></div><div></div></div><div><div></div><div></div><div></div><div></div><div></div><div></div></div><div><div></div><div></div><div></div><div></div><div></div><div></div></div><div><div></div><div></div><div></div><div></div><div></div><div></div></div></div></div><div><div>63"</div><div>25"50"25"</div></div><div>Viewed From Exterior</div><div>Rough Opening: 50 - 3/4" X 63 - 3/4"</div></div><div><div>PK #</div><div>2040</div></div><div><div><div><div><div><div></div><div></div><div></div><div></div><div></div><div></div></div><div><div></div><div></div><div></div><div></div><div></div><div></div></div><div><div></div><div></div><div></div><div></div><div></div><div></div></div><div><div></div><div></div><div></div><div></div><div></div><div></div></div><div><div></div><div></div><div></div><div></div><div></div><div></div></div></div></div><div><div>63"</div><div>25"50"25"</div></div><div>Viewed From Exterior</div><div>Rough Opening: 50 - 3/4" X 63 - 3/4"</div></div><div><div>PK #</div><div>2040</div></div><div><div><div><div><div><div></div><div></div><div></div><div></div><div></div><div></div></div><div><div></div><div></div><div></div><div></div><div></div><div></div></div><div><div></div><div></div><div></div><div></div><div></div><div></div></div><div><div></div><div></div><div></div><div></div><div></div><div></div></div><div><div></div><div></div><div></div><div></div><div></div><div></div></div></div></div><div><div>63"</div><div>25"50"25"</div></div><div>Viewed From Exterior</div><div>Rough Opening: 50 - 3/4" X 63 - 3/4"</div></div><div><div>PK #</div><div>2040</div></div><div><div><div><div><div><div></div><div></div><div></div><div></div><div></div><div></div></div><div><div></div><div></div><div></div><div></div><div></div><div></div></div><div><div></div><div></div><div></div><div></div><div></div><div></div></div><div><div></div><div></div><div></div><div></div><div></div><div></div></div><div><div></div><div></div><div></div><div></div><div></div><div></div></div></div></div><div><div>63"</div><div>25"50"25"</div></div><div>Viewed From Exterior</div><div>Rough Opening: 50 - 3/4" X 63 - 3/4"</div></div><div><div>PK #</div><div>2040</div></div><div><div><div><div><div><div></div><div></div><div></div><div></div><div></div><div></div></div><div><div></div><div></div><div></div><div></div><div></div><div></div></div><div><div></div><div></div><div></div><div></div><div></div><div></div></div><div><div></div><div></div><div></div><div></div><div></div><div></div></div><div><div></div><div></div><div></div><div></div><div></div><div></div></div></div></div><div><div>63"</div><div>25"50"25"</div></div><div>Viewed From Exterior</div><div>Rough Opening: 50 - 3/4" X 63 - 3/4"</div></div><div><div>PK #</div><div>2040</div></div><div><div><div><div><div><div></div><div></div><div></div><div></div><div></div><div></div></div><div><div></div><div></div><div></div><div></div><div></div><div></div></div><div><div></div><div></div><div></div><div></div><div></div><div></div></div><div><div></div><div></div><div></div><div></div><div></div><div></div></div><div><div></div><div></div><div></div><div></div><div></div><div></div></div></div></div><div><div>63"</div><div>25"50"25"</div></div><div>Viewed From Exterior</div><div>Rough Opening: 50 - 3/4" X 63 - 3/4"</div></div><div><div>PK #</div><div>2040</div></div><div><div><div><div><div><div></div><div></div><div></div><div></div><div></div><div></div></div><div><div></div><div></div><div></div><div></div><div></div><div></div></div><div><div></div><div></div><div></div><div></div><div></div><div></div></div><div><div></div><div></div><div></div><div></div><div></div><div></div></div><div><div></div><div></div><div></div><div></div><div></div><div></div></div></div></div><div><div>63"</div><div>25"50"25"</div></div><div>Viewed From Exterior</div><div>Rough Opening: 50 - 3/4" X 63 - 3/4"</div></div><div><div>PK #</div><div>2040</div></div><div><div><div><div><div><div></div><div></div><div></div><div></div><div></div><div></div></div><div><div></div><div></div><div></div><div></div><div></div><div></div></div><div><div></div><div></div><div></div><div></div><div></div><div></div></div><div><div></div><div></div><div></div><div></div><div></div><div></div></div><div><div></div><div></div><div></div><div></div><div></div><div></div></div></div></div><div><div>63"</div><div>25"50"25"</div></div><div>Viewed From Exterior</div><div>Rough Opening: 50 - 3/4" X 63 - 3/4"</div></div><div><div>PK #</div><div>2040</div></div><div><div><div><div><div><div></div><div></div><div></div><div></div><div></div><div></div></div><div><div></div><div></div><div></div><div></div><div></div><div></div></div><div><div></div><div></div><div></div><div></div><div></div><div></div></div><div><div></div><div></div><div></div><div></div><div></div><div></div></div><div><div></div><div></div><div></div><div></div><div></div><div></div></div></div></div><div><div>63"</div><div>25"50"25"</div></div><div>Viewed From Exterior</div><div>Rough Opening: 50 - 3/4" X 63 - 3/4"</div></div><div><div>PK #</div><div>2040</div></div><div><div><div><div><div><div></div><div></div><div></div><div></div><div></div><div></div></div><div><div></div><div></div><div></div><div></div><div></div><div></div></div><div><div></div><div></div><div></div><div></div><div></div><div></div></div><div><div></div><div></div><div></div><div></div><div></div><div></div></div><div><div></div><div></div><div></div><div></div><div></div><div></div></div></div></div><div><div>63"</div><div>25"50"25"</div></div><div>Viewed From Exterior</div><div>Rough Opening: 50 - 3/4" X 63 - 3/4"</div></div><div><div>PK #</div><div>2040</div></div><div><div><div><div><div><div></div><div></div><div></div><div></div><div></div><div></div></div><div><div></div><div></div><div></div><div></div><div></div><div></div></div><div><div></div><div></div><div></div><div></div><div></div><div></div></div><div><div></div><div></div><div></div><div></div><div></div><div></div></div><div><div></div><div></div><div></div><div></div><div></div><div></div></div></div></div><div><div>63"</div><div>25"50"25"</div></div><div>Viewed From Exterior</div><div>Rough Opening: 50 - 3/4" X 63 - 3/4"</div></div><div><div>PK #</div><div>2040</div></div><div><div><div><div><div><div></div><div></div><div></div><div></div><div></div><div></div></div><div><div></div><div></div><div></div><div></div><div></div><div></div></div><div><div></div><div></div><div></div><div></div><div></div><div></div></div><div><div></div><div></div><div></div><div></div><div></div><div></div></div><div><div></div><div></div><div></div><div></div><div></div><div></div></div></div></div><div><div>63"</div><div>25"50"25"</div></div><div>Viewed From Exterior</div><div>Rough Opening: 50 - 3/4" X 63 - 3/4"</div></div><div><div>PK #</div><div>2040</div></div><div><div><div><div><div><div></div><div></div><div></div><div></div><div></div><div></div></div><div><div></div><div></div><div></div><div></div><div></div><div></div></div><div><div></div><div></div><div></div><div></div><div></div><div></div></div><div><div></div><div></div><div></div><div></div><div></div><div></div></div><div><div></div><div></div><div></div><div></div><div></div><div></div></div></div></div><div><div>63"</div><div>25"50"25"</div></div><div>Viewed From Exterior</div><div>Rough Opening: 50 - 3/4" X 63 - 3/4"</div></div><div><div>PK #</div><div>2040</div></div><div><div><div><div><div><div></div><div></div><div></div><div></div><div></div><div></div></div><div><div></div><div></div><div></div><div></div><div></div><div></div></div><div><div></div><div></div><div></div><div></div><div></div><div></div></div><div><div></div><div></div><div></div><div></div><div></div><div></div></div><div><div></div><div></div><div></div><div></div><div></div><div></div></div></div></div><div><div>63"</div><div>25"50"25"</div></div><div>Viewed From Exterior</div><div>Rough Opening: 50 - 3/4" X 63 - 3/4"</div></div><div><div>PK #</div><div>2040</div></div><div><div><div><div><div><div></div><div></div><div></div><div></div><div></div><div></div></div><div><div></div><div></div><div></div><div></div><div></div><div></div></div><div><div></div><div></div><div></div><div></div><div></div><div></div></div><div><div></div><div></div><div></div><div></div><div></div><div></div></div><div><div></div><div></div><div></div><div></div><div></div><div></div></div></div></div><div><div>63"</div><div>25"50"25"</div></div><div>Viewed From Exterior</div><div>Rough Opening: 50 - 3/4" X 63 - 3/4"</div></div><div><div>PK #</div><div>2040</div></div><div><div><div><div><div><div></div><div></div><div></div><div></div><div></div><div></div></div><div><div></div><div></div><div></div><div></div><div></div><div></div></div><div><div></div><div></div><div></div><div></div><div></div><div></div></div><div><div></div><div></div><div></div><div></div><div></div><div></div></div><div><div></div><div></div><div></div><div></div><div></div><div></div></div></div></div><div><div>63"</div><div>25"50"25"</div></div><div>Viewed From Exterior</div><div>Rough Opening: 50 - 3/4" X 63 - 3/4"</div></div><div><div>PK #</div><div>2040</div></div><div><div><div><div><div><div></div><div></div><div></div><div></div><div></div><div></div></div><div><div></div><div></div><div></div><div></div><div></div><div></div></div><div><div></div><div></div><div></div><div></div><div></div><div></div></div><div><div></div><div></div><div></div><div></div><div></div><div></div></div><div><div></div><div></div><div></div><div></div><div></div><div></div></div></div></div><div><div>63"</div><div>25"50"25"</div></div><div>Viewed From Exterior</div><div>Rough Opening: 50 - 3/4" X 63 - 3/4"</div></div><div><div>PK #</div><div>2040</div></div><div><div><div><div><div><div></div><div></div><div></div><div></div><div></div><div></div></div><div><div></div><div></div><div></div><div></div><div></div><div></div></div><div><div></div><div></div><div></div><div></div><div></div><div></div></div><div><div></div><div></div><div></div><div></div><div></div><div></div></div><div><div></div><div></div><div></div><div></div><div></div><div></div></div></div></div><div><div>63"</div><div>25"50"25"</div></div><div>Viewed From Exterior</div><div>Rough Opening: 50 - 3/4" X 63 - 3/4"</div></div><div><div>PK #</div><div>2040</div></div><div><div><div><div><div><div></div><div></div><div></div><div></div><div></div><div></div></div><div><div></div><div></div><div></div><div></div><div></div><div></div></div><div><div></div><div></div><div></div><div></div><div></div><div></div></div><div><div></div><div></div><div></div><div></div><div></div><div></div></div><div><div></div><div></div><div></div><div></div><div></div><div></div></div></div></div><div><div>63"</div><div>25"50"25"</div></div><div>Viewed From Exterior</div><div>Rough Opening: 5</div></div></div></div></div></div></div></div></div></div></div></div></div></div></div></div></div></div></div></div></div></div></div></div></div></div></div></div></div></div></div></div></div></div></div></div></div></div></div></div></div></div></div></div></div></div></div></div></div></div></div></div></div></div></div>		

Tip to Tip Exterior Trim Opening:  
52 3/8" x 66 1/8"

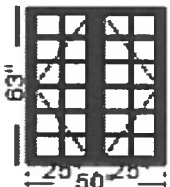

Line #	Location:	Attributes			Item Price	Qty	Ext'd Price
20	None Assigned	<b>Lifestyle, 2-Wide Casement, 50 X 63, Brick Red</b>			\$2,314.60	1	\$2,314.60
 <p>Viewed From Exterior</p> <p><b>Rough Opening: 50 - 3/4" X 63 - 3/4"</b></p>		PK #	<p><b>1: Non-Standard Size Left Casement</b>  <b>Frame Size:</b> 25 X 63  <b>General Information:</b> No Package, Without Hinged Glass Panel, Clad, Pine, 5", 3 11/16"  <b>Exterior Color / Finish:</b> Standard Enduraclad, Brick Red  <b>Interior Color / Finish:</b> Provincial Stain Interior  <b>Glass:</b> Insulated Low-E SunDefense™ Low-E Insulating Glass Argon Non High Altitude  <b>Hardware Options:</b> Wash Hinge Hardware, Fold-Away Crank, Matte Black, No Limited Opening Hardware, No Integrated Sensor  <b>Screen:</b> Full Screen, Black, Vivid View®  <b>Performance Information:</b> U-Factor 0.29, SHGC 0.19, VLT 0.43, CPD PEL-N-14-00518-00001, Performance Class LC, PG 40, Calculated Positive DP Rating 40, Calculated Negative DP Rating 40, TDI WIN-2174, Year Rated 08 11, Egress Does not meet typical United States egress, but may comply with local code requirements  <b>Grille:</b> SDL w/Spacer, No Custom Grille, 7/8", Traditional (2W6H)  <b>Vertical Mull 1:</b> FactoryMull, Standard Joining Mullion, Mull Design Pressure- 20</p> <p><b>2: Non-Standard Size Right Casement</b>  <b>Frame Size:</b> 25 X 63  <b>General Information:</b> No Package, Without Hinged Glass Panel, Clad, Pine, 5", 3 11/16"  <b>Exterior Color / Finish:</b> Standard Enduraclad, Brick Red  <b>Interior Color / Finish:</b> Provincial Stain Interior  <b>Glass:</b> Insulated Low-E SunDefense™ Low-E Insulating Glass Argon Non High Altitude  <b>Hardware Options:</b> Wash Hinge Hardware, Fold-Away Crank, Matte Black, No Limited Opening Hardware, No Integrated Sensor  <b>Screen:</b> Full Screen, Black, Vivid View®  <b>Performance Information:</b> U-Factor 0.29, SHGC 0.19, VLT 0.43, CPD PEL-N-14-00518-00001, Performance Class LC, PG 40, Calculated Positive DP Rating 40, Calculated Negative DP Rating 40, TDI WIN-2174, Year Rated 08 11, Egress Does not meet typical United States egress, but may comply with local code requirements  <b>Grille:</b> SDL w/Spacer, No Custom Grille, 7/8", Traditional (2W6H)  <b>Wrapping Information:</b> EnduraClad® Exterior Trim, Full Frame Replacement, Factory Applied, Brickmould, 1" Sill Nose, Brickmould, Brickmould, Factory Applied, Brick Red, 4 13/16", 6 1/8", Standard Four Sided Jamb Extension, Factory Applied, Pella Recommended Clearance, Perimeter Length = 226".</p>				

**Tip to Tip Exterior Trim Opening:**  
**52 3/8" x 66 1/8"**



Line #	Location:	Attributes			
25	None Assigned	<div><div><div><div><div></div><div></div><div></div><div></div><div></div><div></div><div></div><div></div><div></div><div></div><div></div><div></div><div></div><div></div><div></div><div></div><div></div><div></div><div></div><div></div><div></div><div></div><div></div><div></div><div></div><div></div><div></div><div></div><div></div><div></div><div></div><div></div><div></div><div></div><div></div><div></div><div></div><div></div><div></div><div></div><div></div><div></div><div></div><div></div><div></div><div></div><div></div><div></div><div></div><div></div><div></div><div></div><div></div><div></div><div></div><div></div><div></div><div></div><div></div><div></div><div></div><div></div><div></div><div></div><div></div><div></div><div></div><div></div><div></div><div></div><div></div><div></div><div></div><div></div><div></div><div></div><div></div><div></div><div></div><div></div><div></div><div></div><div></div><div></div><div></div><div></div><div></div><div></div><div></div><div></div><div></div><div></div><div></div><div></div><div></div><div></div><div></div><div></div><div></div><div></div><div></div><div></div><div></div><div></div><div></div><div></div><div></div><div></div><div></div><div></div><div></div><div></div><div></div><div></div><div></div><div></div><div></div><div></div><div></div><div></div><div></div><div></div><div></div><div></div><div></div><div></div><div></div><div></div><div></div><div></div><div></div><div></div><div></div><div></div><div></div><div></div><div></div><div></div><div></div><div></div><div></div><div></div><div></div><div></div><div></div><div></div><div></div><div></div><div></div><div></div><div></div><div></div><div></div><div></div><div></div><div></div><div></div><div></div><div></div><div></div><div></div><div></div><div></div><div></div><div></div><div></div><div></div><div></div><div></div><div></div><div></div><div></div><div></div><div></div><div></div><div></div><div></div><div></div><div></div><div></div><div></div><div></div><div></div><div></div><div></div><div></div><div></div><div></div><div></div><div></div><div></div><div></div><div></div><div></div><div></div><div></div><div></div><div></div><div></div><div></div><div></div><div></div><div></div><div></div><div></div><div></div><div></div><div></div><div></div><div></div><div></div><div></div><div></div><div></div><div></div><div></div><div></div><div></div><div></div><div></div><div></div><div></div><div></div><div></div><div></div><div></div><div></div><div></div><div></div><div></div><div></div><div></div><div></div><div></div><div></div><div></div><div></div><div></div><div></div><div></div><div></div><div></div><div></div><div></div><div></div><div></div><div></div><div></div><div></div><div></div><div></div><div></div><div></div><div></div><div></div><div></div><div></div><div></div><div></div><div></div><div></div><div></div><div></div><div></div><div></div><div></div><div></div><div></div><div></div><div></div><div></div><div></div><div></div><div></div><div></div><div></div><div></div><div></div><div></div><div></div><div></div><div></div><div></div><div></div><div></div><div></div><div></div><div></div><div></div><div></div><div></div><div></div><div></div><div></div><div></div><div></div><div></div><div></div><div></div><div></div><div></div><div></div><div></div><div></div><div></div><div></div><div></div><div></div><div></div><div></div><div></div><div></div><div></div><div></div><div></div><div></div><div></div><div></div><div></div><div></div><div></div><div></div><div></div><div></div><div></div><div></div><div></div><div></div><div></div><div></div><div></div><div></div><div></div><div></div><div></div><div></div><div></div><div></div><div></div><div></div><div></div><div></div><div></div><div></div><div></div><div></div><div></div><div></div><div></div><div></div><div></div><div></div><div></div><div></div><div></div><div></div><div></div><div></div><div></div><div></div><div></div><div></div><div></div><div></div><div></div><div></div><div></div><div></div><div></div><div></div><div></div><div></div><div></div><div></div><div></div><div></div><div></div><div></div><div></div><div></div><div></div><div></div><div></div><div></div><div></div><div></div><div></div><div></div><div></div><div></div><div></div><div></div><div></div><div></div><div></div><div></div><div></div><div></div><div></div><div></div><div></div><div></div><div></div><div></div><div></div><div></div><div></div><div></div><div></div><div></div><div></div><div></div><div></div><div></div><div></div><div></div><div></div><div></div><div></div><div></div><div></div><div></div><div></div><div></div><div></div><div></div><div></div><div></div><div></div><div></div><div></div><div></div><div></div><div></div><div></div><div></div><div></div><div></div><div></div><div></div><div></div><div></div><div></div><div></div><div></div><div></div><div></div><div></div><div></div><div></div><div></div><div></div><div></div><div></div><div></div><div></div><div></div><div></div><div></div><div></div><div></div><div></div><div></div><div></div><div></div><div></div><div></div><div></div><div></div><div></div><div></div><div></div><div></div><div></div><div></div><div></div><div></div><div></div><div></div><div></div><div></div><div></div><div></div><div></div><div></div><div></div><div></div><div></div><div></div><div></div><div></div><div></div><div></div><div></div><div></div><div></div><div></div><div></div><div></div><div></div><div></div><div></div><div></div><div></div><div></div><div></div><div></div><div></div><div></div><div></div><div></div><div></div><div></div><div></div><div></div><div></div><div></div><div></div><div></div><div></div><div></div><div></div><div></div><div></div><div></div><div></div><div></div><div></div><div></div><div></div><div></div><div></div><div></div><div></div><div></div><div></div><div></div><div></div><div></div><div></div><div></div><div></div><div></div><div></div><div></div><div></div><div></div><div></div><div></div><div></div><div></div><div></div><div></div><div></div><div></div><div></div><div></div><div></div><div></div><div></div><div></div><div></div><div></div><div></div><div></div><div></div><div></div><div></div><div></div><div></div><div></div><div></div><div></div><div></div><div></div><div></div><div></div><div></div><div></div><div></div><div></div><div></div><div></div><div></div><div></div><div></div><div></div><div></div><div></div><div></div><div></div><div></div><div></div><div></div><div></div><div></div><div></div><div></div><div></div><div></div><div></div><div></div><div></div><div></div><div></div><div></div><div></div><div></div><div></div><div></div><div></div><div></div><div></div><div></div><div></div><div></div><div></div><div></div><div></div><div></div><div></div><div></div><div></div><div></div><div></div><div></div><div></div><div></div><div></div><div></div><div></div><div></div><div></div><div></div><div></div><div></div><div></div><div></div><div></div><div></div><div></div><div></div><div></div><div></div><div></div><div></div><div></div><div></div><div></div><div></div><div></div><div></div><div></div><div></div><div></div><div></div><div></div><div></div><div></div><div></div><div></div><div></div><div></div><div></div><div></div><div></div><div></div><div></div><div></div><div></div><div></div><div></div><div></div><div></div><div></div><div></div><div></div><div></div><div></div><div></div><div></div><div></div><div></div><div></div><div></div><div></div><div></div><div></div><div></div><div></div><div></div><div></div><div></div><div></div><div></div><div></div><div></div><div></div><div></div><div></div><div></div><div></div><div></div><div></div><div></div><div></div><div></div><div></div><div></div><div></div><div></div><div></div><div></div><div></div><div></div><div></div><div></div><div></div><div></div><div></div><div></div><div></div><div></div><div></div><div></div><div></div><div></div><div></div><div></div><div></div><div></div><div></div><div></div><div></div><div></div><div></div><div></div><div></div><div></div><div></div><div></div><div></div><div></div><div></div><div></div><div></div><div></div><div></div><div></div><div></div><div></div><div></div><div></div><div></div><div></div><div></div><div></div><div></div><div></div><div></div><div></div><div></div><div></div><div></div><div></div><div></div><div></div><div></div><div></div><div></div><div></div><div></div><div></div><div></div><div></div><div></div><div></div><div></div><div></div><div></div><div></div><div></div><div></div><div></div><div></div><div></div><div></div><div></div><div></div><div></div><div></div><div></div><div></div><div></div><div></div><div></div><div></div><div></div><div></div><div></div><div></div><div></div><div></div><div></div><div></div><div></div><div></div><div></div><div></div><div></div><div></div><div></div><div></div><div></div><div></div><div></div><div></div><div></div><div></div><div></div><div></div><div></div><div></div><div></div><div></div><div></div><div></div><div></div><div></div><div></div><div></div><div></div><div></div><div></div><div></div><div></div><div></div><div></div><div></div><div></div><div></div><div></div><div></div><div></div><div></div><div></div><div></div><div></div><div></div><div></div><div></div><div></div><div></div><div></div><div></div><div></div><div></div><div></div><div></div><div></div><div></div><div></div><div></div><div></div><div></div><div></div><div></div><div></div><div></div><div></div><div></div><div></div><div></div><div></div><div></div><div></div><div></div><div></div><div></div><div></div><div></div><div></div><div></div><div></div><div></div><div></div><div></div><div></div><div></div><div></div><div></div><div></div><div></div><div></div><div></div><div></div><div></div><div></div><div></div><div></div><div></div><div></div><div></div><div></div><div></div><div></div><div></div><div></div><div></div><div></div><div></div><div></div><div></div><div></div><div></div><div></div><div></div><div></div><div></div><div></div><div></div><div></div><div></div><div></div><div></div><div></div><div></div><div></div><div></div><div></div><div></div><div></div><div></div><div></div><div></div><div></div><div></div><div></div><div></div><div></div><div></div><div></div><div></div><div></div><div></div><div></div><div></div><div></div><div></div><div></div><div></div><div></div><div></div><div></div><div></div><div></div><div></div><div></div><div></div><div></div><div></div><div></div><div></div><div></div><div></div><div></div><div></div><div></div><div></div><div></div><div></div><div></div><div></div><div></div><div></div><div></div><div></div><div></div><div></div><div></div><div></div><div></div><div></div><div></div><div></div><div></div><div></div><div></div><div></div><div></div><div></div><div></div><div></div><div></div><div></div><div></div><div></div><div></div><div></div><div></div><div></div><div></div><div></div><div></div><div></div><div></div><div></div><div></div><div></div><div></div><div></div><div></div><div></div><div></div><div></div><div></div><div></div><div></div><div></div><div></div><div></div><div></div><div></div><div></div><div></div><div></div><div></div><div></div><div></div><div></div><div></div><div></div><div></div><div></div><div></div><div></div><div></div><div></div><div></div><div></div><div></div><div></div><div></div><div></div><div></div><div></div><div></div><div></div><div></div><div></div><div></div><div></div><div></div><div></div><div></div><div></div><div></div><div></div><div></div><div></div><div></div><div></div><div></div><div></div><div></div><div></div><div></div><div></div><div></div><div></div><div></div><div></div><div></div><div></div><div></div><div></div><div></div><div></div><div></div><div></div><div></div><div></div><div></div><div></div><div></div><div></div><div></div><div></div><div></div><div></div><div></div><div></div><div></div><div></div><div></div><div></div><div></div><div></div><div></div><div></div><div></div><div></div><div></div><div></div><div></div><div></div><div></div><div></div><div></div><div></div><div></div><div></div><div></div><div></div><div></div><div></div><div></div><div></div><div></div><div></div><div></div><div></div><div></div><div></div><div></div><div></div><div></div><div></div><div></div><div></div><div></div><div></div><div></div><div></div><div></div><div></div><div></div><div></div><div></div><div></div></div></div></div></div>			

**Tip to Tip Exterior Trim Opening:**  
**40 3/8" x 66 1/8"**



Line #	Location:	Attributes		
30	Front w Shutters	<b>Architect Reserve, 2-Wide Casement, 50 X 63, Poplar White</b>		
			<b>Item Price</b>	<b>Qty</b>
			\$2,146.89	1
				<b>Ext'd Price</b>
				\$2,146.89

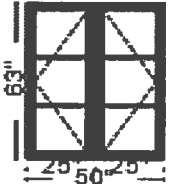

Viewed From Exterior

**Rough Opening:** 50 - 3/4" X 63 - 3/4"

**PK #**  
2040

**1: Non-Standard Size Left Casement**  
**Frame Size:** 25 X 63  
**General Information:** Standard, Clad, Pine, 5", 3 11/16"  
**Exterior Color / Finish:** Painted, Standard Enduraclad, Poplar White  
**Interior Color / Finish:** Provincial Stain Interior  
**Sash / Panel:** Putty Glaze, Ogee, Standard  
**Glass:** Insulated Dual Low-E SunDefense™ Low-E Insulating Glass Argon Non High Altitude  
**Hardware Options:** Wash Hinge Hardware, Fold-Away Crank, Matte Black, No Window Opening Control Device, No Limited Opening Hardware, No Integrated Sensor  
**Screen:** Full Screen, Black, Vivid View®  
**Performance Information:** U-Factor 0.28, SHGC 0.18, VLT 0.40, CPD PEL-N-11-21753-00002, Performance Class CW, PG 40, Calculated Positive DP Rating 40, Calculated Negative DP Rating 40, TDI WIN-1576, Year Rated 08, Egress Does not meet typical United States egress, but may comply with local code requirements  
**Grille:** ILT, No Custom Grille, 7/8", Traditional (1W3H), Putty Glaze, Ogee  
**Vertical Mull 1:** FactoryMull, Standard Joining Mullion, Frame To Frame Width- 0", Mull Design Pressure- 20

**2: Non-Standard Size Right Casement**  
**Frame Size:** 25 X 63  
**General Information:** Standard, Clad, Pine, 5", 3 11/16"  
**Exterior Color / Finish:** Painted, Standard Enduraclad, Poplar White  
**Interior Color / Finish:** Provincial Stain Interior  
**Sash / Panel:** Putty Glaze, Ogee, Standard  
**Glass:** Insulated Dual Low-E SunDefense™ Low-E Insulating Glass Argon Non High Altitude  
**Hardware Options:** Wash Hinge Hardware, Fold-Away Crank, Matte Black, No Window Opening Control Device, No Limited Opening Hardware, No Integrated Sensor  
**Screen:** Full Screen, Black, Vivid View®  
**Performance Information:** U-Factor 0.28, SHGC 0.18, VLT 0.40, CPD PEL-N-11-21753-00002, Performance Class CW, PG 40, Calculated Positive DP Rating 40, Calculated Negative DP Rating 40, TDI WIN-1576, Year Rated 08, Egress Does not meet typical United States egress, but may comply with local code requirements  
**Grille:** ILT, No Custom Grille, 7/8", Traditional (1W3H), Putty Glaze, Ogee  
**Wrapping Information:** EnduraClad® Exterior Trim, Full Frame Replacement, Factory Applied, Brickmould, 1" Sill Nose, Brickmould, Brickmould, Factory Applied, Cranberry, 4 13/16", 6 1/8", Standard Four Sided Jamb Extension, Factory Applied, Pella Recommended Clearance, Perimeter Length = 226".

**Tip to Tip Exterior Trim Opening:**  
**52 3/8" x 66 1/8"**

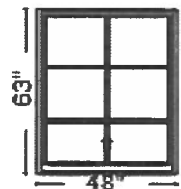

Line #	Location:	Attributes			
35	Front w Shutters	<b>Architect Reserve, Single Hung, 48 X 63, Poplar White</b>	<b>Item Price</b>	<b>Qty</b>	<b>Ext'd Price</b>
			\$1,663.26	1	\$1,663.26
	<div><div><p>Viewed From Exterior</p><p><b>Rough Opening:</b> 48 - 3/4" X 63 - 3/4"</p></div><div><p><b>PK #</b> 2040</p></div></div>	<p><b>1: Non-Standard Size Single Hung, Custom Split (21)</b> <b>Frame Size:</b> 48 X 63 <b>General Information:</b> Standard, Luxury, Clad, Pine, 5", 3 11/16" <b>Exterior Color / Finish:</b> Painted, Standard Enduraclad, Poplar White <b>Interior Color / Finish:</b> Provincial Stain Interior <b>Sash / Panel:</b> Putty Glaze, Ogee, Standard, No Sash Lugs <b>Glass:</b> Insulated Dual Low-E SunDefense™ Low-E Insulating Glass Argon Non High Altitude <b>Hardware Options:</b> Spoon-Style Lock, Matte Black, No Window Opening Control Device, No Limited Opening Hardware, Order Sash Lift, No Integrated Sensor <b>Screen:</b> Integrated Rolscreen® Lower Sash Only <b>Performance Information:</b> U-Factor 0.29, SHGC 0.19, VLT 0.43, CPD PEL-N-232-00307-00001, Performance Class CW, PG 45, Calculated Positive DP Rating 45, Calculated Negative DP Rating 45, TDI WIN-1090, Year Rated 08 11, Egress Does not meet typical United States egress, but may comply with local code requirements <b>Grille:</b> ILT, No Custom Grille, 7/8", Traditional (2W2H / 2W1H), Putty Glaze, Ogee <b>Wrapping Information:</b> EnduraClad® Exterior Trim, Full Frame Replacement, Factory Applied, Brickmould, 1" Sill Nose, Brickmould, Brickmould, Factory Applied, Cranberry, 4 13/16", 6 1/8", Standard Four Sided Jamb Extension, Factory Applied, Pella Recommended Clearance, Perimeter Length = 222".</p>			

**Tip to Tip Exterior Trim Opening:**  
50 3/8" x 66 1/8"

Line #	Location:	Attributes		
40	Front w Shutters	<div><div><div><div><div></div><div></div><div></div><div></div></div><div></div></div><div><div>63"</div><div>48"</div></div><div>Viewed From Exterior</div></div><div><div>PK #</div><div>2040</div></div><div><div>Rough Opening:</div><div>48 - 3/4" X 63 - 3/4"</div></div></div>	<div>Architect Reserve, Single Hung, 48 X 63, Poplar White</div> <div><div>1: Non-Standard Size Single Hung, Custom Split (21)</div><div>Frame Size: 48 X 63</div><div>General Information: Standard, Luxury, Clad, Pine, 5", 3 11/16"</div><div>Exterior Color / Finish: Painted, Standard Enduraclad, Poplar White</div><div>Interior Color / Finish: Provincial Stain Interior</div><div>Sash / Panel: Putty Glaze, Ogee, Standard, No Sash Lugs</div><div>Glass: Insulated Dual Low-E SunDefense™ Low-E Insulating Glass Argon Non High Altitude</div><div>Hardware Options: Spoon-Style Lock, Matte Black, No Window Opening Control Device, No Limited Opening Hardware, Order Sash Lift, No Integrated Sensor</div><div>Screen: Integrated Rolscreen® Lower Sash Only</div><div>Performance Information: U-Factor 0.29, SHGC 0.19, VLT 0.43, CPD PEL-N-232-00307-00001, Performance Class CW, PG 45, Calculated Positive DP Rating 45, Calculated Negative DP Rating 45, TDI WIN-1090, Year Rated 08 11, Egress Does not meet typical United States egress, but may comply with local code requirements</div><div>Grille: ILT, No Custom Grille, 7/8", Traditional (2W2H / 2W1H), Putty Glaze, Ogee</div><div>Wrapping Information: EnduraClad® Exterior Trim, Full Frame Replacement, Factory Applied, Brickmould, 1" Sill Nose, Brickmould, Brickmould, Factory Applied, Cranberry, 4 13/16", 6 1/8", Standard Four Sided Jamb Extension, Factory Applied, Pella Recommended Clearance, Perimeter Length = 222"</div></div> <div><div>Item Price</div><div>\$1,663.26</div></div> <div><div>Qty</div><div>1</div></div> <div><div>Ext'd Price</div><div>\$1,663.26</div></div>	

**Tip to Tip Exterior Trim Opening:**  
50 3/8" x 66 1/8"

## Thank You For Your Interest In Pella® Products

For more information regarding the finishing, maintenance, service and warranty of all Pella® products, visit the Pella® website at [www.pella.com](http://www.pella.com)







---

**PELLA WARRANTY:**

Pella products are covered by Pella's limited warranties in effect at the time of sale. All applicable product warranties are incorporated into and become a part of this contract. Please see the warranties for complete details, taking special note of the two important notice sections regarding installation of Pella products and proper management of moisture within the wall system. Neither Pella Corporation nor the Seller will be bound by any other warranty unless specifically set out in this contract. However, Pella Corporation will not be liable for branch warranties which create obligations in addition to or obligations which are inconsistent with Pella written warranties.

Clear opening (egress) information does not take into consideration the addition of a Rolscreen [or any other accessory] to the product. You should consult your local building code to ensure your Pella products meet local egress requirements.

Per the manufacturer's limited warranty, unfinished mahogany exterior windows and doors must be finished upon receipt prior to installing and refinished annually, thereafter. Variations in wood grain, color, texture or natural characteristics are not covered under the limited warranty.

INSYNCTIVE PRODUCTS: In addition, Pella Insynctive Products are covered by the Pella Insynctive Products Software License Agreement and Pella Insynctive Products Privacy Policy in effect at the time of sale, which can be found at [Insynctive.pella.com](http://Insynctive.pella.com). By installing or using Your Insynctive Products you are acknowledging the Insynctive Software Agreement and Privacy Policy are part of the terms of sale.

---

**ARBITRATION AND CLASS ACTION WAIVER ("ARBITRATION AGREEMENT")**

**YOU and Pella and its subsidiaries and the Pella Branded Distributor AGREE TO ARBITRATE DISPUTES ARISING OUT OF OR RELATING TO YOUR PELLA PRODUCTS (INCLUDES PELLA GOODS AND PELLA SERVICES) AND WAIVE THE RIGHT TO HAVE A COURT OR JURY DECIDE DISPUTES. YOU WAIVE ALL RIGHTS TO PROCEED AS A MEMBER OR REPRESENTATIVE OF A CLASS ACTION, INCLUDING CLASS ARBITRATION, REGARDING DISPUTES ARISING OUT OF OR RELATING TO YOUR PELLA PRODUCTS.** You may opt out of this Arbitration Agreement by providing notice to Pella no later than ninety (90) calendar days from the date You purchased or otherwise took ownership of Your Pella Goods. To opt out, You must send notice by e-mail to [pellawebsupport@pella.com](mailto:pellawebsupport@pella.com), with the subject line: "Arbitration Opt Out" or by calling (877) 473-5527. Opting out of the Arbitration Agreement will not affect the coverage provided by any applicable limited warranty pertaining to Your Pella Products. For complete information, including the full terms and conditions of this Arbitration Agreement, which are incorporated herein by reference, please visit [www.pella.com/arbitration](http://www.pella.com/arbitration) or e-mail to [pellawebsupport@pella.com](mailto:pellawebsupport@pella.com), with the subject line: "Arbitration Details" or call (877) 473-5527. D'ARBITRAGE ET RENONCIATION AU RECOURS COLLECTIF ("convention d'arbitrage") EN FRANÇAIS SEE [PELLA.COM/ARBITRATION](http://PELLA.COM/ARBITRATION). DE ARBITRAJE Y RENUNCIA COLECTIVA ("acuerdo de arbitraje") EN ESPAÑOL VER [PELLA.COM/ARBITRATION](http://PELLA.COM/ARBITRATION).

---

**Product Performance Information:**

U-Factor, Solar Heat Gain Coefficient (SHGC), and Visible Light Transmittance (VLT) are certified by the National Fenestration Rating Council (NFRC). Manufacturer stipulates that these ratings conform to applicable NFRC procedures for determining whole product performance. NFRC ratings are determined for a fixed set of environmental conditions and a specific product size. NFRC does not recommend any products and does not warrant the suitability of any product for any specific use.

Design Pressure (DP), Performance Class, and Performance Grade (PG) are certified by a third party organization, in many cases the Window and Door Manufacturers Association (WDMA). The certification requires the performance of at least one product of the product line to be tested in accordance with the applicable performance standards and verified by an independent party. The certification indicates that the product(s) of the product line passed the applicable tests. The certification does not apply to mulled and/or product combinations unless noted. Actual product results will vary and change over the products life.

For more performance information along with information on Florida Product Approval System (FPAS) Number and Texas Dept. of Insurance (TDI) number go to [www.pella.com/performance](http://www.pella.com/performance).

---

For more information regarding the finishing, maintenance, service and warranty of all Pella® products, visit the Pella® website at [www.pella.com](http://www.pella.com)

---

TERMS & CONDITIONS:



Order Totals	
Taxable Subtotal	\$14,067.32
Sales Tax @ 8.25%	\$1,160.55
Non-taxable Subtotal	\$0.00
<b>Total</b>	<b>\$15,227.87</b>
<b>Deposit Received</b>	<b>\$0.00</b>
<b>Amount Due</b>	<b>\$15,227.87</b>

## Pella Architect Series® Reserve™ - Casement

### Aluminum EnduraClad® Exterior

#### Detailed Product Description

##### Frame

---

- Select softwood, immersion treated with Pella's EnduraGuard® wood protection formula in accordance with WDMA I.S.-4. The EnduraGuard formula includes three active ingredients for protection against the effects of moisture, decay, stains from mold and mildew. Plus, an additional ingredient adds protection against termite damage.
- Interior exposed surfaces are [clear pine] [mahogany] [douglas fir]. Any curved member may have visible finger-jointed surfaces.
- Exterior surfaces are clad with aluminum.
- Components are assembled with screws, staples and concealed corner locks
- Overall frame depth is 5" (127mm) for a wall depth of 3-11/16" (94mm).
- Optional factory-applied jamb extensions available between 3-13/16" (97mm) and 9-3/16" (233mm).
- Optional factory-installed fold-out installation fins with flexible fin corners.
- Optional factory-applied EnduraClad® exterior trim.

##### Sash

---

- Select softwood, immersion treated with Pella's EnduraGuard® wood protection formula in accordance with WDMA I.S.-4. The EnduraGuard formula includes three active ingredients for protection against the effects of moisture, decay, stains from mold and mildew. Plus, an additional ingredient adds protection against termite damage.
- Interior exposed surfaces are [clear pine] [mahogany] [douglas fir]. Any curved member may have visible finger-jointed surfaces.
- Exterior surfaces are clad with extruded aluminum butt-jointed at all corners of the sash with through-stile construction and sealed.
- Corners mortised and tenoned, glued and secured with metal fasteners.
- Sash thickness is [1-13/16" (46mm) for 11/16"] [2-1/8" (54mm) for 1"] glazing.
- Sash exterior profile is [ogee] [putty glaze], interior profile is ogee.

##### Weatherstripping

---

- Dual weatherstripping.
  - Flexible santoprene material compressed between frame and sash for positive seal on all four sides.
  - Secondary thermoplastic vulcanizate (TPV) leaf-type weatherstrip between edge of sash and frame.

##### Glazing System<sub>1</sub>

---

- Quality float glass complying with ASTM C 1036.
- Silicone-glazed dual-pane 11/16" dual-seal insulating glass [[annealed] [tempered]], [[clear] [[Advanced Low-E] [SunDefense™ Low-E] [NaturalSun Low-E] [AdvancedComfort Low-E] with argon]] [[bronze] [gray] [green] Advanced Low-E [with Argon]] [obscure] [Reflective Bronze] [Reflective Gray].  
-or-
- Silicone-glazed dual-pane 1" dual-seal tempered spandrel glass [Lava Bronze Amber] [Black] [Ford Blue] [Symmetry Bronze] [Symmetry Gray] [Symmetry Green].  
-or-
- Silicone-glazed dual-pane 11/16" dual-seal [[annealed] [tempered]] non-impact laminated glass [[clear] [[Advanced Low-E] [SunDefense Low-E] with Argon]] [[bronze] [gray] [green] Advanced Low-E [with argon]].  
- or -
- Silicone-glazed 1" triple-pane, dual-seal insulating glass [[annealed] [tempered]] [[Advanced Low-E] [SunDefense™] [NaturalSun Low-E] with [argon] [krypton]].  
- or -
- Impact-Resistant
  - Silicone-glazed 1" dual-seal impact-resistant insulating glass, [PVB] [SGP]. [[tempered] [annealed]] exterior light is [[Advanced Low-E] [SunDefense] with argon] [clear] [bronze] [gray] [green]]. Laminated clear interior light.  
- or -
  - Silicone-glazed 11/16" dual-seal impact-resistant insulating glass, [PVB]. [[tempered] [annealed]] exterior light is [[Advanced Low-E with argon] [clear]]. Laminated [clear] interior light, or [[tempered] [annealed]] exterior light is [[Advanced Low-E] [SunDefense] with argon] [clear]]. Laminated [[bronze] [gray] [green]] interior light.

##### Exterior

---

- Aluminum clad exteriors shall be finished with EnduraClad® protective finish, in a multi-step, baked-on finish.
  - Color is [standard] [custom].  
- or -
- Aluminum clad exteriors shall be finished with EnduraClad Plus protective finish with 70% fluoropolymer resin in a multi-step, baked-on finish
  - Color is [standard] [custom].  
- or -
- Aluminum clad exteriors shall be finished with an anodized protective finish.
  - Color is [Clear] [Light Bronze] [Dark Bronze] [Black] [Custom].



## Interior

---

- [Unfinished, ready for site finishing] [factory primed with one coat acrylic latex] [factory prefinished [paint] [stain]<sub>2</sub>].

## Hardware

---

- Roto operator assembly
  - Steel worm gear sash operator with hardened gears.
  - Operator base is zinc die cast with painted finish.
  - Operator linkage, hinge slide, and hinge arms are stainless steel.
  - Exposed fasteners are stainless steel.
  - Hardware shall exceed 1,000 hours salt spray exposure per ASTM B 117.
- All vent units are available with left- or right-hand hinging.
- SureLock® System—A single handle locking system operates positive-acting arms that reach out and pull the sash into a locked position: one operating lock installed on units with frame height 29" and less, two unison operating locks installed on units with frame height over 29".
- Style of hardware is [Standard integrated fold-away crank and standard lock handle with [baked enamel [Champagne] [White] [Brown] [Matte Black]] [Bright Brass] [Satin Nickel] [Oil-Rubbed Bronze] hardware finish].

– or –

- [Antiek fold-away crank and Antiek lock handle with [baked enamel [Champagne] [White] [Brown] [Matte Black]] [Bright Brass] [Satin Nickel] [Oil-Rubbed Bronze] [antique brass] [distressed bronze] [distressed nickel] hardware finish].

## Optional Products

---

### Grilles

- Integral Light Technology® grilles
  - Interior grilles are [5/8"] [7/8"] [1-1/4"] [2"] ogee profile that are solid [pine] [mahogany] [douglas fir]. Interior surfaces are [unfinished, ready for site finishing] [factory primed] [pine: factory prefinished [paint] [stain]<sub>2</sub>].
  - Exterior grilles are [5/8" putty glaze profile] [7/8" [putty glaze] [ogee] profile] [1-1/4" [putty glaze] [ogee] profile] [2" ogee profile] that are extruded aluminum.
  - Patterns are [Traditional] [Prairie] [Top Row] [Cross] [New England] [Victorian] [Simulated French].
  - Insulating glass contains non-glare spacer between the panes of glass.
  - Grilles are adhered to both sides of the insulating glass with VHB acrylic adhesive tape and aligned with the non-glare spacer.

– or –

- Grilles-Between-the-Glass<sub>3</sub>
  - Insulating glass contains 3/4" contoured aluminum grilles permanently installed between two panes of glass (exterior air-space on triple-pane insulating glass).
  - Patterns are [Traditional] [Prairie] [Cross] [Top Row].
  - Interior color is [White] [Tan<sub>4</sub>] [Brown<sub>4</sub>] [Putty<sub>4</sub>] [Black] [Morning Sky Gray] [Ivory] [Sand Dune] [Harvest] [Cordovan] [Brickstone].
  - Exterior color<sub>5</sub> is [standard]<sub>2</sub>.

– or –

- Roomside Removable Grilles
  - [[3/4"] [1-1/4"] [2"] Regular] [[1-1/4"] [2"] Colonial] profile, with [Traditional] [Prairie] patterns that are removable solid pine wood bars steel-pinned at joints and fitted to sash with steel clips and tacks.
  - Interior [unfinished, ready for site finishing] [factory-primed] [pine: [factory prefinished [paint] [stain]<sub>2</sub>].
  - Exterior [unfinished, ready for site finishing] [Factory Primed] [finish color matched to exterior cladding<sub>5</sub>].

### Screens

- InView™ Screens
  - Vinyl-coated 18/18 mesh fiberglass screen cloth complying with the performance requirements of SMA 1201, set in aluminum frame fitted to inside of window, supplied complete with all necessary hardware.
  - Screen frame finish is [baked enamel [Champagne] [Artisan Greige] [Skyline Gray] [White] [Brown] [Black]] [Wrapped in wood veneer, factory prefinished stain to match interior finish].

– or –

- Vivid View® Screens<sub>6</sub>
  - PVDF 21/17 mesh, minimum 78 percent light transmissive screen, set in aluminum frame fitted to inside of window, supplied complete with all necessary hardware.
  - Screen frame finish is [baked enamel [Champagne] [Artisan Greige] [Skyline Gray] [White] [Brown] [Black]] [Wrapped in wood veneer, factory prefinished stain to match interior finish].

– or –

- Rolscreen® Soft-close Retractable Screen (for rectangular units only)
  - InView™ Screen cloth, self-storing, rolling, black vinyl-coated 18/18 mesh fiberglass screen cloth complying with ASTM D 3656 and the performance requirements of SMA 1201 mounted behind overhead cover.
  - Cover finish is [factory prefinished paint] [[pine] [mahogany] [douglas fir] veneer wrapped over extruded aluminum with factory prefinished [stain] [paint]<sub>2</sub>].
  - Guides are aluminum extrusion with [[pine] [mahogany] [douglas fir] veneer wrapped over extruded aluminum with factory prefinished [stain] [paint]<sub>2</sub>].

### Hardware

- Optional factory applied limited opening hardware available for vent units in stainless steel; nominal 3" opening.
- Optional factory applied window opening control device. Device allows window to open less than 4" with normal operation, with a release mechanism that allows the sash to open completely.

### Sensors

- Optional factory installed integrated security sensors available in vent units.

- (1) Low-E coated insulating glass is argon-filled (except high altitude). All other insulating glass (including high altitude Low-E) is air-filled.
- (2) Contact your local Pella sales representative for current designs and color options.
- (3) Available in clear or Low-E insulating glass with argon, and obscure insulated glass.
- (4) Tan, Brown and Putty Interior GBG colors are available in single-tone (Brown/Brown, Tan/Tan or Putty/Putty). Other interior colors are also available with tan or brown exterior.
- (5) Appearance of exterior grille color will vary depending on Low-E coating on glass.
- (6) Vivid View screen is not available when frame height is > 84" or when both frame width and frame height are > 48".



## Pella Architect Series® Reserve™ – Double-Hung Windows

### Aluminum EnduraClad® Exterior

#### Detailed Product Description

##### Frame

---

- Select softwood, immersion treated with Pella's EnduraGuard® wood protection formula in accordance with WDMA I.S.-4. The EnduraGuard formula includes three active ingredients for protection against the effects of moisture, decay, stains from mold and mildew. Plus, an additional ingredient adds protection against termite damage.
- Interior exposed surfaces are [clear pine] [mahogany] [douglas fir].
- Exterior surfaces are clad with aluminum.
- Components are assembled with screws, staples and concealed corner locks.
- Overall frame depth is 5" (127mm) for a wall depth of 3-11/16" (94mm).
- Optional factory applied jamb extensions available between 3-13/16" (97mm) and 9-3/16" (233mm).
- Vinyl jamb liner with wood / clad inserts.
- Optional factory installed fold-out installation fins with flexible fin corners.
- Optional factory-applied EnduraClad® exterior trim.

##### Sash

---

- Select softwood, immersion treated with Pella's EnduraGuard® wood protection formula in accordance with WDMA I.S.-4. The EnduraGuard formula includes three active ingredients for protection against the effects of moisture, decay, stains from mold and mildew. Plus, an additional ingredient adds protection against termite damage.
- Interior exposed surfaces are [clear pine] [mahogany] [douglas fir]. Any curved member may have visible finger-jointed surfaces.
- Exterior surfaces are clad with extruded aluminum butt-jointed at all corners of the sash with through-stile construction and sealed.
- Corners mortised and tenoned, glued and secured with metal fasteners.
- Sash thickness is 1-7/8" (47mm).
- Double-Hung: Upper sash has surface-mounted wash locks for easy tilt-in cleaning] [Single-Hung: Fixed upper sash has surface-mounted wash locks] [Arch Head units have no wash locks].
- Lower sash has concealed wash locks in lower check rail allowing sash to tilt in for easy cleaning.
- Simulated-Hung units have non-operable upper and lower sashes.
- Sash exterior profile is [ogee] [putty glaze], interior profile is ogee.

##### Weatherstripping

---

- Water-stop santoprene-wrapped foam at head and sill.
- Thermoplastic elastomer bulb with slip-coating set into lower sash for tight contact at check rail.
- Vinyl-wrapped foam inserted into jamb liner to seal against sides of sash.

##### Glazing System

---

- Quality float glass complying with ASTM C 1036.
- Custom and high altitude glazing available.
- Silicone-glazed dual-pane 13/16" dual-seal insulating glass [[annealed] [tempered]], [[clear] [[Advanced Low-E] [SunDefense™ Low-E] [NaturalSun Low-E] [AdvancedComfort Low-E] with argon]] [[bronze] [gray] [green] Advanced Low-E [with Argon]] [obscure] [Reflective Bronze].  
-or-
- Silicone-glazed dual-pane 13/16" dual-seal [[annealed] [tempered]] non-impact laminated glass [[clear] [[Advanced Low-E] [SunDefense Low-E] with Argon]] [[bronze] [gray] [green] Advanced Low-E [with argon]].

##### Exterior

---

- Aluminum-clad exteriors shall be finished with EnduraClad® protective finish, in a multi-step, baked-on finish.
  - Color is [standard] [custom]<sub>1</sub>.- or -
- Aluminum-clad exteriors shall be finished with EnduraClad Plus protective finish with 70% fluoropolymer resin in a multi-step, baked-on finish.
  - Color is [standard] [custom]<sub>1</sub>.- or -
- Aluminum clad exteriors shall be finished with an anodized protective finish.
  - Color is [Clear] [Light Bronze] [Dark Bronze] [Black] [Custom]<sub>1</sub>.

##### Interior

---

- [Unfinished, ready for site finishing] [factory primed with one coat acrylic latex] [pine: factory prefinished [paint] [stain] <sub>1</sub>].

##### Hardware

---

- Galvanized block-and-tackle balances are connected to self-locking balance shoes which are connected to the sashes using zinc die cast terminals and concealed within the frame.
- Sash lock is [standard (cam-action)] [historic spoon-style] [air-conditioner lock] [simulated lock (Single-piece lock ties upper and lower sash together. When removed lower sash becomes operable)]. Two sash locks on units with frame width 37" and greater.
- Optional sash lift furnished for field installation. Two lifts on units with frame width 37" and greater.
- Hardware finish is [baked enamel [Champagne] [White] [Brown] [Matte Black]] [Bright Brass] [Satin Nickel] [Oil-rubbed Bronze] [Antique Brass] [Distressed Bronze] [Distressed Nickel]].

## Optional Products

---

### Sash

- Exterior sash lugs
  - Optional factory applied accessory. Exterior finish is [Standard<sub>1</sub>] [Custom<sub>1</sub>].

### Grilles

- Integral Light Technology® grilles
  - Interior grilles are [5/8"] [7/8"] [1-1/4"] [2"] ogee profile that are solid [pine] [mahogany] [douglas fir]. Interior surfaces are [unfinished, ready for site finishing] [factory primed] [pine: factory prefinished [paint] [stain] <sub>1</sub>].
  - Exterior grilles are [5/8" putty glaze profile] [7/8" [putty glaze] [ogee] profile] [1-1/4" [putty glaze] [ogee] profile] [2" ogee profile] that are extruded aluminum.
  - Patterns are [Traditional] [Prairie] [Top Row] [New England] [Victorian].
  - Insulating glass contains non-glare spacer between the panes of glass.
  - Grilles are adhered to both sides of the insulating glass with VHB acrylic adhesive tape and aligned with the non-glare spacer.  
– or –
- Grilles-Between-the-Glass<sub>2</sub>
  - Insulating glass contains 3/4" contoured aluminum grilles permanently installed between two panes of glass.
  - Patterns are [Traditional] [9-Lite Prairie] [Cross] [Top Row]
  - Interior color is [White] [Tan<sub>3</sub>] [Brown<sub>3</sub>] [Putty<sub>3</sub>] [Black] [Morning Sky Gray] [Ivory] [Sand Dune] [Harvest] [Cordovan] [Brickstone].
  - Exterior color<sub>4</sub> is [standard<sub>1</sub>].  
– or –
- Roomside Removable grilles
  - [[3/4"] [1-1/4"] [2"] traditional] [[1-1/4"] [2"] colonial] profile, with [Traditional] [Prairie] patterns that are removable solid pine wood bars steel-pinned at joints and fitted to sash with steel clips and tacks.
  - Interior [unfinished, ready for site finishing] [factory primed] [pine: factory prefinished [paint] [stain] <sub>1</sub>].
  - Exterior [unfinished, ready for site finishing] [factory primed] [finish color matched to exterior cladding<sub>4</sub>].

### Screens

- Integrated Rolscreen® (for rectangular units only)<sub>5</sub>
  - Retractable screen integrated into [lower sash] [both upper and lower sash]. Screen rollers are fixed and concealed within the frame, screen is held to the sash by magnets which release when the bottom sash is tilted for cleaning, and when the upper sash is opened past 18".
  - InView Screen cloth, black vinyl-coated 18/18 mesh fiberglass screen cloth complying with ASTM D 3656 and the performance requirements of SMA 1201.  
– or –
- InView™ screens
  - [Half-Size] [Full-Size<sub>4</sub>] black vinyl-coated 18/18 mesh fiberglass screen cloth complying with the performance requirements of SMA 1201, set in a [standard roll-form] [premium extruded] aluminum frame fitted to outside of window, supplied complete with all necessary hardware.
  - Full screen spreader bar placed on units > 37" width or > 65" height.
  - Screen frame finish is [standard screen: baked enamel] [premium extruded: [baked enamel] [anodized]], color to match window cladding.  
– or –
- Vivid View® screens<sub>7</sub>
  - [Half-Size] [Full-Size] PVDF 21 / 17 mesh, minimum 78 percent light transmissive screen, set in a [standard roll-form] [premium extruded] aluminum frame fitted to outside of window, supplied complete with all necessary hardware.
  - Full screen spreader bar placed on units > 37" width or > 65" height.
  - Screen frame finish is [standard screen: baked enamel] [premium extruded: [baked enamel] [anodized]], color to match window cladding.

### Hardware

- Optional factory applied limited opening device available for vent units in stainless steel; nominal 3-3/4" opening. Limiting device concealed from view.
- Optional factory applied window opening control device. Device allows window to open less than 4" with normal operation, with a release mechanism that allows the sash to open completely. Complies with ASTM F2090-10.

### Sensors

- Optional factory installed integrated security sensors available in vent units.

(1) Contact your local Pella sales representative for current designs and color options.

(2) Available in clear or Low-E insulating glass only.

(3) Tan, Brown and Putty Interior GBG colors are available in single-tone (Brown/Brown, Tan/Tan or Putty/Putty). Other interior colors are also available with Tan or Brown exterior.

(4) Appearance of exterior grille color will vary depending on Low-E coating on glass.

(5) Full screens are available on units ≤ 96" height.

(6) Integrated Rolscreen only available on sizes ≥ 34" tall and 21" wide, and ≤ 84" tall and 48" wide.

(7) Vivid View screen is not available when frame height is > 84" or when both frame width and frame height are > 48".



## Pella Architect Series® Reserve™ - Casement

### Aluminum EnduraClad® Exterior

#### Detailed Product Description

##### Frame

---

- Select softwood, immersion treated with Pella's EnduraGuard® wood protection formula in accordance with WDMA I.S.-4. The EnduraGuard formula includes three active ingredients for protection against the effects of moisture, decay, stains from mold and mildew. Plus, an additional ingredient adds protection against termite damage.
- Interior exposed surfaces are [clear pine] [mahogany] [douglas fir]. Any curved member may have visible finger-jointed surfaces.
- Exterior surfaces are clad with aluminum.
- Components are assembled with screws, staples and concealed corner locks
- Overall frame depth is 5" (127mm) for a wall depth of 3-11/16" (94mm).
- Optional factory-applied jamb extensions available between 3-13/16" (97mm) and 9-3/16" (233mm).
- Optional factory-installed fold-out installation fins with flexible fin corners.
- Optional factory-applied EnduraClad® exterior trim.

##### Sash

---

- Select softwood, immersion treated with Pella's EnduraGuard® wood protection formula in accordance with WDMA I.S.-4. The EnduraGuard formula includes three active ingredients for protection against the effects of moisture, decay, stains from mold and mildew. Plus, an additional ingredient adds protection against termite damage.
- Interior exposed surfaces are [clear pine] [mahogany] [douglas fir]. Any curved member may have visible finger-jointed surfaces.
- Exterior surfaces are clad with extruded aluminum butt-jointed at all corners of the sash with through-stile construction and sealed.
- Corners mortised and tenoned, glued and secured with metal fasteners.
- Sash thickness is [1-13/16" (46mm) for 11/16"] [2-1/8" (54mm) for 1"] glazing.
- Sash exterior profile is [ogee] [putty glaze], interior profile is ogee.

##### Weatherstripping

---

- Dual weatherstripping.
  - Flexible santoprene material compressed between frame and sash for positive seal on all four sides.
  - Secondary thermoplastic vulcanizate (TPV) leaf-type weatherstrip between edge of sash and frame.

##### Glazing System<sub>1</sub>

---

- Quality float glass complying with ASTM C 1036.
- Silicone-glazed dual-pane 11/16" dual-seal insulating glass [[annealed] [tempered]], [[clear] [[Advanced Low-E] [SunDefense™ Low-E] [NaturalSun Low-E] [AdvancedComfort Low-E] with argon]] [[bronze] [gray] [green] Advanced Low-E [with Argon]] [obscure] [Reflective Bronze] [Reflective Gray].  
  
- or -
- Silicone-glazed dual-pane 1" dual-seal tempered spandrel glass [Lava Bronze Amber] [Black] [Ford Blue] [Symmetry Bronze] [Symmetry Gray] [Symmetry Green].  
  
- or -
- Silicone-glazed dual-pane 11/16" dual-seal [[annealed] [tempered]] non-impact laminated glass [[clear] [[Advanced Low-E] [SunDefense Low-E] with Argon]] [[bronze] [gray] [green] Advanced Low-E [with argon]].  
  
- or -
- Silicone-glazed 1" triple-pane, dual-seal insulating glass [[annealed] [tempered]] [[Advanced Low-E] [SunDefense™] [NaturalSun Low-E] with [argon] [krypton]].  
  
- or -
- Impact-Resistant
  - Silicone-glazed 1" dual-seal impact-resistant insulating glass<sub>1</sub> [PVB] [SGP]. [[tempered] [annealed]] exterior light is [[Advanced Low-E] [SunDefense] with argon] [clear] [bronze] [gray] [green]]. Laminated clear interior light.  
  
- or -
  - Silicone-glazed 11/16" dual-seal impact-resistant insulating glass<sub>1</sub> [PVB]. [[tempered] [annealed]] exterior light is [[Advanced Low-E with argon] [clear]]. Laminated [clear] interior light, or [[tempered] [annealed]] exterior light is [[Advanced Low-E] [SunDefense] with argon] [clear]]. Laminated [[bronze] [gray] [green]] interior light.

##### Exterior

---

- Aluminum clad exteriors shall be finished with EnduraClad® protective finish, in a multi-step, baked-on finish.
  - Color is [standard] [custom]<sub>2</sub>.  
- or -
- Aluminum clad exteriors shall be finished with EnduraClad Plus protective finish with 70% fluoropolymer resin in a multi-step, baked-on finish
  - Color is [standard] [custom]<sub>2</sub>.  
- or -
- Aluminum clad exteriors shall be finished with an anodized protective finish.
  - Color is [Clear] [Light Bronze] [Dark Bronze] [Black] [Custom]<sub>2</sub>.

## Interior

---

- [Unfinished, ready for site finishing] [factory primed with one coat acrylic latex] [factory prefinished [paint] [stain]<sub>2</sub>].

## Hardware

---

- Roto operator assembly
  - Steel worm gear sash operator with hardened gears.
  - Operator base is zinc die cast with painted finish.
  - Operator linkage, hinge slide, and hinge arms are stainless steel.
  - Exposed fasteners are stainless steel.
  - Hardware shall exceed 1,000 hours salt spray exposure per ASTM B 117.
- All vent units are available with left- or right-hand hinging.
- SureLock® System—A single handle locking system operates positive-acting arms that reach out and pull the sash into a locked position: one operating lock installed on units with frame height 29" and less, two unison operating locks installed on units with frame height over 29".
- Style of hardware is [Standard integrated fold-away crank and standard lock handle with [baked enamel [Champagne] [White] [Brown] [Matte Black]] [Bright Brass] [Satin Nickel] [Oil-Rubbed Bronze] hardware finish].

— or —

- [Antiek fold-away crank and Antiek lock handle with [baked enamel [Champagne] [White] [Brown] [Matte Black]] [Bright Brass] [Satin Nickel] [Oil-Rubbed Bronze] [antique brass] [distressed bronze] [distressed nickel] hardware finish].

## Optional Products

---

### Grilles

- Integral Light Technology® grilles
  - Interior grilles are [5/8"] [7/8"] [1-1/4"] [2"] ogee profile that are solid [pine] [mahogany] [douglas fir]. Interior surfaces are [unfinished, ready for site finishing] [factory primed] [pine: factory prefinished [paint] [stain]<sub>2</sub>].
  - Exterior grilles are [5/8" putty glaze profile] [7/8" [putty glaze] [ogee] profile] [1-1/4" [putty glaze] [ogee] profile] [2" ogee profile] that are extruded aluminum.
  - Patterns are [Traditional] [Prairie] [Top Row] [Cross] [New England] [Victorian] [Simulated French].
  - Insulating glass contains non-glare spacer between the panes of glass.
  - Grilles are adhered to both sides of the insulating glass with VHB acrylic adhesive tape and aligned with the non-glare spacer.

— or —

- Grilles-Between-the-Glass<sub>3</sub>
  - Insulating glass contains 3/4" contoured aluminum grilles permanently installed between two panes of glass (exterior air-space on triple-pane insulating glass).
  - Patterns are [Traditional] [Prairie] [Cross] [Top Row].
  - Interior color is [White] [Tan<sub>4</sub>] [Brown<sub>4</sub>] [Putty<sub>4</sub>] [Black] [Morning Sky Gray] [Ivory] [Sand Dune] [Harvest] [Cordovan] [Brickstone].
  - Exterior color<sub>5</sub> is [standard]<sub>2</sub>.

— or —

- Roomside Removable Grilles
  - [[3/4"] [1-1/4"] [2"] Regular] [[1-1/4"] [2"] Colonial] profile, with [Traditional] [Prairie] patterns that are removable solid pine wood bars steel-pinned at joints and fitted to sash with steel clips and tacks.
  - Interior [unfinished, ready for site finishing] [factory-primed] [pine: [factory prefinished [paint] [stain]<sub>2</sub>].
  - Exterior [unfinished, ready for site finishing] [Factory Primed] [finish color matched to exterior claddings<sub>5</sub>].

### Screens

- InView™ Screens
  - Vinyl-coated 18/18 mesh fiberglass screen cloth complying with the performance requirements of SMA 1201, set in aluminum frame fitted to inside of window, supplied complete with all necessary hardware.
  - Screen frame finish is [baked enamel [Champagne] [Artisan Greige] [Skyline Gray] [White] [Brown] [Black]] [Wrapped in wood veneer, factory prefinished stain to match interior finish].

— or —

- Vivid View® Screens<sub>6</sub>
  - PVDF 21/17 mesh, minimum 78 percent light transmissive screen, set in aluminum frame fitted to inside of window, supplied complete with all necessary hardware.
  - Screen frame finish is [baked enamel [Champagne] [Artisan Greige] [Skyline Gray] [White] [Brown] [Black]] [Wrapped in wood veneer, factory prefinished stain to match interior finish].

— or —

- Rolscreen® Soft-close Retractable Screen (for rectangular units only)
  - InView™ Screen cloth, self-storing, rolling, black vinyl-coated 18/18 mesh fiberglass screen cloth complying with ASTM D 3656 and the performance requirements of SMA 1201 mounted behind overhead cover.
  - Cover finish is [factory prefinished paint] [[pine] [mahogany] [douglas fir] veneer wrapped over extruded aluminum with factory prefinished [stain] [paint]<sub>2</sub>].
  - Guides are aluminum extrusion with [[pine] [mahogany] [douglas fir] veneer wrapped over extruded aluminum with factory prefinished [stain] [paint]<sub>2</sub>].

### Hardware

- Optional factory applied limited opening hardware available for vent units in stainless steel; nominal 3" opening.
- Optional factory applied window opening control device. Device allows window to open less than 4" with normal operation, with a release mechanism that allows the sash to open completely.

### Sensors

- Optional factory installed integrated security sensors available in vent units.



- (1) Low-E coated insulating glass is argon-filled (except high altitude). All other insulating glass (including high altitude Low-E) is air-filled.
- (2) Contact your local Pella sales representative for current designs and color options.
- (3) Available in clear or Low-E insulating glass with argon, and obscure insulated glass.
- (4) Tan, Brown and Putty Interior GBG colors are available in single-tone (Brown/Brown, Tan/Tan or Putty/Putty). Other interior colors are also available with tan or brown exterior.
- (5) Appearance of exterior grille color will vary depending on Low-E coating on glass.
- (6) Vivid View screen is not available when frame height is > 84" or when both frame width and frame height are > 48".

# Exterior Window and Door Trim Options

NEW CONSTRUCTION/FULL-FRAME REPLACEMENT

## ENDURA CLAD® EXTERIOR TRIM

Factory-applied, low-maintenance aluminum trim.

✓ WOOD CLAD

✗ FIBERGLASS

✗ VINYL



Monroe Trim and 1" Sill Nose

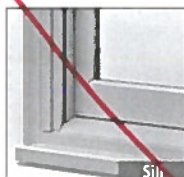

Brickmould Trim and 1/2" Sill Nose



Jefferson Trim and 2" Sill Nose

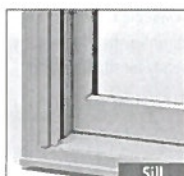

3-1/2" Flat Casing Trim and 3-1/2" Flat Casing Sill



3-1/2" Brickmould Trim and 1" Sill Nose



1/2" Nose

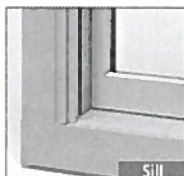

1" Nose with Nose Extension

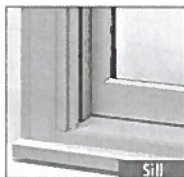

2" Nose with Nose Extension



3-1/2" Flat Casing

### TRIM PROFILES



Brickmould



Monroe



3-1/2" Brickmould



Jefferson



3-1/2" Flat Casing

### SILL PROFILES

### HEAD DETAIL

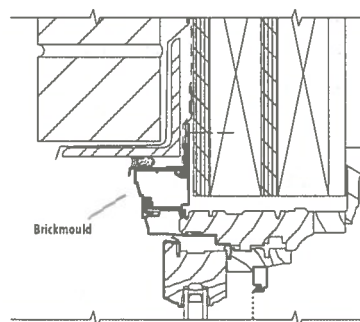

Brickmould

## FRAME EXPANDER

Durable, snap-in trim that is adjustable to field conditions.

✓ WOOD CLAD

✓ FIBERGLASS

✓ VINYL



4-1/2" Flat Brickmould and 3-1/2" Flat Casing

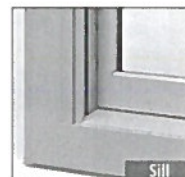

- Prefinished; matches Pella products.
- Provides the look of flat trim.
- Aluminum brickmould can be attached to re-create the look of historical wood brickmould.
- No metal brake required.

- Cut-to-length kits, 96" or 144" lengths.
- Available in widths from 1" to 6".
- Receptors are available to provide a finished edge.

### FRAME EXPANDERS



2-1/4" Vinyl Frame Expander



1"



1-3/4"



2-1/2"



4"



6"

Aluminum Frame Expander Options for Wood and Fiberglass Products

### ALUMINUM BRICKMOULD WITH CLIP



1-1/2"



2-1/16"



1-7/8"



1-7/8"



1-5/16"



1-11/16"

### HEAD DETAIL

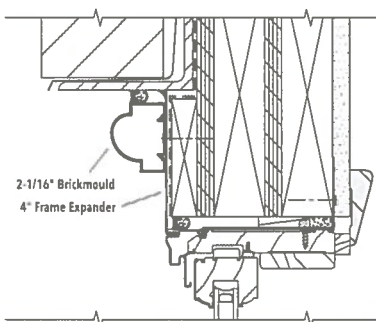

2-1/16" Brickmould  
4" Frame Expander

# Exterior Window and Door Trim Options

NEW CONSTRUCTION/FULL-FRAME REPLACEMENT (Cont.)

## AZEK® TRIM SURROUNDS

Decay-resistant PVC trim, field-cut or factory-assembled surrounds.

✓ WOOD CLAD    ✓ FIBERGLASS    ✓ VINYL

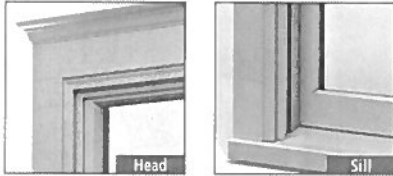

3-3/8" Flat Casing with Crown Molding

- Ready for site finishing.
- Cellular PVC material that's impervious to insects and moisture.
- Preassembled surrounds or 9' lengths.
- 4" or 5" flat trim, or 2" brickmould with sill nose.

### TRIM PROFILES

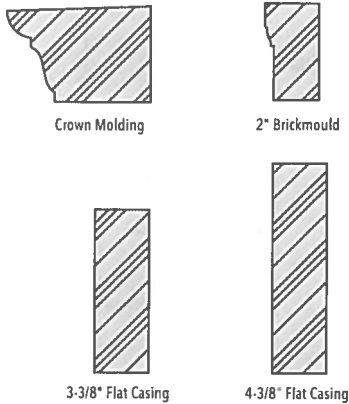

### SILL PROFILES



Sill Nose

### HEAD DETAIL

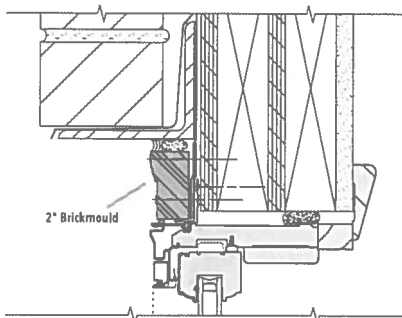

## ROUGH/SMOOTH WOOD

Field-cut, protected, reversible wood trim.

✓ WOOD CLAD    ✓ FIBERGLASS    ✓ VINYL

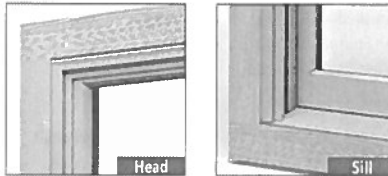

3-1/2" Flat Casing

- Primed and ready for site finishing.
- Grained or smooth appearance.
- 10' lengths.
- 3-1/2" or 5" flat widths, 3/4" thickness.

### TRIM PROFILES

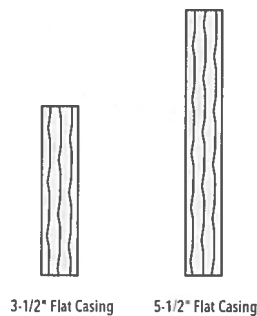

### HEAD DETAIL

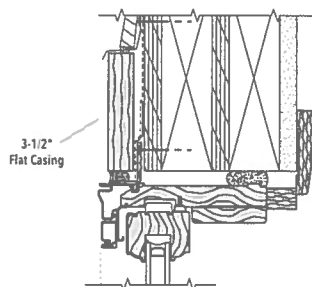

## WOOD BRICKMOULD

EnduraGuard® protected wood brickmould available factory-applied or in lineal lengths.

✓ WOOD    ✗ FIBERGLASS    ✗ VINYL

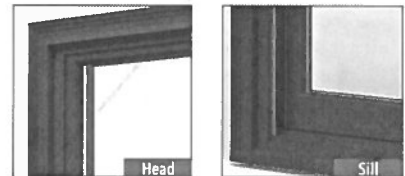

1-7/8" Brickmould with Rabbet and Double-Hung Sill Nose

- Available in primed Pine or unfinished Mahogany; ready for site finishing.
- Straight or curved.
- 1-7/8" or 3-1/2" brickmould or flat trim with 1-1/2" or 1-7/8" sill nose/subsill.
- Designed for wood exterior windows and doors only.

### TRIM PROFILES

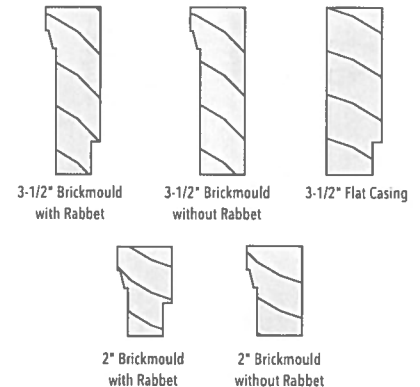

### SILL PROFILES

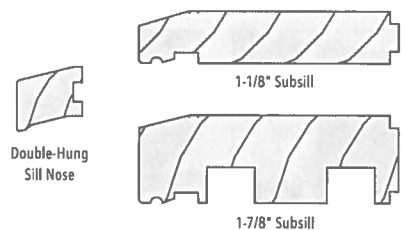

### HEAD DETAIL

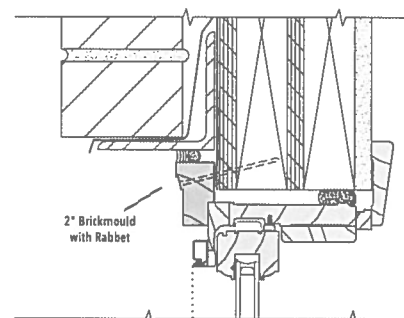





## IMPORTANT SAFETY AND PRODUCT INFORMATION – WINDOW

# Install Instructions

**CAUTION:** Many windows in older homes are painted with lead-based paint. Removal of old windows may disturb this paint. Proper precautions must be taken to minimize exposure to dust and debris. Consult state or local authorities and/or go to [www.epa.gov/lead](http://www.epa.gov/lead) for more information.



**WARNING:** To ensure safety and security and help prevent property damage, including possible damage to your window or door, close and lock windows and doors any time they are not being used for venting on a nice day, and particularly during high winds or rain.

### Important Notice

Because all construction must anticipate some water infiltration, it is important that the wall system be designed and constructed to properly manage moisture. Pella Corporation is not responsible for claims or damages caused by anticipated and unanticipated water infiltration; deficiencies in building design, construction and maintenance; failure to install Pella products in accordance with Pella's installation instructions; or the use of Pella products in wall systems which do not allow for proper management of moisture within the wall systems. The determination of the suitability of all building components, including the use of Pella products, as well as the design and installation of flashing and sealing systems are the responsibility of the Buyer or User, the architect, contractor, installer, or other construction professional and are not the responsibility of Pella.

Pella products should not be used in barrier wall systems which do not allow for proper management of moisture within the wall systems, such as barrier Exterior Insulation and Finish Systems (EIFS) (also known as synthetic stucco) or other non-water managed systems. Except in the states of California, New Mexico, Arizona, Nevada, Utah and Colorado, Pella makes no warranty of any kind on and assumes no responsibility for Pella windows and doors installed in barrier wall systems. In the states listed above, the installation of Pella Products in barrier wall or similar systems must be in accordance with Pella's installation instructions. Product modifications that are not approved by Pella Corporation will void the warranty.

### Care and Maintenance

Care and maintenance information is available by contacting your local Pella retailer. This information is also available at [www.pella.com](http://www.pella.com).

### Cleaning Instructions

**GLASS:** Remove any protective film and labels and clean the glass, using a soft, clean, grit-free cloth and mild soap or detergent. Be sure to remove all liquid by wiping dry or use a clean squeegee.

**FACTORY FINISHED PRODUCT:** Pella product that has been prefinished with stain or paint from the factory requires no additional finishing. Clean the surface with mild soap and water.

**PELLA® ALUMINUM CLAD OR IMPERVIA FRAMES:** The interior and exterior frame and sash are protected with a tough factory finish. Clean this surface with mild soap and water. Stubborn stains and deposits may be removed with mineral spirits. DO NOT use abrasives. DO NOT scrape or use tools that might damage the surface.

**ENCOMPASS BY PELLA®/THERMASTAR BY PELLA®, PELLA® 350 SERIES AND PELLA® 250 SERIES WINDOWS FRAMES:** The vinyl frame may be cleaned using the same method as the glass. For stubborn dirt, a "non-abrasive" cleaner such as Bon-Ami® or Soft Scrub® may be used. Do not use solvents such as mineral spirits, toluene, xylene, naphtha or muriatic acid as they can dull the finish, soften the vinyl and/or cause failure of the insulated unit seal. Keep door tracks clear of dirt and debris. Keep weep holes open and clear of obstructions.

DO NOT use abrasives. DO NOT scrape or use tools that might damage the surface.

**Notice:** DO NOT use inappropriate solvents or brickwash or cleaning.

### Interior Finish (Wood Windows)

Paint or finish immediately after installation.

If products cannot be finished immediately, cover with clear plastic to protect from dirt, damage and moisture. Remove any construction residue before finishing. Sand all wood surfaces lightly with 180 grit or finer sandpaper. DO NOT use steel wool. BE CAREFUL NOT TO SCRATCH THE GLASS. Remove sanding dust. Pella products must be finished per the below instructions; failure to follow these instructions voids the Limited Warranty.

**Note:** To maintain proper product performance do not paint, finish or remove the weatherstripping, mohair dust pads, gaskets or vinyl parts. Air and water leakage will result if these parts are removed. After finishing, allow venting windows and doors to dry completely before closing them. If paint, stain or finish gets on the weatherstripping, wipe it off immediately with a damp cloth.

Window Cleaning and Prep Instructions for Unfinished or Primed windows: Dry wipe dust from windows gently. Examine window for possible smudges or fingerprints made from normal handling or construction. To remove smudges, lightly wipe surface with warm water. Scuff sand with light grade sand paper or abrasive pad (220 grit or higher). Rinse surface with warm water. Let window surfaces dry completely before applying finish.

Finish the windows as soon as possible after installation.

- On casement and awnings, it is optional to paint, stain or finish the vertical and horizontal sash edges.
- On single-hungs and double-hungs, do not paint, stain or finish the vertical sash edges, any finish on the vertical sash edges may cause the sash to stick; it is optional to paint, stain or finish the horizontal sash edges.

Pella Corporation is not responsible for interior paint and stain finish imperfections for any product that is not factory-applied by Pella Corporation. For additional information on finishing see the Pella Owner's Manual or go to [www.pella.com](http://www.pella.com).

The use of unapproved finishes, solvents or cleaning chemicals may cause adverse reactions with door materials. Pella will not be responsible for problems caused by the use of unapproved materials. If in doubt, contact your local retailer or representative.

### Exterior Finish of Existing Frame (Pocket Replacement)

It is the responsibility of the homeowner, contractor or installer to ensure any exposed unfinished wood is covered or finished. Possible methods include, however are not limited to, covering with aluminum coil stock or painting.

For Casement Hardware Installation go to: [www.installpella.com/trimaccessory/hardware](http://www.installpella.com/trimaccessory/hardware)



## FULL FRAME REMOVAL WHEN PREPARING TO INSTALL A NEW NAIL FIN WINDOW

This method of Full Frame Removal involves removing the sash and entire frame of the existing window from the wall. The resulting opening is the original rough opening. The existing window nailing fins are usually nailed to the studs in frame construction with siding, brick veneer or other exterior material applied over the fin on the outside. The interior may have a drywall return from the wall to the window frame.

**CAUTION:** Many windows in older homes are painted with lead-based paint. Removal of old windows may disturb this paint. Proper precautions must be taken to minimize exposure to dust and debris. Consult state or local authorities and/or go to [www.epa.gov/lead](http://www.epa.gov/lead) for more information.

### TOOLS REQUIRED:

- Utility knife 
- Phillips and Standard screwdrivers 
- Pry bar 
- Circular saw 
- Hammer 
- Putty knife 

REMEMBER TO USE APPROPRIATE PERSONAL PROTECTIVE EQUIPMENT.

### EXISTING WOOD BRICKMOULD FRAME WINDOW

- Score paint or varnish between the interior trim and the wall with a sharp utility knife.  
*NOTE: This will minimize the damage to the interior wall and trim.*
- Remove the interior trim. Using a pry bar and block of wood, remove the interior trim from all four sides of the window including the stool at the bottom of the window. If the interior trim is being reused, pull the nails out through the back side of the board with nipper pliers.
- Cut the exterior sealant line between the exterior brickmould or trim and the exterior siding or wall cladding.
- Remove the exterior brickmould or flat trim using a pry bar and block of wood.  
*Caution: Some windows may come out of the opening as the exterior trim is removed.*
- Remove the window frame using a pry bar if necessary.

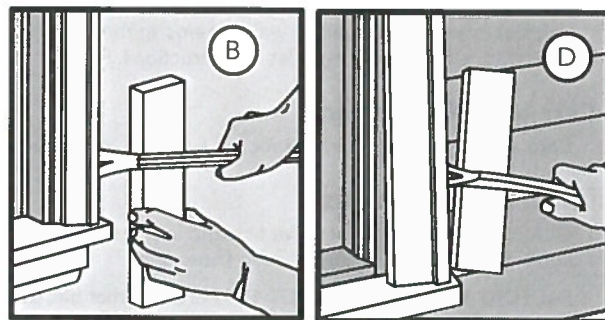

### EXISTING NAIL FIN WINDOW REMOVAL

#### Sash Removal

- Remove the vent sash and screen from the old window.
- Remove the fixed sash. In some cases, there are screws holding in the fixed sash. Remove the screws and take out the fixed sash.  
*NOTE: There may be a need to break the caulking free from around the fixed sash before it can be removed.*
- Remove the division bar by unscrewing the fasteners holding it to the frame. If the screws are not accessible, then use a hacksaw to cut the division bar off at the head and sill flush with the old window frame.

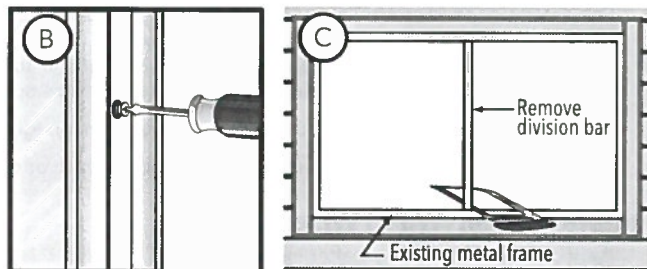

### WINDOW WITH EXTERIOR TRIM

- Remove the existing exterior trim (if applicable). Use a block of wood to protect the exterior wall material. Use a pry bar to remove the existing exterior trim.
- Remove the nails or screws attaching the window nailing fin to the wall.
- Remove the window from the opening.

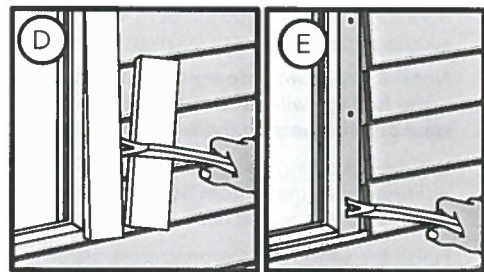

### WINDOW WITH NO EXTERIOR TRIM

- Use a reciprocating saw to cut through sealant line and the nailing fin.  
OR
- Remove siding or cut back the siding a minimum of 3" or far enough to expose the nailing fin. Remove the fasteners attaching the window to the wall.  
*NOTE: When cutting back the siding, set the saw blade depth 1/8" less than the thickness of the siding. Break the cut ends of the siding off after sawing. DO NOT cut through the existing building wrap.*
- Remove the window from the wall.

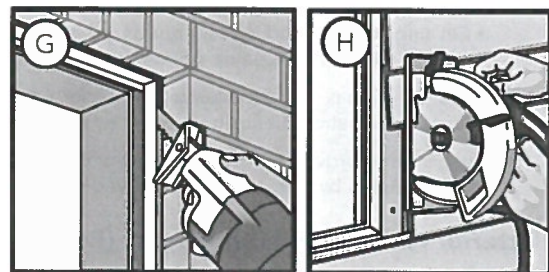







Consult with local providers and authorities to recycle or properly dispose of old window components.













## PREPARING FOR NAIL FIN WINDOW INSTALLATION

### YOU WILL NEED TO SUPPLY:

- Moisture resistant shims/spacers 
- Fasteners (see nail fin anchor instructions and tables at the end of this booklet) 
- Closed cell foam backer rod/sealant backer 
- Pella® SmartFlash™ foil backed butyl window and door flashing tape or equivalent 
- Low expansion, low pressure polyurethane insulating window and door foam sealant. **DO NOT** use high pressure or latex foams. 
- Pella Window and Door Installation Sealant or equivalent high quality, multi-purpose sealant 

### TOOLS REQUIRED:

- Tape measure 
- Level 
- Square 
- Hammer 
- Stapler 
- Scissors or utility knife 
- Small flat blade screwdriver 
- Sealant Gun 
- Screw Gun with a Phillips Driver bit 
- 1/8" Allen wrench 

**Other construction materials may be required. Read and understand the instructions and inspect the wall conditions before you begin.**

### INSTALLATION WILL REQUIRE (2) OR MORE PERSONS FOR SAFETY REASONS.

Store windows in upright position, out of direct sunlight.

### ROUGH OPENING VERIFICATION

- A. Confirm the opening is plumb and level.

**NOTE:** It is critical the bottom is level and it does not slope to the interior.

- B. Remove dirt, oil or debris from the opening and surrounding wall surfaces.

- C. Confirm the window will fit the opening. Measure all four sides of the opening to make sure it is 1/2" to 3/4" larger than the window in both width and height. On larger openings measure the width and height in several places to ensure the header or studs are not bowed.

**NOTE:** 1-1/2" or more of solid wood blocking is typically required around the perimeter of the opening. Fix any problems with the rough opening before proceeding.

- D. For continuous exterior insulation panels up to 1" thick, utilize standard installation methods. For insulating panels 1.5" to 2" thick, Rough Opening Support Brackets or solid wood blocking is required.

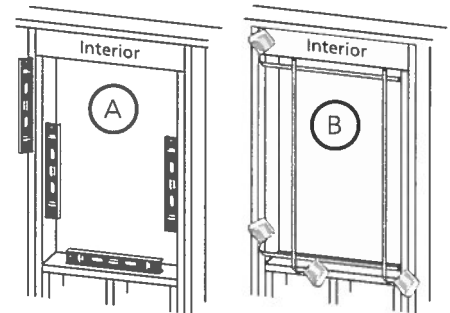

### PREPARE THE WINDOW FOR INSTALLATION

- A. Remove plastic wrap and cardboard packaging from window. DO NOT cut checkrail bands (if present) or remove plastic or foam shipping spacers located between the window sash and frame. DO NOT open the window until it is securely fastened.

- B. Inspect the product for any damage such as cracks, dents or scratches. DO NOT install damaged windows.

- C. Remove screens and hardware (if necessary). Label them and set them aside in a protected area.

**Windows with Half Screens:** From the exterior, pull one side of the screen near the shipping clips until the clips disengage from the frame. Rotate the shipping clips toward the exterior of the screen until they snap free from the screen.

Half screens of some vinyl windows can be removed from the interior.

- D. Fold out installation fin to 90° (units with fold up fin only).

Be careful not to remove or tear the fin corners.

**NOTE:** If the fin is not at 90°, the window will not line up correctly on the interior.

- E. Units with painted head drip cap fin and no pre-punched holes: Pre-drill holes through the fin (refer to the anchor page for spacing)

**Curved top units with flexible fins:** Prepare the window frame for attachment by pilot drilling through the frame or securing installation clips (refer to the anchor page).

**Units with EnduraClad Exterior trim and narrow fins with NO pre-punched holes:** Install clips or pre-drill holes for frame screws.

See the anchor instruction pages at the end of this booklet.

Additional preparation may be required for performance upgrade, impact resistant products or to comply with local building code requirements.

- F. Read the entire instruction before proceeding.

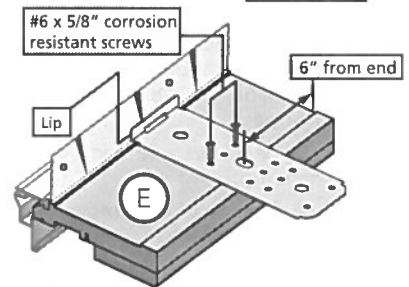
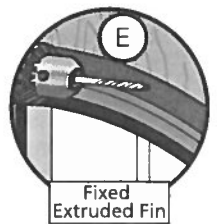
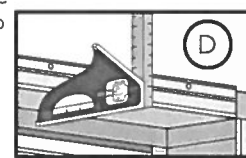
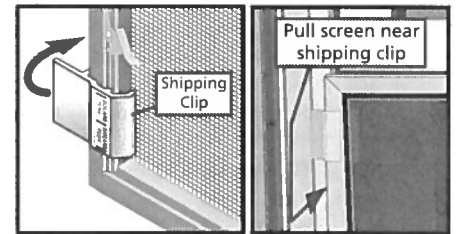

These instructions were developed and tested for use with wall systems designed to manage water. **These instructions are not to be used with any other construction methods or window frame types.** Installation instructions for use with other construction methods or frame types may be obtained from Pella Corporation, your local Pella® retailer or [www.installpella.com](http://www.installpella.com). Building designs, construction methods, building materials, and site conditions unique to your project may require an installation method different from these instructions and/or additional care. Determining the appropriate installation method is the responsibility of you, your architect, or construction professional.



Always read the Limited Warranty before purchasing or installing Pella® products. By installing this product, you are acknowledging that this Limited Warranty is part of the terms of the sale. Failure to comply with all Pella installation and maintenance instructions may void your Pella product warranty. See written Limited Warranty for details, including exceptions and limitations at [pella.com/warranty](http://pella.com/warranty), or contact Pella Customer Service at 877-473-5527.





## FULL FRAME REPLACEMENT WITH NAIL FIN

INSTALLATION OF NEW NAIL FIN WINDOWS AFTER THE REMOVAL OF EXISTING WINDOWS AND THE SURROUNDING TRIM OR SIDING

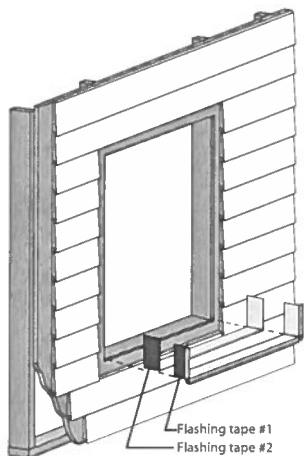

# 1 PREPARE THE OPENING

Refer to the existing frame removal instruction and nail fin installation preparation sections at the beginning of this booklet.

- Repair the wall surface around the opening (if necessary) by installing new blocking flush with the surface of the existing sheathing and/or repairing the existing building wrap with flashing tape.
- Cut 2 pieces of flashing tape 12" longer than opening width.
- Apply sill flashing tape #1 extending far enough onto the wall surface to overlap the building wrap 1" or onto the top edge of the siding and 6" up each jamb.
- Cut 1" wide tabs at each corner by tearing the foil 1/2" each way from corner.
- Apply sill flashing tape #2 overlapping tape #1 by 1" minimum.
- If existing building wrap is folded into the opening at the jambs, skip to step 1H.
- Cut 2 pieces of flashing tape. Make one equal to the height of each side of the opening.

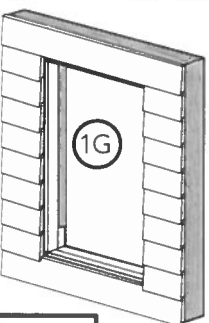
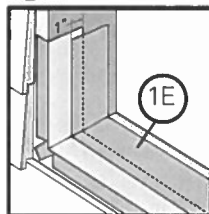
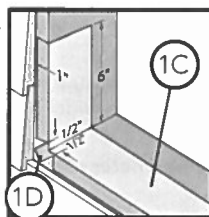

- Apply one piece on each jamb starting 1" from the exterior of the framing, over the edge of the sheathing and onto the surface of the sheathing.

**NOTE: PRESS ALL FLASHING TAPE DOWN FIRMLY.**

- Install and level sill shims. Place 1" wide x 1/4" to 3/8" thick shims 1/2" from each side. Keep shims back from interior face of window. Place additional shims under each mullion and sliding window interlocker.

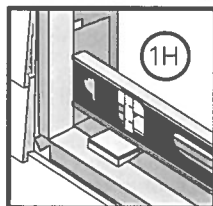

- Attach shims to prevent movement after they are level.

**NOTE: Improper placement of shims may result in bowing the bottom of the window.**

- Apply a continuous, 3/8" tall bead of sealant 1/2" from the edge of the opening at the sides and top only. Do NOT apply sealant at the sill. This step may be omitted if there will be at least 3" of wall surface between the edge of the window frame and the siding after installation.

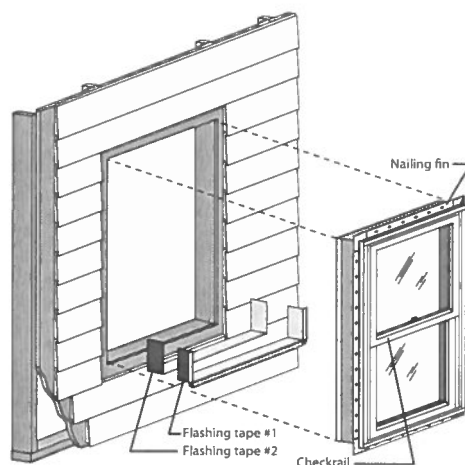
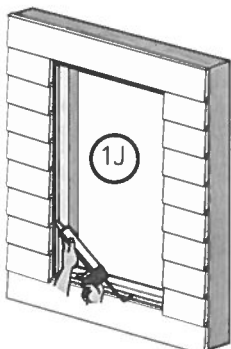

# 2 SETTING AND FASTENING THE WINDOW

- Insert the window into the opening on the sill spacers. Center the window between jambs.
- Drive two fasteners, one near each end of the top nailing fin. See the nail fin anchor instructions at the end of this booklet for fastener requirements.
- Plumb and square the window using shims at the locations shown. Adjust shims to plumb and square the window. Keep shims 1/2" short of window frame depth.

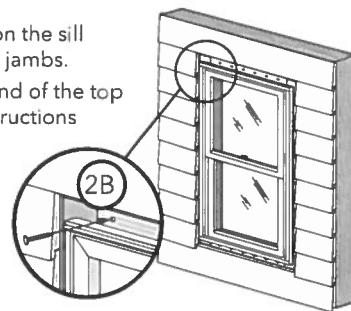

**NOTE: DO NOT shim above the window. Additional shims are required at screw locations for large units and combinations. See the nail fin anchor instructions at the end of this booklet.**

- Check the window placement by measuring from the interior surface of the window frame or jamb extension to the interior surface of the wall for consistency. If the dimensions are not equal, confirm the fins are folded fully to 90° (if applicable).

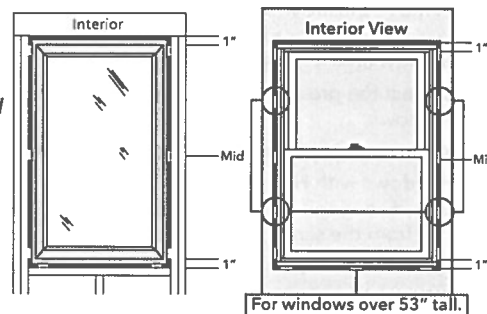

- Drive two fasteners one near each end of the sill nailing fin.
- Check window operation. **Vent awning and casement:** See lock lever and crank handle instructions at the end of this instruction. Lift the lock lever and turn the crank handle to open the window. Remove the shipping spacers. Open and close the window to test for proper operation.

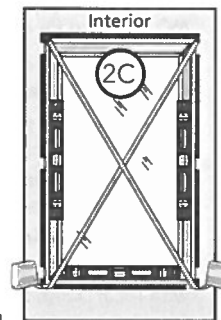
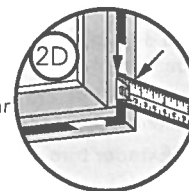

**Double Hung:** Cut the checkrail bands (if applicable) and remove shipping spacers. Open, close and tilt the sashes to test for proper operation. Check for equal sash to frame reveal from top to bottom.

**NOTE: Adjust shims to correct any issues with plumb, square, operation or reveal.**

- Close and lock the window.
- Finish driving fasteners into the nailing fin. Refer to the nail fin anchor instructions at the end of this booklet.



## FULL FRAME REPLACEMENT WITH NAIL FIN (CONTINUED)

INSTALLATION OF NEW NAIL FIN WINDOWS AFTER THE REMOVAL OF EXISTING WINDOWS AND THE SURROUNDING TRIM OR SIDING

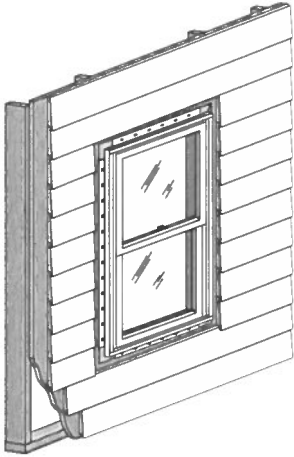

### 3 SEALING THE TOP AND SIDE NAILING FINS

**NOTE:** Apply flashing tape 1/2" onto frame cladding with fold-up or slide-in fins. Pre-fold flashing tape at 1/2" to assist with application. For siding less than 1/2" thick, adjust the placement of the tape to allow the exterior sealant to cover the tape edge.

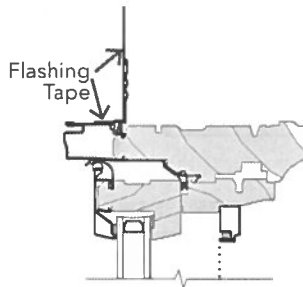

Curved and angle top units without pre-applied fin corners:

- A. Cut four 1-1/2" long pieces of flashing tape.

Apply one to each end of sill fin to extend it 1-1/2" past each jamb.

Apply one to the bottom end of each jamb fin beginning 1-1/2" from the end of the fin and lapping over the first piece of flashing tape.

If there is less than 3" between the window frame and the siding, skip to step 3C.

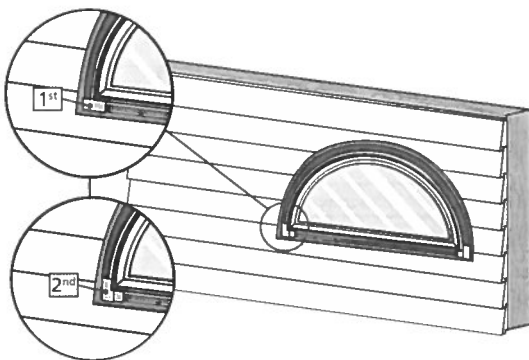

- B. Apply straight side flashing tape. Cut two pieces of flashing tape 4" taller than straight sides. Apply tape over the fin and onto weather resistive barrier. Extend tape 2" above and below straight sides.

**Angle top units:** On the short side, do not allow the side tape to extend higher than what the top tape will cover.

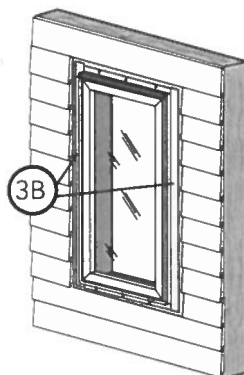

- C. Apply top flashing tape.

**Rectangular Units:** Cut one piece of flashing tape to extend 1" past both side flashing tapes.

**Curved Top Units:** Using several short pieces, start taping from the sides of the window working towards the peak.

Cut each piece short enough so each piece overlaps the previous piece. Tighter curved frames will require shorter pieces of tape.

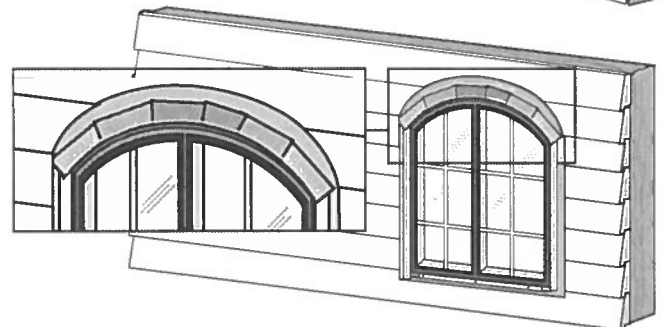
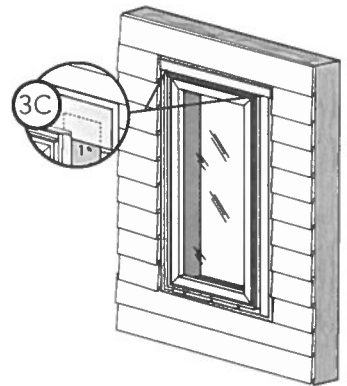

**NOTE: DO NOT TAPE OVER BOTTOM NAILING FIN.**

**NOTE: PRESS ALL FLASHING TAPE DOWN FIRMLY.**

- D. Install head flashing if none exists, properly incorporating it with the siding and building wrap according to applicable code requirements.
- E. Install blocking for frame expander support or solid trim at this time, if applicable.
- F. Install interior sealant. Refer to the interior sealant instructions at the end of this booklet.
- G. Install exterior sealant. Refer to the exterior sealant instructions at the end of this booklet.
- H. Install frame expander and receptor (if applicable). See separate instructions.

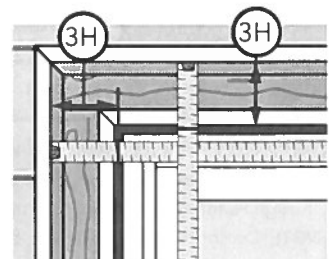



## NAIL FIN WINDOW ANCHOR INSTRUCTIONS

**Note:** Standard performance only. Additional anchoring may be required for performance upgrade, impact resistant products or to comply with local building code requirements.

PLACE FASTENERS AT THE LOCATIONS INDICATED.

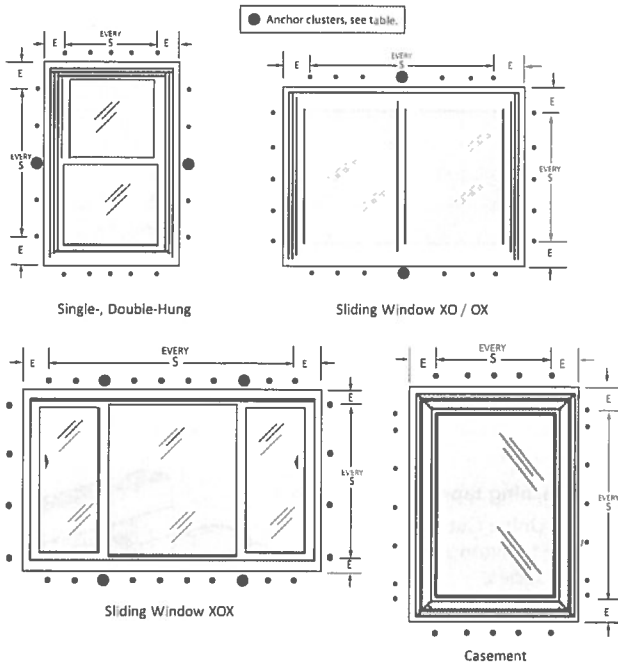

### 250 SERIES

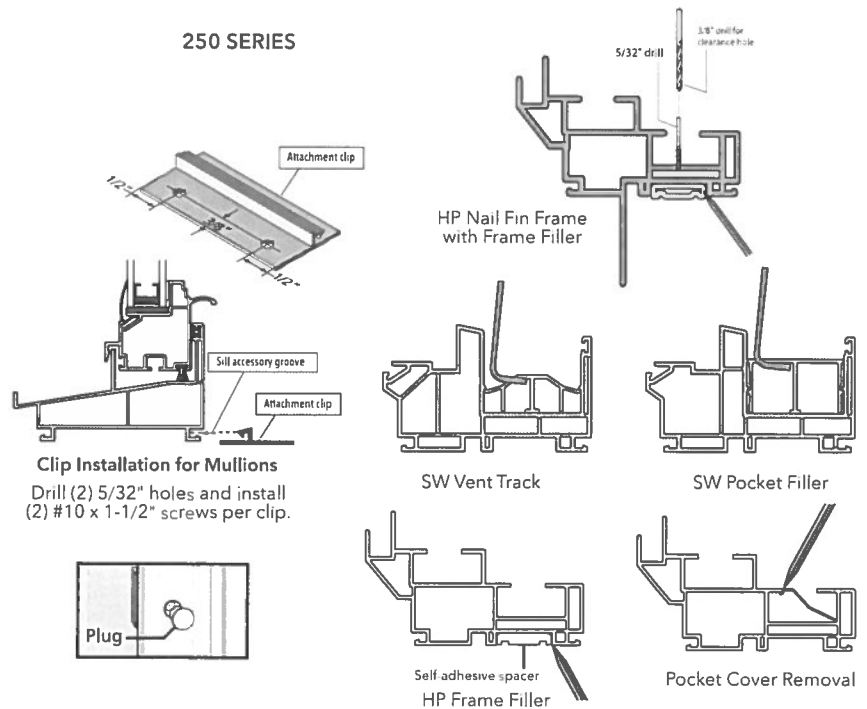

ENCOMPASS BY PELLA®/THERMASTAR BY PELLA® / PELLA® 250 SERIES AND PELLA® 350 SERIES WINDOWS

Product		PG Rating	Max Frame Width (inches)	Max Frame Height (inches)	Edge Spacing (E)	Max. Intermediate Spacing(s)	Anchor Type	Anchor Cluster	
							Wood *		
Encompass and ThermoStar Windows		< 50	Any	Any	Every Other Pre-Punched		2" 11 Ga. Roofing Nail	Additional nails at 3" and 6" on both sides of the transition mullion at head and sill.	
		50	Any	Any	Every Pre-Punched Hole		#8 x 2" Screw with Washer	** High Performance DH: (3) #10 x 2" jamb frame screws, 4" apart at checkrails. Use (4) #10 x 2" screws at head mullion ends and 4 clips at sill mullion ends 3" and 6" from mullion.	
250 SERIES	Windows/CM /AW	< 50	Any	Any	Every Other Pre-Punched Hole		1.5" 11 Ga. Roofing Nail	High Performance DH: (3) #8 x 2" jamb frame screws, 4" apart at checkrails.	
	SH/SW/FX	50	Any	Any	Every Pre-Punched Hole		1.5" 11 Ga. Roofing Nail		
	DH	50	Any	Any	Every Pre-Punched Hole		#10 x 2" Screw with Washer	** 3 jamb frame screws, 4" apart at Checkrails.	
	CM/AW	50	Any	Any	Every Pre-Punched Hole		#10 x 2" Screw with Washer		
	Combinations	< 35	Any	Any	Every Other Pre-Punched Hole		#8 x 2" Screw with Washer		None
	Combinations	> 35	Any	Any	Every Pre-Punched Hole		#8 x 2" Screw with Washer		
350 SERIES	SH and DH	30	40"	63"	6"	8"	1.5" 11 Ga. Roofing Nail	None	
		40	40"	63"	6"	8"	1.5" 11 Ga. Roofing Nail	5 nails, 2" apart at Checkrails	
		+40/-60	Any	Any	6"	8"	1.5" 11 Ga. Roofing Nail	5 nails, 2" apart at Checkrails and Mullion Ends	
	2-Panel Sliding Windows	30	76"	48"	6"	8"	1.5" 11 Ga. Roofing Nail	None	
		40	76"	62"	6"	8"	1.5" 11 Ga. Roofing Nail	5 nails, 2 inches apart Meeting Stiles	
		+40/-60	76"	72"	6"	8"	#10 x 2" Screw with Washer	3 Screws, 2" apart at Meeting Stiles	
	3-Panel Sliding Windows	30	123"	48"	6"	8"	1.5" 11 Ga. Roofing Nail	None	
		40	123"	62"	6"	8"	1.5" 11 Ga. Roofing Nail	5 nails, 2" apart at Meeting Stiles	
		All Other	Any	Any	6"	8"	#10 x 2" Screw with Washer	5 Screws, 2" apart at Meeting Stiles	
	CM/AW/FX	40	Any	Any	6"	8"	1.5" 11 Ga. Roofing Nail	None	
		60	Any	Any	4"	4"	1.5" 11 Ga. Roofing Nail	None	
	FX Composites	All	Any	Any	4"	4"	1.5" 11 Ga. Roofing Nail	5 nails, 2" apart at Mullion Ends	

**IMPORTANT:** For installations over continuous exterior insulation, the anchor length must be increased by the thickness of the insulating panels

\* For light gauge steel framing, use #10 self-drilling modified truss head screws.

\*\* High Performance Frame Fillers are required at each jamb anchor location.

NOTE: Do not over-drive fasteners, but allow for movement of building materials.

Refer to the supplemental instruction included with the unit for securing mullion end anchors (if applicable).

When screws are used in the Nail-Fin, a 1" fender washer is required at each screw anchor location.





## NAIL FIN WINDOW ANCHOR INSTRUCTIONS (CONTINUED)

**Note:** Standard performance only. Additional anchoring may be required for performance upgrade, impact resistant products or to comply with local building code requirements.

### PELLA® IMPERVIA, ARCHITECT SERIES® (850) AND PELLA® LIFESTYLE SERIES NAIL FIN ANCHOR SPACING INSTRUCTIONS

Product	PG Rating	Max Frame Width (inches)	Max Frame Height (inches)	Edge Spacing (E)	Max. Intermediate Spacing (S)	Anchor Type	Frame Anchors
						Wood *	
Impervia Windows	All	Any	Any	3"	7"	2" 11 Ga. Roofing Nail	None
Architect Series & Lifestyle Series Clad Wood CM, AW or FX Windows	All	73"	73"	Every Pre-Punched		2" 11 Ga. Roofing Nail	None
	All	>73"	>73"	Every Pre-Punched Hole		2" 11 Ga. Roofing Nail	#10 x 3-1/2" Screws at 1/3 points along head and jambs
Architect Series & Lifestyle Series SH or DH Windows	All	Any	Any	Every Pre-Punched Hole		2" 11 Ga. Roofing Nail	None
Monumental DH	All	<54	<96	Every Pre-Punched Hole		1-1/2" 11 Ga. Roofing Nail	Refer to the next page for units larger than 54 x 96
Clad Wood Curved Shape Windows with Flexible Fin or Wide EnduraClad Exterior trim with narrow fin.	All	Any	Any	6"	16"	(2) #6 x 1-1/2" screw** per clip	(2) #6 x 5/8" holding each clip** to the window frame
Clad Wood Curved Windows with Rigid Fin	All	Any	Any	6"	12"	2" 11 Ga. Roofing Nail	None

**IMPORTANT:** For installations over continuous exterior insulation, the anchor length must be increased by the thickness of the insulating panels.

\* = For light gauge steel framing, use #10 self-drilling modified truss head screws.

\*\* Refer to the Pella® EnduraClad® Exterior trim with narrow nailing fin anchoring instructions.

NOTE: Do not over-drive fasteners in vinyl fins, but allow for movement of building materials.

Refer to the supplemental instruction included with the unit for securing mullion end anchors (if applicable).

Clad wood direct set windows achieve PG50 up to 60" x 60" with standard anchoring. Larger sizes achieve PG40. Refer to advanced performance/impact resistant instructions for other options.

#### EXAMPLE ANCHOR TYPES



Roofing Nail



K-Lath/Modified Truss Head Screw

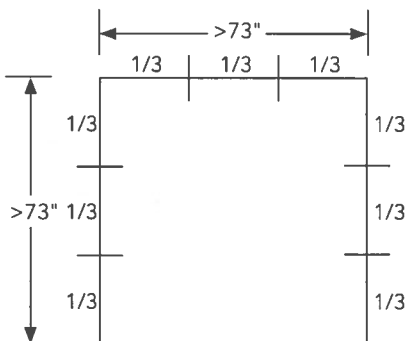

Screws not required at the sill.

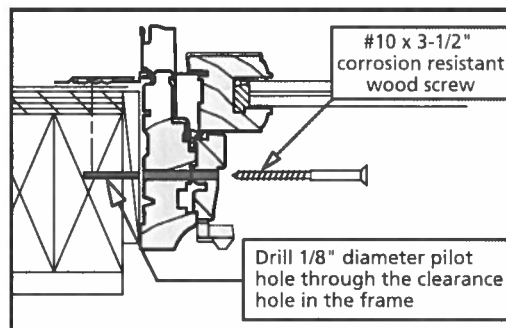

**Drill 1/8" diameter Holes for windows with curved rigid fins**

**Add installation clips or frame anchor screws for vent and fixed clad-wood casements over 73".**

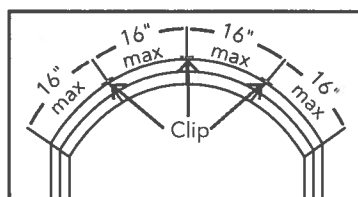
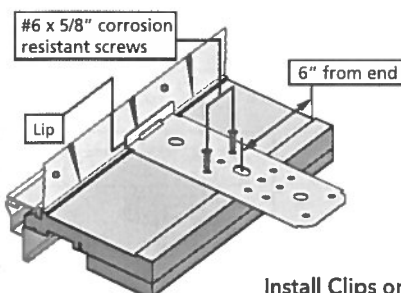

**Install Clips or frame screws for windows with non-structural curved flex fins.**

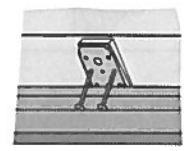



# UNITS WITH WIDE PELLA® ENDURACLAD® EXTERIOR TRIM WITH NARROW FINNS AND NO PRE-PUNCHED HOLES ANCHOR INSTRUCTIONS AND MONUMENTAL HUNG > 54" X 96"

*Note: Standard performance only. Additional anchoring may be required for performance upgrade, impact resistant products or to comply with local building code requirements.*

*Units with narrow fins and NO pre-punched holes must be anchored using frame screws or installation clips. These fins are for flashing purposes only.*

*Units installed over continuous exterior insulation must be anchored using installation clips*

**PLACE FRAME SCREWS OR CLIPS AT THE LOCATIONS INDICATED**

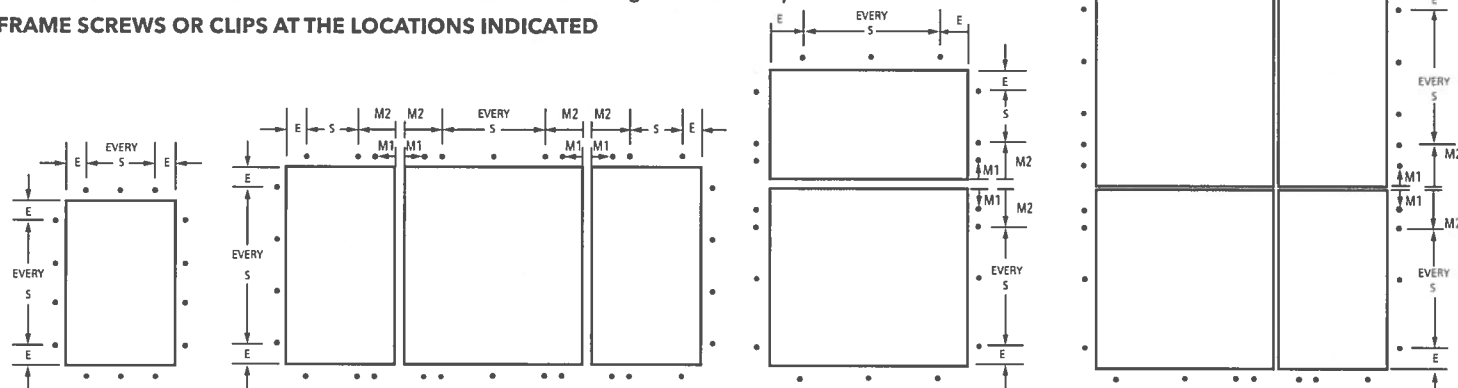

## ARCHITECT SERIES® (850) AND PELLA® LIFESTYLE SERIES WINDOW ANCHOR SPACING INSTRUCTIONS

Product	Edge Spacing (E)	Max. Intermediate Spacing (S)	First Mullion Anchor (M1)	Second Mullion Anchor (M2)	Fastener	Special Notes
					Wood **	
Casement/Awning	6"	16'	3"*	6"	#8 x 3" Finish Screw	
Double- or Single-Hung	6"	16'	3"*	6"	#8 x 3" Finish Screw	For windows with integrated Rolcreen® retractable screen, drive jamb screws at each factory pre-punched hole in the jamb liner. Add fasteners as necessary, driving the head past flush of the jamb liner. Avoid Rolcreen components in the head and sill.
Fixed Frame	6"	16'	3"*	6"	#8 x 3" Finish Screw	
Monumental DH > 54" x 96"	6" (head)	16" (head)	3" *	6" *	#8 x 3" Screw	Remove sashes and jamb liners. Drive 1 screw through each jamb liner support clip (top, bottom, checkrail and center of each sash). Drive 2 additional screws through the frame (or secure clips) 3" above and below the checkrail on each jamb. Drive additional screws through the frame (or secure clips) centered between each jamb liner support clip.

\* M1 anchor required if design pressure exceeds 20 psf.

\*\* For light gauge steel framing, use #10 self-drilling/self-tapping screws; For concrete or masonry, use 3/16" masonry screws with 1-1/4" minimum embedment.

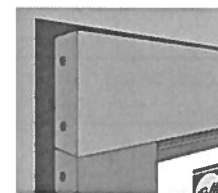

Exterior trim with narrow fin

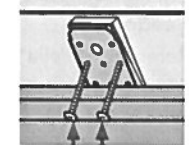

#6 x 1-1/2" screw

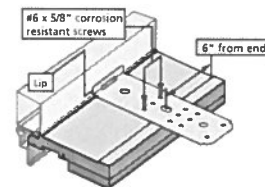

#6 x 5/8" corrosion resistant screws

6" from end

## 1/8" Pilot Hole Locations

	Casement/Awning	Lifestyle Series Double-Hung	Architect Series Double-Hung	Monumental-Hung
Head				
Jamb			 Units with Integrated Rolcreen	 Pry Here
Sill	Do not install fasteners through operator cutout. 		Not applicable for units with Integrated Rolcreen. 	Sill anchors not required. 

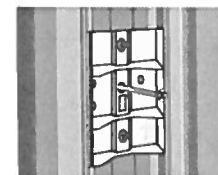

Monumental Hung jamb liner support clip

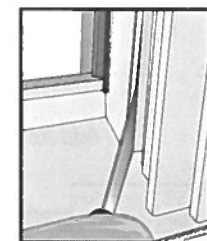

Pry off Monumental Double-Hung jamb liner

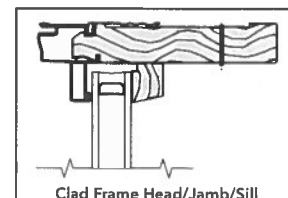

Clad Frame Head/Jamb/Sill



## Interior Sealant Instructions

**CAUTION:** Use low pressure polyurethane window and door insulating foams. Follow the directions on the can. Do not use high pressure or latex foams.

- Insert the nozzle or straw between the rough opening and window frame from the interior. Use a pliers (if necessary) to compress the end of a straw tube to allow it to fit in tight openings.
- Place a 1" deep bead of foam approximately 1" from the interior of the frame to allow for expansion. DO NOT fill the entire depth of the rough opening cavity.

**NOTE:** Apply foam between the frame and rough opening, NOT between jamb extensions and the rough opening.

- To ensure a continuous interior seal, apply sealant over the interior surface of any shims or clips interrupting the foam seal.

Backer rod (as necessary) and sealant can be used in place of the low expansion foam to create the interior seal. However, foam has greater insulating properties. Fiberglass batt or similar insulation is not recommended as it can absorb water and does not act as an air seal.

**NOTE:** Use a low odor, paintable sealant such as Pella Window and Door Installation Sealant.

Re-check window operation and remove shipping spacers after foam installation. Excess foam may be removed with a serrated knife after it cures.

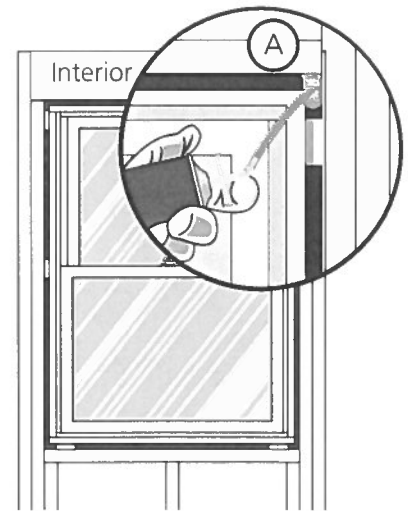

## Exterior Sealant Instructions

**CAUTION:** Use a high quality, multi-purpose exterior sealant such as Pella Window and Door Installation Sealant. Follow the directions on the cartridge.

When applying siding, brick veneer, flashing, or other exterior finish materials, leave adequate space between the window frame and the material for sealant application.

- Insert backer rod 3/8" deep in the space around the window. Backer rod adds shape and controls the depth of the sealant line.
- Apply a continuous bead of sealant to the entire perimeter of the window.
- Shape, tool and clean excess sealant. When finished, the sealant should be the shape of an hourglass.

**NOTE:** The siding details below apply to windows without a J-mould as part of the frame. The J-mould frame is only intended for vinyl or metal sidings where the siding is extended behind the J-mould portion of the frame. The J-mould should be removed and replaced with backer rod and sealant with all other siding or trim types.

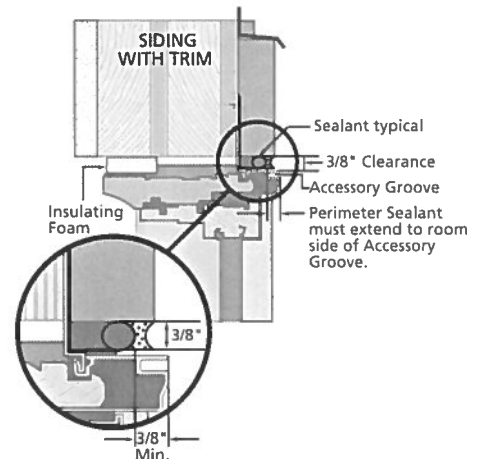
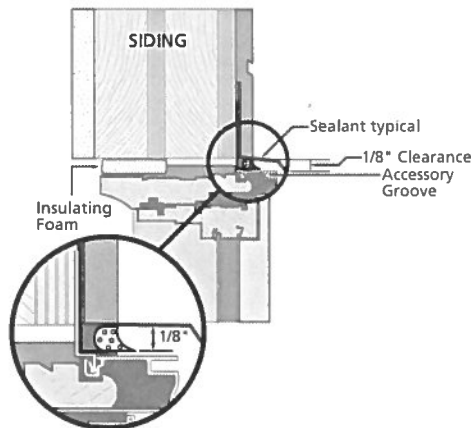
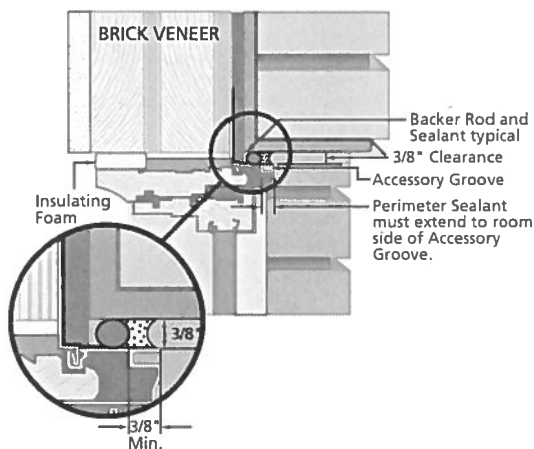
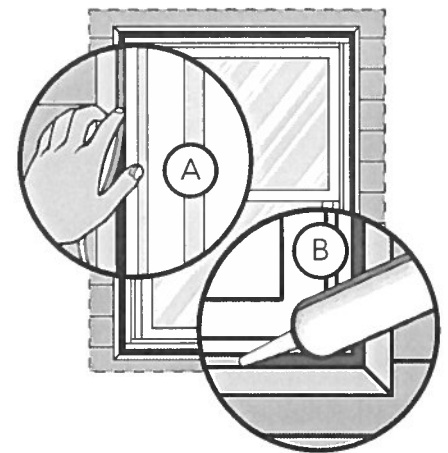





# Architect Series® Reserve™ Hung Window

Unit Sections - Aluminum-Clad Putty Glaze Exterior Profile with Integrated Rolscreen®

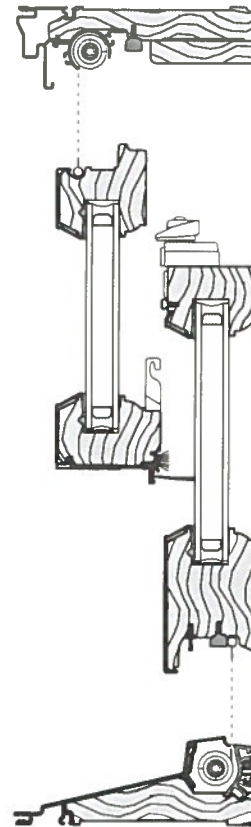
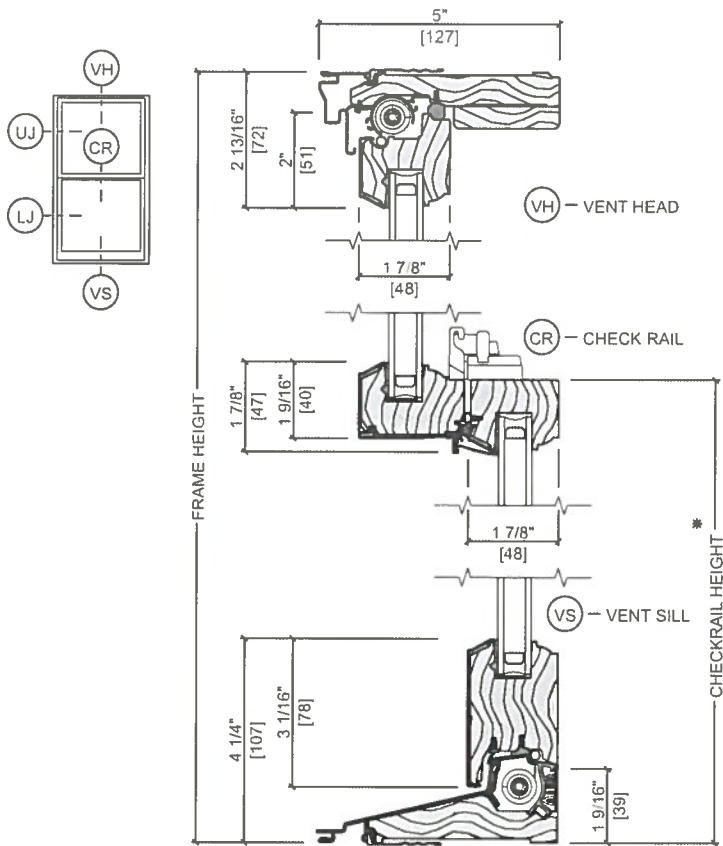

\* Dimension required for ordering units with unequal sash.

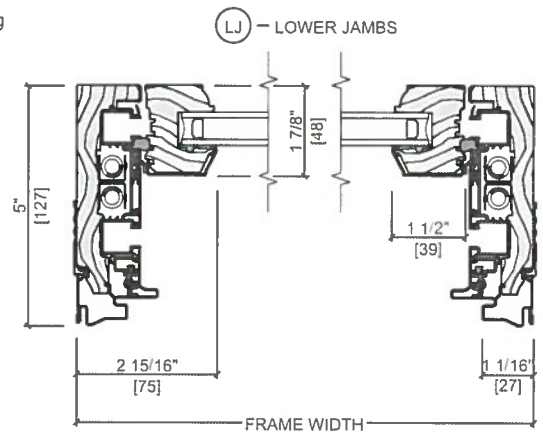
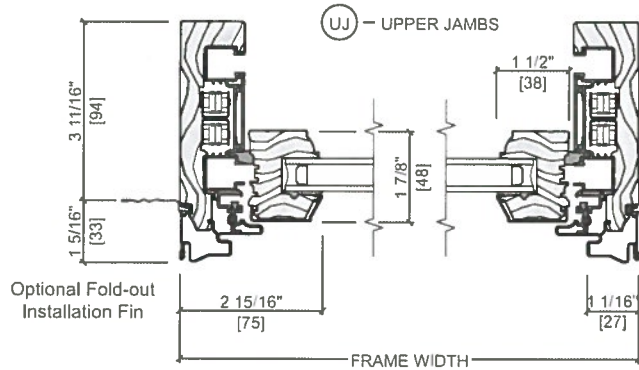

Scale 3" = 1' 0"

All dimensions are approximate.



# Architect Series® Reserve™ Hung Window

## Unit Sections - Wood Exterior Putty Glaze Exterior Profile

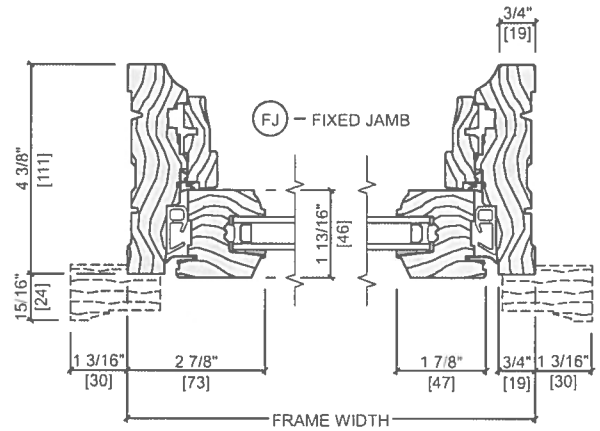
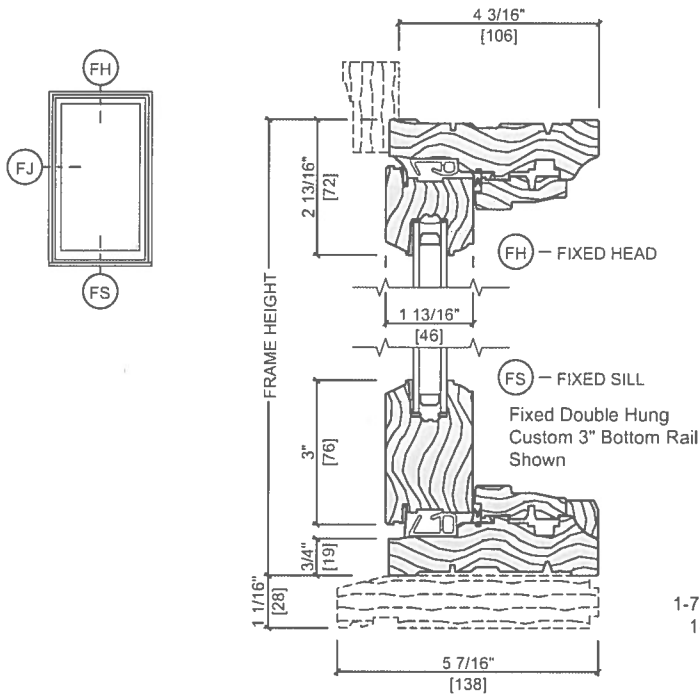

1-7/8" Brickmould #3443  
1-1/8" Subsill #3544  
Shown

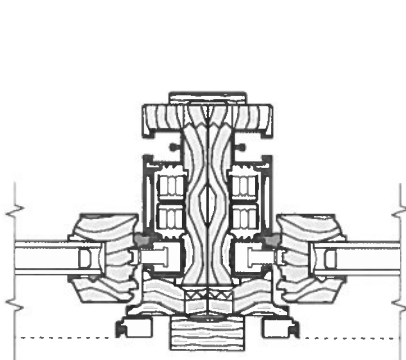
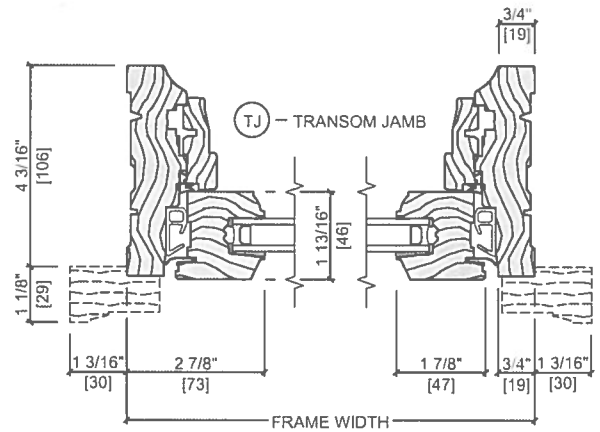
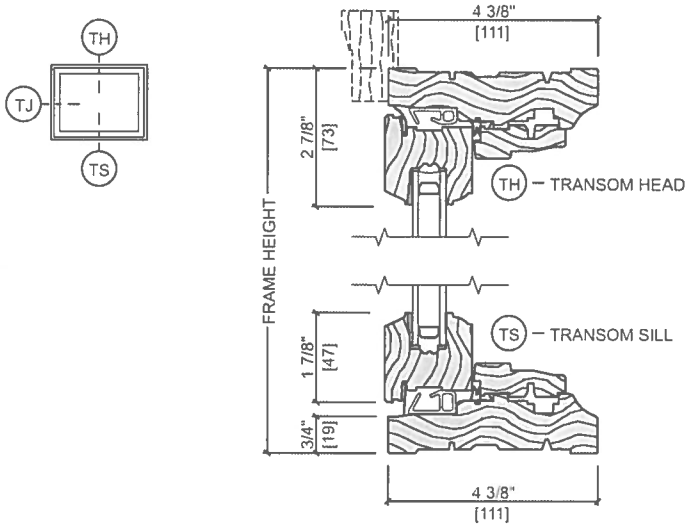

VERTICAL JOINING MULLION  
LX VENT / LX VENT

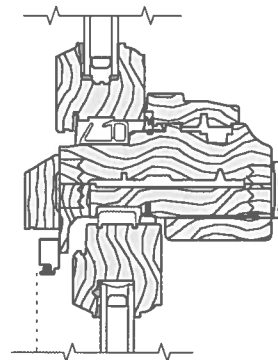

HORIZONTAL JOINING MULLION  
TRANSOM / VENT

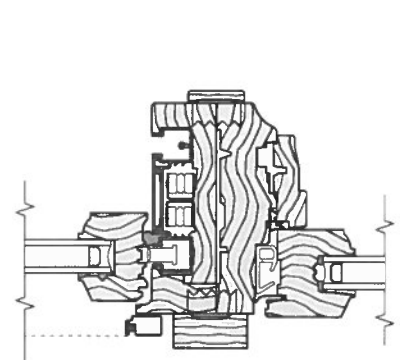

VERTICAL JOINING MULLION  
LX VENT / FIXED

Scale 3" = 1' 0"

All dimensions are approximate.



# Architect Series® Reserve™ Casement Window

Unit Sections - Aluminum-Clad Exterior, Putty Glaze Exterior Profile

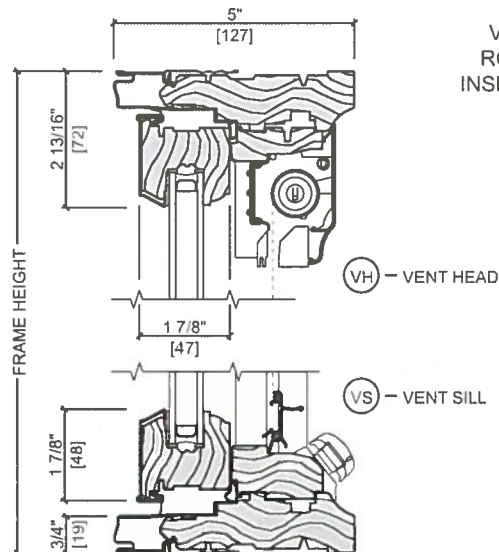
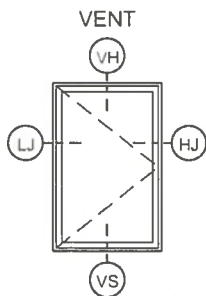
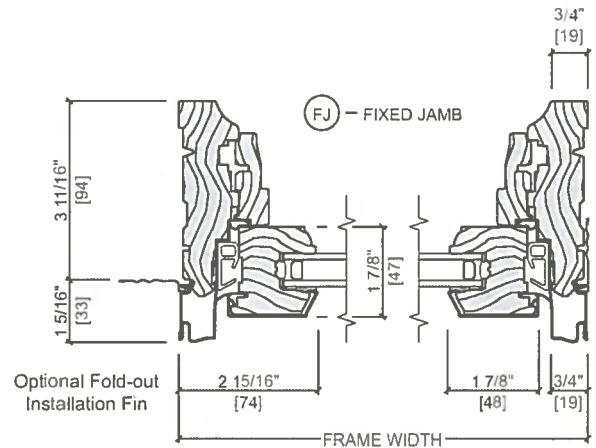
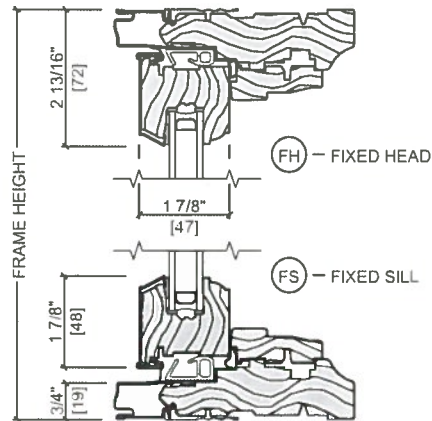
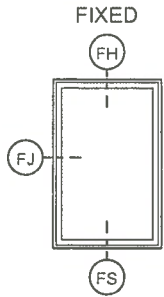
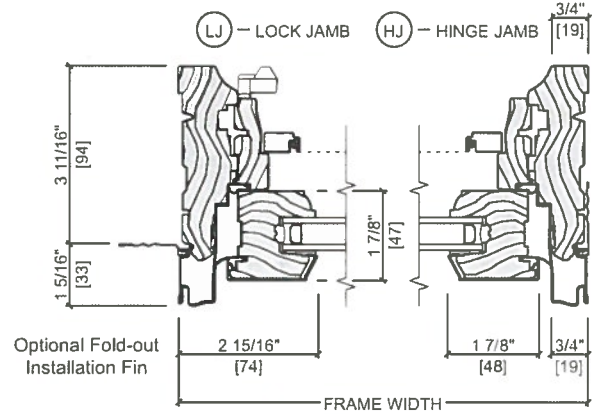
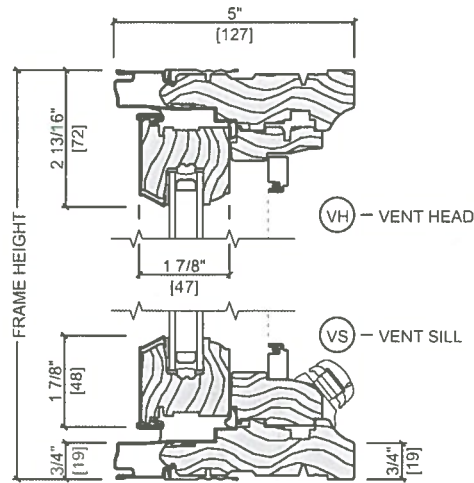
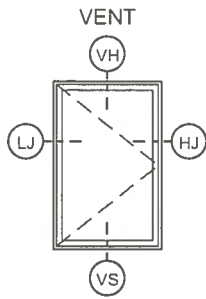

VENT WITH  
ROLSCREEN®  
INSECT SCREEN

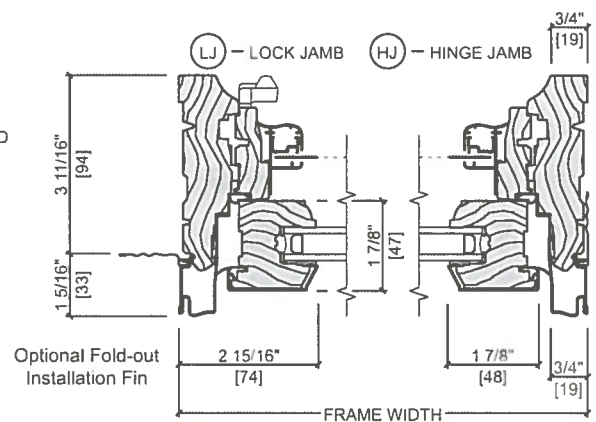

Scale 3" = 1'-0"  
All dimensions are approximate.





# Architect Series® Reserve™ Casement Window

## Unit Sections - Wood Exterior, Putty Glaze Exterior Profile

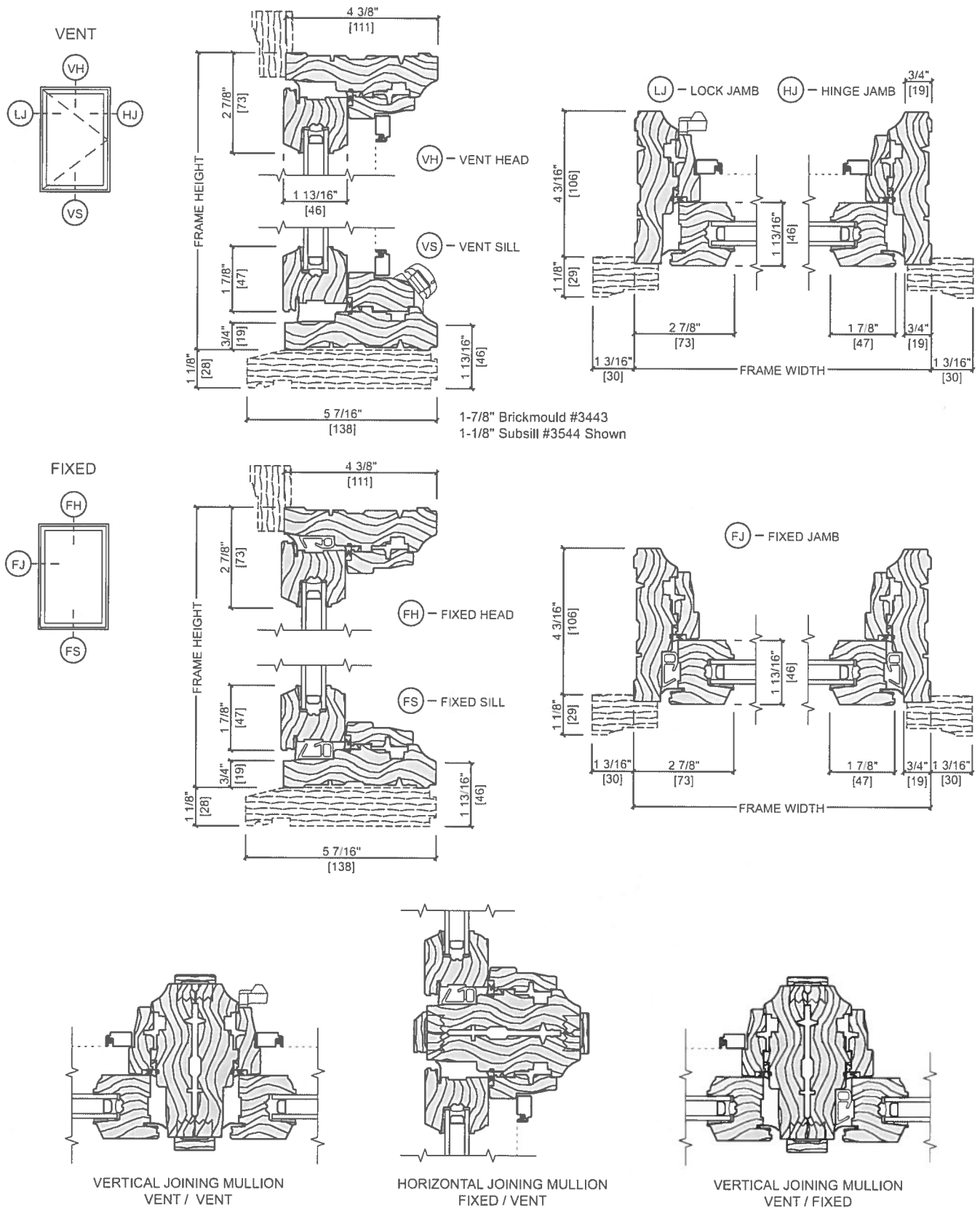

Scale 3" = 1' 0"  
All dimensions are approximate.

**T-47 RESIDENTIAL REAL PROPERTY AFFIDAVIT  
(MAY BE MODIFIED AS APPROPRIATE FOR COMMERCIAL TRANSACTIONS)**

Date: \_\_\_\_\_

GF No. \_\_\_\_\_

Name of Affiant(s): **John Butler and Andrea Fechner**

Address of Affiant: **229 W Hollywood, San Antonio, Tx 78212**

Description of Property: **NCB 6459 Block 10 Lot 7,8,& W 12.5 ft of 9**

County **Bexar**, Texas

"Title Company" as used herein is the Title Insurance Company whose policy of title insurance is issued in reliance upon the statements contained herein.

Before me, the undersigned notary for the State of **Texas**, personally appeared Affiant(s) who after by me being sworn, stated:

1. We are the owners of the Property. (Or state other basis for knowledge by Affiant(s) of the Property, such as lease, management, neighbor, etc. For example, "Affiant is the manager of the Property for the record title owners."):

2. We are familiar with the property and the improvements located on the Property.

3. We are closing a transaction requiring title insurance and the proposed insured owner or lender has requested area and boundary coverage in the title insurance policy(ies) to be issued in this transaction. We understand that the Title Company may make exceptions to the coverage of the title insurance as Title Company may deem appropriate. We understand that the owner of the property, if the current transaction is a sale, may request a similar amendment to the area and boundary coverage in the Owner's Policy of Title Insurance upon payment of the promulgated premium.

4. To the best of our actual knowledge and belief, since **April 13, 2017** there have been no:

- a. construction projects such as new structures, additional buildings, rooms, garages, swimming pools or other permanent improvements or fixtures;
- b. changes in the location of boundary fences or boundary walls;
- c. construction projects on immediately adjoining property(ies) which encroach on the Property;
- d. conveyances, replattings, easement grants and/or easement dedications (such as a utility line) by any party affecting the Property.

EXCEPT for the following (If None, Insert "None" Below:) **None**

5. We understand that Title Company is relying on the truthfulness of the statements made in this affidavit to provide the area and boundary coverage and upon the evidence of the existing real property survey of the Property. This Affidavit is not made for the benefit of any other parties and this Affidavit does not constitute a warranty or guarantee of the location of improvements.

6. We understand that we have no liability to Title Company that will issue the policy(ies) should the information in this Affidavit be incorrect other than information that we personally know to be incorrect and which we do not disclose to the Title Company.

**John Butler**

**Andrea Fechner**

SWORN AND SUBSCRIBED this **26** day of **December**

Notary Public

(TAR-1907) 02-01-2010

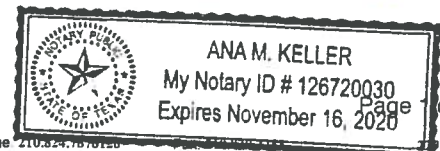

MONTE VISTA SUBDIVISION  
(VOL. 642, PG. 116)  
BLOCK 10, N.C.B. 6459

W. 12.5' OF LOT 37,  
LOTS 38 & 39

LOTS 35, 36 &  
E. 12.5' OF LOT 37

LOTS 33 & 34

14' ALLEY  
N 89°42'57" E 62.56' (F.M.)

LEGEND

These standard symbols will  
be found in the drawing.

- BOUNDARY LINE
- WOOD FENCE
- OVERHEAD ELECTRIC
- PLATTED LOT LINE
- SET IRON ROD
- FOUND IRON ROD
- FOUND "X" ON CONCRETE
- WATER METER
- ELECTRIC METER
- POWER POLE
- (PLAT) RECORDED ON PLAT
- (F.M.) FIELD MEASURED

GRAPHIC SCALE

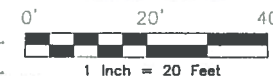

The survey is hereby agreed with the  
discrepancies, conflicts, or shortages in area or  
boundary lines, measurements, dimensions,  
overlapping of improvements, etc.

AARON MICAH REYNOLDS, a Registered Professional Land Surveyor in the State of Texas,  
do hereby certify to  
that the above map is true and correct according to an actual field survey, made by me on the ground  
under my supervision, of the property shown hereon or described by field notes accompanying this drawing. I further  
certify that all easements and rights-of-way of which I have been advised are shown hereon and that, as far as  
as shown, there are no visible encroachments, no visible overlapping of improvements and no apparent  
discrepancies or conflicts in the boundary lines, and no visible physical evidence of encroachments or rights-of-way  
as of the date of this field survey. I further certify that this survey complies with the  
minimum standards established by the Texas Board of Professional Land Surveyors (Section 663.18)  
Borrower Owner: JOHN A. BUTLER II AND ANDREA M. FECHNER  
Address: 229 W. HOLLYWOOD AVE. City No. 1-172477  
Legal Description of the Land:  
Called Lots 7, 8 and the West 1/2 of Lot 9, Block 10, New City Block 6459,  
MONTE VISTA, City of San Antonio, Bexar County, Texas, according to the plat thereof  
recorded in Volume 642, Page 34, Deed and Plat Records of Bexar County, Texas.

FINAL "AS-BUILT" SURVEY

JOB NO.	1704044123	NO.	REVISION	DATE
AT	04-13-1			
DRAWN BY	MM/AM KB			
APPROVED BY	AMR			



Aaron M. Reynolds  
AARON MICAH REYNOLDS, R.P.L.S.  
Registered Professional Land Surveyor  
Registration No. 6644

SUBJECT TO RESTRICTIVE COVENANTS AND/OR EASEMENTS RECORDED IN:  
VOLUME 642, PAGE(S) 34, DEED AND PLAT RECORDS, BEXAR COUNTY, TEXAS  
VOLUME 16817, PAGE 1967, REAL PROPERTY, BEXAR COUNTY, TEXAS

PROPERTY PHOTOGRAPH:



**AMERISURVEYORS LLC**  
1306 NW Loop 436, Suite 446  
Phon: (214) 373-1991  
San Antonio, Texas 78253  
Fax: (214) 373-2492

HOLLYWOOD BOULEVARD  
(58' R.O.W.-PER PLAT)  
(A.K.A. W. HOLLYWOOD AVE.)



# Customer Approval Form:

Signature: \_\_\_\_\_ Date: \_\_\_\_\_

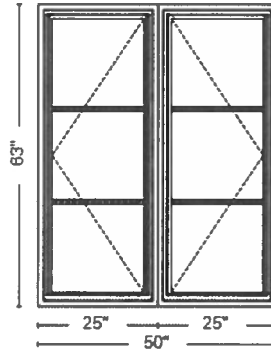

Viewed from the Exterior

**Quote Number:** 11591789

**Line Number:** 30

**Quote Qty:** 1

**Scaling:** 1/2" = 1'

**Description:** Architect Reserve, 2-Wide Casement, 50 X 63, Poplar White

**Rough Opening:** 50.75" X 63.75"

These drawings are based on our interpretation of the information provided to us. They are submitted for final approval of the individual\*\* responsible for the project and are not intended to create any warranty or other liability. The user\*\* is responsible for compliance with applicable building codes or other regulations and determining the suitability of the suggestions for the particular application, including the final design of reinforcement, flashing, and sealant systems for all window and door installations.

\*\* building owner, architect, contractor, installer and/or consumer



**Quote Name:** Clad Wood wondows

**Project Name:** Murray, Kathy

**Jobsite Location:** ,

**Room Location:** Front w Shutters

**Sales Branch Location:** 37000 Pella South Texas

# Customer Approval Form:

Signature: \_\_\_\_\_ Date: \_\_\_\_\_

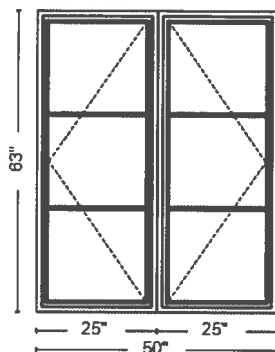

Viewed from the Exterior

Quote Number: 11591789

Line Number: 15

Quote Qty: 1

Scaling: 1/2" = 1'

Description: Lifestyle, 2-Wide Casement, 50 X 63, Brick Red

Rough Opening: 50.75" X 63.75"

These drawings are based on our interpretation of the information provided to us. They are submitted for final approval of the individual\*\* responsible for the project and are not intended to create any warranty or other liability. The user\*\* is responsible for compliance with applicable building codes or other regulations and determining the suitability of the suggestions for the particular application, including the final design of reinforcement, flashing, and sealant systems for all window and door installations.

\*\* building owner, architect, contractor, installer and/or consumer



Quote Name: Clad Wood wondows

Project Name: Murray, Kathy

Jobsite Location: ,

Room Location: Front w Shutters

Sales Branch Location: 37000 Pella South Texas

# Customer Approval Form:

Signature: \_\_\_\_\_ Date: \_\_\_\_\_

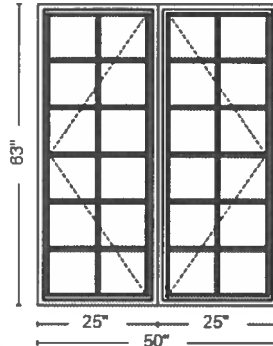

Viewed from the Exterior

**Quote Number:** 11591789

**Line Number:** 20

**Quote Qty:** 1

**Scaling:** 1/2" = 1'

**Description:** Lifestyle, 2-Wide Casement, 50 X 63, Brick Red

**Rough Opening:** 50.75" X 63.75"

These drawings are based on our interpretation of the information provided to us. They are submitted for final approval of the individual\*\* responsible for the project and are not intended to create any warranty or other liability. The user\*\* is responsible for compliance with applicable building codes or other regulations and determining the suitability of the suggestions for the particular application, including the final design of reinforcement, flashing, and sealant systems for all window and door installations.

\*\* building owner, architect, contractor, installer and/or consumer



**Quote Name:** Clad Wood wondows

**Project Name:** Murray, Kathy

**Jobsite Location:** ,

**Room Location:** None Assigned

**Sales Branch Location:** 37000 Pella South Texas



# Customer Approval Form:

Signature: \_\_\_\_\_ Date: \_\_\_\_\_

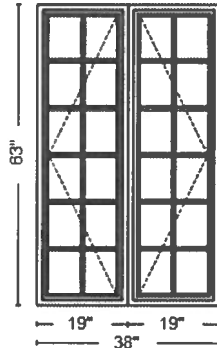

Viewed from the Exterior

**Quote Number:** 11591789

**Line Number:** 25

**Quote Qty:** 2

**Scaling:** 1/2" = 1'

**Description:** Lifestyle, 2-Wide Casement, 38 X 63, Brick Red

**Rough Opening:** 38.75" X 63.75"

These drawings are based on our interpretation of the information provided to us. They are submitted for final approval of the individual\*\* responsible for the project and are not intended to create any warranty or other liability. The user\*\* is responsible for compliance with applicable building codes or other regulations and determining the suitability of the suggestions for the particular application, including the final design of reinforcement, flashing, and sealant systems for all window and door installations.

\*\* building owner, architect, contractor, installer and/or consumer



**Quote Name:** Clad Wood wondows

**Project Name:** Murray, Kathy

**Jobsite Location:** ,

**Room Location:** None Assigned

**Sales Branch Location:** 37000 Pella South Texas