

HISTORIC AND DESIGN REVIEW COMMISSION

September 18, 2019

HDRC CASE NO: 2019-518
ADDRESS: 15701 O'CONNOR RD
COMMON NAME: FRIESENHAHN PARK
LEGAL DESCRIPTION: NCB 17756 P-8A
ZONING: R-6
CITY COUNCIL DIST.: 10
APPLICANT: Marc Zak/Terra Design Group
OWNER: City of San Antonio
TYPE OF WORK: Park improvements
APPLICATION RECEIVED: August 30, 2019
60-DAY REVIEW: October 29, 2019
CASE MANAGER: Stephanie Phillips
REQUEST:

The applicant is requesting a Certificate of Appropriateness to perform various park improvements, to include the extension of an existing trail through the park site and the creation of a park maintenance entryway on Classen Rd.

APPLICABLE CITATIONS:

UDC Sec. 35-641. - Design Considerations for Historic and Design Review Commission Recommendations.

In reviewing an application, the historic and design review commission shall be aware of the importance of attempting to find a way to meet the current needs of the City of San Antonio, lessee or licensee of public property. The historic and design review commission shall also recognize the importance of recommending approval of plans that will be reasonable to implement. The best urban design standards possible can and should be employed with public property including buildings and facilities, parks and open spaces, and the public right-of-way. Design and construction on public property should employ such standards because the use of public monies for design and construction is a public trust. Public commitment to quality design should encourage better design by the private sector. Finally, using such design standards for public property improves the identity and the quality of life of the surrounding neighborhoods.

UDC Sec 35-642. – New Construction of Buildings and Facilities

In considering whether to recommend approval or disapproval of a certificate, the historic and design review commission shall be guided by the following design considerations. These are not intended to restrict imagination, innovation or variety, but rather to assist in focusing on design principles, which can result in creative solutions that will enhance the city and its neighborhoods. Good and original design solutions that meet the individual requirements of a specific site or neighborhood are encouraged and welcomed.

(a) Site and Setting.

(1) Building sites should be planned to take into consideration existing natural climatic and topographical features. The intrusive leveling of the site should be avoided. Climatic factors such as sun, wind, and temperature should become an integral part of the design to encourage design of site-specific facilities which reinforces the individual identity of a neighborhood and promotes energy efficient facilities.

(2) Special consideration should be given to maintain existing urban design characteristics, such as setbacks, building heights, streetscapes, pedestrian movement, and traffic flow. Building placement should enhance or create focal points and views. Continuity of scale and orientation shall be emphasized.

(3) Accessibility from streets should be designed to accommodate safe pedestrian movement as well as vehicular traffic. Where possible, parking areas should be screened from view from the public right-of-way by attractive fences, berms, plantings or other means.

(4) Historically significant aspects of the site shall be identified and if possible incorporated into the site design. Historic relationships between buildings, such as plazas or open spaces, boulevards or axial relationships should be maintained.

(b) Building Design.

(1) Buildings for the public should maintain the highest quality standards of design integrity. They should elicit a pride of ownership for all citizens. Public buildings should reflect the unique and diverse character of San Antonio and should be responsive to the time and place in which they were constructed.

- (2) Buildings shall be in scale with their adjoining surroundings and shall be in harmonious conformance to the identifying quality and characteristics of the neighborhood. They shall be compatible in design, style and materials. Reproductions of styles and designs from a different time period are not encouraged, consistent with the secretary of the interior's standards. Major horizontal and vertical elements in adjoining sites should be respected.
- (3) Materials shall be suitable to the type of building and design in which they are used. They shall be durable and easily maintained. Materials and designs at pedestrian level shall be at human scale, that is they shall be designed to be understood and appreciated by someone on foot. Materials should be selected that respect the historic character of the surrounding area in texture, size and color.
- (4) Building components such as doors, windows, overhangs, awnings, roof shapes and decorative elements shall all be designed to contribute to the proportions and scale of their surrounding context. Established mass/void relationships shall be maintained. Patterns and rhythms in the streetscape shall be continued.
- (5) Colors shall be harmonious with the surrounding environment, but should not be dull. Choice of color should reflect the local and regional character. Nearby historic colors shall be respected.
- (6) Mechanical equipment or other utility hardware should be screened from public view with materials compatible with the building design. Where possible, rooftop mechanical equipment should be screened, even from above. Where feasible, overhead utilities should also be underground or attractively screened. Exterior lighting shall be an integral part of the design. Interior lighting shall be controlled so that the spillover lighting onto public walkways is not annoying to pedestrians.
- (7) Signs which are out of keeping with the character of the environment in question should not be used. Excessive size and inappropriate placement on buildings results in visual clutter. Signs should be designed to relate harmoniously to exterior building materials and colors. Signs should express a simple clear message with wording kept to a minimum.
- (8) Auxiliary design. The site should take into account the compatibility of landscaping, parking facilities, utility and service areas, walkways and appurtenances. These should be designed with the overall environment in mind and should be in visual keeping with related buildings, structures and places.

Unified Development Code Sec. 35-640. - Public Property and Rights-of-Way.

- (a) Public Property. Generally, the historic and design review commission will consider applications for actions affecting the exterior of public properties except in the case of building interiors that are the sites of major public assemblies or public lobbies. The historic and design review commission will also consider applications for actions affecting public properties such as city parks, open spaces, plazas, parking lots, signs and appurtenances.
- (b) Public Rights-of-Way. Generally, the historic and design review commission will consider applications for actions affecting public rights-of-way whose construction or reconstruction exceeds in quality of design or materials standards of the design manual of the public works department.

Unified Development Code Sec. 35-646. - Construction in Public Rights-of-Way.

- (a) General Provisions. All construction in the public right-of-way shall conform to all city codes. In considering an application, the historic and design review commission shall be guided by the following:
- (1) Sidewalk Zones. Pedestrian movement should be pleasant, allowing for store browsing, comfortable transit waiting and easy accessibility for disabled people. Where possible, sidewalks should at least five (5) feet in width. Existing sidewalks should not be narrowed when replaced.
- (2) Sidewalk Paving and Surfaces. Materials should complement stylistic differences of individual buildings, particularly when related to historic buildings.
- A. Materials. Materials should be chosen for beauty, strength, longevity, easy maintenance and traction when dry or wet.
 - B. Color and Texture. To ensure the safety of pedestrians, all changes in surfaces should be defined by contrasting color, texture or materials.
- (3) Street Features and Arrangements. Historic districts and the downtown, as well as other distinct areas of the city have diverse character and any street furniture selected for these areas should complement these differences. In addition, the clustering of street furniture in one (1) place is recommended. Trash receptacles, seating, telephones and other street furniture should be grouped together.
- A. Circulation. A clear path-of-travel of thirty-six (36) inches wide shall be maintained in and around street features

and arrangement.

- B. Seating. Seating should be physically comfortable and inviting, durable and attractive. Plaza and open space seating should also be socially comfortable by offering a variety of choices such as in the sun or shade, near traffic and activity or not, and alone or in groups.
- C. Drinking Fountains. Placing drinking fountains in new development is encouraged. Fountains should be placed within general areas of pedestrian traffic and located on accessible surfaces.
- D. Trash Receptacles. Trash receptacles should blend visually with their surroundings and their design and location should make use as convenient as possible.
- E. Vending Machines. Vending machines will not dispense items other than newspapers and periodicals. Vending machines shall be clustered together and away from intersection corners.
- F. Vending Carts and Kiosks. Vending carts and kiosks are encouraged in locations that do not impede normal pedestrian traffic.
- G. Outdoor Dining. Lease of public right-of-way for outdoor dining is encouraged in appropriate locations. Lease of sidewalk space for outdoor dining shall be managed through the department of parks and recreation and shall comply with all city codes. It is recommended that at least eight (8) feet of sidewalk be retained between the curb and the leased or licensed space to provide an uninterrupted public walkway.
- H. Street Objects. Utility boxes, vending machines and so on should not be located in sidewalk zones. Their design and color should be compatible with character of their surroundings.

(4) Streetscape Landscaping. Landscaping, particularly streets trees, are an important addition to the streetscape because of the hot Texas climate. Appropriate application along sidewalks strengthens the visual quality of public streets. Careful selection of plant materials, using native and low-water use plants, is recommended.

(Ord. No. 98697 § 6)

Sec. 35-645. - Signs and Billboards on Public Property or Right-of-Way.

(a) General Provisions. All non-regulatory signage on public property, on the public right-of-way, or overhanging the public right-of-way shall conform to all city codes and must be approved by the historic preservation officer prior to installation. Permits must be obtained following approval of the application. The historic preservation officer may submit an application under this section to the historic and design review commission for their recommendation prior to approving, denying, or approving with conditions the application. Memorials, markers, naming rights of public property, and recognition of charitable donations given to the City of San Antonio shall be additionally governed by existing policies for memorials and markers and/or any formal action passed by city council. Temporary displays approved by the department exercising control of the public property are authorized if in accordance with chapter 28 of the City Code of San Antonio, Texas.

(b) Sign Definitions. For signage definitions, refer to subsection 35-612(b) and chapter 28 of the City Code.

(c) Proportion of Signs. Signage width and height must be in proportion to the facade, respecting the size, scale and mass of the facade, building height, and rhythms and sizes of window and door openings. The building facade shall be considered as part of an overall sign program but the sign shall be subordinate to the overall building composition. Additionally, signs should respect and respond to the character and/or period of the area in which they are being placed.

(d) Standards for Sign Design and Placement. In considering whether to recommend approval or disapproval of an application for a certificate to construct or alter signage on a building, object, site, or structure, the historic and design review commission shall be guided by the following standards in addition to any specific design guidelines adopted by city council:

- (1) Primary sign design considerations shall be identification and legibility. Size, scale, height, color and location of signs shall be harmonious with, and properly related to, the overall design of the building or structure and the surrounding area.
- (2) The number of signs on each building shall be kept to a minimum to prevent unsightly clutter and confusion.
- (3) Signs which describe, point, or direct the reader to a specific place or along a specific course, such as "entrance," "exit," and "handicap access" shall be reviewed.
- (4) All graphic elements shall reinforce the architectural integrity of any building. Signs should not disfigure, damage, mar, alter, or conceal architectural features or details and should be limited to sizes which are in scale with the architecture and the streetscape. The historic and design review commission shall be guided by the building's proportion and scale

when such elements are incorporated.

(5) Additionally, when reviewing applications for signage the historic preservation officer and the historic and design review commission shall consider the visual impact on nearby historic resources and established neighborhood character.

(f) Prohibited Signs. Signs that shall not be permitted include:

(1) Any sign placed upon a building, object, site, or structure in any manner so as to disfigure, damage, interrupt, or conceal any window opening, door, or significant architectural feature or detail of any building;

(2) Roof mounted signs, except in the cases of (i) integral design with the building; (ii) a contributing sign; (iii) or otherwise allowed in this article;

(3) Digital and/or LED lighted signs, not to include LED light sources that do not meet the definition of a sign, with or without rotating, flashing lettering, icons or images. Except as provided below:

A. A public transportation agency may incorporate transit information signage into transit shelters, utilizing LED or digital technology, provided the signage is contained within or under the transit shelter, and is limited to five (5) square feet of signage area, and one (1) sign per thirty (30) linear feet of pedestrian shelter.

B. A public transportation agency may incorporate transit information signage into a monument sign at transit stops, utilizing LED or digital technology, provided it is limited to five (5) square feet of signage area.

C. A public transportation agency may incorporate transit information signage into a monument sign at transit facilities (other than transit stops), utilizing LED or digital technology, provided it is limited to seven (7) square feet of signage area.

D. The historic preservation officer may impose additional restrictions on illumination to ensure that the character of signs are harmonious with the character of the structures on which they are to be placed and any designated landmarks or districts in the area, provided that such restrictions are reasonably related to other conforming signs and conforming structures in the area, do not unreasonably restrict the amount of signage allowed by this section, and are in keeping with the intent of this section. Among other things, consideration shall be given to the location and illumination of the sign in relation to the surrounding buildings, the use of appropriate materials, the size and style of lettering and graphics, and the type of lighting proposed. Notwithstanding the above, applicants may not exceed illumination restrictions contained in chapter 28.

FINDINGS:

- a. The property located at 15701 O'Connor Rd, northeast of Downtown, is a public park with the common name of Friesenhahn Park. The applicant is requesting approval to carry out various park improvements.
- b. PARK IMPROVEMENTS – The applicant has proposed various park improvements, to include the extension of an existing trail through the park site and the creation of a park maintenance entryway off Classen Rd. Staff finds the proposal consistent with the UDC.
- c. ARCHAEOLOGY – The project shall comply with all federal, state, and local laws, rules, and regulations regarding archaeology.

RECOMMENDATION:

Staff recommends approval of the proposed park improvements based on findings a through c with the following stipulation:

- i. ARCHAEOLOGY – The project shall comply with all federal, state, and local laws, rules, and regulations regarding archaeology.

City of San Antonio One Stop

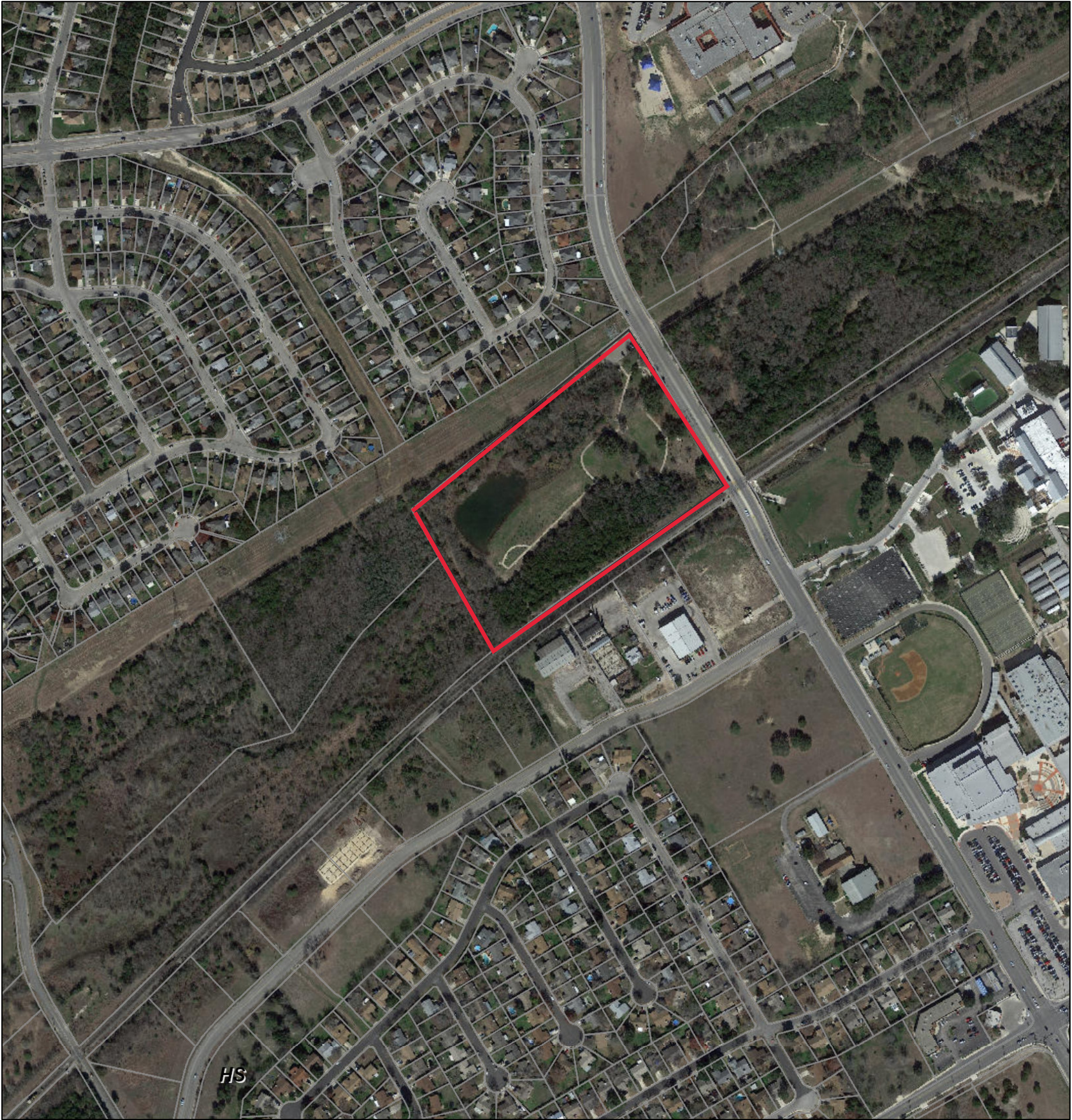

September 12, 2019

- User drawn lines
- Community Service Centers
- Pre-K Sites
- CoSA Parcels
- BCAD Parcels

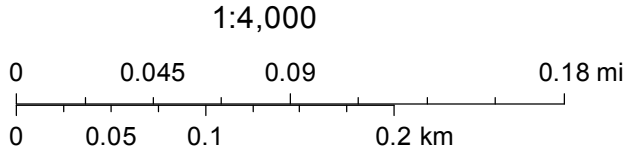

CoSA



August 29, 2019

City of San Antonio
Office of Historic Preservation
1901 South Alamo
San Antonio, Texas 78204

To whom it may concern:

The following is a detailed description of the improvements proposed for Friesenhahn Park to be considered appropriate by the Office of Historic Preservation.

1. Extend the existing trail through the park site, 2,175 linear feet, 6'-0" wide, to be in the same likeness and character of the existing trail.
2. Park maintenance entry on Classen Road.

Please let us know if you have any questions or comments regarding the proposed improvements at Friesenhahn Park.

Respectfully,

A handwritten signature in blue ink, appearing to read "Marc R. Zak", with a stylized flourish at the end.

Marc R. Zak, PLA



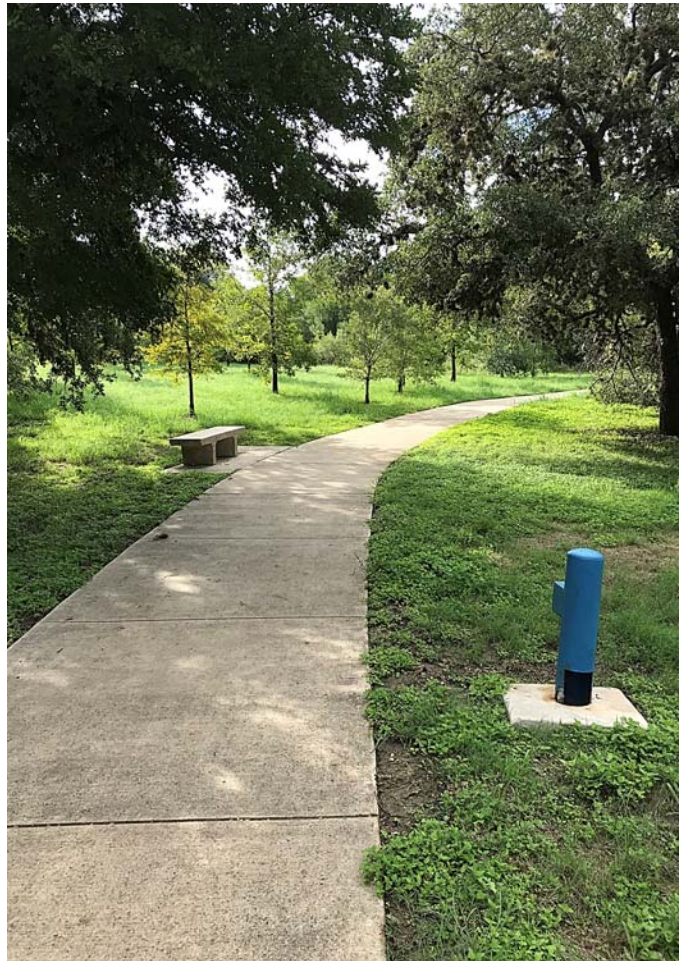
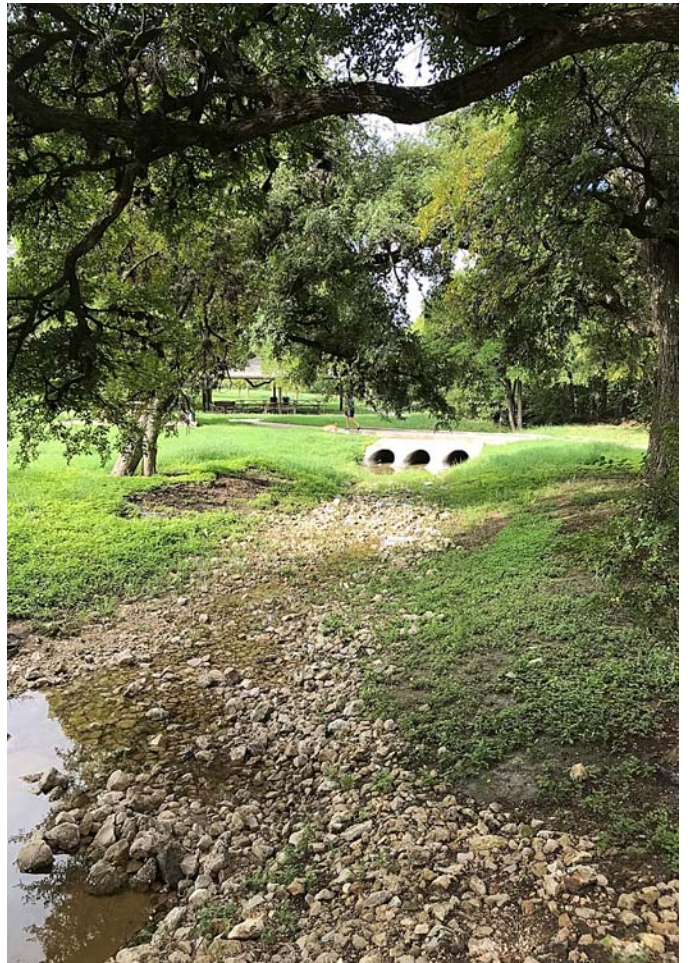







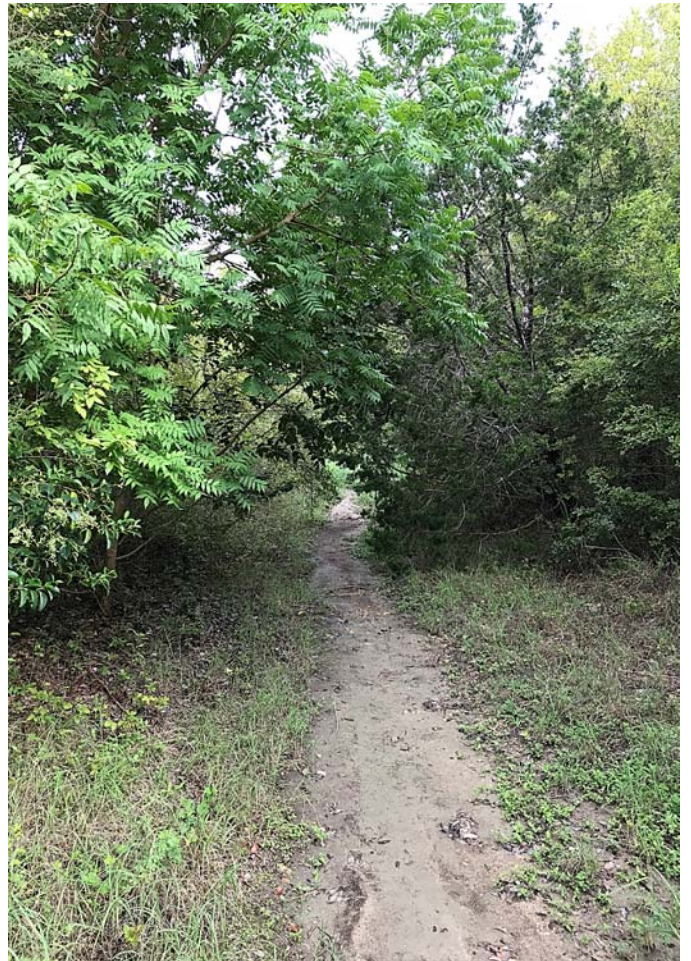





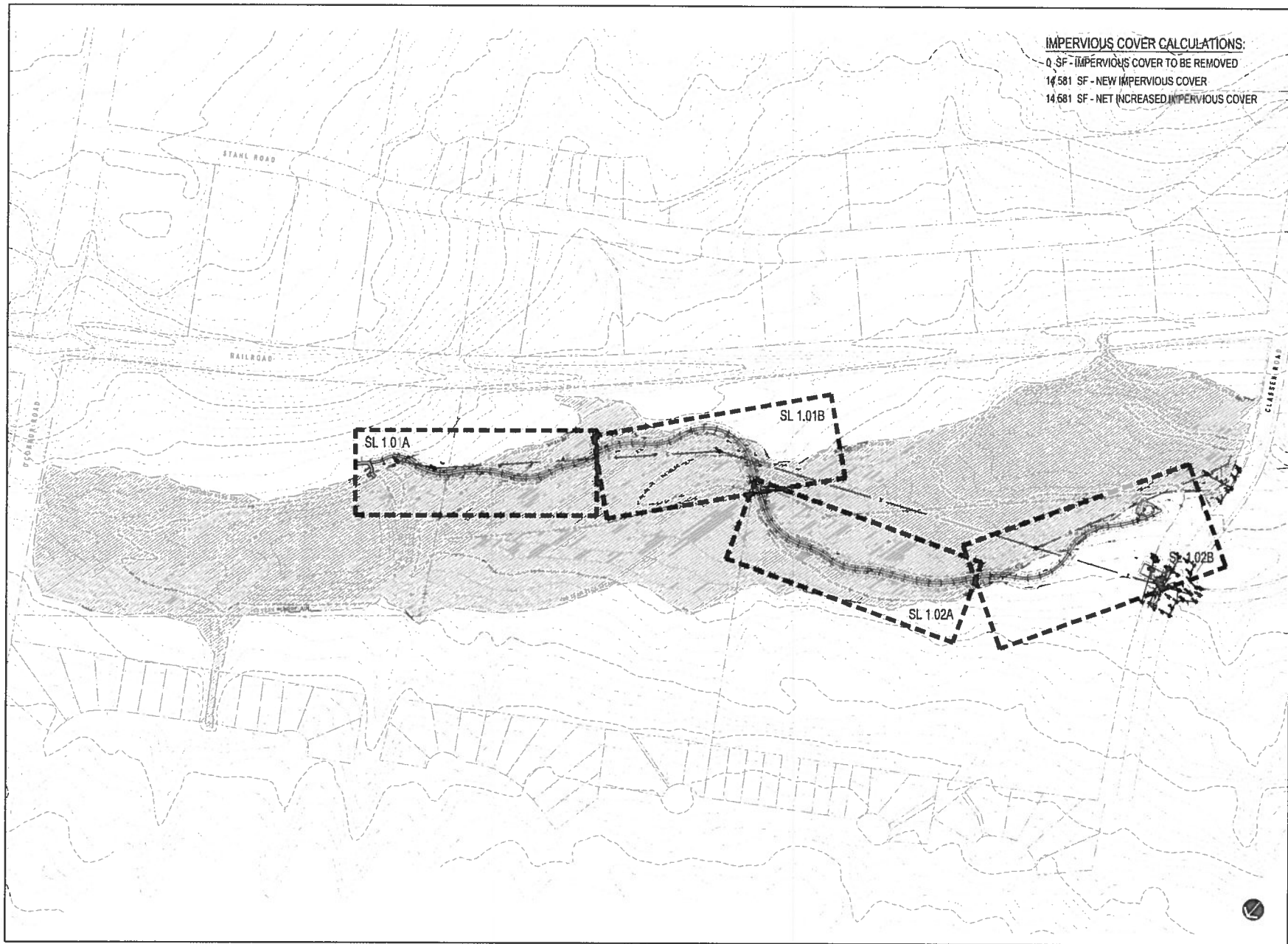

IMPERVIOUS COVER CALCULATIONS:
 0 SF - IMPERVIOUS COVER TO BE REMOVED
 14,581 SF - NEW IMPERVIOUS COVER
 14,681 SF - NET INCREASED IMPERVIOUS COVER



Tdg

terra design group, inc.
 2318 W. Hwy. 410
 San Antonio, Texas 78217
 210.220.1400
 210.220.1401
 tdesign@terradesigngroup.com

**FRIESENHAHN
 PARK**

15701 O'Conner Road
 San Antonio, Texas 78247



REVISION DATE

Project no. _____
 Date: _____
 Sheet: _____

**OVERALL
 SITE LAYOUT
 AND GRADING
 SL 1.00**

Construction Documents



terra design group, inc.
2315 rue lazar, 413
San Antonio, Texas 78217
210.220.1400
210.220.1401
mca@terradesigngroup.com

FRIESENHAHN PARK

15701 O'Conner Road
San Antonio, Texas 78247

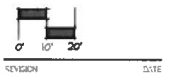

Project no:
Date: August 8, 2019
Sheet:

**SITE LAYOUT
AND GRADING**

SL 1.01

Construction Document

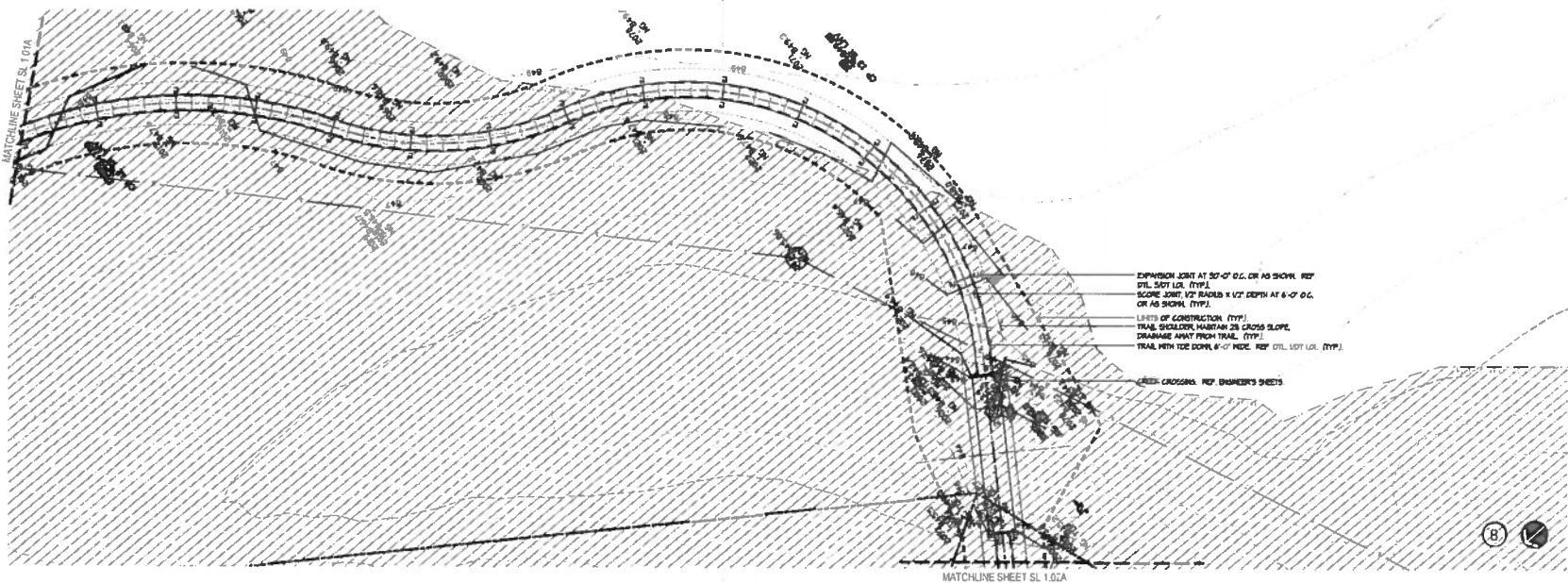
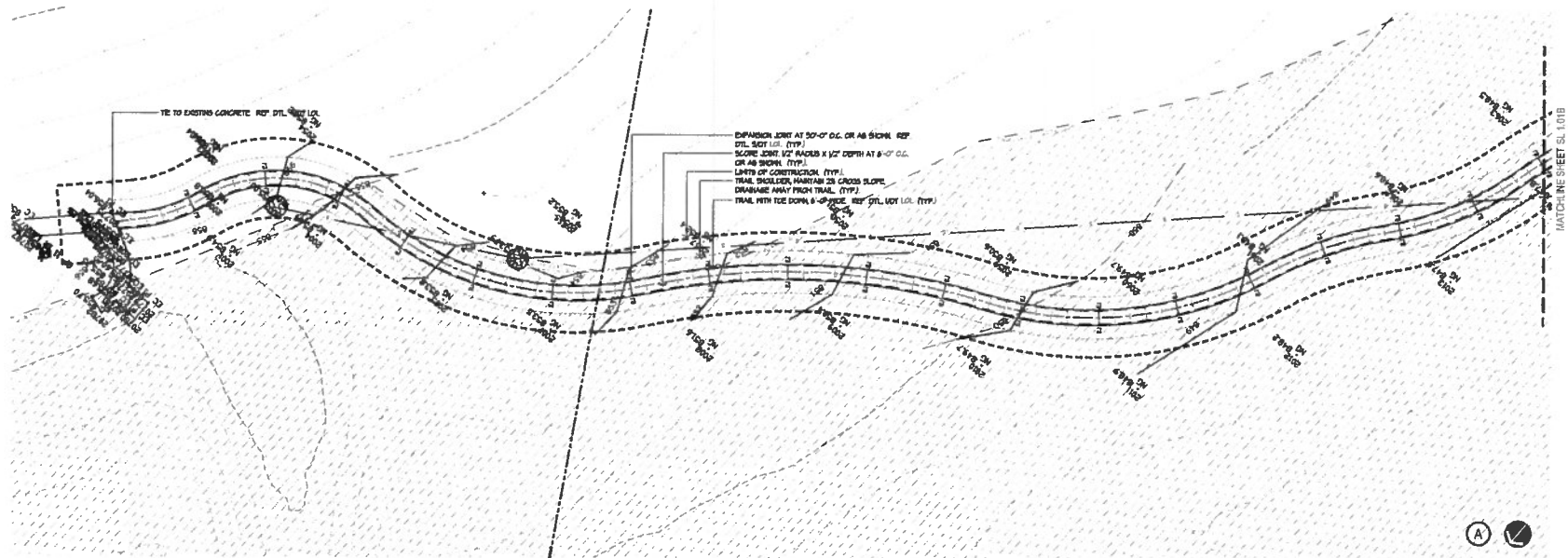



terra design group, inc.
2315 ne Loop 110
San Antonio, Texas 78217
210.220.1400
210.220.1404
www.terradesigngroup.com

FRIESENHAHN PARK

15701 O'Conner Road
San Antonio, Texas 78247



REVISION DATE

Project No: 15701
Date: August 9, 2018
Sheet:

**SITE LAYOUT
AND GRADING**

SL 1.02

On Station Documents

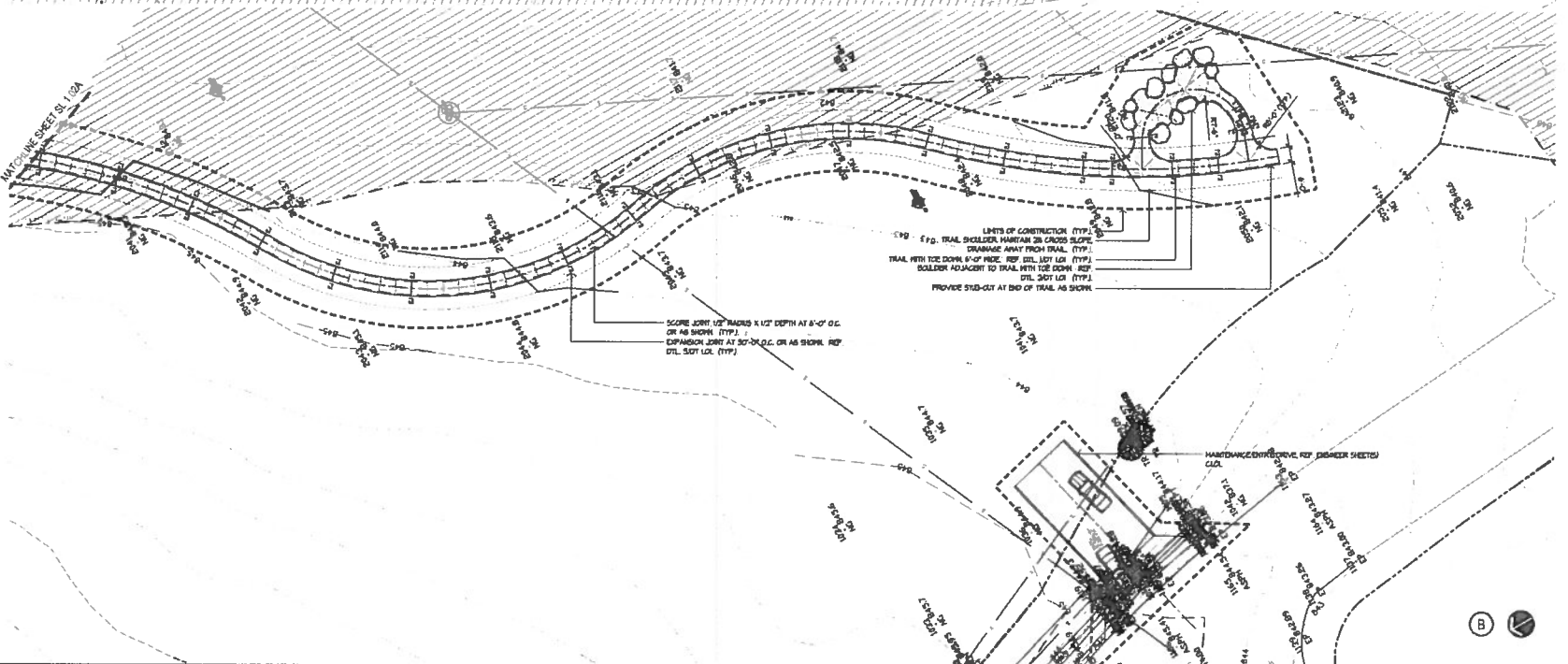
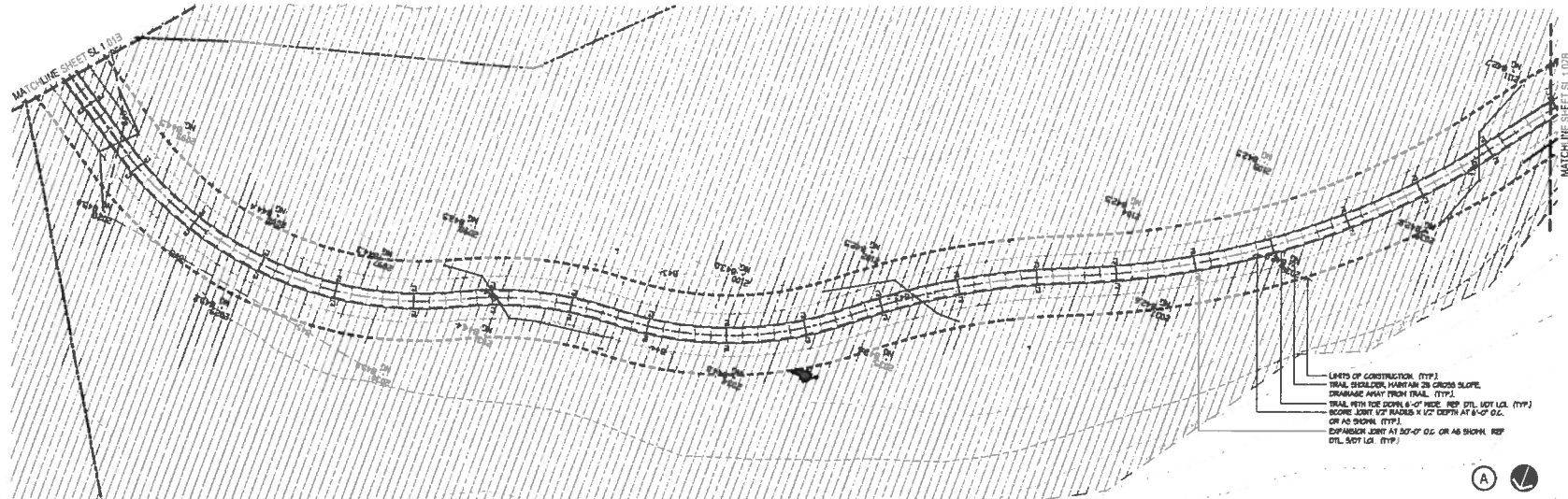



terra design group, inc.
21516 MacP 413
San Antonio, Texas 78217
210.220.1400
710.220.1400
mail@terradesigngroup.com

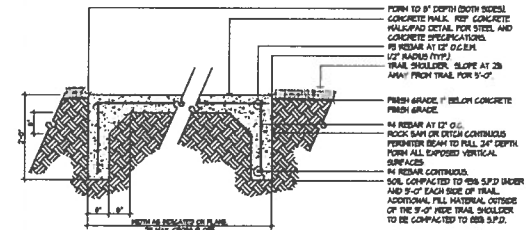

① SECTION: CONCRETE WALK WITH TOE DOWN
Scale: 3/4" = 1'-0"

- NOTES:
1. BOLLARD SIZES RANGE FROM 3'-4" X 3'-4" X 2'-1" TO 3'-4" X 3'-4" X 3'-1". BOLLARD SIZES TO BE SCALED FROM LAYOUT SHEETS.
2. BOLLARDS SMALLER THAN 3'-4" X 3'-4" X 2'-1" WILL NOT BE ACCEPTED.
3. FIELD COLLECTED BOLLARDS OF THE SPECIFIED SIZE ARE ACCEPTABLE.

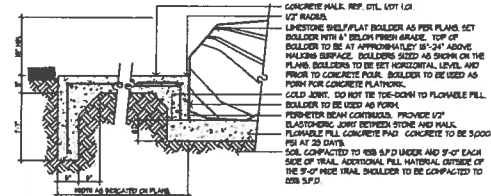

② SECTION: CONCRETE TO ROCK
Scale: 3/4" = 1'-0"

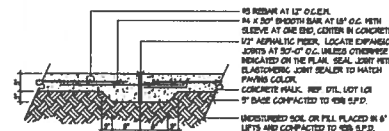

③ SECTION: EXPANSION JOINT
Scale: 3/4" = 1'-0"

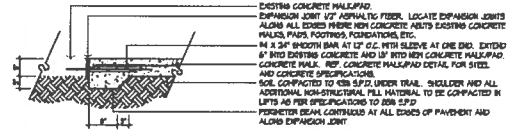

④ SECTION: WALK AT EXISTING CONCRETE WALK
Scale: 3/4" = 1'-0"

FRIESENHAHN
PARK

15701 O'Conner Road
San Antonio, Texas 78247

REVISION DATE

Project no. August 18, 2019
Sheet:

SITE
DETAILS

DT 1.01

Construction Documents



THESE SHEETS ARE FOR PRELIMINARY REVIEW ONLY. IT IS NOT TO BE USED FOR CONSTRUCTION DOCUMENTS.



Terra design group, inc.
2715 rue laurier #10
San Antonio, Texas 78211
710.220.1670
info@terradesign.com

T-Core Engineers

1001 East of River Street, Suite 100, San Antonio, TX 78204
210.220.1670



SCALE: 1" = 10'(H)
SCALE: 1" = 2'(V)

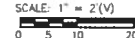

NOTES

1. CONTRACTOR TO POUR THICKENED SLAB OF 8" TO MEET PROPOSED BOX FLOWLINE. THICKENED SLAB WILL REDUCE OPENING HEIGHT OF BOX BY 1".
2. WHERE STONE RIPRAP PROTECTION MEETS PROPOSED TRAIL, THE TOP OF THE STONE PROTECTION SHALL MATCH PROPOSED TRAIL GRADE.

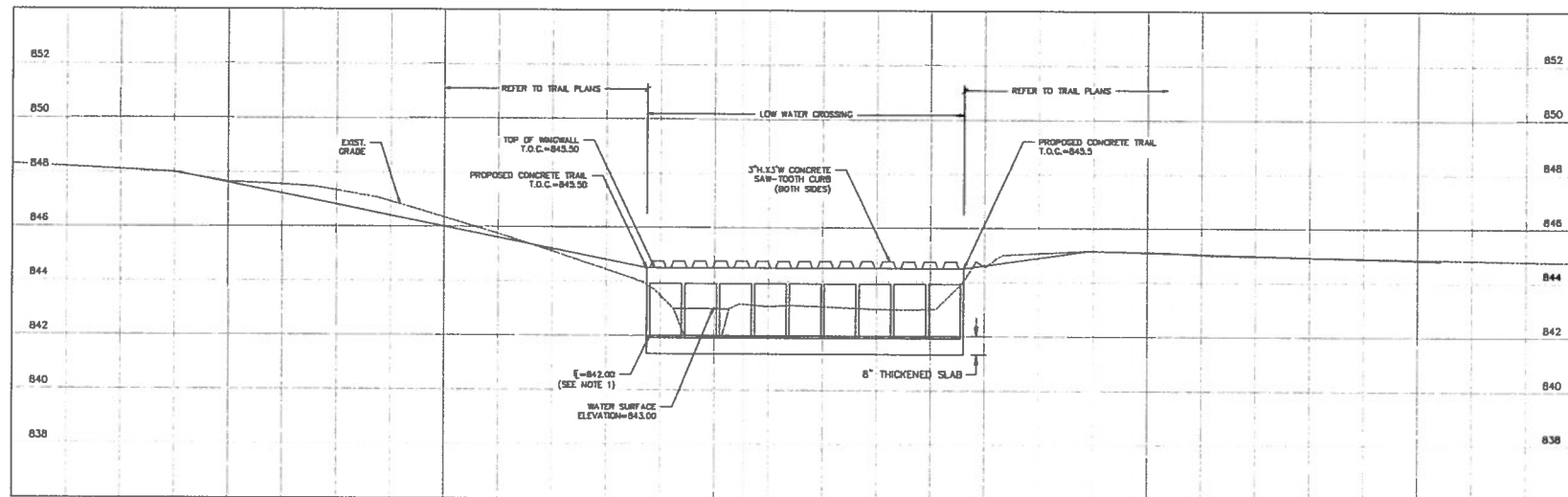
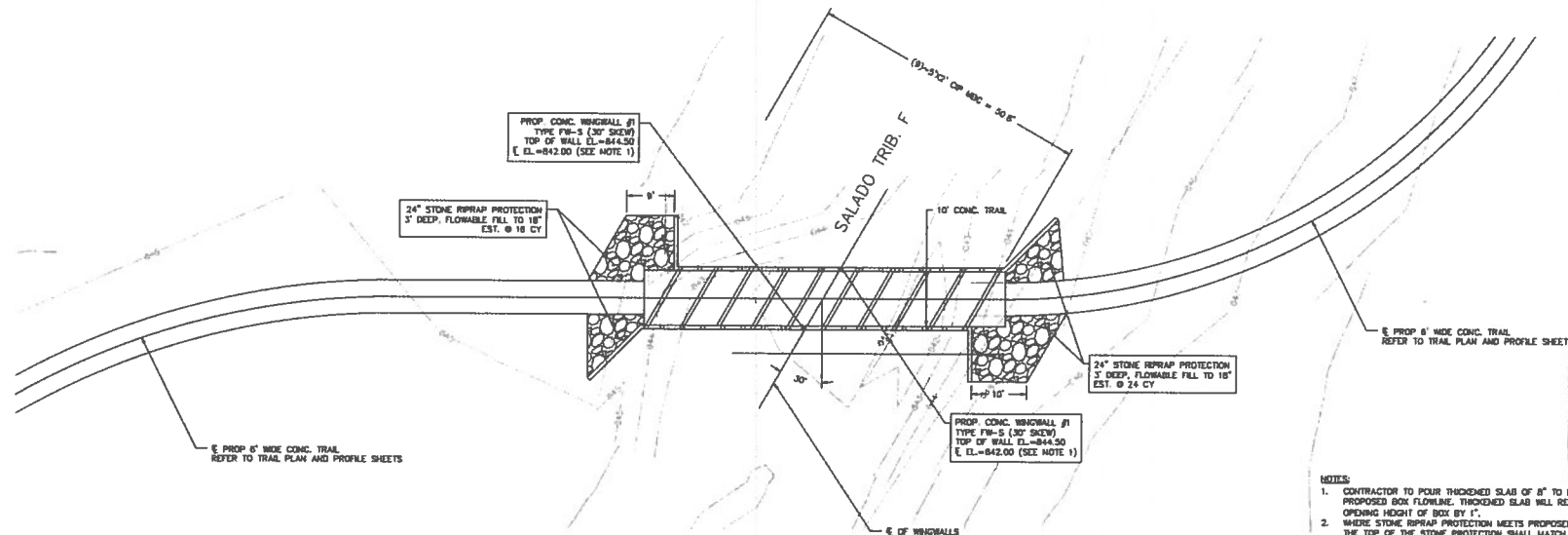

FRIESENHAHN
PARK

15701 O'Conner Road
San Antonio, Texas 78247

REVISION DATE

Project no:
Date:
Sheet:

CULVERT
LAYOUT

CL 1.01

Construction Documents (100%)

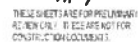
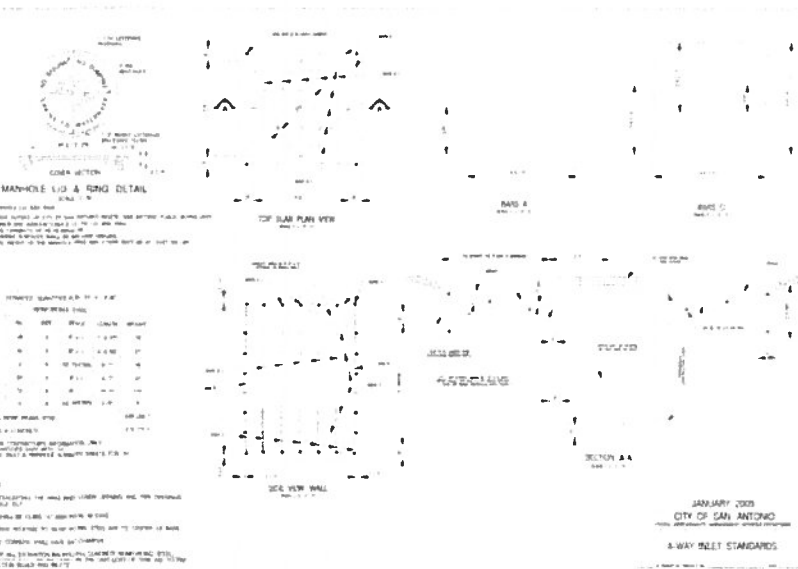
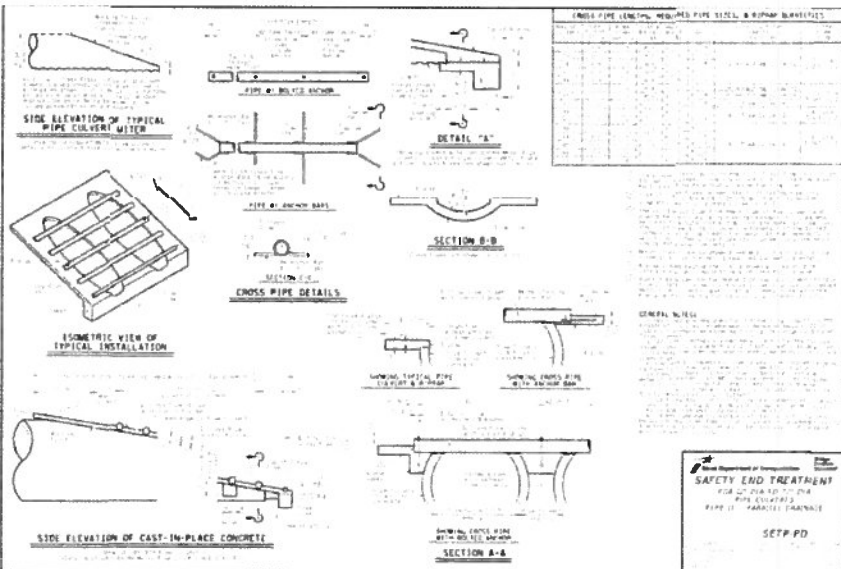
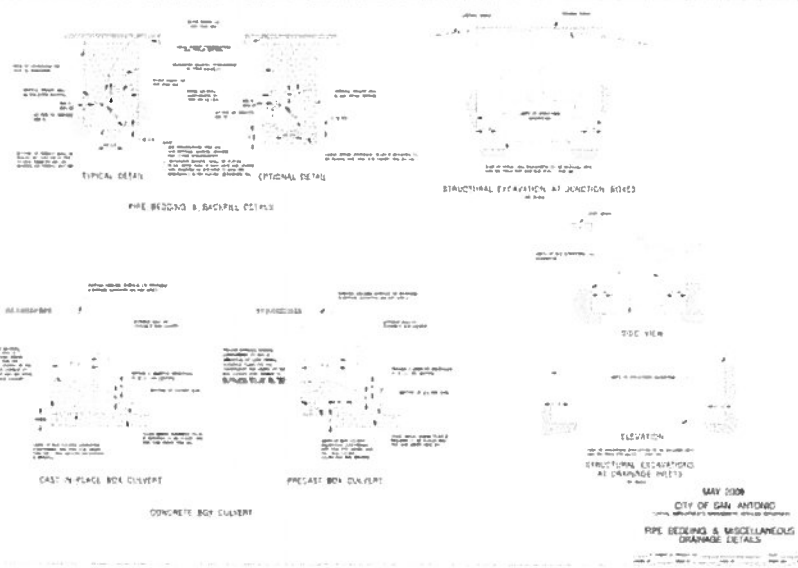
[illegible][illegible][illegible]

Tdg

2015 release 410
 date enforced: 04/01/2017
 210.220 14.0
 210.230 14.0
 www.ecfr.gov



© 2007 Pearson Education, Inc. All rights reserved. This publication is protected by copyright. Any unauthorized reproduction or distribution, in whole or in part, without written permission from Pearson Education, Inc., may result in legal action against you.

FRIESENHAHN
PARK

15701 O'Conner Road
San Antonio, Texas 78247

SYDOW DATE

Project no.
Date.
Sheet 2 OF 2

FRIESENHAHN
PARK
ENTRY DRIVE

C1.02

Construction Documents (100%)