

BRANCH PRUNING DETAIL

NOTE: DO NOT CUT FROM D TO E.

A. FIRST CUT - TO PREVENT THE BARK FROM BEING PEELED WHEN THE BRANCH FALLS.
B. SECOND CUT - TO REDUCE THE WEIGHT OF BRANCH.
C. FINAL CUT - ALLOW FOR HEALING COLLAR BUT NO STUBS
D. BRANCH RIDGES - INDENT PROPERLY BRANCH RIDGES WHICH ARE SITE FOR DECAY.

FOR OAKS ONLY: PAINT ALL WOUNDS OR CUTS WITH PRUNING PAINT WITHIN 20 MIN TO PREVENT THE SPREAD OF OAK WILT.

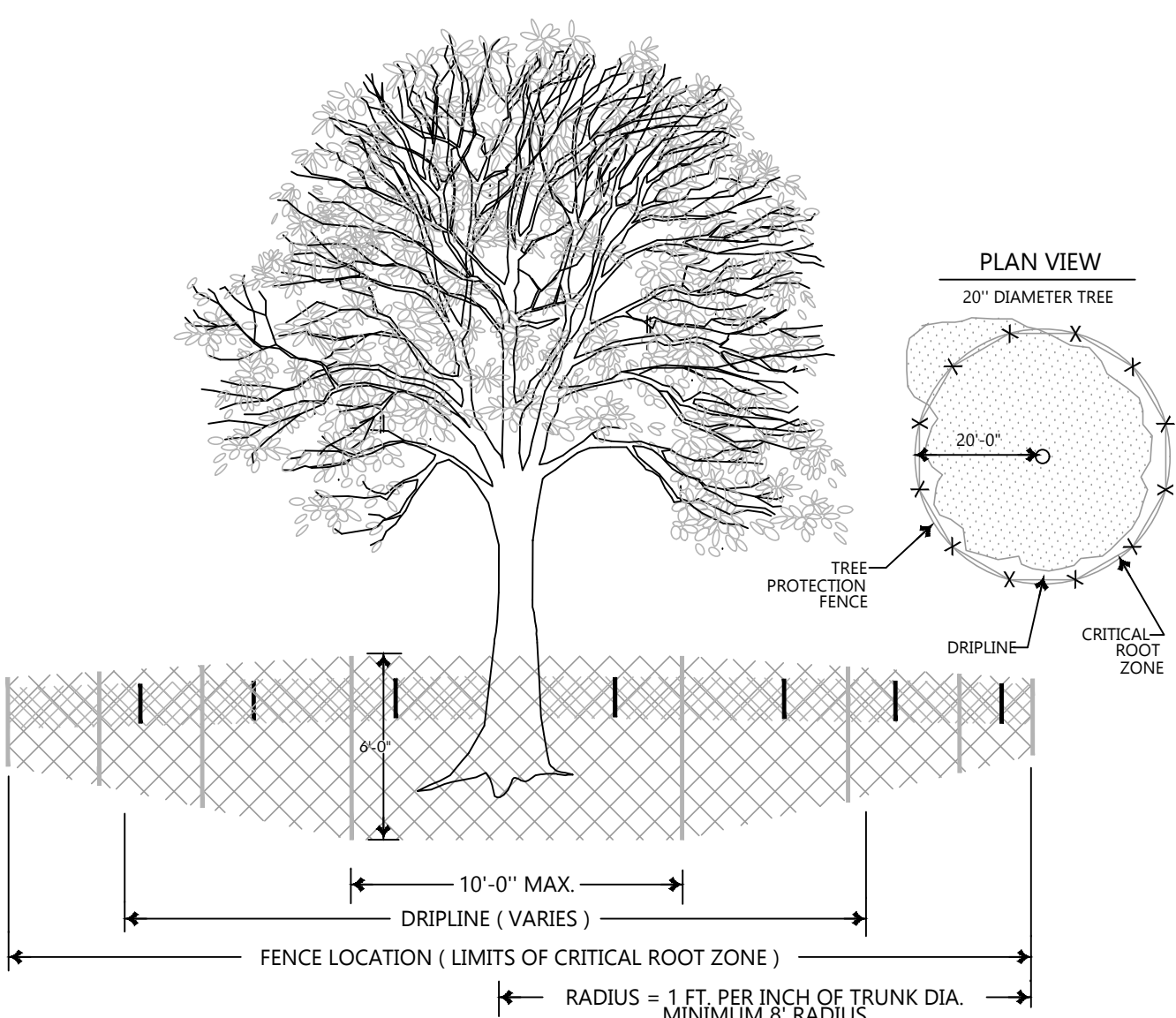

TREE PROTECTION FENCING DETAIL

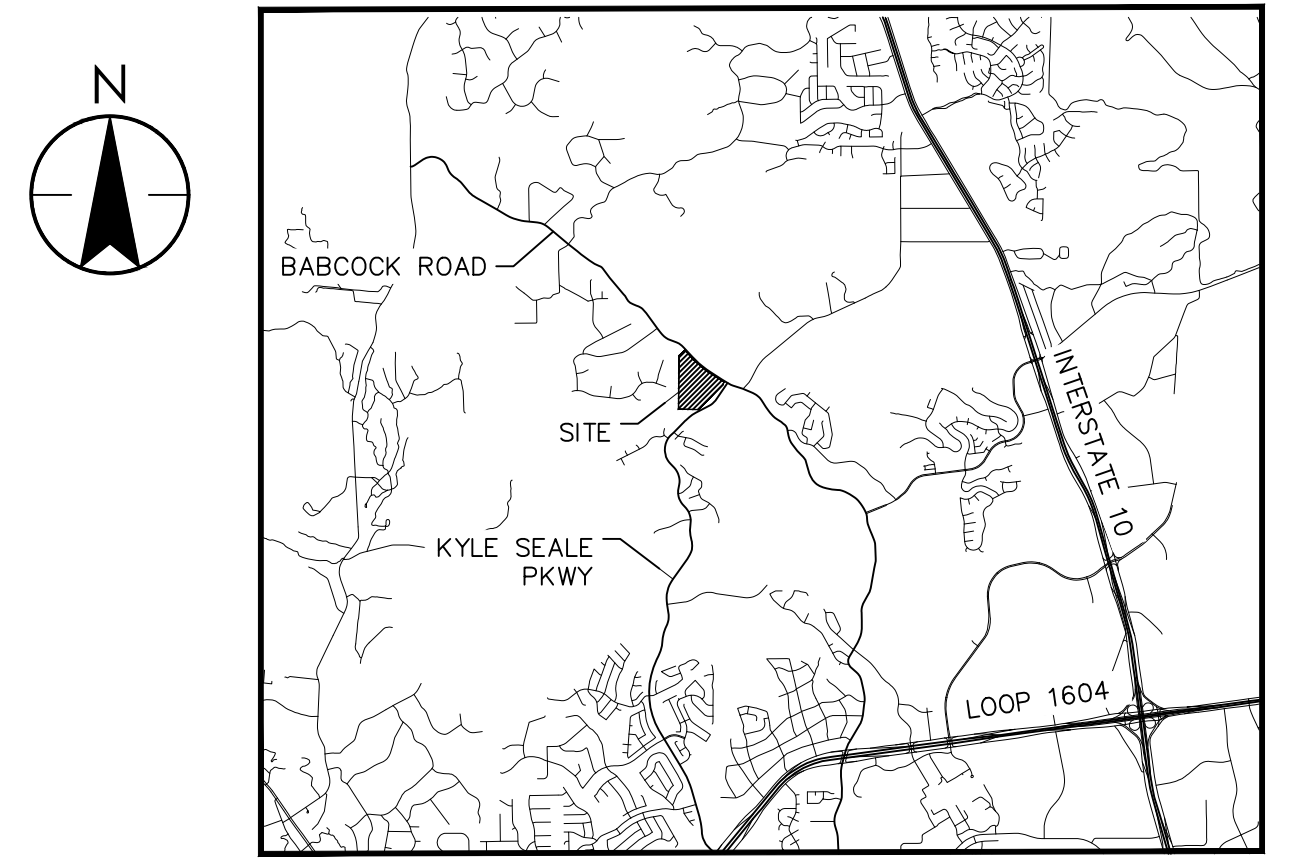

VICINITY MAP
NOT TO SCALE

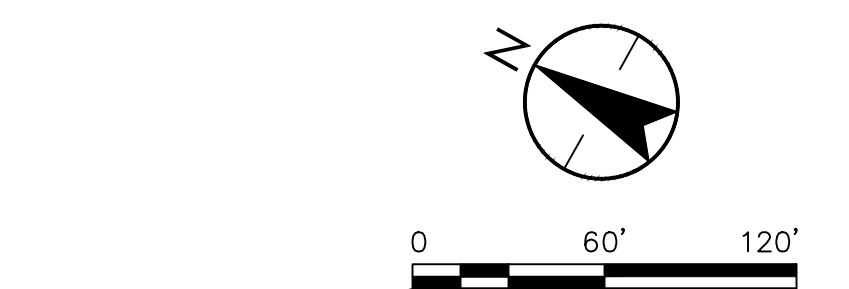

- TREE COVER LEGEND**
- EXISTING TREE CANOPY PRESERVED IN VESTED RIGHTS AREA
 - EXISTING TREE CANOPY REMOVED IN VESTED RIGHTS AREA
 - EXISTING TREE CANOPY PRESERVED IN FLOODPLAIN
 - EXISTING TREE CANOPY REMOVED IN FLOODPLAIN
 - EXISTING TREE CANOPY PRESERVED
 - EXISTING TREE CANOPY REMOVED
 - EXISTING TREE CANOPY PRESERVED IN ENVIRONMENTALLY SENSITIVE AREAS
 - EXISTING TREE CANOPY REMOVED IN ENVIRONMENTALLY SENSITIVE AREAS

- HERITAGE TREE LEGEND**
- EXISTING HERITAGE TREE PRESERVED
 - EXISTING HERITAGE DECAYED

- TOPOGRAPHIC LEGEND**
- EXISTING TOPOGRAPHY
 - PROPOSED TOPOGRAPHY
 - 100 YEAR EXISTING FLOODPLAIN
 - 2006 VESTED RIGHTS AREA

- TREE PROTECTION NOTES:**
- A ROOT PROTECTION ZONE WILL BE ESTABLISHED AROUND EACH TREE OR ANY VEGETATION TO BE PRESERVED TO MEET THE LANDSCAPE OR TREE PRESERVATION ORDINANCES. THE ROOT PROTECTION ZONE SHALL BE AN AREA DENIED BY THE RADIUS EXTENDING OUTWARD FROM THE TRUNK OF THE TREE A DISTANCE OF ONE (1) LINEAL FOOT FOR EACH INCH DIAMETER INCH AT BREAST HEIGHT (4.5') OF THE TREE. A 10-INCH DIAMETER TREE WILL HAVE A 10 FOOT RADIUS ROOT PROTECTION ZONE.
 - NO WORK SHALL BEGIN WHERE TREE PROTECTION FENCING HAS NOT BEEN COMPLETED AND APPROVED. TREE PROTECTION FENCING SHALL BE INSTALLED, MAINTAINED AND REPAIRED BY THE CONTRACTOR DURING CONSTRUCTION. THE FENCING WILL BE A MINIMUM OF 4' HEIGHT.
 - ALL ROOTS LARGER THAN ONE-INCH IN DIAMETER ARE TO BE CUT CLEANLY AND OAK WOUNDS PAINTED WITHIN 30 MINUTES.
 - EXPOSED ROOTS SHALL BE COVERED AT THE END OF THE WORK DAY USING TECHNIQUES SUCH AS COVERING WITH SOIL, MULCH OR WET BURLAP.
 - NO EQUIPMENT, VEHICLES OR MATERIALS SHALL BE OPERATED OR STORED WITHIN THE ROOT PROTECTION ZONE. NO CLEAN-OUT AREAS WILL BE CONSTRUCTED SO THAT THE MATERIAL WILL BE IN OR MIGRATE TO THE ROOT PROTECTION ZONE.
 - NO GRADE CHANGE MORE THAN 3" IS ALLOWED WITHIN THE ROOT PROTECTION ZONE.
 - ROOTS OR BRANCHES IN CONFLICT WITH CONSTRUCTION SHALL BE CUT CLEANLY ACCORDING TO PROPER PRUNING METHODS. ALL OAK WOUNDS SHALL BE PAINTED WITHIN 20 MINUTES TO PREVENT OAK WILT INFECTION.
 - ANY TREE REMOVAL SHALL BE APPROVED BY THE CITY ARBORIST (207-8053).
 - TREES WHICH ARE DAMAGED OR LOST DUE TO THE CONTRACTOR'S NEGLIGENCE DURING CONSTRUCTION SHALL BE MITIGATED.
 - TREES MUST BE MAINTAINED IN GOOD HEALTH THROUGHOUT THE CONSTRUCTION PROCESS. MAINTENANCE MAY INCLUDE WATERING THE ROOT PROTECTION ZONE AND OR WASHING FOLIAGE.
 - NO WIRES, NAILS OR OTHER MATERIALS MAY BE ATTACHED TO PROTECTED TREES.
 - AVOID TRENCHING THROUGH THE CRZ OF PROTECTED TREES. ALTER ROUTES OF UNDERGROUND INFRASTRUCTURE OR USE ALTERNATE METHODS SUCH AS PIPE BORING OR HAND TRENCHING. DO NOT TRENCH OR EXCAVATE THE SOIL WITHIN CRZS, TUNNEL OR BORE AT LEAST 18 INCHES BENEATH CRZS TO INSTALL UTILITY LINES.

BENCHMARKS:

TBM 181 COTTON SHINGLE SET ON ASPHALT NEAR THE NORTH END OF A MEDIAN ALONG KYLE SEAL PKWY AND THE SOUTH RIGHT OF WAY LINE OF BABCOCK RD. ELEV+1181.30'
TBM 102 PK NAIL SET ON SIDEWALK ALONG THE SOUTH RIGHT OF WAY LINE OF KYLE SEAL PKWY. BENCHMARK 3775 SOUTHWEST OF BABCOCK RD. ELEV+1184.01'
TBM 103 PK NAIL SET ON SIDEWALK ALONG THE SOUTH RIGHT OF WAY LINE OF KYLE SEAL PKWY. BENCHMARK 4125 SOUTHWEST OF BABCOCK RD. ELEV+1181.02'

LEGAL DESCRIPTION:

BEING A 44.28 ACRES TRACT OF LAND SITUATED IN BEAR COUNTY, TEXAS, ESTABLISHING LOT 4, BLOCK 4, BEING ALL OF A CALLED 41.68 ACRES TRACT OUT OF CB 4710 AND CB 4541 AS RECORDED IN VOLUME 180, PAGE 2014, AND ALL OF LOT 3 OF THE BABCOCK RD., COMMERCIAL SUBDIVISION AS RECORDED IN VOLUME 173, PAGE 27 OF THE OFFICIAL PUBLIC RECORDS OF BEAR COUNTY, TEXAS.

FLOODPLAIN NOTE:

THE DRAINAGE EASEMENTS WERE DELINEATED TO CONTAIN THE LESSER OF THE BOUNDARIES OF THE 1% ANNUAL CHANCE (100-YEAR) FLOOD ZONE ESTABLISHED BY THE FEDERAL EMERGENCY MANAGEMENT AGENCY (FEMA) IN ACCORDANCE WITH DRRM PANEL 0210G, DATED 9/29/10; OR THE 1% ANNUAL CHANCE (100-YEAR) ULTIMATE DEVELOPMENT CONDITION WATER SURFACE ELEVATION (OR THE 4% ANNUAL CHANCE (50-YEAR) ULTIMATE DEVELOPMENT FLOODPLAIN PLUS FREEBOARD, CONSTRUCTION, IMPROVEMENTS, OR STRUCTURES WITHIN THE DRAINAGE EASEMENTS AND FLOODPLAIN ARE PROHIBITED WITHOUT PRIOR WRITTEN APPROVAL FROM THE FLOODPLAIN ADMINISTRATOR OF THE CITY OF SAN ANTONIO OR BEAR COUNTY.

LOT 3, BLOCK 4, CB 4541 LIES WITHIN THE FEMA 1% ANNUAL CHANCE (100-YEAR) FLOODPLAIN AS DERIVED ON THE FEMA FLOOD INSURANCE RATE MAP OF BEAR COUNTY, TEXAS, DRRM PANEL NUMBERS 48029C AND 48029C, DATED 9/29/10. A FEMA CLOAK FLOODPLAIN STUDY HAS BEEN PREPARED BY AND WAS APPROVED BY THE CITY OF SAN ANTONIO AND/OR BEAR COUNTY. THE FLOODPLAIN STUDY (FEMA CASE NO. 15) FINDING APPROVAL BY FEMA. FLOODPLAIN INFORMATION IS SUBJECT TO CHANGE AS A RESULT OF FUTURE FEMA MAP REVISIONS AND/OR AMENDMENTS.

- VESTED RIGHTS NOTE:**
- ALL AREAS OUTSIDE OF LIMIT OF LINE INDICATING VESTED RIGHTS WILL BE REVIEWED UNDER THE CITY OF SAN ANTONIO'S 2010 TREE PRESERVATION ORDINANCE.
 - GRADING OUTSIDE OF VESTED RIGHTS AREA IS SHOWN FOR REFERENCE ONLY.

Consultant

Revision	By	App'd	YYMMDD

Issued	By	App'd	YYMMDD



11/10/2020

Client/Project
SA BIGHAUSLAND, LLC
BABCOCK ROAD AND KYLE SEAL PARKWAY
SAN ANTONIO, TEXAS

Project No.: 222011059
File Name: 11059PCD_101_TRE_OVRALL
Scale:
STANTEC: EB STANTEC
Dwn. Dgnr. Chkd. 2020.05.05
Title
TREE PRESERVATION PLAN
Revision: Sheet: of
Drawing No. L-0.0

