

HISTORIC AND DESIGN REVIEW COMMISSION

November 18, 2020

HDRC CASE NO: 2020-494
COMMON NAME: VETERANS MEMORIAL PLAZA PARK
ZONING: D,RIO-3,H
CITY COUNCIL DIST.: 1
DISTRICT: Auditorium Circle Historic District
APPLICANT: Candy Martin
OWNER: BEXAR COUNTY PERFORMING ARTS CENTER FOUNDATION
TYPE OF WORK: Addition of a new monument
APPLICATION RECEIVED: October 30, 2020
60-DAY REVIEW: Not applicable due to City Council Emergency Orders
CASE MANAGER: Stephanie Phillips
REQUEST:

The applicant is requesting a Certificate of Appropriateness for approval to install a new monument in Veterans Memorial Plaza Park.

APPLICABLE CITATIONS:

Sec. 35-645. - Signs and Billboards on Public Property or Right-of-Way.

(a) General Provisions. All non-regulatory signage on public property, on the public right-of-way, or overhanging the public right-of-way shall conform to all city codes and must be approved by the historic preservation officer prior to installation. Permits must be obtained following approval of the application. The historic preservation officer may submit an application under this section to the historic and design review commission for their recommendation prior to approving, denying, or approving with conditions the application. Memorials, markers, naming rights of public property, and recognition of charitable donations given to the City of San Antonio shall be additionally governed by existing policies for memorials and markers and/or any formal action passed by city council. Temporary displays approved by the department exercising control of the public property are authorized if in accordance with chapter 28 of the City Code of San Antonio, Texas.

Sec. 35-679. - Other Requirements and Regulations.

(d) Monuments, Markers, Memorials, and Acknowledgements. Monuments, markers or memorial plaques are not permitted on the riverside of property abutting the river, or within the publicly owned right-of-way without the express written consent of the historic preservation officer. The following standards shall apply:

(1) Texas historical markers are permitted, but must be mounted to walls or structures. Pole-mounted THC markers are not permitted in "RIO-3."

(2) Monuments and memorial plaques must commemorate an event or person significant to the Riverwalk or the history of the Riverwalk. To assure that the significance of an event or person has withstood the test of time, memorial plaques may commemorate an event ten (10) years or older a person ten (10) years or more posthumously.

(3) Memorial gifts, such as benches, fountains or art etc., may from time to time be accepted as gifts by the city, plaques acknowledging the gift shall be bronze and no larger the ten inches by four inches (10" x 4"). Memorial plaques for a gift of a tree or other plantings are not permitted.

(4) Placement of monuments, memorials and markers will be under the jurisdiction of the director of parks and recreation, rather than the director of planning, after consultation with the historic preservation officer.

(5) Plaques recognizing donors for significant improvements or plaques acknowledging the naming of significant improvements such as, but not limited to, pocket parks, footbridges, fountains, grottos, gardens, gazebos, boat landings, overlooks and other significant features may be placed along the San Antonio River. The plaques may be no larger than four (4) square feet and must be made of either cast bronze, cast aluminum (or other suitable metal), carved stone, or tile. Language utilized (in recognition of an individual, corporation or foundation) on a plaque must contain language substantially similar to "sponsored by, underwritten by, a gift from."

FINDINGS:

- a. The applicant is requesting approval to install a new monument in Veterans Memorial Plaza Park. The park is located in the Auditorium Circle Historic District and is bordered by Jefferson St, E Martin St, and the AT&T Building. The park is located directly adjacent to the Tobin Center for the Performing Arts.
- b. PRIOR REVIEW – The City of San Antonio Parks & Recreation Department has been working with a group for the Gold Star Monument for the last several months and has received, reviewed, and approved the proposed monument. The Parks department also included John Baines and Randy Ramseur, the original developer and architect for the plaza, in the discussion and they reviewed and approved the monument plans. Additionally, the proposed concept of the monument was discussed amongst the tri-chairs of the Military Transformation Task Force (MTTF) and the Director of the City of San Antonio Office of Veterans and Military Affairs. Support was granted from these agencies in August 2020.
- c. MONUMENT – The Gold Star Families Memorial Monument will be installed adjacent to the AT&T Center in the existing Plaza. The monument will be constructed of concrete, granite, and granite markers. Staff finds that the request complies with UDC Section 35-679.

RECOMMENDATION:

Staff recommends approval based on findings a and c.

City of San Antonio One Stop



November 13, 2020

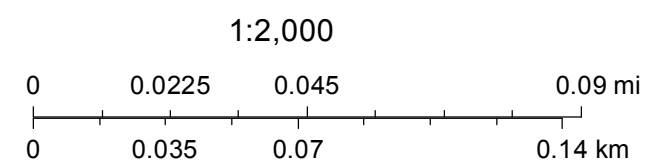



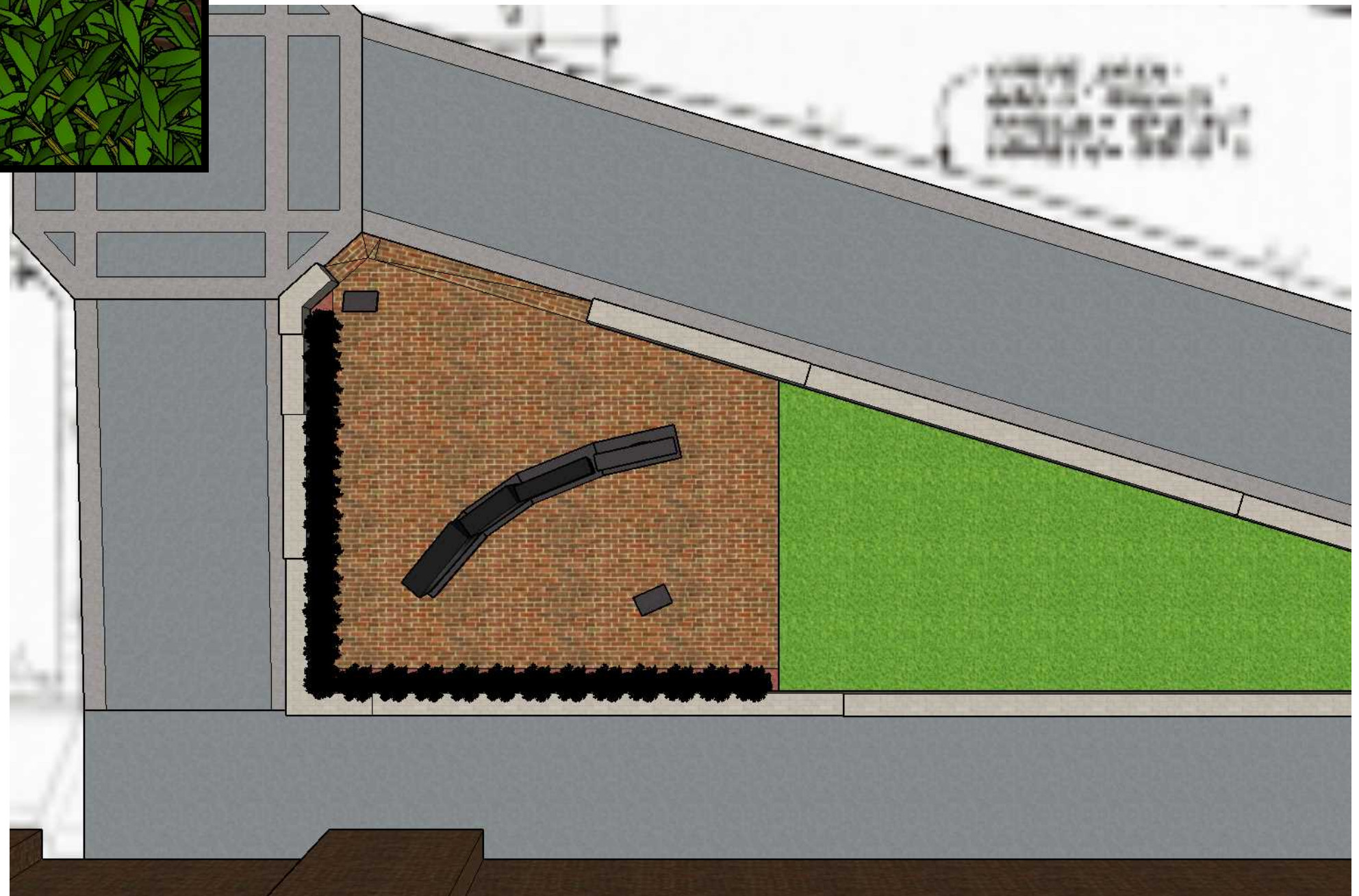
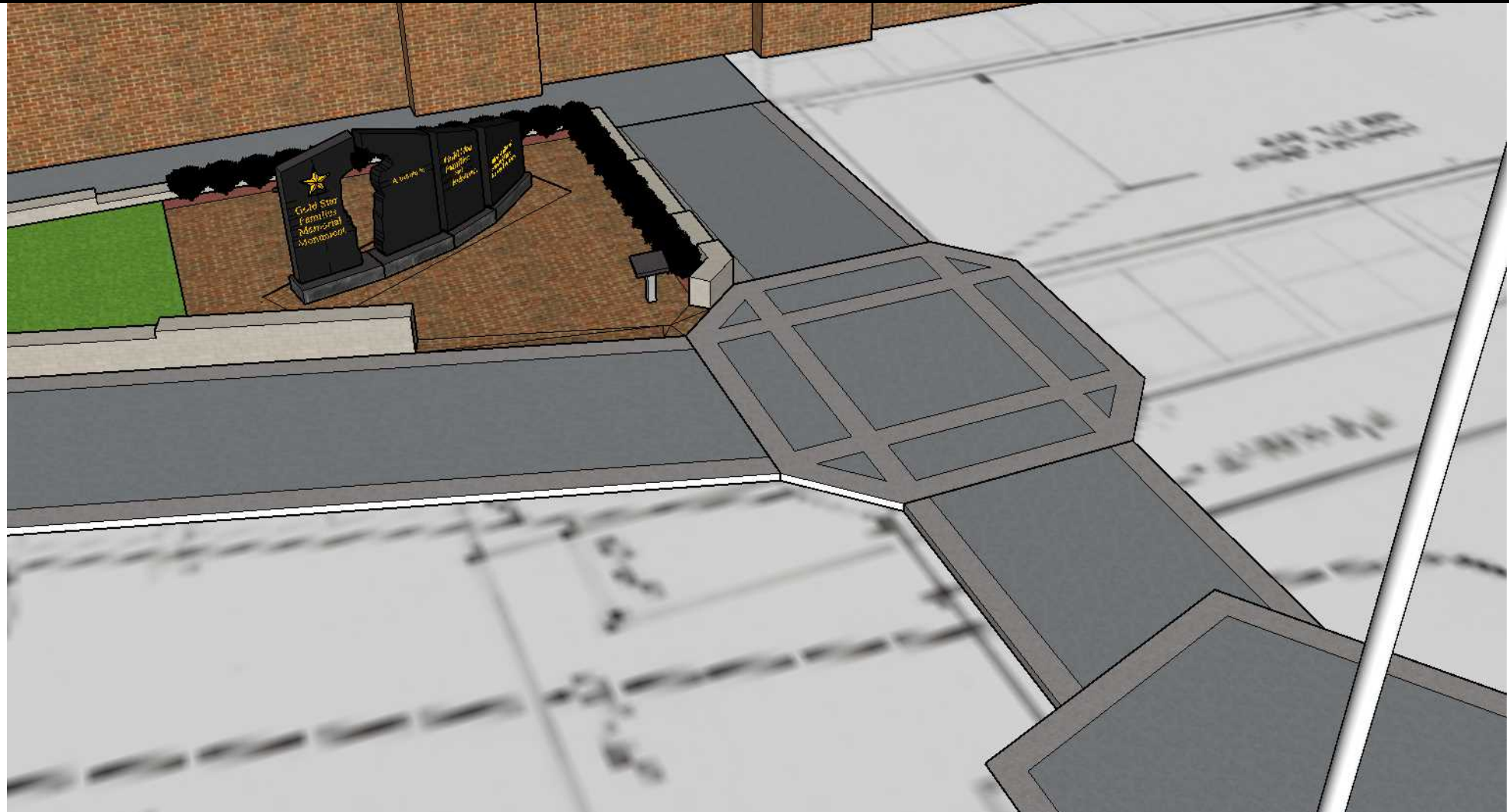
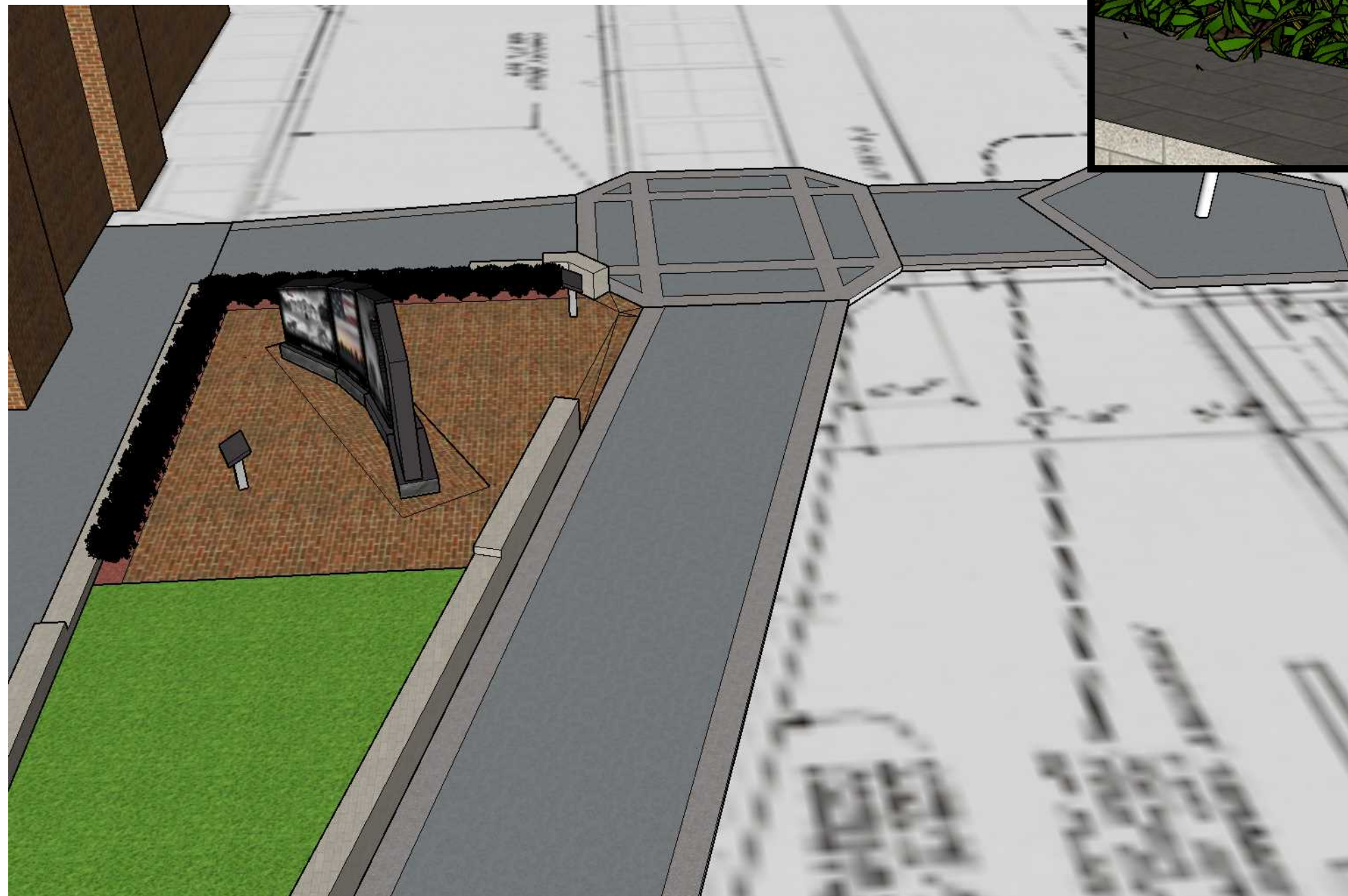



HOMELAND



FAMILY



PATRIOT



SACRIFICE

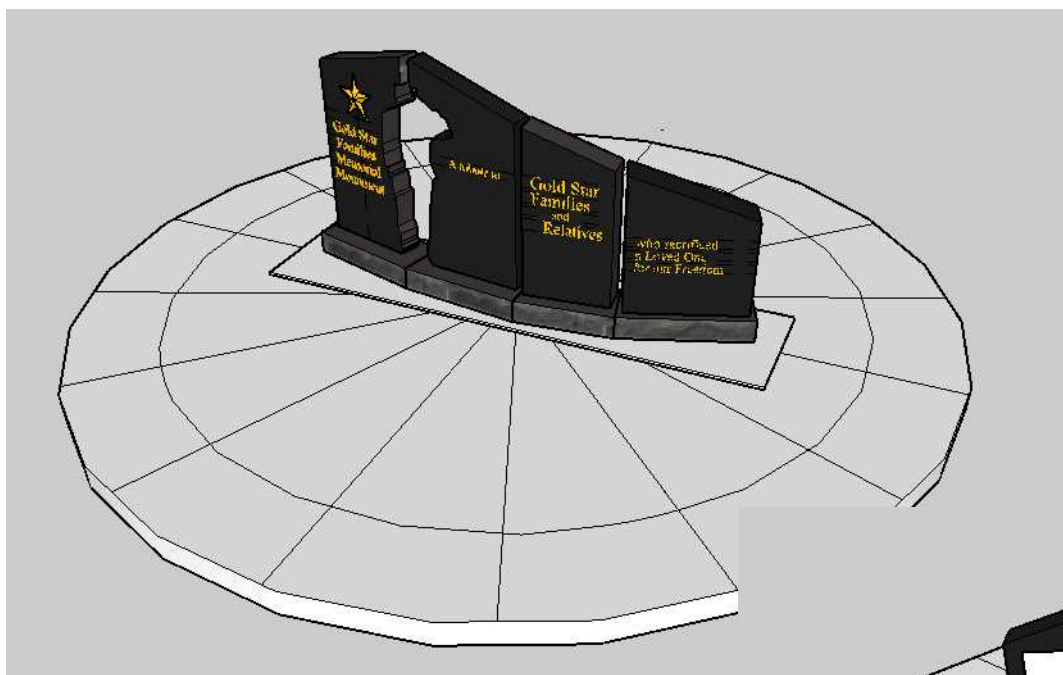

1 Isometric of Monument
A01 Scale: NTS

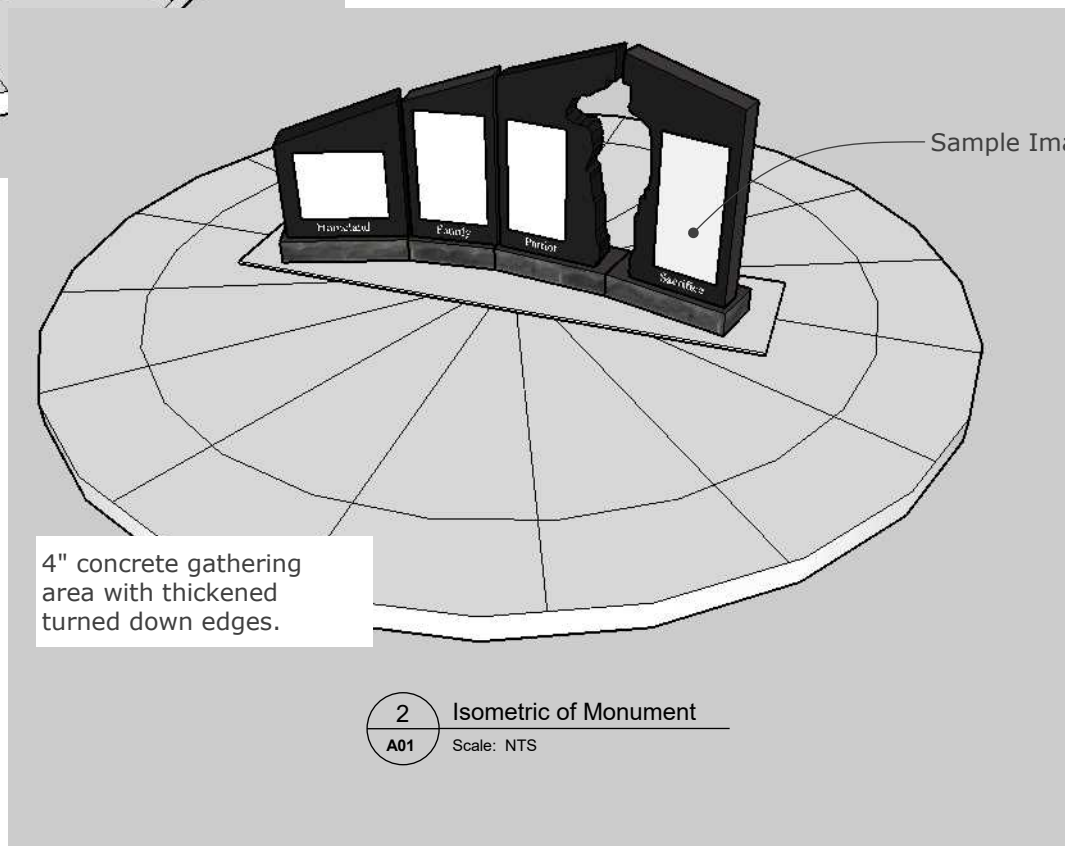

2 Isometric of Monument
A01 Scale: NTS

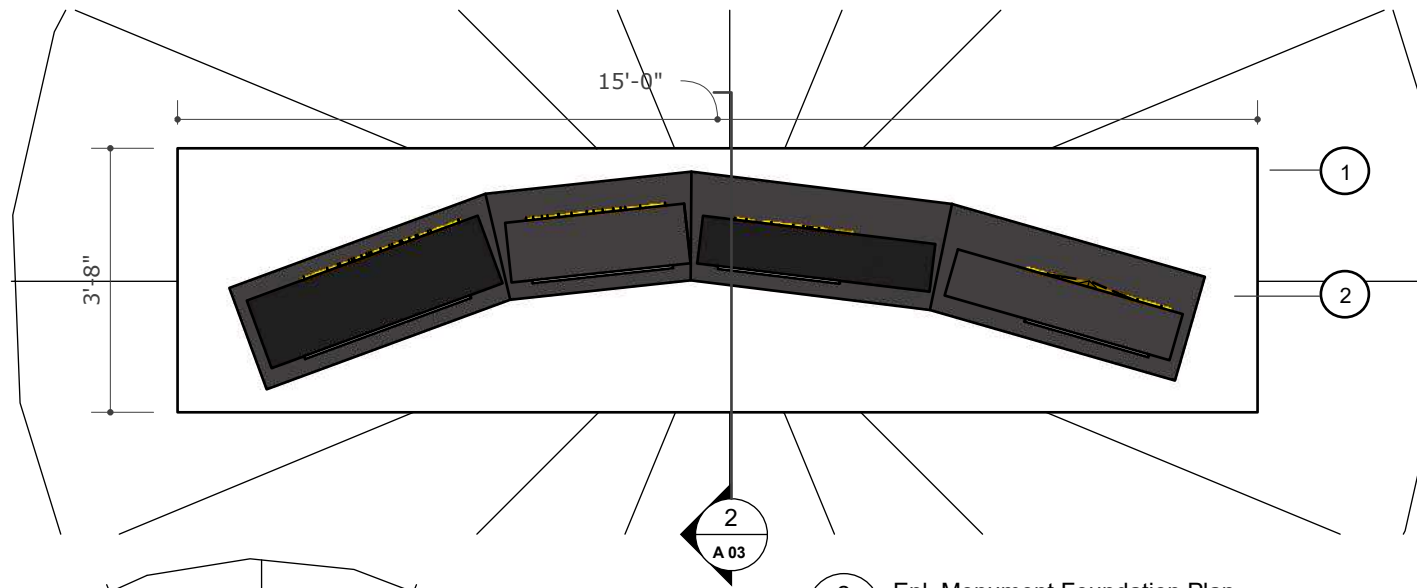

2 Enl. Monument Foundation Plan
A02 Scale: 3/8" = 1'-0"

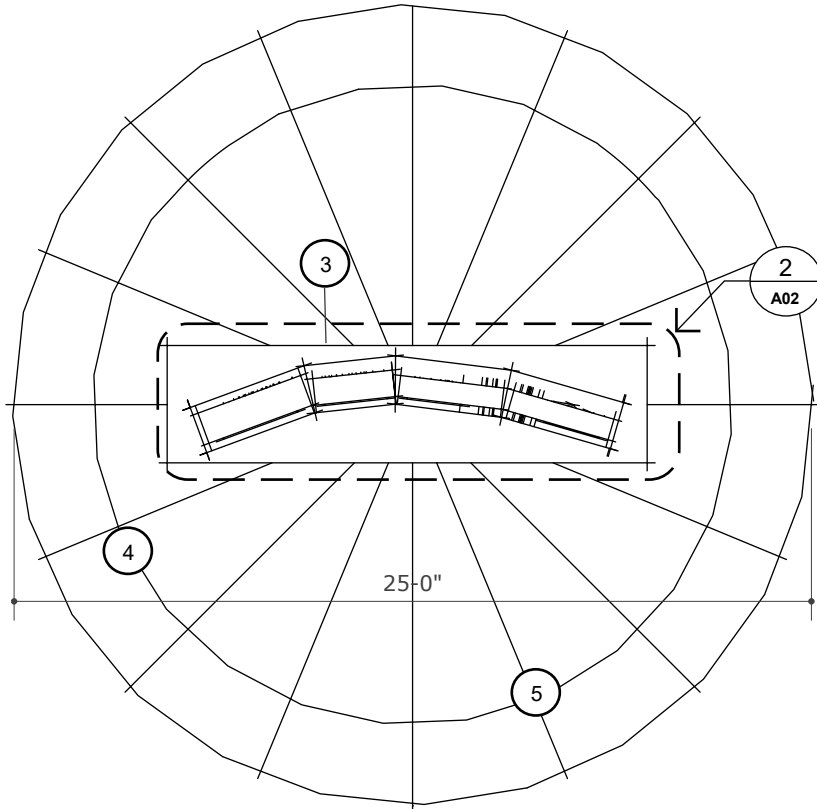

1 Typical Plan Layout
A02 Scale: 1/8" = 1'-0"

Numbered Notes:

1. 12" Thick footing, 4000# concrete. #4 bars @ 10" oc long direction, #4 bars at 16" oc short direction. #4 bent bars @ 32" oc.
2. 18" tall stem wall - 3'-8" wide. 2 rows of #4 bar long direction. 1 row #4 bars @ 16" oc in short direction. Top of radius stem wall must be completely flat to allow monuments to sit plumb.
3. Monument base to be placed by others. See Sheet 3.
4. 4" Concrete slab with light broom finish, tool joints as shown. Slope to drain. 4" min. stone base.
5. Provide expansion joints or control joints at max 20' any direction. Pattern may be modified to accommodate site restraints or design.

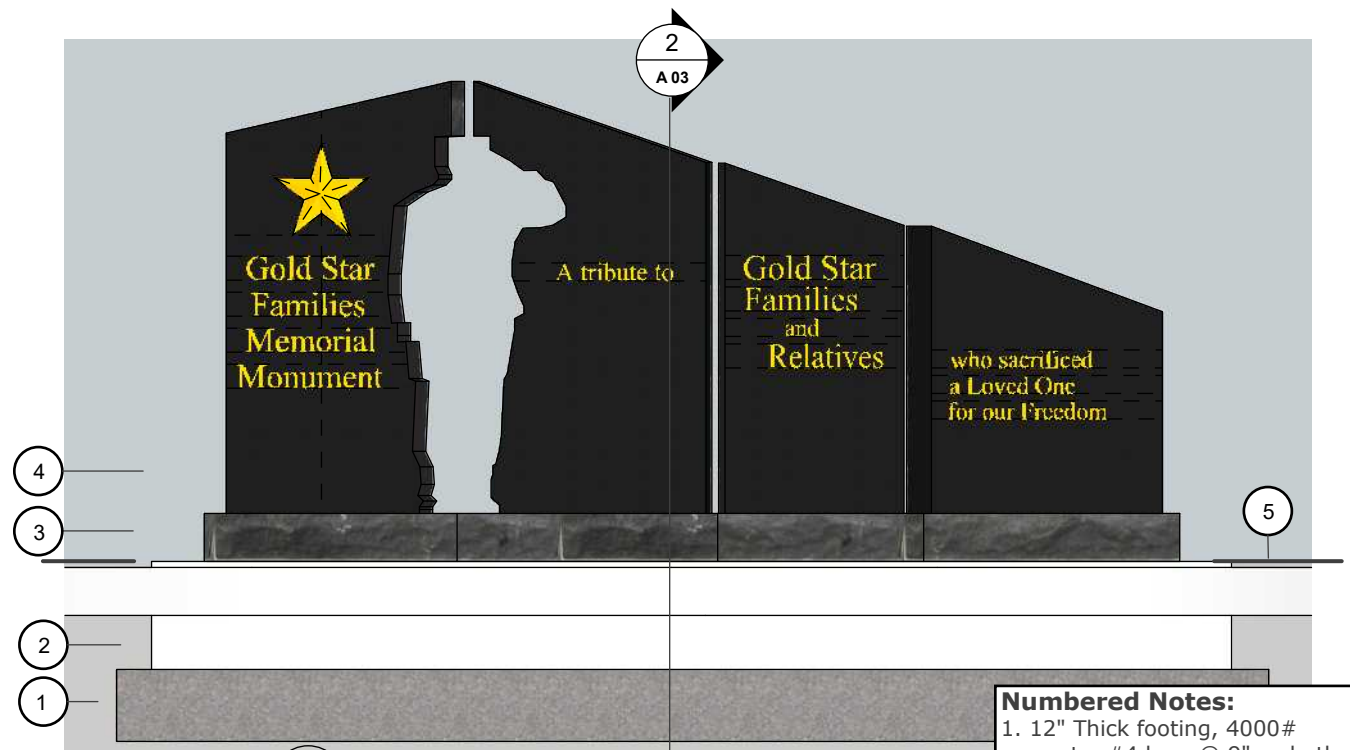
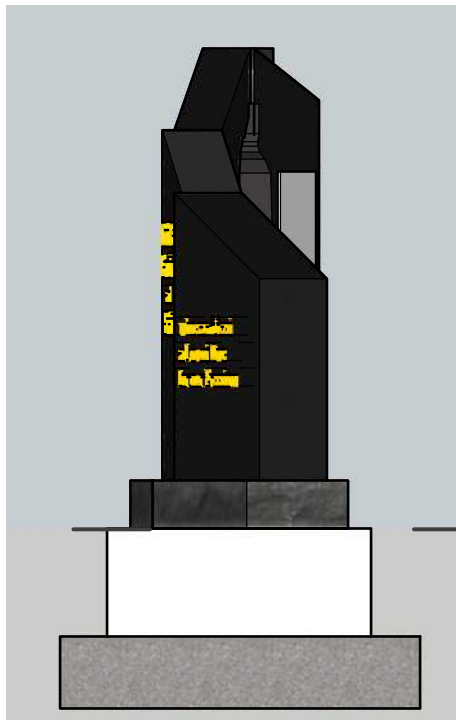

1 Monument Foundation Elevations
A 03 Scale: 3/8" = 1'-0"

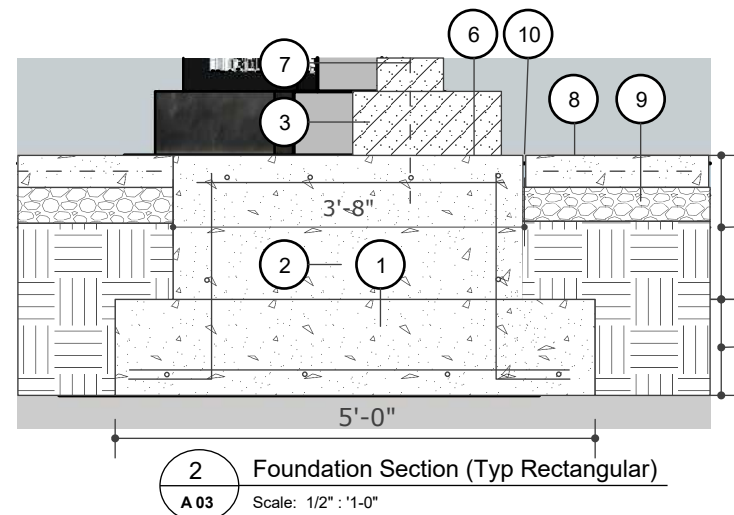

Numbered Notes:

1. 12" Thick footing, 4000# concrete. #4 bars @ 9" oc both directions. Minimum 3" cover. #4 bent bars @ 18" oc.
2. 18" tall stem wall - 2'-6" wide. 4 rows of #4 bar long direction equally spaced (3 rows in alt foundation detail 2 alt A04). #4 bars @ 12" oc in short direction.
3. 8" Tall monument base (by others)
4. Laser etched monuments, images will vary from site to site (by others)
5. Grade line.
6. Top of stem wall must be completely flat to allow monuments to sit plumb.
7. Anchor Bar drilled into existing foundation and installed by Monument Company.
8. 4" Concrete slab with light broom finish, tool joints as shown. Slope to drain.
9. 4" min. stone base.
10. 1/2" exp jt with sealant at joints.

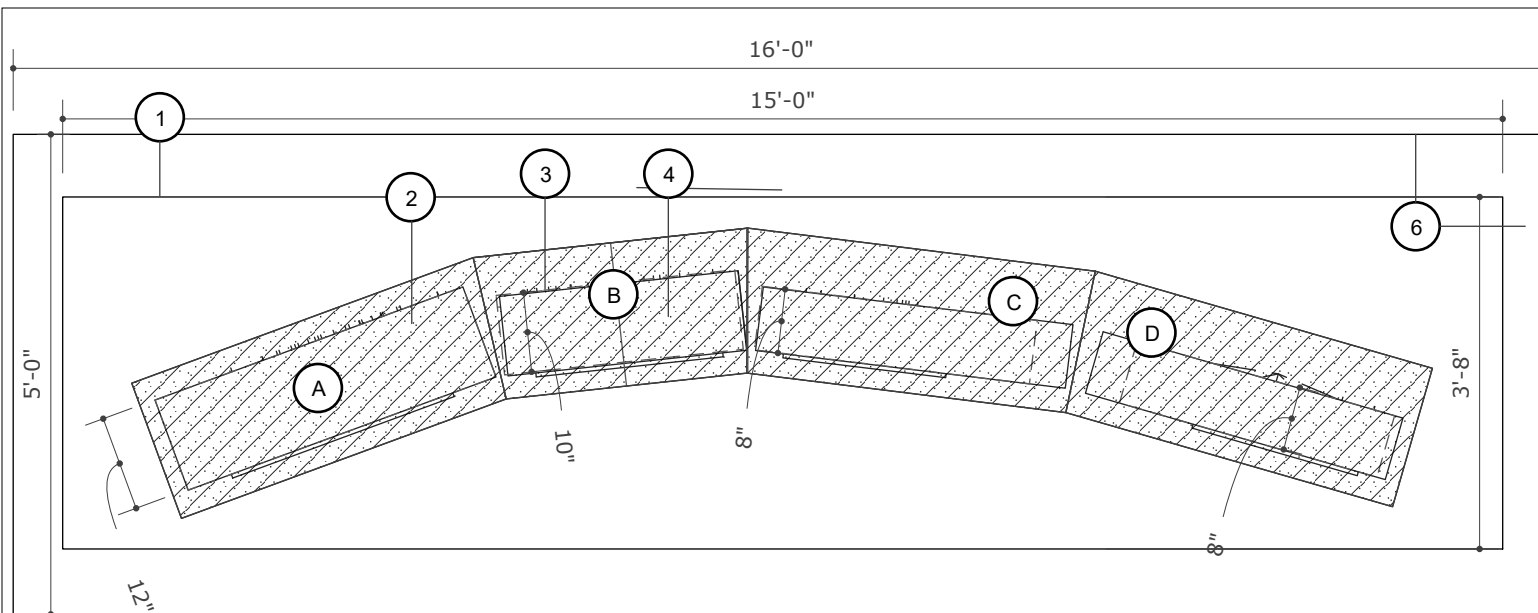

Numbered Notes:

1. Top of stem wall below. (Standard Rectangle.) Must be perfectly level to place monument.
2. Shaded areas are monument bases.
3. Short dashed are location of vertical monuments to be placed on top of monument bases.
4. Holes in monument bases and vertical monuments are by monument stone provider. Monument stone installer will drill and epoxy vertical dowels after these bases are field located.
5. Exposed edges of monument bases are rough cut, concealed faces and tops are polished smooth.
6. Footing below. See Sheet 2.

1 Monument Base Placement Plan
A04 Scale: 1/2" = 1' - 0"

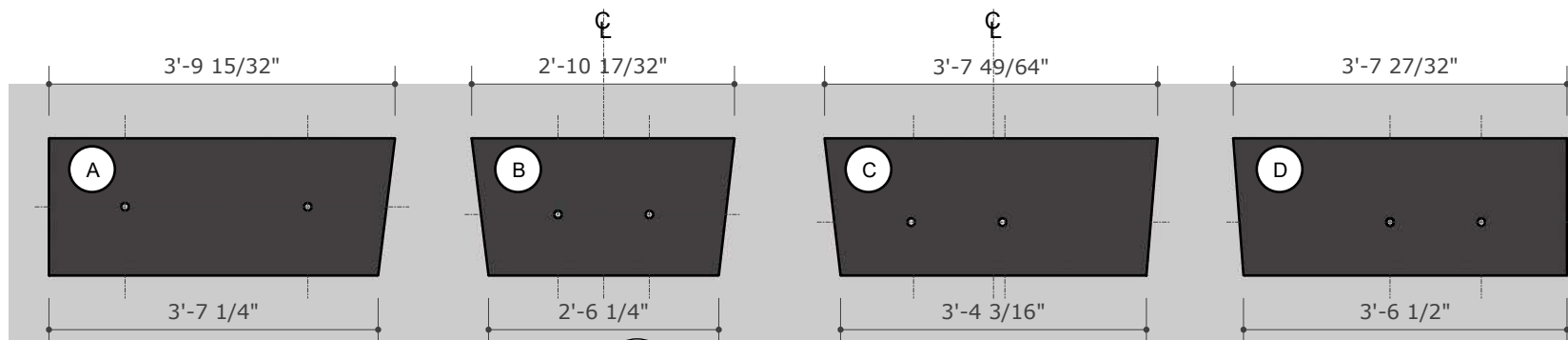

2 Monument Base Plans
A04 Scale: 1/2" = 1'-0"

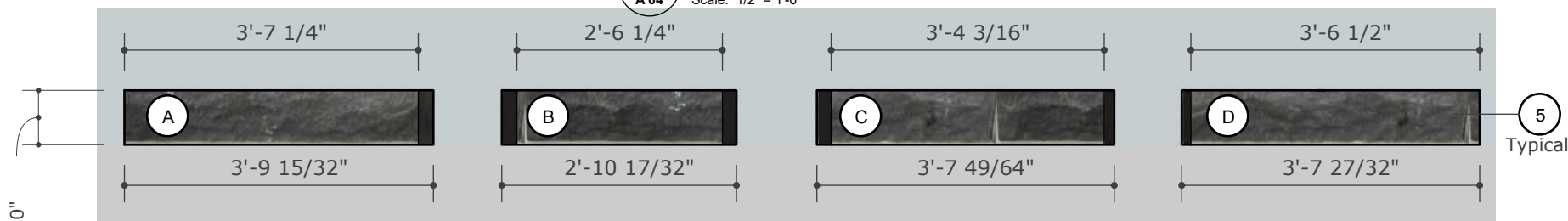

3 Monument Base Elevations
A04 Scale: 1/2" = 1'-0"

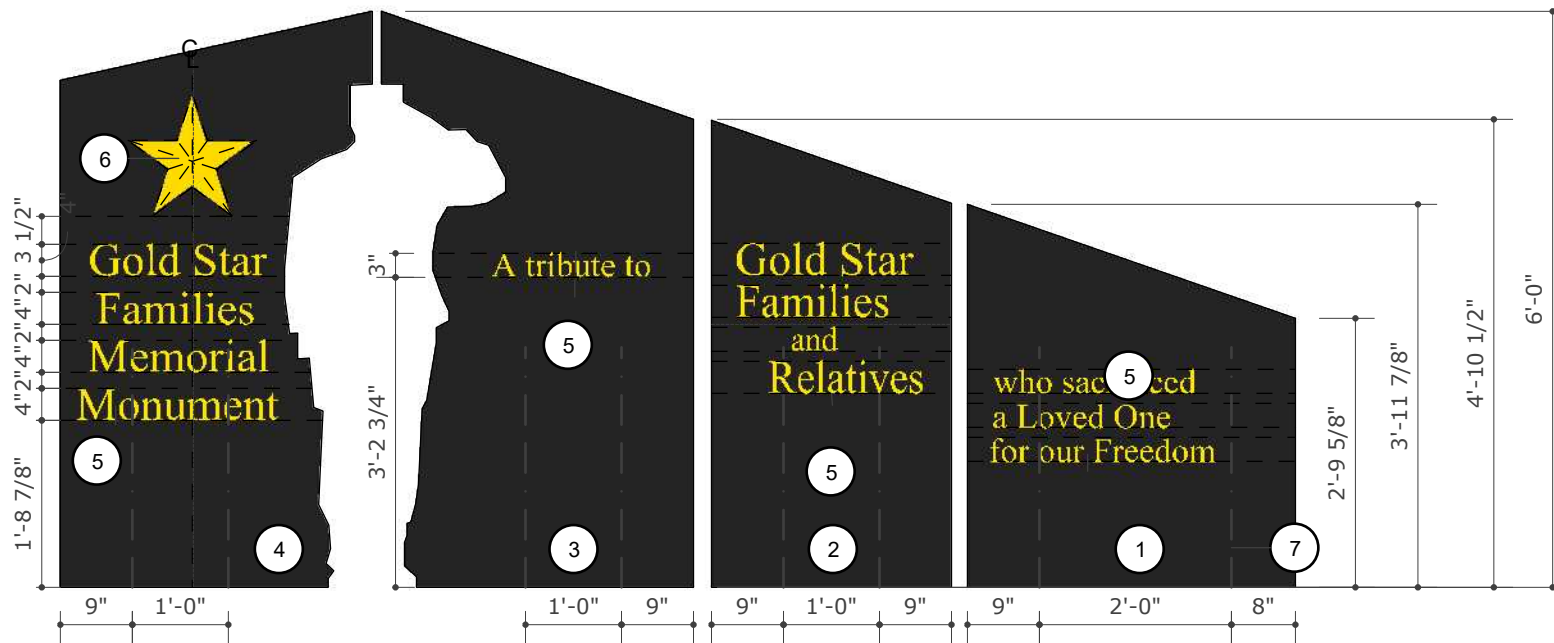

1 Monument Front Elevation
A05 Scale: 1/2" = 1'-0"

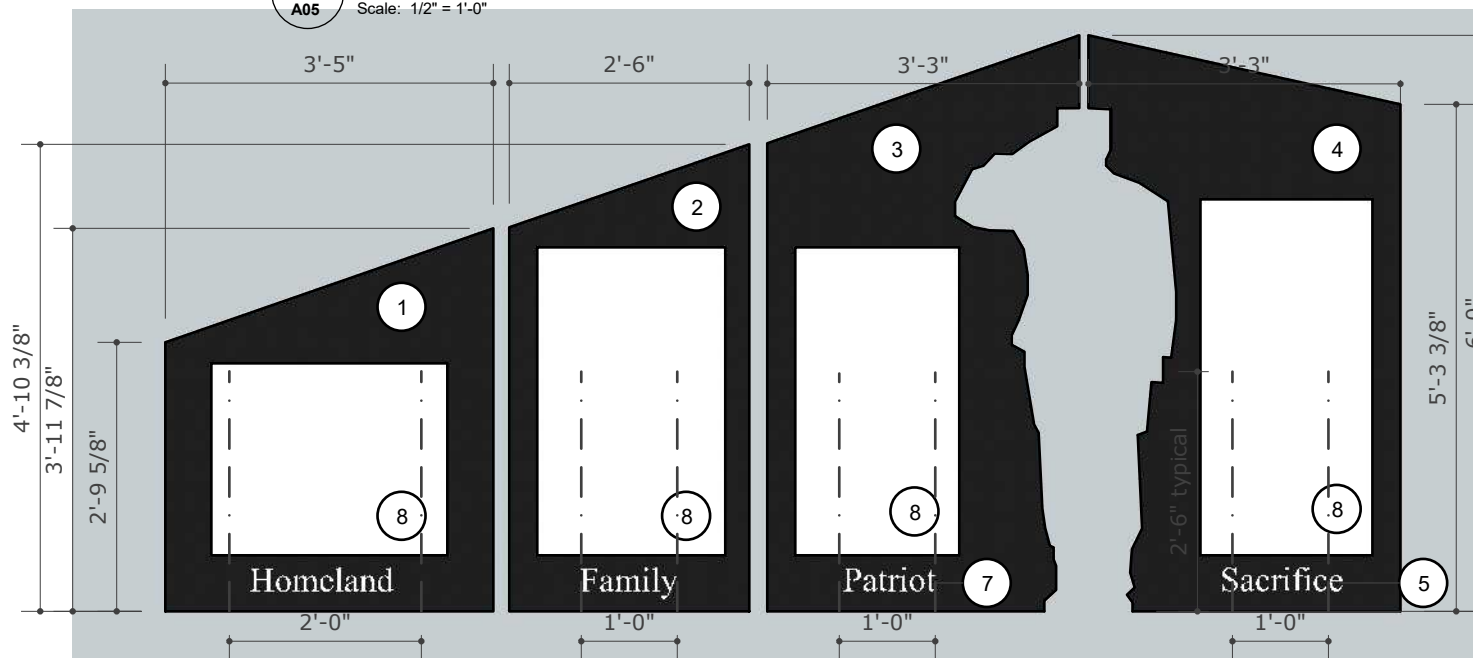

1 Monument Rear Elevation
A05 Scale: 1/2" = 1'-0"

Numbered Notes:

1. Standing Granite Slab 3' - 11 7/8" tall x 3'-5" wide x 12" thick.
2. Standing Granite Slab 4' - 10 3/8" tall x 2'-6" wide x 10" thick.
3. Standing Granite Slab 6' - 0" tall x 3'-5" wide x 8" thick.
4. Standing Granite Slab 6' - 0" tall x 3'-5" wide x 8" thick.
5. Sandblasted inscription text height as indicated. Text as shown. Times New Roman font.
6. Cast Bronze Nautical Star with concealed stainless steel fasteners.
7. 1" dia. drilled cores by monument installer typical 2 each stone.
8. Image areas. Coordinate with owner.



Future Home of the

San Antonio Gold Star Families Memorial Monument



For more information please contact:
The Woody Williams Foundation Phone: (888)-839-7190 Email: Contact@hwwmohf.org

Explanation and Schematics for Description Marker

Explanation Markers. The last element of the Monument design is the Explanation Marker. This feature is designed by the committee in order to explain to visitors the significance of the monument and the images that have been chosen by the GSFMM committee. The GSFMM may choose to use a granite marker or a bronze marker.

- 1) One 18"X24"X8" bevel marker (description ledger) with polished bevel top and a 1 ½" polished margin and the pedestal of the same granite that is 5 feet tall and 8 inches square.



Sample Only

- 2) The balance of the stone will be rock pitched, with laser etched lettering to provide the message and meaning of the scenes on the four monuments.

Please see next page.

San Antonio Marker information will read and include:



Gold Star Families Memorial Monument



This monument honors, recognizes, and serves Gold Star Families and the legacy of their Loved Ones who have paid the ultimate sacrifice while serving in the Armed Forces of the United States of America.

The **Homeland** panel depicts images representing San Antonio, Texas, with symbols of our heritage and pride. This area is home to many Gold Star Families, it is our people, it is our family, it is our Freedom.

The **Family** panel represents the uniquely brave spirit of our Military families who provide support to their Loved Ones serving in our Armed Forces of the United States of America.

The **Patriot** panel shows the raising of the America Flag on Iwo Jima, which symbolizes those who vigorously support and defend our great Nation through selfless service in our Armed Forces.

The **Sacrifice** panel represents the sacrifices made by our Gold Star Families by the loss of their Loved One while in service to our country. There is a somber remembrance behind the folded flag. A sacrifice of a lifetime....is symbolic in that a life was sacrificed.

The **Silhouette** represents a saluting service member to symbolize the void created by the loss and legacy of the Loved Ones who have paid the ultimate sacrifice while serving in the Armed Forces of the United States of America.

This monument is a project of the City of San Antonio, its businesses, its organizations, Wish For Our Heroes and the Woody Williams Foundation.



Woody Williams Foundation

12123 Shelbyville Road
Suite 100
Louisville, Kentucky 40243

Office Of Historic Preservation Online Application
October 30th, 2020

Specifications of materials to be used for the San Antonio Gold Star Families Memorial Monument.

Please allow this letter to describe the requested information.

The Gold Star Families Memorial Monument stands at 7' tall X 16' wide. It is made of India Black Granite. This monument is erected in 8 sections.

- Four 8 inch India Black Granite bases
- Four India Black Granite panels with sandblasted wording on one side and laser etched images on the other side.
- 1 Bronze gold coated nautical star place on the front of the monument

Our team stands ready to answer any further questions or clarifications if needed.

I may best be reach at 502-379-0746 or alex.nauert@hwwmohf.org

With appreciation,

Alexander H. Nauert

Alexander H. Nauert
Director of Programs
502-379-0746