

Z2021-10700087

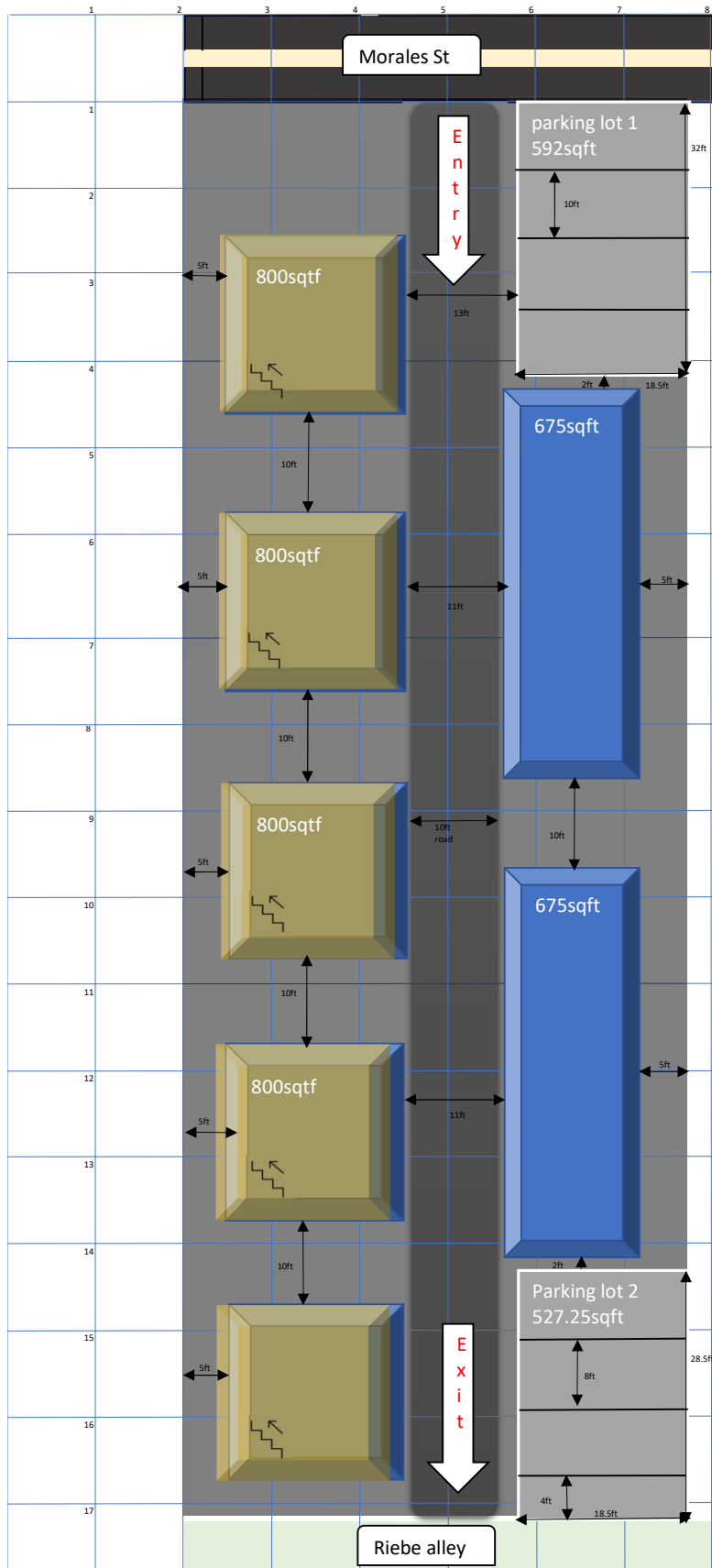

1016 Morales St.

Two story homes, 800sqft; 5 units

One story homes, 675sqft; 2 units

10 foot and 5 foot set back from resident and land respectively

Parking lot 1: 592sqft; 4 spaces

Parking lot 2: 527.25sqft; 4 spaces

*Lot Size - 9,128sqft

*Paved road - 1,620 sqft

*Scale 1 to 10ft; larger squares are 100sqft; smaller squares are 2sqft

*Wooden Fencing

*Intended use of property: Residential

From: "R-4 AHOD" Residential Single-Family Airport Hazard Overlay District

To: "IDZ-2 AHOD" Medium Intensity Infill Development Zone Airport Hazard Overlay District with uses permitted for 21 (twenty-one) dwelling units

"I, Ivan Emil Wright, the owner acknowledge that this site plan submitted for the purpose of rezoning this property is in accordance with all applicable provisions of the Unified Development Code. Additionally, I understand that City Council approval of a site plan in conjunction with a rezoning case does not relieve me from adherence to any/all City adopted Code at the time of plan submittal for building permits."

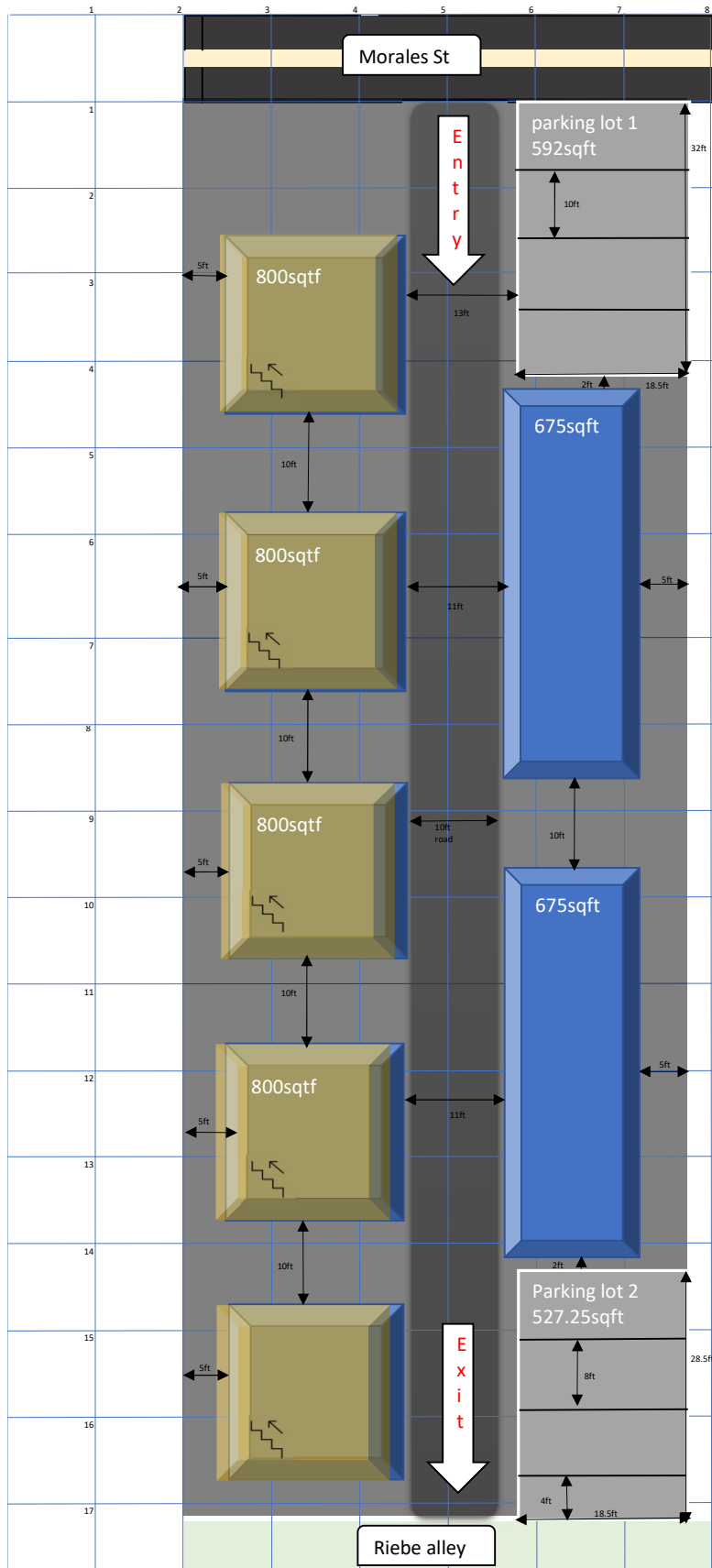

From: "R-4 AHOD" Residential Single-Family Airport Hazard Overlay District
To: "IDZ-2 AHOD" Medium Intensity Infill Development Zone Airport Hazard Overlay District with uses permitted for 21 (twenty-one) dwelling units

"I, Ivan Emil Wright, the owner acknowledge that this site plan submitted for the purpose of rezoning this property is in accordance with all applicable provisions of the Unified Development Code. Additionally, I understand that City Council approval of a site plan in conjunction with a rezoning case does not relieve me from adherence to any/all City adopted Code at the time of plan submittal for building permits."

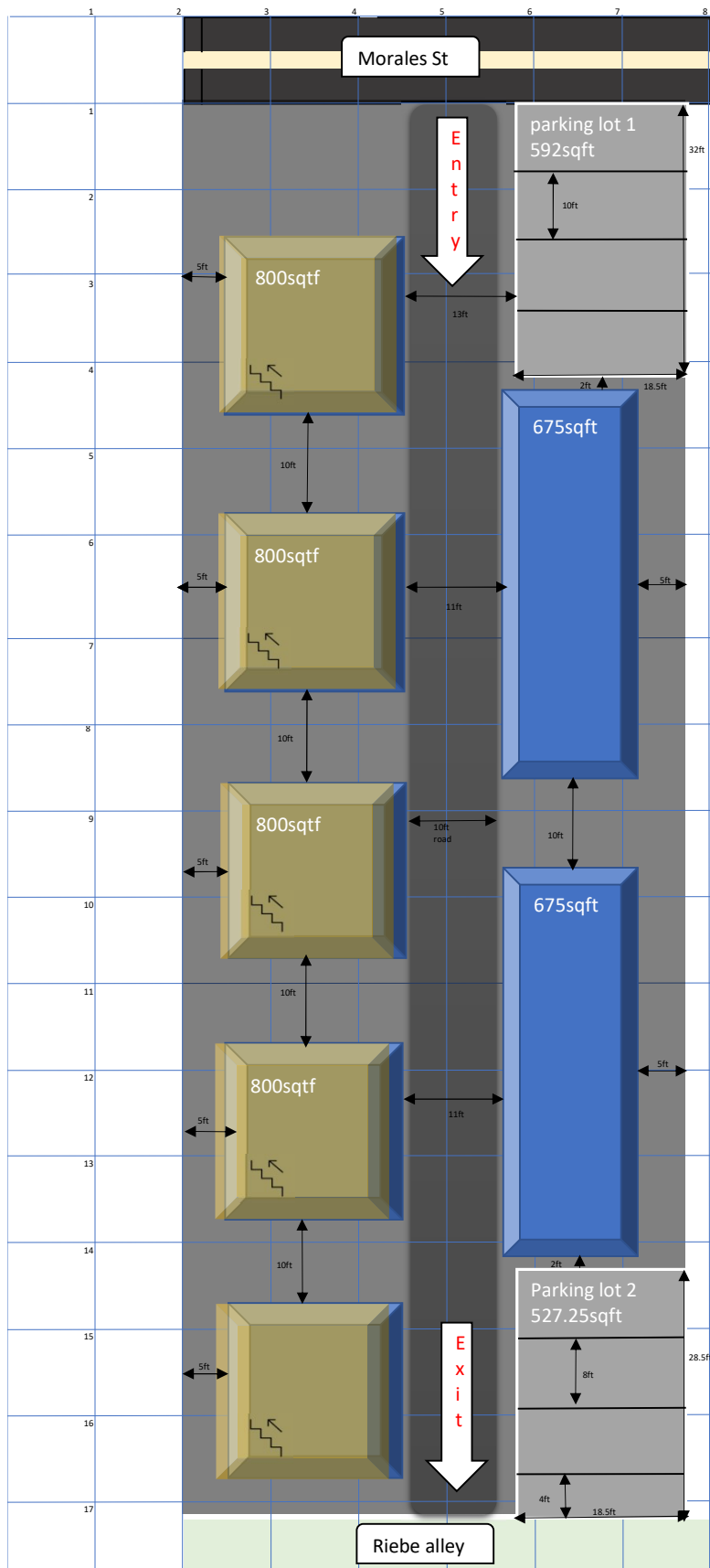

1028 Morales St.

Two story homes, 800sqft; 5 units

One story homes, 675sqft; 2 units

10 foot and 5 foot set back from resident and land respectively

Parking lot 1: 592sqft; 4 spaces

Parking lot 2: 527.25sqft; 4 spaces

*Lot Size - 9,128sqft

*Paved road - 1,620 sqft

*Scale 1 to 10ft; larger squares are 100sqft; smaller squares are 2sqft

*Wooden Fencing

*Intended use of property: Residential

From: "R-4 AHOD" Residential Single-Family Airport Hazard Overlay District

To: "IDZ-2 AHOD" Medium Intensity Infill Development Zone Airport Hazard Overlay District with uses permitted for 21 (twenty-one) dwelling units

"I, Ivan Emil Wright, the owner acknowledge that this site plan submitted for the purpose of rezoning this property is in accordance with all applicable provisions of the Unified Development Code. Additionally, I understand that City Council approval of a site plan in conjunction with a rezoning case does not relieve me from adherence to any/all City adopted Code at the time of plan submittal for building permits."